

**COMMONWEALTH OF KENTUCKY
BEFORE THE PUBLIC SERVICE COMMISSION**

In the Matter of:

THE APPLICATION OF)
APC TOWERS IV, LLC, A DELAWARE)
LIMITED LIABILITY COMPANY)
AND CELLCO PARTNERSHIP D/B/A VERIZON WIRELESS)
FOR ISSUANCE OF A CERTIFICATE OF PUBLIC) CASE NO.: 2024-00291
CONVENIENCE AND NECESSITY TO CONSTRUCT)
A WIRELESS COMMUNICATIONS FACILITY)
IN THE COMMONWEALTH OF KENTUCKY)
IN THE COUNTY OF LIVINGSTON)

SITE NAME: EV SMITHLAND NORTH

* * * * *

RESPONSE TO NOTICE OF FILING DEFICIENCY

Applicants, by counsel and in response to the Kentucky Public Service Commission’s (“PSC”) letter dated October 29, 2024 requesting additional information to cure a deficiency in the within matter, state as follows:

1. In Response to the PSC’s finding of a deficiency with respect to 807 KAR 5:063 Section 1(1)(l), Applicants hereby submit **Exhibit A**, which includes enhanced images of the previously filed United States Postal Service Form 3811 “green card.” **Exhibit A** includes a scan of the green card with a red circle added by Applicants’ counsel to highlight the signature, which appears to have been made by a stamp. **Exhibit A** also includes a zoomed scan of the green card depicting the same signature stamp.

2. As further confirmation, the United States Postal Service (USPS) tracking data for the letter sent to the Kentucky Transportation Cabinet is attached as **Exhibit B**. The USPS tracking data confirms that the letter’s status as “delivered, individual picked up at Postal Facility” as of October 17, 2024.

3. In compliance with 807 KAR 5:063 Section 1(1)(I), the letter was mailed to the landowner according to the record of the County's Property Valuation Administrator ("PVA"), which was attached to the filed application as part of Exhibit J (page 217) and is included as **Exhibit C**. The County's PVA records for the owner's address do not include a zip code. Despite the zip code not being included in the mailing, the notice letter is documented as received by the landowner no later than October 17, 2024 (see filed application and as supplemented by **Exhibits A and B** of this filing).

WHEREFORE, Applicants respectfully request that the PSC accept the foregoing information for filing, and having met the requirements of KRS §§ 278.020(1), 278.650, and 278.665 and all applicable rules and regulations of the PSC, find the application non-deficient, and proceed to grant a Certificate of Public Convenience and Necessity to construct and operate the WCF at the location set forth in the subject application.

Respectfully submitted,



David A. Pike

And



F. Keith Brown

Pike Legal Group, PLLC
1578 Highway 44 East, Suite 6
P. O. Box 369
Shepherdsville, KY 40165-0369
Telephone: (502) 955-4400
Telefax: (502) 543-4410
Email: dpike@pikelegal.com
Email: kbrown@pikelegal.com

Attorneys for Applicants

LIST OF EXHIBITS

- A - Enhanced Images of Previously Filed United States Postal Service Form 3811 "green card"
- B - United States Postal Service Tracking Data
- C - Livingston County, Kentucky Property Valuation Administrator Record for Parcel # 043-00-00-006.00

EXHIBIT A

Enhanced Images of Previously Filed
United States Postal Service Form 3811 "green card"

SENDER: COMPLETE THIS SECTION

- Complete items 1, 2, and 3.
- Print your name and address on the reverse so that we can return the card to you.
- Attach this card to the back of the mailpiece, or on the front if space permits.

1. Article Addressed to:

COMMONWEALTH OF KY
KY TRANSPORTATION CABINET
DEPT OF HWYS
FRANKFORT, KY



9590 9402 7926 2305 8810 52

2. Article Number (Transfer from service label)

7022 3330 0000 3636 7184

PS Form 3811, July 2020 PSN 7530-02-000-9053

COMPLETE THIS SECTION ON DELIVERY

A. Signature

X

Agent

Addressee

B. Received by (Printed Name)

C. Date of Delivery

D. Is delivery address different from Item 1?
If YES, enter delivery address below:

Yes

No

SEP 17 2023

3. Service Type

Adult Signature

Adult Signature Restricted Delivery

Certified Mail®

Certified Mail Restricted Delivery

Collect on Delivery

Collect on Delivery Restricted Delivery

Insured Mail

Insured Mail Restricted Delivery (over \$500)

Priority Mail Express®

Registered Mail™

Registered Mail Restricted Delivery

Signature Confirmation™

Signature Confirmation Restricted Delivery

Domestic Return Receipt

Address different from Item 1? Y

delivery address below: N

Free Order

SEP 17 2023

EXHIBIT B

United States Postal Service Tracking Data

Tracking Number:

[Remove X](#)

70223330000036367184

[Copy](#)

[Add to Informed Delivery \(https://informedelivery.usps.com/\)](https://informedelivery.usps.com/)

Latest Update

Your item was picked up at a postal facility at 7:43 am on October 17, 2024 in FRANKFORT, KY 40601.

Get More Out of USPS Tracking:

USPS Tracking Plus®

Delivered

Delivered, Individual Picked Up at Postal Facility

FRANKFORT, KY 40601

October 17, 2024, 7:43 am

Arrived at Post Office

FRANKFORT, KY 40601

October 17, 2024, 5:03 am

In Transit to Next Facility

September 17, 2024

Arrived at USPS Regional Facility

LEXINGTON KY DISTRIBUTION CENTER

September 12, 2024, 11:52 am

Arrived at USPS Regional Facility

LOUISVILLE KY DISTRIBUTION CENTER

September 12, 2024, 12:47 am

[Hide Tracking History](#)

Feedback

What Do USPS Tracking Statuses Mean? (<https://faq.usps.com/s/article/Where-is-my-package>)

Text & Email Updates



USPS Tracking Plus®



Product Information



See Less ^

Track Another Package

Enter tracking or barcode numbers

Need More Help?

Contact USPS Tracking support for further assistance.

FAQs

EXHIBIT C

Livingston County, Kentucky Property Valuation Administrator Record for
Parcel # 043-00-00-006.00

Livingston County, KY PVA

Summary

Parcel Number 043-00-00-006.00
 Account Number 8319
 Location Address U S 60 EAST 811
 Description STATE GAR SALT SHED & HWY DEPT 23.09 AC
 (Note: Not to be used on legal documents)
 Class Exempt State
 Tax District 01 County

[View Map](#)



Owner

Primary Owner
[COMMONWEALTH OF KY](#)
 KY TRANSPORTATION CABINET
 DEPT OF HWYS
 FRANKFORT, KY

Land Characteristics

Condition		Topography	
Plat Book/Page		Drainage	
Subdivision		Flood Hazard	
Lot		Zoning	
Block		Electric	No
Acres	0.00	Water	No
Front	0	Gas	No
Depth	0	Sewer	No
Lot Size	0x0	Road	No
Lot Sq Ft	0	Sidewalks	
Shape		Information Source	

Improvement Information

Building Number	1	Kitchens	0
Description	BRIDGE CREW GARAGE	Dining Rooms	0
Residence Type		Living Rooms	0
Comm Type		Family Rooms	0
Mobile Home Type		Bedrooms	0
Year Built	2004	Full Baths	0
Effective Age	0	Half Baths	0
Ave. Wall Height	0	Other Rooms	0
Structure		Total Rooms	0
Number of Stories	1	Living Sq Ft	0
Exterior		Fireplaces/Water	0/0
Foundation		Supplemental Heat	
Construction Type	Wood Frame	Mobile Home Model	
Construction Quality		Mobile Home Manufacturer	
Building Condition	Very Good/Excellent	MH Skirt Foundation	
Roof Type		Heat	No
Roof Cover		Heat Source	
Roof Pitch		Heat Type	
Basement Type		Air Conditioning	No
Basement Finish		AC/Type	
Basement Size		Special Improvements	No
Basement Sq Ft	0	Fire Alarm	No
Garage/Carport		Sprinklers	No
Garage Size		Porch/Deck	
Garage Type		Porch Sq Ft	0
Garage Exterior		Deck Sq Ft	0
Width	100	Concrete Sq Ft	0
Length	40	Farm Bldg Type	
Garage Sq Ft	0	Value	\$120,000.00
Pool		Driveway	
Pool Size	0	Fence	0
Tennis Courts			

Building Number	2	Kitchens	0
Description	SALT STORAGE	Dining Rooms	0
Residence Type		Living Rooms	0
Comm Type		Family Rooms	0
Mobile Home Type		Bedrooms	0
Year Built	2004	Full Baths	0
Effective Age	0	Half Baths	0
Ave. Wall Height	0	Other Rooms	0
Structure		Total Rooms	0
Number of Stories	1	Living Sq Ft	0
Exterior		Fireplaces/Water	0/0
Foundation		Supplemental Heat	
Construction Type		Mobile Home Model	
Construction Quality		Mobile Home Manufacturer	
Building Condition		MH Skirt Foundation	
Roof Type		Heat	No
Roof Cover		Heat Source	
Roof Pitch		Heat Type	
Basement Type		Air Conditioning	No
Basement Finish		AC/Type	
Basement Size		Special Improvements	No
Basement Sq Ft	0	Fire Alarm	No
Garage/Carport		Sprinklers	No
Garage Size		Porch/Deck	
Garage Type		Porch Sq Ft	0
Garage Exterior		Deck Sq Ft	0
Width	0	Concrete Sq Ft	0
Length	0	Farm Bldg Type	
Garage Sq Ft	0	Value	\$25,000.00
Pool		Driveway	
Pool Size	0	Fence	0
Tennis Courts			

Building Number	3	Kitchens	0
Description	DEPT OF TRANSP BLDG	Dining Rooms	0
Residence Type		Living Rooms	0
Comm Type		Family Rooms	0
Mobile Home Type		Bedrooms	0
Year Built	1978	Full Baths	0
Effective Age	0	Half Baths	0
Ave. Wall Height	0	Other Rooms	0
Structure		Total Rooms	0
Number of Stories	0	Living Sq Ft	0
Exterior		Fireplaces/Water	0/0
Foundation		Supplemental Heat	
Construction Type		Mobile Home Model	
Construction Quality		Mobile Home Manufacturer	
Building Condition		MH Skirt Foundation	
Roof Type		Heat	No
Roof Cover		Heat Source	
Roof Pitch		Heat Type	
Basement Type		Air Conditioning	No
Basement Finish		AC/Type	
Basement Size		Special Improvements	No
Basement Sq Ft	0	Fire Alarm	No
Garage/Carport		Sprinklers	No
Garage Size		Porch/Deck	
Garage Type		Porch Sq Ft	0
Garage Exterior		Deck Sq Ft	0
Width	0	Concrete Sq Ft	0
Length	0	Farm Bldg Type	
Garage Sq Ft	0	Value	\$200,000.00
Pool		Driveway	
Pool Size	0	Fence	0
Tennis Courts			

Building Number	4	Kitchens	0
Description	SHED	Dining Rooms	0
Residence Type		Living Rooms	0
Comm Type		Family Rooms	0
Mobile Home Type		Bedrooms	0
Year Built	0	Full Baths	0
Effective Age	0	Half Baths	0
Ave. Wall Height	0	Other Rooms	0
Structure		Total Rooms	0
Number of Stories	0	Living Sq Ft	0
Exterior		Fireplaces/Water	0/0
Foundation		Supplemental Heat	
Construction Type		Mobile Home Model	
Construction Quality		Mobile Home Manufacturer	
Building Condition		MH Skirt Foundation	
Roof Type		Heat	No
Roof Cover		Heat Source	
Roof Pitch		Heat Type	
Basement Type		Air Conditioning	No
Basement Finish		AC/Type	
Basement Size		Special Improvements	No
Basement Sq Ft	0	Fire Alarm	No
Garage/Carport		Sprinklers	No
Garage Size		Porch/Deck	
Garage Type		Porch Sq Ft	0
Garage Exterior		Deck Sq Ft	0
Width	0	Concrete Sq Ft	0
Length	0	Farm Bldg Type	
Garage Sq Ft	0	Value	\$4,000.00
Pool		Driveway	
Pool Size	0	Fence	0
Tennis Courts			

Building Number	5	Kitchens	0
Description	STATE GARAGE MAINTENANCE	Dining Rooms	0
Residence Type		Living Rooms	0
Comm Type		Family Rooms	0
Mobile Home Type		Bedrooms	0
Year Built	1979	Full Baths	0
Effective Age	0	Half Baths	0
Ave. Wall Height	0	Other Rooms	0
Structure		Total Rooms	0
Number of Stories	0	Living Sq Ft	0
Exterior		Fireplaces/Water	0/0
Foundation		Supplemental Heat	
Construction Type		Mobile Home Model	
Construction Quality		Mobile Home Manufacturer	
Building Condition		MH Skirt Foundation	
Roof Type		Heat	No
Roof Cover		Heat Source	
Roof Pitch		Heat Type	
Basement Type		Air Conditioning	No
Basement Finish		AC/Type	
Basement Size		Special Improvements	No
Basement Sq Ft	0	Fire Alarm	No
Garage/Carport		Sprinklers	No
Garage Size		Porch/Deck	
Garage Type		Porch Sq Ft	0
Garage Exterior		Deck Sq Ft	0
Width	0	Concrete Sq Ft	0
Length	0	Farm Bldg Type	
Garage Sq Ft	0	Value	\$50,000.00
Pool		Driveway	
Pool Size	0	Fence	0
Tennis Courts			

Building Number	6	Kitchens	0
Description	EQUIPMENT SHED	Dining Rooms	0
Residence Type		Living Rooms	0
Comm Type		Family Rooms	0
Mobile Home Type		Bedrooms	0
Year Built	2015	Full Baths	0
Effective Age	0	Half Baths	0
Ave. Wall Height	0	Other Rooms	0
Structure		Total Rooms	0
Number of Stories	0	Living Sq Ft	0
Exterior		Fireplaces/Water	0/0
Foundation		Supplemental Heat	
Construction Type		Mobile Home Model	
Construction Quality		Mobile Home Manufacturer	
Building Condition		MH Skirt Foundation	
Roof Type		Heat	No
Roof Cover		Heat Source	
Roof Pitch		Heat Type	
Basement Type		Air Conditioning	No
Basement Finish		AC/Type	
Basement Size		Special Improvements	No
Basement Sq Ft	0	Fire Alarm	No
Garage/Carport		Sprinklers	No
Garage Size		Porch/Deck	
Garage Type		Porch Sq Ft	0
Garage Exterior		Deck Sq Ft	0
Width	0	Concrete Sq Ft	0
Length	0	Farm Bldg Type	
Garage Sq Ft	0	Value	\$15,000.00
Pool		Driveway	
Pool Size	0	Fence	0
Tennis Courts			

Sales/Transfer Info

[Click Here for Sales/Transfer Information](#)

Valuation

	2024 Working	2023 Certified	2022 Certified	2021 Certified	2020 Certified	2019 Certified
+ Land Value	\$58,000	\$58,000	\$58,000	\$58,000	\$58,000	\$58,000
+ Improvement Value	\$414,000	\$414,000	\$414,000	\$414,000	\$414,000	\$414,000
+ Ag Improvement Value	\$0	\$0	\$0	\$0	\$0	\$0
= Total Taxable Value	\$472,000	\$472,000	\$472,000	\$472,000	\$472,000	\$472,000
- Exemption Value	\$0	\$0	\$0	\$0	\$0	\$0
= Net Taxable Value	\$472,000	\$472,000	\$472,000	\$472,000	\$472,000	\$472,000
<hr/>						
+ Land FCV	\$0	\$0	\$0	\$0	\$0	\$0
+ Improvement FCV	\$0	\$0	\$0	\$0	\$0	\$0
+ Ag Improvement FCV	\$0	\$0	\$0	\$0	\$0	\$0
= Total FCV	\$0	\$0	\$0	\$0	\$0	\$0
<hr/>						
Exemption						
Farm Acres	0.00	0.00	0.00	0.00	0.00	0.00
Fire Protection Acres	0.00	0.00	0.00	0.00	0.00	0.00

Tax Bill Search

[Click Here for Tax Information](#)

Sketches

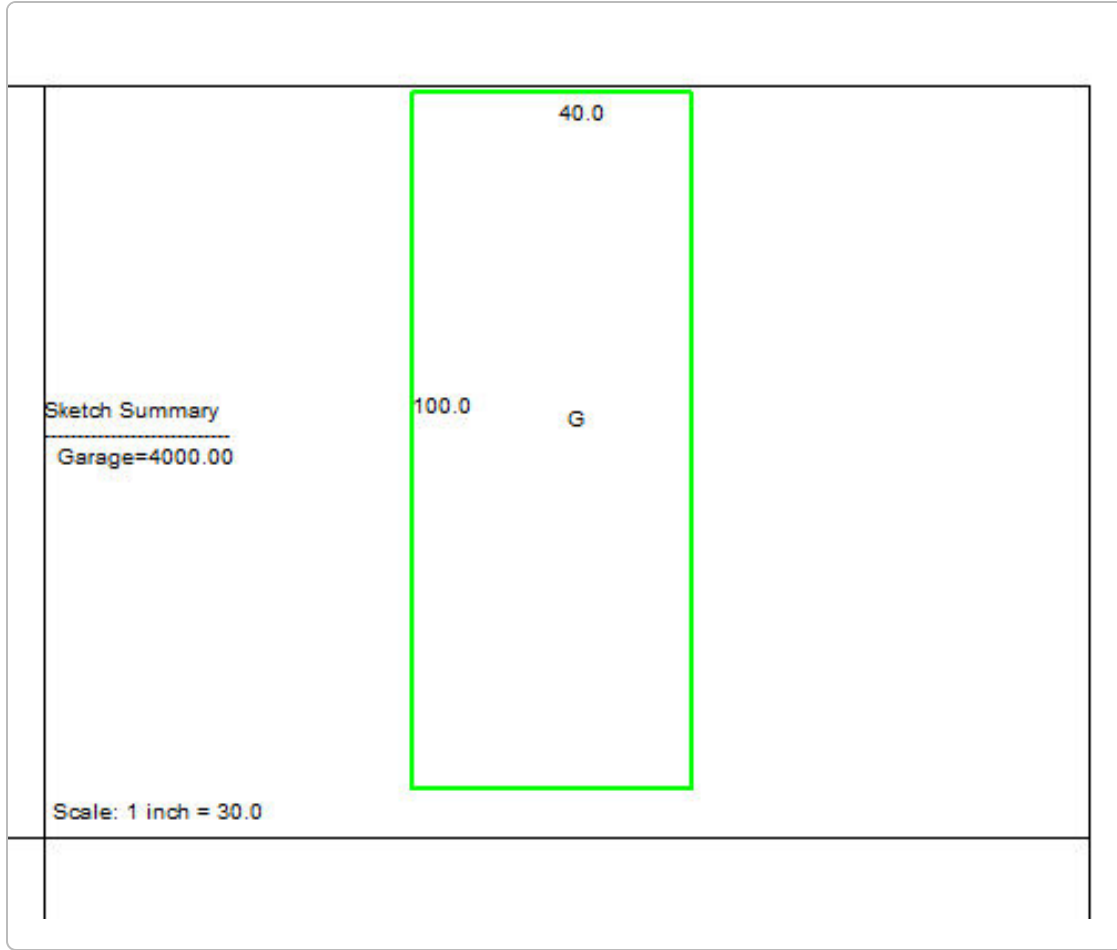

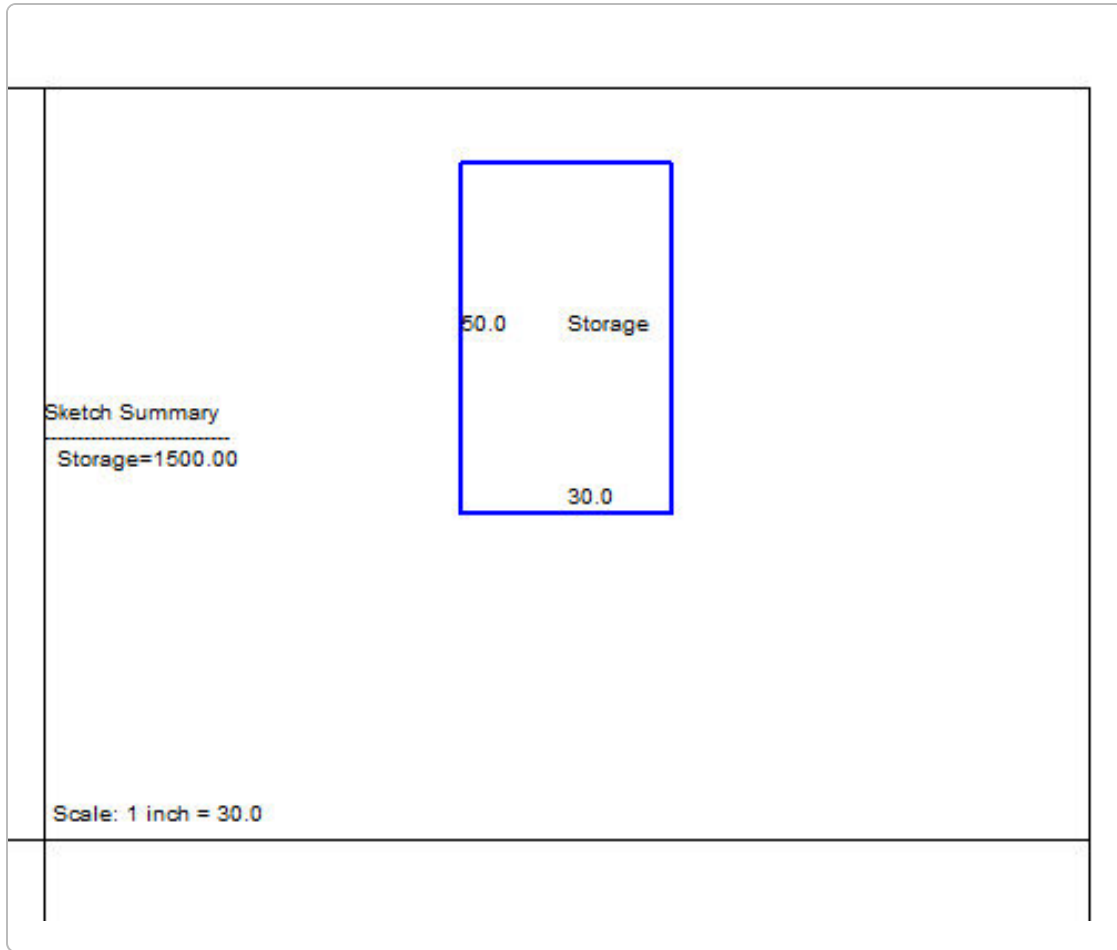

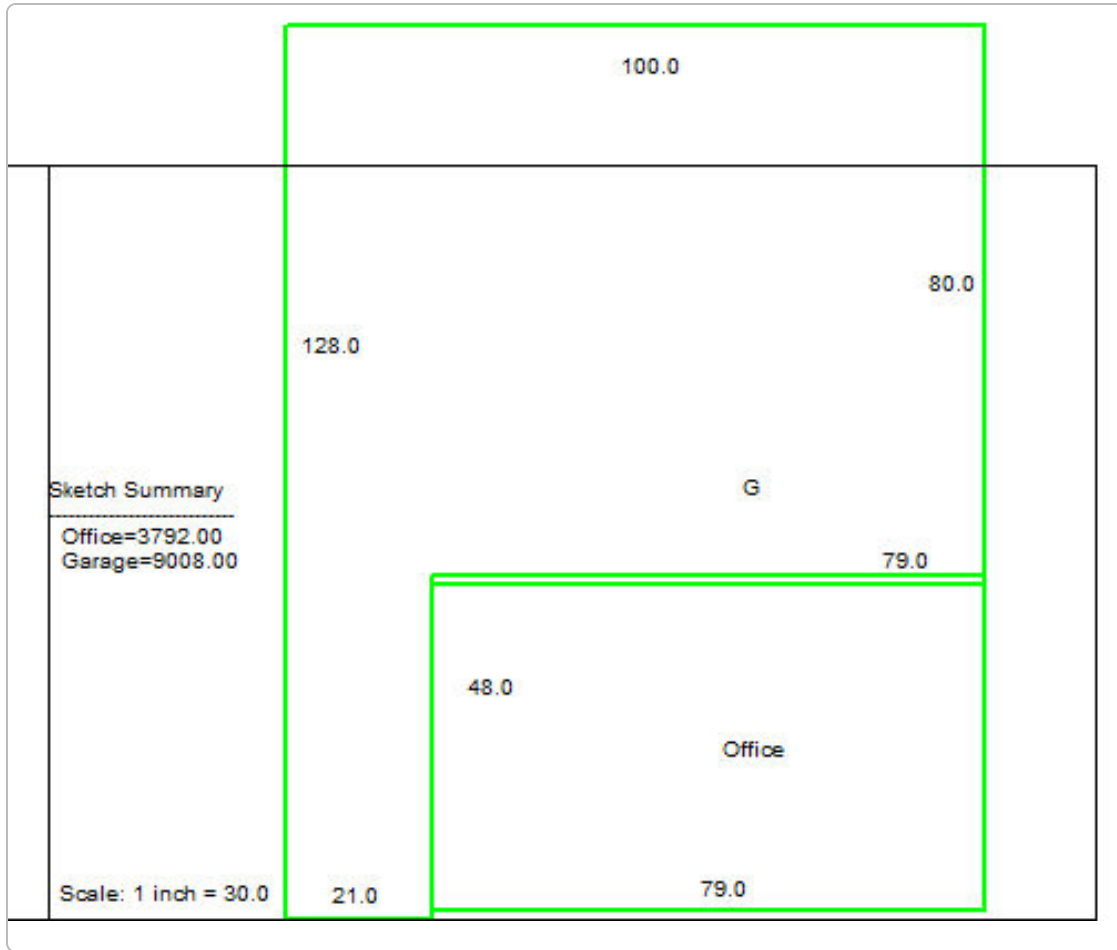

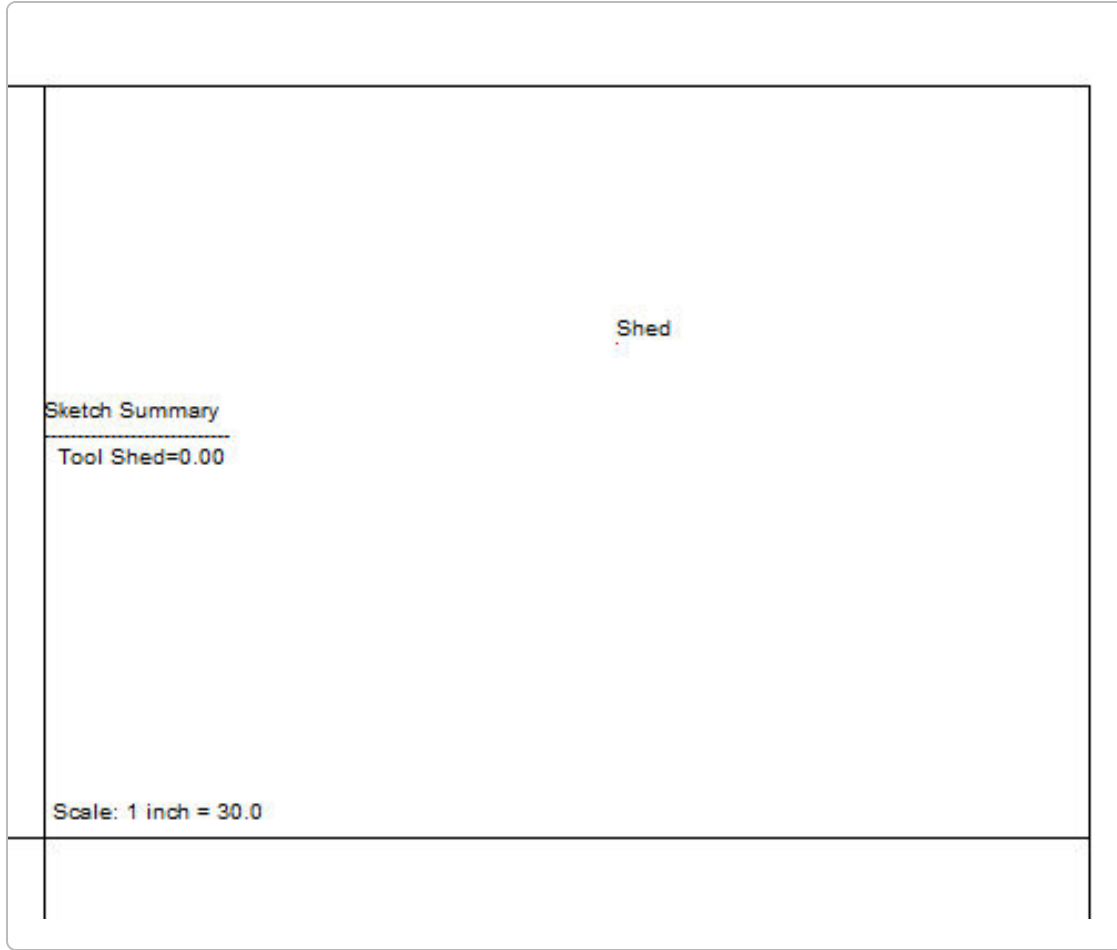

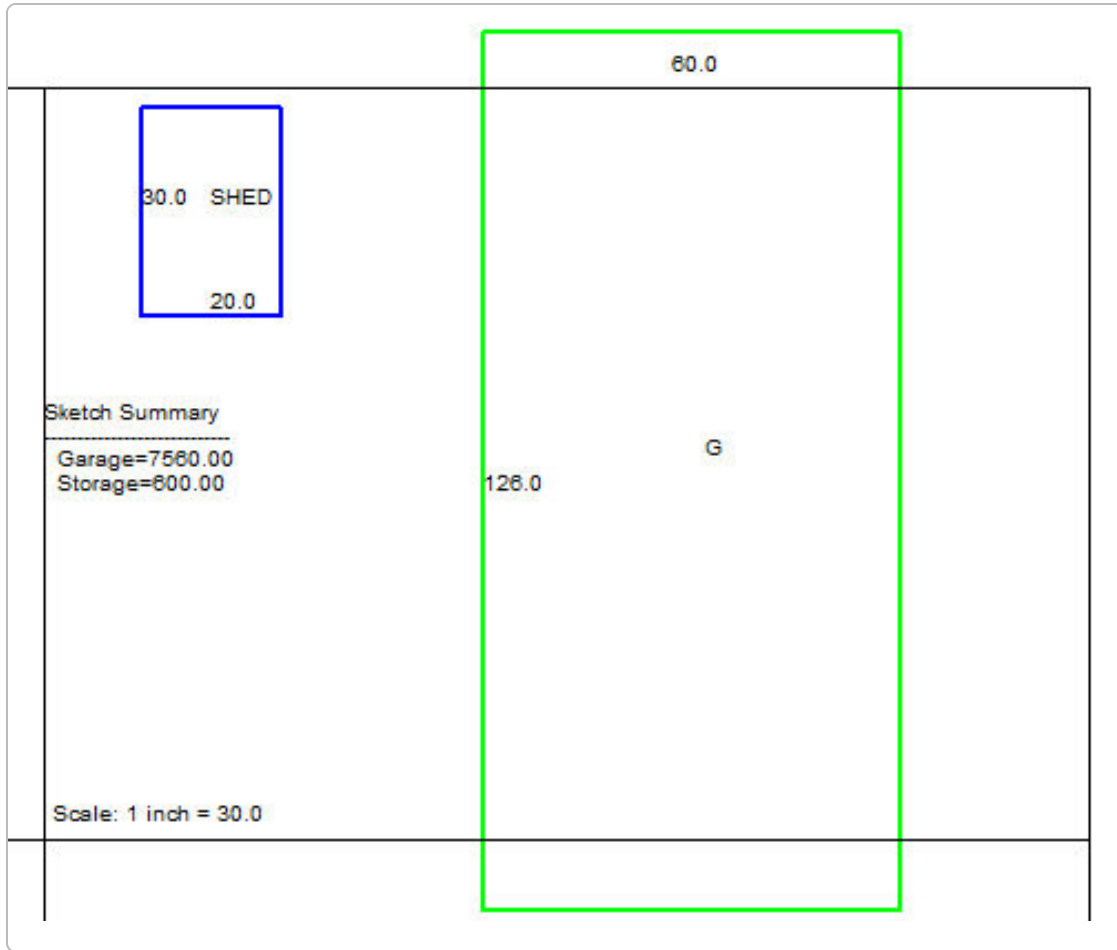



Photos





Recent Sales in Area

Sale date range:

From: To:

No data available for the following modules: Sales, Taxes.

Under Kentucky State Law, KRS 171.410, these records are public information and may appear on the Internet. If you believe any data is inaccurate, or if you have any comments about our site, we would like to hear from you. Comments may be made by telephone at (270) 928-2524. We do our best to ensure that all of our data is accurate, but the PVA does not assume any liability associated with the use or misuse of this data.
[| User Privacy Policy](#) | [GDPR Privacy Notice](#)
[Last Data Upload: 9/10/2024, 5:29:38 PM](#)

[Contact Us](#)

