

PLOTTED: 9/16/2024 1:26 PM BY EDURHAM
 FILE LOCATION: U:\OTHER\KYM\2024 RICE GEN STATION\MADISONVILLE\CAD\KYM\KSC\6.DWG

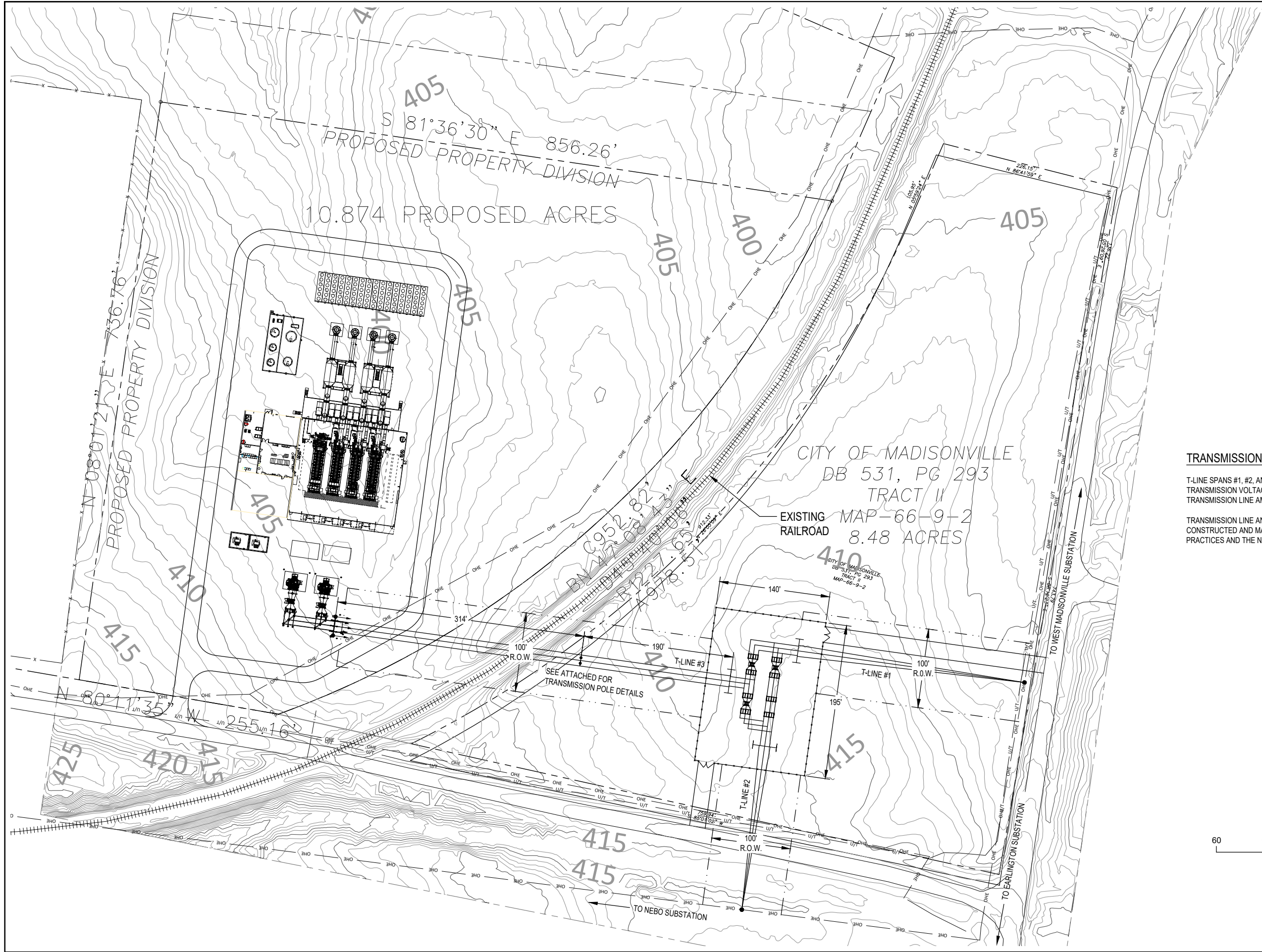

TRANSMISSION NOTES:

T-LINE SPANS #1, #2, AND #3 CONDUCTOR: 954 AAC
 TRANSMISSION VOLTAGE: 69KV NOMINAL
 TRANSMISSION LINE AMPACITY: 900 AMPS

TRANSMISSION LINE AND APPURTENANCES WILL BE
 CONSTRUCTED AND MAINTAINED WITH ACCEPTED ENGINEERING
 PRACTICES AND THE NATIONAL ELECTRICAL SAFETY CODE.

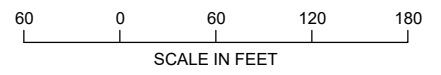

 850 CENTER WAY, NORCROSS, GEORGIA 30071 (770) 453-1410 pdengineers.com ENGINEERS - SURVEYORS	
DATE	9-12-24
SCALE	NONE
DRAWING NO.	KYKYMRCCK6
REV.	B
KENTUCKY MUNICIPAL ELECTRIC AGENCY MADISONVILLE, KENTUCKY RICE GENERATION STATION - MADISONVILLE SITE LAYOUT	
REVISION	
BY	
DATE	
DESIGNED BY	PAH
DRAWN BY	EED
CHECKED BY	PAH
ISSUED FOR PERMIT	PAH
ISSUED FOR REVIEW	PAH