

**COMMONWEALTH OF KENTUCKY
BEFORE THE PUBLIC SERVICE COMMISSION**

In the Matter of:

THE APPLICATION OF)
NEW CINGULAR WIRELESS PCS, LLC,)
A DELAWARE LIMITED LIABILITY COMPANY,)
D/B/A AT&T MOBILITY)
AND HARMONI TOWERS LLC, A DELAWARE)
LIMITED LIABILITY COMPANY)
FOR ISSUANCE OF A CERTIFICATE OF PUBLIC) CASE NO.: 2022-00027
CONVENIENCE AND NECESSITY TO CONSTRUCT)
A WIRELESS COMMUNICATIONS FACILITY)
IN THE COMMONWEALTH OF KENTUCKY)
IN THE COUNTY OF RUSSELL)

SITE NAME: CLIFTY CREEK ROAD

* * * * *

APPLICANTS' RESPONSE
TO COMMISSION STAFF'S DATA REQUEST

New Cingular Wireless PCS, LLC, a Delaware limited liability company, d/b/a AT&T Mobility (“AT&T”) and Harmoni Towers LLC, a Delaware limited liability company (“Harmoni”) (collectively “Applicants”), by counsel, make this Response to the Kentucky Public Service Commission Staff’s (“Commission Staff”) First Request for Information to New Cingular Wireless PCS, LLC d/b/a AT&T Mobility and Harmoni Towers LLC dated June 6, 2023 (“Data Request”). Applicants respectfully state, as follows:

Question 1: Refer to KRS 278.665(2) and 807 KAR 5:063, Section 1(1)(l)(1). Also refer to the Application filed on January 26, 2022. Provide all documentation, including the original documents obtained from the Russell County Property Valuation Administration (PVA), that Joint Applicants relied upon to create the list of adjacent

property owners entitled to notification.

1. Copies of the PVA records obtained from the Russell County PVA and relied upon to create the list of adjacent property owners entitled to notification are attached as **Exhibit J-1**.

Question 2: Refer to KRS 278.665(2) and 807 KAR 5:063, Section 1(1)(l)(1). Also refer to the Application filed on January 26, 2022. For each of the adjoining property owners to whom notice was sent by certified mail, return receipt requested, provide a copy of all signed United States Postal Service Forms 3811, otherwise known as “signed green cards,” or a copy of the notice that was returned to Joint Applicants as undelivered. This is a continuing request and should be updated in a supplemental filing until all signed green cards and undelivered notices are returned to Joint Applicants.

2. The signed United States Postal Service Forms 3811, otherwise known as “signed green cards” or a copy of the notice that was returned undelivered is attached as **Exhibit J-2**.

3. An Affidavit of Certification signed by the attorney supervising the preparation of the response on behalf of Applicants’ certifying that the response is true and accurate to the best of that person’s knowledge, information, and belief formed after a reasonable inquiry is included as **Exhibit 1**.

WHEREFORE, there being no ground for denial of the subject application and substantial evidence in support of the requested CPCN, Applicants respectfully request the Kentucky Public Service Commission:

- (a) Accept this Response for filing;
- (b) Issue a Certificate of Public Convenience and Necessity to construct and operate the WCF at the location set forth herein without further delay; and
- (c) Grant Applicants any other relief to which they are entitled.

Respectfully submitted,



David A. Pike
and

F. Keith Brown

F. Keith Brown
Pike Legal Group, PLLC
1578 Highway 44 East, Suite 6
P. O. Box 369
Shepherdsville, KY 40165-0369
Telephone: (502) 955-4400
Telefax: (502) 543-4410
Email: dpike@pikelegal.com
Attorneys for Applicants

LIST OF EXHIBITS

- 1 - Affidavit of Certification
- J-1 - PVA Records
- J-2 - Signed or Returned Green Cards

EXHIBIT 1
AFFIDAVIT OF CERTIFICATION

**AFFIDAVIT OF CERTIFICATION
COMMONWEALTH OF KENTUCKY
PUBLIC SERVICE COMMISSION**

I, F. Keith Brown attorney for New Cingular Wireless PCS, LLC, a Delaware limited liability company, d/b/a AT&T Mobility and Harmoni Towers LLC, a Delaware limited liability company (“Applicants”), do hereby certify that I am the person supervising the preparation of the Response to Commission Staff’s Data Request on behalf of Applicants and that this response is true and accurate to the best of my knowledge, information, and belief formed after a reasonable inquiry.

Further the affiant sayeth naught.

Affiant:

J. Keith Brown

Date: June 23 2023

State of Kentucky)

County of Bullitt)

AFFIANT ACKNOWLEDGEMENT

On this, the 23 day of June 2023 before me, the subscriber, a Notary Public in and for the above state, personally appeared to me F. Keith Brown and in due form of law, acknowledged, subscribed, and swore that he executed this instrument as his voluntary act and deed.

In testimony whereof, I have hereunto set my hand and affixed my seal in said County and State on the day and year last above written.

My commission expires on: December 4, 2024



[Signature]
Notary Public, State at Large
KYNP19462

**EXHIBIT J-1
PVA RECORDS**



Parcel Summary

Map Number 036-00-00-044.00
Account Number 88291 (PID: 324960 PTID: 172254)
Location Address 570 CLIFTY CREEK RD.
Tax District 00
Property Class FARM
Description 36-44 (6.99 ACRES)
Acres 6.99
Deed Information 294/636

View Map

Owner Information

Current Owner
MANN PAULA
570 CLIFTY CREEK RD.
JAMESTOWN, KY 42629

MANN PAULA GLOVER
570 CLIFTY CREEK RD.
JAMESTOWN, KY 42629

Land Information

Table with 9 columns: Lot Size, Lot Frontage, Lot Depth, Acreage, Street Type, Driveway, Neighborhood Type, Site Condition, Land Value. Row 1: 0.00, 0.00, 6.99, SECONDARY, GRAVEL, TYPICAL, GOOD, \$3,900

Valuation

Table with 6 columns: Category, 2022 Working, 2021 Certified, 2020 Certified, 2019 Certified, 2018 Certified. Rows: Homestead, RES, FRM_FCV, FRM_TXV

Mobile Home Information

Table with 9 columns: Manufacturer, Model, Year Built, Exterior, Sqft, Width (ft), Length (ft), Pool, Value. Row 1: 1998, OTHER, 700, 14, 50, 2000

Residential Improvement Information

Table with 2 columns: Property Feature, Value. Rows: Building, Residence Type, Year Built, Foundation, Basement, Exterior, Bedrooms, Full Bath, Half Bath, Roof Cover, Roof Type, Residence Condition, Fireplaces, Heat, AC, Total Rooms, Value, Living Sqft, Basement Sqft, Garage Sqft, Porch Sqft, Patio/Deck Sqft, Basement Finish, Structure, Garage, Pool

Sales Information

Table with 6 columns: Sale Date, Sale Price, Deed Book, Deed Page, Previous Owner, Sale Type. Row 1: \$2,000, GWENDOLYN GLOVER

Historical PRC

- Property Record Card-1 (PDF)
Property Record Card-2 (PDF)

Recent Sales In Area

Sale date range:

From:

01/24/2019

To:

01/24/2022

Sales by Neighborhood

Sales by Subdivision

1500

Feet ▼

Sales by Distance

No data available for the following modules: Commercial Improvement Information, Photos, Sketches.

This is an information system. Information contained herein is not warranted to be correct or complete. The filing office by the furnishing of this information makes no representation whatsoever. Neither the filing officer nor any employee of the filing officer shall be personally liable for any damages which may arise due to information furnished pursuant to this section which is subsequently shown to be inaccurate or incomplete. Any party obtaining information from this system shall be on noti

[User Privacy Policy](#)
[GDPR Privacy Notice](#)



Last Data Upload: [1/21/2022, 6:24:20 PM](#)

Version 2.3.172

Parcel Summary

Map Number 036-00-00-044.02
 Account Number 88293 (PID: 324962 PTID: 172256)
 Location Address 570 CLIFTY CREEK RD
 Tax District 00
 Property Class FARM
 Description 36-44 (10.96 ACRES & HOUSE)
 Acres 10.96
 Deed Information 293/369

[View Map](#)



Owner Information

Current Owner
 MANN PAULA GLOVER
 570 CLIFTY CREEK RD.
 JAMESTOWN, KY 42629

Land Information

Lot Size	Lot Frontage	Lot Depth	Acreage	Street Type	Driveway	Neighborhood Type	Site Condition	Land Value
			10.96	SECONDARY	ASPHALT	TYPICAL	AVERAGE	\$4,700

Valuation

	2022 Working	2021 Certified	2020 Certified	2019 Certified	2018 Certified
Homestead	N	N	N	N	N
FRM_FCV	\$109,750	\$109,750	\$109,750	\$109,750	\$109,750
FRM_TXV	\$81,700	\$81,700	\$81,700	\$81,700	\$81,700
FRM_RES	\$77,000	\$77,000	\$77,000	\$77,000	\$77,000

Residential Improvement Information

Building	1	Heat	HEAT PUMP
Residence Type	SINGLE FAMILY	AC	CENTRAL
Year Built	0	Total Rooms	0
Foundation	CONCRETE BLOCK	Value	\$77,000
Basement	WALKOUT	Living Sqft	1,988
Exterior	BRICK VENEER	Basement Sqft	1,568
Bedrooms	3	Garage Sqft	0
Full Bath	2	Porch Sqft	156
Half Bath	0	Patio/Deck Sqft	364
Roof Cover	METAL	Basement Finish	
Roof Type	GABLE	Structure	1 STORY
Residence Condition	GOOD	Garage	NONE
Fireplaces		Pool	

Sales Information

Sale Date	Sale Price	Deed Book	Deed Page	Previous Owner	Sale Type
11/21/2012	\$109,750	293	369	RONALD & PAULA MANN	

Historical PRC

[Property Record Card \(PDF\)](#)

Photos



Sketches

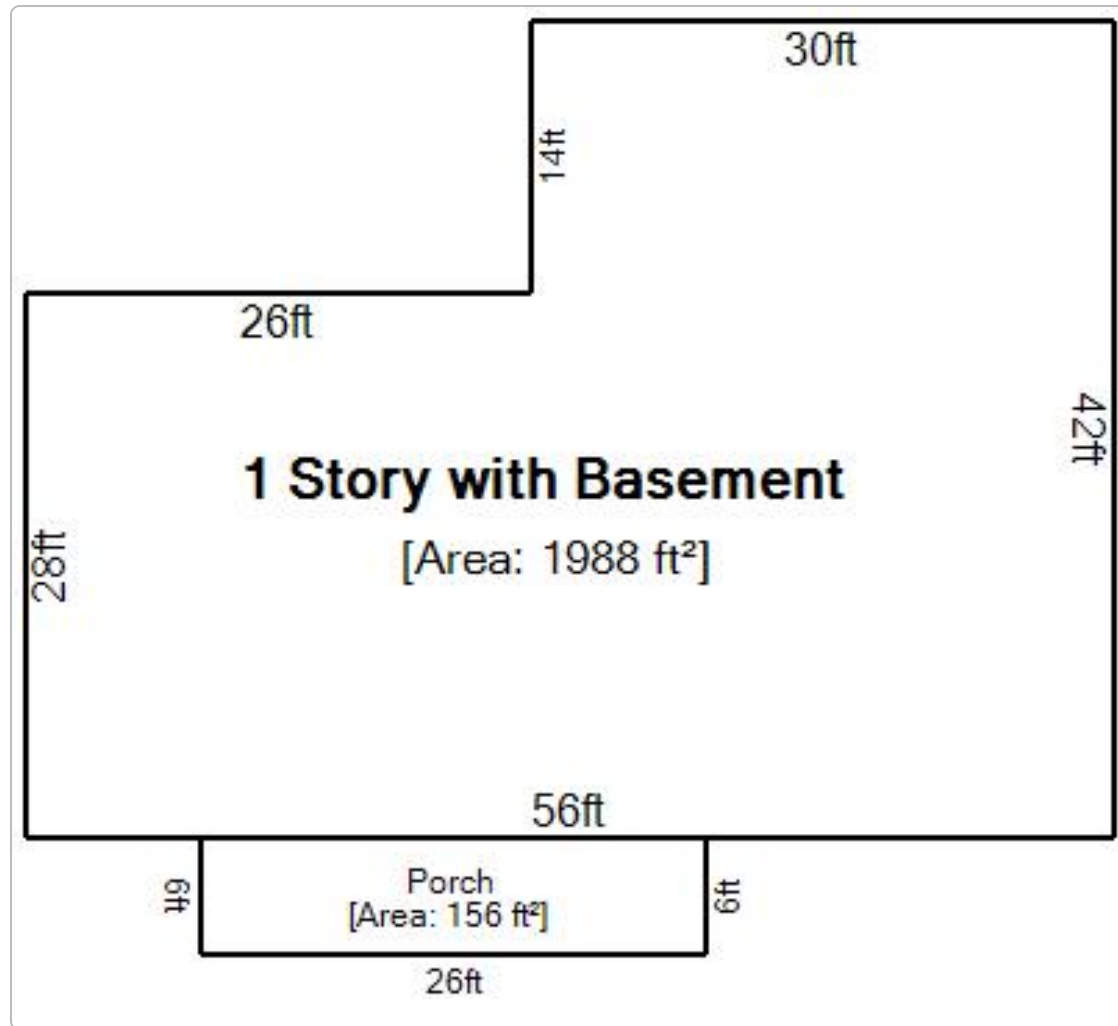

Recent Sales In Area

Sale date range:

From:

01/24/2019

To:

01/24/2022

Sales by Neighborhood

Sales by Subdivision

1500

Feet



Sales by Distance

No data available for the following modules: Commercial Improvement Information, Mobile Home Information.

This is an information system. Information contained herein is not warranted to be correct or complete. The filing office by the furnishing of this information makes no representation whatsoever. Neither the filing officer nor any employee of the filing officer shall be personally liable for any damages which may arise due to information furnished pursuant to this section which is subsequently shown to be inaccurate or incomplete. Any party obtaining information from this system shall be on noti

[User Privacy Policy](#)
[GDPR Privacy Notice](#)



Last Data Upload: [1/21/2022, 6:24:20 PM](#)

Version 2.3.172

Parcel Summary

Map Number 036-00-00-044.01
Account Number 92153 (PID: 327482 PTID: 175482)
Location Address 653 CLIFTY CREEK RD.
Tax District 00
Property Class FARM
Description 36-44.01 (51.64 ACRES)
Acres 51.64
Deed Information 274/100

[View Map](#)



Owner Information

Current Owner
 SELBY SHERRY GRIDER & BRANDON
 336 COLSON DR
 RUSSELL SPRINGS, KY 42642

Land Information

Lot Size	Lot Frontage	Lot Depth	Acreage	Street Type	Driveway	Neighborhood Type	Site Condition	Land Value
			51.64	SECONDARY		TYPICAL	GOOD	\$20,700

Valuation

	2022 Working	2021 Certified	2020 Certified	2019 Certified	2018 Certified
Homestead	N	N	N	N	N
FRM_FCV	\$150,000	\$150,000	\$150,000	\$150,000	\$150,000
FRM_TXV	\$20,700	\$20,700	\$20,700	\$20,700	\$20,700
FRM_AC	\$51	\$51	\$51	\$51	\$51
FIRE_AC	\$11	\$11	\$11	\$11	\$11

Sales Information

Sale Date	Sale Price	Deed Book	Deed Page	Previous Owner	Sale Type
11/02/2009	\$150,000	274	100	GRIDER BILLY FRANK	

Historical PRC

[Property Record Card \(PDF\)](#)

Photos



Recent Sales In Area

Sale date range:

From:

01/24/2019

To:

01/24/2022

Sales by Neighborhood

Sales by Subdivision

1500

Feet



Sales by Distance

No data available for the following modules: Commercial Improvement Information, Mobile Home Information, Residential Improvement Information, Sketches.

This is an information system. Information contained herein is not warranted to be correct or complete. The filing office by the furnishing of this information makes no representation whatsoever. Neither the filing officer nor any employee of the filing officer shall be personally liable for any damages which may arise due to information furnished pursuant to this section which is subsequently shown to be inaccurate or incomplete. Any party obtaining information from this system shall be on noti

[User Privacy Policy](#)
[GDPR Privacy Notice](#)



Last Data Upload: [1/21/2022, 6:24:20 PM](#)

Version 2.3.172

Parcel Summary

Map Number 036-00-00-048.01
 Account Number 91549 (PID: 327079 PTID: 174985)
 Location Address CLIFTY CREEK RD.
 Tax District 00
 Property Class RESIDENTIAL
 Description 36-48.01 (1.08 ACRES & 1994 MOBILE HOME)
 Acres 1.08
 Deed Information 257/483

[View Map](#)



Owner Information

Current Owner
 ROUSE DIANA & OTHERS
 12260 DONCASTER CT.
 FISHERS, IN 46038

Land Information

Lot Size	Lot Frontage	Lot Depth	Acreage	Street Type	Driveway	Neighborhood Type	Site Condition	Land Value
	0.00	0.00	1.08	SECONDARY	GRAVEL	TYPICAL	AVERAGE	\$6,500

Valuation

	2022 Working	2021 Certified	2020 Certified	2019 Certified	2018 Certified
Homestead	N	N	N	N	N
RES	\$12,000	\$12,000	\$12,000	\$12,000	\$12,000

Mobile Home Information

Manufacturer	Model	Year Built	Exterior	Sqft	Width (ft)	Length (ft)	Pool	Value
		1994	OTHER	840	14	60		5500

Sales Information

Sale Date	Sale Price	Deed Book	Deed Page	Previous Owner	Sale Type
08/01/2007	\$9,500	257	483	GLOVER DALLAS M. & SARAH J.	
08/01/1994	\$2,000			ORDIS & MARY GLOVE	

Historical PRC

[Property Record Card \(PDF\)](#)

Photos



Sketches

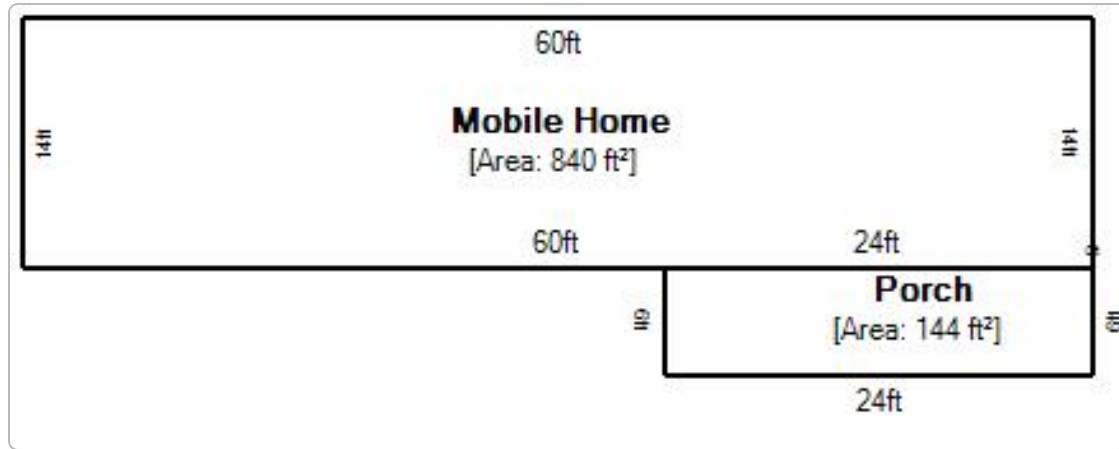

Recent Sales In Area

Sale date range:

From:

01/24/2019

To:

01/24/2022

Sales by Neighborhood

Sales by Subdivision

1500

Feet



Sales by Distance

No data available for the following modules: Commercial Improvement Information, Residential Improvement Information.

This is an information system. Information contained herein is not warranted to be correct or complete. The filing office by the furnishing of this information makes no representation whatsoever. Neither the filing officer nor any employee of the filing officer shall be personally liable for any damages which may arise due to information furnished pursuant to this section which is subsequently shown to be inaccurate or incomplete. Any party obtaining information from this system shall be on not

[User Privacy Policy](#)
[GDPR Privacy Notice](#)

Last Data Upload: 1/21/2022, 6:24:20 PM



Version 2.3.172

qPublic.net™ Russell County, KY PVA

Parcel Summary

Map Number 025-00-00-059.01
Account Number 87603 (PID: 324513 PTID: 171674)
Location Address 510 CLIFTY CREEK RD
Tax District 00
Property Class FARM
Description 25-59.01 (1.8 ACRES)
Acres 1.8
Deed Information 125/298

[View Map](#)



Owner Information

Current Owner
 LAWLESS ROY ROGERS & MARY ALICE &
 LAWLESS JOSHUA RYAN
 435 YORK RD
 JAMESTOWN KY 42629

Land Information

Lot Size	Lot Frontage	Lot Depth	Acreage	Street Type	Driveway	Neighborhood Type	Site Condition	Land Value
			1.80	SECONDARY		TYPICAL	AVERAGE	\$800

Valuation

	2022 Working	2021 Certified	2020 Certified	2019 Certified	2018 Certified
Homestead	N	N	N	N	N
FRM_FCV	\$6,000	\$6,000	\$6,000	\$6,000	\$6,000
FRM_TXV	\$800	\$800	\$800	\$800	\$800

Sales Information

Sale Date	Sale Price	Deed Book	Deed Page	Previous Owner	Sale Type
01/01/1991		125	298	ELMER LAWLESS	

Historical PRC

[Property Record Card \(PDF\)](#)

Photos



Recent Sales In Area

Sale date range:

From:

01/24/2019

To:

01/24/2022

Sales by Neighborhood

Sales by Subdivision

1500

Feet ▼

Sales by Distance

No data available for the following modules: Commercial Improvement Information, Mobile Home Information, Residential Improvement Information, Sketches.

This is an information system. Information contained herein is not warranted to be correct or complete. The filing office by the furnishing of this information makes no representation whatsoever. Neither the filing officer nor any employee of the filing officer shall be personally liable for any damages which may arise due to information furnished pursuant to this section which is subsequently shown to be inaccurate or incomplete. Any party obtaining information from this system shall be on noti

[User Privacy Policy](#)
[GDPR Privacy Notice](#)



[Last Data Upload: 1/21/2022, 6:24:20 PM](#)

Version 2.3.172

Parcel Summary

Map Number 025-00-00-059.00
 Account Number 87604 (PID: 324514 PTID: 171675)
 Location Address 406 CLIFTY CREEK RD
 Tax District 00
 Property Class FARM
 Description 25-59 (54.2 ACRES & HOUSE)
 Acres 54.2
 Deed Information 278/096

[View Map](#)



Owner Information

Current Owner
 LAWLESS ROY, MARY ALICE & JOSHUA RYAN &
 MCGAHA LINDA & JIMMY
 435 YORK RD
 JAMESTOWN KY 42629

Land Information

Lot Size	Lot Frontage	Lot Depth	Acreage	Street Type	Driveway	Neighborhood Type	Site Condition	Land Value
	0.00	0.00	54.20	SECONDARY	GRAVEL	TYPICAL	AVERAGE	\$19,600

Valuation

	2022 Working	2021 Certified	2020 Certified	2019 Certified	2018 Certified
Homestead	N	N	N	N	N
FRM_FCV	\$90,000	\$90,000	\$90,000	\$90,000	\$90,000
FRM_TXV	\$29,600	\$29,600	\$29,600	\$29,600	\$29,600
FRM_RES	\$10,000	\$10,000	\$10,000	\$10,000	\$10,000
FRM_AC	\$54	\$54	\$54	\$54	\$54
FIRE_AC	\$29	\$29	\$29	\$29	\$29

Residential Improvement Information

Building	1	Heat	WOOD
Residence Type	SINGLE FAMILY	AC	
Year Built	0	Total Rooms	0
Foundation		Value	\$10,000
Basement		Living Sqft	864
Exterior	ALUMINUM/VINYL	Basement Sqft	0
Bedrooms	3	Garage Sqft	0
Full Bath	1	Porch Sqft	64
Half Bath	0	Patio/Deck Sqft	0
Roof Cover	METAL	Basement Finish	
Roof Type	GABLE	Structure	1 STORY
Residence Condition	POOR	Garage	ATTCHD1
Fireplaces	0	Pool	

Sales Information

Sale Date	Sale Price	Deed Book	Deed Page	Previous Owner	Sale Type
07/01/2010	\$31,700	278	-96	LAWLESS ROY ROGERS & MARY ALICE	
01/01/1987					
01/01/1987				LAWLESS ELMER MRS.	
01/01/1987					

Historical PRC

[Property Record Card \(PDF\)](#)

Photos



Recent Sales In Area

Sale date range:

From:

01/24/2019

To:

01/24/2022

Sales by Neighborhood

Sales by Subdivision

1500

Feet



Sales by Distance

No data available for the following modules: Commercial Improvement Information, Mobile Home Information, Sketches.

This is an information system. Information contained herein is not warranted to be correct or complete. The filing office by the furnishing of this information makes no representation whatsoever. Neither the filing officer nor any employee of the filing officer shall be personally liable for any damages which may arise due to information furnished pursuant to this section which is subsequently shown to be inaccurate or incomplete. Any party obtaining information from this system shall be on noti

[User Privacy Policy](#)
[GDPR Privacy Notice](#)

Last Data Upload: [1/21/2022, 6:24:20 PM](#)

Version 2.3.172



qPublic.net™ Russell County, KY PVA

Parcel Summary

Map Number 037-00-00-002.00
 Account Number 88572 (PID: 325116 PTID: 172481)
 Location Address 535 CLIFTY CREEK RD.
 Tax District 00
 Property Class FARM
 Description 37-02 (6 ACRES & HOUSE)
 Acres 6
 Deed Information 102/616

[View Map](#)



Owner Information

Current Owner
 MCCLURE NATHAN L. & DIANA K.
 535 CLIFTY CREEK RD.
 JAMESTOWN, KY 42629

Land Information

Lot Size	Lot Frontage	Lot Depth	Acreage	Street Type	Driveway	Neighborhood Type	Site Condition	Land Value
	0.00	0.00	6.00	SECONDARY	GRAVEL	TYPICAL	GOOD	\$2,700

Valuation

	2022 Working	2021 Certified	2020 Certified	2019 Certified	2018 Certified
Homestead	N	N	N	N	N
FRM_FCV	\$150,000	\$150,000	\$150,000	\$150,000	\$150,000
FRM_TXV	\$122,700	\$122,700	\$122,700	\$122,700	\$122,700
FRM_RES	\$120,000	\$120,000	\$120,000	\$120,000	\$120,000
FRM_AC	\$6	\$6	\$6	\$6	\$6

Residential Improvement Information

Building	1	Heat	
Residence Type	SINGLE FAMILY	AC	CENTRAL
Year Built	1999	Total Rooms	0
Foundation	POURED CONCRETE	Value	\$120,000
Basement	WALKOUT	Living Sqft	4,920
Exterior	FRAME	Basement Sqft	960
Bedrooms	4	Garage Sqft	2,000
Full Bath	2	Porch Sqft	0
Half Bath	1	Patio/Deck Sqft	3,360
Roof Cover	METAL	Basement Finish	
Roof Type	GABLE	Structure	2.5 STORY
Residence Condition	GOOD	Garage	ATTCHD1
Fireplaces	1	Pool	

Sales Information

Sale Date	Sale Price	Deed Book	Deed Page	Previous Owner	Sale Type
01/01/1985	\$6,000	102	616	KENNETH LEWIS JR.	

Historical PRC

[Property Record Card \(PDF\)](#)

Photos



Sketches

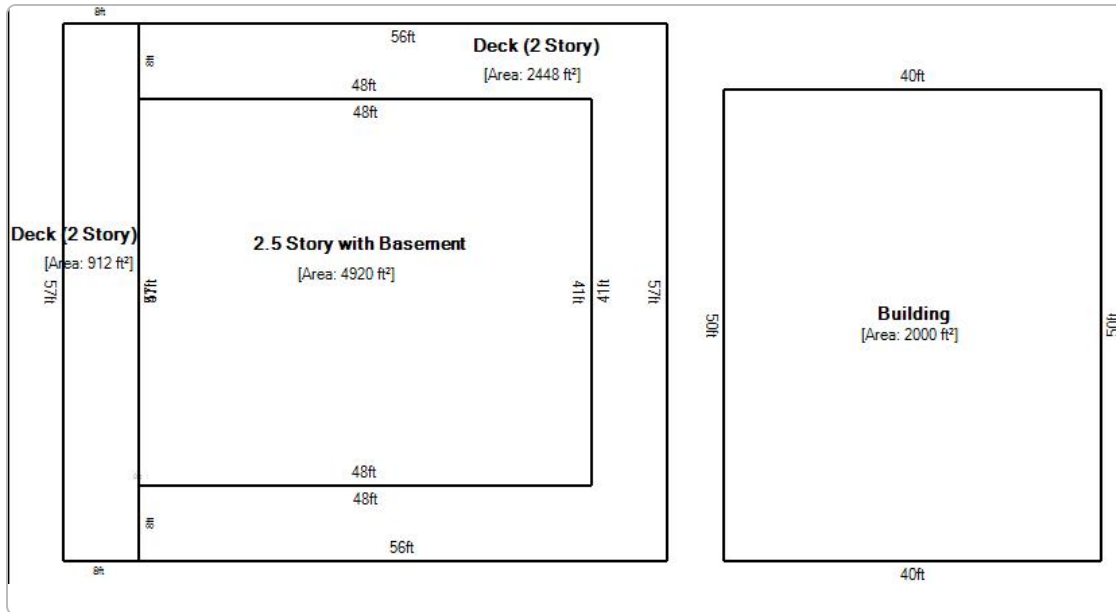

Recent Sales In Area

Sale date range:

From:

01/24/2019

To:

01/24/2022

Sales by Neighborhood

Sales by Subdivision

1500

Feet ▼

Sales by Distance

No data available for the following modules: Commercial Improvement Information, Mobile Home Information.

This is an information system. Information contained herein is not warranted to be correct or complete. The filing office by the furnishing of this information makes no representation whatsoever. Neither the filing officer nor any employee of the filing officer shall be personally liable for any damages which may arise due to information furnished pursuant to this section which is subsequently shown to be inaccurate or incomplete. Any party obtaining information from this system shall be on noti

[User Privacy Policy](#)
[GDPR Privacy Notice](#)



Last Data Upload: [1/21/2022, 6:24:20 PM](#)

Version 2.3.172

Parcel Summary

Map Number 037-00-00-003.03
 Account Number 95153 (PID: 329425 PTID: 177970)
 Location Address 565 CLIFTY CREEK RD.
 Tax District 00
 Property Class RESIDENTIAL
 Description 37-03.03 (1.37 ACRES & HOUSE)
 Acres 1.37
 Deed Information 169/296

[View Map](#)



Owner Information

Current Owner
 WILLIAMS MARK A.
 565 CLIFTY CREEK RD
 JAMESTOWN, KY 42629

Land Information

Lot Size	Lot Frontage	Lot Depth	Acreage	Street Type	Driveway	Neighborhood Type	Site Condition	Land Value
	0.00	0.00	1.37	SECONDARY		TYPICAL	GOOD	\$2,000

Valuation

	2022 Working	2021 Certified	2020 Certified	2019 Certified	2018 Certified
Homestead	N	N	N	N	N
RES	\$72,000	\$72,000	\$72,000	\$72,000	\$72,000

Residential Improvement Information

Building	1	Heat	
Residence Type	SINGLE FAMILY	AC	CENTRAL
Year Built	0	Total Rooms	0
Foundation	SLAB	Value	\$70,000
Basement	WALKOUT	Living Sqft	768
Exterior	LOG	Basement Sqft	768
Bedrooms	3	Garage Sqft	2,400
Full Bath	1	Porch Sqft	658
Half Bath	1	Patio/Deck Sqft	0
Roof Cover	METAL	Basement Finish	
Roof Type	GABLE	Structure	1 STORY
Residence Condition	GOOD	Garage	DETRM2
Fireplaces	0	Pool	

Sales Information

Sale Date	Sale Price	Deed Book	Deed Page	Previous Owner	Sale Type
06/01/1997	\$2,000	169	296	JOE WILLIAMS	

Historical PRC

[Property Record Card \(PDF\)](#)

Photos



Sketches

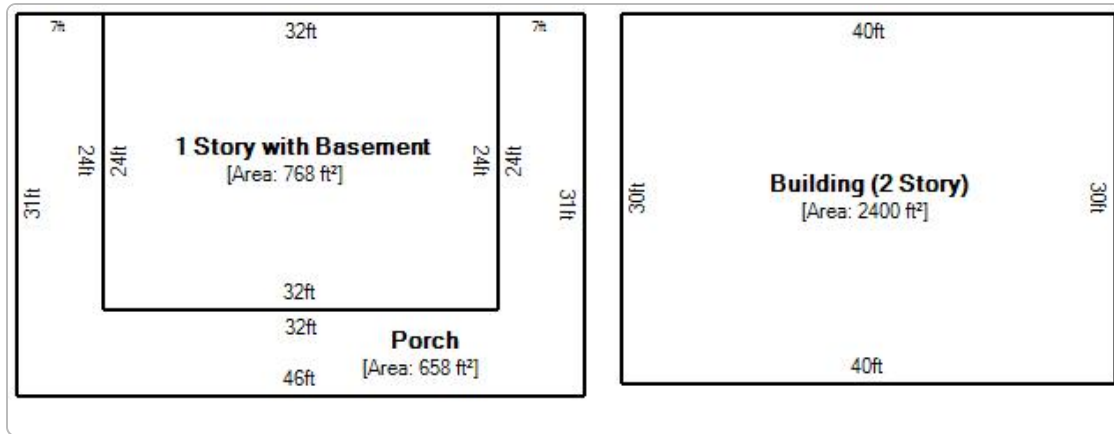

Recent Sales In Area

Sale date range:

From:

01/24/2019

To:

01/24/2022

Sales by Neighborhood

Sales by Subdivision

1500

Feet



Sales by Distance

No data available for the following modules: Commercial Improvement Information, Mobile Home Information.

This is an information system. Information contained herein is not warranted to be correct or complete. The filing office by the furnishing of this information makes no representation whatsoever. Neither the filing officer nor any employee of the filing officer shall be personally liable for any damages which may arise due to information furnished pursuant to this section which is subsequently shown to be inaccurate or incomplete. Any party obtaining information from this system shall be on not

[User Privacy Policy](#)
[GDPR Privacy Notice](#)

Last Data Upload: 1/21/2022, 6:24:20 PM



Version 2.3.172



Parcel Summary

Map Number 037-00-00-003.00
 Account Number 95141 (PID: 329415 PTID: 177959)
 Location Address CLIFTY CREEK RD.
 Tax District 00
 Property Class FARM
 Description 37-03 (145.44 ACRES)
 Acres 145
 Deed Information 170/101

[View Map](#)

Owner Information

Current Owner
 WILLIAMS JOE L., HEIRS
 815 CLIFTY CREEK RD.
 JAMESTOWN, KY 42629

Land Information

Lot Size	Lot Frontage	Lot Depth	Acreage	Street Type	Driveway	Neighborhood Type	Site Condition	Land Value
			145.00	SECONDARY		TYPICAL	GOOD	\$26,000

Valuation

	2022 Working	2021 Certified	2020 Certified	2019 Certified	2018 Certified
Homestead	N	N	N	N	N
FRM_FCV	\$175,000	\$175,000	\$175,000	\$175,000	\$175,000
FRM_TXV	\$26,000	\$26,000	\$26,000	\$26,000	\$26,000
FRM_AC	\$145	\$145	\$145	\$145	\$145
FIRE_AC	\$111	\$111	\$111	\$111	\$111

Sales Information

Sale Date	Sale Price	Deed Book	Deed Page	Previous Owner	Sale Type
12/01/1943	\$1,700	170	101		

Historical PRC

[Property Record Card \(PDF\)](#)

Recent Sales In Area

Sale date range:

From:

To:

No data available for the following modules: Commercial Improvement Information, Mobile Home Information, Residential Improvement Information, Photos, Sketches.

This is an information system. Information contained herein is not warranted to be correct or complete. The filing office by the furnishing of this information makes no representation whatsoever. Neither the filing officer nor any employee of the filing officer shall be personally liable for any damages which may arise due to information furnished pursuant to this section which is subsequently shown to be inaccurate or incomplete. Any party obtaining information from this system shall be on noti

[User Privacy Policy](#)
[GDPR Privacy Notice](#)

[Last Data Upload: 1/21/2022, 6:24:20 PM](#)



Version 2.3.172

EXHIBIT J-2
SIGNED OR RETURNED GREEN CARDS

SENDER: COMPLETE THIS SECTION	COMPLETE THIS SECTION ON DELIVERY
<ul style="list-style-type: none"> Complete items 1, 2, and 3. Print your name and address on the reverse so that we can return the card to you. Attach this card to the back of the mailpiece, or on the front if space permits. 	<p>A. Signature <input type="checkbox"/> Age <input type="checkbox"/> Add <input type="checkbox"/></p> <p>X </p> <p>B. Received by (Printed Name) C. Date of Delivery <input type="checkbox"/> Yes <input type="checkbox"/> No</p> <p>1-31-2</p> <p>D. Is delivery address different from item 1? <input type="checkbox"/> Yes <input type="checkbox"/> No If YES, enter delivery address below:</p>
<p>1. Article Addressed to:</p> <p>MCCLURE NATHAN L. & DIANA K. 535 CLIFTY CREEK RD JAMESTOWN, KY 42629</p>	
 9590 9402 7095 1251 7123 58	<p>3. Service Type <input type="checkbox"/> Priority Mail Express <input type="checkbox"/> Registered Mail™ <input type="checkbox"/> Registered Mail Restricted Delivery <input type="checkbox"/> Registered Mail Restricted Delivery <input type="checkbox"/> Certified Mail® <input type="checkbox"/> Signature Confirmation <input type="checkbox"/> Signature Confirmation Restricted Delivery <input type="checkbox"/> Collect on Delivery <input type="checkbox"/> Signature Confirmation Restricted Delivery <input type="checkbox"/> Collect on Delivery Restricted Delivery <input type="checkbox"/> Insured Mail <input type="checkbox"/> Registered Mail Restricted Delivery (over \$500)</p>
<p>2. Article Number (Transfer from service label)</p> <p>7021 2720 0001 6149 4581</p>	
PS Form 3811, July 2020 PSN 7530-02-000-9053 Domestic Return Form	

SENDER: COMPLETE THIS SECTION	COMPLETE THIS SECTION ON DELIVERY
<ul style="list-style-type: none"> Complete items 1, 2, and 3. Print your name and address on the reverse so that we can return the card to you. Attach this card to the back of the mailpiece, or on the front if space permits. 	<p>A. Signature <input type="checkbox"/> Age <input type="checkbox"/> Add <input type="checkbox"/></p> <p>X </p> <p>B. Received by (Printed Name) C. Date of Delivery <input type="checkbox"/> Yes <input type="checkbox"/> No</p> <p>Paula Mann 2/9/2</p> <p>D. Is delivery address different from item 1? <input type="checkbox"/> Yes <input type="checkbox"/> No If YES, enter delivery address below:</p>
<p>1. Article Addressed to:</p> <p>MANN PAULA 570 CLIFTY CREEK RD JAMESTOWN, KY 42629</p>	
 9590 9402 7095 1251 7123 03	<p>3. Service Type <input type="checkbox"/> Priority Mail Express <input type="checkbox"/> Registered Mail™ <input type="checkbox"/> Registered Mail Restricted Delivery <input type="checkbox"/> Registered Mail Restricted Delivery <input type="checkbox"/> Certified Mail® <input type="checkbox"/> Signature Confirmation <input type="checkbox"/> Signature Confirmation Restricted Delivery <input type="checkbox"/> Collect on Delivery <input type="checkbox"/> Signature Confirmation Restricted Delivery <input type="checkbox"/> Collect on Delivery Restricted Delivery <input type="checkbox"/> Insured Mail <input type="checkbox"/> Registered Mail Restricted Delivery (over \$500)</p>
<p>2. Article Number (Transfer from service label)</p> <p>7021 2720 0001 6149 4635</p>	
PS Form 3811, July 2020 PSN 7530-02-000-9053 Domestic Return Form	

SENDER: COMPLETE THIS SECTION	COMPLETE THIS SECTION ON DELIVERY
<ul style="list-style-type: none"> Complete items 1, 2, and 3. Print your name and address on the reverse so that we can return the card to you. Attach this card to the back of the mailpiece, or on the front if space permits. 	<p>A. Signature <input type="checkbox"/> Age <input type="checkbox"/> Add <input type="checkbox"/></p> <p>X </p> <p>B. Received by (Printed Name) C. Date of Delivery <input type="checkbox"/> Yes <input type="checkbox"/> No</p> <p>Gary L. Williams 1-31-2</p> <p>D. Is delivery address different from item 1? <input type="checkbox"/> Yes <input type="checkbox"/> No If YES, enter delivery address below:</p>
<p>1. Article Addressed to:</p> <p>WILLIAMS MARK A. 565 CLIFTY CREEK RD JAMESTOWN, KY 42629</p>	
 9590 9402 7095 1251 7123 65	<p>3. Service Type <input type="checkbox"/> Priority Mail Express <input type="checkbox"/> Registered Mail™ <input type="checkbox"/> Registered Mail Restricted Delivery <input type="checkbox"/> Registered Mail Restricted Delivery <input type="checkbox"/> Certified Mail® <input type="checkbox"/> Signature Confirmation <input type="checkbox"/> Signature Confirmation Restricted Delivery <input type="checkbox"/> Collect on Delivery <input type="checkbox"/> Signature Confirmation Restricted Delivery <input type="checkbox"/> Collect on Delivery Restricted Delivery <input type="checkbox"/> Insured Mail <input type="checkbox"/> Registered Mail Restricted Delivery (over \$500)</p>
<p>2. Article Number (Transfer from service label)</p> <p>7021 2720 0001 6149 4574</p>	
PS Form 3811, July 2020 PSN 7530-02-000-9053 Domestic Return Form	

SENDER: COMPLETE THIS SECTION

- Complete items 1, 2, and 3.
- Print your name and address on the reverse so that we can return the card to you.
- Attach this card to the back of the mailpiece, or on the front if space permits.

1. Article Addressed to:

WILLIAMS JOE L., HEIRS
815 CLIFTY CREEK RD
JAMESTOWN, KY 42629



9590 9402 7095 1251 7123 72

2. Article Number (Transfer from service label)
7021 2720 0001 6149 4567

PS Form 3811, July 2020 PSN 7530-02-000-9053

COMPLETE THIS SECTION ON DELIVERY

A. Signature Age Add
Joe L. Williams

B. Received by (Printed Name) C. Date of D
Cory L Williams *1-31-21*

D. Is delivery address different from item 1? Yes
 If YES, enter delivery address below: No

3. Service Type Priority Mail Expr
 Adult Signature Registered Mail™
 Adult Signature Restricted Delivery Registered Mail F
 Certified Mail® Delivery
 Certified Mail Restricted Delivery Signature Confir
 Collect on Delivery Signature Confir
 Collect on Delivery Restricted Delivery Restricted Delive
 Insured Mail
 Insured Mail Restricted Delivery
 (over \$500)

Domestic Return R

SENDER: COMPLETE THIS SECTION

- Complete items 1, 2, and 3.
- Print your name and address on the reverse so that we can return the card to you.
- Attach this card to the back of the mailpiece, or on the front if space permits.

1. Article Addressed to:

SELBY SHERRY GRIDER & BRANDON
336 COLSON DR
RUSSELL SPRINGS, KY 42642



9590 9402 7095 1251 7123 10

2. Article Number (Transfer from service label)
7021 2720 0001 6149 4628

PS Form 3811, July 2020 PSN 7530-02-000-9053

COMPLETE THIS SECTION ON DELIVERY

A. Signature Age Adk
X

B. Received by (Printed Name) C. Date of D
Sherry Grider *1/29/21*

D. Is delivery address different from item 1? Yes
 If YES, enter delivery address below: No

3. Service Type Priority Mail Expr
 Adult Signature Registered Mail™
 Adult Signature Restricted Delivery Registered Mail F
 Certified Mail® Delivery
 Certified Mail Restricted Delivery Signature Confir
 Collect on Delivery Signature Confir
 Collect on Delivery Restricted Delivery Restricted Delive
 Insured Mail
 Insured Mail Restricted Delivery
 (over \$500)

Domestic Return R

SENDER: COMPLETE THIS SECTION

- Complete items 1, 2, and 3.
- Print your name and address on the reverse so that we can return the card to you.
- Attach this card to the back of the mailpiece, or on the front if space permits.

1. Article Addressed to:

LAWLESS ROY ROGERS & MARY ALICE
& LAWLESS JOSHUA RYAN
435 YORK RD
JAMESTOWN, KY 42629



9590 9402 7095 1251 7123 34

2. Article Number (Transfer from service label)
7021 2720 0001 6149 4604

PS Form 3811, July 2020 PSN 7530-02-000-9053

COMPLETE THIS SECTION ON DELIVERY

A. Signature Ag Ad
X *Mary Alice Lawless*

B. Received by (Printed Name) C. Date of D
Mary Alice Lawless *1-31-21*

D. Is delivery address different from item 1? Ye
 If YES, enter delivery address below: No

3. Service Type Priority Mail Exp
 Adult Signature Registered Mail™
 Adult Signature Restricted Delivery Registered Mail
 Certified Mail® Delivery
 Certified Mail Restricted Delivery Signature Confir
 Collect on Delivery Signature Confir
 Collect on Delivery Restricted Delivery Restricted Delive
 Insured Mail
 Insured Mail Restricted Delivery
 (over \$500)

Domestic Return F

SENDER: COMPLETE THIS SECTION	COMPLETE THIS SECTION ON DELIVERY
<ul style="list-style-type: none"> ■ Complete items 1, 2, and 3. ■ Print your name and address on the reverse so that we can return the card to you. ■ Attach this card to the back of the mailpiece, or on the front if space permits. 	<p>A. Signature <input checked="" type="checkbox"/> <i>Mary Alice Lawless</i> <input type="checkbox"/> Age <input type="checkbox"/> Add</p> <p>B. Received by (Printed Name) <input type="checkbox"/> C. Date of Delivery <input type="checkbox"/> 1-31-</p>
<p>1. Article Addressed to:</p> <p>LAWLESS ROY, MARY ALICE & JOSHUA RYAN & MCGAHA LINDA & JIMMY 435 YORK RD JAMESTOWN, KY 42629</p>	<p>D. Is delivery address different from item 1? <input type="checkbox"/> Yes If YES, enter delivery address below: <input type="checkbox"/> No</p>
 9590 9402 7095 1251 7123 41	<p>3. Service Type <input type="checkbox"/> Priority Mail Express <input type="checkbox"/> Adult Signature <input type="checkbox"/> Registered Mail™ <input type="checkbox"/> Adult Signature Restricted Delivery <input type="checkbox"/> Registered Mail™ Delivery <input type="checkbox"/> Certified Mail® <input type="checkbox"/> Signature Confirmation <input type="checkbox"/> Certified Mail Restricted Delivery <input type="checkbox"/> Signature Confirmation Restricted Delivery <input type="checkbox"/> Collect on Delivery <input type="checkbox"/> Signature Confirmation Restricted Delivery <input type="checkbox"/> Collect on Delivery Restricted Delivery <input type="checkbox"/> Insured Mail (over \$500)</p>
<p>2. Article Number (Transfer from service label) 7021 2720 0001 6149 4598</p>	<p>PS Form 3811, July 2020 PSN 7530-02-000-9053 Domestic Return Form</p>

SENDER: COMPLETE THIS SECTION	COMPLETE THIS SECTION ON DELIVERY
<ul style="list-style-type: none"> ■ Complete items 1, 2, and 3. ■ Print your name and address on the reverse so that we can return the card to you. ■ Attach this card to the back of the mailpiece, or on the front if space permits. 	<p>A. Signature <input checked="" type="checkbox"/> <i>Gary D. Robertson</i> <input type="checkbox"/> Age <input type="checkbox"/> Add</p> <p>B. Received by (Printed Name) <input type="checkbox"/> C. Date of Delivery <input type="checkbox"/> 1-31-</p>
<p>1. Article Addressed to:</p> <p>GARY D. ROBERTSON COUNTY JUDGE EXECUTIVE P. O. BOX 397 410 MONUMENT SQUARE, SUITE 205 JAMESTOWN, KY 42629</p>	<p>D. Is delivery address different from item 1? <input type="checkbox"/> Yes If YES, enter delivery address below: <input type="checkbox"/> No</p>
 9590 9402 7095 1251 7122 80	<p>3. Service Type <input type="checkbox"/> Priority Mail Express <input type="checkbox"/> Adult Signature <input type="checkbox"/> Registered Mail™ <input type="checkbox"/> Adult Signature Restricted Delivery <input type="checkbox"/> Registered Mail™ Delivery <input type="checkbox"/> Certified Mail® <input type="checkbox"/> Signature Confirmation <input type="checkbox"/> Certified Mail Restricted Delivery <input type="checkbox"/> Signature Confirmation Restricted Delivery <input type="checkbox"/> Collect on Delivery <input type="checkbox"/> Signature Confirmation Restricted Delivery <input type="checkbox"/> Collect on Delivery Restricted Delivery <input type="checkbox"/> Insured Mail (over \$500)</p>
<p>2. Article Number (Transfer from service label) 7021 2720 0001 6149 4659</p>	<p>PS Form 3811, July 2020 PSN 7530-02-000-9053 Domestic Return Form</p>

SENDER: COMPLETE THIS SECTION	COMPLETE THIS SECTION ON DELIVERY
<ul style="list-style-type: none"> ■ Complete items 1, 2, and 3. ■ Print your name and address on the reverse so that we can return the card to you. ■ Attach this card to the back of the mailpiece, or on the front if space permits. 	<p>A. Signature <input checked="" type="checkbox"/> <i>Diana Rouse</i> <input type="checkbox"/> Age <input type="checkbox"/> Add</p> <p>B. Received by (Printed Name) <input type="checkbox"/> C. Date of Delivery <input type="checkbox"/> 019 APR 2021</p>
<p>1. Article Addressed to:</p> <p>ROUSE DIANA & OTHERS 12260 DONCASTER CT FISHERS, IN 46038</p>	<p>D. Is delivery address different from item 1? <input type="checkbox"/> Yes If YES, enter delivery address below: <input type="checkbox"/> No</p>
 9590 9402 7095 1251 7123 27	<p>3. Service Type <input type="checkbox"/> Priority Mail Express <input type="checkbox"/> Adult Signature <input type="checkbox"/> Registered Mail™ <input type="checkbox"/> Adult Signature Restricted Delivery <input type="checkbox"/> Registered Mail™ Delivery <input type="checkbox"/> Certified Mail® <input type="checkbox"/> Signature Confirmation <input type="checkbox"/> Certified Mail Restricted Delivery <input type="checkbox"/> Signature Confirmation Restricted Delivery <input type="checkbox"/> Collect on Delivery <input type="checkbox"/> Signature Confirmation Restricted Delivery <input type="checkbox"/> Collect on Delivery Restricted Delivery <input type="checkbox"/> Insured Mail (over \$500)</p>
<p>2. Article Number (Transfer from service label) 7021 2720 0001 6149 4611</p>	<p>PS Form 3811, July 2020 PSN 7530-02-000-9053 Domestic Return Form</p>

SENDER: COMPLETE THIS SECTION

- Complete items 1, 2, and 3.
- Print your name and address on the reverse so that we can return the card to you.
- Attach this card to the back of the mailpiece, or on the front if space permits.

1. Article Addressed to:

**MANN PAULA GLOVER
570 CLIFTY CREEK RD
JAMESTOWN, KY 42629**



9590 9402 7095 1251 7122 97

2. Article Number (Transfer from service label)

7021 2720 0001 6149 4642

COMPLETE THIS SECTION ON DELIVERY

A. Signature Adult Signature Age Restricted Delivery
 X  Addressee's Signature

B. Received by (Printed Name) Addressee's Signature
 Paula Mann

C. Date of Delivery
 7/9/16

D. Is delivery address different from item 1? Yes
 If YES, enter delivery address below: No

3. Service Type
- Adult Signature
 - Adult Signature Restricted Delivery
 - Certified Mail®
 - Certified Mail Restricted Delivery
 - Collect on Delivery
 - Collect on Delivery Restricted Delivery
 - Registered Mail™
 - Registered Mail Restricted Delivery
 - Signature Confirmation
 - Signature Confirmation Restricted Delivery
 - Priority Mail Express
 - Registered Mail™
 - Signature Confirmation
 - Signature Confirmation Restricted Delivery