

CABLE DATA (LOADING: HEAVY DISTRICT 1/2" ICE, 4LBS WIND @ 0'F)	
16-A79 TO 16-A81	16-A81 TO S. HENDERSON
OHGW: 3/8" EHS 7-STRAND STEEL	D.T. = 4.350F @ NESC 250B, INITIAL
OPGW: 48 FIBER, OD 0.602"	R.S. = 148' D.T. = 1.075F @ NESC 250B, INITIAL
161KV CONDUCTOR, 756 KCMIL 267 ACSR "BRANKE"	R.S. = 148' D.T. = 1.050F @ NESC 250B, INITIAL
	R.S. = 145' D.T. = 1.425F @ NESC 250B, INITIAL

- PRELIMINARY
- FOR BID
- FOR CONSTRUCTION
- FOR RECORD
- "AS BUILT"
-



- LEGEND**
- NEW POLE
 - DOWN GLY
 - EXISTING POLE
 - EXISTING OH LINE
 - X- FENCE
 - - - EASEMENT
 - - - PROPERTY LINE
 - DITCH/STREAM
 - * VIBRATION DAMPER

REV	DATE	BY	ENGR	REVISION DESCRIPTION
1	11/10/2022	ABG		ISSUED FOR CONSTRUCTION AS-BUILT

REID - SOUTH HENDERSON 161KV LINE 16 - A

W.O.	DRAWING REVIEW	DATE	
SCALE:	1" = 200' HORIZ 1" = 40' VERT	DATE	16 - A
	DRAWN	DATE	SHEET 04

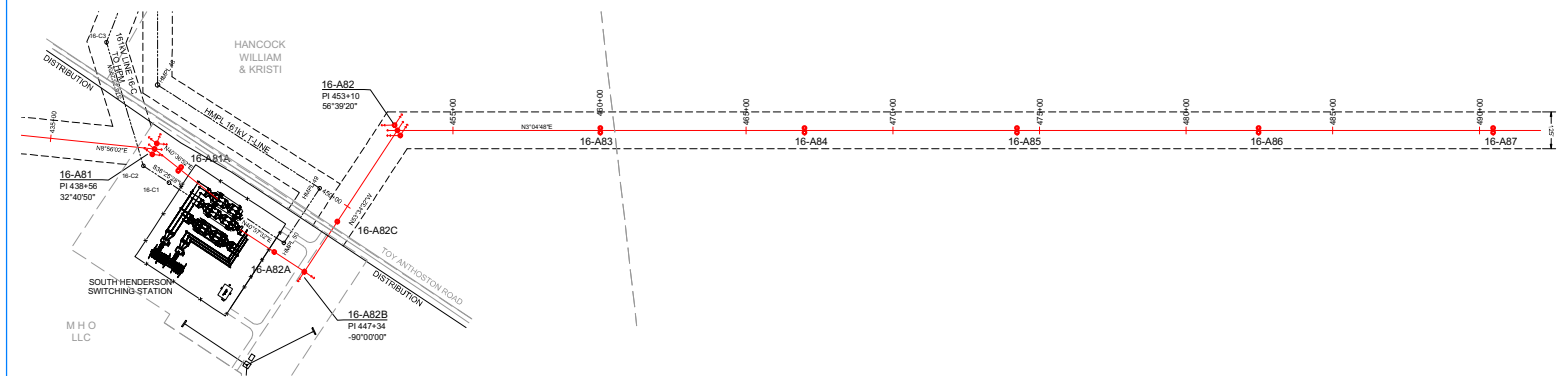
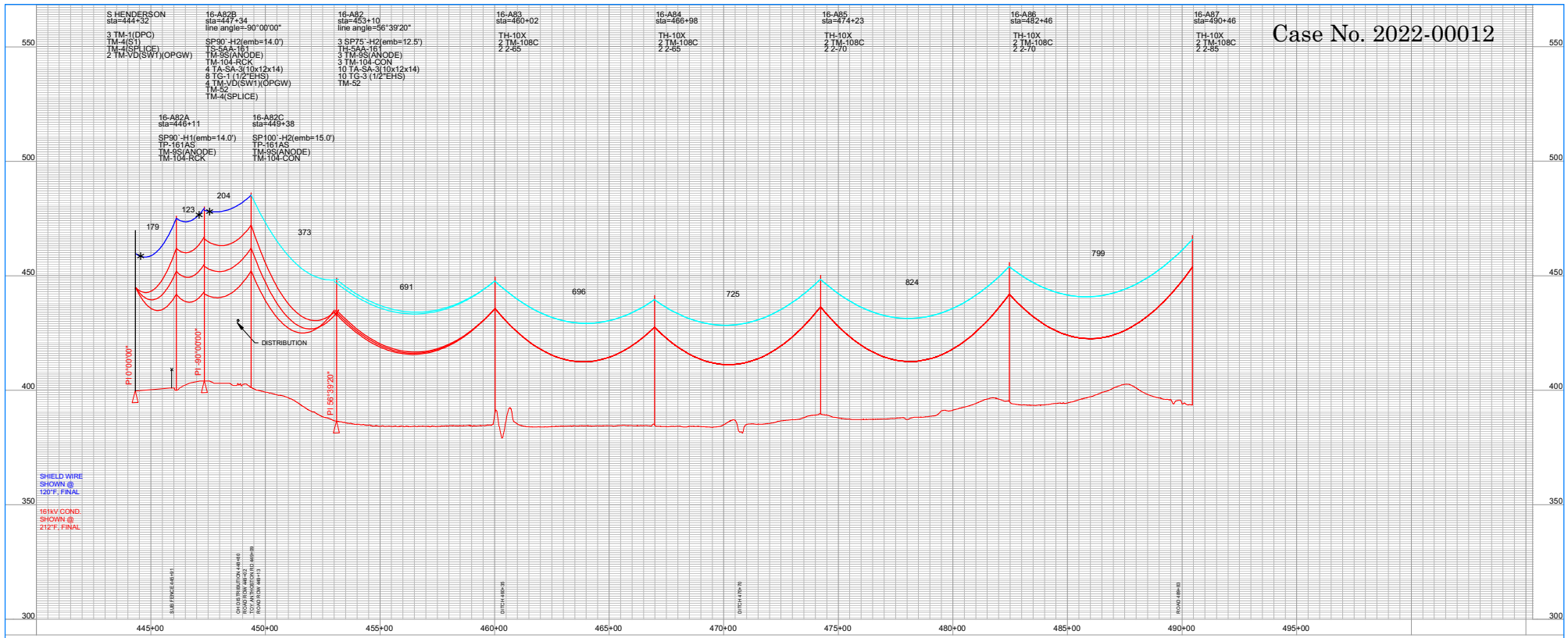

PHASING DIAGRAMS (LOOKING AHEAD TOWARD HENDERSON COUNTY)

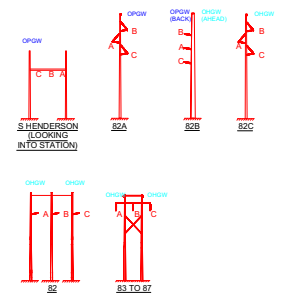

Case No. 2022-00012

CABLE DATA (LOADING: HEAVY DISTRICT 1/2" ICE, 4LBS WIND @ 0°F)			
S. HENDERSON TO 16-A82B	16-A82B TO 16-A82	16-A82 TO 16-A83	
OHGW: 3/8" EHS 7-STRAND STEEL			
OPGW: 48 FIBER, OD 0.602"	R.S. = 158' D.T. = 1.025# @ NESC 250B, INITIAL	R.S. = 330' D.T. = 3.000# @ NESC 250B, INITIAL	D.T. = 4.325# @ NESC 250B, INITIAL
161KV CONDUCTOR: 756 KCMIL 267 ACSE DRUMK	R.S. = 157' D.T. = 1.425# @ NESC 250B, INITIAL	R.S. = 322' D.T. = 2.875# @ NESC 250B, INITIAL	D.T. = 10.400# @ NESC 250B, INITIAL

- PRELIMINARY
- FOR BID
- FOR CONSTRUCTION
- FOR RECORD
- AS BUILT
-



- LEGEND**
- NEW POLE
 - DOWN GUY
 - EXISTING POLE
 - EXISTING OH LINE
 - X- FENCE
 - - - EASEMENT
 - - - PROPERTY LINE
 - - - DITCH/STREAM
 - * VIBRATION DAMPER

REV	DATE	DRWT	ENGR	REVISION DESCRIPTION
0	01/05/22	ABG		ISSUED FOR CONSTRUCTION
1	11/10/22	ABG		AS-BUILT

Big Rivers
ELECTRIC CORPORATION

SOUTH HENDERSON - HENDERSON COUNTY
161KV
LINE 16 - A

W.D.	DRAWING REVIEW	DATE	16 - A
SCALE	ENGINEER	11/10/22	SHEET 98

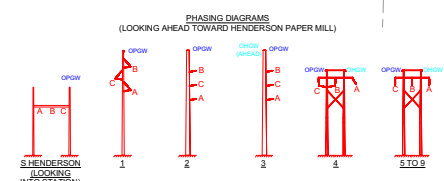
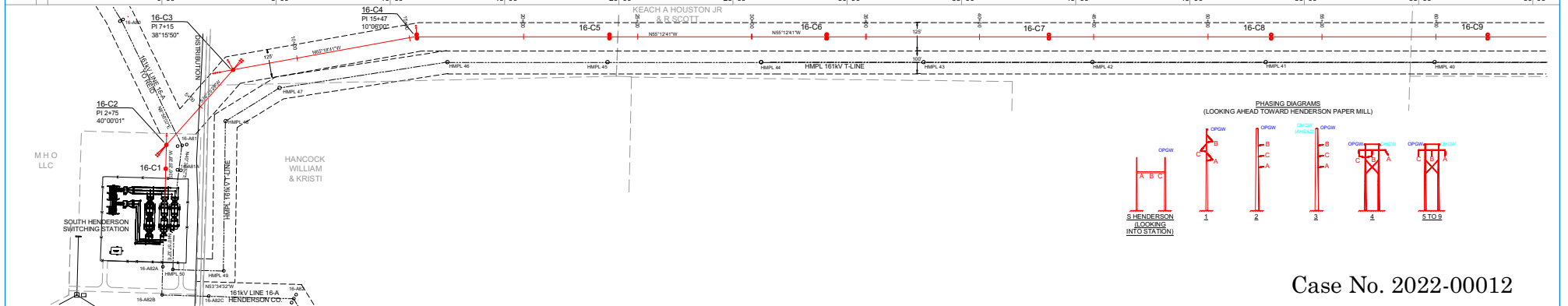
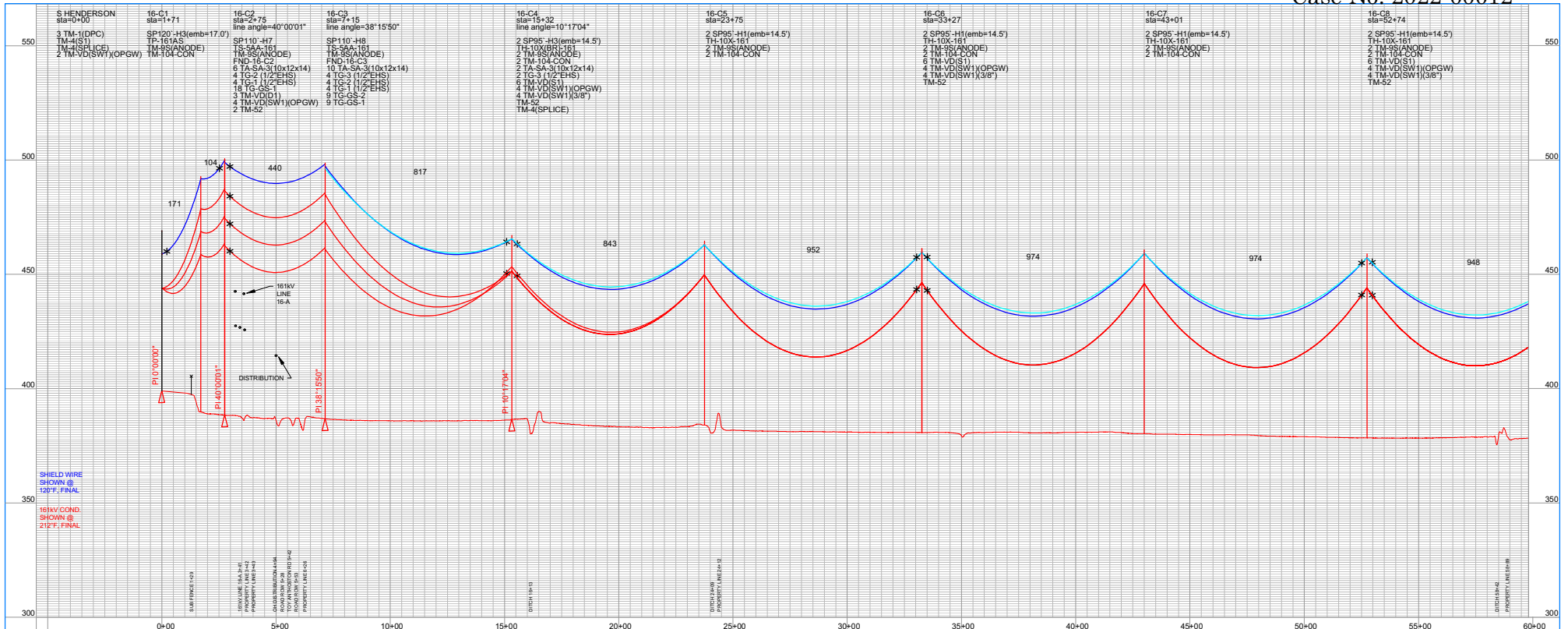

CABLE DATA (LOADING: HEAVY DISTRICT 1/2" ICE, 4LBS WIND @ 0'F)

	16-C2 TO 16-C2	16-C2 TO 16-C3	16-C3 TO 16-C3
OPGW: 3" EHS 7-STRAND STEEL			
OPGW: 48 FIBER, OD 0.602"	R.S. = 148' D.T. = 1.025" @ NESC 2908, INITIAL	R.S. = 439' D.T. = 4.500" @ NESC 2908, INITIAL	R.S. = 595' D.T. = 6.500" @ NESC 2908, INITIAL
161kV CONDUCTOR, 756 KCMIL 267 ACSE STRANKE	R.S. = 148' D.T. = 1.450" @ NESC 2908, INITIAL	R.S. = 439' D.T. = 7.875" @ NESC 2908, INITIAL	R.S. = 595' D.T. = 10.000" @ NESC 2908, INITIAL

- PRELIMINARY
- FOR BID
- FOR CONSTRUCTION
- FOR RECORD
- AS BUILT
-

- LEGEND
- NEW POLE
 - DOWN GLY
 - EXISTING POLE
 - EXISTING OH LINE
 - X- FENCE
 - - - EASEMENT
 - - - PROPERTY LINE
 - - - DITCH/STREAM
 - * VIBRATION DAMPER

REV	DATE	BY	ENGR	REVISION DESCRIPTION
1	04/05/22	ABP	ABP	ISSUED FOR CONSTRUCTION
2	11/10/22	ABP	ABP	AS-BUILT

Big Rivers
ELECTRIC CORPORATION

SOUTH HENDERSON - HENDERSON PAPER MILL 161kV LINE 16-C

W.O. DATE: 11/10/22
SCALE: 1" = 40' HORIZ
DRAWN: 11/10/22
DATE: 11/10/22
BY: [Signature]
CHECKED: [Signature]
16 - C
SHEET 1 OF 8

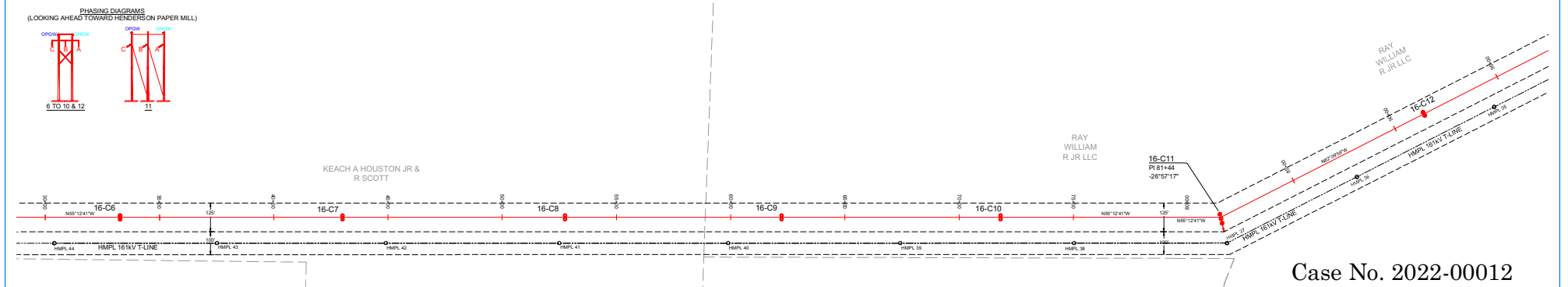
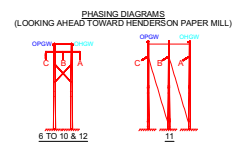
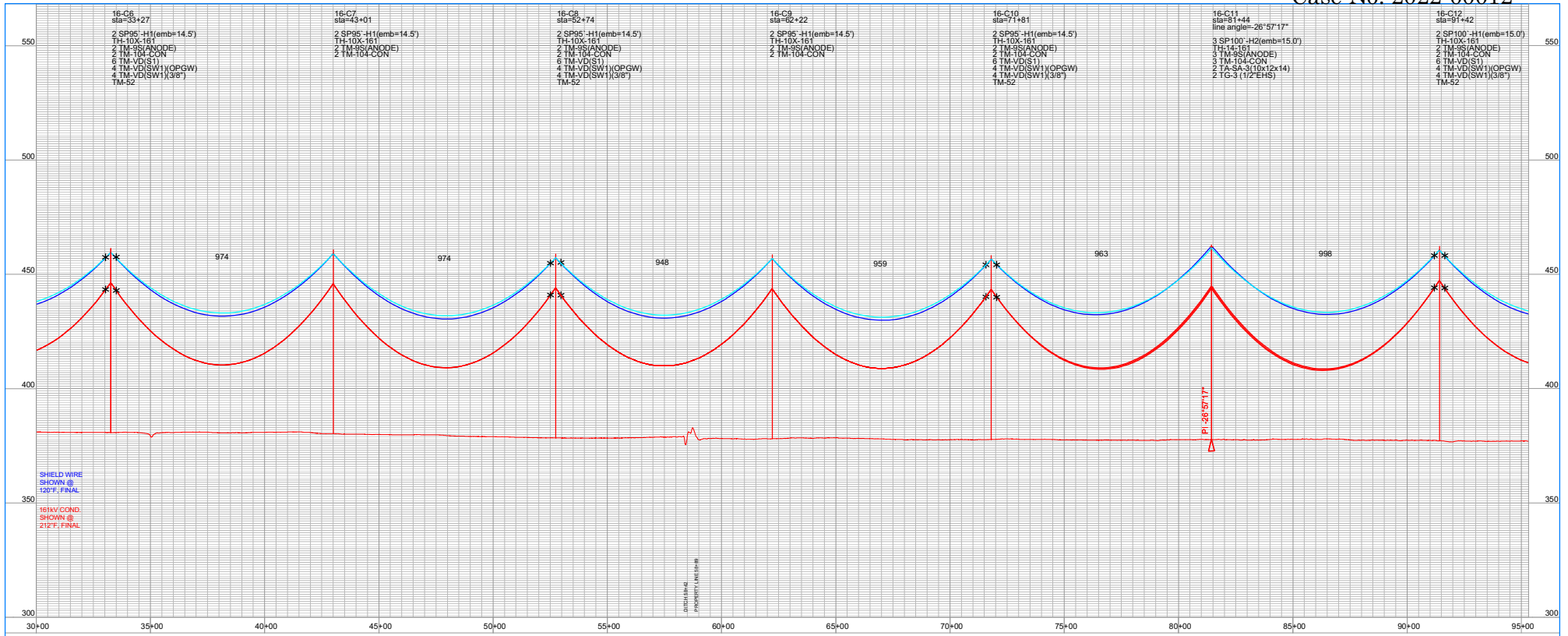

CABLE DATA (LOADING: HEAVY DISTRICT 12\"/>

CONDUCTOR	R.S.	D.T.
OHGW: 31\"/>		

- PRELIMINARY
- FOR BID
- FOR CONSTRUCTION
- FOR RECORD
- AS BUILT



- LEGEND
- NEW POLE
 - DOWN GUY
 - EXISTING POLE
 - EXISTING OH LINE
 - X- FENCE
 - - - EASEMENT
 - - - PROPERTY LINE
 - DITCH/STREAM
 - * VIBRATION DAMPER

REV	DATE	BY	ENGR	REVISION DESCRIPTION
0	04/05/2022	ABG	ABG	ISSUED FOR CONSTRUCTION
1	11/10/2023	ABG	ABG	AS-BUILT

Big Rivers ELECTRIC COOPERATIVE

SOUTH HENDERSON - HENDERSON PAPER MILL 161KV LINE 16 - C

W.O.	DATE	BY	DATE
SCALE:	1" = 40' HORIZ	1" = 40' VERT	11/10/2023

16 - C

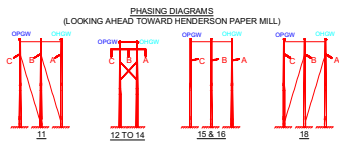
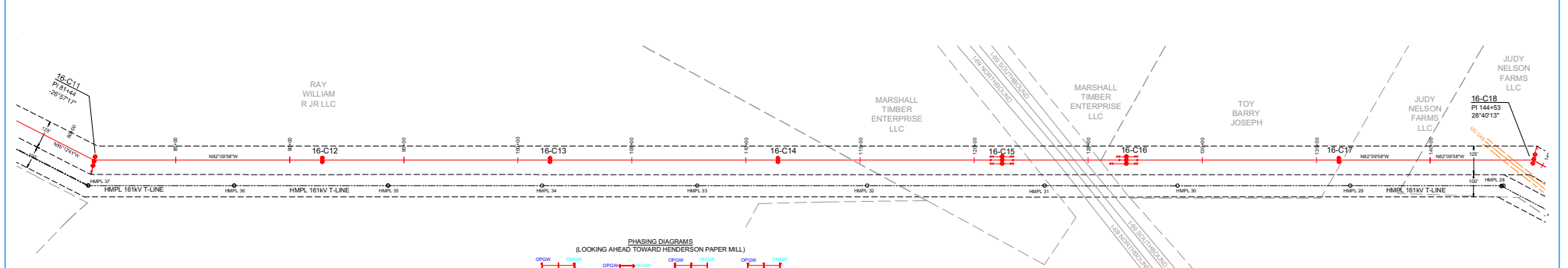
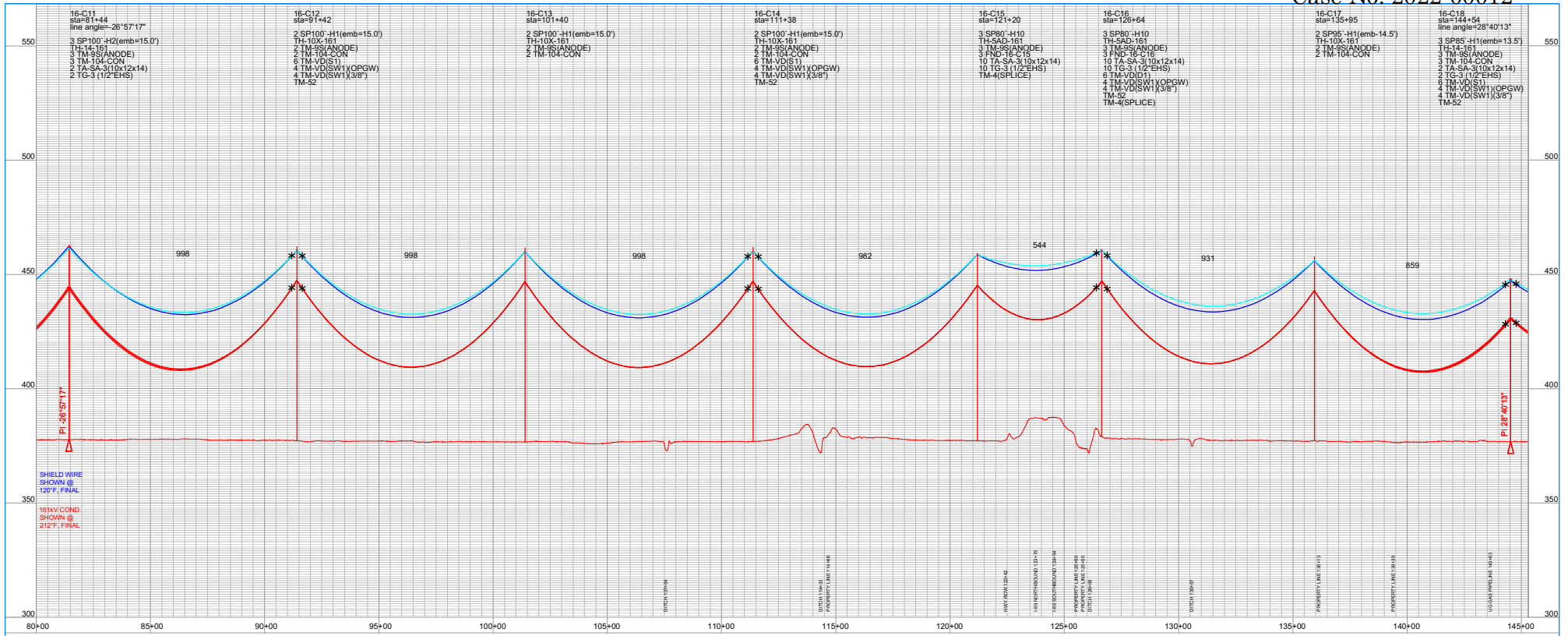

CABLE DATA (LOADING: HEAVY DISTRICT 1/2" ICE, 4LBS WIND @ 0°F)			
16-C3 TO 16-C15	16-C15 TO 16-C16	16-C16 TO 16-C18	
R.S. = 95'	R.S. = 54'	R.S. = 81'	
D.T. = 4.600F @ NESC 250S, INITIAL	D.T. = 4.5714 @ NESC 250S, INITIAL	D.T. = 4.6508 @ NESC 250S, INITIAL	
R.S. = 95'	R.S. = 54'	R.S. = 81'	
D.T. = 6.500F @ NESC 250S, INITIAL	D.T. = 6.500F @ NESC 250S, INITIAL	D.T. = 6.500F @ NESC 250S, INITIAL	
R.S. = 95'	R.S. = 54'	R.S. = 81'	
D.T. = 10.000F @ NESC 250S, INITIAL	D.T. = 7.875F @ NESC 250S, INITIAL	D.T. = 10.000F @ NESC 250S, INITIAL	

PRELIMINARY
 FOR BID
 FOR CONSTRUCTION
 FOR RECORD
 AS BUILT



- LEGEND
- NEW POLE
 - DOWN GLY
 - EXISTING POLE
 - EXISTING OH LINE
 - X- FENCE
 - - - EASEMENT
 - - - PROPERTY LINE
 - - - DITCH/STREAM
 - * VIBRATION DAMPER

REV	DATE	DRFT	ENGR	REVISION DESCRIPTION
0	04/05/22	ABG		ISSUED FOR CONSTRUCTION
1	11/10/22	ABG		AS-BUILT



SOUTH HENDERSON - HENDERSON PAPER MILL 161KV LINE 16 - C

W.D.	DATE	DRAWING REVIEW	DATE
	11/10/22	11/10/22	11/10/22
SCALE:	AS SHOWN	DATE PLOTTED:	11/10/22

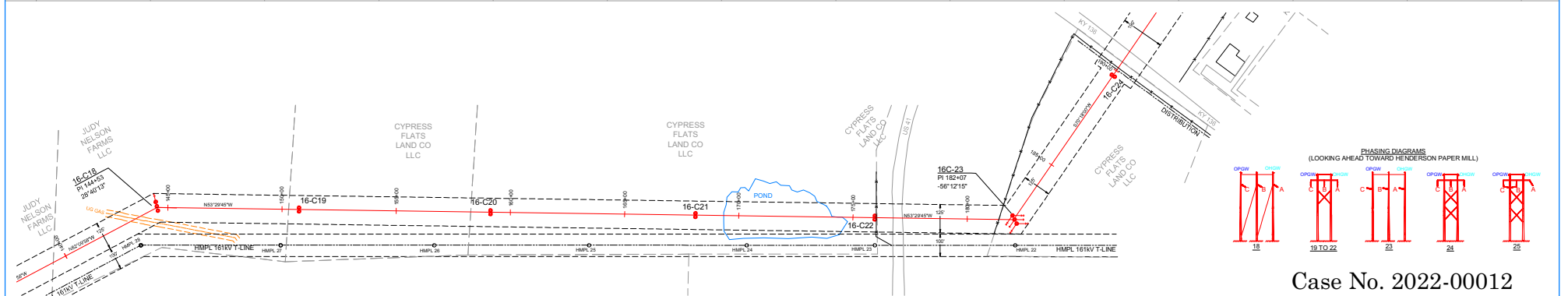
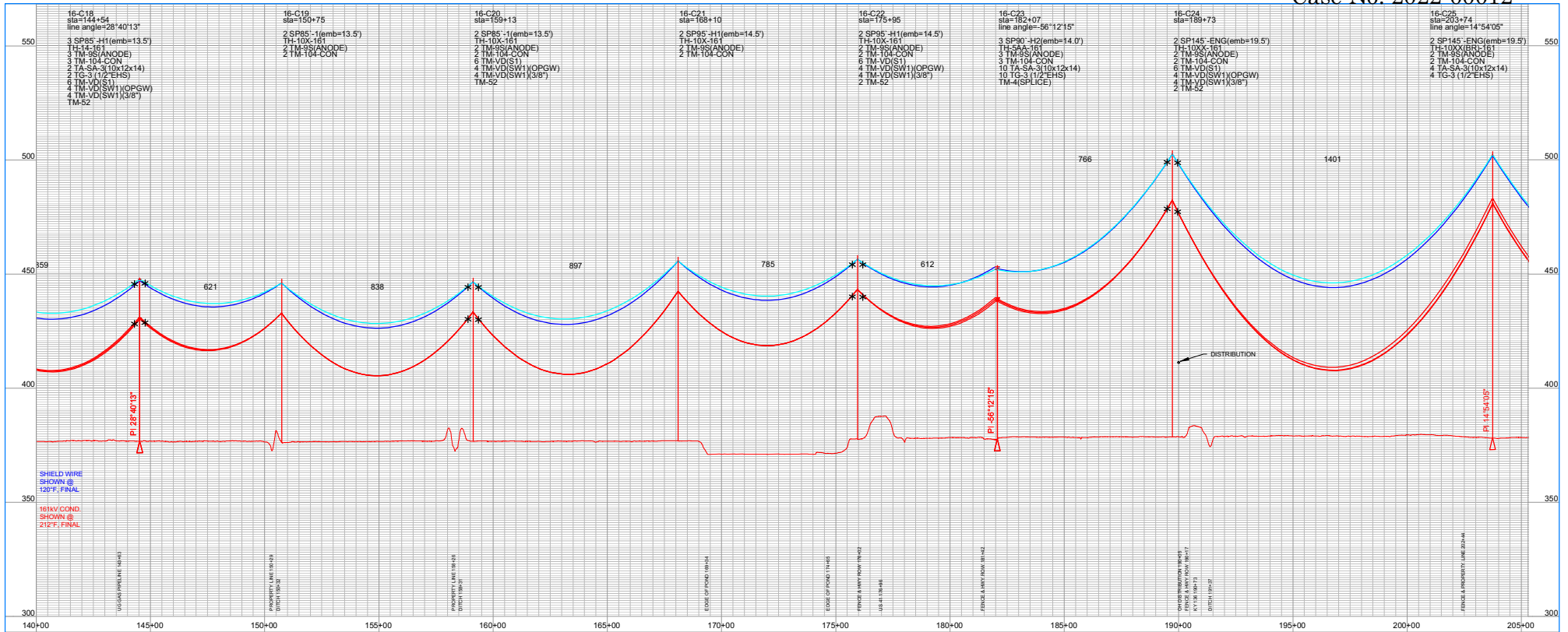

CABLE DATA (LOADING: HEAVY DISTRICT 1/2" ICE, 4LBS WIND @ 0°F)

OHGW: 3/8" EHS 7 STRAND STEEL	16-C18 TO 16-C23	16-C23 TO 16-C33
R.S. = 817'	R.S. = 1,011'	
D.T. = 4.650F @ NESC 250S, INITIAL	D.T. = 4.650F @ NESC 250S, INITIAL	
OPGW: 48 FIBER, OD 0.602"	R.S. = 818'	R.S. = 1,012'
D.T. = 6.500F @ NESC 250S, INITIAL	D.T. = 6.500F @ NESC 250S, INITIAL	
161KV CONDUCTOR, 755 KCMIL 267 ACSB STRANKE	R.S. = 818'	R.S. = 1,012'
D.T. = 10.000F @ NESC 250S, INITIAL	D.T. = 10.000F @ NESC 250S, INITIAL	

- PRELIMINARY
- FOR BID
- FOR CONSTRUCTION
- FOR RECORD
- AS BUILT

- LEGEND
- NEW POLE
 - DOWN GUY
 - EXISTING POLE
 - EXISTING OH LINE
 - X- FENCE
 - - - EASEMENT
 - - - PROPERTY LINE
 - - - DITCH/STREAM
 - * VIBRATION DAMPER

REV	DATE	DRFT	ENGR	REVISION DESCRIPTION
1	04/05/22	ABG	ABG	ISSUED FOR CONSTRUCTION
2	11/10/22	ABG	ABG	AS-BUILT

Big Rivers ELECTRIC CORPORATION

SOUTH HENDERSON - HENDERSON PAPER MILL 161KV LINE 16 - C

W.D. [] DATE []
SCALE: [] DRAWN: [] CHECKED: []
16 - C

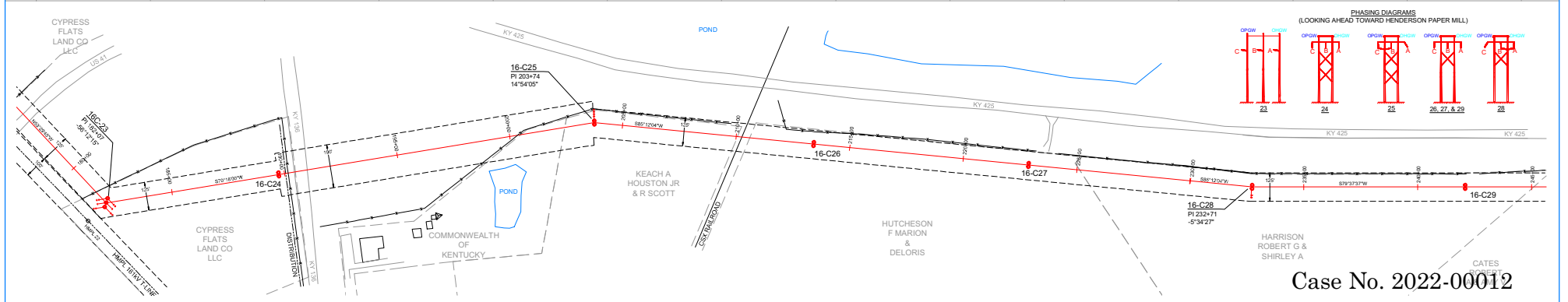
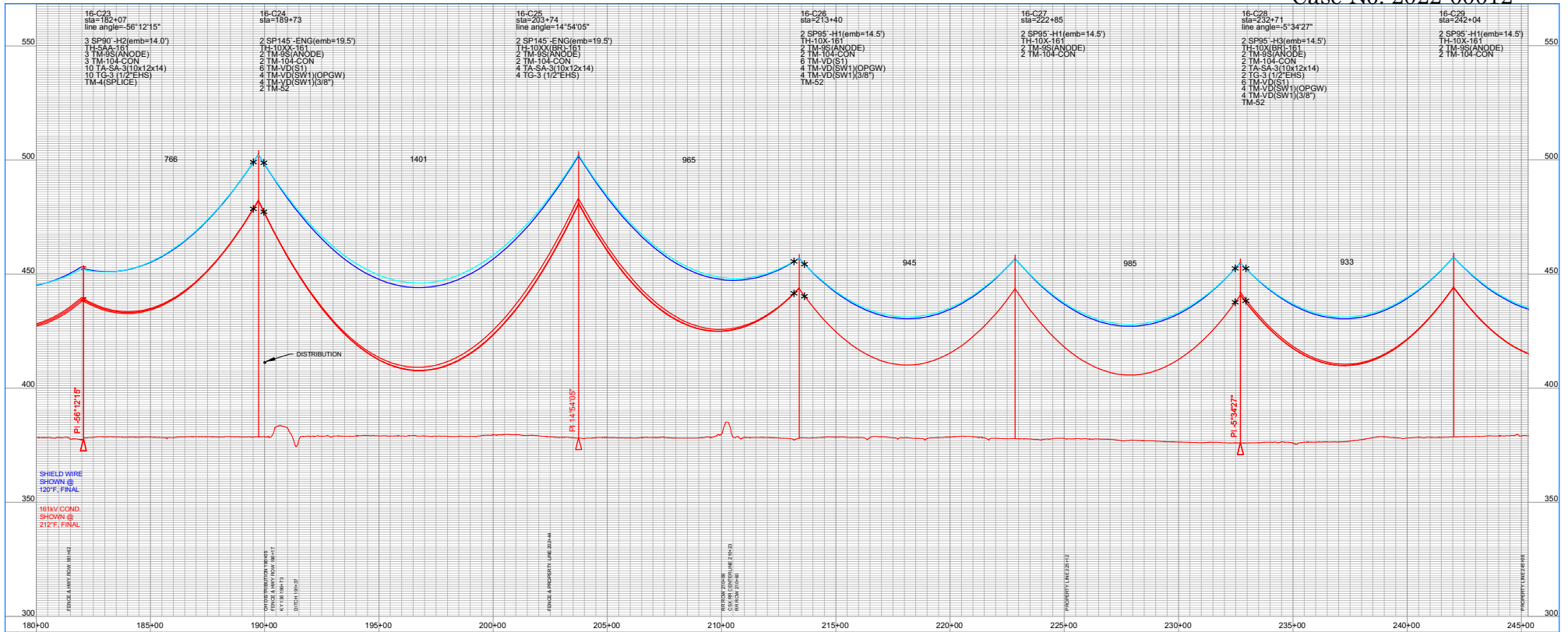

CABLE DATA & LOADING: HEAVY DISTRICT 12" ICE, 4LBS WIND @ 0° F

16-C23 TO 16-C23	
OHGW: 31# EHS 7-STRAND STEEL	R.S. = 1.011' D.T. = 4.600F @ NESC 2008, INITIAL
OPGW: 48 FIBER, OD 0.602"	R.S. = 1.012' D.T. = 6.600F @ NESC 2008, INITIAL
161KV CONDUCTOR: 756 KCMIL 267 ACSE STRANKE	R.S. = 1.012' D.T. = 10.000F @ NESC 2008, INITIAL

PRELIMINARY FOR BID FOR CONSTRUCTION FOR RECORD AS BUILT



LEGEND

- NEW POLE
- DOWN GUY
- EXISTING POLE
- EXISTING OH LINE
- FENCE
- EASEMENT
- PROPERTY LINE
- DITCH/STREAM
- VIBRATION DAMPER

REV	DATE	DRFT	ENGR	REVISION DESCRIPTION
0	04/05/22	ABG		ISSUED FOR CONSTRUCTION
1	11/10/22	ABG		AS-BUILT

Big Rivers ELECTRIC CORPORATION

SOUTH HENDERSON - HENDERSON PAPER MILL 161KV LINE 16 - C

W.D.	DATE	DATE	DATE
	11/10/22	11/10/22	11/10/22

SCALE: ENGINEER: 1/8"=1'-0" PER PROJECTOR: DATE: 11/10/22 SHEET: 6 OF 6

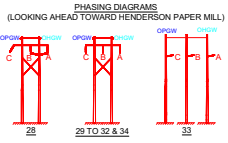
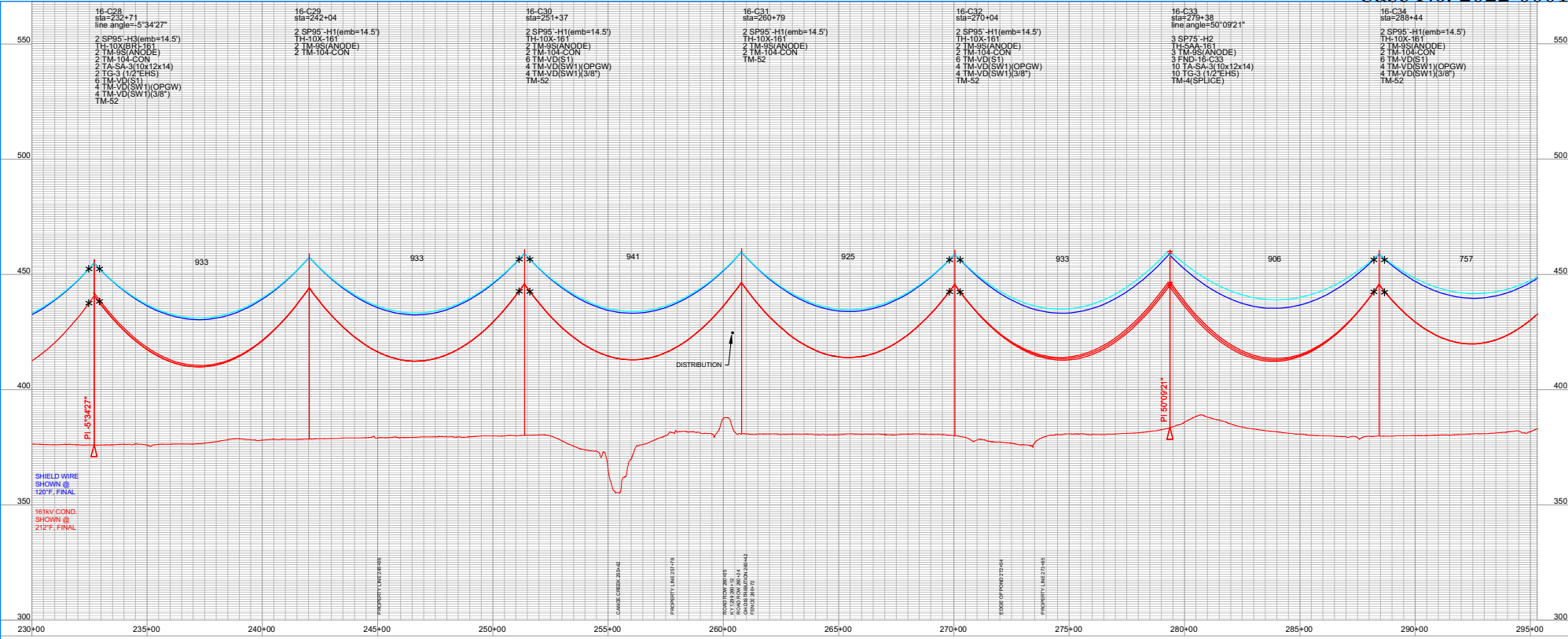

CABLE DATA (LOADING: HEAVY DISTRICT 12" ICE, 4LBS WIND @ 0°F)	
OPGW: 31" EHS 7-STRAND STEEL	R.S. = 1.011' D.T. = 4.600# @ NESC 2026, INITIAL
OPGW: 48 FIBER, OD 0.602"	R.S. = 1.012' D.T. = 6.000# @ NESC 2026, INITIAL
161KV CONDUCTOR: 756 KCMIL 267 ACSS DRUMKE	R.S. = 1.012' D.T. = 10.000# @ NESC 2026, INITIAL

- PRELIMINARY
- FOR BID
- FOR CONSTRUCTION
- FOR RECORD
- AS BUILT
-

LEGEND

- NEW POLE
- DOWN GUY
- EXISTING POLE
- EXISTING OH LINE
- X- FENCE
- - - EASEMENT
- - - PROPERTY LINE
- DITCH/STREAM
- * VIBRATION DAMPER

REV	DATE	DRFT	ENGR	REVISION DESCRIPTION
1	05/16/2022	ABG	ABG	ISSUED FOR CONSTRUCTION
2	11/10/2022	ABG	ABG	REVISED PROPERTY OWNER LABELS

Big Rivers
ELECTRIC COMPANY

SOUTH HENDERSON -
HENDERSON PAPER MILL 161KV
LINE 16 - C

W.D.	DATE	SCALE	ENGINEER	DRAWN	DATE	SHEET
	11-10-2022	1"=50'	ABG	ABG	11/10/2022	6 OF 6

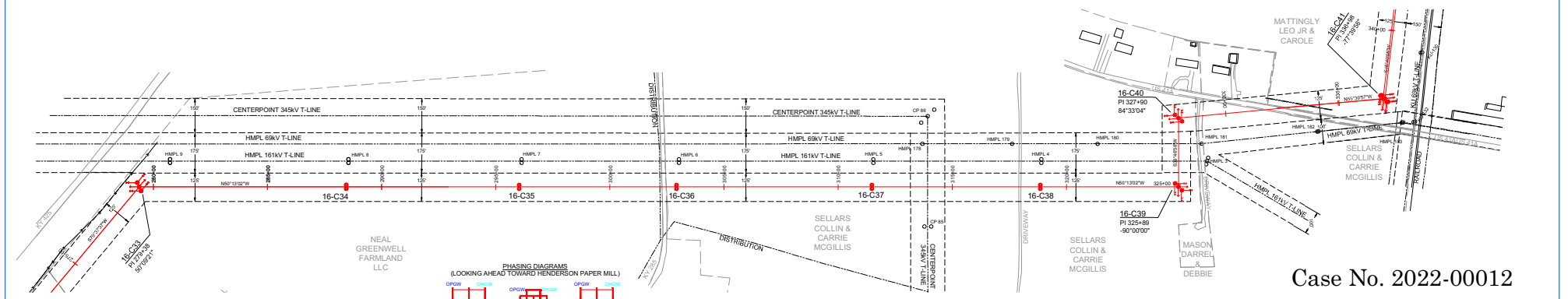
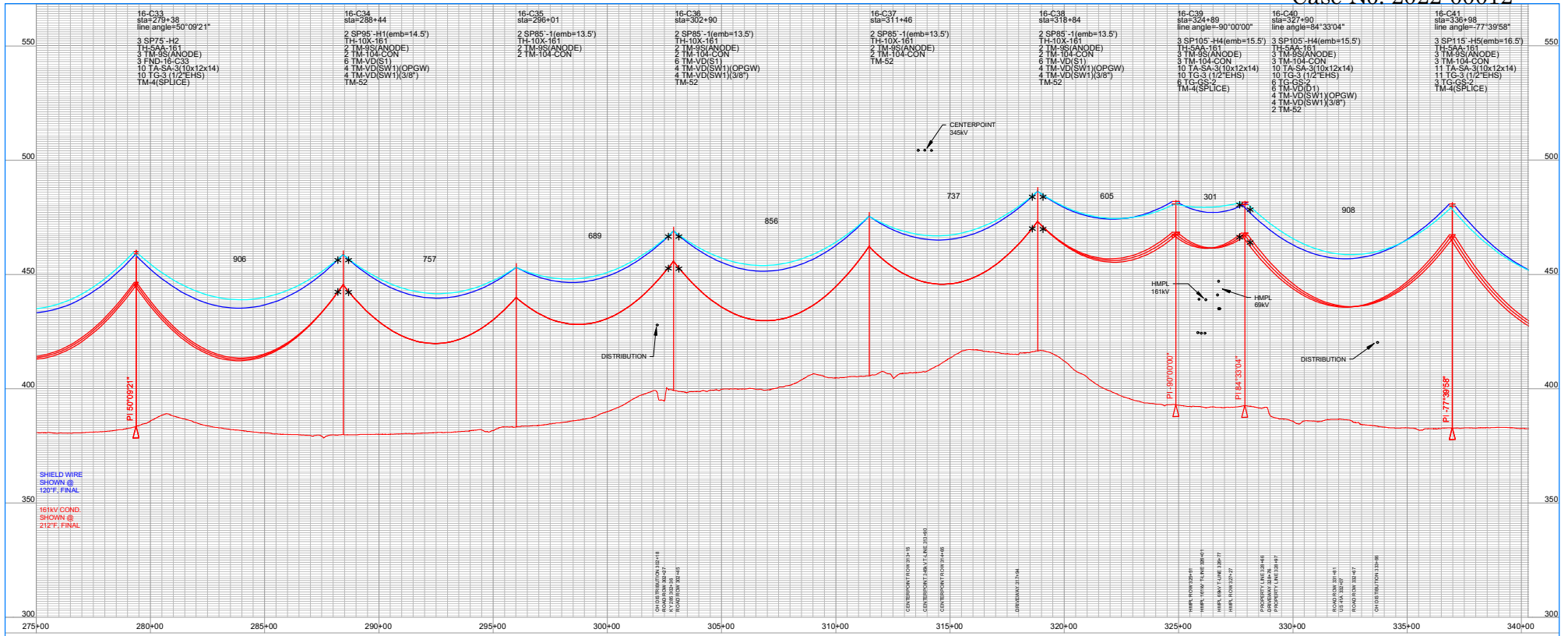

CABLE DATA (LOADING: HEAVY DISTRICT 1/2" ICE, 4LBS WIND @ 0°F)

16-C33 TO 16-C34	16-C34 TO 16-C35	16-C35 TO 16-C36	16-C36 TO 16-C37	16-C37 TO 16-C38	16-C38 TO 16-C39	16-C39 TO 16-C40	16-C40 TO 16-C41
R.S. = 777'	R.S. = 309'	R.S. = 909'	R.S. = 909'	R.S. = 909'	R.S. = 909'	R.S. = 909'	R.S. = 909'
D.T. = 4.6504' @ NESC 250S, INITIAL	D.T. = 3.7754' @ NESC 250S, INITIAL	D.T. = 4.6504' @ NESC 250S, INITIAL	D.T. = 4.6504' @ NESC 250S, INITIAL	D.T. = 4.6504' @ NESC 250S, INITIAL	D.T. = 4.6504' @ NESC 250S, INITIAL	D.T. = 4.6504' @ NESC 250S, INITIAL	D.T. = 4.6504' @ NESC 250S, INITIAL
OPGW: 48 FIBER, OD 0.602"	R.S. = 777'	R.S. = 299'	R.S. = 909'	R.S. = 909'	R.S. = 909'	R.S. = 909'	R.S. = 909'
D.T. = 6.5004' @ NESC 250S, INITIAL	D.T. = 4.5004' @ NESC 250S, INITIAL	D.T. = 4.5004' @ NESC 250S, INITIAL	D.T. = 4.5004' @ NESC 250S, INITIAL	D.T. = 4.5004' @ NESC 250S, INITIAL	D.T. = 4.5004' @ NESC 250S, INITIAL	D.T. = 4.5004' @ NESC 250S, INITIAL	D.T. = 4.5004' @ NESC 250S, INITIAL
161KV CONDUCTOR, 755 KCMIL 267 ACSR STRANKE	R.S. = 777'	R.S. = 300'	R.S. = 907'	R.S. = 907'	R.S. = 907'	R.S. = 907'	R.S. = 907'
D.T. = 10.0004' @ NESC 250S, INITIAL	D.T. = 7.8754' @ NESC 250S, INITIAL	D.T. = 10.0004' @ NESC 250S, INITIAL	D.T. = 10.0004' @ NESC 250S, INITIAL	D.T. = 10.0004' @ NESC 250S, INITIAL	D.T. = 10.0004' @ NESC 250S, INITIAL	D.T. = 10.0004' @ NESC 250S, INITIAL	D.T. = 10.0004' @ NESC 250S, INITIAL

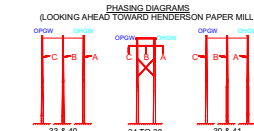

- PRELIMINARY
- FOR BID
- FOR CONSTRUCTION
- FOR RECORD
- AS BUILT
-

- LEGEND
- NEW POLE
 - DOWN GLY
 - EXISTING POLE
 - EXISTING OH LINE
 - FENCE
 - EASEMENT
 - PROPERTY LINE
 - DITCH/STREAM
 - * VIBRATION DAMPER

REV	DATE	DRFT	ENGR	REVISION DESCRIPTION
1	11/15/2022		ABG	ISSUED FOR CONSTRUCTION
2	04/03/2023		ABG	AS-BUILT

Big Rivers
ELECTRIC CORPORATION

SOUTH HENDERSON - HENDERSON PAPER MILL 161KV LINE 16 - C

W.D. _____ DATE _____
SCALE: _____ DRAWN: _____ DATE _____
ENGINEER: _____ PROJECT NUMBER: _____
CHECKED: _____ SHEET: 7 OF 8

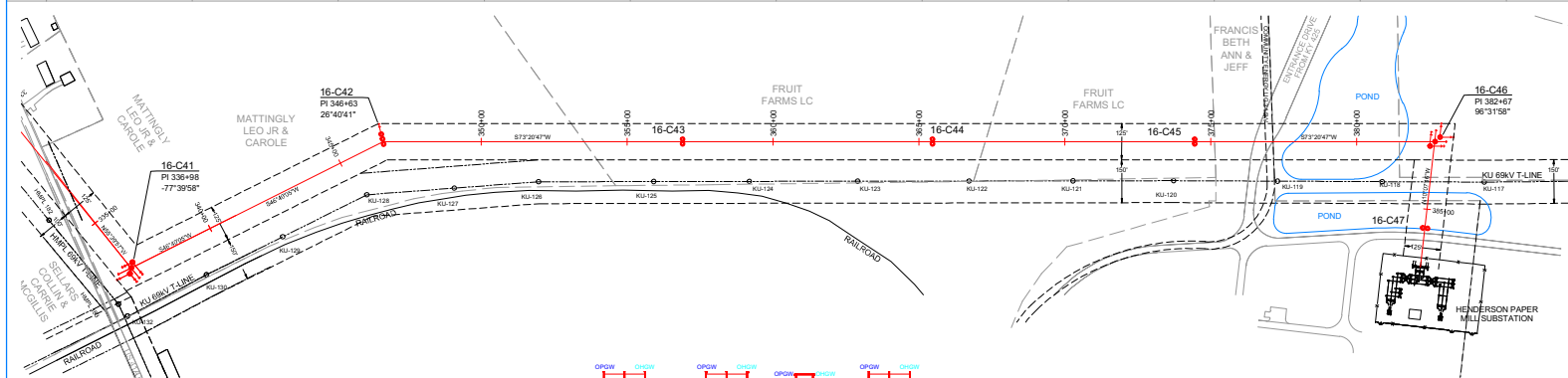
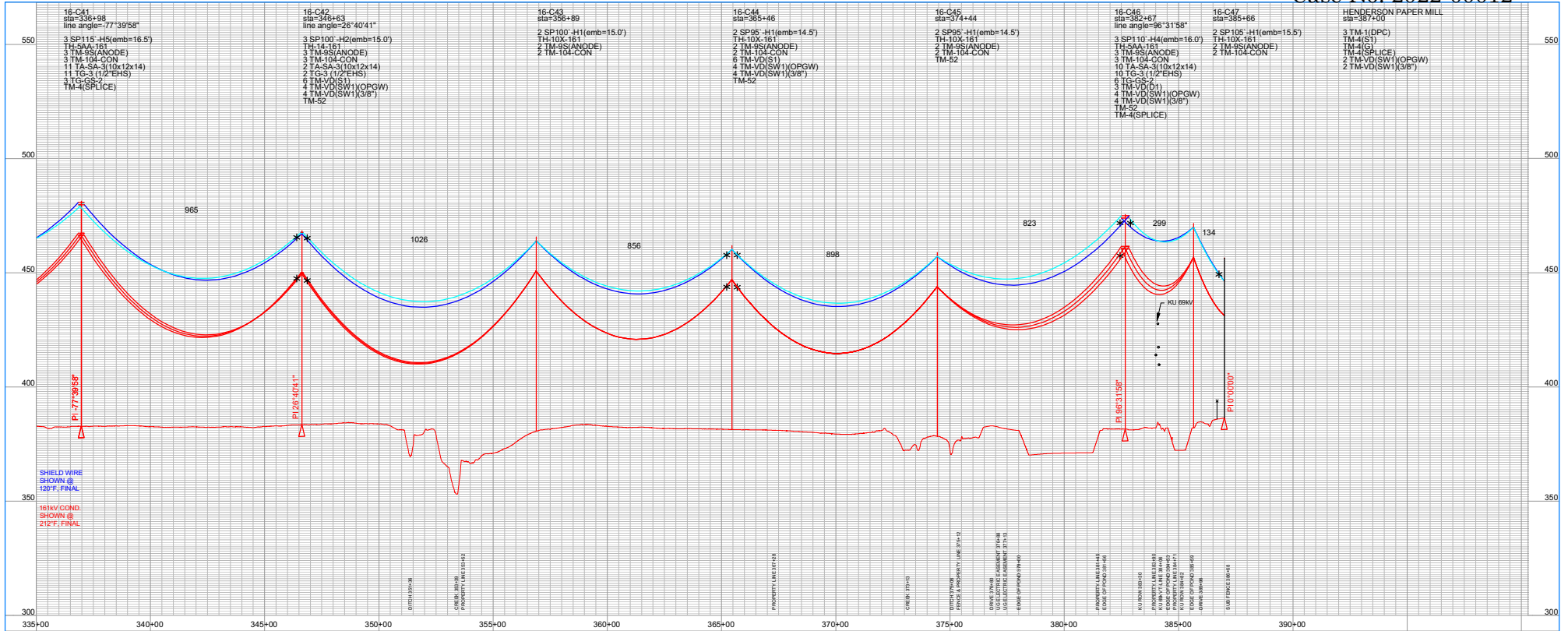

CABLE DATA (LOADING: HEAVY DISTRICT 12" ICE, 4LBS WIND @ 0°F)

16-C41 TO 16-C42	16-C46 TO 16-C47
R.S. = 931°	R.S. = 242°
D.T. = 4.600F @ NESG	D.T. = 1.5754 @ NESG
2508. INITIAL	2952. INITIAL
R.S. = 529°	R.S. = 272°
D.T. = 6.500F @ NESG	D.T. = 2.950F @ NESG
3009. INITIAL	2909. INITIAL
R.S. = 523°	R.S. = 257°
D.T. = 10.000F @ NESG	D.T. = 2.890F @ NESG
2908. INITIAL	

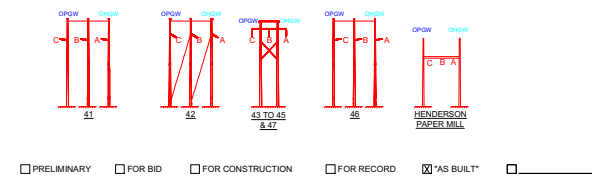

LEGEND

- NEW POLE
- DOWN GLY
- EXISTING POLE
- EXISTING OH LINE
- FENCE
- EASEMENT
- PROPERTY LINE
- DITCH/STREAM
- VIBRATION DAMPER

REV	DATE	DRFT	ENGR	REVISION DESCRIPTION
0	04/20/2022	ABG	ABG	ISSUED FOR CONSTRUCTION
1	11/10/2022	ABG	ABG	AS-BUILT



SOUTH HENDERSON - HENDERSON PAPER MILL 161KV LINE 16 - C

W.D.	DATE	SCALE	16 - C
ENGINEER	DRAWN	DATE	11/10/2022



In the Matter of:

ELECTRONIC APPLICATION OF)	
BIG RIVERS ELECTRIC CORPORATION)	
FOR A CERTIFICATE OF PUBLIC)	Case No.
CONVENIENCE AND NECESSITY TO)	2022-00012
CONSTRUCT A 161 KV TRANSMISSION LINE IN)	
HENDERSON COUNTY, KENTUCKY)	

CONFIDENTIAL INFORMATION
STATION AS BUILT DRAWINGS

Filed Pursuant to Ordering Paragraph No. 7 of
Commission's June 6, 2022 Order

**STATION DRAWINGS SUBMITTED WITH
MOTION FOR CONFIDENTIAL TREATMENT**

