

**COMMONWEALTH OF KENTUCKY
BEFORE THE KENTUCKY STATE BOARD
ON ELECTRIC GENERATION AND TRANSMISSION SITING**

In the Matter of the Application of SR Turkey Creek,)
LLC (f/k/a Turkey Creek Solar, LLC), for a) **Case No. 2020-00040**
Construction Certificate to Construct a Merchant)
Electric Generating Facility

NOTICE OF FILING

SR Turkey Creek, LLC (f/k/a Turkey Creek Solar, LLC) (“Turkey Creek”), by counsel, hereby provides notice that it is filing its final site layout plan.

In its Order dated September 23, 2020, the Siting Board required Turkey Creek to comply with the following mitigation measure: “a final site layout plan shall be submitted to the Siting Board. Material deviations from the preliminary site layout plan which formed the basis for the instant review shall be clearly indicated on the revised graphic.” In compliance with this Order, Turkey Creek is filing its final site layout plan, which is attached hereto as Exhibit 1. A comparison of the final plan and the preliminary site layout plan that was submitted with the Application and attached hereto as Exhibit 2 reveals that there are no material deviations. Turkey Creek further confirms that there is no change in Turkey Creek’s boundaries from the information that formed the basis of the Siting Board’s decision.

Respectfully submitted,

/s/ M. Todd Osterloh

STURGILL, TURNER, BARKER & MOLONEY, PLLC

JAMES W. GARDNER

M. TODD OSTERLOH

333 W. Vine Street, Suite 1500

Lexington, Kentucky 40507

Telephone No. (859) 255-8581

Fax No. (859) 231-0851

tosterloh@sturgillturner.com

jgardner@sturgillturner.com

ATTORNEYS FOR SR TURKEY CREEK, LLC

1602546

Exhibit 1

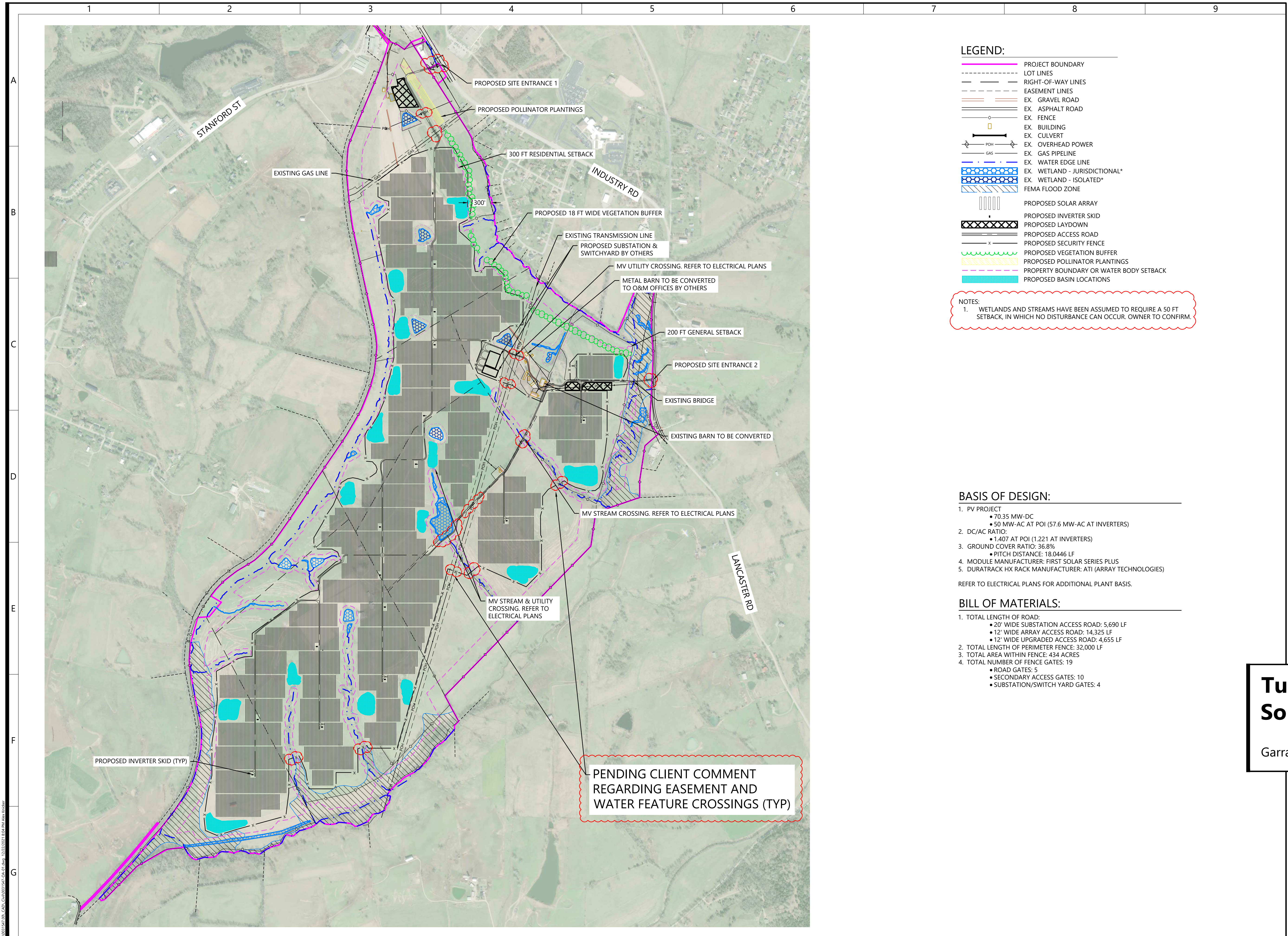

- LEGEND:**
- PROJECT BOUNDARY
 - LOT LINES
 - RIGHT-OF-WAY LINES
 - EASEMENT LINES
 - EX. GRAVEL ROAD
 - EX. ASPHALT ROAD
 - EX. FENCE
 - EX. BUILDING
 - EX. CULVERT
 - EX. OVERHEAD POWER
 - EX. GAS PIPELINE
 - EX. WATER EDGE LINE
 - EX. WETLAND - JURISDICTIONAL*
 - EX. WETLAND - ISOLATED*
 - FEMA FLOOD ZONE
 - PROPOSED SOLAR ARRAY
 - PROPOSED INVERTER SKID
 - PROPOSED LAYDOWN
 - PROPOSED ACCESS ROAD
 - PROPOSED SECURITY FENCE
 - PROPOSED VEGETATION BUFFER
 - PROPOSED POLLINATOR PLANTINGS
 - PROPERTY BOUNDARY OR WATER BODY SETBACK
 - PROPOSED BASIN LOCATIONS

NOTES:
 1. WETLANDS AND STREAMS HAVE BEEN ASSUMED TO REQUIRE A 50 FT SETBACK, IN WHICH NO DISTURBANCE CAN OCCUR. OWNER TO CONFIRM.

- BASIS OF DESIGN:**
1. PV PROJECT
 - 70.35 MW-DC
 - 50 MW-AC AT POI (57.6 MW-AC AT INVERTERS)
 2. DC/AC RATIO:
 - 1.407 AT POI (1.221 AT INVERTERS)
 3. GROUND COVER RATIO: 36.8%
 - PITCH DISTANCE: 18,0446 LF
 4. MODULE MANUFACTURER: FIRST SOLAR SERIES PLUS
 5. DURATRACK HX RACK MANUFACTURER: ATI (ARRAY TECHNOLOGIES)
- REFER TO ELECTRICAL PLANS FOR ADDITIONAL PLANT BASIS.

- BILL OF MATERIALS:**
1. TOTAL LENGTH OF ROAD:
 - 20' WIDE SUBSTATION ACCESS ROAD: 5,690 LF
 - 12' WIDE ARRAY ACCESS ROAD: 14,325 LF
 - 12' WIDE UPGRADED ACCESS ROAD: 4,655 LF
 2. TOTAL LENGTH OF PERIMETER FENCE: 32,000 LF
 3. TOTAL AREA WITHIN FENCE: 434 ACRES
 4. TOTAL NUMBER OF FENCE GATES: 19
 - ROAD GATES: 5
 - SECONDARY ACCESS GATES: 10
 - SUBSTATION/SWITCH YARD GATES: 4

PENDING CLIENT COMMENT REGARDING EASEMENT AND WATER FEATURE CROSSINGS (TYP)

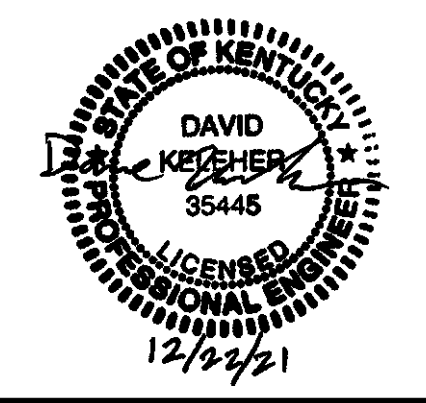

REVISIONS:

#	DATE	COMMENT
0	12/22/21	ISSUED FOR CONSTRUCTION

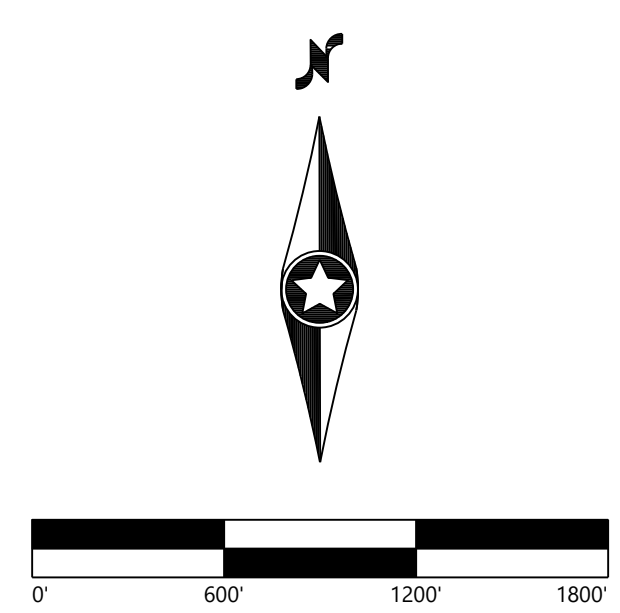

Turkey Creek Solar
 Garrard County, KY

Overall Site Plan

FOR CONSTRUCTION WITH EXCEPTION OF CLOUDED HOLDS

DATE: 12/22/2021
 SHEET: C.102

12/22/2021 10:00 AM C:\Users\jgibson\OneDrive\Documents\12222021\1000\1000.dwg 12/22/2021 10:00 AM jgibson

Exhibit 2



Drawing Legend	
	Potential Project Footprint
	Wetland Features
	Utility Easement
	Water Features
	Array Area
	Parcel Boundary
	Fence Boundary
	Access Roads
	Vegetative Buffer

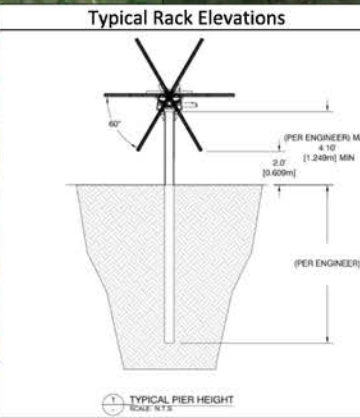

Standard Notes

- (1) The Purpose of this plan is for a Power Generation Permit for review and approval by the Kentucky State Siting Board to construct a solar energy system. All information shown is for planning purposes only.
- (2) The property lines, existing improvements, and topographic data shown hereon are not based on a field survey and have been completed from ArcGIS & Google Earth Imagry. No field evidence of property markers were located with this Exhibit.
- (3) Wetlands and Streams are shown representative of a delineation received by Carolina Solar Energy.
- (4) Project area will be cleared and grubbed as necessary, retaining pre-development drainage patterns as much as possible. Minor grading will occur around inverter areas to divert surface drainage. Areas subject to rutting during construction will be temporarily stabilized with gravel that will remain after construction. Soil conditions and equipment loads will determine final design.
- (5) Proposed construction and temporary laydown yard/construction staging area to be used during site construction. A portion of this area will be covered with gravel to allow delivery of construction materials. Prior to construction, this area will be compacted by a smooth drum or sheepfoot roller to reduce/prevent rutting. Following construction gravel laydown yard will be removed.
- (6) Access aisles shown on this plan indicate construction and maintenance access points for ingress/egress. Prior to construction, these aisles are compacted by a smooth drum or sheepfoot roller to reduce/prevent rutting. Gravel may be placed in high traffic or poorly draining areas during construction activities to improve access. Soil access aisle will be scarified, aerated, and re-seeded after construction. Access aisles to inverters may require gravel to support delivery equipment loads. Soil conditions and final equipment selection will determine if gravel access aisles will be required to inverter locations
- (7) All Right-Of-Ways are public unless noted otherwise.
- (8) Utility lines and services shown hereon are approximate per aerial photography or as reported by various responsible parties. Location of underground utilities are not shown. Call appropriate authorities before digging.
- (9) No lighting is proposed for the array area. The Interconnection Substation will have some lighting.
- (10) 6' tall chain link fence with three strands of barbed wire or similar to meet National Electric Code requirements. The proposed access gate will be locked with a standard keyed or combination lock. Emergency personnel will be provided a key or combination for access.

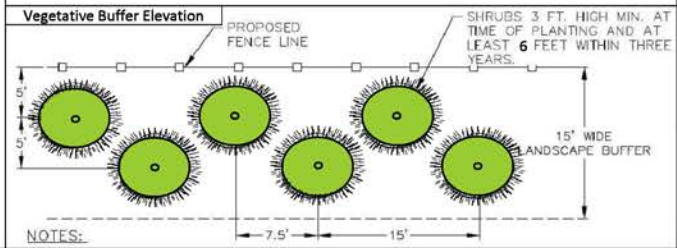

Carolina Solar Energy
400 W. Main St.
Durham, NC 27701
Suite 503

Turkey Creek Farm
50 MWAC

ISSUE
11.25.19
12.04.19
12.08.19

PROJECT
Turkey Creek

DRAWN BY
CI

DESCRIPTION
Array Layout