



ANDY BESHEAR
GOVERNOR

TRANSPORTATION CABINET
DEPARTMENT OF HIGHWAYS DISTRICT 1 OFFICE
5501 KENTUCKY DAM ROAD
PADUCAH, KY. 42003
PHONE: (270) 898-2431 FAX: (270) 898-7457
WWW.TRANSPORTATION.KY.GOV/

JIM GRAY
SECRETARY

June 15, 2020

SUBJECT: McCracken County 073
US 60 (Mile Post 7.81 7.92)
Permit Number: 01-2020-00140

Mr. Grissom,
Your application for an encroachment permit has been approved by the Department of Highways. A copy must be given to the party responsible for completing the project and must be kept at the jobsite at all times.

Please see that the work is done in strict conformity with the permit and any other applicable conditions (if there is any other attached documents, conditions or specifications). The work should be completed no later than 1 year from this date. **Please call Eddie Holland (contact info listed below) for a pre pour inspection 24 hrs. in advance.**

If there are any questions regarding this permit, please do not hesitate to contact Eddie Holland, Transportation Engineering Tech. III @ eddie.holland@ky.gov (270) 898-2431, or fax number (270) 898-7457

Sincerely,

Kyle Poat, P.E.
Chief District Engineer
Department of Highways
District 1 – Paducah
5501 Kentucky Dam Road
Paducah, Ky. 42003



Kentucky Transportation Cabinet
 Department of Highways
 Division of Maintenance
 Permits Branch

ENCROACHMENT PERMIT

KYTC KEPT #: 01-2020-00140

Permittee: JPEC

Permit Type / Subtype: Entrance / Commercial

Work Completion Date: 6/1/2021

INDEMNITIES		
Type	Amount Required	Tracking Number
Performance Bond	\$0.00	
Cash / Check	\$0.00	
Self-Insured	\$15,000.00	0027216
Payment Bond	\$0.00	
Liability Insurance	\$0.00	

This permit has been: **APPROVED** **DENIED**

Kyle Poat	D1 - Chief District Engineer	6/15/2020
SIGNATURE	TITLE	DATE

The TC 99-1(B), including the application TC-99 1(A) and all related and accompanying documents and drawings make up the permit. It is not a permit unless both the TC 99-1(A) and TC 99-1(B) are both present.

LOCATION(S)			
Description	County - Route	Latitude	Longitude
7.81	McCracken - US 60	37.072408	-88.731369
7.92	McCracken - US 60	37.071985	-88.729430



To Submit a Locate Request
 24 Hours a Day, Seven Days a Week:
 Call 811 or 800-752-6007



APPLICATION FOR ENCROACHMENT PERMIT

KYTC KEPT #: 01-2020-00140

SECTION 1: APPLICANT CONTACT INFORMATION

APPLICANT Jackson Purchase Energy Cooperative	ADDRESS 2900 Irvin Cobb Drive	CITY Paducah	
EMAIL		STATE KY	ZIP 42003
CONTACT NAME 1 Greg Grissom	EMAIL greg.grissom@jpenergy.com	PHONE # 270-442-7321	CELL #
CONTACT NAME 2 (if applicable)	EMAIL	PHONE #	CELL #

SECTION 2: PROPOSED WORK LOCATION

ADDRESS 6525 U.S. 60	CITY Paducah	STATE Kentucky	ZIP 42001
COUNTY McCracken	ROUTE # US 60	MILE POINT 7.81 left/7.92 left	LONGITUDE (X) -88.73134
			LATITUDE (Y) 37.07268°

ADDITIONAL LOCATION INFORMATION:

FOR KYTC USE ONLY

PERMIT TYPE: Air Right Entrance Utilities Vegetation Removal Other: _____

ACCESS: Full Partial by Permit **LOCATION:** Left Right Crossing

SECTION 3: GENERAL DESCRIPTION OF WORK

MP 7.81 - Construction of a new 3-lane (36' wide) concrete paved entrance.

MP 7.92 - Construction of a new right turn in - right turn out concrete paved entrance with traffic island.

A required minimum site distance of 610 FT for a speed limit of 55 mph was verified for the East entrance. The total site distance to the East, for the westbound lane, is approximately 1000 FT.

THE UNDERSIGNED APPLICANT(s), being duly authorized representative(s) or owner(s), DO AGREE TO ALL ORIGINAL UNEDITED TERMS AND CONDITIONS ON THE TC 99-1A, pages 1-4.

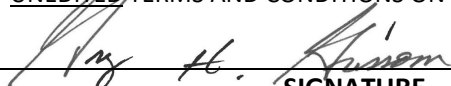

 SIGNATURE

06/12/2020

 DATE

This is not a permit unless and until the applicant(s) receives an approved TC 99-1B from KYTC. This application shall become void if not approved by the cancellation date. The cancellation date shall be a minimum of one year from the date the applicant submits their application.

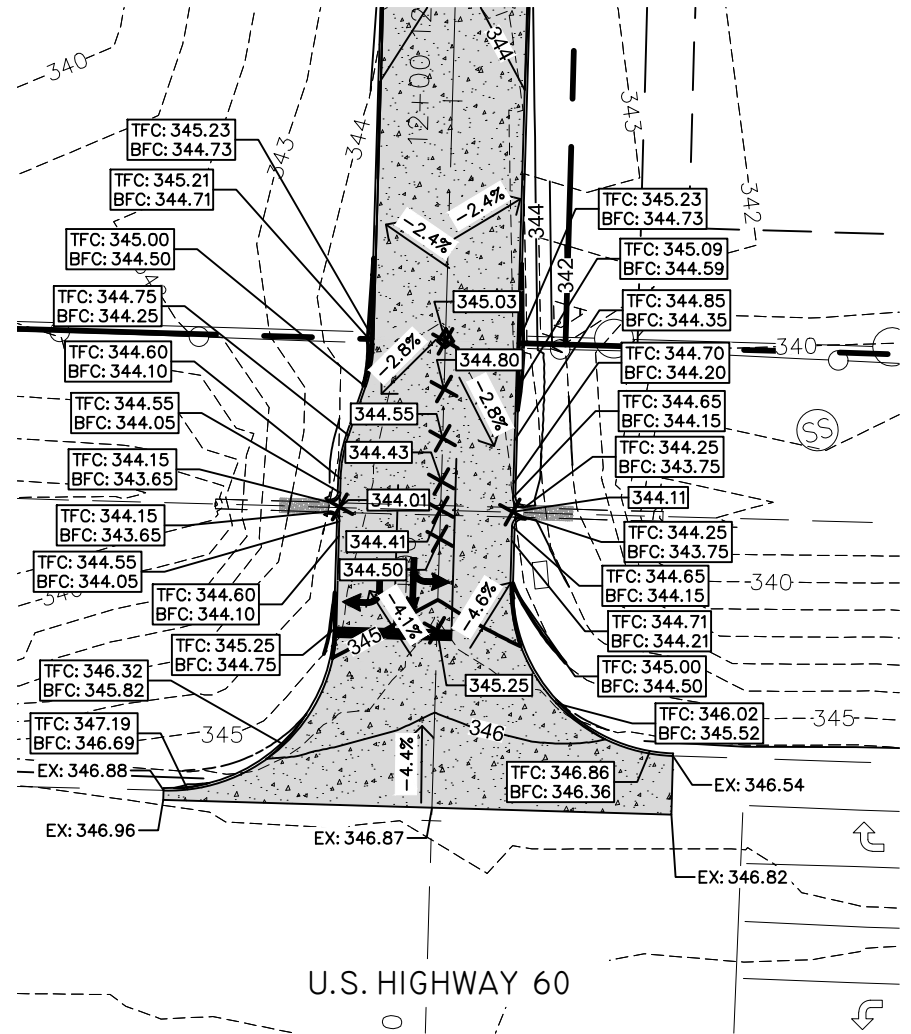
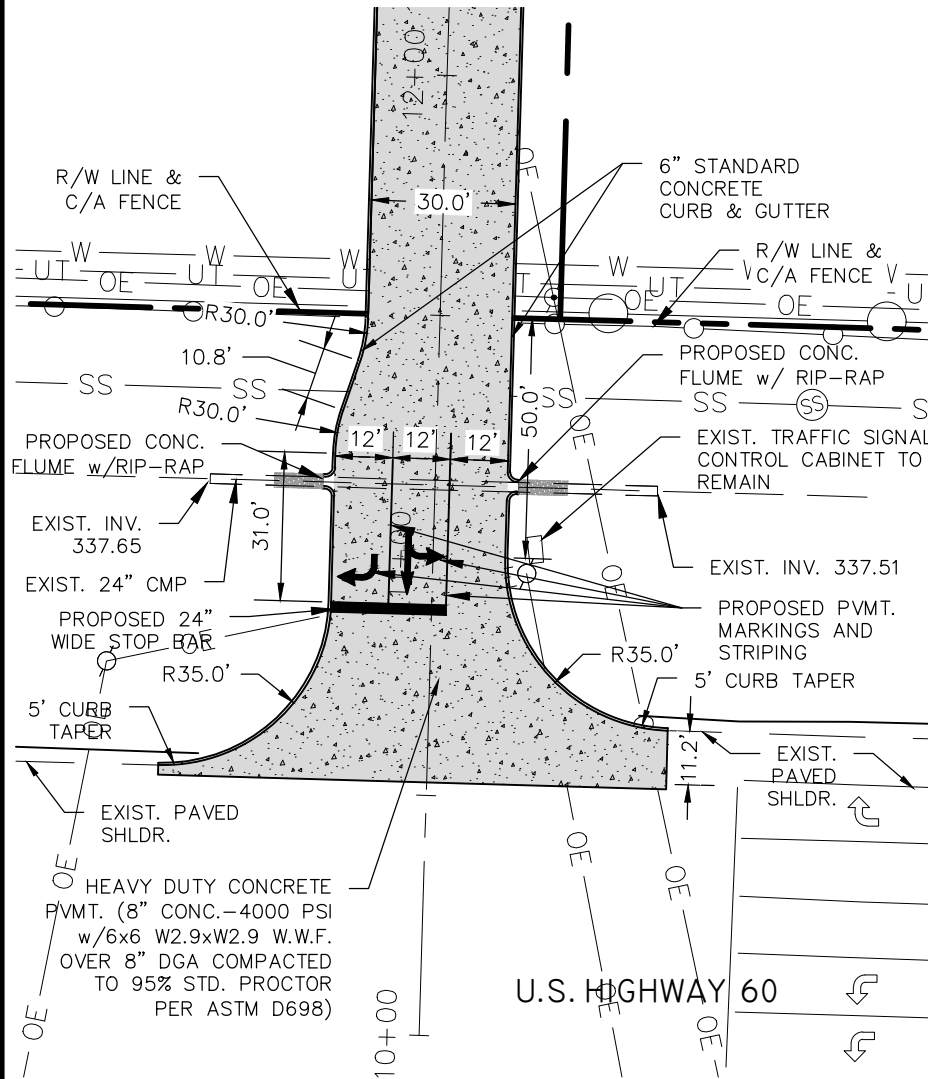

BFW BACON | FARMER | WORKMAN
ENGINEERING & TESTING, INC.

500 SOUTH 17th STREET
PADUCAH, KY 42003
PHONE: 270.443.1995

403 N. COURT STREET
MARION, IL 62959
PHONE: 618.997.9190

1215 DIUGUID DRIVE
MURRAY, KY 42071
PHONE: 270.753.7307

966 DOUBLE BRIDGE RD.
LEWISBURG, TN 37091
PHONE: 931.359.4882

907 ARROW RD., SUITE 2
CHAMPAIGN, IL 61821
PHONE: 217.530.4283

www.bfwengineers.com
COPYRIGHT © 2017 - BACON FARMER WORKMAN ENGINEERING & TESTING, INC.

PROJECT NO.	19231
DATE:	JUNE 2020
DRAWN BY:	DRC
SCALE:	1" = 40'

U.S. 60 ENTRANCE - MP 7.81 LEFT

JACKSON PURCHASE ENERGY COOP
6525 U.S. HIGHWAY 60
PADUCAH, MCCRACKEN CO., KY 42001

SHEET
EXHIBIT
A
SHEET 1 OF 2

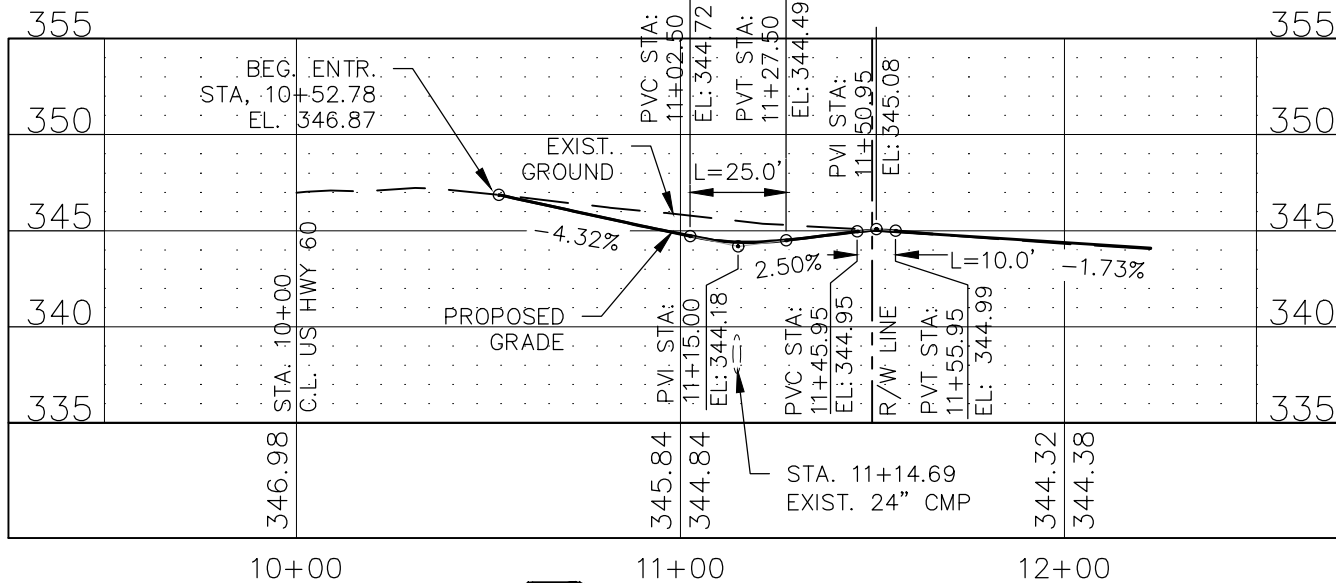

1 **ENTRANCE PROFILE**
SCALE: HORIZ. 1" = 50' VERT. 1" = 10'

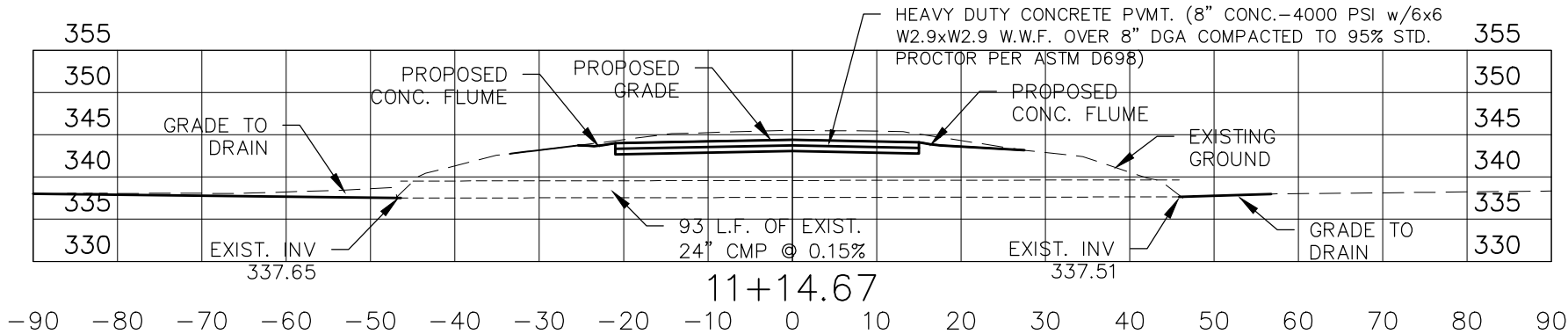

2 **ENTRANCE SECTION**
SCALE: 1" = 20'

BFW **BACON | FARMER | WORKMAN**
ENGINEERING & TESTING, INC.

500 SOUTH 17th STREET
PADUCAH, KY 42003
PHONE: 270.443.1995

403 N. COURT STREET
MARION, IL 62959
PHONE: 618.997.9190

1215 DIUGUID DRIVE
MURRAY, KY 42071
PHONE: 270.753.7307

966 DOUBLE BRIDGE RD.
LEWISBURG, TN 37091
PHONE: 931.359.4882

907 ARROW RD., SUITE 2
CHAMPAIGN, IL 61821
PHONE: 217.530.4283

www.bfwengineers.com
COPYRIGHT © 2017 - BACON FARMER WORKMAN ENGINEERING & TESTING, INC.

PROJECT NO.
19231

DATE:
JUNE 2020

DRAWN BY:
DRC

SCALE:
AS NOTED

U.S. 60 ENTRANCE - MP 7.81 LEFT

JACKSON PURCHASE ENERGY COOP
6525 U.S. HIGHWAY 60
PADUCAH, McCRACKEN CO., KY 42001

SHEET
EXHIBIT
A
SHEET 2 OF 2

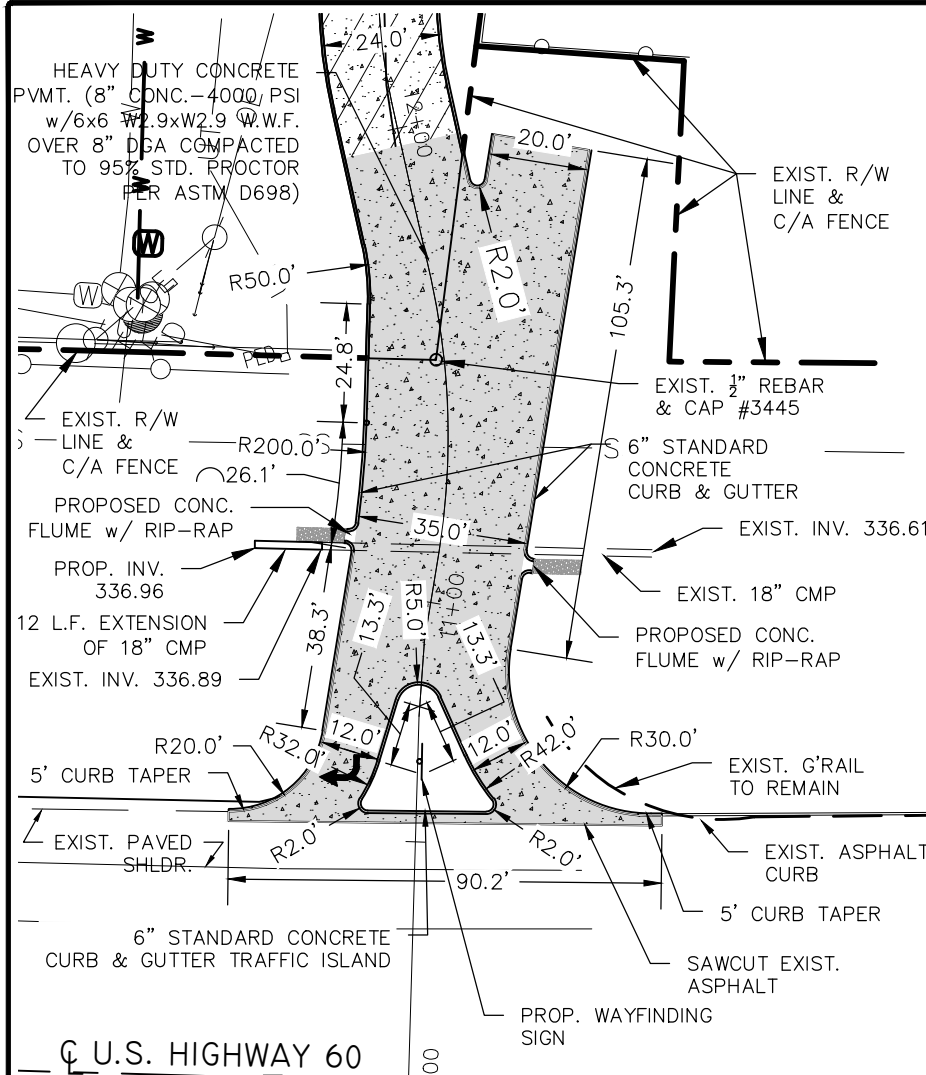

1 ENTRANCE PLAN
SCALE: 1" = 40'

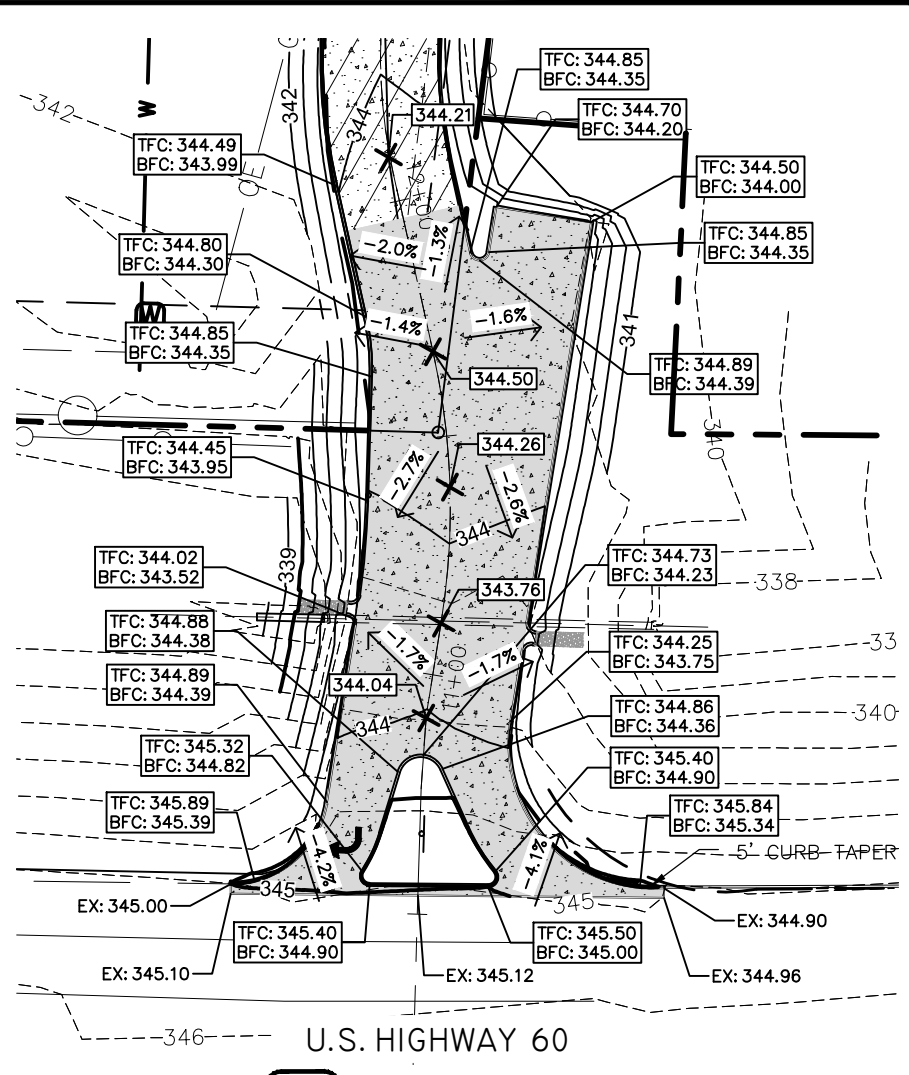

2 GRADING PLAN
SCALE: 1" = 40'



BFW BACON | FARMER | WORKMAN
ENGINEERING & TESTING, INC.

500 SOUTH 17th STREET
PADUCAH, KY 42003
PHONE: 270.443.1995

403 N. COURT STREET
MARION, IL 62959
PHONE: 618.997.9190

1215 DIUGUID DRIVE
MURRAY, KY 42071
PHONE: 270.753.7307

968 DOUBLE BRIDGE RD.
LEWISBURG, TN 37091
PHONE: 931.359.4882

907 ARROW RD., SUITE 2
CHAMPAIGN, IL 61821
PHONE: 217.530.4283

www.bfwengineers.com COPYRIGHT © 2017 - BACON FARMER WORKMAN ENGINEERING & TESTING, INC.

PROJECT NO.
19231

DATE:
JUNE 2020

DRAWN BY:
DRC

SCALE:
1" = 40'

U.S. 60 ENTRANCE - MP 7.92 LEFT

JACKSON PURCHASE ENERGY COOP
6525 U.S. HIGHWAY 60
PADUCAH, MCCrackEN CO., KY 42001

SHEET
EXHIBIT
B
SHEET 1 OF 2

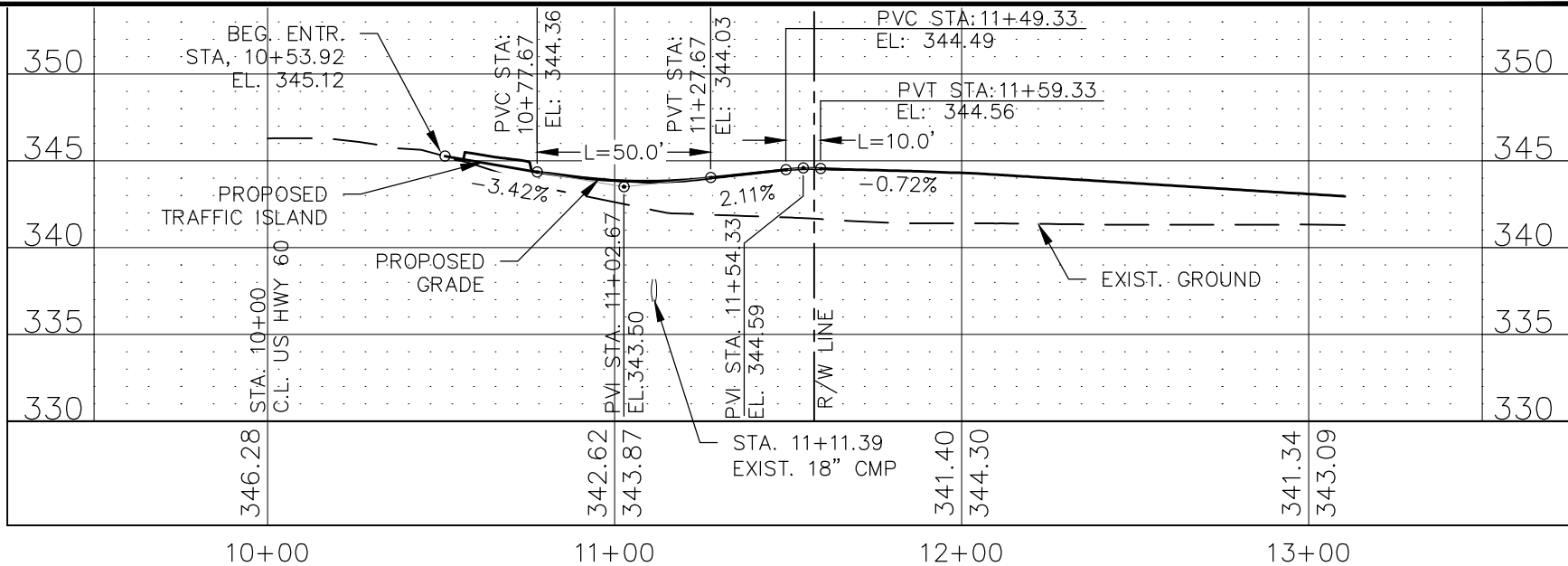

1 ENTRANCE PROFILE
SCALE: HORIZ. 1" = 50' VERT. 1" = 10'

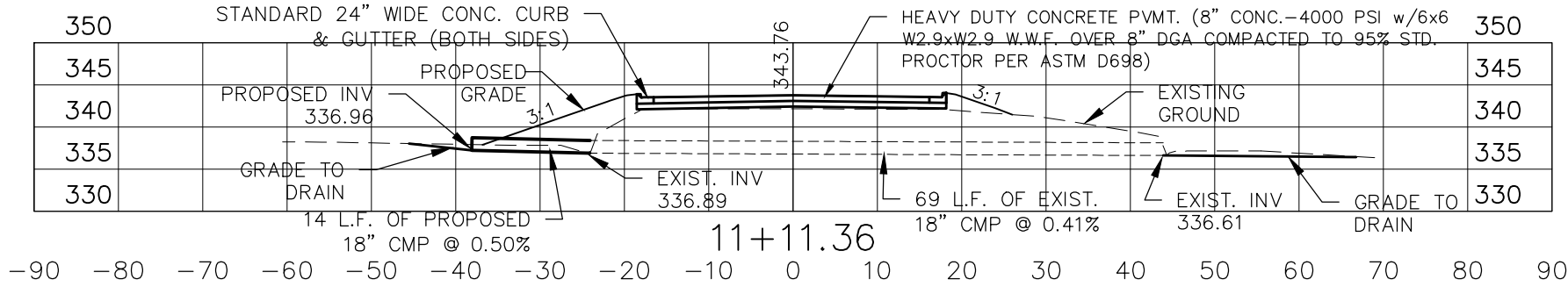

2 ENTRANCE PIPE SECTION
SCALE: 1" = 20'

BFW BACON | FARMER | WORKMAN
ENGINEERING & TESTING, INC.

500 SOUTH 17th STREET
PADUCAH, KY 42003
PHONE: 270.443.1995

403 N. COURT STREET
MARION, IL 62959
PHONE: 618.997.9190

1215 DIUGUID DRIVE
MURRAY, KY 42071
PHONE: 270.753.7307

966 DOUBLE BRIDGE RD.
LEWISBURG, TN 37091
PHONE: 931.359.4882

907 ARROW RD., SUITE 2
CHAMPAIGN, IL 61821
PHONE: 217.530.4283

www.bfwengineers.com COPYRIGHT © 2017 - BACON FARMER WORKMAN ENGINEERING & TESTING, INC.

PROJECT NO.
19231

DATE:
JUNE 2020

DRAWN BY:
DRC

SCALE:
AS NOTED

U.S. 60 ENTRANCE - MP 7.81 LEFT

JACKSON PURCHASE ENERGY COOP
6525 U.S. HIGHWAY 60
PADUCAH, MCCRACKEN CO., KY 42001

SHEET
EXHIBIT
B
SHEET 2 OF 2