



Brian Jones <drakesborogas@gmail.com>

Center Messages

1 message

Wed, Feb 1, 2023 at 12:17 AM

ky@ocinc.com <ky@ocinc.com>
To: drakesboro@comcast.net, drakesborogas@gmail.com

Kentucky 811

SUMM

DAILY AUDIT OF TICKETS SENT ON 01/31/23

Date/Time: 02/01/2023 01:15:32 AM

Receiving Terminal: 0032

Seq #	Ticket #	Seq #	Ticket #
-----	-----	-----	-----

* Indicates ticket # is repeated

Total Tickets: 0

Please call (573) 636-1556 if this data does not match the tickets you received on 01/31/23

COMPLETED

BY: HS Date: 2-1-23



Brian Jones <drakesborogas@gmail.com>

Center Messages

1 message

ky@occin.com <ky@occin.com>
To: drakesboro@comcast.net, drakesborogas@gmail.com

Thu, Feb 2, 2023 at 12:17 AM

Kentucky 811

SUMM

DAILY AUDIT OF TICKETS SENT ON 02/01/23

Date/Time: 02/02/2023 01:15:34 AM

Receiving Terminal: 0032

Seq #	Ticket #	Seq #	Ticket #
1	230320194-NORM		

* indicates ticket # is repeated

Total tickets: 1

NORM - NORMAL

1

Please call (573) 636-1556 if this data does not match the tickets you received on 02/01/23

COMPLETE
BY: BS
Date: 2-2-22

2/1/2023 7:32 AM

ky@occing.com

NORMAL 230320194

To drakesboro@comcast.net • drakesborogas@gmail.com

Ticket No: 230320194
District Code: 0032
Request Date: 02/01/23 8:31 AM EST
Begin Date: 02/06/23 8:00 AM EST

Location Info:
County: MUHLENBERG
Address/Street: PARKER ST
Intersecting: BIG SPRINGS RD
Subdivision:
Location Info: FROM THE INTERSECTION OF BIG SPRINGS RD AND PARKER ST, TRAVEL 200FT SOUTHWEST ON PARKER ST. FROM THIS POINT, MARK PARKER ST CURB TO CURB, AND EXTENDING 20FT OFF EACH CURB FOR 100FT SOUTHWEST.

Comments:
0032 Map: VIEW EXCAVATION AREA AND FACILITY MAP FOR 0032
Attachment(s): NO
NW Lat/Lon: 37.2242079, -87.0557099
Contact Name: DONALD SIMS
Email: mulhembergwate@gmail.com
Requested By: DONALD SIMS
Excavator: MUHLENBERG COUNTY WATER DISTRI
Address: P.O. BOX 348
 GREENVILLE, KY 42345

Type of Work: REPAIR WATER MAIN
Explosives: NO
Area Marked: YES
Work Done For: MUHLENBERG COUNTY WATER DISTRI

District: 0139
Company Name: CITY OF DRAKESBORO
AT&T DISTRIBUTION

Utility Type: S,W,G COMMUNICATIONS
Depth: 5 FT
Job #:

Map Information
0032 Map: VIEW EXCAVATION AREA AND FACILITY MAP FOR 0032
Attachment(s): NO
NW Lat/Lon: SE Lat/Lon: 37.2237838, -87.0551456
Contact Information
Contact Name: DONALD SIMS
Email: mulhembergwate@gmail.com
Requested By: DONALD SIMS
Excavator Information
Excavator: MUHLENBERG COUNTY WATER DISTRI
Address: P.O. BOX 348
 GREENVILLE, KY 42345
Excavation Information
Type of Work: REPAIR WATER MAIN
Explosives: NO
Area Marked: YES
Work Done For: MUHLENBERG COUNTY WATER DISTRI

Flagged & Printed
 2-1-2023
 BSA & BS

COMPLETED
 2-1-23
 Date: 2/1/23



Brian Jones <drakesborogas@gmail.com>

Center Messages

1 message

Fri, Feb 3, 2023 at 12:18 AM

ky@ocinc.com <ky@ocinc.com>
To: drakesboro@comcast.net, drakesborogas@gmail.com

Kentucky 811

SUMM

DAILY AUDIT OF TICKETS SENT ON 02/02/23

Date/Time: 02/03/2023 01:15:34 AM

Receiving Terminal: 0032

Seq #	Ticket #	Seq #	Ticket #
-----	-----	-----	-----

* indicates ticket # is repeated

Total Tickets: 0

Please call (573) 636-1556 if this data does not match the tickets you received on 02/02/23

COMPLETED
BY BS
Date 2-2-23



Brian Jones <drakesborogas@gmail.com>

Center Messages

1 message

ky@ocinc.com <ky@ocinc.com>
To: drakesboro@comcast.net, drakesborogas@gmail.com

Kentucky 811

SUMM

DAILY AUDIT OF TICKETS SENT ON 02/03/23

Date/Time: 02/04/2023 01:15:32 AM

Receiving Terminal: 0032

Seq #	Ticket #	Seq #	Ticket #
-----	-----	-----	-----

* Indicates ticket # is repeated

Total Tickets: 0

Please call (573) 636-1556 if this data does not match the tickets you received on 02/03/23

COMPLETED

BY: BS

DATE:

2-3-2023

Sat, Feb 4, 2023 at 12:17 AM



Brian Jones <drakesborogas@gmail.com>

Center Messages

1 message

Sun, Feb 5, 2023 at 12:17 AM

ky@ocinc.com <ky@ocinc.com>
To: drakesboro@comcast.net, drakesborogas@gmail.com

Kentucky 811

SUMM
DAILY AUDIT OF TICKETS SENT ON 02/04/23

Date/Time: 02/05/2023 01:15:25 AM

Receiving Terminal: 0032

Seq #	Ticket #	Seq #	Ticket #
-----	-----	-----	-----

* Indicates ticket # is repeated

Total Tickets: 0

Please call (573) 636-1556 if this data does not match the tickets you received on 02/04/23

COMPLETED
By: BJ Date: 2-4-2023



Brian Jones <drakesborogas@gmail.com>

Center Messages

1 message

ky@ocinc.com <ky@ocinc.com>

To: drakesboro@comcast.net, drakesborogas@gmail.com

Kentucky 811

SUMM

DAILY AUDIT OF TICKETS SENT ON 02/05/23

Date/Time: 02/06/2023 01:15:24 AM

Receiving Terminal: 0032

Seq #	Ticket #	Seq #	Ticket #
-----	-----	-----	-----

* Indicates ticket # is repeated

Total Tickets: 0

Please call (573) 636-1556 if this data does not match the tickets you received on 02/05/23

COMPLETE
2-6-23
BY [Signature]
Date: _____



Brian Jones <drakesborogas@gmail.com>

Center Messages

1 message

Tue, Feb 7, 2023 at 12:17 AM

ky@occlnc.com <ky@occlnc.com>
To: drakesboro@comcast.net, drakesborogas@gmail.com

Kentucky 811

SUMM

DAILY AUDIT OF TICKETS SENT ON 02/06/23

Date/Time: 02/07/2023 01:15:43 AM

Receiving Terminal: 0032

Seq #	Ticket #	Seq #	Ticket #
-----	-----	-----	-----

* Indicates ticket # is repeated

Total tickets: 0

Please call (573) 636-1556 if this data does not match the tickets you received on 02/06/23

COMPLETED
BY BT
Date: 2-7-2023

2/8/2023 10:59 AM

ky@ocinc.com

NORMAL 230391045

To drakesboro@comcast.net • drakesborogas@gmail.com

NEW TICKET

Previous No:

Seq No: 5

Request By: WEB

Expires: 03/01/23 11:59 PM EST

Location Information

City: BEECHMONT

Lot:

FROM THE CENTERLINES OF US HWY 431 S AND MASONIC DR, HEAD NORTH-NORTHWEST ON US HWY 431 S FOR 335 FT. THEN FROM THE CENTERLINE OF US HWY 431 S, HEAD WSW FOR 142 FEET TO THE SITE ON THE WSW SIDE OF THE STREET. MARK ENTIRE PROPERTY, PAINT AND FLAG.

Begin Date: 02/11/23 8:00 AM EST

02/08/23 11:59 AM EST

District Code: 0032

230391045

Ticket No: 230391045

NORMAL

Request Date: 02/08/23 11:59 AM EST

02/11/23 8:00 AM EST

County: MUHLENBERG

2711 US HWY 431 S

Address/Street: MASONIC DR

Subdivision:

Location Info:

Comments:

0032 Map: VIEW EXCAVATION AREA AND FACILITY MAP FOR 0032

NO

Attachment(s):

37.1823074,-87.0331668

Contact Name: JEFF LONG

jefflong531@gmail.com

Requested By: SANDRA LONG

BURIAL TECH LLC

Excavator: 297 HIDDEN VALLEY RD

BEREA, KY 40403

Type of Work: COMCAST LINE BURIAL

NO

Explosives: YES

Area Marked: BURIAL TECH LLC

Work Done For:

District

0032

0072

0139

Company Name

CITY OF DRAKESBORO

COMCAST COMMUNICATIONS

AT&T DISTRIBUTION

Members Notified

Utility Type

S,W,G

TV,FO

COMMUNICATIONS

Depth: 1 FT

Job #:

Excavation Information

Excavator Information

Phone: (859)248-4591

Phone: (859)248-4591

Fax:

Phone: (859)248-4591

Contact Information

SE Lat/Lon: 37.1812885,-87.0318581

Map Information

VIEW EXCAVATION AREA AND FACILITY MAP FOR 0032

0032 Map: NO

Attachment(s):

NW Lat/Lon: 37.1823074,-87.0331668

Contact Name: JEFF LONG

Email: jefflong531@gmail.com

Requested By: SANDRA LONG

Excavator: 297 HIDDEN VALLEY RD

BEREA, KY 40403

Type of Work: COMCAST LINE BURIAL

NO

Explosives: YES

Area Marked: BURIAL TECH LLC

Work Done For:

District

0032

0072

0139

Company Name

CITY OF DRAKESBORO

COMCAST COMMUNICATIONS

AT&T DISTRIBUTION

Members Notified

Utility Type

S,W,G

TV,FO

COMMUNICATIONS

Depth: 1 FT

Job #:

Excavation Information

Excavator Information

Phone: (859)248-4591

Phone: (859)248-4591

Fax:

Phone: (859)248-4591

Contact Information

SE Lat/Lon: 37.1812885,-87.0318581

Map Information

VIEW EXCAVATION AREA AND FACILITY MAP FOR 0032

0032 Map: NO

Attachment(s):

NW Lat/Lon: 37.1823074,-87.0331668

Contact Name: JEFF LONG

Email: jefflong531@gmail.com

Requested By: SANDRA LONG

Excavator: 297 HIDDEN VALLEY RD

BEREA, KY 40403

Type of Work: COMCAST LINE BURIAL

NO

Explosives: YES

Area Marked: BURIAL TECH LLC

Work Done For:

NO GAS @ TROP
Banded
2/8/23

DATE: 2-8-2023
BY: BS
COMPLETED

2/8/2023 9:48 AM

ky@ocinc.com

NORMAL 230390802

To drakesboro@comcast.net • drakesborogas@gmail.com

NEW TICKET

Previous No: 1
 Seq No: 1
 Request By: WEB
 Expires: 03/01/23 11:59 PM EST

City: BEECHMONT

Location Information

MUHLENBERG
 3645 MERLE TRAVIS HWY
 BEECHMONT DR

Lot:

MARK ENTIRE PROPERTY, PAINT AND FLAG.

Map Information

VIEW EXCAVATION AREA AND FACILITY MAP FOR 0032

Ticket No: 230390802
 District Code: 0032
 Request Date: 02/08/23 10:48 AM EST
 Begin Date: 02/11/23 8:00 AM EST

County: MUHLENBERG
 Address/Street: 3645 MERLE TRAVIS HWY
 Intersecting: BEECHMONT DR
 Subdivision:
 Location Info: MARK ENTIRE PROPERTY, PAINT AND FLAG.

0032 Map:
 Attachment(s):
 NW Lat/Lon: 37.1729451, -87.0362719

Contact Name: JEFF LONG
 Email: jefflong531@gmail.com

Requested By: SANDRA LONG
 Excavator: BURIAL TECH LLC
 Address: 297 HIDDEN VALLEY RD
 BEREA, KY 40403

Excavator Information

Phone: (859)248-4591
 Fax:
 Phone: (859)248-4591

Excavation Information

Depth: 1 FT
 Job #:

Type of Work: COMCAST LINE BURIAL
 Explosives: NO
 Area Marked: YES
 Work Done For: BURIAL TECH LLC.

Members Notified

Company Name: CITY OF DRAKESBORO
 Members Notified: COMCAST COMMUNICATIONS
 Utility Type: S,W,G
 TV,FO
 COMMUNICATIONS

Flagged & painted
 2-8-2023
 B. Jones

COMPLETE
 2-8-23
 9:48 AM

2/8/2023 9:54 AM

ky@occing.com

NORMAL 230390838

To drakesboro@comcast.net • drakesborogas@gmail.com

Ticket No: 230390838	Request Date: 02/08/23 10:54 AM EST	Begin Date: 02/11/23 8:00 AM EST
District Code: 0032	Request By: WEB	Expires: 03/01/23 11:59 PM EST
Previous No: NEW TICKET	Seq No: 2	
Location Information	City: DRAKESBORO	
County: MUELLENBERG	Address/Street: 301 CARVER LN	
Intersecting: MERLE TRAVIS HWY	Subdivision:	
Location Info:	Lot:	
Comments:	FROM THE CENTERLINES OF CARVER LN AND MERLE TRAVIS HWY, HEAD WEST-NORTHWEST ON CARVER LN FOR 1636 FT. THEN FROM THE CENTERLINE OF CARVER LN, HEAD SSW FOR 271 FEET TO THE SITE ON THE SSW SIDE OF THE STREET. MARK ENTIRE PROPERTY, PAINT AND FLAG.	
0032 Map:	VIEW EXCAVATION AREA AND FACILITY MAP FOR 0032	
Attachment(s):	NO	
NW Lat/Lon:	37.1958679, -87.0786124	
Contact Name:	JEFF LONG	
Email:	jefflong531@gmail.com	
Requested By:	SANDRA LONG	
Excavator:	BURIAL TECH LLC	
Address:	297 HIDDEN VALLEY RD BEREA, KY 40403	
Type of Work:	COMCAST LINE BURIAL	
Explosives:	NO	
Area Marked:	YES	
Work Done For:	BURIAL TECH LLC.	
District: 0032	Company Name: CITY OF DRAKESBORO	Members Notified:
0139	AT&T DISTRIBUTION	Utility Type: S,W,G COMMUNICATIONS

Flagged & Painted
2-8-2023
RAH RSJ

COMPLETED
 BY: *RSJ*
 DATE: *2-8-23*

NORMAL 230390839

To drakesboro@comcast.net • drakesborogas@gmail.com

Ticket No:	230390839	Ticket Code:	0032
Request Date:	02/08/23 11:04 AM EST	Request By:	WEB
Begin Date:	02/11/23 8:00 AM EST	Expires:	03/01/23 11:59 PM EST
County:	MUHLENBERG	City:	DRAKESBORO
Address/Street:	355 CARVER LN	Subdivison:	MERLE TRAVIS HWY
Location Info:	THIS TICKET CONTAINS 2 PROPERTIES. THE FIRST PROPERTY IS 415 CARVER LN. MARK ENTIRE PROPERTY, PAINT AND FLAG. THE SECOND PARCEL IS LOCATED 2013 FEET NW FROM THE INTERSECTION OF CARVER LN AND MERLE TRAVIS HWY. MARK ENTIRE PROPERTY, PAINT AND FLAG.		
Comments:	<p>Map Information 0032 Map: VIEW EXCAVATION AREA AND FACILITY MAP FOR 0032 Attachment(s): NO NW Lat/Lon: 37.1985848, -87.0815886 Contact Name: JEFF LONG Email: jefflong531@gmail.com Requested By: SANDRA LONG Excavator: BURIAL TECH LLC Address: 297 HIDDEN VALLEY RD BERA, KY 40403</p> <p>Type of Work: COMCAST LINE BURIAL Explosives: NO Area Marked: YES Work Done For: BURIAL TECH LLC.</p> <p>Members Notified Company Name: CITY OF DRAKESBORO AT&T DISTRIBUTION</p> <p>Utility Type S,W,G COMMUNICATIONS</p>		
Excavator Information	JEFF LONG jefflong531@gmail.com Phone: (859)248-4591 Fax: (859)248-4591	Contact Information	SE Lat/Lon: 37.1938729, -87.0764739
Excavation Information	Depth: 1 FT Job #:	Excavator Information	Phone: (859)248-4591 Phone: (859)248-4591

COMPLETED
 BY BS
 2-8-23

Flagged & Painted
 2-8-2023
 BSA BS



Brian Jones <drakesborogas@gmail.com>

NORMAL 230391183

1 message

ky@ocinc.com <ky@ocinc.com>
To: drakesboro@comcast.net, drakesborogas@gmail.com



COMPLETED

BY: BJ Date: 2-8-2023

Wed, Feb 8, 2023 at 11:43 AM

Ticket No: 230391183

District Code: 0032

Request Date: 02/08/23 12:43 PM EST

Begin Date: 02/11/23 8:00 AM EST

County: MUHLENBERG

Address/Street: 25 POST OFFICE DR

Intersecting: BEECH CREEK RD

Subdivision: Lot:

Location Info:

Comments:

0032 Map: VIEW EXCAVATION AREA AND FACILITY MAP FOR 0032

Attachment(s): NO

NW Lat/Lon: 37.1763933,-87.0638469

Contact Name: JEFF LONG

Email: jefflong531@gmail.com

Requested By: SANDRA LONG

Excavator: BURIAL TECH LLC

Address: 297 HIDDEN VALLEY RD

Type of Work: COMCAST LINE BURIAL

Explosives: NO

Area Marked: YES

Work Done For: BURIAL TECH LLC

Members Notified

Excavation Information

BEREA, KY 40403
297 HIDDEN VALLEY RD
BURIAL TECH LLC
Phone: (859)248-4591
Phone: (859)248-4591

Excavator Information

JEFF LONG
Phone: (859)248-4591
Fax:

Contact Information

SE Lat/Lon: 37.1756180,-87.0613126

Map Information

VIEW EXCAVATION AREA AND FACILITY MAP FOR 0032

ATTENTION: THERE ARE OTHER INTERSECTIONS OF ROADS WITH IDENTICAL STREET NAMES IN THE AREA. THE EXACT LOCATION OF THE DIG SITE INTERSECTION IS LOCATED AT (37.175958, -87.06377). PLEASE CONSULT THE PROVIDED MAP OF THIS SITE FOR MORE INFORMATION. FROM THE CENTERLINES OF POST OFFICE LN AND BEECH CREEK RD, HEAD EAST ON POST OFFICE LN FOR 88 FT. THEN FROM THE CENTERLINE OF POST OFFICE LN, HEAD N FOR 62 FEET TO THE SITE ON THE N SIDE OF THE STREET. MARK ENTIRE PROPERTY. PAINT AND FLAG.

Location Information

City: BEECHMONT
Request By: WEB
Seq No: 6
Previous No:
Request Date: 02/08/23 12:43 PM EST
Expires: 03/01/23 11:59 PM EST

NEW TICKET

istrict
0032
0139

Company Name
CITY OF DRAKESBORO
AT&T DISTRIBUTION

Utility Type
S,W,G
COMMUNICATIONS

Gmail - NORMAL 230391183

B. Allard
No conflict
2-8-2023



Brian Jones <drakesborogas@gmail.com>

Center Messages

1 message

ky@ocinc.com <ky@ocinc.com>

To: drakesboro@comcast.net, drakesborogas@gmail.com

Kentucky 811

SUMM

DAILY AUDIT OF TICKETS SENT ON 02/08/23

Date/Time: 02/09/2023 01:15:33 AM

Receiving Terminal: 0032

Seq #	Ticket #	Seq #	Ticket #
1	230390802-NORM	5	230391045-NORM
2	230390838-NORM	6	230391183-NORM
3	230390839-NORM	7	230391913-NORM
4	230390897-NORM		

* indicates ticket # is repeated

Total Tickets: 7

NORM - NORMAL

| 7

Please call (573) 636-1556 if this data does not match the tickets you received on 02/08/23

COMPLETED
BY RSJ
Date: 2-9-2023

2/8/2023 11:43 AM

ky@ocinc.com

NORMAL 230391183

To drakesboro@comcast.net • drakesborogas@gmail.com

Ticket No: 230391183

District Code: 0032

Request Date: 02/08/23 12:43 PM EST

Begin Date: 02/11/23 8:00 AM EST

Location Information

MUHLENBERG

County: MUHLENBERG

25 POST OFFICE DR

Address/Street: 25 POST OFFICE DR

BEECH CREEK RD

Intersecting: BEECH CREEK RD

Lot:

Subdivision:

ATTENTION: THERE ARE OTHER INTERSECTIONS OF ROADS WITH IDENTICAL STREET NAMES IN THE AREA. THE EXACT LOCATION OF THE DIG SITE INTERSECTION IS LOCATED AT (37.175958, -87.06377). PLEASE CONSULT THE PROVIDED MAP OF THIS SITE FOR MORE INFORMATION. FROM THE CENTERLINES OF POST OFFICE LN AND BEECH CREEK RD, HEAD EAST ON POST OFFICE LN FOR 88 FT. THEN FROM THE CENTERLINE OF POST OFFICE LN, HEAD N FOR 62 FEET TO THE SITE ON THE N SIDE OF THE STREET. MARK ENTIRE PROPERTY, PAINT AND FLAG.

Comments:

VIEW EXCAVATION AREA AND FACILITY MAP FOR 0032

Attachment(s): NO

NW Lat/Lon: 37.1763933, -87.0638469

Contact Information

JEFF LONG

Contact Name: JEFF LONG

jefflong531@gmail.com

Email: jefflong531@gmail.com

Excavator Information

SANDRA LONG

Requested By: SANDRA LONG

BURIAL TECH LLC

Excavator: BURIAL TECH LLC

297 HIDDEN VALLEY RD

Address: 297 HIDDEN VALLEY RD

BEREA, KY 40403

Type of Work: COMCAST LINE BURIAL

COMCAST LINE BURIAL

Explosives: NO

YES

Area Marked: YES

BURIAL TECH LLC.

Work Done For: BURIAL TECH LLC.

Members Notified

UTILITY Type
S,W,G
COMMUNICATIONS

District: 0032

CITY OF DRAKESBORO

0139

AT&T DISTRIBUTION

2-8-2023
C/ter
B. Allard

NEW TICKET

Previous No: 6

Request By: WEB

Expires: 03/01/23 11:59 PM EST

COMPLETED

City: BEECHMONT

2-8-2023

2/8/2023 3:15 PM

ky@ocinc.com

NORMAL 230391913

To drakesboro@comcast.net • drakesborogas@gmail.com

Ticket No: 230391913
District Code: 0032
Request Date: 02/08/23 4:15 PM EST
Begin Date: 02/11/23 8:00 AM EST

Location Information

City: DRAKESBORO
Address/Street: 428 STATE HWY 70 E
Intersecting: ROCHESTER RD
Subdivision:
Location Info:

FROM THE CENTERLINES OF BROWDER CUTOFF RD AND ROCHESTER RD, HEAD EAST-SOUTHEAST ON BROWDER CUTOFF RD FOR 98 FT. THEN FROM THE CENTERLINE OF BROWDER CUTOFF RD, HEAD SSW FOR 38 FEET TO THE SITE ON THE SSW SIDE OF THE STREET. MARK ENTIRE PROPERTY, PAINT AND FLAG.

Comments:

0032 Map: VIEW EXCAVATION AREA AND FACILITY MAP FOR 0032
Attachments(s): NO
NW Lat/Lon: 37.1998640,-87.0300522

Contact Information

SE Lat/Lon: 37.1992157,-87.0289184

Contact Name: JEFF LONG
Email: jefflong531@gmail.com

Excavator Information

Phone: (859)248-4591
Fax:

Requested By: SANDRA LONG

Excavator: BURIAL TECH LLC
Address: 297 HIDDEN VALLEY RD
 BUREA, KY 40403

Excavation Information

Depth: 1 FT
Job #:

Type of Work: COMCAST LINE BURIAL

Explosives: NO

Area Marked: YES

Work Done For: BURIAL TECH LLC.

District: 0032

Company Name: CITY OF DRAKESBORO

0139

Utility Type: COMCAST COMMUNICATIONS

Utility Type: TV,FO

*2-9-2023
 Clear no conflict
 BADA B5*

2/9/2023 9:08 AM

ky@ocinc.com

NORMAL 230400634

To drakesboro@comcast.net • drakesborogas@gmail.com

Ticket No:	NORMAL 230400634	Previous No:	NEW TICKET
District Code:	0032	Seq No:	1
Request Date:	02/09/23 10:08 AM EST	Request By:	WEB
Begin Date:	02/14/23 8:00 AM EST	Expires:	03/02/23 11:59 PM EST
County:	MUHLENBERG	Location Information	
Address/Street:	3454 US HWY 431 S	City:	BEECHMONT
Intersecting:	MERLE TRAVIS HWY	Lot:	
Subdivision:		Map Information	
Location Info:	MARK ENTIRE PROPERTY, PAINT AND FLAG.	VIEW EXCAVATION AREA AND FACILITY MAP FOR 0032	
Comments:		Attachment(s):	NO
0032 Map:		NW Lat/Lon:	37.1723710,-87.0338798
Contact Name:	JEFF LONG	Contact Information	
Email:	jefflong531@gmail.com	Excavator Information	
Requested By:	SANDRA LONG	Excavator Name:	BURIAL TECH LLC
Excavator:	BURIAL TECH LLC	Address:	297 HIDDEN VALLEY RD BEREA, KY 40403
Type of Work:	COMCAST LINE BURIAL	Excavation Information	
Explosives:	NO	Depth:	1 FT
Area Marked:	YES	Job #:	
Work Done For:	BURIAL TECH LLC.	Members Notified	
District	0032	Company Name	CITY OF DRAKESBORO
	0072		COMCAST COMMUNICATIONS
	0139		AT&T DISTRIBUTION
		Utility Type	S,W,G TV,FO COMMUNICATIONS

2-9-2023
Flagged & Painted
B4 & B5

COMPLETED
BY: B5
Date: 2-9-2023



Brian Jones <drakesborogas@gmail.com>

Center Messages

1 message

Fri, Feb 10, 2023 at 12:17 AM

ky@ocinc.com <ky@ocinc.com>
To: drakesboro@comcast.net, drakesborogas@gmail.com

Kentucky 811

SUMM

DAILY AUDIT OF TICKETS SENT ON 02/09/23

Date/Time: 02/10/2023 01:15:35 AM

Receiving Terminal: 0032

Seq #	Ticket #	Seq #	Ticket #
1	230400634-NORM		

* indicates ticket # is repeated

Total tickets: 1

NORM - NORMAL

| 1

Please call (573) 636-1556 if this data does not match the tickets you received on 02/09/23

COMPLETED

By: _____
Data: _____



Brian Jones <drakesborogas@gmail.com>

Center Messages

1 message

Sat, Feb 11, 2023 at 12:17 AM

ky@occin.com <ky@occin.com>
To: drakesboro@comcast.net, drakesborogas@gmail.com

Kentucky 811

SUMM

DAILY AUDIT OF TICKETS SENT ON 02/10/23

Date/Time: 02/11/2023 01:15:32 AM

Receiving Terminal: 0032

Seq #	Ticket #	Seq #	Ticket #
-----	-----	-----	-----

* indicates ticket # is repeated

Total tickets: 0

Please call (573) 636-1556 if this data does not match the tickets you received on 02/10/23

COMPLETE
BY: BJ
Date: 2-11-2023



Brian Jones <drakesborogas@gmail.com>

Center Messages

1 message

ky@ocinc.com <ky@ocinc.com>
To: drakesboro@comcast.net, drakesborogas@gmail.com

Sun, Feb 12, 2023 at 12:17 AM

Kentucky 811

SUMM

DAILY AUDIT OF TICKETS SENT ON 02/11/23

Date/Time: 02/12/2023 01:15:23 AM

Receiving Terminal: 0032

Seq #	Ticket #	Seq #	Ticket #
1	230420059-NORM	2	230420062-NORM

* indicates ticket # is repeated

Total tickets: 2

NORM - NORMAL | 2

Please call (573) 636-1556 if this data does not match the tickets you received on 02/11/23

COMPLETED
BY: BS
Date: 2-12-2023



Brian Jones <drakesborogas@gmail.com>

Center Messages

1 message

Mon, Feb 13, 2023 at 12:17 AM

ky@ocinc.com <ky@ocinc.com>
To: drakesboro@comcast.net, drakesborogas@gmail.com

Kentucky 811

SUMM

DAILY AUDIT OF TICKETS SENT ON 02/12/23

Date/Time: 02/13/2023 01:15:23 AM

Receiving Terminal: 0032

Seq #	Ticket #	Seq #	Ticket #
-----	-----	-----	-----

* Indicates ticket # is repeated

Total Tickets: 0

Please call (573) 636-1556 if this data does not match the tickets you received on 02/12/23

COMPLETED
By: BJ
Date: 2-13-2023

2/13/2023 10:42 AM

ky@ocinc.com

EMERGENCY 230441065

To drakesboro@comcast.net • drakesborogas@gmail.com

NEW TICKET

EMERGENCY

230441065

0032

Ticket No:

02/13/23 11:42 AM EST

Request Date:

02/13/23 1:45 PM EST

Begin Date:

Location Information

MUHLENBERG

County:

1866 STATE HWY 70 E

Address/Street:

ROCHESTER RD

Intersecting:

Lot:

Subdivision:

ATTENTION: THERE ARE OTHER INTERSECTIONS OF ROADS WITH IDENTICAL STREET NAMES IN THE AREA. THE EXACT LOCATION OF THE DIG SITE INTERSECTION IS LOCATED AT (37.2011116, -87.006806). PLEASE CONSULT THE PROVIDED MAP OF THIS SITE FOR MORE INFORMATION. FROM THE CENTERLINES OF HILLTOP LN AND ROCHESTER RD, HEAD SOUTH-SOUTHWEST ON HILLTOP LN FOR 120 FT. THEN FROM THE CENTERLINE OF HILLTOP LN, HEAD ESE FOR 49 FEET TO THE SITE ON THE ESE SIDE OF THE STREET. MARK FRONT OF PROPERTY. AREA IS MARKED WITH WHITE ARROW ON THE ROAD.

Comments:

EMERGENCY CREW EN ROUTE

Map Information

VIEW EXCAVATION AREA AND FACILITY MAP FOR 0032

Attachment(s):

NO

37.2011945,-87.0071163

NW Lat/Lon:

Contact Information

KEVIN DEEL

Contact Name:

darlam@butlerwater.com

Email:

Excavator Information

DARLA MORRIS

Requested By:

BUTLER COUNTY WATER SYSTEM

Excavator:

PO BOX 1488

Address:

MORGANTOWN, KY 42261

Excavation Information

EMERGENCY REPAIR WATER METER

Type of Work:

NO

Explosives:

YES

Area Marked:

BUTLER COUNTY WATER SYSTEM

Work Done For:

Members Notified

District

CITY OF DRAKESBORO

0032

COMCAST COMMUNICATIONS

0072

AT&T DISTRIBUTION

0139

TIME WARNER CABLE

0270

COMMUNICATIONS

COMMUNICATIONS

TV,FO

S,W,G

Utility Type

Flagged & Painted 2-13-23

Job #: 575917

Depth: 3 FT

Phone: (270)526-4656

Phone: (270)526-4656

Fax:

Phone: (270)792-0734

SE Lat/Lon: 37.2003647,-87.0063910

2-13-23
COMPLETED
BS

2/8/2023 10:08 AM

ky@ocinc.com

NORMAL 230390897

To drakesboro@comcast.net • drakesborogas@gmail.com

Ticket No:	230390897	Company Name:	CITY OF DRAKESBORO
District Code:	0032	Utility Type:	COMMUNICATIONS
Request Date:	02/08/23 11:08 AM EST	Members Notified:	
Begin Date:	02/11/23 8:00 AM EST	Excavation Information:	COMCAST LINE BURIAL
Location Info:		Excavator Information:	Excavator: SANDRA LONG Address: 297 HIDDEN VALLEY RD BEREA, KY 40403
County:	MUHLENBERG	Contact Information:	Contact: JEFF LONG Phone: (859)248-4591 Fax: (859)248-4591
Address/Street:	850 MERLE TRAVIS HWY	Map Information:	VIEW EXCAVATION AREA AND FACILITY MAP FOR 0032
Intersecting:	CARVER LN	Excavation Information:	Depth: 1 FT Job #:
Subdivision:		Comments:	FLAG. FROM THE CENTERLINES OF MERLE TRAVIS HWY AND CARVER LN, HEAD NORTH-NORTHWEST ON MERLE TRAVIS HWY FOR 515 FT. THEN FROM THE CENTERLINE OF MERLE TRAVIS HWY, HEAD SW FOR 115 FEET TO THE SITE ON THE SW SIDE OF THE STREET. MARK ENTIRE PROPERTY, PAINT AND
Location Info:		0032 Map:	Attachments(s):
City:	DRAKESBORO	NW Lat/Lon:	37.1945686, -87.0735154
Location Information:		Contact Name:	JEFF LONG
Request By:	WEB	Email:	jefflong531@gmail.com
Seq No:	4	Requested By:	SANDRA LONG
Previous No:		Excavator:	BURIAL TECH LLC
NEW TICKET		Address:	BURIAL TECH LLC
		Requested By:	BURIAL TECH LLC
		Area Marked:	YES
		Explosives:	NO
		Type of Work:	COMCAST LINE BURIAL
		Work Done For:	BURIAL TECH LLC
		District:	0032
		District:	0139

Flagged & Painted
2-8-2023
BFA & RS

COMPLETE
Date: 2-8-23

2/11/2023 9:31 AM

ky@ocinc.com

NORMAL 230420059

To drakesboro@comcast.net • drakesborogas@gmail.com

Ticket No: 230420059

District Code: 0032

Request Date: 02/11/23 10:31 AM EST

Begin Date: 02/16/23 8:00 AM EST

County: MUHLENBERG

Address/Street: 100 SPRING DR

Intersecting: MILL RD

Subdivision: MARK RIGHT SIDE FACING FRONT OF PROPERTY.

Location Info: Comments:

0032 Map: VIEW EXCAVATION AREA AND FACILITY MAP FOR 0032

Attachment(s): NW Lat/Lon: 37.1649206, -87.0391995

Contact Name: JONATHAN ELLIS

Email: kellis0123@yahoo.com

Requested By: JONATHAN ELLIS

Excavator: JONATHAN ELLIS

Address: 100 SPRING DR

Type of Work: INSTALL CURTAIN DRAINS

Explosives: NO

Area Marked: NO

Work Done For: JONATHAN ELLIS

District: 0032

0139

Company Name: CITY OF DRAKESBORO
AT&T DISTRIBUTION

Members Notified

Utility Type: S,W,G
COMMUNICATIONS

Excavation Information

BEECHMONT,

100 SPRING DR

JONATHAN ELLIS

JONATHAN ELLIS

Excavator Information

Phone: (270)977-9208

Phone: (270)977-9208

Fax:

Phone: (270)977-9208

Contact Information

SE Lat/Lon: 37.1642579, -87.0382873

Map Information

VIEW EXCAVATION AREA AND FACILITY MAP FOR 0032

NO

Contact Information

Phone: (270)977-9208

Fax:

Phone: (270)977-9208

Excavator Information

JONATHAN ELLIS

JONATHAN ELLIS

100 SPRING DR

BEECHMONT,

Excavation Information

INSTALL CURTAIN DRAINS

NO

NO

JONATHAN ELLIS

Work Done For: JONATHAN ELLIS

Area Marked: NO

Explosives: NO

Type of Work: INSTALL CURTAIN DRAINS

0139

Company Name: CITY OF DRAKESBORO
AT&T DISTRIBUTION

Members Notified

Utility Type: S,W,G
COMMUNICATIONS

2-13-2023
Flagged & painted
B. Jones

COMPLETED
2-13-2023
BY: BS

Lot:

Location Information

City: BEECHMONT

Expires: 03/04/23 11:59 PM EST

Request By: CALL

Seq No: 1

Previous No:

HOMEOWNER

2/11/2023 9:37 AM

ky@ocinc.com

NORMAL 230420062

To drakesboro@comcast.net • drakesborogas@gmail.com

Ticket No: 230420062	Company Name: CITY OF DRAKESBORO	District: 0032
Normal	AT&T DISTRIBUTION	0139
Request Date: 02/11/23 10:37 AM EST	Work Done For: JONATHAN ELLIS	Area Marked: NO
Begin Date: 02/23/23 12:00 AM EST	Explosives: NO	Type of Work: INSTALL CURTAIN DRAINS AND DRIVEWAY
District Code: 0032	Excavation Information:	
Seq No: 2	Address: 201 LAKEVIEW DR JONATHAN ELLIS BEECHMONT,	
Previous No: HOWEOWNER	Excavator Information:	
Request By: CALL	Requested By: JONATHAN ELLIS	
Expires: 03/04/23 11:59 PM EST	Excavator: JONATHAN ELLIS	
Location Information:	Contact Information:	
County: WUHLBERG	Phone: (270)977-9208	
Address/Street: 201 LAKEVIEW DR	Fax: (270)977-9208	
Intersecting: MILL RD	SE Lat/Lon: 37.1629494, -87.0370326	
Subdivision: MARK LEFT SIDE FACING FRONT OF PROPERTY.	Map Information:	
Location Info: MARK LEFT SIDE FACING FRONT OF PROPERTY.	VIEW EXCAVATION AREA AND FACILITY MAP FOR 0032	
Comments:	Attachment(s): NO	
	NW Lat/Lon: 37.1655600, -87.0391385	
	Contact Name: JONATHAN ELLIS	
	Email: kelis0123@yahoo.com	
	Requested By: JONATHAN ELLIS	
	Excavator: JONATHAN ELLIS	
	Address: 201 LAKEVIEW DR JONATHAN ELLIS BEECHMONT,	
	Excavation Information:	
	Depth: 3 FT	
	Job #:	
	Members Notified:	
	Utility Type: S,W,G	
	COMMUNICATIONS	

COMPLETED

BY: BS DATE: 2-13-2023

2-13-2023
Flagged & painted
B. Jones



Brian Jones <drakesborogas@gmail.com>

NORMAL 230441043

1 message

ky@ocinc.com <ky@ocinc.com>
To: drakesboro@comcast.net, drakesborogas@gmail.com

COMPLETED
2-13-23
BY [Signature]

Mon, Feb 13, 2023 at 10:38 AM

2-13-2023
Flagged & Painted
B. Jones



NEW TICKET

Ticket No:

230441043

District Code:

0032

Request Date:

02/13/23 11:38 AM EST

Begin Date:

02/16/23 8:00 AM EST

Location Information

County:

MUHLENBERG

Address/Street:

18 HICKORY CT

Intersecting:

HILL HAVEN PL

Subdivision:

MARK ENTIRE PROPERTY, PAINT AND FLAG.

Comments:

Map Information

0032 Map:

VIEW EXCAVATION AREA AND FACILITY MAP FOR 0032

Attachment(s):

NO

NW Lat/Lon:

37.1783566,-87.0373602

Contact Information

Contact Name:

JEFF LONG

Email:

jefflong531@gmail.com

Requested By:

SANDRA LONG

Excavator:

BURIAL TECH LLC

Address:

297 HIDDEN VALLEY RD

BEREA, KY 40403

Excavation Information

Type of Work:

COMCAST LINE BURIAL

Explosives:

NO

Area Marked:

YES

Work Done For:

BURIAL TECH LLC.

Members Notified

District

0032

Company Name

CITY OF DRAKESBORO

Utility Type

S,W,G
COMMUNICATIONS

AT&T DISTRIBUTION



Brian Jones <drakesborogas@gmail.com>

Center Messages

1 message

ky@ocinc.com <ky@ocinc.com>

To: drakesboro@comcast.net, drakesborogas@gmail.com

Tue, Feb 14, 2023 at 12:17 AM

Kentucky 811

SUMM

DAILY AUDIT OF TICKETS SENT ON 02/13/23

Date/Time: 02/14/2023 01:15:34 AM

Receiving Terminal: 0032

Seq #	Ticket #	Seq #	Ticket #
1	230441043-NORM	3	230441398-NORM
2	230441065-EMER	4	230441832-NORM

* Indicates ticket # is repeated

Total Tickets: 4

NORM - NORMAL

3

EMER - EMERGENCY

1

Please call (573) 636-1556 if this data does not match the tickets you received on 02/13/23

COMPLETED
 BY: [Signature]
 Date: 2-14-23

2/13/2023 12:44 PM

ky@ocinc.com

NORMAL 230441398

To drakesboro@comcast.net • drakesborogas@gmail.com

Ticket No:	230441398	Company Name	CITY OF DRAKESBORO
District Code:	0032	Company Name	AT&T DISTRIBUTION
Request Date:	02/13/23 1:44 PM EST	Company Name	COMCAST COMMUNICATIONS
Begin Date:	02/16/23 10:00 AM EST	Company Name	MUNINET FIBER AGENCY
Address/Street:	11 DITNEY HILL RD	Utility Type	FO
County:	MUHLENBERG	Utility Type	TV,FO
Intersecting:	KY-176	Utility Type	S,W,G
Subdivision:		Utility Type	COMMUNICATIONS
Location Info:	MARK A 20FT RADIUS OF THE STAKES WITH ORANGE RIBBON LOCATED BEHIND THE HOME.	Members Notified	
Comments:		Members Notified	
0032 Map:	VIEW EXCAVATION AREA AND FACILITY MAP FOR 0032	Excavator Information	
Attachment(s):	NO	Excavator Information	
NW Lat/Lon:	37.2140526,-87.0585595	Contact Information	
Contact Name:	LEO KERN	Contact Information	
Email:	leo.kern@lge-ku.com	Contact Information	
Requested By:	LEO KERN	Contact Information	
Excavator:	KENTUCKY UTILITIES	Contact Information	
Address:	382 AIRPORT RD GREENVILLE, KY 42345	Contact Information	
Type of Work:	INSTALL UTILITY POLE AND ANCHOR	Excavation Information	
Explosives:	NO	Excavation Information	
Area Marked:	YES	Excavation Information	
Work Done For:	KENTUCKY UTILITIES	Excavation Information	
District	0032	Excavation Information	
District	0072	Excavation Information	
District	0139	Excavation Information	
District	0639	Excavation Information	

2-14-2023
Painted + Flagged
C. Spurlin

COMPLETED BY
2-14-23

2/14/2023 1:08 PM

ky@ocinc.com

NORMAL 230451601

To drakesboro@comcast.net • drakesborogas@gmail.com

HOMEOWNER

Previous No:

Seq No: 1

Request By: CALL

Expires: 03/07/23 11:59 PM EST

Location Information

City: BELTON

Lot:

COMPLETED

BY: BS 2-14-23

Ticket No:

230451601

District Code:

0032

Request Date:

02/14/23 2:08 PM EST

Begin Date:

02/17/23 8:00 AM EST

County:

MUHLENBERG

Address/Street:

230 DAVID MARTIN LN

Intersecting:

HARRIS RD

Subdivision:

MARK FRONT OF PROPERTY.

Comments:

Map Information

VIEW EXCAVATION AREA AND FACILITY MAP FOR 0032

Attachment(s):

NO

NW Lat/Lon:

37.1795872,-87.0228221

Contact Name:

KRISTA EMBRY

Email:

Requested By:

KRISTA EMBRY

Excavator:

KRISTA EMBRY

Address:

230 DAVID MARTIN LN

BELTON,

Type of Work:

REPAIR/STRAIGHTEN DRIVEWAY

Explosives:

NO

Area Marked:

NO

Work Done For:

KRISTA EMBRY

District

0032

Company Name

CITY OF DRAKESBORO

AT&T DISTRIBUTION

0139

Members Notified

Utility Type
S,W,G
COMMUNICATIONS

Excavation Information

Depth: 5 FT

Job #:

Excavator Information

Phone: (270)602-9723

Phone: (270)602-9723

Fax:

Phone: (270)602-9723

Contact Information

SE Lat/Lon: 37.1777630,-87.0209170

2-14-2023
Clear
B. Jones

2/14/2023 1:48 PM

ky@occing.com

NORMAL 230451845

To drakesboro@comcast.net • drakesborogas@gmail.com

NEW TICKET

Previous No:

Seq No: 2

Request By: WEB

Expires: 03/07/23 11:59 PM EST

Location Information

City: BEECHMONT

MUHLBERG

2687 MERLE TRAVIS HWY

County:

Address/Street:

Intersecting:

Subdivision:

Location Info:

FROM THE CENTERLINES OF MERLE TRAVIS HWY AND BEECH CREEK BROWDER RD, HEAD WEST-SOUTHWEST ON MERLE TRAVIS HWY FOR 311 FT. THEN FROM THE CENTERLINE OF MERLE TRAVIS HWY, HEAD N FOR 210 FEET TO THE SITE ON THE N SIDE OF THE STREET. MARK ENTIRE PROPERTY. PAINT AND FLAG.

Comments:

Map Information

VIEW EXCAVATION AREA AND FACILITY MAP FOR 0032

Attachment(s):

NW Lat/Lon:

37.1771020,-87.0567094

Contact Information

Phone: (859)358-0470

Fax:

Excavator Information

Phone: (859)358-0470

SANDRA LONG

BURIAL TECH LLC

Requested By:

Excavator:

Address:

BEREA, KY 40403

297 HIDDEN VALLEY RD

Excavation Information

COMCAST LINE BURIAL

Type of Work:

Explosives:

NO

Area Marked:

YES

Work Done For:

BURIAL TECH LLC.

Members Notified

CITY OF DRAKESBORO

COMCAST COMMUNICATIONS

AT&T DISTRIBUTION

District

0032

0072

0139

Utility Type

S,W,G

TV,FO

COMMUNICATIONS

Job #:

Depth: 1 FT

2-14-2023
Painted & Flagged
B. Jones

COMPLETE
85
2-14-23

2/13/2023 2:28 PM

ky@ocinc.com

NORMAL 230441832

To drakesboro@comcast.net - drakesborogas@gmail.com

Ticket No: 230441832	Normal
District Code: 0032	NEW TICKET
Request Date: 02/13/23 3:27 PM EST	Previous No:
Begin Date: 02/16/23 8:00 AM EST	Seq No: 4
County: MUHLENBERG	Request By: WEB
Address/Street: 404 IKE EVERLY AVE	Expires: 03/06/23 11:59 PM EST
Intersecting: KEIGAN ST	City: DRAKESBORO
Subdivision:	Lot:
Location Info: MARK ENTIRE PROPERTY. PAINT AND FLAG.	
Comments:	
0032 Map: VIEW EXCAVATION AREA AND FACILITY MAP FOR 0032	
Attachment(s): NO	
NW Lat/Lon: 37.2214721, -87.0529600	
Contact Name: BURIAL TECH LLC.	
Email: jefflong531@gmail.com	
Requested By: SANDRA LONG	
Excavator: BURIAL TECH LLC	
Address: 297 HIDDEN VALLEY RD BEREA, KY 40403	
Type of Work: COMCAST LINE BURIAL	
Explosives: NO	
Area Marked: YES	
Work Done For: BURIAL TECH LLC.	
District: 0032	Company Name: CITY OF DRAKESBORO
0139	AT&T DISTRIBUTION

Utility Type: S,W,G COMMUNICATIONS	Members Notified
Depth: 1 FT	
Job #:	

Contact Information	Excavator Information
Phone: (859)358-0470	Phone: (859)358-0470
Fax:	
SE Lat/Lon: 37.2207640, -87.0518253	
Contact Information	Excavator Information
Phone: (859)358-0470	Phone: (859)358-0470
Fax:	
Excavation Information	

COMPLETED
 BY: RS
 Date: 2-15-2023



Brian Jones <drakesborogas@gmail.com>

Center Messages

1 message

Wed, Feb 15, 2023 at 12:17 AM

ky@ocinc.com <ky@ocinc.com>
To: drakesboro@comcast.net, drakesborogas@gmail.com

Kentucky 811

SUMM

DAILY AUDIT OF TICKETS SENT ON 02/14/23

Date/Time: 02/15/2023 01:15:32 AM

Receiving Terminal: 0032

Seq #	Ticket #
1	230451601-NORM
2	230451845-NORM

* indicates ticket # is repeated

Total Tickets: 2

NORM - NORMAL

| 2

Please call (573) 636-1556 if this data does not match the tickets you received on 02/14/23

COMPLETED
85
2-15-2023



Brian Jones <drakesborogas@gmail.com>

Center Messages

1 message

Sat, Feb 18, 2023 at 12:17 AM

ky@ocinc.com <ky@ocinc.com>
To: drakesboro@comcast.net, drakesborogas@gmail.com

Kentucky 811

DAILY AUDIT OF TICKETS SENT ON 02/17/23

Date/Time: 02/18/2023 01:15:35 AM

Receiving Terminal: 0032

Seq #	Ticket #	Seq #	Ticket #
-----	-----	-----	-----

* Indicates ticket # is repeated

Total Tickets: 0

Please call (573) 636-1556 if this data does not match the tickets you received on 02/17/23

COMPLETED
By: BS
Date: 2-20-23



Brian Jones <drakesborogas@gmail.com>

Center Messages

1 message

ky@ocinc.com <ky@ocinc.com>
To: drakesboro@comcast.net, drakesborogas@gmail.com

Sun, Feb 19, 2023 at 12:17 AM

Kentucky 811

SUMM

DAILY AUDIT OF TICKETS SENT ON 02/18/23

Date/Time: 02/19/2023 01:15:25 AM

Receiving Terminal: 0032

Seq #	Ticket #	Seq #	Ticket #
-----	-----	-----	-----

* Indicates ticket # is repeated

Total Tickets: 0

Please call (573) 636-1556 if this data does not match the tickets you received on 02/18/23

COMPLETE
85
2-20-23



Brian Jones <drakesborogas@gmail.com>

Center Messages

1 message

Mon, Feb 20, 2023 at 12:17 AM

ky@ocinc.com <ky@ocinc.com>
To: drakesboro@comcast.net, drakesborogas@gmail.com

Kentucky 811

SUMM

DAILY AUDIT OF TICKETS SENT ON 02/19/23

Date/Time: 02/20/2023 01:15:25 AM

Receiving Terminal: 0032

Seq #	Ticket #	Seq #	Ticket #
-----	-----	-----	-----

* indicates ticket # is repeated

Total tickets: 0

Please call (573) 636-1556 if this data does not match the tickets you received on 02/19/23

COMPLETED
BY BS
2-20-23

NORMAL 230461972

To drakesboro@comcast.net • drakesborogas@gmail.com

Ticket No: 230461972
District Code: 0032
Request Date: 02/15/23 4:23 PM EST
Begin Date: 02/20/23 7:00 AM EST

NEW TICKET
COMPLETED
BS
 2-20-23

Previous No: Seq No: 3
Request By: WEB
Expires: 03/08/23 11:59 PM EST

Location Information
City: DRAKESBORO
Address/Street: 130 N JOHN PRINE AVE
Intersecting: BROAD ST
Subdivision:
Location Info: FROM THE CENTERLINE OF BROAD ST AND JOHN PRINE AVE, HEAD NORTH-NORTHWEST ON JOHN PRINE AVE FOR 13 FT. THEN FROM THE CENTERLINE OF JOHN PRINE AVE, HEAD ENE FOR 111 FEET TO THE POLE - NEW METAL . MARK A 100 FT RADIUS AROUND THE POLE. PAINT AND FLAG. CENTERPOINT COORDINATES: LAT:37.2209463, LON:-87.0460343

Comments:
0032 Map: VIEW EXCAVATION AREA AND FACILITY MAP FOR 0032
Attachment(s): NO
NW Lat/Lon: 37.2212749,-87.0464469
Contact Name: SEAN REILLY
Email: kelly.harris@star-llc.net

Requested By: KELLY HARRIS
Excavator: STAR CONSTRUCTION
Address: 608 BARK COVE LANE
 OWENSBORO, KY 42301

Type of Work: INSTALL UTILITY POLES AND ANCHORS
Explosives: NO
Area Marked: YES
Work Done For: AT&T

District: 0032
Company Name: CITY OF DRAKESBORO
Utility Type: S,W,G
 TV,FO
 COMMUNICATIONS

Members Notified
AT&T Distribution
AT&T

Job #: Depth: 6 FT

Water, sewer, gas located
2-20-2023
BA, BS, CS

NORMAL 230461952

To drakesboro@comcast.net • drakesborogas@gmail.com

NEW TICKET **COMPLETED**

Previous No: **230461952**
Seq No: **2**
Request By: **CALL**
Expires: **03/08/23 11:59 PM EST**

Request By: **CALL**
City: **BELTON**
Lot: **779 STATE HWY 2270 W**

Address/Street: **JUSTIN LN**
Intersecting: **779 STATE HWY 2270 W**
Subdivision: **JUSTIN LN**

Location Info: **LOCATE A 25 FOOT RADIUS OF THE WATER METER LOCATED WITH A BLUE FLAG IN THE FRONT OF THE PROPERTY**

Comments: **0032 Map: VIEW EXCAVATION AREA AND FACILITY MAP FOR 0032**

Attachment(s): **NO**
NW Lat/Lon: **37.1520392,-87.0405855**

Contact Information: **KURT SARNECKE**
Email: **muhlenbergwater@gmail.com**

Requested By: **LISA DEARMOND**
Excavator: **MUHLENBERG COUNTY WATER DISTRI**

Address: **PO BOX 348**
GREENVILLE, KY 42345

Type of Work: **REPAIR WATER SERVICE LEAK**
Explosives: **NO**
Area Marked: **YES**

Work Done For: **MUHLENBERG COUNTY WATER DISTRI**
Members Notified: **AT&T DISTRIBUTION**

District: **0032**
Company Name: **CITY OF DRAKESBORO**
Utility Type: **S,W,G COMMUNICATIONS**

Ticket No: **230461952**
District Code: **0032**
Request Date: **02/15/23 4:20 PM EST**
Begin Date: **02/18/23 12:00 AM EST**
County: **MUHLENBERG**
Address/Street: **779 STATE HWY 2270 W**
Intersecting: **JUSTIN LN**
Subdivision: **JUSTIN LN**
Location Info: **LOCATE A 25 FOOT RADIUS OF THE WATER METER LOCATED WITH A BLUE FLAG IN THE FRONT OF THE PROPERTY**
Comments: **0032 Map: VIEW EXCAVATION AREA AND FACILITY MAP FOR 0032**
Attachment(s): **NO**
NW Lat/Lon: **37.1520392,-87.0405855**
Contact Information: **KURT SARNECKE**
Email: **muhlenbergwater@gmail.com**
Requested By: **LISA DEARMOND**
Excavator: **MUHLENBERG COUNTY WATER DISTRI**
Address: **PO BOX 348**
GREENVILLE, KY 42345
Type of Work: **REPAIR WATER SERVICE LEAK**
Explosives: **NO**
Area Marked: **YES**
Work Done For: **MUHLENBERG COUNTY WATER DISTRI**
Members Notified: **AT&T DISTRIBUTION**
District: **0032**
Company Name: **CITY OF DRAKESBORO**
Utility Type: **S,W,G COMMUNICATIONS**

*Flagged + Printed
BA + BS
2-16-2023*

NORMAL 230461937

To drakesboro@comcast.net • drakesborogas@gmail.com

2-20-23
B5
NEW TICKET

NEW TICKET

Ticket No:

230461937

District Code:

0032

Request Date:

02/15/23 4:16 PM EST

Begin Date:

02/18/23 12:00 AM EST

County:

MUHLENBERG

Address/Street:

1284 JACKSONTOWN RD

Intersecting:

14TH AVE

Subdivision:

LOCATE A 25 FOOT RADIUS OF THE WATER METER LOCATED WITH A BLUE FLAG IN THE FRONT OF THE PROPERTY

Comments:

VIEW EXCAVATION AREA AND FACILITY MAP FOR 0032

Attachment(s):

NO

NW Lat/Lon:

37.2186425,-87.0642445

Contact Name:

KURT SARNECKE

Email:

muhlenbergwater@gmail.com

Requested By:

LISA DEARMOND

Excavator:

MUHLENBERG COUNTY WATER DISTRI

Address:

PO BOX 348

GREENVILLE, KY 42345

Type of Work:

REPAIR WATER SERVICE LEAK

Explosives:

NO

Area Marked:

YES

Work Done For:

MUHLENBERG COUNTY WATER DISTRI

District

0032

CITY OF DRAKESBORO

AT&T DISTRIBUTION

0139

Company Name

Members Notified

Utility Type

S,W,G

COMMUNICATIONS

No Conflict
B. Jones
2-16-23

Depth: 5 FT
Job #:

Phone: (270)338-1300

Phone: (270)977-0307

SE Lat/Lon: 37.2165906,-87.0614596

Excavator Information

Contact Information

Map Information

Location Information

City: DRAKESBORO

Request By: CALL
Expires: 03/08/23 11:59 PM EST

Previous No:

Seq No: 1

Request By: CALL

Expires: 03/08/23 11:59 PM EST

NORMAL 230471094

To drakesboro@comcast.net • drakesborogas@gmail.com

NEW TICKET
 2-20-23
 BJS

Ticket No: 230471094
 District Code: 0032
 Request Date: 02/16/23 2:02 PM EST
 Begin Date: 02/22/23 8:00 AM EST

Location Information
 County: MUHLBERG
 Address/Street: 166 STATE HWY 2107
 Intersecting: JOHN PRINE AVE

Subdivision:
 Location Info: AS FACING THE HOUSE FROM STATE HWY 2107 LOCATE A 5 FOOT RADIUS AROUND THE STAKE
 Located ON THE RIGHT SIDE OF THE PROPERTY

Comments:
 0032 Map: VIEW EXCAVATION AREA AND FACILITY MAP FOR 0032

Attachment(s):
 NW Lat/Lon: 37.2303874,-87.0526873

Contact Name: JERRY WOOLF
 Email: JERRY.WOOLF@STAR-LLC.NET

Contact Information
 Requested By: JERRY WOOLF
 Excavator: STAR CONSTRUCTION
 Address: OWENSBORO, KY 42301

Excavator Information
 Type of Work: INSTALL NEW ANCHOR
 Explosives: NO
 Area Marked: YES
 Work Done For: AT&T

Members Notified
 Utility Type: S,W,G
 TV,FO
 PIPELINE
 COMMUNICATIONS

No Conflict
 B. Jones
 2-16-2023

NORMAL 230471038

To drakesboro@comcast.net • drakesborogas@gmail.com

COMPLETE BY 2-20-23

Ticket No: 230471038
 District Code: 0032
 Request Date: 02/16/23 1:41 PM EST
 Begin Date: 02/22/23 8:00 AM EST

Location Information
 County: MUELLENBERG
 Address/Street: 157 MUD ST
 Intersecting: DITNEY HILL RD
 Subdivision:
 Location Info: AS FACING THE HOUSE FROM MUD ST LOCATE A 5 FOOT RADIUS AROUND THE BROKEN POLE MARKED WITH A STAKE AND RED RIBBON LOCATED ON THE RIGHT SIDE OF THE PROPERTY

Comments:
 0032 Map: VIEW EXCAVATION AREA AND FACILITY MAP FOR 0032
 Attachment(s): NO
 NW Lat/Lon: 37.2115681,-87.0591222
 SE Lat/Lon: 37.2080691,-87.0562793

Contact Information
 Contact Name: JERRY WOOLF
 Email: JERRY.WOOLF@STAR-LLC.NET
 Requested By: JERRY WOOLF
 Excavator: STAR CONSTRUCTION
 Address: 608 BARK COVE LANE
 OWENSBORO, KY 42301

Excavation Information
 Type of Work: REPLACE TELEPHONE POLE
 Explosives: NO
 Area Marked: YES
 Work Done For: AT&T

Members Notified
 Company Name: CITY OF DRAKESBORO
 AT&T DISTRIBUTION
 District: 0032
 Utility Type: S,W,G COMMUNICATIONS

NO utility mains in this area
 BAd BT
 2-16-2023

NORMAL 230471055

To drakesboro@comcast.net • drakesborogas@gmail.com

COMPLETED BY *BS* 2-24-23

NEW TICKET

Ticket No:	230471055	Company Name:	CITY OF DRAKESBORO
District Code:	0032	Utility Type:	S,W,G TV,FO COMMUNICATIONS
Request Date:	02/16/23 1:52 PM EST	Members Notified:	
Begin Date:	02/22/23 8:00 AM EST	Excavator Information:	JERRY WOOLF JERRY.WOOLF@STAR-LLC.NET Phone: (270)556-8009 Fax:
County:	MUHLENBERG	Contact Information:	JERRY WOOLF Phone: (270)556-8009
Address/Street:	N JOHN PRINE AVE	Excavation Information:	REPLACE POLE AND ANCHOR Job #: A02FYL B Depth: 7 FT
Intersecting:	BROAD ST	Map Information:	VIEW EXCAVATION AREA AND FACILITY MAP FOR 0032
Subdivision:		Attachment(s):	0032 Map:
Location Info:	LOCATE A 5 FOOT RADIUS AROUND THREE STAKES LOCATED ON THE EAST SIDE OF N JOHN PRINE AVE DIRECTLY EAST OF THE T-INTERSECTION OF BROAD ST WITHIN 10 FEET TO 150 FEET OFF THE ROAD	Comments:	
Address/Street:	N JOHN PRINE AVE	Type of Work:	Explosives: NO Area Marked: YES Work Done For: AT&T
Intersecting:	BROAD ST	Requested By:	JERRY WOOLF STAR CONSTRUCTION
City:	DRAKESBORO	Excavator:	608 BARK COVE LANE OWENSBORO, KY 42301
Lot:		Address:	
Location Information:		Request:	0139
Expires:	03/09/23 11:59 PM EST	Request No:	0072
Request By:	CALL	Request Date:	0032
Seq No:	2	Request Date:	02/16/23 1:52 PM EST
Previous No:		Request Date:	02/22/23 8:00 AM EST

*2-20-2023
water, sewer, gas & parked
PA, BT, CS*

NORMAL 230471088

To drakesboro@comcast.net • drakesborogas@gmail.com

COMPLETE
BY *BJ*
DATE 2-20-23

NEW TICKET

Previous No: 230471088
Seq No: 3
Request By: CALL
Expires: 03/09/23 11:59 PM EST

City: DRAKESBORO

Location Information

MUHLENBERG
JOHN PRINE AVE
STEED AVE
LOCATE A 50 FOOT RADIUS OF THE INTERSECTION

Lot:

Map Information

VIEW EXCAVATION AREA AND FACILITY MAP FOR 0032
NO

SE Lat/Lon: 37.2248325,-87.0489803

Contact Information

Phone: (270)556-8009
Fax:

Excavator Information

Phone: (270)556-8009
Phone: (270)556-8009

Excavation Information

Depth: 7 FT
Job #: A02FYL B

Members Notified

Utility Type
S,W,G
TV,FO
COMMUNICATIONS

Ticket No:

NORMAL
230471088

District Code:

0032

Request Date:

02/16/23 1:56 PM EST

Begin Date:

02/22/23 8:00 AM EST

County:

MUHLENBERG

Address/Street:

JOHN PRINE AVE

Intersecting:

STEED AVE

Subdivision:

LOCATE A 50 FOOT RADIUS OF THE INTERSECTION

Comments:

0032 Map:

VIEW EXCAVATION AREA AND FACILITY MAP FOR 0032

Attachment(s):

NW Lat/Lon:

37.2259028,-87.0503636

Contact Name:

JERRY WOOLF

Email:

JERRY.WOOLF@STAR-LLC.NET

Requested By:

JERRY WOOLF

Excavator:

STAR CONSTRUCTION

Address:

608 BARK COVE LANE
OWENSBORO, KY 42301

Type of Work:

INSTALL NEW ANCHOR

Explosives:

NO

Area Marked:

YES

Work Done For:

AT&T

District

Company Name

0032

CITY OF DRAKESBORO

0072

COMCAST COMMUNICATIONS

0139

AT&T DISTRIBUTION

*Water in area
+ sewer plugged
marked
2-20-2023
BJ & BJ*

Kentucky 811

NORMAL

Type

230510603

Ticket no

02/20/23 11:14 am

Request date

02/23/23 08:00 am

Start date

03/13/23 11:59 pm

Expiration date

Locked N

Past work start N

Past due time N

Excavator information

RON MALLORY'S PLUMBING

Excavator name

260 MYERS CHAPEL RD

Address

BELTON, KY 42324

Company phone

270-543-6175

Requested by

RON MALLORY

Phone

270-543-6175

On-site name

RON MALLORY

On-site phone

270-543-6175

Contact email

ronmallory59@gmail.com

Excavation information

REPLACE WATER SERVICE

Type of work

RICHARD BROWN

Work done for

N

Explosives

Y

Area marked

Depth (ft)

2

Job name/number

Location information

County

MUHLENBERG

City

BEECHMONT

Address

704

Street

HILL RD

Nearest intersecting street

KY-2270

Subdivision

Location of work

FROM THE CENTERLINES OF HILL RD AND KY-2270, HEAD NORTH-NORTHWEST ON HILL RD FOR 160 FT. THEN FROM THE CENTERLINE OF HILL RD, HEAD NE FOR 10 FEET TO THE BEGINNING OF THE ROUTE MARK 0.5 FEET EITHER SIDE OF THE FLAGGED ROUTE. MARK FOLLOWING THE ROUTE ENE FOR 99 FEET, THEN SSE 21 FEET.

PAINT AND FLAG.

ROUTE COORDINATES: BEGIN LAT:37.1712193, LON:-86.99969 TO LAT:37.1713432, LON:-86.9993869 TO LAT:37.1712877, LON:-86.9993708 END.

Comments

NW Lat 37.1714166

Lon -86.9998055

SE Lat 37.1711269

Lon -86.9992678

Members notified

COMPLETED BY: BS 2-20-2023

District	Utility name	Utility types	Status
0032	CITY OF DRAKESBORO	S,W,G COMMUNICATIONS	No Conflict (No natural gas in this area)
0139	AT&T DISTRIBUTION		Not yet responded

Map

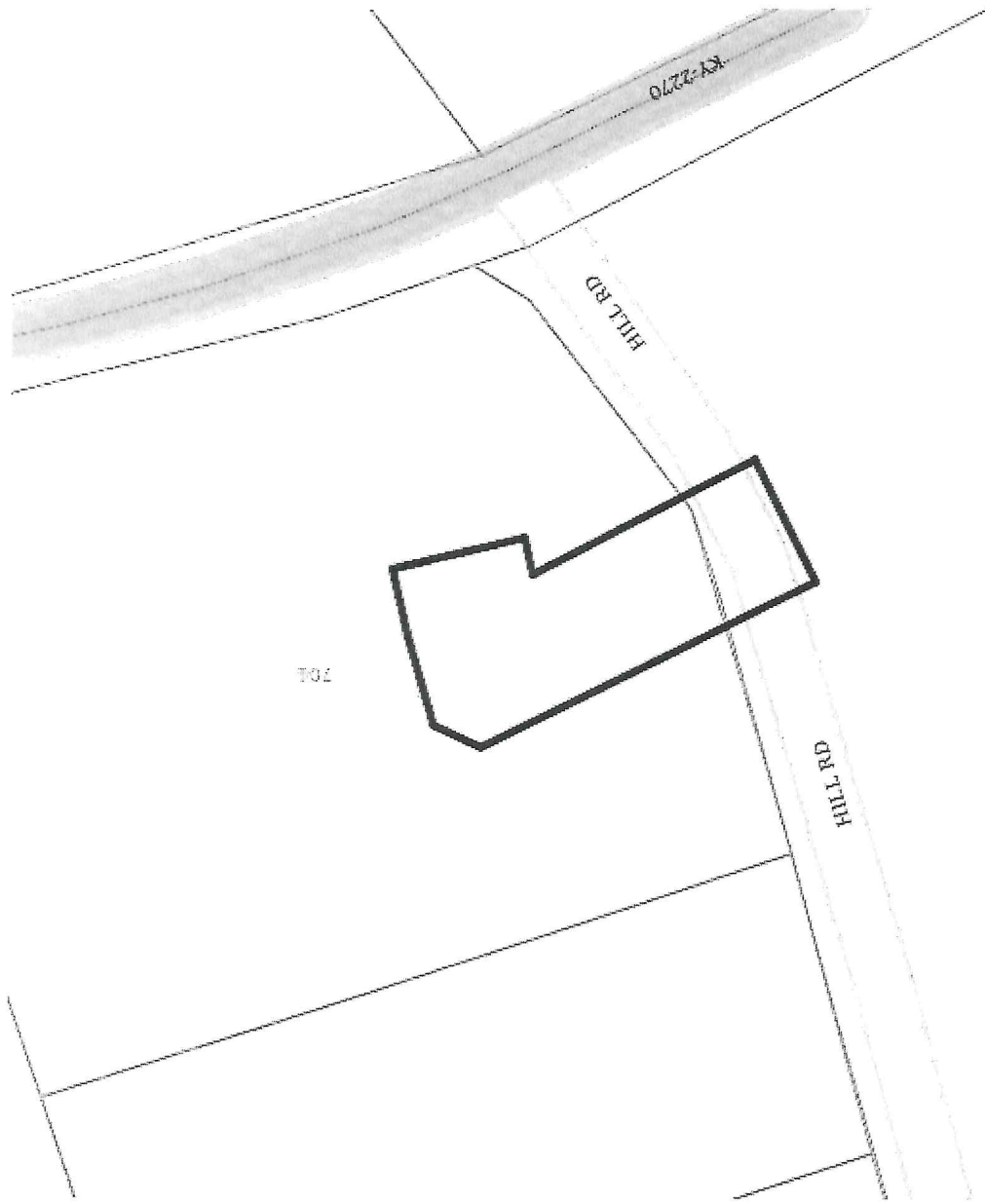

Site



Brian Jones <drakesborogas@gmail.com>

Center Messages

1 message

To: drakesboro@comcast.net, drakesborogas@gmail.com
ky@occin.com <ky@occin.com>

Tue, Feb 21, 2023 at 12:17 AM

Kentucky 811

SUMM

DAILY AUDIT OF TICKETS SENT ON 02/20/23

Date/Time: 02/21/2023 01:15:34 AM

Receiving Terminal: 0032

Seq #	Ticket #	Seq #	Ticket #
1	230516003-NORM	2	230511554-NORM

* indicates ticket # is repeated

Total Tickets: 2

NORM - NORMAL

| 2

Please call (573) 636-1556 if this data does not match the tickets you received on 02/20/23

COMPLETED
BY: RS
2-22-2023

NORMAL 230511554

To drakesboro@comcast.net • drakesborogas@gmail.com

COMPLETE
2-21-23
BY BS

NEW TICKET

Ticket No:	230511554	Previous No:	
District Code:	0032	Seq No:	2
Request Date:	02/20/23 3:03 PM EST	Request By:	CALL
Begin Date:	02/23/23 8:30 AM EST	Expires:	03/13/23 11:59 PM EDT

Location Information

County: MUHLENBERG
 Address/Street: 5108 STATE HWY 176
 Intersecting: CANEY CREEK LN
 Subdivision: MARK 20 FT RADIUS OF WOODEN STAKES WITH ORANGE RIBBON ON IN THE RIGHT REAR CORNER OF THE PROPERTY.
 Comments: 0032 Map: VIEW EXCAVATION AREA AND FACILITY MAP FOR 0032

Attachment(s): NW Lat/Lon: 37.2032571, -87.0932155
 SE Lat/Lon: 37.2021682, -87.0904266

Contact Information

Contact Name: JAMES TRAVIS
 Email: james.travis@lge-ku.com
 Phone: (270)543-9904
 Fax: (270)338-3364

Excavator Information

Requested By: JAMES TRAVIS
 Excavator: KENTUCKY UTILITIES
 Address: 382 AIRPORT RD
 GREENVILLE, KY 42345

Excavation Information

Type of Work: INSTALL POLE AND ANCHOR
 Explosives: NO
 Area Marked: YES
 Work Done For: KENTUCKY UTILITIES

Members Notified

District	0032	Company Name	CITY OF DRAKESBORO
0139	0639	AT&T DISTRIBUTION	MUNINET FIBER AGENCY
WINKY		WINDSTREAM KENTUCKY INC	

Utility Type

S,W,G
 COMMUNICATIONS
 FO
 TEL

Depth: 8 FT
 Job #:

ALL CLEAR
 2/21/23
 BS/BS



Brian Jones <drakesborogas@gmail.com>

Center Messages

1 message

Wed, Feb 22, 2023 at 12:17 AM

ky@occinc.com <ky@occinc.com>
To: drakesboro@comcast.net, drakesborogas@gmail.com

Kentucky 811

SUMM

DAILY AUDIT OF TICKETS SENT ON 02/21/23

Date/Time: 02/22/2023 01:15:35 AM

Receiving Terminal: 0032

Seq # Ticket # Seq # Ticket #

* indicates ticket # is repeated

Total Tickets: 0

Please call (573) 636-1556 if this data does not match the tickets you received on 02/21/23

COMPLETE

BY BJ DATE 2-22-23



Brian Jones <drakesborogas@gmail.com>

Center Messages

1 message

Thu, Feb 23, 2023 at 12:17 AM

ky@ocinc.com <ky@ocinc.com>
To: drakesboro@comcast.net, drakesborogas@gmail.com

Kentucky 811

SUMM

DAILY AUDIT OF TICKETS SENT ON 02/22/23

Date/Time: 02/23/2023 01:15:34 AM

Receiving Terminal: 0032

Seq #	Ticket #
1	230530868-NORM

1 230530868-NORM

* indicates ticket # is repeated

Total Tickets: 1

NORM - NORMAL

| 1

Please call (573) 636-1556 if this data does not match the tickets you received on 02/22/23

COMPLETED

By: RJ

Date:

2-23-23

NORMAL 230530868

To drakesboro@comcast.net • drakesborogas@gmail.com

COMPLETED
2-23-23

Ticket No:	NORMAL	0032	0032
District Code:	230530868	0032	0032
Request Date:	02/22/23 11:04 AM EST	0032	0032
Begin Date:	02/25/23 6:00 AM EST	0032	0032
County:	MUHLENBERG	0032	0032
Address/Street:	461 HORSESHOE LOOP	0032	0032
Intersecting:	R G HADISON LN	0032	0032
Subdivision:		0032	0032
Location Info:		0032	0032
Comments:	MARK THE REAR OF THE PROPERTY WITHIN APPX 15 FT FROM THE BACK OF THE HOUSE. PLEASE LOCATE AS QUICKLY AS POSSIBLE. THE CALLER STATES THAT ONLY THE PHONE COMPANY NEEDS TO RESPOND. SHE IS ESPECIALLY CONCERNED ABOUT THE DEPTH OF THE PHONE LINE.		
Map:	0032	0032	0032
Attachment(s):	NW Lat/Lon:	0032	0032
Contact Name:	DIANA SIMPSON	0032	0032
Email:		0032	0032
Requested By:	DIANA SIMPSON	0032	0032
Excavator:	LARRY A'DAY	0032	0032
Address:	461 HORSESHOE LOOP	0032	0032
	BELTON,	0032	0032
Type of Work:	LEVELING	0032	0032
Explosives:	NO	0032	0032
Area Marked:	NO	0032	0032
Work Done For:	DIANA SIMPSON	0032	0032
District:	0032	0032	0032
Company Name:	CITY OF DRAKESBORO	0032	0032
	LTC CONNECT	0032	0032
	TEXAS GAS TRANSMISSION	0032	0032
Utility Type:	S,W,G	0032	0032
	COMMUNICATIONS	0032	0032
	PIPELINE	0032	0032
Excavator Information:	Phone: (270)657-8215	0032	0032
	Phone: (270)657-8215	0032	0032
	Fax:	0032	0032
Contact Information:	SE Lat/Lon: 37.1290136,-87.0324471	0032	0032
	37.1302957,-87.0346056	0032	0032
Excavation Information:	Depth: 2 FT	0032	0032
	Job #:	0032	0032
Members Notified:		0032	0032

2-23-2023
Flagged gas service at side of house
B. Jones

EMERGENCY 230541230

To drakesboro@comcast.net • drakesborogas@gmail.com

COMPLETED
BY: *B.J.*
DATE: *2-23-23*

NEW TICKET

Previous No:
Seq No: 2
Request By: CALL
Expires: 03/16/23 11:59 PM EDT

Location Information

County: MUHLENBERG
Address/Street: RED HOUSE LN
Intersecting: STATE HWY 2270
Subdivision:
Location Info: SITE IS LOCATED AT INTERSECTION OF RED HOUSE LN AND STATE HWY 2270. MARK 25 FT RADIUS OF RED HOUSE LN AND STATE HWY 2270.
Comments: CREW IS ON SITE

Map Information
VIEW EXCAVATION AREA AND FACILITY MAP FOR 0032

Attachment(s): NO
NW Lat/Lon: 37.1595651,-87.0302425
SE Lat/Lon: 37.1583441,-87.0287105

Contact Information

Contact Name: JAROD HENDERSON
Email: muhlenbergwater@gmail.com
Requested By: MICHELLE POINTER
Excavator Information

Excavator: MUHLENBERG COUNTY WATER DISTRI
Address: P.O. BOX 348
GREENVILLE, KY 42345

Excavation Information
EMERGENCY - REPAIR WATER MAIN

Type of Work: NO
Explosives: NO
Area Marked: NO
Work Done For: MUHLENBERG COUNTY WATER DISTRICT 1

Members Notified

Company Name: CITY OF DRAKESBORO
District: 0032
AT&T DISTRIBUTION
S,W,G
COMMUNICATIONS

2-23-2023
Clear
B. Jones

NORMAL 230540465

To drakesboro@comcast.net • drakesborogas@gmail.com

COMPLETED BY: BS DATE: 2-23-23

Ticket No:	230540465	Previous No:	HOMOWNER
District Code:	0032	Seq No:	1
Request Date:	02/23/23 9:17 AM EST	Request By:	WEB
Begin Date:	03/02/23 8:00 AM EST	Expires:	03/16/23 11:59 PM EDT
County:	MUHLENBERG	City:	BELTON
Address/Street:	106 JAMESON LN	Location Information	
Intersecting:	LANGLEY RD	Lot:	
Location Info:	BACKYARD	Map Information	
Comments:		VIEW EXCAVATION AREA AND FACILITY MAP FOR 0032	
Attachment(s):	NO	SE Lat/Lon:	37.1725976,-86.9798034
NW Lat/Lon:		Contact Information	
Contact Name:	AMBER AVERY	Phone:	(270)543-4913
Email:	Creedriver1@gmail.com	Fax:	
Requested By:	AMBER AVERY	Excavator Information	
Excavator:	AMBER AVERY	Phone:	(270)543-4913
Address:	106 JAMESON LN BELTON, KY 43324	Excavation Information	
Type of Work:	LEVELING	Depth:	3 FT
Explosives:	NO	Job #:	
Area Marked:	NO	Members Notified	
Work Done For:	AMBER AVERY	Utility Type	S,W,G COMMUNICATIONS
District	0032	Company Name	CITY OF DRAKESBORO
	0139		AT&T DISTRIBUTION

2-23-23
Clear
B. Jones

NORMAL 230541355

To drakesboro@comcast.net • drakesborogas@gmail.com

COMPLETE
 BY B.J.
 2-23-23

Ticket No:	230541355	Previous No:	NEW TICKET
District Code:	0032	Seq No:	3
Request Date:	02/23/23 1:38 PM EST	Request By:	CALL
Begin Date:	02/28/23 8:00 AM EST	Expires:	03/16/23 11:59 PM EDT
County:	MUHLENBERG	City:	BROWDER
Address/Street:	327 ROCHESTER RD	City:	BROWDER
Intersecting:	DOUGLAS RD	Lot:	
Subdivision:		Location Information	
Location Info:	MARK A 25FT RADIUS OF THE BLUE FLAG	Map Information	
0032 Map:	VIEW EXCAVATION AREA AND FACILITY MAP FOR 0032	Attachment(s):	NO
NW Lat/Lon:	37.1994096,-87.0326051	Contact Information	
Contact Name:	KERRY MATTHIS	Excavator Information	
Email:	muhlenbergwater@gmail.com	Requested By:	LISA DEARMOND
Excavator:	MUHLENBERG COUNTY WATER DISTRI	Address:	PO BOX 348 GREENVILLE, KY 42345
Type of Work:	REPAIR WATER SERVICE	Excavation Information	
Explosives:	NO	Area Marked:	YES
Work Done For:	MUHLENBERG COUNTY WATER	Members Notified	
District	0032	Company Name	CITY OF DRAKESBORO
	0072		COMCAST COMMUNICATIONS
	0139		AT&T DISTRIBUTION
	0270		TIME WARNER CABLE
		Utility Type	S,W,G TV,FO COMMUNICATIONS COMMUNICATIONS

2-23-2023
 Flagged & painted
 B. Jones



Brian Jones <drakesborogas@gmail.com>

NORMAL 230541487

1 message

ky@occin.com <ky@occin.com>
To: drakesboro@comcast.net, drakesborogas@gmail.com

*3-23-23
Clear
B. Jones*



COMPLETED
By: *BJ*
Date: *3-23-23*

HOMOWNER

Previous No:

230541487

Seq No: 4

0032

Request By: CALL

02/23/23 2:40 PM EST

Expires: 03/16/23 11:59 PM EDT

02/28/23 12:00 PM EST

Location Information

City: DUNMOR

MUHLENBERG

1073 STATE HWY 949

J P PORTER

Lot:

MARK FRONT OF PROPERTY INSIDE THE CIRCLE DRIVEWAY

Comments:

Map Information

VIEW EXCAVATION AREA AND FACILITY MAP FOR 0032

Attachment(s):

NO

SE Lat/Lon: 37.1146002,-86.9868136

37.1164588,-86.9883410

Contact Information

Phone: (270)725-2884

WILLIAM HARPER

Contact Name:

Fax:

Email:

Excavator Information

Phone: (270)725-2884

WILLIAM HARPER

Requested By:

Phone: (270)725-2884

WILLIAM HARPER

Excavator:

1073 STATE HWY 949

Address:

DUNMOR,

Excavation Information

PLANTING TREE

Type of Work:

NO

Depth: 3 FT

Explosives:

NO

Job #:

Area Marked:

WILLIAM HARPER

Work Done For:

Members Notified

District

Company Name

Utility Type

0032

CITY OF DRAKESBORO

COMMUNICATIONS

0196

LTC CONNECT

PIPELINE

0347

TEXAS GAS TRANSMISSION

NORMAL 230541781

To drakesboro@comcast.net • drakesborogas@gmail.com

Ticket No: 230541781
District Code: 0032
Request Date: 02/23/23 3:33 PM EST
Begin Date: 02/28/23 8:00 AM EST

Location Information

County: MUELLENBERG
Address/Street: 722 BROAD ST
Intersecting: MINE ST

Subdivision: FROM THE CENTERLINES OF BROAD ST AND MINE ST, HEAD WEST-SOUTHWEST ON BROAD ST FOR 576 FT. THEN FROM THE CENTERLINE OF BROAD ST, HEAD SSW FOR 126 FEET TO THE BEGINNING OF THE ROUTE MARK 2.5 FEET EITHER SIDE OF THE POINTS IN THE ROUTE. MARK FOLLOWING THE ROUTE NW FOR 65 FEET, THEN NE 101 FEET. PAINT AND FLAG. DO NOT PAINT HARD SURFACES. ROUTE COORDINATES: BEGIN LAT:37.2155557, LON:-87.0577402 TO LAT:37.2156967, LON:-87.0578784 TO LAT:37.2158697, LON:-87.0576061 END.

Comments:

0032 Map: VIEW EXCAVATION AREA AND FACILITY MAP FOR 0032
Attachment(s): NO

NW Lat/Lon: 37.2159662,-87.0579666
Contact Information: SE Lat/Lon: 37.2154593,-87.0574854

Contact Name:

Email: brian.reed@perfecton.com
Requested By: CHRIS VINCENT

Excavator Information

Phone: (270)977-3396
Fax: (270)608-5375

Excavator:

Address: PERFECTION LAWN & LANDSCAPE
 260 SPARTAN DR
 GREENVILLE, KY 42345

Excavation Information

Type of Work: INSTALL DRAINAGE SYSTEM
Explosives: NO
Area Marked: UNKNOWN
Work Done For: SARAH BOYD

Members Notified

District: 0032
Company Name: CITY OF DRAKESBORO
Utility Type: S,W,G
AT&T DISTRIBUTION

*2-23-2023
 Sewer, water, gas marked
 B&B*

COMPLETED
 BY: BS
 Date: 2-23-23

NEW TICKET
Previous No:
Seq No: 5
Request By: WEB
Expires: 03/16/23 11:59 PM EDT



Brian Jones <drakesborogas@gmail.com>

Center Messages
1 message

ky@ocinc.com <ky@ocinc.com>
To: drakesboro@comcast.net, drakesborogas@gmail.com

Fri, Feb 24, 2023 at 12:17 AM

Kentucky 811

SUMM

DAILY AUDIT OF TICKETS SENT ON 02/23/23

Date/Time: 02/24/2023 01:15:37 AM

Receiving Terminal: 0032

Seq #	Ticket #
1	230540465-NORM
2	230541230-EMER
3	230541355-NORM
4	230541487-NORM
5	230541781-NORM

* indicates ticket # is repeated

Total Tickets: 5

NORM - NORMAL

4

EMER - EMERGENCY

1

Please call (573) 636-1556 if this data does not match the tickets you received on 02/23/23

COMPLETED BY BJ 2-23-23

IN PROGRESS 230582070

To drakesboro@comcast.net • drakesborogas@gmail.com

COMPLETED
BY: B5
2-27-23

HOMEOWNER

Previous No:

Seq No: 1

Request By: CALL

Expires: 03/20/23 11:59 PM EDT

Location Information

City: BROWDER

Lot:

MARK THE ENTIRE DRIVEWAY

Comments:

VIEW EXCAVATION AREA AND FACILITY MAP FOR 0032

Map Information

Attachment(s):

NO

37.1945977,-87.0112403

SE Lat/Lon: 37.1890689,-87.0046362

Contact Information

BRENT MOORE

Contact Name:

moorexavation@gmail.com

Email:

Excavator Information

BRENT MOORE

Requested By:

BRENT MOORE

Excavator:

788 TOM HALL RD

Address:

BROWDER,

Excavation Information

DIGGING UP DRIVEWAY

Type of Work:

NO

Explosives:

NO

Area Marked:

BRENT MOORE

Work Done For:

Members Notified

CITY OF DRAKESBORO

District

AT&T DISTRIBUTION

0139

COMMUNICATIONS

Utility Type

S,W,G

Depth: 8 FT

Job #:

2-27-2023

Not in area
Wrong address given
B. Jones



Brian Jones <drakesborogas@gmail.com>

Center Messages

1 message

Tue, Feb 28, 2023 at 12:17 AM

ky@occinc.com <ky@occinc.com>
To: drakesboro@comcast.net, drakesborogas@gmail.com

Kentucky 811

SUMM

DAILY AUDIT OF TICKETS SENT ON 02/27/23

Date/Time: 02/28/2023 01:15:37 AM

Receiving Terminal: 0032

Seq #	Ticket #	Seq #	Ticket #
1	230582070-INPR		

1 230582070-INPR

* Indicates ticket # is repeated

Total Tickets: 1

INPR - IN PROGRESS

| 1

Please call (573) 636-1556 if this data does not match the tickets you received on 02/27/23

COMPLETED
BY BJ
Date 2-28-2023

NORMAL 230591529

To drakesboro@comcast.net • drakesborogas@gmail.com

NEW TICKET

Previous No:

Seq No: 1

Request By: WEB

Expires: 03/21/23 11:59 PM EDT

City: DRAKESBORO

BY: BS

2-28-2023

COMPLETED

Ticket No:

230591529

District Code:

0032

Request Date:

02/28/23 2:21 PM EST

Begin Date:

03/06/23 9:00 AM EST

County:

WUHLENBERG

Address/Street:

11 EXIT LN

Intersecting:

US HWY 431 S

Subdivision:

Lot:

FROM THE CENTERLINES OF EXIT RD AND US HWY 431 S, HEAD WEST-SOUTHWEST ON EXIT RD FOR 17 FT. THEN FROM THE CENTERLINE OF EXIT RD, HEAD N FOR 27 FEET TO THE BEGINNING OF THE ROUTE MARK 10 FEET EITHER SIDE OF THE POINTS IN THE ROUTE. MARK FOLLOWING THE ROUTE N FOR 336 FEET. PAINT AND FLAG. ROUTE COORDINATES: BEGIN LAT:37.2010048, LON:-87.037014 TO LAT:37.2019231, LON:-87.0370824 END.

Comments:

Map Information

VIEW EXCAVATION AREA AND FACILITY MAP FOR 0032

Attachment(s):

NO

NW Lat/Lon:

37.2020103,-87.0371914

Contact Name:

JEFF HIGGINS

Email:

jeff.higgins@ky.gov

Requested By:

JEFFREY HIGGINS

Excavator:

KENTUCKY DEPARTMENT OF TRANSP

Address:

1840 MAIN ST
MADISONVILLE, KY 42431

Type of Work:

UTILITY LOCATION

Explosives:

NO

Area Marked:

NO

Work Done For:

KDOT

Members Notified

District

0032

0072

0139

WINKY

Company Name

CITY OF DRAKESBORO

COMCAST COMMUNICATIONS

AT&T DISTRIBUTION

WINDSTREAM KENTUCKY INC

Utility Type

S,W,G

TV,FO

COMMUNICATIONS

TEL

2-28-2023
Flagged & Painted
BS & BS