

COMMONWEALTH OF KENTUCKY  
BEFORE THE PUBLIC SERVICE COMMISSION

In the Matter of:

SOUTH KENTUCKY RURAL ELECTRIC COOPERATIVE )  
CORPORATION )  
 )  
\_\_\_\_\_ ) CASE NO. 94-518  
 )  
ALLEGED VIOLATIONS OF COMMISSION )  
REGULATION 807 KAR 5:041 )

O R D E R

South Kentucky Rural Electric Cooperative Corporation ("South Kentucky"), a Kentucky corporation which engages in the distribution of electricity to the public for compensation for light, heat, power, and other uses, and which was formed under KRS 279.010 to 279.220, is a utility subject to Commission jurisdiction. KRS 278.010; KRS 279.210.

KRS 278.280(2) directs the Commission to prescribe rules and regulations for the performance of services by utilities. Pursuant to this statutory directive, the Commission promulgated Commission Regulation 807 KAR 5:041, Section 3, which requires electric utilities to maintain their plant and facilities in accordance with the standards of the National Electrical Safety Code (1990 edition) ("NESC").

Commission Staff has submitted to the Commission an Electrical Utility Accident Investigation Report dated August 29, 1994, appended hereto, which alleges:

1. On August 4, 1994, Jeff Belcher received an electric shock when the track drill which he was operating came into contact

with a 120-volt electric underground service. The underground service was located on or near Kentucky Highway 769, approximately two miles from Somerset, Kentucky.

2. At the time of the incident, the electric underground service in question failed to comply with the minimum burial depth standards set forth in National Electrical Safety Code Section 353D2.

3. At the time of the incident, South Kentucky owned and operated the underground service.

4. As a result of its failure to bury the underground service at an acceptable depth, South Kentucky is in probable violation of Commission Regulation 807 KAR 5:041, Section 3.

Based on its review of the Electrical Utility Accident Investigation Report and being otherwise sufficiently advised, the Commission finds that prima facie evidence exists that South Kentucky has failed to comply with Commission Regulation 807 KAR 5:041, Section 3.

The Commission, on its own motion, HEREBY ORDERS that:

1. South Kentucky shall appear before the Commission on March 24, 1995 at 10:00 a.m., Eastern Standard Time, in Hearing Room 1 of the Commission's offices at 730 Schenkel Lane, Frankfort, Kentucky, for the purpose of presenting evidence concerning the alleged violation of Commission Regulation 807 KAR 5:041, Section 3, and of showing cause why it should not be subject to the penalties prescribed in KRS 278.990(1) for this alleged violation.

2. South Kentucky shall submit to the Commission within 20 days of the date of this Order a written response to the allegations contained in the Electrical Utility Accident Investigation Report.

3. The Electrical Utility Accident Investigation Report of August 29, 1994, a copy of which is appended hereto, is made part of the record of this proceeding.

4. Any motion requesting any informal conference with Commission Staff to consider any matter which would aid in the handling or disposition of this proceeding shall be filed with the Commission no later than 20 days from the date of this Order.

Done at Frankfort, Kentucky, this 21st day of December, 1994.

PUBLIC SERVICE COMMISSION

  
Chairman

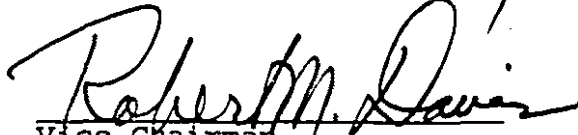
  
Vice Chairman

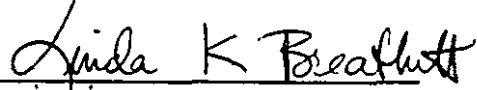
  
Commissioner

ATTEST:

  
Executive Director

APPENDIX

APPENDIX TO AN ORDER OF THE KENTUCKY PUBLIC SERVICE  
COMMISSION IN CASE NO. 94-518 DATED DECEMBER 21, 1994

ELECTRICAL UTILITY ACCIDENT INVESTIGATION

DATE OF THIS REPORT 8-29-94 SUBMITTED BY Elie El-Rouaiheb

NAME OF UTILITY South Kentucky RECC

ACCIDENT REPORTED BY Donnie Burdine

DATE ACCIDENT OCCURRED 8-4-94 at 6:15 p.m.

DATE & TIME UTILITY LEARNED OF ACCIDENT 8-4-94 at 6:37 p.m.

DATE & TIME ACCIDENT REPORTED 8-4-94 at 8:45 p.m.

DATE OF ACCIDENT INVESTIGATION 8-5-94

DATE SUMMARY WRITTEN REPORT WAS RECEIVED FROM UTILITY 8-8-94

PERSONS ASSISTING IN THE INVESTIGATION Jackson Denham of South  
Kentucky RECC and Martha M. Morton of PSC

NAME OF VICTIM Jeff Belcher SEX M AGE N/A

FATAL No NAME OF EMPLOYER M & D General Contractors

INJURIES Mr. Belcher received an electrical shock and  
experienced pain in his arm.

LOCATION OF ACCIDENT SITE Two miles from the Somerset city limits  
out Highway 769, RR 7, Box 95, Somerset, Kentucky.

DESCRIPTION OF ACCIDENT Mr. Jeff Belcher was drilling holes with  
a track drill to blast a ditch for water lines. The drill bit  
contacted the underground 120V electric line. He received an  
electrical shock and was taken to the hospital. No request was  
made to South Kentucky RECC to locate the underground electric  
lines prior to the drilling. At the point of the accident, the  
buried underground electric line was 20 inches deep and at other

ELECTRICAL UTILITY ACCIDENT INVESTIGATION (Continued)

points the depth ranged from 15 inches to 26 inches; however, the majority of the line was less than 20 inches deep.

SOURCE OF INFORMATION Jackson Denham of South Kentucky RECC, South Kentucky RECC's accident report and an on site investigation.

PROBABLE VIOLATIONS There was one probable violation of Commission Regulations involved in this accident. The burial depth of the conductor was 20 inches, resulting in probable violation of 807 KAR 5:041, Section 3(1), Acceptable Standards, which requires compliance with the NESC. The 1990 NESC, Section 353(D2), requires burial depth of underground conductors with less than 600V phase-to-phase to be 24 inches. It should be noted that this violation didn't contribute to the accident.

CORRECTIVE ACTION South Kentucky RECC indicated that the underground electric conductor is scheduled to be relocated along with some overhead electric conductors due to the construction of new roads in the area. The relocation of the electric lines is expected to be completed within 60 days from the date of the accident. South Kentucky should insure that the burial depth of the new underground conductors meet the 1990 NESC requirements.

Voltage of line or facilities 120-240V

Utility: South Kentucky RECC

Date 8-5-94 Time 12:30 p.m.

Measurements made by: Jackson Denham

Submitted by: Eli F. Rowland



# SOUTH KENTUCKY RURAL ELECTRIC

COOPERATIVE CORPORATION

Keith Sloan  
President and General Manager  
Phone (606) 678-4121

925-929 North Main Street  
P. O. Box 910  
Somerset, Kentucky 42502-0910

August 5, 1994

**RECEIVED**

AUG 08 1994

DIVISION OF UTILITY  
ENGINEERING & SERVICES

Martha M. Morton, P.E.  
Kentucky P.S.C.  
P.O. Box 615  
Frankfort, Ky 40602

Martha,

Here is a signed copy of the Jeff Belcher accident report. I didn't sign the other one that I gave you when you were here.

Yours truly,

Jackson Denham  
Supervisor, Special  
Projects Engineering

JD/lr

Enclosure

INVESTIGATIVE REPORT  
PUBLIC ACCIDENT  
ELECTRICAL CONTACT

COOPERATIVE: Name SOUTH KENTUCKY RURAL ELECTRIC Telephone No. (606) 678-4121  
COOPERATIVE CORPORATION

Address 925 N. MAIN ST., P.O. BOX 910, SOMERSET, KY 42502

DATE OF ACCIDENT: 08/04/94 APPROX. 6:15 AM Cooperative PM Notified 08/04/94 6:37 AM PM

LOCATION: At the Bobby Loveless Residence - Two miles from the Somerset City Limits out Highway 769 (Rush Branch Road) House up on the hill on the left at 7 mile marker.

DESCRIPTION OF ACCIDENT: In the process of drilling holes to blast ditch for water line, Jeff Belcher received an electric shock. When the track drill he was operating nicked the insulation from and came in contact with a 120 Volt electric underground service wire that runs from the transformer pole to the meter on the house.

INJURED:

Name	Address	Telephone No.	Occupation
1. Jeff Belcher,	3712 Camelot Dr. Apt. 4,	(606) 271-4310	Drill Operator (Rock
	Lexington, KY 40517		Drill) on water line.

EXTENT OF INJURY: 1. Complained of his arm hurting after receiving electrical shock.

TREATMENT: Ambulance, Doctor, Hospital, Etc.  
911 Dispatched Rescue Squad - Took Jeff to Lake Cumberland Regional Hospital, 305 Langdon St., Somerset - E.R. personnel reported they did a thorough examination and could find no injury, burn marks or anything and they released him. Advised him to check with his family doctor if he had any future problem.

COOPERATIVE EMPLOYEES AT SCENE:

Name	Job Title
Harlan Stout	- Lead Serviceman
Rodney Jones	- Serviceman 1st Class
Jackson Denham	- Supervisor, Special Projects Engineering

WITNESSES:

Name	Address	Telephone No.
Bobby Loveless	RR7, Box 95, Somerset, Ky 42501	(606) 678-8254

LAW OR OTHER OFFICIALS: None

INVESTIGATING:

WEATHER AND TERRAIN

CONDITIONS: Hot & Humid and threatening rain, However, the ground was very dry and rocky at the accident site.

SYSTEM Voltage-type & size conductor-type pole structures-etc.  
PROFILE: 120 Volt Underground Service Wire - Direct Burial Triplex Wire. The wire was installed in a 4-inch black plastic drain pipe. This is the service wire that runs from the transformer pole to the meter on the house.

PROTECTIVE DEVICES	Type	Location	Rating	Did they operate?
	Fuse	at Transformer	3.5 Amp	No

DID OUTAGE OCCUR?	Yes	Date	Time	AM	Duration
	No	/ /		PM	

WAS COOPERATIVE No  
NOTIFIED OR AWARE  
OF WORK IN THE AREA - EXPLAIN:

CLEARANCES: Prepare and attach a diagram. It need not be to scale but the measurements must be accurate. If clearances are reduced because of the accident, measurement and photographs are needed before returning to original condition. Document what caused the reduced clearances, such as broken pole or guy wire, construction equipment, etc. Reference distances to point of impact.

CODE REQUIREMENTS FOR LINE IN QUESTION:

AGENCY INVOLVED: Antenna, auger, crane, construction equipment, etc. Give measurements, make, model, or serial number. Describe any warning sign.  
Track Drill Machine - This machine drills a small diameter hole (Approx. 1 1/2") into rock and hard ground enabling the placement of explosive charges. The machine is mostly steel and is on steel tracks. It is operated by standing on the ground beside the control levers.

ADDITIONAL COMMENTS: Bobby Loveless, the property owner where the accident occurred, is a contractor by trade, who does digging and earth work himself, came out and showed Jeff where the existing water line and buried electric line is located. Jeff began digging a hole at a location away from the lines at the top of the bluff. When Bobby Loveless went into the house to get his shoes, Jeff moved the machine to directly over the electric line and drilled into it. When Bobby came back out of the house Jeff told Bobby he had found the electric line and received a shock and his arm hurt.

PREPARED BY: Jackson Denham Supervisor, Special Projects Engineering 08/05/94 (606) 678-4121 Ext. 268  
Signature Date Telephone No.



PREPARED BY JD  
8/5/94

- NOT TO SCALE -

TOOLS USED  
35 MM CAMERA  
50' STEEL TAPE  
6' RULER  
VOLTMETER

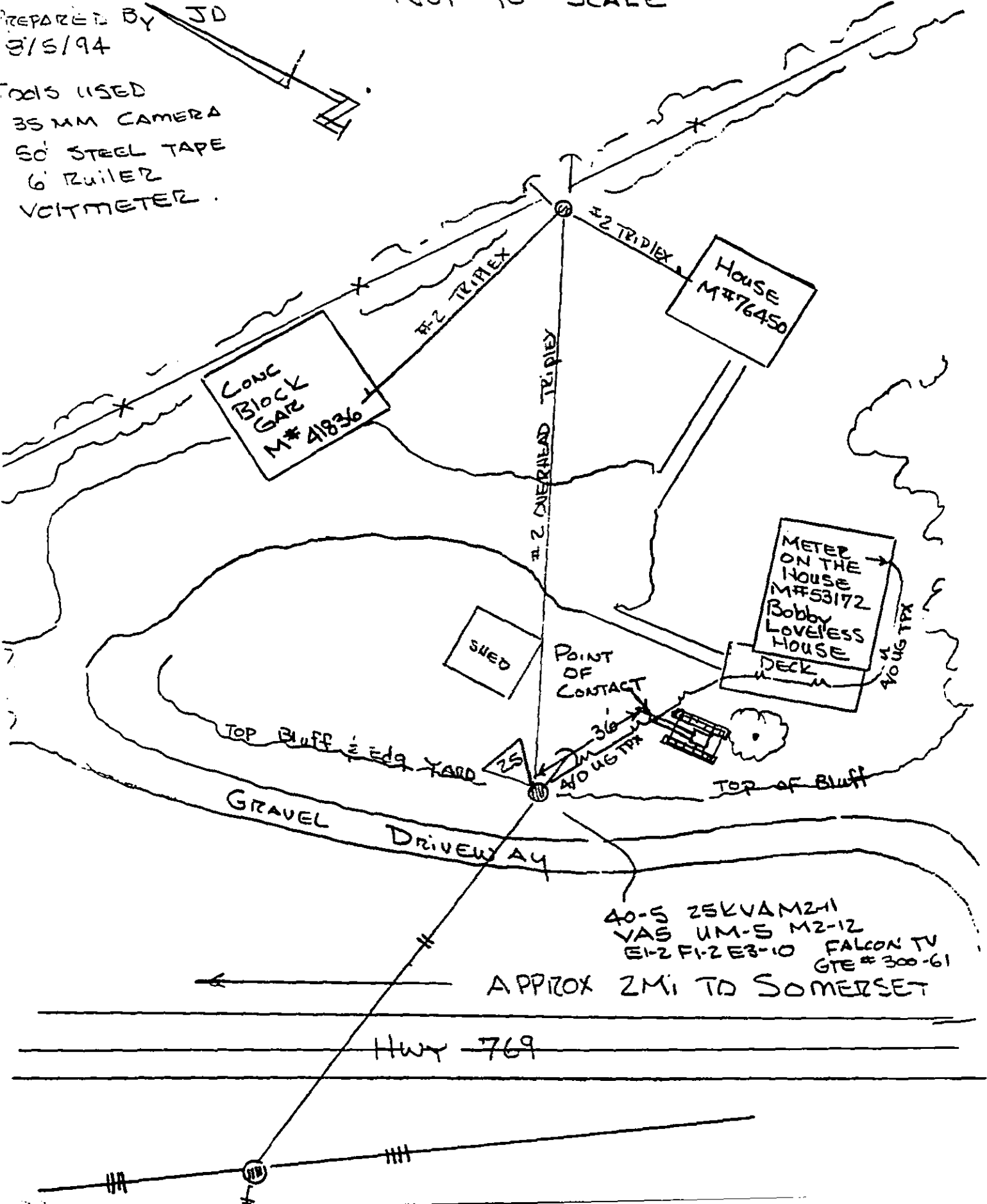

CONC BLOCK  
GAR M# 41836

House  
M# 76450

METER  
ON THE  
HOUSE  
M# 53172  
Bobby  
LOVELESS  
HOUSE  
DECK

SHED

POINT  
OF  
CONTACT

TOP BLUFF Edge YARD

TOP OF BLUFF

GRAVEL  
DRIVEWAY

40-5 25KVAM2H  
VAS UM-5 M2-12  
EI-2 FI-2 E3-10 FALCON TV  
GTE # 300-61

APPROX 2MI TO SOMERSET

Hwy 769

IMAGES THROUGHOUT THIS ROLL OF FILM MAY BE ILLEGIBLE DUE TO THE POOR  
CONDITION OF THE ORIGINAL RECORDS.

8-5-94

So. Ky. RECC dispatcher, Donnie Burdine called me at 19:10 on 8-4-94 to report a electric contact accident.

I called Don Alexander to report this to him and came into office dispatch center.

I was not able to find out any information about condition of person involved. AT 20:50 Donnie Burdine called P.S.C. to report what we had at that time.

I called hospital at 21:40 and was told by emergency room that Mr. Belchet had been checked and released at 21:00 hours. There were no visible burn marks on skin and all vital signs were good. They had noted in he had received an electrical shock, was ok and released with instructions to see his family doctor if he has any problems in the next two or three days.

Walter West  
Dispatch Supervisor  
For week of 8-1-7 1994

ATTACHMENT C

PICTURES TAKEN AT THE ACCIDENT SITE

