

# Czar Coal Corporation

---

107 Dennis Drive  
Lexington, KY 40503  
Telephone: (859) 721-0343  
Facsimile: (859) 422-6775  
Email: [jill@czarky.net](mailto:jill@czarky.net)

July 22, 2009

Commonwealth of Kentucky  
Public Service Commission  
211 Sower Blvd.  
P.O. Box 615  
Frankfort, KY 40602-0615

RECEIVED

JUL 24 2009

PUBLIC SERVICE  
COMMISSION

**Re: Case No. 2009-00134**

To Whom It May Concern:

Please find enclosed Czar Coal Corporation's Response to the Commission's data requests, pursuant to the Order entered July 16, 2009.

Sincerely,



R. Jill Webb  
Counsel for Czar Coal Corporation

COMMONWEALTH OF KENTUCKY  
BEFORE THE PUBLIC SERVICE COMMISSION

RECEIVED  
JUL 24 2009  
PUBLIC SERVICE  
COMMISSION

In The Matter of:

APPLICATION OF CZAR COAL CORPORATION )  
FOR AUTHORIZATION TO RECEIVE SERVICE ) CASE NO.  
FROM KENTUCKY POWER COMPANY IN BIG ) 2009-00134  
SANDY RECC'S SERVICE TERRITORY )

**CZAR COAL CORPORATION'S RESPONSE TO ORDER**

Pursuant to an Order of the Kentucky Public Service Commission dated June 30, 2009, the following is Czar Coal Corporation's ("Czar") response to Appendix B of the Order:

1. Refer to Exhibit A to the Application. The proposed Czar line and the territorial boundary line are both designated by blue lines on the map. Provide a map that more clearly delineates the territorial boundary line as well as the proposed 12.47 KV line.

Response: An updated map is attached hereto.

2. Refer to the Application, Paragraph (e), which provides that Czar has an existing power infrastructure on its property that is served by Kentucky Power.

a. Describe the existing power infrastructure.

Response: Czar owns the Pevler Station. This is the metering point from which Czar receives power from Kentucky Power. The station consists of one 10 MVA transformer that 69 KV is reduced to 12.47 KV. Another 7.5 MVA transformer is also located at the point. The same incoming 69 KV is reduced to 34.5 KV. The 12.47 KV is utilized throughout the mining property to distribute power to the preparation plant, coal loadout, and deep mines. The 34.5 KV is utilized to distribute power to the Matrix Energy Mine. This 34.5 KV line has a 7.5 MVA transformer located on it to reduce the

voltage to 12.47 KV and supply power to an existing power borehole drop and office building.

b. State whether the existing power infrastructure is located in Kentucky Power territory and clearly mark this existing infrastructure on the map requested in Item 1 above.

Response: Yes, the existing infrastructure is located in Kentucky Power territory. The existing infrastructure is marked on the map attached hereto.

c. Provide the following information with regard to the existing power infrastructure:

(1) State who owns and maintains the infrastructure.

Response: Czar owns and maintains the infrastructure.

(2) State when the infrastructure was constructed.

Response: The 69 KV to 12.470 Station was originally constructed by and owned by AEP in the early 1970s. It was later purchased in 1994 by Cumberland River Coal Company. Czar purchased Cumberland River Coal Company's assets, and subsequently became the owner of the station. The 34.5 transformer and line was constructed around 2005.

(3) State whether the infrastructure was constructed and is maintained in accordance with the National Electric Safety Code ("NESC").

Response: Yes, the infrastructure was constructed and maintained according to NESC.

3. Refer to the Application, Paragraph, (e), which provides that Czar can obtain electrical service for the mine from Kentucky Power by constructing approximately

5,800 feet or 1.09 miles of power line from the existing infrastructure to the mine entrance at no cost to Kentucky Power.

a. State whether Kentucky Power or Czar will be responsible for constructing the proposed power line and explain whether the line will be constructed pursuant to the NESC.

Response: Czar will construct and maintain the proposed line according to NESC.

b. Describe any experience Czar has with constructing and/or maintaining electric power lines.

Response: Since 1995, Czar has constructed and maintained miles of power lines on its property.

c. Explain whether the proposed line will be located entirely on Czar property.

Response: The proposed line will be located entirely on property owned or leased by Czar.

d. Describe the property over which the proposed line is to be constructed. Specifically, will the proposed line be installed over or near any residences, structures, or power lines?

Response: The property is a mining complex consisting of approximately 17,000 acres. Surface mining and deep mining have occurred on the property since the 1970's. The vast majority of the property over which the line will be constructed is reclaimed surface mines. The line will not be installed over or near any residences, structures or power lines.

Respectfully submitted,

---

R. Jill Webb, Esq.  
Counsel for Czar Coal Corporation  
107 Dennis Drive  
Lexington, KY 40503

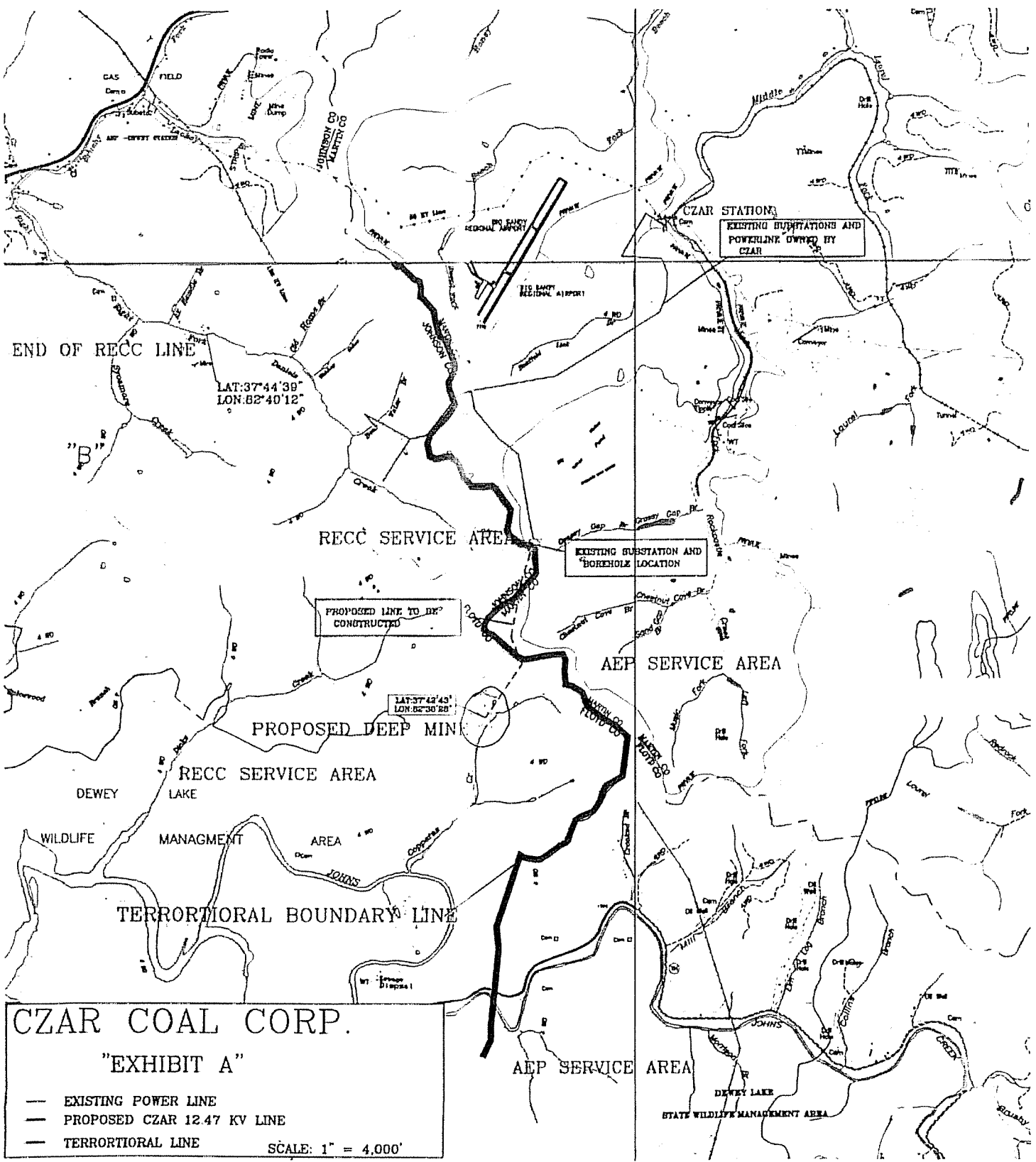

**CZAR COAL CORP.**  
**"EXHIBIT A"**

- EXISTING POWER LINE
- PROPOSED CZAR 12.47 KV LINE
- TERRITORIAL LINE

SCALE: 1" = 4,000'

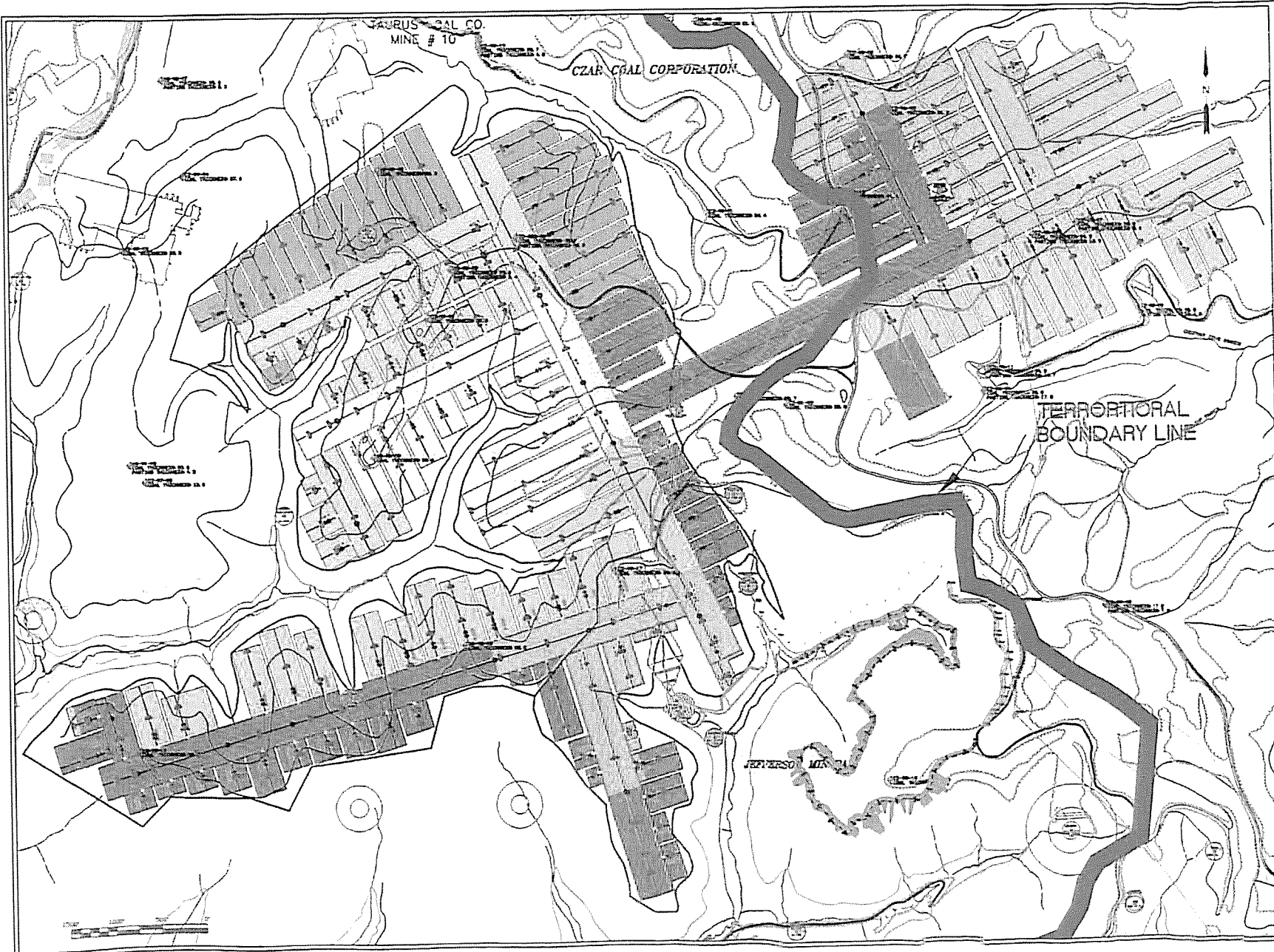

BEECH FORK PROCESSING, LLC  
 HADON SEAM  
 5.71 PLAN ACCESS ROAD

HADON COAL THICKNESS 2.5 FEET AND GREATER  
 HADON COAL THICKNESS LESS THAN 2.5 FEET  
 HADON OLD WORKS

- 2009
- 2010
- 2011
- 2012
- 2013
- 2014
- 2015
- 2016
- 2017
- 2018

