

Writers Direct:
Phone: (859) 426-2151
Fax: (859) 341-4879
E-mail: phughes@dbllaw.com

May 16, 2005

FEDERAL EXPRESS

Public Service Commission
Attn: Mr. Dale Wright
211 Sower Boulevard
P.O. Box 615
Frankfort, Kentucky 40601

RECEIVED
MAY 17 2005
PUBLIC SERVICE
COMMISSION

Re: Slick Rock
Docket No. 2005-00078

Dear Mr. Wright:

Pursuant to your letter of May 4, 2005 regarding deficiencies on the above site, please find enclosed revised drawings that should remedy the deficiencies. As you can see from the attached letters, all property owners that should have been notified of the intent to build were so notified.

If you have any questions or require further information, please do not hesitate to contact me.

Very truly yours,

Patrick R. Hughes

PRH/rmc
Enclosures

cc: Ms. Sherry McFee

64299.1

ATTORNEYS AT LAW

(23)

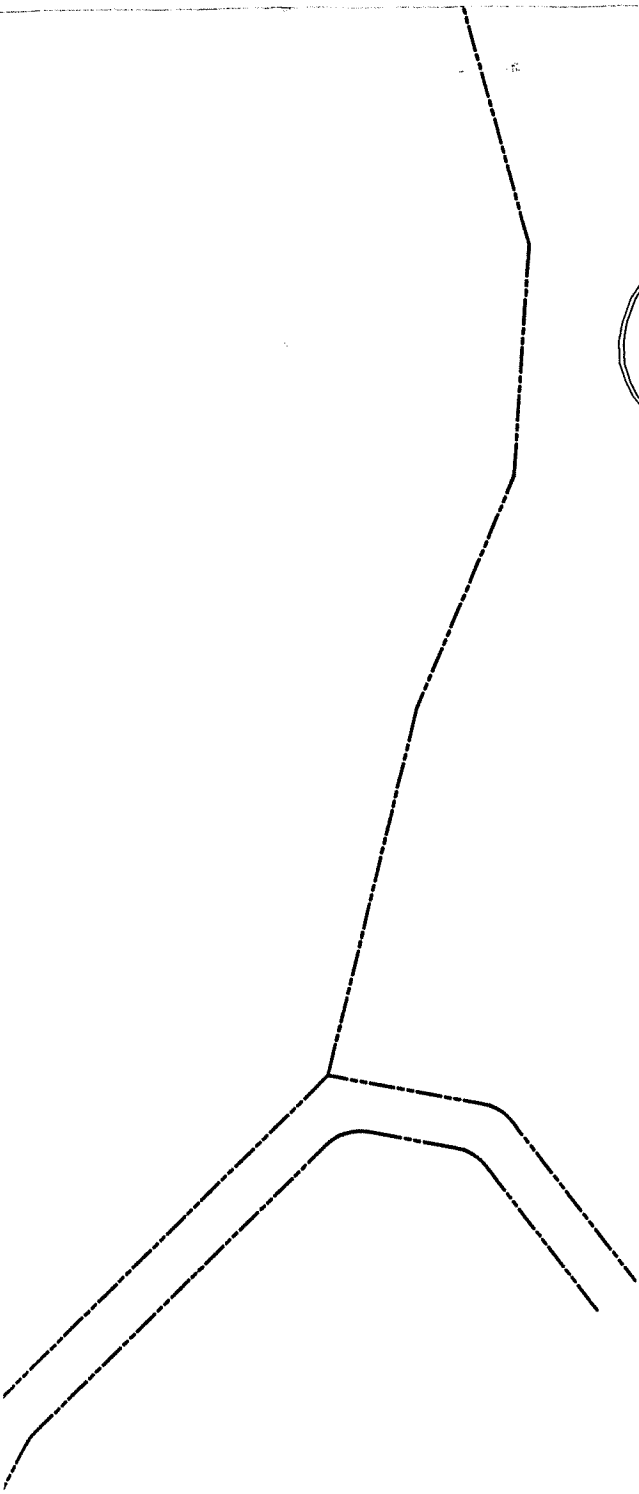

(15)

HEMPHILL CORPORATION SITE SURVEY: KENTUCKY
"SLICK ROCK" TOWER SITE
LOCATED IN: BARREN COUNTY, KENTUCKY
LOCAL PROPERTY OWNERSHIP EXHIBIT PLAN
PREPARED FOR HEMPHILL CORPORATION
HEMPHILL CORPORATION SITE NO.: 1412

RECEIVED

MAY 17 2005

PUBLIC SERVICE
COMMISSION

SHEET NUMBER:

1 OF 1

PROJECT NUMBER:

J.N. 25.012.20

U.S. Postal Service™
CERTIFIED MAIL™ RECEIPT
(Domestic Mail Only; No Insurance Coverage Provided)

For delivery information visit our website at www.usps.com

OFFICIAL USE

Postage	\$
Certified Fee	
Return Receipt Fee (Endorsement Required)	
Restricted Delivery Fee (Endorsement Required)	
Total Postage & Fees	\$

Postmark
Here

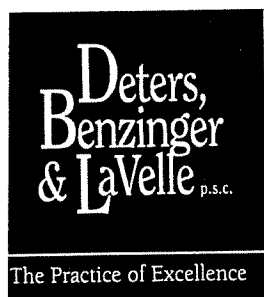

Writers Direct:
Phone: (859) 426-2151
Fax: (859) 341-4879
E-mail: phughes@dbllaw.com

Sent To **Wilbur Hodge**
111 Oscar Gilbin Road
 Street, Apt. No., or PO Box No. **Glasgow, KY 42141**
 City, State, ZIP+4

April 15, 2005

PS Form 3800, June 2002 See Reverse for Instructions

REIPT REQUESTED

Wilbur Hodge
111 Oscar Gilbin Rd.
Glasgow, KY 42141

Re: Kentucky Public Service commission
Slick Rock, Kentucky
Docket No. 2005-00078

Dear Sir/Madam:

Nextel WIP Lease Corp. and Hemphill Corporation have applied to the Kentucky Public Service Commission for a Certificate of Public Convenience and Necessity to construct and operate communications telecommunications services. The facility will include a 340 foot guyed tower for multiple wireless carriers to be located at 1636 Beaver Creek Road, Glasgow, Barren County, Kentucky. A map showing the location of the proposed new facility is enclosed.

The Kentucky Public Service Commission invites your comments regarding the proposed construction. You also have the right to intervene in this matter.

Your comments or request for intervention, if any, should be addressed to: Executive Director, Kentucky Public Service Commission, 211 Sower Blvd., P.O. Box 615, Frankfort, Kentucky 40602-0615. Please refer to Docket No. 2005-00078 in your correspondence.

Very truly yours,

Patrick R. Hughes
Counsel for Nextel WIP Lease Corp.
207 Thomas More Parkway
Crestview Hills, KY 41017
(859) 341-1881

ATTORNEYS AT LAW

U.S. Postal Service™
CERTIFIED MAIL™ RECEIPT
(Domestic Mail Only; No Insurance Coverage Provided)

For delivery information visit our website at www.usps.com

OFFICIAL USE

Postage	\$
Certified Fee	
Return Receipt Fee (Endorsement Required)	
Restricted Delivery Fee (Endorsement Required)	
Total Postage & Fees	\$

Postmark
Here

**Deters,
Benzinger
& LaVelle** p.s.c.

The Practice of Excellence

Writers Direct:
Phone: (859) 426-2151
Fax: (859) 341-4879
E-mail: phughes@dbllaw.com

Sent To **Catherine Bowles Bagby**
4430 Coral Hill Rd.
Street, Apt. No.,
or PO Box No. **Glasgow, KY 42141**
City, State, ZIP+4

April 15, 2005

PS Form 3800, June 2002

See Reverse for Instructions

EIPT REQUESTED

Catherine Bowles Bagby
4430 Coral Hill Rd.
Glasgow, KY 42141

Re: Kentucky Public Service commission
Slick Rock, Kentucky
Docket No. 2005-00078

Dear Sir/Madam:

Nextel WIP Lease Corp. and Hemphill Corporation have applied to the Kentucky Public Service Commission for a Certificate of Public Convenience and Necessity to construct and operate communications telecommunications services. The facility will include a 340 foot guyed tower for multiple wireless carriers to be located at 1636 Beaver Creek Road, Glasgow, Barren County, Kentucky. A map showing the location of the proposed new facility is enclosed.

The Kentucky Public Service Commission invites your comments regarding the proposed construction. You also have the right to intervene in this matter.

Your comments or request for intervention, if any, should be addressed to: Executive Director, Kentucky Public Service Commission, 211 Sower Blvd., P.O. Box 615, Frankfort, Kentucky 40602-0615. Please refer to Docket No. 2005-00078 in your correspondence.

Very truly yours,

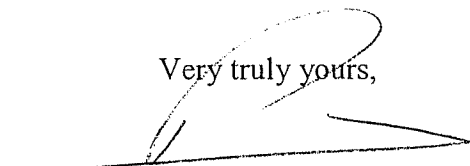

Patrick R. Hughes
Counsel for Nextel WIP Lease Corp.
207 Thomas More Parkway
Crestview Hills, KY 41017
(859) 341-1881

ATTORNEYS AT LAW

U.S. Postal Service™
CERTIFIED MAIL™ RECEIPT
(Domestic Mail Only; No Insurance Coverage Provided)

For delivery information visit our website at www.usps.com®

OFFICIAL USE

Postage	\$
Certified Fee	
Return Receipt Fee (Endorsement Required)	
Restricted Delivery Fee (Endorsement Required)	
Total Postage & Fees	\$

Postmark
Here

**Deters,
Benzinger
& LaVelle** p.s.c.

The Practice of Excellence

Writers Direct:
Phone: (859) 426-2151
Fax: (859) 341-4879
E-mail: phughes@dbllaw.com

Sent To	Kyle Dane Bowles
Street, Apt. No., or PO Box No.	8721 Tompkinsville Rd.
City, State, ZIP+4	Glasgow, KY 42141

April 15, 2005

PS Form 3800, June 2002

See Reverse for Instructions

EIPT REQUESTED

Kyle Dane Bowles
8721 Tompkinsville Rd.
Glasgow, KY 42141

Re: Kentucky Public Service commission
Slick Rock, Kentucky
Docket No. 2005-00078

Dear Sir/Madam:

Nextel WIP Lease Corp. and Hemphill Corporation have applied to the Kentucky Public Service Commission for a Certificate of Public Convenience and Necessity to construct and operate communications telecommunications services. The facility will include a 340 foot guyed tower for multiple wireless carriers to be located at 1636 Beaver Creek Road, Glasgow, Barren County, Kentucky. A map showing the location of the proposed new facility is enclosed.

The Kentucky Public Service Commission invites your comments regarding the proposed construction. You also have the right to intervene in this matter.

Your comments or request for intervention, if any, should be addressed to: Executive Director, Kentucky Public Service Commission, 211 Sower Blvd., P.O. Box 615, Frankfort, Kentucky 40602-0615. Please refer to Docket No. 2005-00078 in your correspondence.

Very truly yours,

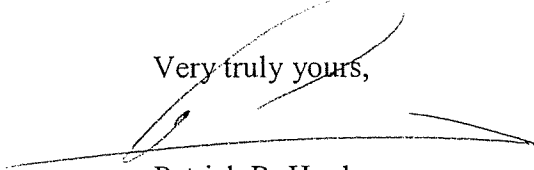
Patrick R. Hughes
Counsel for Nextel WIP Lease Corp.
207 Thomas More Parkway
Crestview Hills, KY 41017
(859) 341-1881

ATTORNEYS AT LAW

61460 1

U.S. Postal Service™
CERTIFIED MAIL™ RECEIPT
(Domestic Mail Only; No Insurance Coverage Provided)

For delivery information visit our website at www.usps.com

OFFICIAL USE

Postage	\$
Certified Fee	
Return Receipt Fee (Endorsement Required)	
Restricted Delivery Fee (Endorsement Required)	
Total Postage & Fees	\$

Postmark
Here

**Deters,
Benzinger
& LaVelle** p.s.c.

The Practice of Excellence

Writers Direct:
Phone: (859) 426-2151
Fax: (859) 341-4879
E-mail: phughes@dbllaw.com

Sent To **Mary Bowles Slone**
1506 Monroe Road
Lebanon, OH 45036

April 15, 2005

PS Form 3800, June 2002

See Reverse for Instructions

POSTAGE RECEIPT REQUESTED

Mary Bowles Slone
1506 Monroe Road
Lebanon, OH 45036

Re: Kentucky Public Service commission
Slick Rock, Kentucky
Docket No. 2005-00078

Dear Sir/Madam:

Nextel WIP Lease Corp. and Hemphill Corporation have applied to the Kentucky Public Service Commission for a Certificate of Public Convenience and Necessity to construct and operate communications telecommunications services. The facility will include a 340 foot guyed tower for multiple wireless carriers to be located at 1636 Beaver Creek Road, Glasgow, Barren County, Kentucky. A map showing the location of the proposed new facility is enclosed.

The Kentucky Public Service Commission invites your comments regarding the proposed construction. You also have the right to intervene in this matter.

Your comments or request for intervention, if any, should be addressed to: Executive Director, Kentucky Public Service Commission, 211 Sower Blvd., P.O. Box 615, Frankfort, Kentucky 40602-0615. Please refer to Docket No. 2005-00078 in your correspondence.

Very truly yours,

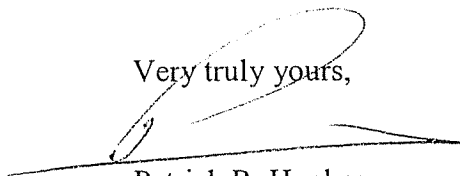

Patrick R. Hughes
Counsel for Nextel WIP Lease Corp.
207 Thomas More Parkway
Crestview Hills, KY 41017
(859) 341-1881

ATTORNEYS AT LAW

61460 I

KENTUCKY OFFICE: Thomas More Park • 207 Thomas More Parkway • Crestview Hills, Kentucky 41017-2596 • Phone (859) 341-1881 • Fax (859) 341-1469

OHIO OFFICE: 3500 Carew Tower • 441 Vine Street • Cincinnati, Ohio 45202-3007 • Phone (513) 241-4110 • Fax (513) 241-4551

www.dbllaw.com

U.S. Postal Service™
CERTIFIED MAIL™ RECEIPT
(Domestic Mail Only; No Insurance Coverage Provided)

For delivery information visit our website at www.usps.com

OFFICIAL USE

Postage	\$
Certified Fee	
Return Receipt Fee (Endorsement Required)	
Restricted Delivery Fee (Endorsement Required)	
Total Postage & Fees	\$

Postmark
Here

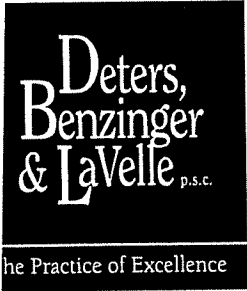

Writers Direct:
Phone: (859) 426-2151
Fax: (859) 341-4879
E-mail: phughes@dbllaw.com

Sent To **Hon. David Greer**
Government Building
 Street, Apt. No., or PO Box No. **117-3A North Public Square**
 City, State, ZIP+4 **Glasgow, KY 42141**

PS Form 3800, June 2002 See Reverse for Instructions

April 15, 2005

EIPT REQUESTED

Hon. Davie Greer
Government Building
117-3A North Pubic Square
Glasgow, KY 42141

Re: Kentucky Public Service commission
Slick Rock, Kentucky
Docket No. 2005-00078

Dear Judge Greer:

Nextel WIP Lease Corp. and Hemphill Corporation have applied to the Kentucky Public Service Commission for a Certificate of Public Convenience and Necessity to construct and operate communications telecommunications services. The facility will include a 340 foot guyed tower for multiple wireless carriers to be located at 1636 Beaver Creek Road, Glasgow, Barren County, Kentucky. A map showing the location of the proposed new facility is enclosed.

The Kentucky Public Service Commission invites your comments regarding the proposed construction. You also have the right to intervene in this matter.

Your comments or request for intervention, if any, should be addressed to: Executive Director, Kentucky Public Service Commission, 211 Sower Blvd., P.O. Box 615, Frankfort, Kentucky 40602-0615. Please refer to Docket No. 2005-00078 in your correspondence.

Very truly yours,

Patrick R. Hughes
Counsel for Nextel WIP Lease Corp.
207 Thomas More Parkway
Crestview Hills, KY 41017
(859) 341-1881

ATTORNEYS AT LAW

U.S. Postal Service™
CERTIFIED MAIL™ RECEIPT
(Domestic Mail Only; No Insurance Coverage Provided)

For delivery information visit our website at www.usps.com

OFFICIAL USE

Postage	\$
Certified Fee	
Return Receipt Fee (Endorsement Required)	
Restricted Delivery Fee (Endorsement Required)	
Total Postage & Fees	\$

Postmark
Here

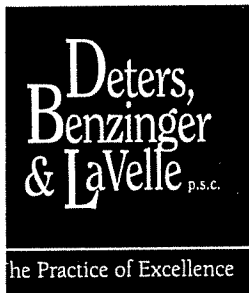

Writers Direct:
Phone: (859) 426-2151
Fax: (859) 341-4879
E-mail: phughes@dbllaw.com

Sent To	Steven Allen Simpson
Street, Apt. No., or PO Box No.	2425 Bear Creek Rd.
City, State, ZIP	Glasgow, KY 42141

PS Form 3800, June 2002 See Reverse for Instructions

April 15, 2005

REPLY REQUESTED

Steven Allen Simpson
2425 Bear Creek Rd.
Glasgow, KY 42141

Re: Kentucky Public Service commission
Slick Rock, Kentucky
Docket No. 2005-00078

Dear Sir/Madam:

Nextel WIP Lease Corp. and Hemphill Corporation have applied to the Kentucky Public Service Commission for a Certificate of Public Convenience and Necessity to construct and operate communications telecommunications services. The facility will include a 340 foot guyed tower for multiple wireless carriers to be located at 1636 Beaver Creek Road, Glasgow, Barren County, Kentucky. A map showing the location of the proposed new facility is enclosed.

The Kentucky Public Service Commission invites your comments regarding the proposed construction. You also have the right to intervene in this matter.

Your comments or request for intervention, if any, should be addressed to: Executive Director, Kentucky Public Service Commission, 211 Sower Blvd., P.O. Box 615, Frankfort, Kentucky 40602-0615. Please refer to Docket No. 2005-00078 in your correspondence.

Very truly yours,

Patrick R. Hughes
Counsel for Nextel WIP Lease Corp.
207 Thomas More Parkway
Crestview Hills, KY 41017
(859) 341-1881

ATTORNEYS AT LAW

61458 1

U.S. Postal Service™
CERTIFIED MAIL™ RECEIPT
(Domestic Mail Only; No Insurance Coverage Provided)

For delivery information visit our website at www.usps.com

OFFICIAL USE

Postage	\$
Certified Fee	
Return Receipt Fee (Endorsement Required)	
Restricted Delivery Fee (Endorsement Required)	
Total Postage & Fees	\$

Postmark
Here

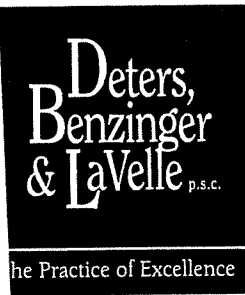

Writers Direct:
Phone: (859) 426-2151
Fax: (859) 341-4879
E-mail: phughes@dbllaw.com

Sent To	Ruben & Irene Bowles
Street, Apt. No.; or PO Box No.	1387 Beaver Creek Rd.
City, State, ZIP+4	Glasgow, KY 42141

PS Form 3800, June 2002 See Reverse for Instructions

April 15, 2005

RECEIPT REQUESTED

Ruben & Irene Bowles
1387 Beaver Creek Rd.
Glasgow, KY 42141

Re: Kentucky Public Service commission
Slick Rock, Kentucky
Docket No. 2005-00078

Dear Sir/Madam:

Nextel WIP Lease Corp. and Hemphill Corporation have applied to the Kentucky Public Service Commission for a Certificate of Public Convenience and Necessity to construct and operate communications telecommunications services. The facility will include a 340 foot guyed tower for multiple wireless carriers to be located at 1636 Beaver Creek Road, Glasgow, Barren County, Kentucky. A map showing the location of the proposed new facility is enclosed.

The Kentucky Public Service Commission invites your comments regarding the proposed construction. You also have the right to intervene in this matter.

Your comments or request for intervention, if any, should be addressed to: Executive Director, Kentucky Public Service Commission, 211 Sower Blvd., P.O. Box 615, Frankfort, Kentucky 40602-0615. Please refer to Docket No. 2005-00078 in your correspondence.

Very truly yours,

Patrick R. Hughes
Counsel for Nextel WIP Lease Corp.
207 Thomas More Parkway
Crestview Hills, KY 41017
(859) 341-1881

ATTORNEYS AT LAW

61457.1

U.S. Postal Service™
CERTIFIED MAIL™ RECEIPT
(Domestic Mail Only; No Insurance Coverage Provided)

For delivery information visit our website at www.usps.com

OFFICIAL USE

Postage	\$
Certified Fee	
Return Receipt Fee (Endorsement Required)	
Restricted Delivery Fee (Endorsement Required)	
Total Postage & Fees	\$

Postmark
Here

**Deters,
Benzinger
& LaVelle** p.s.c.

The Practice of Excellence

Writers Direct:
Phone: (859) 426-2151
Fax: (859) 341-4879
E-mail: phughes@dbllaw.com

Sent To	Wilmer & Dorothy Mae Hodges
Street, Apt. No., or PO Box No.	249 Donnelly Dr.
City, State, ZIP+4	Glasgow, KY 42141

PS Form 3800, June 2002 See Reverse for Instructions

April 15, 2005

REIPT REQUESTED

Wilmer L. and Dorothy Mae Hodges
249 Donnelly Drive
Glasgow, KY 42141

Re: Kentucky Public Service commission
Slick Rock, Kentucky
Docket No. 2005-00078

Dear Sir/Madam:

Nextel WIP Lease Corp. and Hemphill Corporation have applied to the Kentucky Public Service Commission for a Certificate of Public Convenience and Necessity to construct and operate communications telecommunications services. The facility will include a 340 foot guyed tower for multiple wireless carriers to be located at 1636 Beaver Creek Road, Glasgow, Barren County, Kentucky. A map showing the location of the proposed new facility is enclosed.

The Kentucky Public Service Commission invites your comments regarding the proposed construction. You also have the right to intervene in this matter.

Your comments or request for intervention, if any, should be addressed to: Executive Director, Kentucky Public Service Commission, 211 Sower Blvd., P.O. Box 615, Frankfort, Kentucky 40602-0615. Please refer to Docket No. 2005-00078 in your correspondence.

Very truly yours,

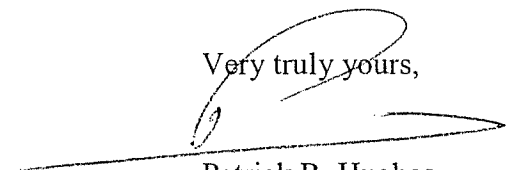
Patrick R. Hughes
Counsel for Nextel WIP Lease Corp.
207 Thomas More Parkway
Crestview Hills, KY 41017
(859) 341-1881

ATTORNEYS AT LAW

61455.1

KENTUCKY OFFICE: Thomas More Park • 207 Thomas More Parkway • Crestview Hills, Kentucky 41017-2596 • Phone (859) 341-1881 • Fax (859) 341-1469

OHIO OFFICE: 3500 Carew Tower • 441 Vine Street • Cincinnati, Ohio 45202-3007 • Phone (513) 241-4110 • Fax (513) 241-4551

www.dbllaw.com

U.S. Postal Service™
CERTIFIED MAIL™ RECEIPT
(Domestic Mail Only; No Insurance Coverage Provided)

For delivery information, visit our website at www.usps.com

OFFICIAL USE

Postage	\$
Certified Fee	
Return Receipt Fee (Endorsement Required)	
Restricted Delivery Fee (Endorsement Required)	
Total Postage & Fees	\$

Postmark
Here

**Deters,
Benzinger
& LaVelle** p.s.c.

The Practice of Excellence

Writers Direct:
Phone: (859) 426-2151
Fax: (859) 341-4879
E-mail: phughes@dbllaw.com

Sent To	Annetta Bowles Gray
Street, Apt. No., or PO Box No.	1297 Coral Hill Rd.
City, State, ZIP+4	Glasgow, KY 42141

April 15, 2005

PS Form 3800, June 2002

See Reverse for Instructions

RECEIPT REQUESTED

Annetta Bowles Gray
1297 Coral Hill Rd.
Glasgow, KY 42141

Re: Kentucky Public Service commission
Slick Rock, Kentucky
Docket No. 2005-00078

Dear Sir/Madam:

Nextel WIP Lease Corp. and Hemphill Corporation have applied to the Kentucky Public Service Commission for a Certificate of Public Convenience and Necessity to construct and operate communications telecommunications services. The facility will include a 340 foot guyed tower for multiple wireless carriers to be located at 1636 Beaver Creek Road, Glasgow, Barren County, Kentucky. A map showing the location of the proposed new facility is enclosed.

The Kentucky Public Service Commission invites your comments regarding the proposed construction. You also have the right to intervene in this matter.

Your comments or request for intervention, if any, should be addressed to: Executive Director, Kentucky Public Service Commission, 211 Sower Blvd., P.O. Box 615, Frankfort, Kentucky 40602-0615. Please refer to Docket No. 2005-00078 in your correspondence.

Very truly yours,

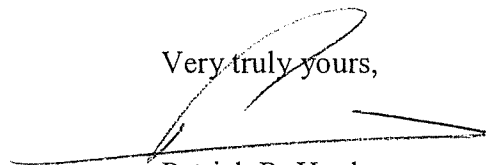

Patrick R. Hughes
Counsel for Nextel WIP Lease Corp.
207 Thomas More Parkway
Crestview Hills, KY 41017
(859) 341-1881

ATTORNEYS AT LAW