

Rural Electric Cooperative Corporation

A Touchstone Energy® Cooperative 

February 16, 2012

RECEIVED

FEB 20 2012

PUBLIC SERVICE  
COMMISSION

Mr. Jeff Derouen  
Executive Director  
Public Service Commission  
PO Box 615  
Frankfort, KY 40602

RE: PSC Case No. 2010-00518

Dear Mr. Derouen:

Per The Commission's request, I have enclosed an original and ten (10) copies of an amendment to Nolin's 2010-2013 Construction Work Plan in the above referenced case. Please give your immediate attention to this work plan amendment, because developers of these projects are ready now to begin construction. We also request expedited action in order to help ensure that Nolin is able to provide timely, affordable and reliable service to our member owners.

If you have any questions or need additional information, please let me know.

Sincerely,

A handwritten signature in cursive script that reads "Michael L. Miller".

Michael L. Miller  
President & CEO

Enclosures

Amendment To Current Approved  
Construction Work Plan

Amendment # **2012-3** Borrower Designation **KY 51 (Nolin RECC)**

Work Plan Period 2011-2013

Changes Proposed

Code	Description	Miles	Summary	Ave/Cost	Sub totals	Total
<b>336</b>	CWP ITEM 18_05_ABC OVHD section	0.4	3 ph 336.4 MCM ACSR	\$140,131	\$56,052	
	Single phase Taps URD sections	1.6	1/0 AL single ph URD	\$58,869	\$94,190	\$150,243
<b>337</b>	CWP ITEM 19_04_ABC URD section	0.4	3 ph 4/0 STR AL URD	\$206,646	\$82,658	
	3 phase URD (1/0 Al)	0.6	3ph 1/0 STR AL URD	\$113,512	\$68,107	\$150,766
<b>Total to be used for New Projects</b>						<b>\$301,009</b>

**Code 336**

Relocate a section of existing .4 miles of three phase #336.4 ACSR and place taps of single phase off the main line totaling 1.6 miles of 1/0 STR Al and serving 13-100 kVA transformers. The new apartment complex is located near the corner of West Vine and Logsdon Parkway in Vine Grove, Kentucky.

Reason for change

The new apartment complex is Phase 1 of The Parks of Vine and will add approximately 78 members. The line will provide a better balance of the phases, improve outage time from trees and provide for future development of the other Phases.

**Code 337**

Tap an existing three phase #336.4 ACSR with 0.4 miles of a three phase 4/0 Al STR AL URD and place taps of single phase off the main line totaling 0.6 miles of 1/0 STR Al and serving 8 transformers of multiple size and configurations. The new complex is located near the corner of Ring Road and Tunnel Hill Road in Elizabethtown, Kentucky.

Reason for change

The new complex will add approximately 78 members. The line will provide a better balance of the phases, improve outage time from trees and provide for future development of the other Phases.

Method of Financing

- Loan Funds
- General Funds
- Contributions in Aid

Status of Borrowers Environmental Report: Topo map attached

Total Estimated Cost of Projects less aid to construction **\$301,009**

Engineering Support Attached: Discussed with RUS GFR

Registered Engineer *Mike Norman* 12,568  
(as required) (Signature) (P.E. number)

Requested By *Michael T. Niello* Date 2-14-2012  
President & CEO

Approved By: *Mike Norman* Date: 2-13-2012  
RUS, GFR

Subject to BER approval? Yes  No

Status of Construction: Proposed start of construction....2012

# CFR 336

**NECA**  
RURAL ELECTRIC COOPERATIVE CORPORATION

A Touchstone Energy® Cooperative

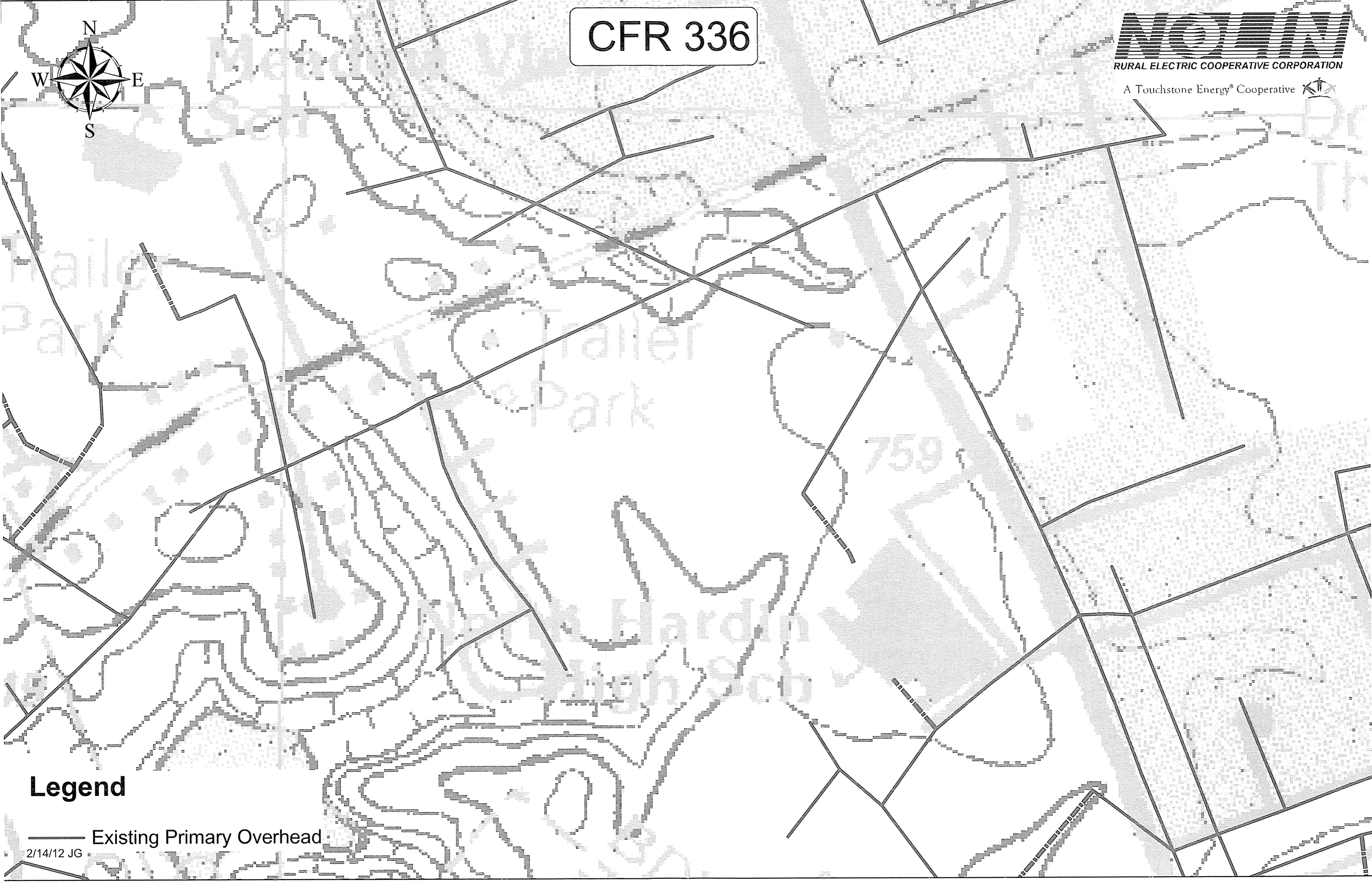
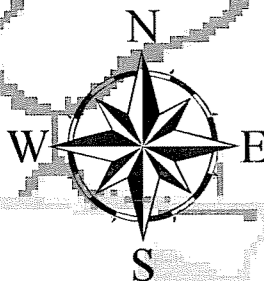

## Legend

— Existing Primary Overhead

2/14/12 JG

# CFR 337

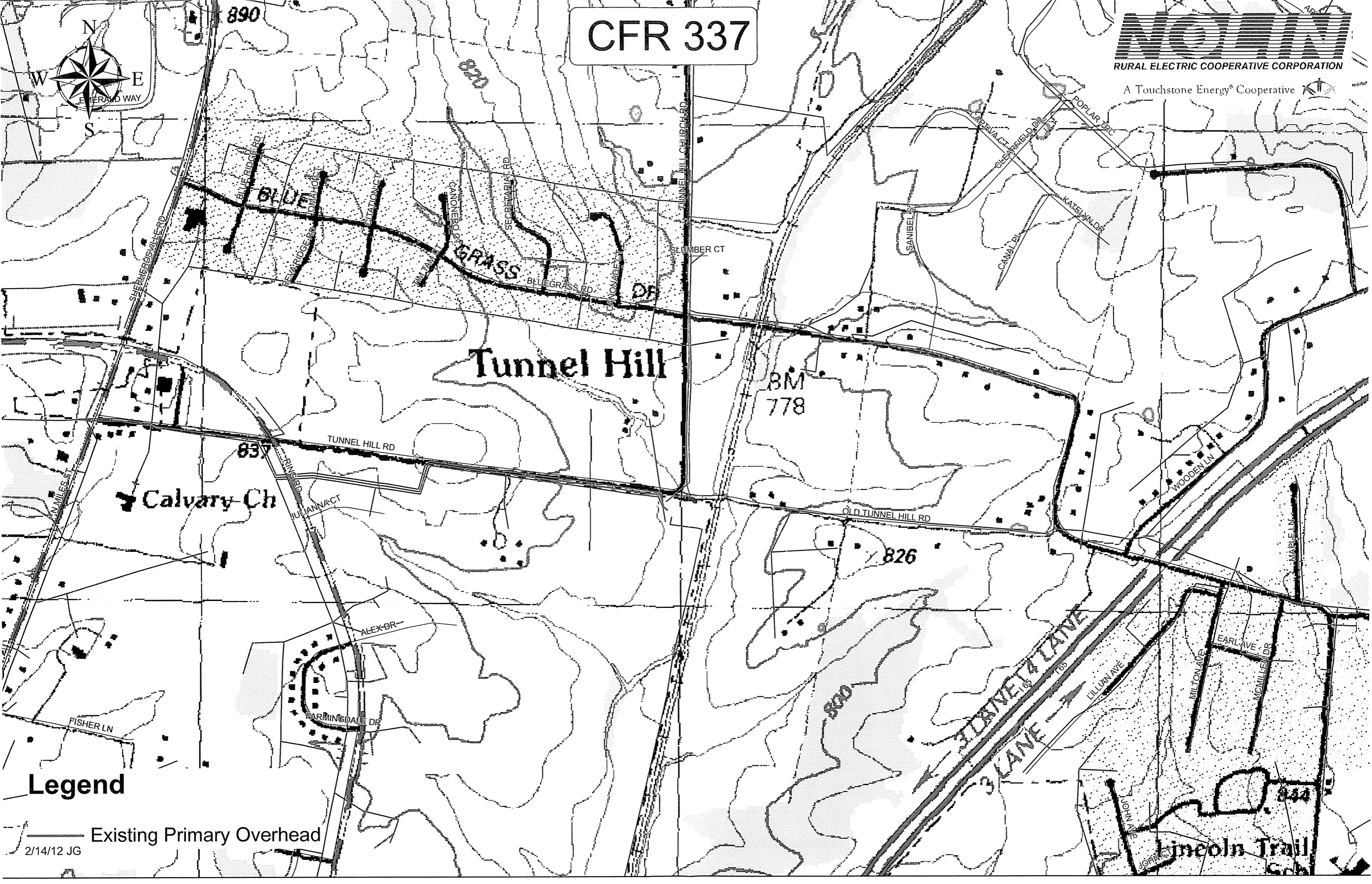

Tunnel Hill

Calvary Ch

Lincoln Trail

## Legend

Existing Primary Overhead

2/14/12 JG