

RECEIVED

May 5, 2014

MAY 7 - 2014

PUBLIC SERVICE
COMMISSION

Mr. Jeff Derouen, Executive Director

Public Service Commission

211 Sower Blvd

Frankfort, KY 40602

Re: Western Pulaski County Water District
Water System Extensions & Improvements &
Water Distribution Telemetry System
Case # 2014-00157

Dear Mr. Derouen:

Please find attached one paper copy and one electronic copy of the plans and specifications for the above referenced projects. Should you need additional information please advise.

Sincerely,

A handwritten signature in black ink, appearing to read 'David M. Bowles', is written over a light blue horizontal line.

David M. Bowles, P.E.

/dmb

Enclosures

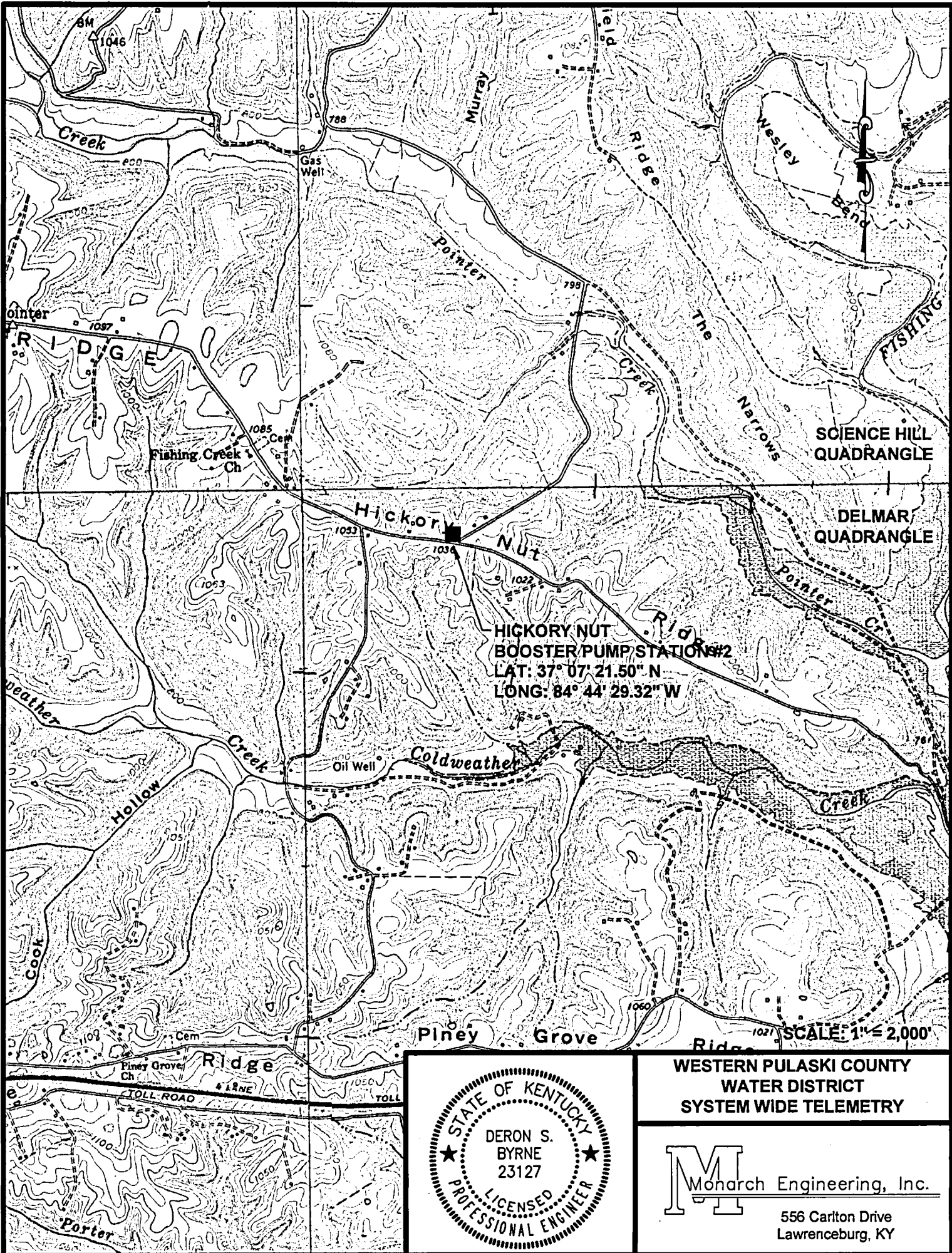

**HICKORY NUT
BOOSTER/PUMP STATIONS #2**
 LAT: 37° 07' 21.50" N
 LONG: 84° 44' 29.32" W

SCALE: 1" = 2,000'



**WESTERN PULASKI COUNTY
 WATER DISTRICT
 SYSTEM WIDE TELEMTRY**

M Monarch Engineering, Inc.
 556 Carlton Drive
 Lawrenceburg, KY

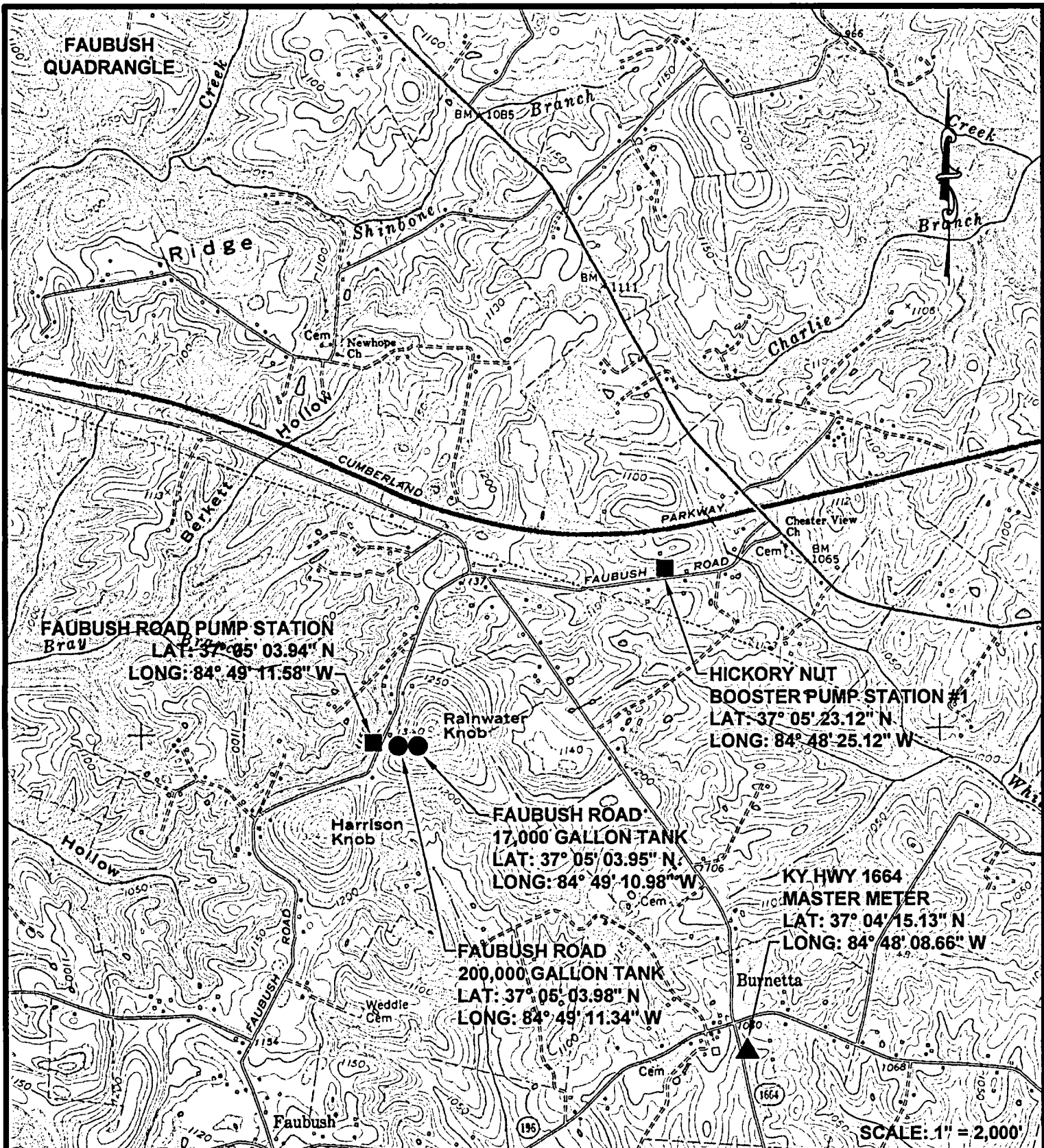

**WESTERN PULASKI COUNTY
 WATER DISTRICT
 SYSTEM WIDE TELEMTRY**

M Monarch Engineering, Inc.
 556 Carlton Drive
 Lawrenceburg, KY

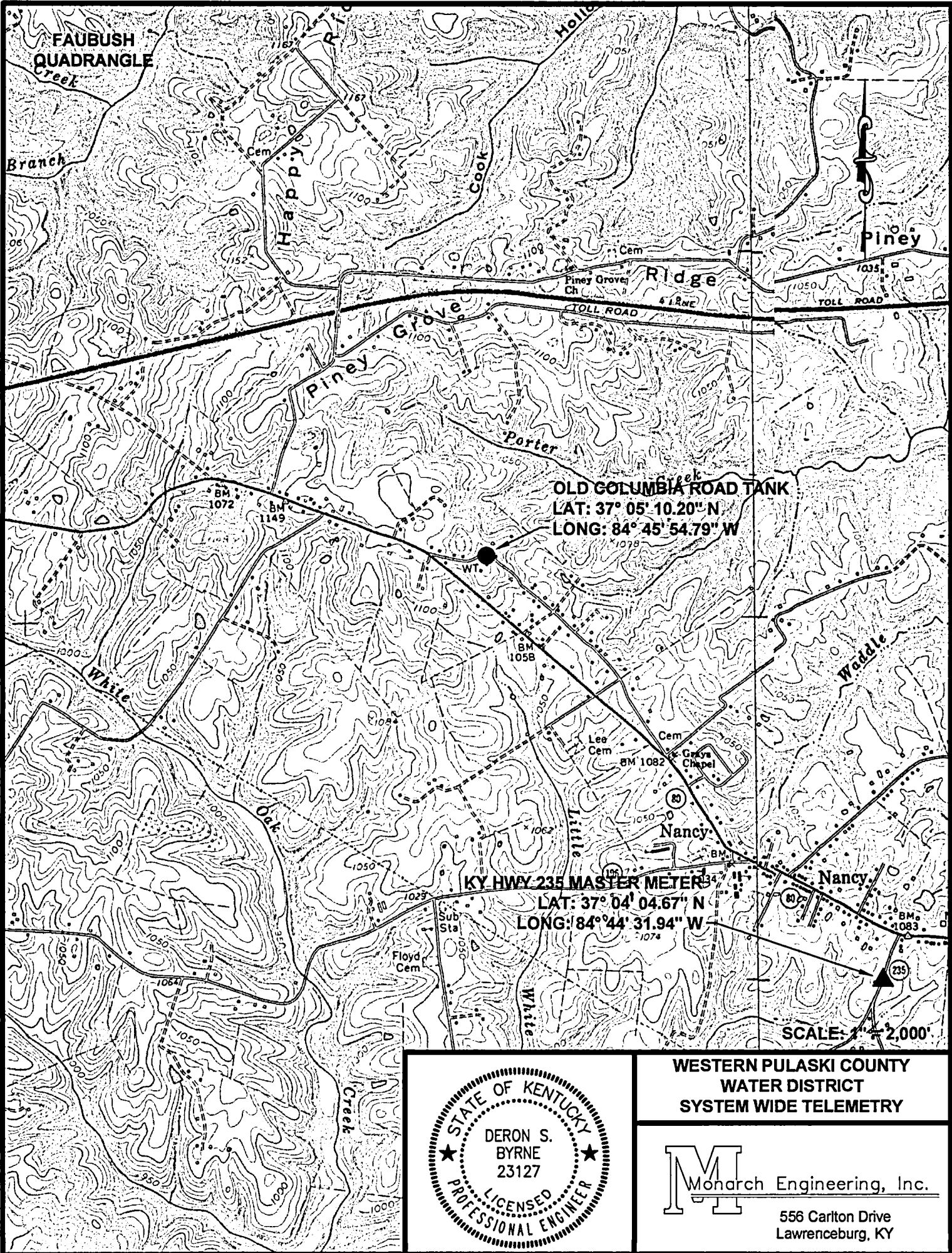

OLD COLUMBIA ROAD TANK
 LAT: 37° 05' 10.20" N
 LONG: 84° 45' 54.79" W

KY HWY-235 MASTER METER
 LAT: 37° 04' 04.67" N
 LONG: 84° 44' 31.94" W

SCALE: 1" = 2,000'



**WESTERN PULASKI COUNTY
 WATER DISTRICT
 SYSTEM WIDE TELEMTRY**

M Monarch Engineering, Inc.
 556 Carlton Drive
 Lawrenceburg, KY

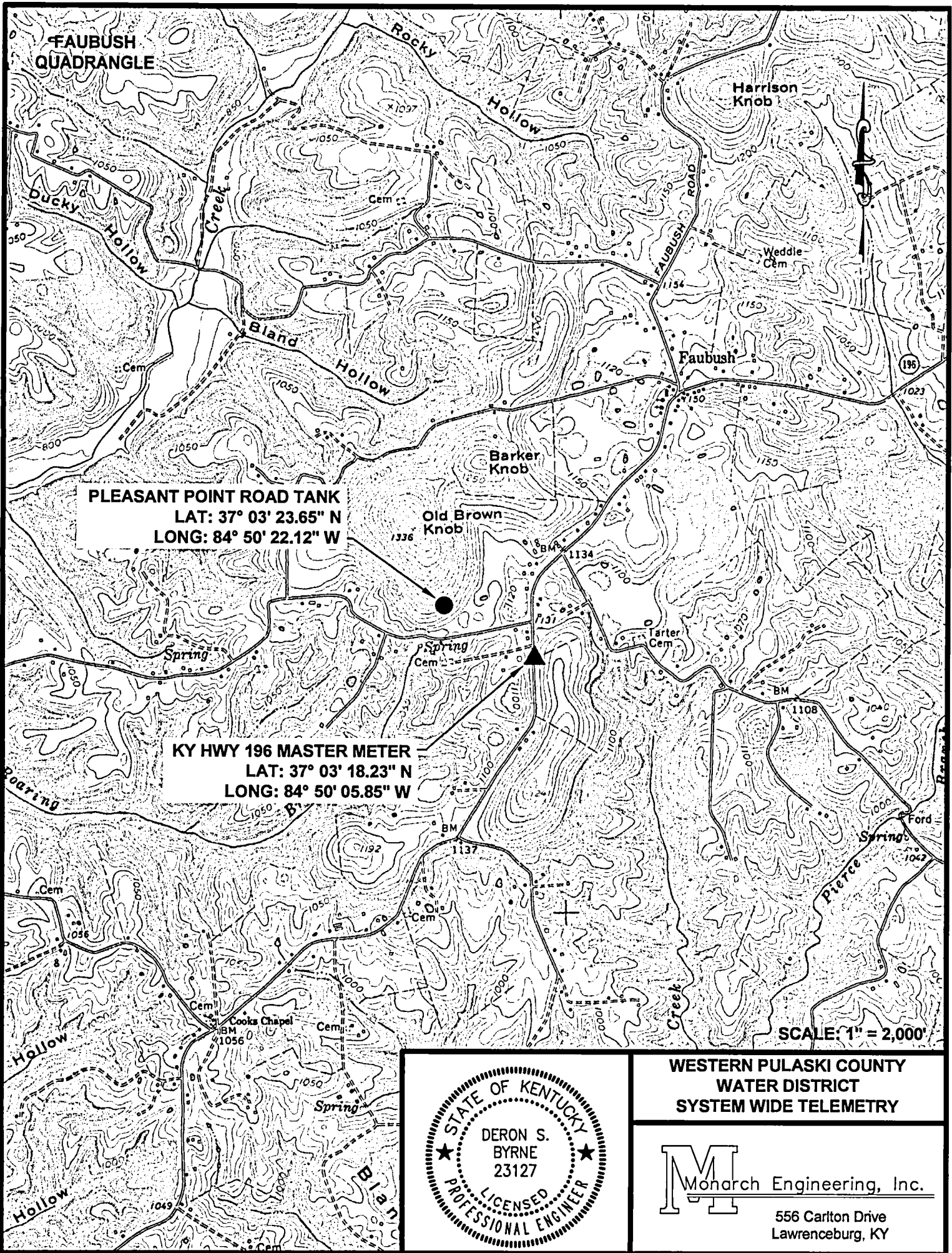

PLEASANT POINT ROAD TANK
 LAT: 37° 03' 23.65" N
 LONG: 84° 50' 22.12" W

KY HWY 196 MASTER METER
 LAT: 37° 03' 18.23" N
 LONG: 84° 50' 05.85" W

SCALE: 1" = 2,000'

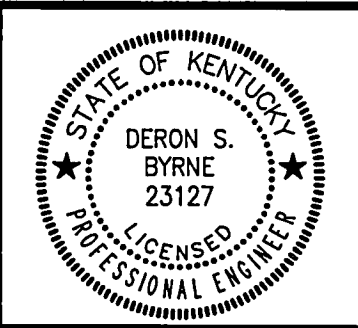

**WESTERN PULASKI COUNTY
 WATER DISTRICT
 SYSTEM WIDE TELEMTRY**

M Monarch Engineering, Inc.
 556 Carlton Drive
 Lawrenceburg, KY

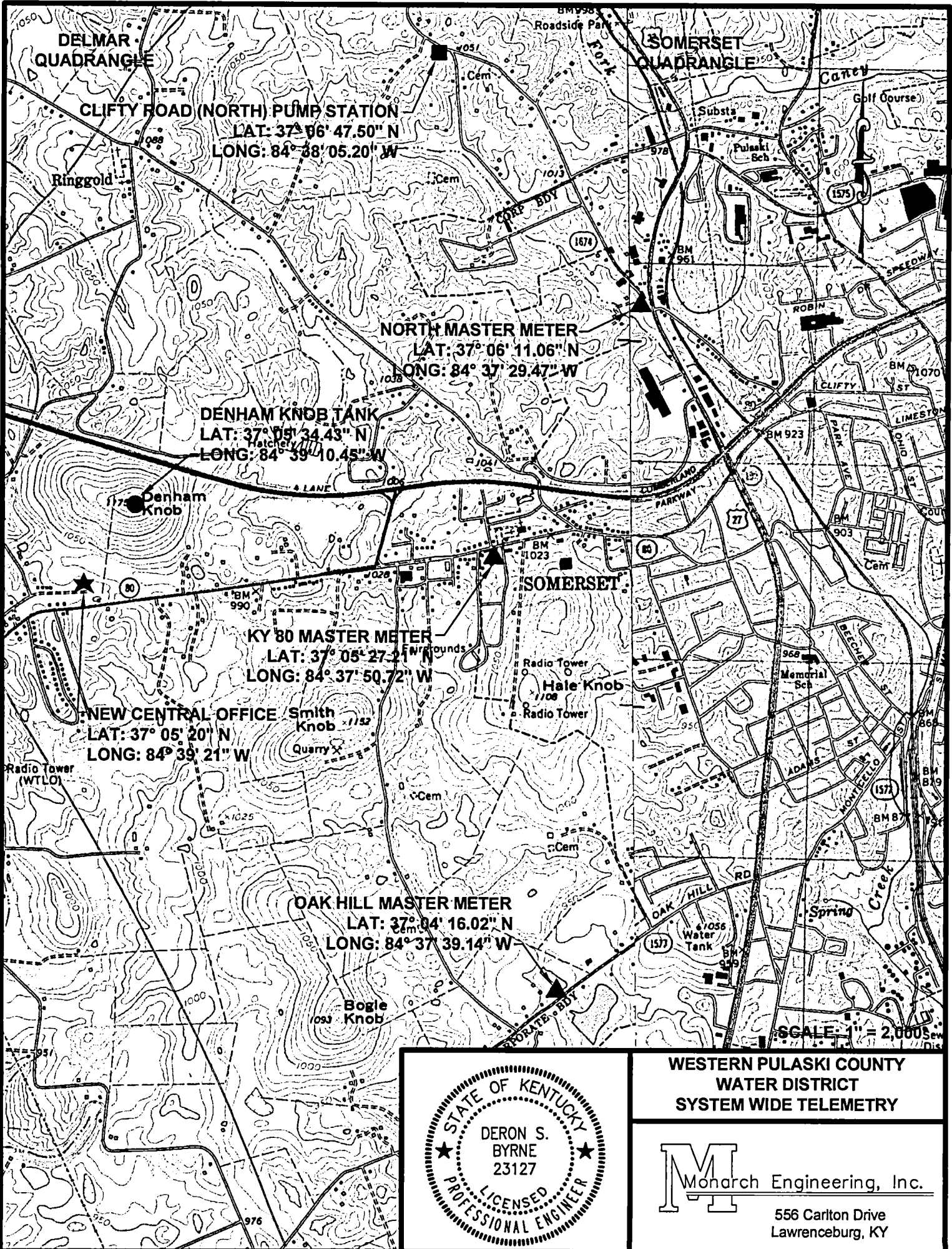

**WESTERN PULASKI COUNTY
 WATER DISTRICT
 SYSTEM WIDE TELEMTRY**

M Monarch Engineering, Inc.
 556 Carlton Drive
 Lawrenceburg, KY

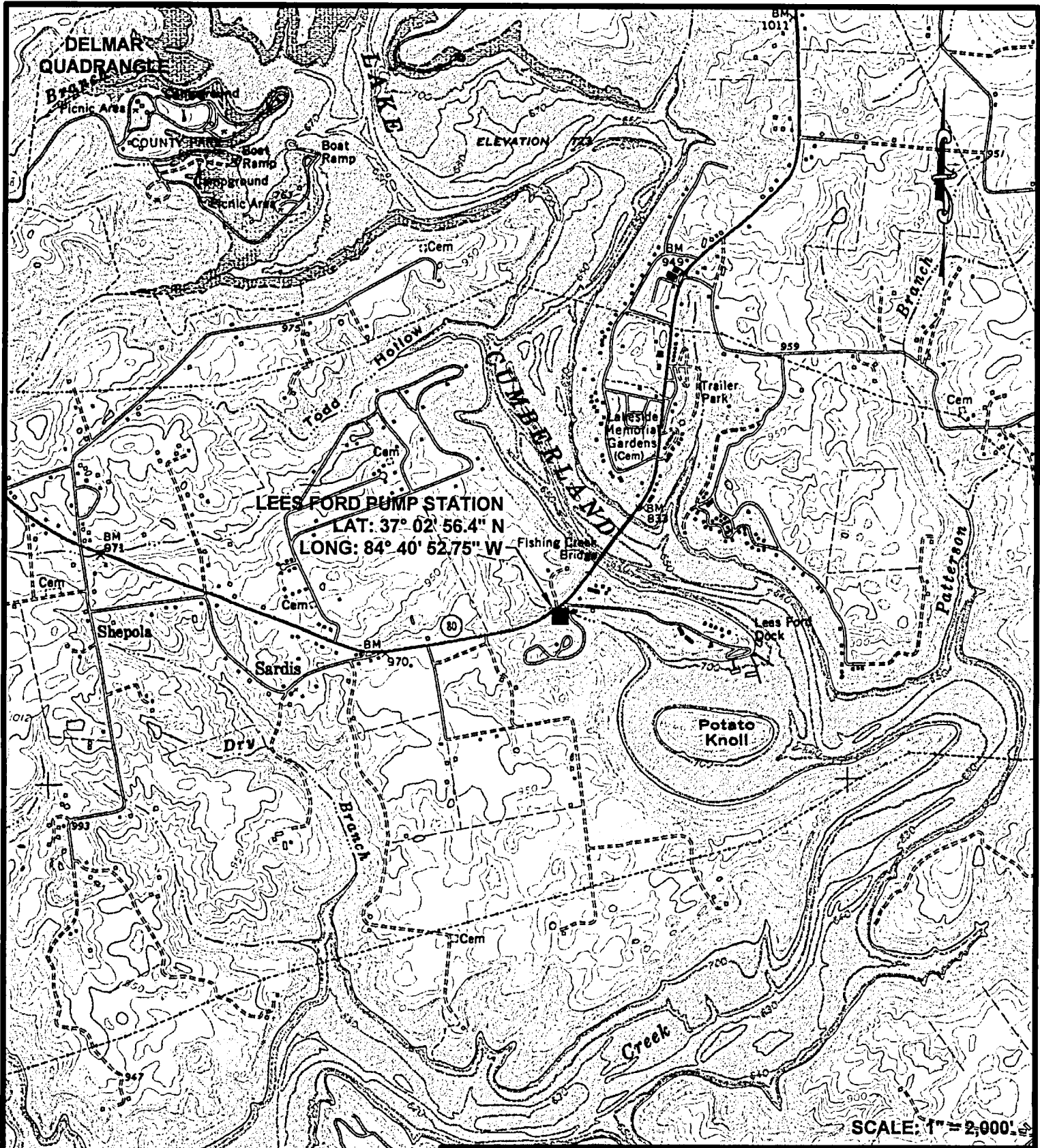

SCALE: 1" = 2,000'



WESTERN PULASKI COUNTY
 WATER DISTRICT
 SYSTEM WIDE TELEMTRY

M Monarch Engineering, Inc.
 556 Carlton Drive
 Lawrenceburg, KY

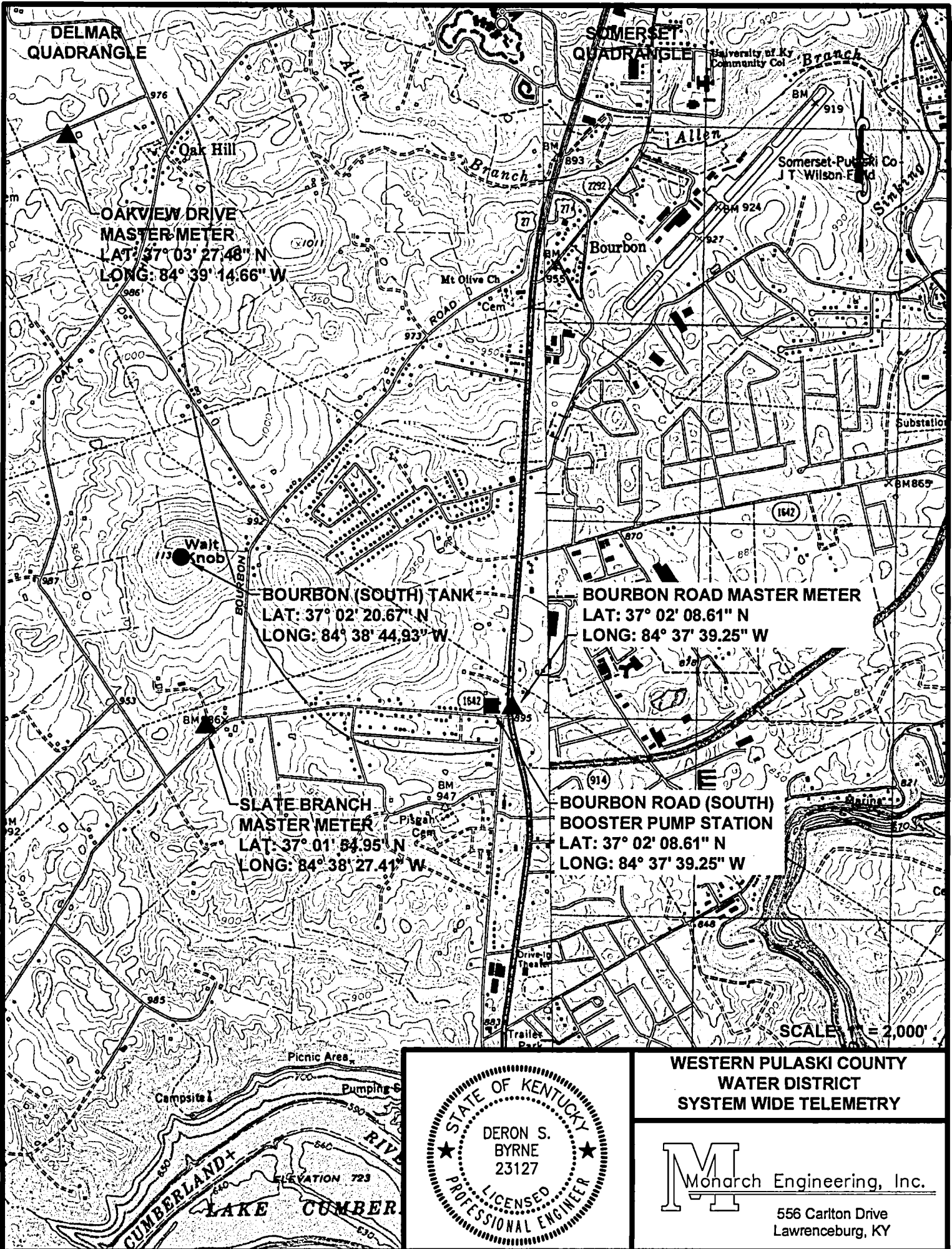

OAKVIEW DRIVE
MASTER METER
LAT: 37° 03' 27.48" N
LONG: 84° 39' 14.66" W

BOURBON (SOUTH) TANK
LAT: 37° 02' 20.67" N
LONG: 84° 38' 44.93" W

BOURBON ROAD MASTER METER
LAT: 37° 02' 08.61" N
LONG: 84° 37' 39.25" W

SLATE BRANCH
MASTER METER
LAT: 37° 01' 54.95" N
LONG: 84° 38' 27.41" W

BOURBON ROAD (SOUTH)
BOOSTER PUMP STATION
LAT: 37° 02' 08.61" N
LONG: 84° 37' 39.25" W

SCALE 1" = 2,000'

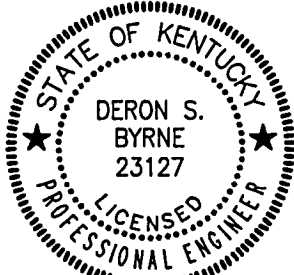

WESTERN PULASKI COUNTY
WATER DISTRICT
SYSTEM WIDE TELEMTRY

Monarch Engineering, Inc.

556 Carlton Drive
Lawrenceburg, KY

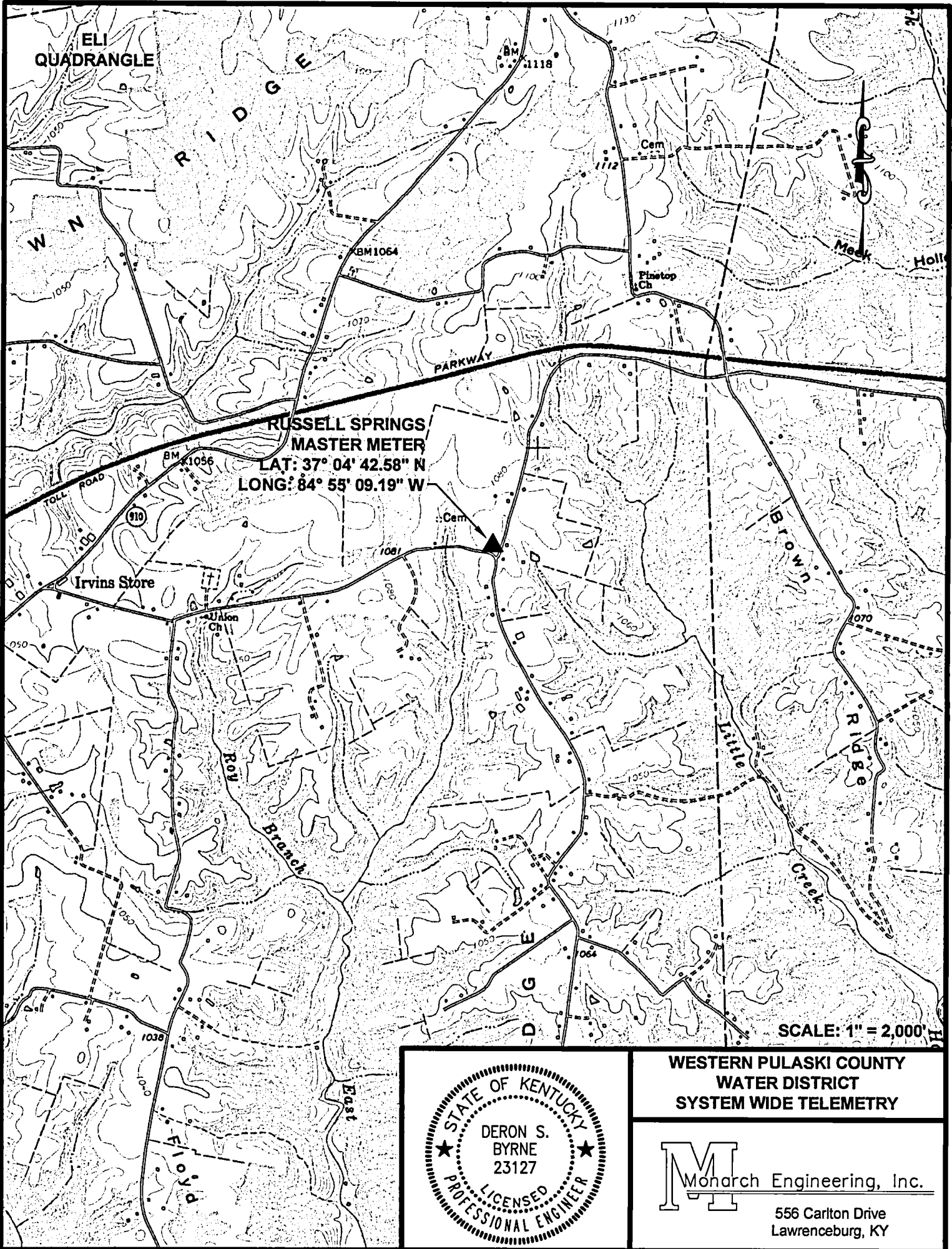

**RUSSELL SPRINGS
MASTER METER**
 LAT: 37° 04' 42.58" N
 LONG: 84° 55' 09.19" W

SCALE: 1" = 2,000'

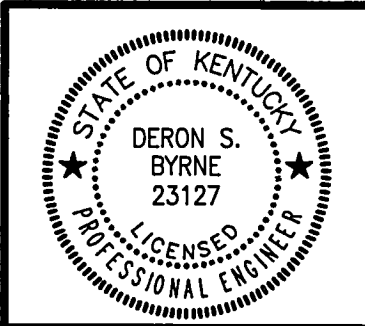

**WESTERN PULASKI COUNTY
 WATER DISTRICT
 SYSTEM WIDE TELEMTRY**

M Monarch Engineering, Inc.
 556 Carlton Drive
 Lawrenceburg, KY

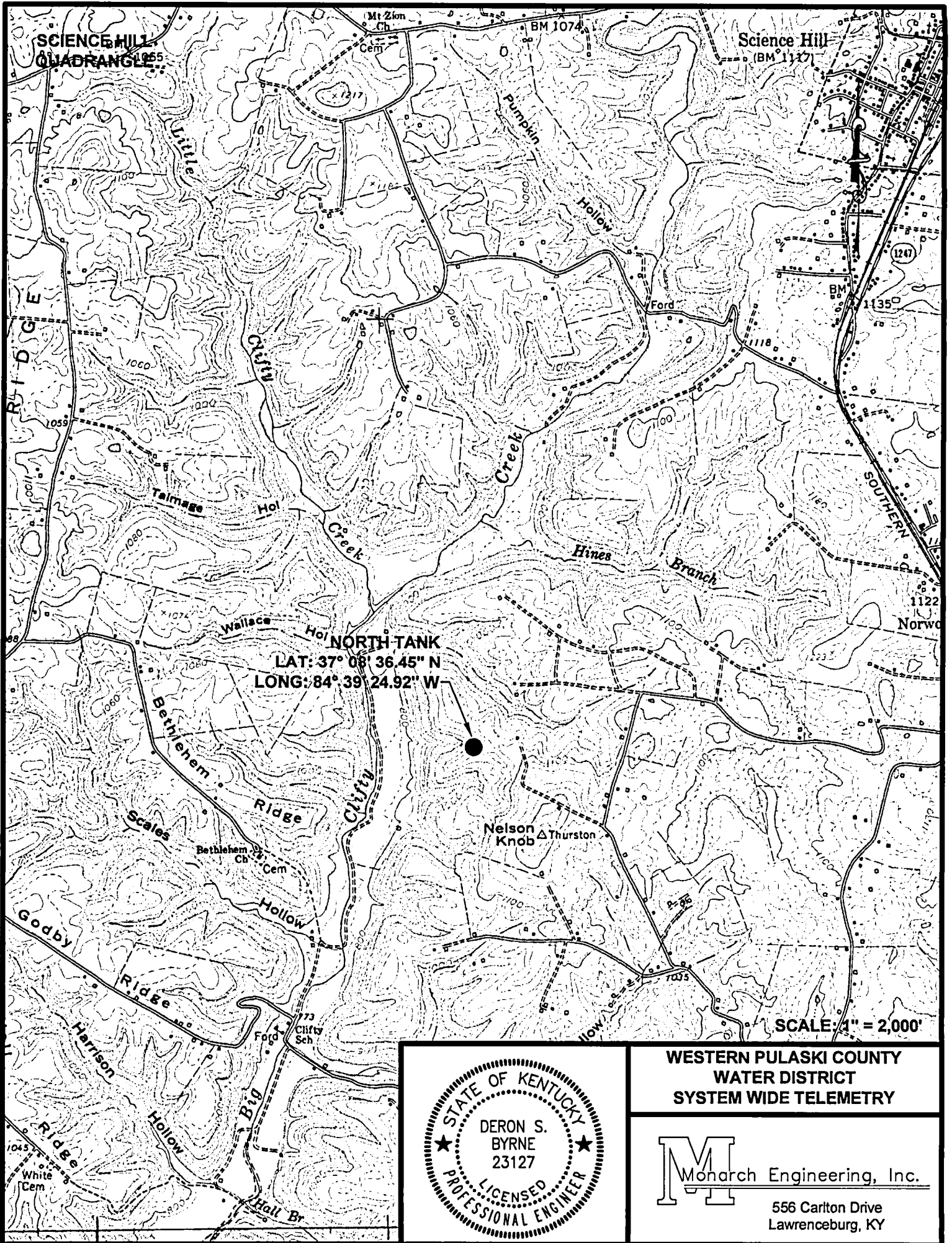

NORTH-TANK
 LAT: 37° 08' 36.45" N
 LONG: 84° 39' 24.92" W

SCALE: 1" = 2,000'



**WESTERN PULASKI COUNTY
 WATER DISTRICT
 SYSTEM WIDE TELEMTRY**

M Monarch Engineering, Inc.
 556 Carlton Drive
 Lawrenceburg, KY

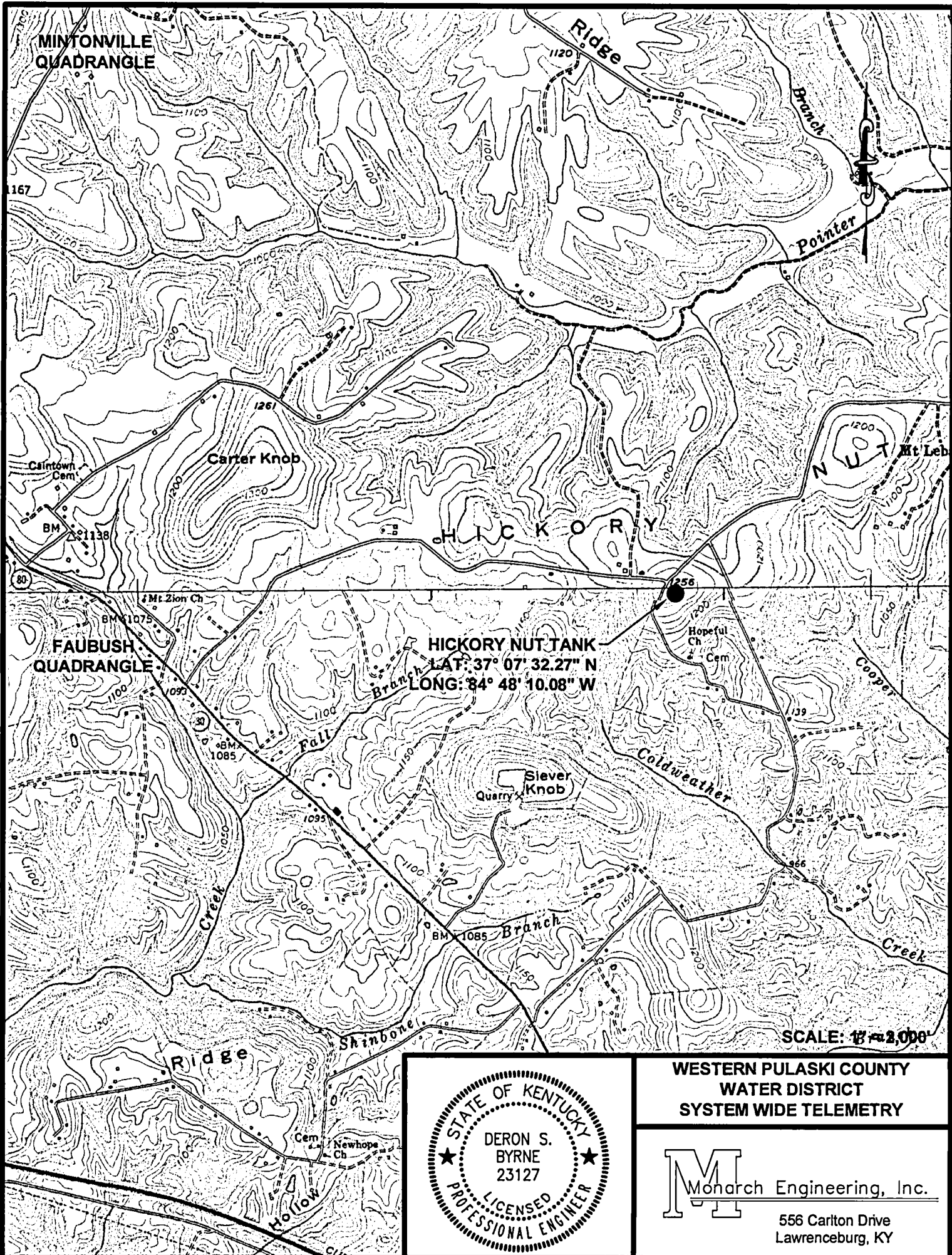

STATE OF KENTUCKY
 ★ DERON S. BYRNE ★
 23127
 LICENSED PROFESSIONAL ENGINEER

WESTERN PULASKI COUNTY
 WATER DISTRICT
 SYSTEM WIDE TELEMTRY

M Monarch Engineering, Inc.
 556 Carlton Drive
 Lawrenceburg, KY

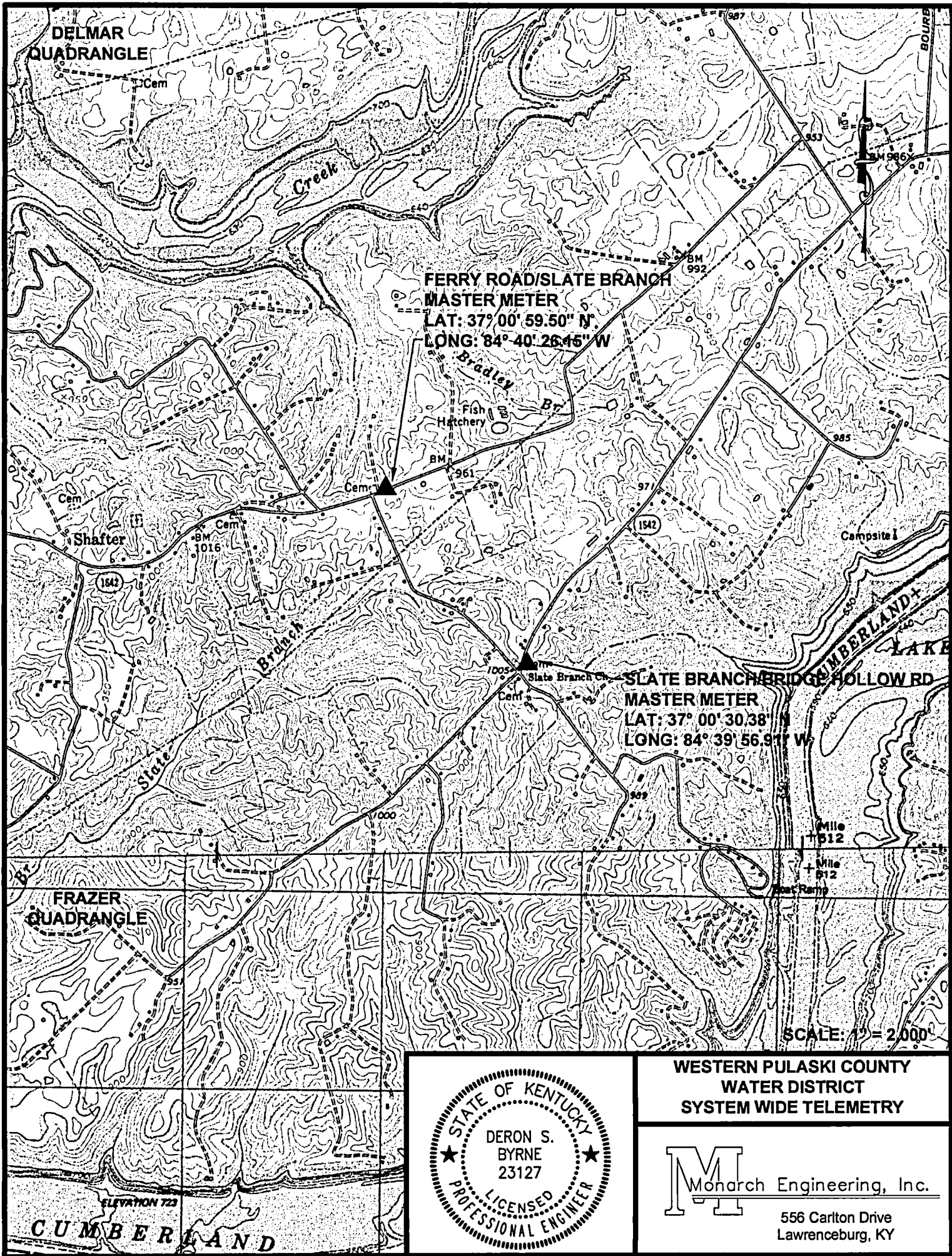

**FERRY ROAD/SLATE BRANCH
MASTER METER**
 LAT: 37° 00' 59.50" N
 LONG: 84° 40' 26.45" W

**SLATE BRANCH BRIDGE HOLLOW RD
MASTER METER**
 LAT: 37° 00' 30.38" N
 LONG: 84° 39' 56.91" W

SCALE: 1" = 2,000'

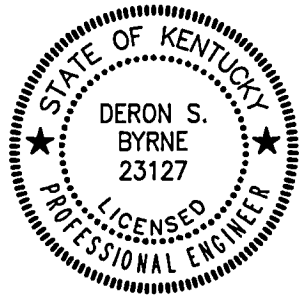

**WESTERN PULASKI COUNTY
WATER DISTRICT
SYSTEM WIDE TELEMTRY**

M Monarch Engineering, Inc.
 556 Carlton Drive
 Lawrenceburg, KY