

COMMONWEALTH OF KENTUCKY  
BEFORE THE PUBLIC SERVICE COMMISSION

In the Matter of:

ROY G. COLLINS	)	
	)	
COMPLAINANT	)	
	)	
V.	)	CASE NO.
	)	2013-00052
JACKSON PURCHASE ENERGY CORPORATION	)	
	)	
DEFENDANT	)	

NOTICE OF FILING

Notice is given to all parties that the following materials have been filed into the record of this proceeding:

- The digital video recording of the evidentiary hearing conducted on February 11, 2014 in this proceeding;
- Certification of the accuracy and correctness of the digital video recording;
- All exhibits introduced at the evidentiary hearing conducted on February 11, 2014 in this proceeding;
- The written log listing, *inter alia*, the date and time of where each witness' testimony begins and ends on the digital video recording of the hearing conducted on February 11, 2014.

A copy of this Notice, the certification of the digital video record, exhibit list, and hearing log have been served by first class mail upon all persons listed at the end of this Notice. Parties desiring an electronic copy of the digital video recording of the hearing in

Windows Media format may download a copy at [http://psc.ky.gov/av\\_broadcast/2013-00052/2013-00052\\_11Feb14\\_Inter.asx](http://psc.ky.gov/av_broadcast/2013-00052/2013-00052_11Feb14_Inter.asx). Parties wishing an annotated digital video recording may submit a written request by electronic mail to [pscfilings@ky.gov](mailto:pscfilings@ky.gov). A minimal fee will be assessed for a copy of this recording.

The exhibits introduced at the evidentiary hearing may be downloaded at <http://psc.ky.gov/Home/Library?type=Cases&folder=2013%20Cases/2013-00052>.

Done at Frankfort, Kentucky, this 14<sup>th</sup> day of February 2014.



---

Linda Faulkner  
Director, Filings Division  
Public Service Commission of Kentucky

Roy G Collins  
109 Dickenson Street  
Manchester, KENTUCKY 40962

G. Kelly Nuckols  
President & CEO  
Jackson Purchase Energy Corporation  
2900 Irvin Cobb Drive  
P. O. Box 4030  
Paducah, KY 42002-4030

Melissa D Yates  
Attorney  
Denton & Keuler, LLP  
555 Jefferson Street  
P. O. Box 929  
Paducah, KENTUCKY 42002-0929

COMMONWEALTH OF KENTUCKY  
BEFORE THE PUBLIC SERVICE COMMISSION

In the Matter of:

ROY G. COLLINS VS. JACKSON PURCHASE ENERGY ) CASE NO. 2013-00052  
CORPORATION )

CERTIFICATE

I, Sonya Harward, hereby certify that:

1. The attached DVD contains a digital recording of the Hearing conducted in the above-styled proceeding on February 11, 2014. Hearing Log, Exhibits, Exhibit List, and Witness List are included with the recording on February 11, 2014.

2. I am responsible for the preparation of the digital recording.

3. The digital recording accurately and correctly depicts the Hearing of February 11, 2014.

4. The "Exhibit List" attached to this Certificate correctly lists all Exhibits introduced at the Hearing of February 11, 2014.

5. The "Hearing Log" attached to this Certificate accurately and correctly states the events that occurred at the Hearing of February 11, 2014 and the time at which each occurred.

Given this 11<sup>th</sup> day of February, 2014.

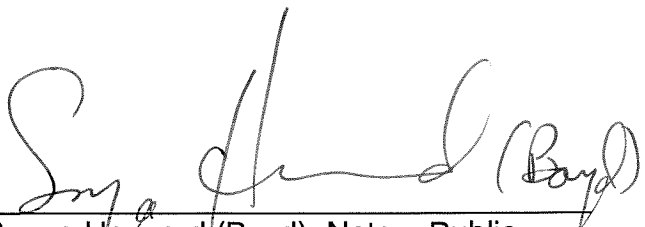

  
Sonya Harward (Boyd), Notary Public  
State at Large  
My commission expires: August 27, 2017



# Session Report - Detail

2013-00052\_11Feb2014

**Roy G. Collins vs. Jackson Purchase Energy Corp.**

Date:	Type:	Location:	Department:
2/11/2014	Other	Public Service Commission	Hearing Room 1 (HR 1)

Judge: Hearing Officer Jim Wood  
 Witness: Charles Williamson - Jackson Purchase  
 Clerk: Sonya Harward

Event Time	Log Event
9:36:54 AM	Session Started
9:36:57 AM	Session Paused
9:48:48 AM	Session Resumed
9:48:53 AM	Session Paused
10:03:33 AM	Session Resumed
10:03:36 AM	Hearing Officer James Wood - Opening Comments
10:04:00 AM	Mr. Roy Collins introduced by Hearing Ofc. Woods. Note: Harward, Sonya Applicant/Complainant
10:04:05 AM	Jackson Purchase Atty. Melissa Yates Note: Harward, Sonya Introduces Kelly Nuckols, President and CEO of Jackson Purchase; Chuck Williamson, Vice President Finance and Accounting for Jackson Purchase; and Scott Ribble, Vice President of Engineering and Operations for Jackson Purchase.
10:04:27 AM	PSC Atty. Jeb Pinney Note: Harward, Sonya Introduces Co-Counsel, Atty. Aaron Ann Cole, and PSC Staff Members Jim Livers, John Shupp, and Bob Russell.
10:05:59 AM	Atty. Yates - Motion to Dismiss Note: Harward, Sonya Jackson Purchase Motion to Dismiss due to Mr. Collins not complying with the Procedural Order in this case, has not filed Direct or Rebuttal Testimony, etc.
10:06:01 AM	Jackson Purchase - Exhibit 1 Note: Harward, Sonya Jackson Purchase Energy Corporation Motion to Dismiss - to be filed later today in this case.
10:07:09 AM	Mr. Roy Collins - Response to Motion to Dismiss
10:08:04 AM	Atty. Pinney - Reponse to Motion to Dismiss
10:09:28 AM	Hearing Ofc. Woods - Response to Motion to Dismiss Note: Harward, Sonya Overruled the Motion.
10:12:12 AM	Witness Charles "Chuck" Williamson takes the stand and is sworn in. Note: Harward, Sonya Jackson Purchase
10:13:02 AM	Mr. Collins cross exam. of Witness Williamson Note: Harward, Sonya Referencing Witness's Testimony, page 8, line 10.
10:14:09 AM	Mr. Collins to Witness Williamson Note: Harward, Sonya Referencing Exhibit D of Jackson Purchase's Response to Commission Staff's First Request, last page.
10:16:56 AM	Mr. Collins to Witness Williamson Note: Harward, Sonya Referencing a document (which Commission Staff will later enter as PSC - Exhibit 1 to this Hearing) listing Rate, Meter Number, various Meter Readings, Monthly Usage, and Monthly Bill Amount at 1400 Carrsville Rd, Hampton, KY, and Hill Grove Rd, Hampton, KY.
10:17:56 AM	Mr. Collins to Witness Williamson Note: Harward, Sonya Referencing Jackson Purchase's Response to Commission Staff's First Request, Item 9, page 5 of 11.

10:19:46 AM	Mr. Collins to Witness Williamson Note: Harward, Sonya	Referencing Jackson Purchase's Tariff, Section 33.
10:21:13 AM	Mr. Collins to Witness Williamson Note: Harward, Sonya	Referencing Jackson Purchase's Response to Commission Staff's First Request, Item 9.
10:23:53 AM	Mr. Collins to Witness Williamson Note: Harward, Sonya	Referencing Jackson Purchase's Tariff, Section 31.
10:27:41 AM	Mr. Collins to Witness Williamson Note: Harward, Sonya	Referencing, generally, Witness's Direct Testimony.
10:28:11 AM	Mr. Collins to Witness Williamson Note: Harward, Sonya	Referencing Jackson Purchase's Corrected Response to Commission Staff's Request, Exhibit I, page 6.
10:31:42 AM	Mr. Collins to Witness Williamson Note: Harward, Sonya	Referencing, generally, Witness's Direct Testimony regarding Mr. Collin's usage of the word 'visit.'
10:33:03 AM	Atty. Cole cross-exam. of Witness Williamson Note: Harward, Sonya	Asking general questions about the Witness's experience and job responsibilities.
10:36:29 AM	Atty. Cole to Witness Williamson Note: Harward, Sonya	Referencing Witness's Direct Testimony, page 3, lines 22-23.
10:36:44 AM	POST HEARING DATA REQUEST by Atty. Cole Note: Harward, Sonya	Provide a confidential copy of the recorded converstations between Mr. Collins's and the Jackson Purchase service reps.
10:37:12 AM	Atty. Cole to Witness Williamson Note: Harward, Sonya	Referencing Witness's Direct Testimony, page 7, lines 22-23.
10:39:05 AM	Atty. Cole to Witness Williamson Note: Harward, Sonya	Referencing Witness's Direct Testimony, page 6, lines 18-19.
10:40:40 AM	Atty. Cole to Witness Williamson Note: Harward, Sonya	Referencing Witness's Direct Testimony, page 8, lines 10-12, and PSC Exhibit 1 to this Hearing, introduced here.
10:41:05 AM	PSC - Exhibit 1 Note: Harward, Sonya	Lists Rate, Meter Number, various Meter Readings, Monthly Usage, and Monthly Bill Amount at 1400 Carrsville Rd, Hampton, KY, and Hill Grove Rd, Hampton, KY.
10:44:29 AM	PSC - Exhibit 2 Note: Harward, Sonya	Titled "Exhibit I"
10:44:56 AM	Atty. Cole to Witness Williamson Note: Harward, Sonya	Referencing page 2 of PSC - Exhibit 1 of this Hearing.
10:49:36 AM	Atty. Yates re-direct exam. of Witness Williamson Note: Harward, Sonya	Referencing Jackson Purchase's Response to Commission Staff's First Request, Exhibit D, chart.
10:51:16 AM	Break Note: Harward, Sonya	Witness Williamson is ill.
10:51:29 AM	Session Paused	
11:00:09 AM	Session Resumed	
11:00:12 AM	Hearing Ofc. Woods - Comments about continuing the Hearing Note: Harward, Sonya	Witness Williamson is experencing a medical emergency.
11:00:18 AM	Camera Lock Deactivated	
11:00:40 AM	Atty. Yates Comments on Continuing Hearing	
11:01:19 AM	Kelly Nuckols Comments on Continuing Hearing	
11:02:08 AM	Additional comments about the ability to continue the Hearing.	
11:03:28 AM	Hearing Ofc. Woods - Comments on Continuing Hearing	
11:03:37 AM	Hearing will be continued, generally, due to Medical Emergency Note: Harward, Sonya	New date will be set to continue Hearing.

11:03:54 AM    Session Paused  
11:07:07 AM    Session Ended



## Exhibit List Report

2013-00052\_11Feb2014

**Roy G. Collins vs. Jackson  
Purchase Energy Corp.**

---

<b>Name:</b>	<b>Description:</b>
Jackson Purchase - Exhibit 1	Jackson Purchase Energy Corporation Motion to Dismiss
PSC - Exhibit 1	Lists Rate, Meter Number, various Meter Readings, Monthly Usage, and Monthly Bill Amount at 1400 Carrsville Rd, Hampton, KY, and Hill Grove Rd, Hampton, KY.
PSC - Exhibit 2	Titled "Exhibit I"



**COMMONWEALTH OF KENTUCKY**  
**BEFORE THE PUBLIC SERVICE COMMISSION**

In the Matter of:

ROY G. COLLINS	)	
	)	
COMPLAINANT	)	
	)	
V.	)	CASE NO.
	)	2013-00052
JACKSON PURCHASE ENERGY	)	
CORPORATION	)	
	)	
DEFENDANT	)	

**JACKSON PURCHASE ENERGY CORPORATION'S  
MOTION TO DISMISS**

Comes Jackson Purchase Energy Corporation and hereby moves the Commission to dismiss with prejudice the Complaint filed against it by Roy Collins. As grounds therefore, JPEC states that in accordance with its usual procedures on October 17, 2013, this Commission entered a Procedural Order in this matter. The Commission's Order, among other things, set dates to file direct and rebuttal testimony. Presumably, the purpose of pre-filed testimony in this matter is to develop the record, ensure that parties are afforded the opportunity to prepare a thorough cross examination and to assist the Commission in an orderly proceeding. Collins failed to comply with the Commission's procedural order and did not file any direct or rebuttal testimony. As such, the only evidence of record at this time indicates that JPEC acted in a fair, just and reasonable manner in the interpretation and application of its tariffs. Therefore, Mr. Collins' Complaint should be dismissed with prejudice.

However, in the event the Commission declines to dismiss Mr. Collins' Complaint, JPEC would ask in the alternative that this Commission prevent Mr. Collins from testifying in this matter as a result of his failure to pre-file either direct or rebuttal testimony. Because of Mr. Collins' failure

to file testimony, it is impossible for JPEC to adequately cross-examine Mr. Collins. His live testimony should be barred for reasons of fair play and procedural due process.

WHEREFORE, for the foregoing reasons, JPEC hereby requests that the Commission dismiss Mr. Collins' complaint with prejudice or, in the alternative, prohibit Mr. Collins from providing any testimony during the trial of this matter because of his failure to provide pre-filed direct or rebuttal testimony.

Respectfully submitted,

DENTON & KEULER  
P.O. BOX 929  
PADUCAH, KY 42002-0929  
Telephone: (270) 443-8253  
Facsimile: (270) 442-6000

By:   
Melissa D. Yates

ATTORNEY FOR JPEC

I hereby certify that the foregoing has been served by hand delivering a copy of the same to

MR JEFF DEROUEN  
KENTUCKY PUBLIC SERVICE COMMISSION  
211 SOWER BLVD  
FRANKFORT KY 40602

MR ROY G COLLINS  
109 DICKENSON STREET  
MANCHESTER KY 40962

on this 11th day of February, 2014.

By:   
Melissa D. Yates

Roy G Collins  
(Hunting Lodge) 1400 Carrsville Rd  
Hampton, KY

Roy G Collins  
Hill Grove Rd  
Hampton, KY

Rate	Meter Number	Current Meter Reading Date	Previous Meter Reading Date	Current Meter Reading	Previous Meter Reading	Monthly Usage	Monthly Bill Amount	Rate	Meter Number	Current Meter Reading Date	Previous Meter Reading Date	Current Meter Reading	Previous Meter Reading	Monthly Usage	Monthly Bill Amount
Small Commercial (SCH-C1) (Partial Month)	45359352	01/25/2013	01/15/2013	17,761	17,327	434	\$71.73								
Small Commercial (SCH-C1)	45359352	02/25/2013	01/25/2013	19,500	17,761	1,739	\$147.51								
Small Commercial (SCH-C1)	45359352	03/24/2013	02/25/2013	20,973	19,500	1,473	\$137.11	Residential (Sch-R)	JP002368	03/25/2013	02/25/2013	8,944	8,921	23	\$11.49
Small Commercial (SCH-C1)	45359352	04/24/2013	03/24/2013	22,323	20,973	1,350	\$128.30	Residential (Sch-R)	JP002368	04/25/2013	03/25/2013	9,067	8,944	123	\$19.20
Small Commercial (SCH-C1)	45359352	05/28/2013	04/24/2013	22,821	22,323	498	\$51.71	Residential (Sch-R)	JP002368	05/27/2013	04/25/2013	9,147	9,067	80	\$15.76
Small Commercial (SCH-C1)	45359352	06/25/2013	05/28/2013	23,322	22,821	501	\$51.12	Residential (Sch-R)	JP002368	06/24/2013	05/27/2013	9,147	9,147	0	\$9.76
Small Commercial (SCH-C1)	45359352	07/24/2013	06/25/2013	23,884	23,322	562	\$56.48	Residential (Sch-R)	JP002368	07/24/2013	06/24/2013	9,147	9,147	0	\$9.76
Small Commercial (SCH-C1)	45359352	08/26/2013	07/24/2013	24,252	23,884	368	\$41.93	Residential (Sch-R)	JP002368	08/24/2013	07/24/2013	9,147	9,147	0	\$10.20
Small Commercial (SCH-C1)	45359352	09/25/2013	08/26/2013	24,658	24,252	406	\$97.70	Residential (Sch-R)	JP002368	09/25/2013	08/24/2013	9,149	9,147	2	\$12.01
Small Commercial (SCH-C1)	45359352	10/23/2013	09/25/2013	24,896	24,658	238	\$35.84	Residential (Sch-R)	JP002368	10/24/2013	09/25/2013	9,149	9,149	0	\$11.32
Small Commercial (SCH-C1)	45359352	11/24/2013	10/23/2013	25,382	24,896	486	\$56.65	Residential (Sch-R)	JP002368	11/24/2013	10/24/2013	9,149	9,149	0	\$10.72
Small Commercial (SCH-C1)	45359352	12/27/2013	11/24/2013	26,451	25,382	1,069	\$114.26	Residential (Sch-R)	JP002368	12/26/2013	11/24/2013	9,149	9,149	0	\$11.32
Small Commercial (SCH-C1)	45359352	01/27/2014	12/27/2013	27,521	26,451	1,070	\$113.17	Residential (Sch-R)	JP002368	01/27/2014	12/26/2013	9,150	9,149	1	\$11.41
<b>Total</b>						<b>9,760</b>	<b>\$1,031.78</b>								
<b>Monthly Average</b>						<b>813</b>	<b>\$85.98</b>								

# EXHIBIT

## I

ID: JBT009

11/29/12 USER: KAREN

JACKSON PURCHASE E.C.  
JOB ORDER 12-0016498

11:36:14

KEYED BY: ANGIE CHITTENDEN  
DATE KEYED: 8/08/12  
TIME KEYED: 8:42:37

DESIRED PRINT DATE: 8/09/12  
\* REPRINT \*

REQUESTED BY: ROY COLLINS

CREW NUMBER: \_\_\_\_\_

ASSOCIATED WITH SERVICE ORDER: 12-0016496  
CC#: 2023562  
0  
0  
COLLINS/ROY G

NEW SERVICE  
SERVICEMAN READ

1400 CARRSVILLE RD  
HAMPTON KY 42047-0000

PHONE: 606 596-0908 HOME  
COUNTY:  
DESIRED COMPLETION DATE: 8/09/12

*- Contractor*

FIELD REP-CALL TONY 859-533-1714 ABOUT  
EITHER OH OR URD SERV FOR A HUNTING LODGE  
CLOSE TO 5-44-1-WILL HAVE LIVING QTRS

SUBSTATION:  
FEEDER:

MAILING ADDRESS

109 DICKENSON ST  
MANCHESTER KY 40962-0000

NEW SERVICE

CONSTRUCTION COMP BY \_\_\_\_\_ DATE \_\_\_\_\_  
TEMP INSP# \_\_\_\_\_ DATE \_\_\_\_\_  
TEMP METER# \_\_\_\_\_ READ \_\_\_\_\_  
TEMP METER SET BY \_\_\_\_\_ DATE \_\_\_\_\_  
DEMAND? \_\_, PH? \_\_, MULT BY? \_\_, KVA SIZE? \_\_\_\_\_  
PERM INSP# \_\_\_\_\_ DATE \_\_\_\_\_  
TEMP METER LAST READ \_\_\_\_\_ DATE \_\_\_\_\_  
PERM METER# \_\_\_\_\_ READ \_\_\_\_\_  
PERM METER SET BY \_\_\_\_\_ DATE \_\_\_\_\_  
CO/SCH\_LS# \_\_\_\_\_ POLE# \_\_\_\_\_ URD? \_\_ DIR \_\_\_\_\_  
\*\*\*\*\* RETURN TO STAKER? Y OR N \*\*\*\*\*

NOTES.....

Budget Code: \_\_\_\_\_

Work Order No: \_\_\_\_\_

Budget Code: \_\_\_\_\_

Work Order No: \_\_\_\_\_

*const cost af  
6,065.*

\*\*\*\*\*  
TAILGATE DISCUSSION

Crew Leader: \_\_\_\_\_ Unit#: \_\_\_\_\_

No. Of Crew Members: \_\_\_\_\_ Date: \_\_\_\_\_

Names: \_\_\_\_\_

Comments

Unusual Conditions: \_\_\_\_\_

Existing Hazards: \_\_\_\_\_

Work Procedures: \_\_\_\_\_

Energy Source Controls: \_\_\_\_\_

Traffic Control: \_\_\_\_\_

*Roy-  
606-599-5739*

*Said this is a Residential  
not going to be Hunting Lodge  
Roy has already talked to Kelly N.*

*Will price of const.  
Cost change?  
Do we chg E1 to R?*

14:40:26

JOB ORDERS 12-0016498

3/14/13  
JBL123FM

Account Number..... 1 05 545 001 00  
Requested By..... ROY COLLINS  
Desired Print Date..... 8/09/12

Select one of the pre-defined service orders from the list below and/or key in notes. G Desired Completion Date: 080912

- |   |  |
|---|--|
| CT ADD POLE FOR OVERHEAD CONST...       | OC CONSUMER REQUESTS/REPAIRS .....     |
| OA ANCHORS/GUYS .....                   | CD CROSSARM REPLACEMENT .....          |
| OB BLINKING/DIMMING LIGHTS .....        | 23 CUT CABLE .....                     |
| 09 CAPACITOR .....                      | AL DISCONNECT - HAZARDOUS COND .....   |
| BO CHECK FOR SIGNS OF TAMPERING .....   | I DISCONNECT - SINGLE PHASE .....      |
| CB CHECK SECURITY LIGHT - DISC .....    | J DISCONNECT - THREE PHASE .....       |
| CC CHECK SECURITY LIGHT-RECONNECT ..... | CQ DISCONNECT AND RETIRE SERVICE ..... |
| CA CHECK SERIAL NUMBER .....            | ZY DISCONNECT FOR NON-PAYMENT .....    |
| 08 CLEARANCE .....                      | M DISCONNECT TRANSFER - THREE PH ..... |
| C7 CODE 7-TRANSFORMER REPAIR .....      | N DISCONNECT TRANSFER-SINGLE PH .....  |

Notes: FIELD REP-CALL TONY 859-533-1714 ABOUT  
EITHER OH OR URD SERV FOR A HUTING LODGE  
CLOSE TO 5-44-1-WILL HAVE LIVING QTRS

Print (Y/N) N

Staking Required (Y/N) Y

Help Available - Help Key JOB ORDER HAS ALREADY PRINTED

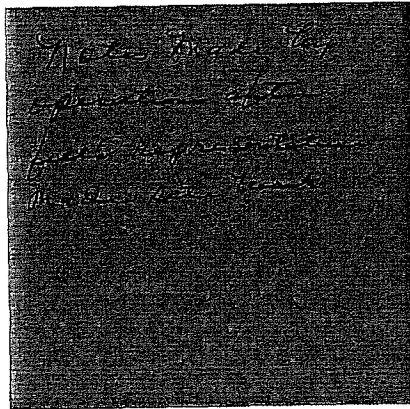

14:40:26

JOB ORDERS 12-001649P

3/14/13  
JBL123FM

Account Number..... 1 05 545 001 00  
Requested By..... ROY COLLINS  
Desired Print Date..... 8/09/12

Select one of the pre-defined service orders from the list below and/or key in notes. G Desired Completion Date: 080912

JOB ORDER ADDITIONAL INFORMATION

JBL123

COLLINS/ROY, G ..... Phone# 606 596 908 County LIVINGSTON COUNTY  
HUNTING LODGE .....

Other..... Inspection Req (Y/N) Y Inspect Rec Date 10213

Rel To Staker 80912 Date Staked 82412 Staked By TD

Contribution Amt 606594 Contribution Date 121812 Refundable Y/N N

Rl By Staker 121812 To Whse Rec By Oper 121812 To be Const I0413

Crew# 17 Pending Construct Compl 11513 Stkng Appt Time 0000 By TD

Notes: INDETERMINATE SERVICE \$6,065.94 Right Of Way Req

INSP 30799 Right Of Way Obt -

F10=Work Orders

Help Available - Help Key

Staking Required (Y/N) Y

Help Available - Help Key JOB ORDER HAS ALREADY PRINTED

3/14/13

Service Order Notepad 12-0016496

14:41:00  
JBL191FM

07- 11/29/12 ROY COLLINS CALLED TO LET US KNOW THAT HE HAS CHANGED HIS MIND  
ABOUT THIS BEING A HUNTING LODGE IT'S GOING TO BE A RESIDENTIAL HOUSE  
WANTED TO KNOW IF THE CONST COST WILL CHANGE TALKED TO TOM AND HE SAID TO  
TALK TO CRAIG ABOUT IT- CAUSE THIS HAS BEEN SOMETHING THAT HAS BEEN UP IN  
THE AIR ABOUT WHAT IS ACTUALLY GOING ON AT THIS LOCATION- ROY SAID HE HAD  
ALREADY BEEN TALKING TO KELLY NUCKOLS ABOUT IT

30-TONY BROWN-BUILDER CALLED TO SEE WHEN SVC WILL BE CONN SAID MR COLLINS  
MAILED CK FOR CONST COST LAST THURS-PER L REED HAS NOT BEEN REC'D YET JOB  
ORDER SHOWS STILL WITH STAKER MR BROWN WILL CALL BACK WED/12/19 TO SEE IF  
CK REC'D & WHEN WILL BE CONNECTED S HALL 12/17/12

+



ID-JBL009  
8/08/12 USER:

JACKSON PURCHASE E.C.  
JOB ORDER 12-0016581

12:49:03  
5-053-001

KEYED BY: ANGIE CHITTENDEN REQUESTED BY: ROY G COLLINS  
DATE KEYED: 8/08/12 DESIRED PRINT DATE: 8/09/12  
TIME KEYED: 8:46:21 CREW NUMBER: \_\_\_\_\_

ASSOCIATED WITH SERVICE ORDER: 12-0016500 RECONNECT  
CC#: 2023562 SERVICEMAN READ  
1 5-053-001 03 7  
COLLINS/ROY G \* ACTIVE \*

HILL GROVE RD PHONE:  
HAMPTON KY 42047-0000 COUNTY: LIVINGSTON COUNTY  
DESIRED COMPLETION DATE: 8/09/12  
METER NUMBER: JP002368

CHG FROM BROWN  
8-9-12

SUBSTATION: Joy  
FEEDER: Joy/Hampton South

MAILING ADDRESS

109 DICKENSON ST  
MANCHESTER KY 40962-0000

RECONNECT TRANSFER - SINGLE PH  
COMPLETED BY L 99 DATE 8/9/12  
MULTIPLY BY \_\_\_\_\_  
SERIAL NUMBER \_\_\_\_\_  
SIZE \_\_\_\_\_  
METER READING 7815  
INSPECTION # \_\_\_\_\_ DATE \_\_\_\_\_  
DEMAND YES \_\_\_\_\_ NO \_\_\_\_\_  
TRANSF # \_\_\_\_\_  
IMPEDANCE \_\_\_\_\_ KVA \_\_\_\_\_ PHASE \_\_\_\_\_

NOTES.....  
Budget Code: \_\_\_\_\_  
Work Order No: \_\_\_\_\_  
Budget Code: \_\_\_\_\_  
Work Order No: \_\_\_\_\_  
\_\_\_\_\_ 7-5-D \_\_\_\_\_  
\_\_\_\_\_  
\_\_\_\_\_

\*\*\*\*\*  
METER TEST DUE 12/05/33  
LAST TESTED 12/05/08

\* OLD NEW \*  
\* MULT BY 00001 \_\_\_\_\_ \*  
\* MAKER'S NO. JP002368 \_\_\_\_\_ \*  
\* SIZE 300 \_\_\_\_\_ \*  
\* METER READ \_\_\_\_\_ \*  
\* AMI MTR ADR \_\_\_\_\_ \*

\*\*\*\*\*  
Cr \_\_\_\_\_  
No \_\_\_\_\_  
Na \_\_\_\_\_  
Un \_\_\_\_\_  
Ex \_\_\_\_\_  
Wo \_\_\_\_\_  
En \_\_\_\_\_  
PP \_\_\_\_\_  
Tr \_\_\_\_\_  
Rescue: \_\_\_\_\_

Mo  
8.16.12

ID-JBL009  
8/08/12

USER: CHI

JACKSON PURCHASE E.C.  
JOB ORDER 12-0016496

8:42:49

KEYED BY: ANGIE CHI/TENDEN  
DATE KEYED: 8/08/12  
TIME KEYED: 8:42:37

DESIRED PRINT DATE: 8/09/12

REQUESTED BY: ROY COLLINS

CREW NUMBER: 17

ASSOCIATED WITH SERVICE ORDER: 12-0016496  
CC#: 2023562  
0  
COLLINS/ROY G 00 0 1-05-545-001-00-9

NEW SERVICE  
SERVICEMAN READ

1400 CARRSVILLE RD  
HAMPTON KY 42047-0000

PHONE: 606 596-0908 HOME  
COUNTY:  
DESIRED COMPLETION DATE: 8/09/12

ACTIVATED ENGR 1/16/13

SUBSTATION:  
FEEDER: 509 0501 A

FIELD REP-CALL TONY 859-533-1714 ABOUT  
EITHER OH OR URD SERV FOR A HOME-HFI  
CLOSE TO 5-44-1-WILL HAVE LIVING QTRS

MAILING ADDRESS

109 DICKENSON ST  
MANCHESTER KY 40962-0000

NEW SERVICE

CONSTRUCTION COMP BY \_\_\_\_\_ DATE \_\_\_\_\_  
TEMP INSP# 30799 DATE 1-2-13  
TEMP METER# \_\_\_\_\_ READ \_\_\_\_\_  
TEMP METER SET BY \_\_\_\_\_ DATE \_\_\_\_\_  
DEMAND?  , PH?  , MULT BY?  , KVA SIZE? 15  
PERM INSP# \_\_\_\_\_ DATE \_\_\_\_\_  
TEMP METER LAST READ \_\_\_\_\_ DATE \_\_\_\_\_  
PERM METER# 45 359 352 READ 17327  
PERM METER SET BY DD+ET DATE 1-15-13  
CO/SCH6 LS# \_\_\_\_\_ POLE# 25-545-001 URD?  DIR/1  
\*\*\*\*\* RETURN TO STAKER? Y OR N \*\*\*\*\*

NOTES.....  
Budget Code: 102-00  
Work Order No: CR121946  
Budget Code: \_\_\_\_\_  
Work Order No: \_\_\_\_\_  
Address 2944963  
(pt 102)  
2/5/13

This A Perm meterbase.

Stake 9 08-24-12 TD

TAILGATE DISCUSSION

Crew Leader: DD Unit#: 17  
No. Of Crew Members: \_\_\_\_\_ Date: 1-15  
Names: DG ET  
JG JS BH

Comments

Unusual Conditions: \_\_\_\_\_  
Existing Hazards: \_\_\_\_\_  
Work Procedures: \_\_\_\_\_  
Energy Source Controls: \_\_\_\_\_  
PPE: \_\_\_\_\_  
Traffic Control: \_\_\_\_\_  
Rescue: \_\_\_\_\_

-1406249326

1/16/13  
AW

**Terry Miller**

---

**From:** Terry Miller  
**Sent:** Wednesday, February 20, 2013 10:10 AM  
**To:** Scott Ribble  
**Subject:** FW: Roy Collins

**Importance:** High

---

**From:** Terry Miller  
**Sent:** Tuesday, January 15, 2013 10:01 AM  
**To:** Scott Ribble; Craig Gerke  
**Subject:** Roy Collins  
**Importance:** High

Scott,  
I received a call from Ginny Smith at the PSC this morning and she told me that she spoke with Mr. Collins concerning his letter. She said that at this time it would not be considered a primary residence, however he is insisting that it will be their secondary home. If he wants to continue to try to change this opinion, Ginny told him he would need to file a formal complaint with the PSC.

*Terry Miller  
Jackson Purchase Energy Corporation  
Manager of Customer Service  
270-441-0824  
270-559-0786 (cell)*

The email message and any attachments to it may be confidential and are intended solely for the use of the individual(s) to whom it is addressed. If you are not the intended recipient of the email, you must neither take any action based upon its contents, nor copy, distribute or show it to anyone. Please contact the sender if you believe you have received this email in error.





C: 121946  
R: .

### ASSEMBLY UNITS REPORT

Location					
Location Name	Function	Const. Unit	Description	Quantity	Work Crew
1	INSTALL	1360	A5.2 (A5-2)	1	JPEC1
1	INSTALL	3205	E1.1 (E1-2)	1	JPEC1
1	INSTALL	3240	E3.10 (E3-10) JPEC UNIT	1	JPEC1
1	INSTALL	3306	F2.8 (F1-2S)	1	JPEC1
1	INSTALL	4618	M 5-9-1	1	JPEC1
2	INSTALL	4902	2 ACSR PRI	346	JPEC1
2	INSTALL	4902	2 ACSR PRI	346	JPEC1
2	INSTALL	1200	A1.1 (A1)	1	JPEC1
2	INSTALL	4510	H5.1 (M2-2)	1	JPEC1
2	INSTALL	1141	POLE 40 FT CL 5	1	JPEC1
3	INSTALL	4902	2 ACSR PRI	301	JPEC1
3	INSTALL	4902	2 ACSR PRI	301	JPEC1
3	INSTALL	1350	A5.1 (A5)	1	JPEC1
3	INSTALL	3205	E1.1 (E1-2)	1	JPEC1
3	INSTALL	3240	E3.10 (E3-10) JPEC UNIT	1	JPEC1
3	INSTALL	3306	F2.8 (F1-2S)	1	JPEC1
3	INSTALL	3405	G1.5 (G3)	1	JPEC1
3	INSTALL	4505	H1.1 (M2-1)	1	JPEC1
3	INSTALL	1135	POLE 35 FT Class 5	1	JPEC1
3	INSTALL	6138	TRANS CONV 15 KVA	1	JPEC1

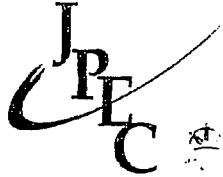

C: 121946  
R: -

### ASSEMBLY UNITS REPORT

Summary					
	Function	Const. Unit	Description	Quantity	Correction
	INSTALL	1135	POLE 35 FT Class 5	1	
	INSTALL	1141	POLE 40 FT CL 5	1	
	INSTALL	1200	A1.1 (A1)	1	
	INSTALL	1350	A5.1 (A5)	1	
	INSTALL	1360	A5.2 (A5-2)	1	
	INSTALL	3205	E1.1 (E1-2)	2	
	INSTALL	3240	E3.10 (E3-10) JPEC UNIT	2	
	INSTALL	3306	F2.8 (F1-2S)	2	
	INSTALL	3405	G1.5 (G3)	1	
	INSTALL	4505	H1.1 (M2-1)	1	
	INSTALL	4510	H5.1 (M2-2)	1	
	INSTALL	4618	M 5-9-1	1	
	INSTALL	4902	2 ACSR PRI	1,294	
	INSTALL	6138	TRANS CONV 15 KVA	1	



C: 121946  
R:

	Function	Qty	Unit	Crew	Material Cost	Labor Cost
1	INSTALL	1	A5.2 (A5-2)	JPEC1	52.63	\$25.73
1	INSTALL	1	E1.1 (E1-2)	JPEC1	16.87	\$0.00
1	INSTALL	1	E3.10 (E3-10) JPEC UNIT	JPEC1	3.7	\$0.00
1	INSTALL	1	F2.8 (F1-2S)	JPEC1	83.48	\$409.17
1	INSTALL	1	M 5-9-1	JPEC1	123.68	\$51.50
2	INSTALL	1	A1.1 (A1)	JPEC1	33.3	\$0.00
2	INSTALL	1	H5.1 (M2-2)	JPEC1	4.92	\$77.25
2	INSTALL	1	POLE 40 FT CL 5	JPEC1	281.5	\$849.52
2	INSTALL	346	2 ACSR PRI	JPEC1	55.36	\$411.74
2	INSTALL	346	2 ACSR PRI	JPEC1	55.36	\$411.74
3	INSTALL	301	2 ACSR PRI	JPEC1	48.16	\$358.19
3	INSTALL	301	2 ACSR PRI	JPEC1	48.16	\$358.19
3	INSTALL	1	A5.1 (A5)	JPEC1	41.63	\$25.73
3	INSTALL	1	E1.1 (E1-2)	JPEC1	16.87	\$0.00
3	INSTALL	1	E3.10 (E3-10) JPEC UNIT	JPEC1	3.7	\$0.00
3	INSTALL	1	F2.8 (F1-2S)	JPEC1	83.48	\$409.17
3	INSTALL	1	G1.5 (G3)	JPEC1	167.69	\$103.00
3	INSTALL	1	H1.1 (M2-1)	JPEC1	13.62	\$77.25
3	INSTALL	1	POLE 35 FT	JPEC1	205.22	\$695.06
3	INSTALL	1	TRANS CONV 15 KVA	JPEC1	0	\$463.37

Summary	
Cost Type	Amount
Total Labor and Material	6065.94

1339.33      \$4,726.61

W/O #  
C130035

	TOTAL	13-01 JANUARY
DIRECT LABOR	420.43	420.43
VACATION, HOLIDAY, FLEX & MISC	214.32	214.32
SICK	32.84	32.84
PENSION	202.51	202.51
HEALTH, LIFE & DISABILITY	272.79	272.79
PAYROLL TAXES	95.41	95.41
INDIRECT LABOR	301.71	301.71
BUSINESS LIABILITY		
MISCELLANEOUS		
INDIRECT MATERIALS	1.29	1.29
INDIRECT TRANSPORTATION	175.76	175.76
POWER OPERATED EQUIPMENT		
STORES EXPENSE	15.26	15.26
DIRECT MATERIAL	255.03	255.03
A/P (J/E) DIRECT MATERIAL		
DIRECT TRANSPORTATION	268.86	268.86
SALVAGE		
WORK ORDER TOTAL	2,256.21	2,256.21





Sheet 1 of 3

JPEC Staking Sheet  
System Designation: KY20 McCracken

NO PAN

Acct #: 05-545-001  
Near Acct #:  
Consumer: Roy Collins  
Address: 1400 Carrsville Rd  
Address: Hampton  
Zip: 42047  
Phone:

County: 4  
Work Plan:  
Loan:  
Code: 101

Service Order #: C: 130035  
Job Order #: 13-000230 ✓ R:  
Staked by: TD Date: 1/3/2013  
STP by: Date: 1/4/13  
STE by: Date: 1/16/13

Notes: Install URD Service *Stawie 1/30/13*

Demand (Y/N): N  
Substation: Jy  
Feeder: # 0505  
Hold Card:

Goes with WO#: Phase: A  
Voltage: 120/240  
Trans Size: 15  
Main Size: 200

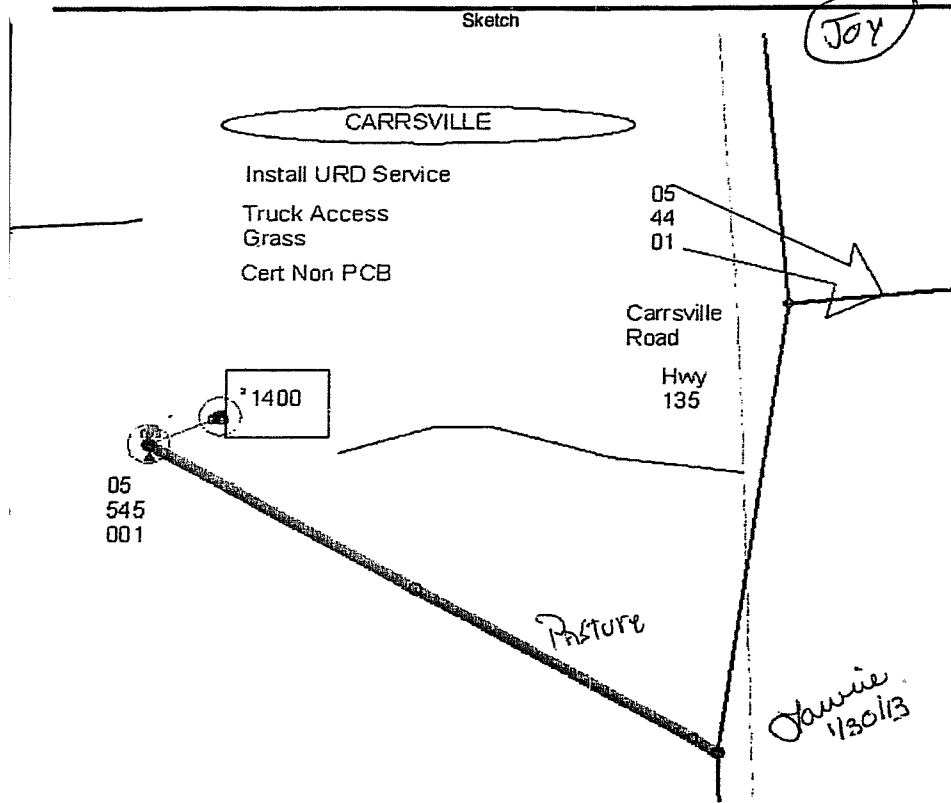

OTHER ATTACHMENTS		
LOCATION #	COMPANY	EX/ADD/REM

URD LOCATE INFO	
BUD #:	
BUD Date:	
Utility	Utility

ROUTING INFORMATION			
Date to Whse:	Date to Crew:	Date Complete:	Truck #: 17
Date to Oper: 1/4/13	Crew Number:	Completed by: DD	Stawie 01/16/13

TRANSFORMER RECORDS									
INSTALL									
Prikey	Serial Number	Size	Manufact.	PH	Sec. Voltage	% IMP	# of Bush	OH /	URD

*Use notes on sheet 100 @ 1706*

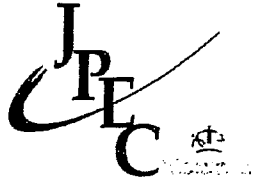

C: 130035  
R: -

### ASSEMBLY UNITS REPORT

Location						
Location Name	Function	Const. Unit	Description	Quantity	Work Crew	
1	INSTALL	4316	1/0 URD TPX SER Material Only	40	JPEC1	
1	INSTALL	5700	UM 5	1	JPEC1	
2	INSTALL	4316	1/0 URD TPX SER	74	JPEC1 ✓	

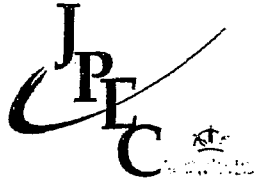

ASSEMBLY UNITS REPORT

C: 130035  
R: .



Summary				
Function	Const. Unit	Description	Quantity	Correction
INSTALL	4316	1/0 URD TPX SER	114	
INSTALL	5700	UM 5	1	

@cost

### Material Issued From Truck

Job Name COULINS, ROY Date 1-15-13  
 Acc# No. 05-545-001 Work Order # C130035 Budget Code 101-00

Description	Code	Quan.	Description	Code	Quan.	Description	Code	Quan.
<b>Anchors &amp; Arrestors</b>			<b>Splice &amp; Terminators</b>			<b>Pins</b>		
Anchor (Bell/Buss)	005		Splice, Tension	510		Insul. Adaptor-(Lead Head)		390
Anchor-Screw Type	007		Splice, Repair	511		Crossarm Pin-Steel		391
Anchor-Trip: Helix	008		Splice, Jumper	512		Clamp Type Pin		392
Anchor Rods (Single Eye)	015		Term. Pin (Adapter)	534		Stud-5/8x7-(Post)		393
Anchor Rods-Twin Eye	018		Term. Pin 500 MCM	535		Stud-3/4x1x3/4-(Post)		394
Anchor Rods-Screw Type	017		Term. Ser. Pin	536	3	Stud All Other		395
Anchor Rods (Triple Helix)	018		Term. Lug	537	3	Angla Mounting-(Mule Hoof)		396
Arrestor-Distrib	030		Term. Adapt 4 hole (Paddle)	538		Pole Top		397
Arrestor-Secondary	033					Pole Splint		398
Arrestor-Station 60Kv	035		<b>Bracket</b>					
			Bracket, Term-1 Pos	621		<b>Poles</b>		
<b>Bolts, Washers, Nuts, Etc.</b>			Bracket, Term-2 Pos	622		Pole-30'		430
Carriage	040		Bracket, Term-3 Pos	623		Pole-35'		435
Clevis	041		Bracket, Term 4B - 6 Pos	626		Pole-35 Galv. Steel		437
D.A.	042		Angle Sup.- (C3-1)	060		Pole-40'		440
Bolt-Eye	043		Horiz. Insul. (close const.)	061		Pole-45'		445
Machine-1/2"	044		Pole Top Post	083		Pole-50'		450
Machine-5/8"	045					Pole-55'		455
Machine-5/8" X 6" or Less	051		<b>Cutouts &amp; Fuses</b>			Pole-60'		460
Machine-3/4"	046		Cutout	231		Pole-65'		465
Thimble Eye	048		Cutout, Load Brk-100 amp	232		Pole-70'		470
Upsel	049		Cutout, Load Brk 200 amp	233		Pole-75'		475
Washer-Curved	551		Fuse, PDMT Trans	240				
Washer-Round	552		Fuse, Line	241		<b>OverHead, Wire, Bars</b>		
Washer-Square	553		Fuse, Trans - (flpper)	242		4 ACSR		101
Washer-Square 4x1/2	554		Fuse, Substation	243		2 ACSR		102
Washer-Anchor Log	555					1/0 ACSR		103
Crossarm-Saddle Plate	225		Wire, Solid Cooper & Sq. Guard			2/0 ACSR		100
Nut-Eye	371		#8	572		3/0 ACSR		104
Nut-Lock	372		#6	573		4/0 ACSR		105
Nut-Thimble Eye	373		#4	574		336.6 ACSR		106
Hook-Drive	330		SQ. Wire	1418		397.5 ACSR		107
Screw-Lag	485		SQ. Guard	999		500 MCM AA		108
						350 MCM AA		109
<b>Connectors</b>			<b>Switches</b>			652.4 MCM		110
Conn. Small	200		Switch, Line Disc	521		6 Std. C		111
Conn. K-1 Jumper	201		Switch, Inline	527		4 Std. C		112
Conn. Large	202		Switch, Line Disc, Gang	522		2 Std. C		113
			Switch, Disc. - Sub	524		1/0 Std. C		114
<b>Crossarms, Braces, Etc.</b>			Switch, By-Pass-400 Amp	525		2/0 Std. C		115
Crossarm-8"	218		Switch, By-Pass-600 Amp	528		4/0 Std. C		117
Crossarm-8" F/Glass Non-DE	219		Switch, Auto Reg. Byp.	528		350 Std. C		118
Crossarm-10"	220					500 Std. C		119
Crossarm-10" F/Glass Non-DE	224		<b>Ground Rods, Guy Material</b>					
Crossarm-12"	222		Ground Rod-5/8	281		<b>OverHead, Wire, Service</b>		
Crossarm-All Other	221		Ground Rod-3/4	262		6 DPX		130
Crossarm-Assy. (Dead End)	223		Ground Pole Bolt Plate	263		2 TPX		131
Brace-Alloy Arm	055		Blocker, Stray Voltage	264		1/0 TPX		132
Brace-28" (Light 1 set)	056		Guy Attach	270		2/0 TPX		133
Brace-60" (Heavy 1 set)	057		Guy Attach (Fiberglass Rod)	269		3/0 TPX		134
Brace-Wood-72"	058		Guy Clamp-3-Bolt	271		4/0 TPX		135
			Guy Grips (Wrap)	272		350 TPX		136
<b>Armor Rods &amp; Ties</b>			Guy Marker	273		4 Quad		141
Armor Rod	020		Guy Wire-6M	278		2 Quad		142
Ties, Preform-S.T.T.	540		Guy Wire-10M	277		1/0 Quad		143
Wire Alum Tie-4	571		Guy Wire-3/8"	278		2/0 Quad		144
			Guy Wire-12.5M	279		3/0 Quad		145
<b>Clamps, Stirrup &amp; Clevis</b>						4/0 Quad		146
Anchor Rod Clamp	070		<b>Hangers</b>			350 Quad		147
Dead End Clamp (Shoe)	071		Cap-w/Switch	303		2/0 Std. C		155
Ground Rod Clamp	072		Trans Cluster 12"	309		4/0 Std. C		158
Hot Line Clamp	073		Trans Cluster 24"	310		500 Std. C		158
Saddle Tap (Stirrup)	480		R-OCR	312		750 Std. C		169
Service Grip (wrap)	075		Alum. Platform	313		350 MCM AL		177
Suspend. Clamp (angle shoe)	076					500 MCM AL		178
Wireholder-Conduit (K-17)	580		<b>Insulators</b>			2 STD. RHW		184
Clevis, Sec. SW (J-8)	080		Pin Type	354		250 STD. RHW		187
Clevis, Sec. SW (K-11)	081		Post Type	355		300 STD. RHW		188
Clevis, Anchor Shackle	082		Post Type-Hor.-(Close Const.)	358		350 STD RHW		189
Clevis, Sec. Wideback	083		Horiz. Post 69KV	357				
			23KV Post-(Sub)	358				
<b>Capacitors (Misc)</b>			Guy Strain-(Fiber Glass Rod)	359				
Capacitor, Control	816		Spool	380				
Capacitor, Junc. Box	818		Suspension-(Belle)	362				
Oil Switch	802		Epoxiator	363				

Description	Code	Quan.	Description	Code	Quan.	Description	Code	Quan.
<b>Primary URD Cable</b>			<b>Pads, Pedestals, Shields, Boots</b>			<b>Controls, Heads, Globes, Ballast</b>		
Pr: 2" Alum URD	642		Pad (Info Park)	679		S/L & F/L Control (Eye all)	495	
Pr: 1/0 Alum URD	641		Pad, Concrete	680		S/L 100W Head	498	
Pr: 4/0 Alum URD	645		Pad, Fiberglass Trans	681		S/L 175W Head	496	
500' CU Pr: URD	648		Box Pad, Trans (Vault)	682		Optical, Assembly (Globe all)	497	
500' MCM Alum Pr: URD	647		Box Pad, Cover (Vault cover)	683		Ballast S/L (all but below)	494	
750' MCM Alum Pr: URD	655		Ped, Power (sec)	684		Ballast HPS	499	
			Shield Cable Riser 8' (Shield)	688		Ballast 100W MH	483	
<b>Secondary URD Cable &amp; Wire</b>			Shield, Back Up Pole (ft)			Security & Flood Lights		
6' URD DPX	748		Boot for Shield	688				
1/0' URD TPX	651		Shield, Riser (5' ft)	689		S/L 100W HPS	488	
2/0' URD TPX	662					S/L 175W MV	491	
4/0' URD TPX	654		<b>Brackets, Cabinets, etc.</b>			S/L 250W HPS	489	
350' URD TPX	658		Bar, Trans - Bars	611		F/L 250W HPS	490	
1/0' Quad	657		Bar, Trans - Ins - 4 Pos	613		S/L 400W MV	492	
4/0' Quad	658		Bar, Trans - Ins 6 or 8 Pos	614		S/L 400W MH	2503	
350' Quad	659		Bar, Pedas - Ins - 4 Pos	615		F/L 1000W MH	505	
10/2' UF W/Grd	740		Bracket, Conduit	620				
12/2' UF	741		Bracket, Stand-Off Con.	628		<b>Decorative Lighting</b>		
10/2' UF W/Grd	742		Cabinet, 4 Junct, 3-Phase	630		Breakaway Base (Info Park)	2100	
8' UF	743		Cabinet, Junct, 1-Phase	632		Pole (Info Park)	2200	
10' UF	744		Sleeve, Grd, 1-Phase (Vault)	633		8' Arm (Info Park)	2300	
6' UF	745		Box Pad, Switch Gear	631		Head 400W MH/480V (Info Park)	2400	
12/3' UF W/Grd	747		Switchgear, PMH6	637		AAL Fixture (Info Park)	2401	
10/3' UF	748					AAL Pole (Info Park)	2201	
			<b>URD, Splice, Term, Misc.</b>			Fixture 1000w (Info Park) Big Sq	2405	
<b>Arrestors</b>			Ter Splice 1/0	1008		Pole (West Park)	2202	
Arrestor-Elbow	031		Splice URD Repair (Pr)	691		Fixture Acorn 150W hps (West Park)	2402	
Arrestor-Parking Stand	705		Splice URD Repair (Sec)	692		Screw Base	1999	
			Splice Cover (Sec)	693		Bracket, Arm/2 Light (Woodlawn)	2403	
<b>Conduit</b>			Splice Jacket	694		Fixture Acorn 100W HPS	503	
Conduit, 1/2" PVC	681		Sealing Kit (Cold Shrink)	695		20' Fib Glass Pole (Direct Bury)	504	
Conduit, 3/4" PVC	682		Support Cable (Pig Tail)	697		Cobra Head (400W 2/unit)	501	
Conduit, 1" PVC	683		Term Bushing (Wall Bushing)	706		Cobra Head (250W St Light HPS)	502	
Conduit, 1 1/4" PVC	684		Rotatable Feed Thru (Wall)	707		Cobra Head (100W HPS)	506	
Conduit, 1 1/2" PVC	685		Pothead (2 thru 4/0)	710		Acorn Head (400W MH)	507	
Conduit, 2-2 1/2" PVC	686		Pothead (all other 750)	711		Acorn Head (175W MH)	2500	
Conduit, 2-2 1/2" Rigid	788		Term Indoor	716		Mongoose Fixture 250W HPS	2408	
Conduit, 3" PVC	687		Term Elbow-4/0	714		Roadway Fixture 100W HPS typell	2404	
Conduit, 4" PVC	688		Term Elbow-500 MCM	716		10' Arm (Only)	500	
Conduit, 4" Rigid	788		Term Elbow #1/0	717		S/L Concrete Foundation	2000	
Conduit, 5" PVC	680		Term Elbow #2	718		Dixie Screw Base (Large)	2105	
Conduit, 5" Rigid	789		Splice 600 URD 15KV	720		Pole 30' Tapered Steel Pole Bronze	2203	
Conduit, 6" PVC	677		Term Junc-1 Pos	721		Pole 30' Fiberglass Black	2204	
Conduit, 6" Rigid	777		Term Junc-2 Pos	722		Pole 35' Steel	2205	
			Term Junc-3 Pos	723		Pole 30' Tapered Aluminum	2208	
			Term Junc-4 Pos	724		Pole 12' MH Black Fluted	2207	
<b>Conduit Elbow, Cap &amp; Adaptor</b>			Term Junc-Caps (Ground)	730		8' Arm (for SQ. Steel Pole)	2303	
Elbow-1" PVC	670		2-Way Loadbreak Junc	726		8' Arm Black	2304	
Elbow-1 1/2" PVC	671							
Elbow-2-2 1/2" PVC	672		<b>500 Termination Kit</b>					
Elbow-2-2 1/2" Rigid	772							
Elbow-3" PVC	673		Cable Adapter	733				
Elbow-4" PVC	674		Elbow Housing	734				
Elbow-4" Rigid	774		Connector Plug	736				
Elbow-5" PVC	676		Term, Dead End Plug	737				
Elbow-5" Rigid	776		Wall Bushing Reducer 600 Amp	738				
Elbow-6" PVC	676		Insul. Plug	739				
Elbow-6" Rigid	776							
<b>Vented Cap &amp; Adaptor (all)</b>			<b>Security &amp; Flood Light Bulbs</b>					
			S/L Bulb-100W Metal Halide	482				
			S/L Bulb-100W	488				
<b>Polypipe</b>			Bulb, 160W HPS	2502				
2-2 1/2" Polypipe	2826		Bulb, 175W & 400W MV	493				
4" Polypipe	2840		Bulb, 175W Metal Halide	2501				
2 1/2" Polypipe Coupling	2828		Bulb, 250W HPS	487				
4" Polypipe Coupling	2841		Bulb, 400W Metal Halide	2500				
			F/L Bulb-1000W Metal Halide	484				

Contractor/Employee DD

Prepared By \_\_\_\_\_

Unit No. \_\_\_\_\_

Entered By \_\_\_\_\_

# Work Order Summary Sheet

Construction W/O # C130035 Retirement W/O # \_\_\_\_\_

G/L Account # 107.200 X 107.100 G/L Account # 108.800 108.810

Map Location: 05-545-001

County Code: 1 \_\_\_ 2 \_\_\_ 3 \_\_\_ 4 X 5 \_\_\_ 6 \_\_\_

Contractor Code: \_\_\_\_\_

Budget Code: 101-00 ( )

Loan #: AS 8

Goes with W/O: \_\_\_\_\_

Phase (1 - 6) 1

Date Entered: 1/4/13

Date Released: 1/15/13

Date Completed: 1/15/13

Month Closed: \_\_\_\_\_

NOTES:

~~COPY~~ ~~ORIG~~ HAS  
ORIGINAL

## ✓ Wire Statistics

Add Remove

Pri. OH \_\_\_\_\_

UG \_\_\_\_\_

Sec. OH \_\_\_\_\_

UG \_\_\_\_\_

✓ Ser. OH \_\_\_\_\_

UG X 74 114

Member \_\_\_\_\_

Construction Cost \$ \_\_\_\_\_

Retirement Cost \$ \_\_\_\_\_

Actual Cost of W/O \$ \_\_\_\_\_

(Construction + Retirement - Contribution paid)

Description:

\_\_\_\_\_

Consumer:

COLLINS, ROY

Contribution Paid: \$ \_\_\_\_\_

Date Paid: \_\_\_\_\_ Acct# \_\_\_\_\_

Non-Cash Contribution: \$ \_\_\_\_\_

Construction Contribution: \$ \_\_\_\_\_

Retirement Contribution: \$ \_\_\_\_\_

Total Contribution: \$ \_\_\_\_\_

ID-JBL009  
1/03/13 USER: TOMD

JACKSON PURCHASE E.C.  
JOB ORDER 13-0000230

6:27:43  
5-044-001

KEYED BY: TOM DILLWORTH  
DATE KEVED: 1/03/13  
TIME KEVED: 6:25:36

DESIRED PRINT DATE: 1/03/13

REQUESTED BY: T DILLWORTH

CREW NUMBER: 17

ASSOCIATED WITH SERVICE ORDER: 13-0000230  
CC#: 118760

JOB ORDER  
SERVICEMAN READ

1 ~~13-0000230~~ 01 3 Roy Collins  
\* ACTIVE \*

1403 CARRSVILLE RD  
HAMPTON KY 42047-9324

PHONE: 270 988-3644 HOME  
COUNTY: LIVINGSTON COUNTY  
DESIRED COMPLETION DATE: 2/30/13  
LAST COOP READ: 12/20/12  
LAST COOP KWH READ: 0003744

METER NUMBER: JP002367  
PRESENT READ: 0003744

SUBSTATION: Joy  
FEEDER: Joy/Hampton South

MAILING ADDRESS

1403 CARRSVILLE RD  
HAMPTON KY 42047-9324

INSTALL URD SERVICE WIRE

*Notes  
Asy to  
1/16/13  
AC*

UNDERGROUND FACILITIES

COMPLETED BY: DD+ET DATE: 1-15-13

PRI WIRE: \_\_\_\_\_

SEC WIRE: \_\_\_\_\_

SER WIRE: \_\_\_\_\_

TRANSFORMER: \_\_\_\_\_

PEDESTAL: \_\_\_\_\_

SWITCH: \_\_\_\_\_

TRENCH: \_\_\_\_\_

HAUL DIRT: \_\_\_\_\_

SOW GRASS: \_\_\_\_\_

NOTES.....

Budget Code: 101-00

Work Order No: C130035

Budget Code: \_\_\_\_\_

Work Order No: \_\_\_\_\_

Meter Set. Ins. is on

O.H. Order

DD

Stake 01-03-13 70

OTHER:

\*\*\*\*\*  
METER TEST DUE 12/05/33  
LAST TESTED 12/05/08

	OLD	NEW
* MULT BY	00001	_____
* MAKER'S NO.	JP002367	_____
* SIZE	300	_____
* METER READ	_____	_____
* AMI MTR ADR	_____	_____

\*\*\*\*\*  
TAILGATE DISCUSSION

Crew Leader: DD Unit#: 17

No. Of Crew Members: \_\_\_\_\_ Date: 1-15

Names: ET DG BH

JS JG

Comments

Unusual Conditions: \_\_\_\_\_

Existing Hazards: \_\_\_\_\_

Work Procedures: \_\_\_\_\_

Energy Source Controls: \_\_\_\_\_

PPE: \_\_\_\_\_

Traffic Control: \_\_\_\_\_

Rescue: \_\_\_\_\_

*DD  
1/16/13  
AC*

JACKSON PURCHASE E.C. (MATERIAL PICKING SLIP) A/O 1/04/13  
 WORK ORDER C130035 W.I.P. ACCT. NO. 107.200 W/O DATE 1/04/13  
 CONSUMER DATA : ACCOUNT NO. 05545001 NAME COLLINS/ROY  
 BUILT BY CO-OP X CONTRACTOR WAREHOUSE 01 UNIT \_\_\_\_\_ INITIALS \_\_\_\_\_

4316 1/0 URD TPX SER	QTY =	114	ACTUAL TIME	_____	<b>Crew</b>
651 CABLE, SEC - 1/0 TPX URD		1.191	115	_____ T	<b>Copy</b>
5700 UM 5	QTY =	1	ACTUAL TIME	_____	
485 SCREW, LAG		.464	8	_____ T	
686 SHIELD, RISER 8' (3")		38.120	3	_____ T	

----- OTHER ISSUES -----  
 ITM # DESCRIPTION AVERAGE QTY RETURNS LOCATION



JACKSON PURCHASE E.C. (MATERIAL PICKUP SLIP) A/O 1/04/13  
 WORK ORDER C130035 W.I.P. ACCT. NO. 107.200 W/O DATE 1/04/13  
 CONSUMER DATA : ACCOUNT NO. 05545001 NAME COLLINS/ROY

BUILT BY CO-OP X CONTRACTOR WAREHOUSE 01 UNIT LT INITIALS JG  
 4316 1/0 URD TPX SER QTY = 114 ACTUAL TIME 1/15/12

651 CABLE, SEC - 1/0 TPX URD 1.191 115 T **Warehouse**

5700 UM 5 QTY = 1 ACTUAL TIME **Copy**

485 SCREW, LAG .464 8 T

686 SHIELD, RISER 8' (3") 38.120 3 T

----- OTHER ISSUES -----

ITEM #	DESCRIPTION	AVERAGE	QTY	RETURNS	LOCATION

*cl-15-13  
RW*