

RECEIVED

JUN 26 2007
PUBLIC SERVICE
COMMISSION

CELLCO PARTNERSHIP D/B/A verizon wireless

MYNHIER

1050 MCBRAYER RD
ROWAN COUNTY
MOREHEAD, KENTUCKY 40351

PROPOSED 290' SELF-SUPPORT TOWER WITH MULTIPLE CARRIERS

UTILITY PROTECTION NOTE

THE CONTRACTOR'S ATTENTION IS DIRECTED TO THE UTILITY PROTECTION CENTER, WHICH IS LOCATED AT THE CORNER OF MCBRAYER RD AND HOLLOWAY RD. THE CONTRACTOR SHALL NOTIFY THE UTILITY PROTECTION CENTER 48 HOURS IN ADVANCE OF ANY CONSTRUCTION ON THIS PROJECT. ALL NEW SERVICE AND GROUNDING TRENCHES PROVIDE A WARNING TAPE 12 INCHES ABOVE THE UNDERGROUND INSTALLATION (SEE NEC 300.5).

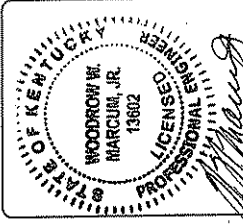

SITE NAME:	MYNHIER
SITE ADDRESS:	1050 MCBRAYER RD MOREHEAD, KY 40351
LATITUDE:	38° 08' 19.57" N
LONGITUDE:	83° 26' 23.58" W
LEASE AREA:	5,000 SQ. FT.
TOWER TYPE:	SELF-SUPPORT
TOWER HEIGHT:	290'

NO.	REVISION/ISSUE	DATE
1	ISSUE FOR COMMENT	5/24/07
2	ISSUE FOR CONST	6/22/07

TITLE SHEET

T-1

SHEET NO.	DESCRIPTION
T-1	TITLE SHEET
ARCHITECTURAL	
C-2	OVERALL SITE LAYOUT
C-3	SITE LAYOUT
C-4	NORTH & SOUTH ELEVATIONS
C-5	EAST & WEST ELEVATIONS
C-6	GRADING & EROSION CONTROL PLAN
C-6A-0	ROADWAY PLANS
C-7	NOTES & ICE BRIDGE DETAIL
C-8	FOUNDATION DETAILS & NOTES
C-9	FENCE & SIGNAGE DETAILS
ELECTRICAL	
E-1	GROUNDING & CONDUIT ROUTING
E-1A	UTILITY CONDUIT ROUTING
E-2	EQUIPMENT GROUNDING PLAN
E-3	10' UTILITY H-FRAME
E-4	POLYPHASE DETAIL
E-5	GPS ANTENNA DETAILS
E-6	ELECTRICAL & GROUNDING NOTES

POLICE DEPARTMENT PHONE: (606) 784-5446
FIRE DEPARTMENT PHONE: (606) 783-1139
ELECTRIC COMPANY KENTUCKY UTILITIES PHONE: (606) 563-8446 EXT. 20 CONTACT: MICHAEL STITT
TELEPHONE COMPANY WINDSTREAM PHONE: (606) 784-5051 CONTACT: RICK OCHSNER

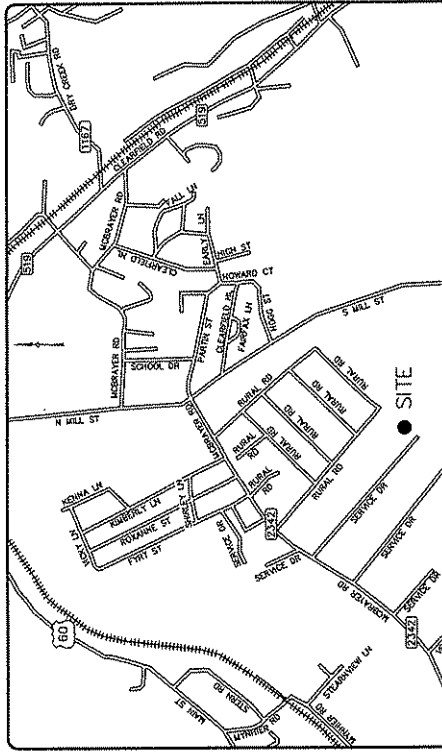

VICINITY MAP SCALE: NONE

DIRECTIONS TO SITE

DIRECTIONS FROM COUNTY SEAT: IN MOREHEAD STARTING AT THE CORNER OF SR 32 AND US 60 (FLEMINGSBURG RD), PROCEED SOUTH ON US 60 APPROX. 0.3 MILE TO SR 519 (CLEARFIELD RD) TURN LEFT, CONTINUE ON SR 519 (CLEARFIELD RD) APPROX. 0.5 MILE TO A MILE TO N HELL ST TURN LEFT, FOLLOW N HELL ST TO A SERVICE DR TURN LEFT, FOLLOW SERVICE DR TO SITE ON LEFT AT THE END OF THE DRIVE.

DIRECTIONS FROM LOUISVILLE: VERMON WIRELESS MTRCO. STARTING AT 2441 HOLLOWAY RD, GO TO PLANTSIDE DR TURN LEFT, PROCEED APPROX. 0.3 MILE TO BLANKENBAKER Pkwy TURN RIGHT, PROCEED ON BLANKENBAKER Pkwy APPROX. 0.7 MILE TO I-64 TURN RIGHT (EAST), CONTINUE EAST ON I-64 APPROX. 10.4 MILES (EXIT 137) TO SR 32 (FLEMINGSBURG RD) TURN RIGHT, PROCEED ON SR 32 (FLEMINGSBURG RD) APPROX. 0.3 MILE TO SR 519 (CLEARFIELD RD) TURN LEFT, CONTINUE ON SR 519 (CLEARFIELD RD) APPROX. 0.5 MILE TO A MILE TO N HELL ST TURN LEFT, FOLLOW N HELL ST TO A SERVICE DR TURN LEFT, FOLLOW SERVICE DR TO SITE ON LEFT AT THE END OF THE DRIVE.

REGION MAP SCALE: NONE

BTM
BTM ENGINEERING, INC.
3001 TAYLOR SPRINGS DR
LOUISVILLE, KENTUCKY 40220
(502) 459-8402 PHONE
(502) 459-8427 FAX

DESIGN ENGINEER

F.S. Land Company
T. Alan Neal Company

F.S. LAND
Land Surveyors and Consulting Engineers
PO Box 17546, Louisville, KY 40220
Phone: (502) 586-5800
Fax: (502) 586-5283

SURVEYOR

verizon wireless
 2441 HOLLOWAY RD
 LOUISVILLE, KY 40288
 PHONE (502) 552-0330
 FAX (502) 266-7548

BTM
 BTM ENGINEERING, INC.
 3901 TAYLOR SPRINGS DR
 LOUISVILLE, KENTUCKY 40220
 PHONE (502) 459-8402
 FAX (502) 459-8427

STATE OF KENTUCKY
 WOODROW W. MARCUM, JR.
 13802
 LICENSED PROFESSIONAL ENGINEER

SITE NAME: MTHHER
 SITE ADDRESS: 050 MCRAVER RD
 MOREHEAD, KY 40351
 ELEVATION: 587.00
 LONGITUDE: 83.26 23.58 W
 LEASE AREA: 5,000 SQ. FT.
 TOWER TYPE: SELF-SUPPORT
 TOWER HEIGHT: 290'

NO.	REVISION/ISSUE	DATE
1	ISSUE FOR COMMENT	5/24/07
2	ISSUE FOR CONST	6/22/07

TITLE: ROADWAY PLANS
 SHEET: C-6B

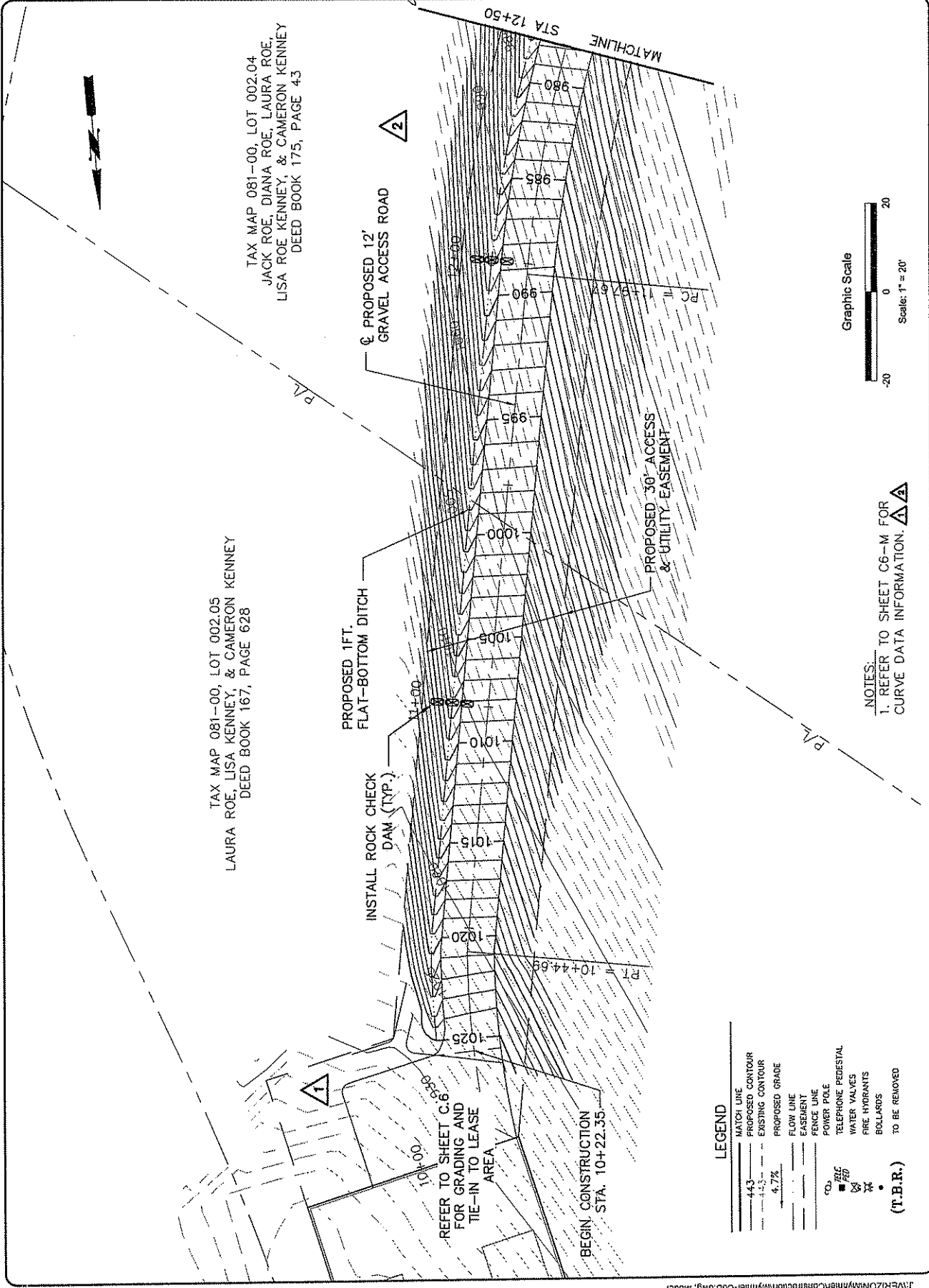

- LEGEND**
- MATCH LINE
 - 44.3' PROPOSED CONTOUR
 - EXISTING CONTOUR
 - 4.7% PROPOSED GRADE
 - FLOW LINE
 - EASEMENT
 - FENCE LINE
 - POWER POLE
 - TELEPHONE PEDESTAL
 - WATER VALVES
 - FIRE HYDRANTS
 - BOLLARDS
 - TO BE REMOVED
- (T.B.R.)

verizon wireless
 2441 HOLLOWAY RD
 LOUISVILLE, KY 40299
 PHONE (502) 552-0330
 FAX (502) 266-7518

BTM
 BTM ENGINEERING, INC.
 3001 TAYLOR SPRINGS DR
 LOUISVILLE, KENTUCKY 40220
 PHONE (502) 459-6802
 FAX (502) 459-6827

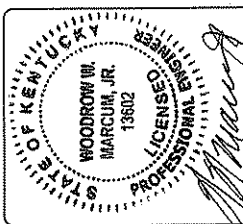

SITE NAME: *ATVNHIER*
 SITE ADDRESS: 1050 MCBRAYER RD
 MOREHEAD, KY 40351
 LATITUDE: 38° 08' 19.57" N
 LONGITUDE: 83° 26' 23.38" W
 LEASE AREA: 5,000 SQ. FT.
 TOWER TYPE: SELF-SUPPORT
 TOWER HEIGHT: 290'

NO.	REVISION/ISSUE	DATE
1	ISSUE FOR COMMENT	5/24/07
2	ISSUE FOR CONST	6/22/07

TITLE: ROADWAY PLANS

SHEET: C-6C

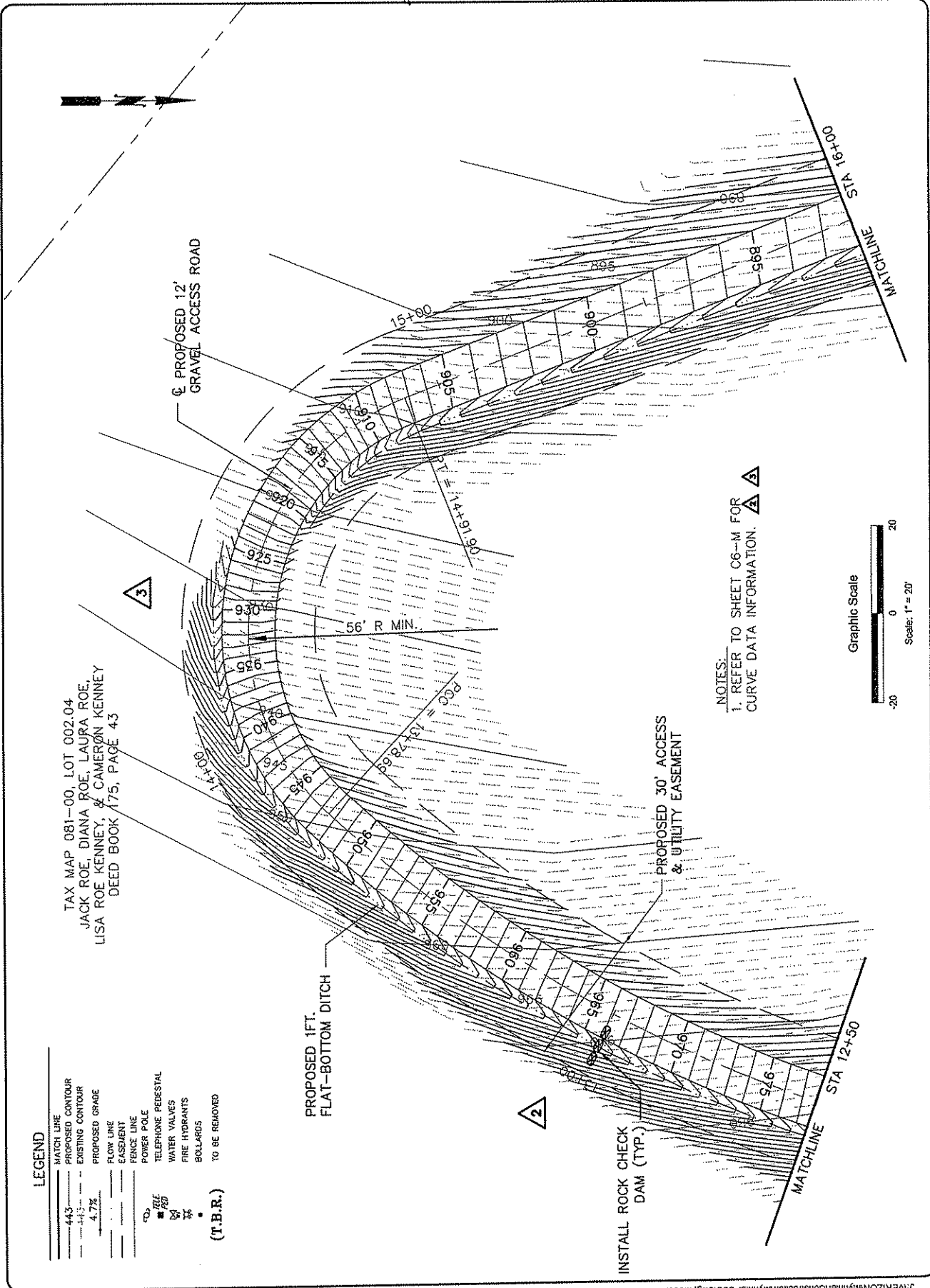

TAX MAP 081-00, LOT 002.04
 JACK ROE, DIANA ROE, LAURA ROE,
 LISA ROE KENNEY, & CAMERON KENNEY
 DEED BOOK 175, PAGE 43

LEGEND

- MATCH LINE
- PROPOSED CONTOUR
- EXISTING CONTOUR
- PROPOSED GRADE
- 4.7%
- FLOW LINE
- EASEMENT
- FENCE LINE
- POWER POLE
- TELEPHONE PEDESTAL
- WATER VALVES
- FIRE HYDRANTS
- BOLLARDS
- TO BE REMOVED
- (T.B.R.)

NOTES:
 1. REFER TO SHEET C6-M FOR
 CURVE DATA INFORMATION.

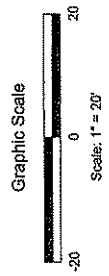



2441 HOLLOWAY RD
LOUISVILLE, KY 40299
PHONE (502) 552-0330
FAX (502) 266-7548

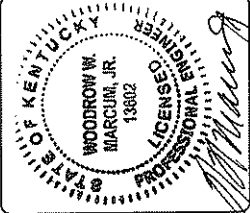

SITE NAME: MARNIER
SITE ADDRESS: 1050 McBRAYER RD
MOREHEAD, KY 40355
LATITUDE: 37° 09' 19.57" N
LONGITUDE: 83° 26' 23.58" W
LEASE AREA: 5,000 SQ. FT.
TOWER TYPE: SELF-SUPPORT
TOWER HEIGHT: 296'

NO.	REVISION/ISSUE	DATE
1	ISSUE FOR COMMENT	5/24/07
2	ISSUE FOR CONST	6/22/07

TITLE: ROADWAY PLANS

SHEET: C-6D

TAX MAP 081-00, LOT 002.04
JACK ROE, DIANA ROE, LAURA ROE,
LISA ROE KENNEY, & CAMERON KENNEY
DEED BOOK 175, PAGE 43

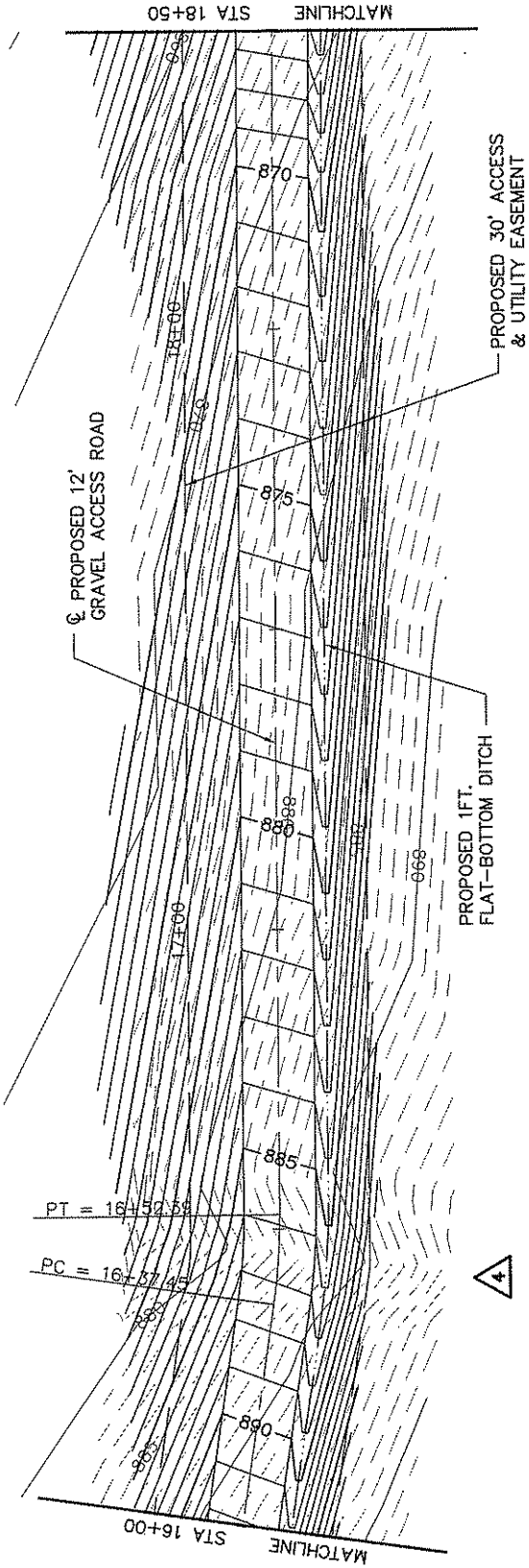

LEGEND

- MATCH LINE
- PROPOSED CONTOUR
- EXISTING CONTOUR
- PROPOSED GRADE
- FLOW LINE
- EASEMENT
- FENCE LINE
- POWER POLE
- TELEPHONE PEDESTAL
- WATER VALVES
- FIRE HYDRANTS
- BOLLARDS
- TO BE REMOVED

(T.B.R.)

NOTES:
1. REFER TO SHEET C6-M FOR CURVE DATA INFORMATION.

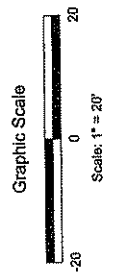

verizon wireless
 2441 HOLLOWAY RD
 LOUISVILLE, KY 40299
 PHONE (502) 552-0330
 FAX (502) 266-7548

BTA
 BTA ENGINEERING, INC.
 3001 TAYLOR SPRINGS DR
 LOUISVILLE, KENTUCKY 40220
 PHONE (502) 459-8402
 FAX (502) 459-8427

STATE OF KENTUCKY
 WOODROW W. MARCUM, JR.
 13802
 LICENSED PROFESSIONAL ENGINEER

SITE NAME: HYNHIER
 SITE ADDRESS: 1050 MCBRYER RD
 MCHESNEY, KY 40351
 LATITUDE: 38° 09' 19.57" N
 LONGITUDE: 83° 26' 23.55" W
 LEASE AREA: 5,000 SQ. FT.
 TOWER TYPE: SELF-SUPPORT
 TOWER HEIGHT: 290'

NO.	REVISION / ISSUE	DATE
1	ISSUE FOR COMMENT	5/24/07
2	ISSUE FOR CONST.	6/22/07

TITLE:
 ROADWAY PLANS

SHEET:
 C-6E

TAX MAP 081-00, LOT 002.04
 JACK ROE, DIANA ROE, LAURA ROE
 LISA ROE KENNEY, & CAMERON KENNEY
 DEED BOOK 175, PAGE 43

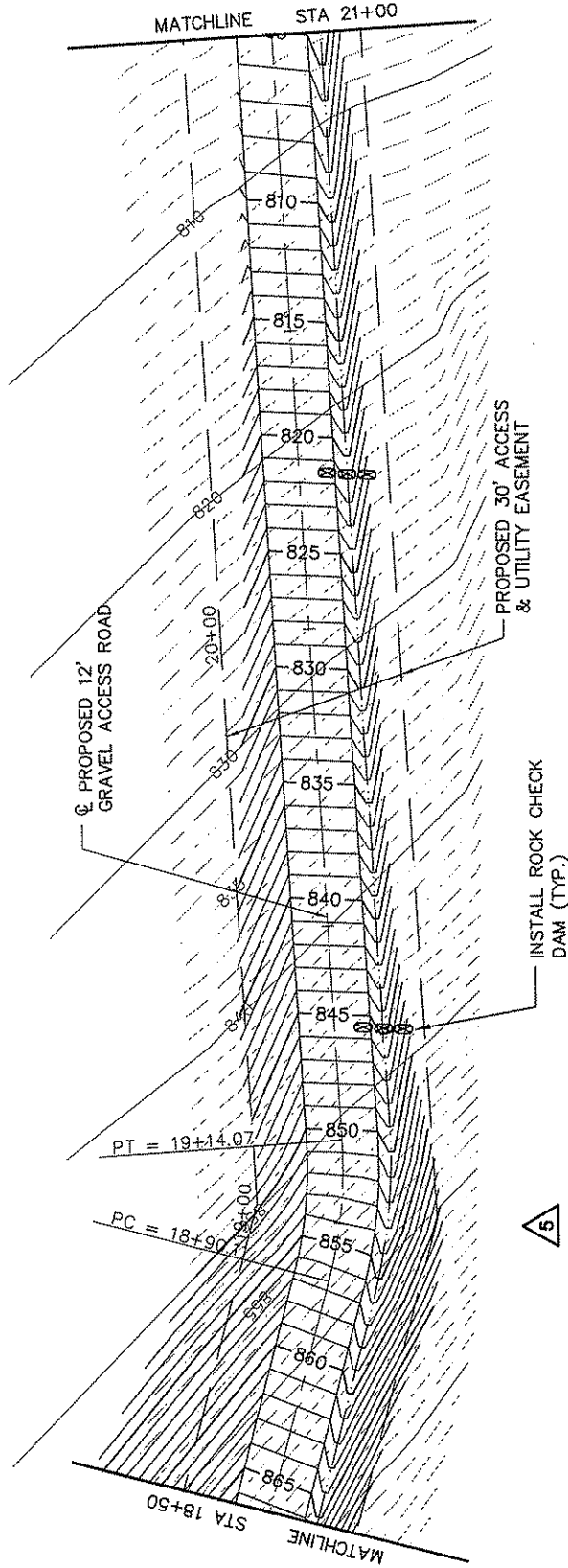

Graphic Scale



NOTES:
 1. REFER TO SHEET C6-M FOR
 CURVE DATA INFORMATION.

LEGEND

- MATCH LINE
- 4.4% PROPOSED CONTOUR
- 4.7% EXISTING CONTOUR
- 4.7% PROPOSED GRADE
- FLOW LINE
- EASEMENT
- FENCE LINE
- POWER POLE
- ☐ TELEPHONE REPEATER
- ☒ WATER VALVES
- ☒ FIRE HYDRANTS
- ☒ BOLLARDS
- TO BE REMOVED

(T.B.R.)

2441 HOLLOWAY RD
LOUISVILLE KY 40299
PHONE (502) 552-0330
FAX (502) 266-7548

BT
BT ENGINEERING, INC.
3090 WOODS DR
LOUISVILLE, KENTUCKY 40220
PHONE (502) 459-8402
FAX (502) 459-8427

STATE OF KENTUCKY
WOODROW W. MARCUM, JR.
13802
LICENSED PROFESSIONAL ENGINEER

SITE NAME:	MYNHER
SITE ADDRESS:	1050 LOCUSTVIEW RD HOBOKEN, NJ 07030
LATITUDE:	38° 09' 19.57" N
LONGITUDE:	67° 26' 23.56" W
LEASE AREA:	5,000 SQ. FT.
TOWER TYPE:	SELF-SUPPORT
TOWER HEIGHT:	290'

NO.	REVISION/ISSUE	DATE
1	ISSUE FOR COMMENT	5/24/07
2	ISSUE FOR CONST	6/22/07

TITLE: ROADWAY PLANS
SHEET: C-6F

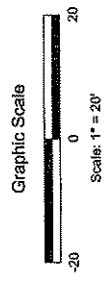
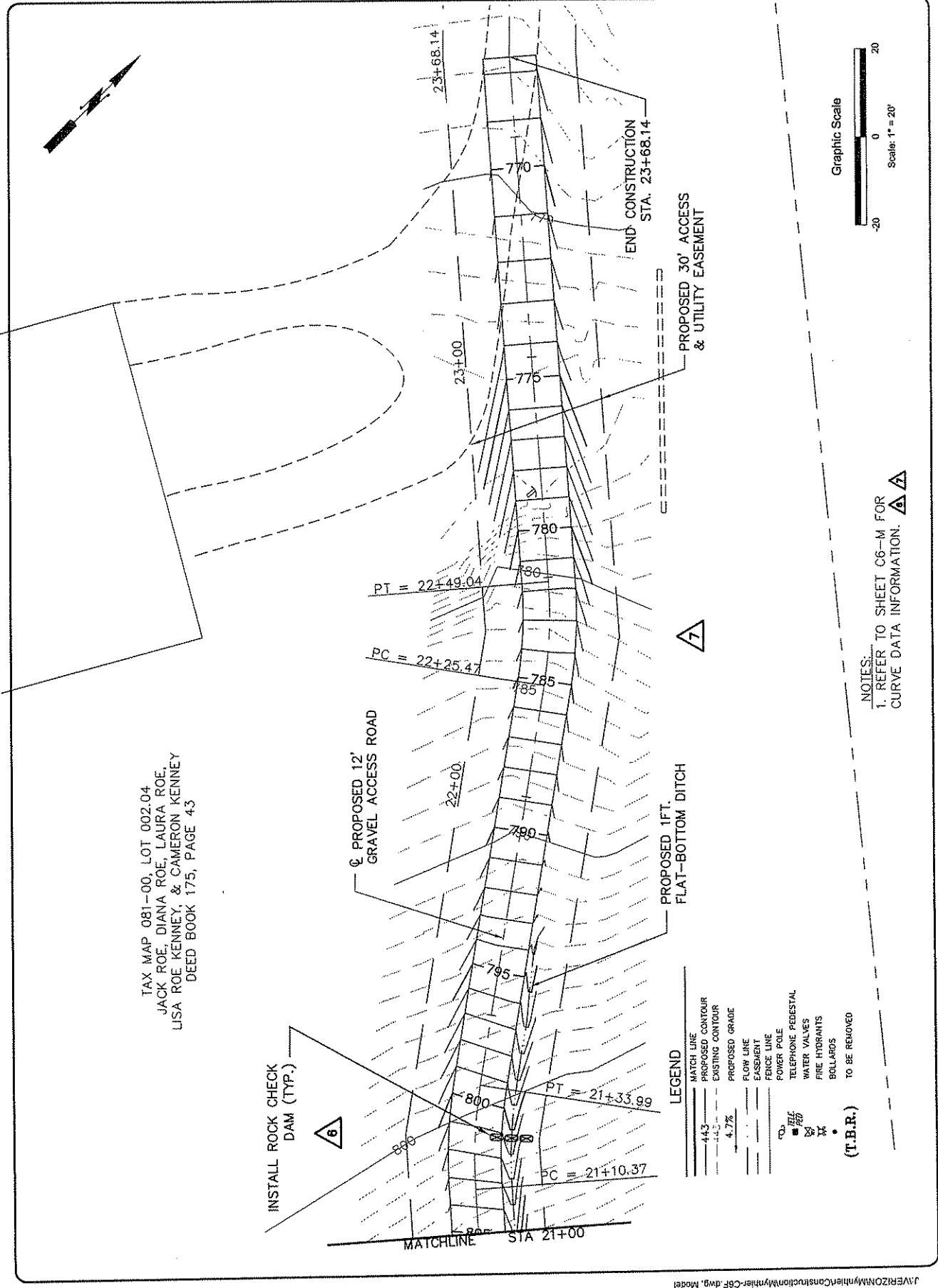

NOTES:
1. REFER TO SHEET C6-M FOR CURVE DATA INFORMATION.

LEGEND

- MATCH LINE
- PROPOSED CONTOUR
- EXISTING CONTOUR
- PROPOSED GRADE
- FLOW LINE
- EASEMENT
- FENCE LINE
- POWER POLE
- TELEPHONE PEDESTAL
- WATER VALVES
- FIRE HYDRANTS
- BOLLARDS
- TO BE REMOVED

(T.B.R.)

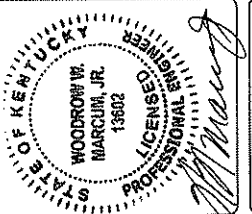
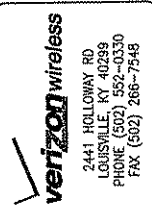

SITE NAME: MYRHER
 SITE ADDRESS: 264 WOODWAY RD, MOREHEAD, KY 40351
 LATITUDE: 38° 08' 19.97" N
 LONGITUDE: 83° 29' 23.95" W
 LEASE AREA: 5,000 SQ. FT.
 TOWER TYPE: SELF-SUPPORT
 TOWER HEIGHT: 290'

NO.	REVISION/ISSUE	DATE
1	ISSUE FOR COMMENT	5/24/07
2	ISSUE FOR CONST	6/22/07

TITLE: ROADWAY PLANS

SHEET: C6-C

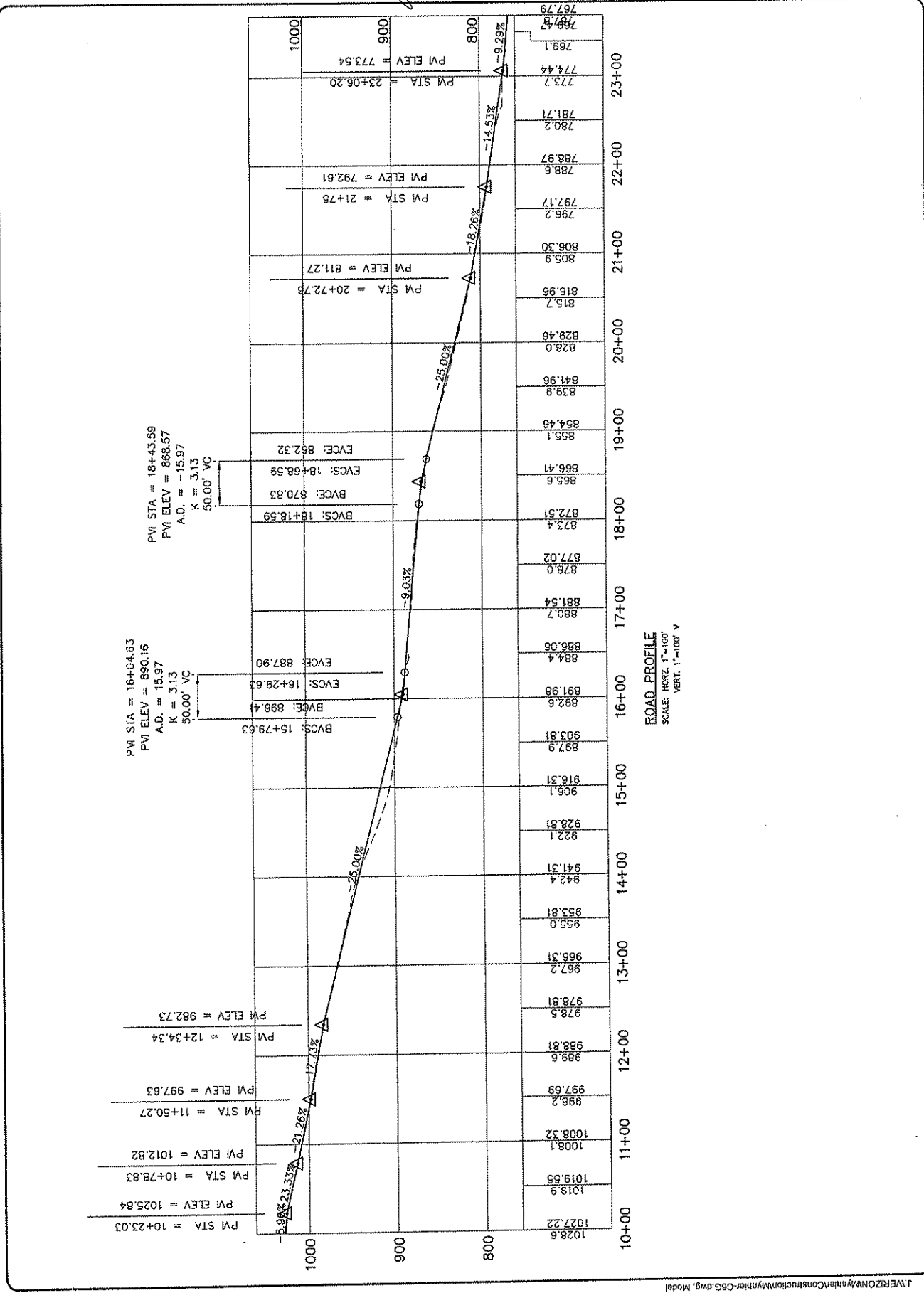

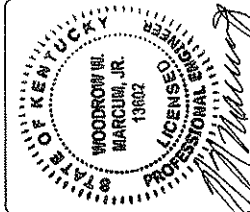
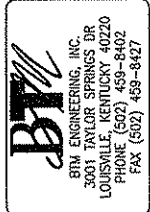

SITE NAME: MYRRIER
 SITE ADDRESS: 1060 McSWAY RD, MOREHEAD, KY 40351
 LATITUDE: 38° 09' 19.57" N
 LONGITUDE: 83° 26' 23.98" W
 LEASE AREA: 5,000 SQ. FT.
 TOWER TYPE: SELF-SUPPORT
 TOWER HEIGHT: 290'

NO.	REVISION/ISSUE	DATE
1	ISSUE FOR COMMENT	5/24/07
2	ISSUE FOR CONST	6/22/07

TITLE: ROADWAY PLANS

SHEET: C6-H

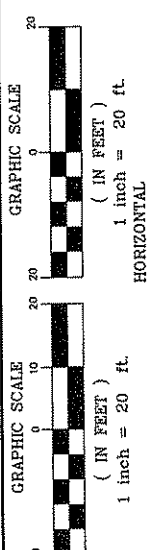
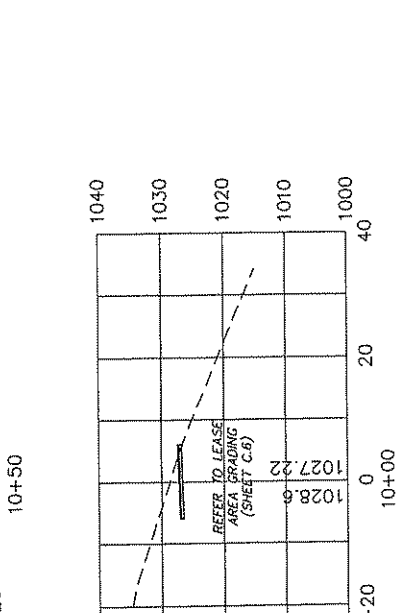
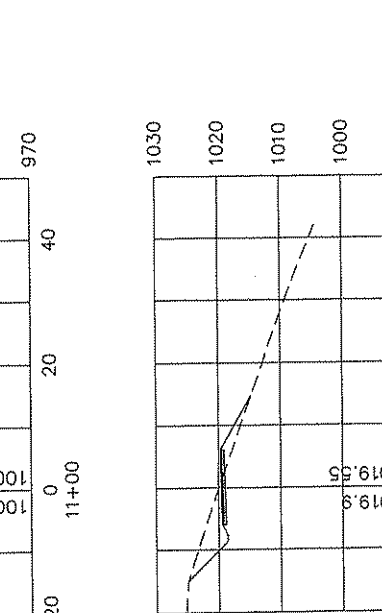
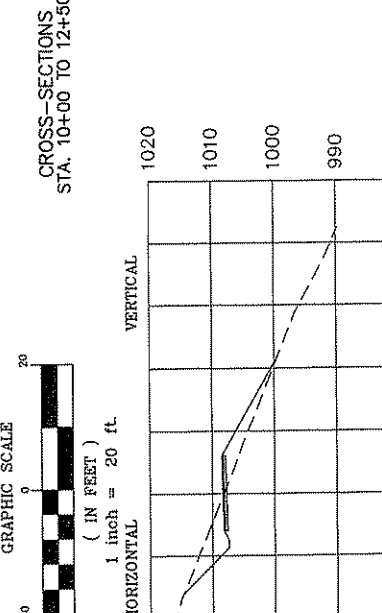
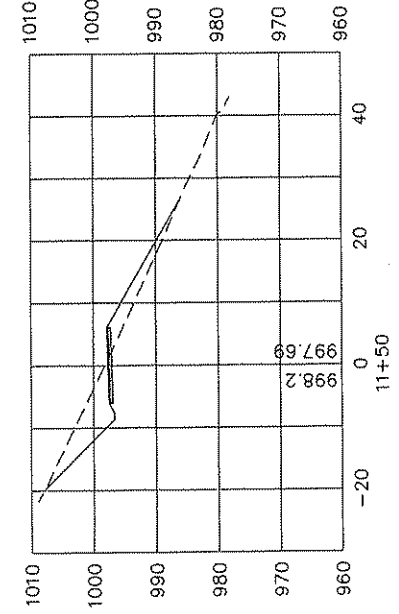
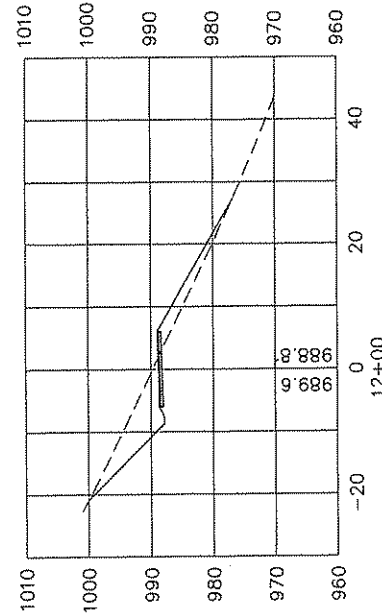
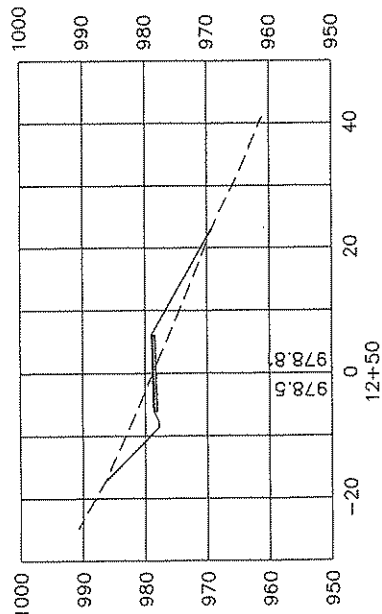

CROSS-SECTIONS
 STA. 10+00 TO 12+50

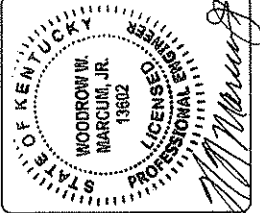
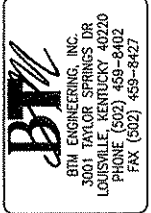

SITE NAME: WINNER

SITE ADDRESS: 1050 MCBRYER RD MOREHEAD, KY 40351

LATITUDE: 38° 09' 18.57" N
LONGITUDE: 83° 26' 22.58" W

LEASE AREA: 5,000 SQ. FT.

TOWER TYPE: SELF-SUPPORT

TOWER HEIGHT: 290'

NO.	REVISION/ISSUE	DATE
1	ISSUE FOR COMMENT	5/24/07
2	ISSUE FOR CONST	6/22/07

TITLE: ROADWAY PLANS

SHEET: C6-1

CROSS-SECTIONS
STA. 13+00 TO 18+50

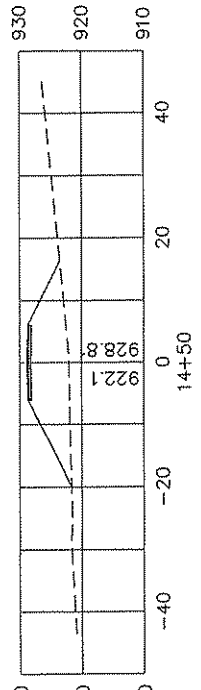
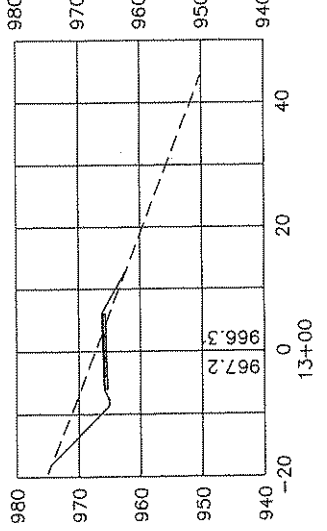
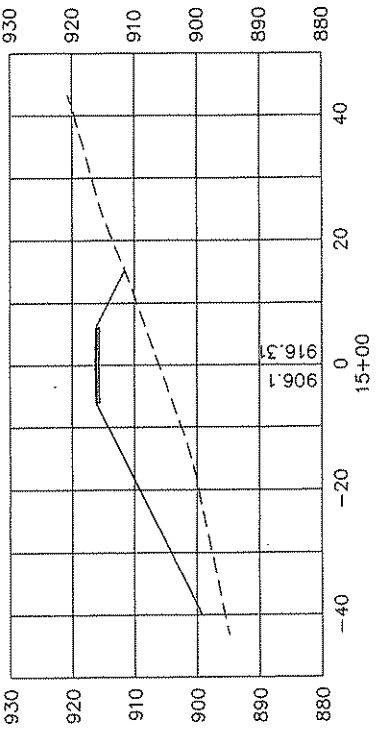
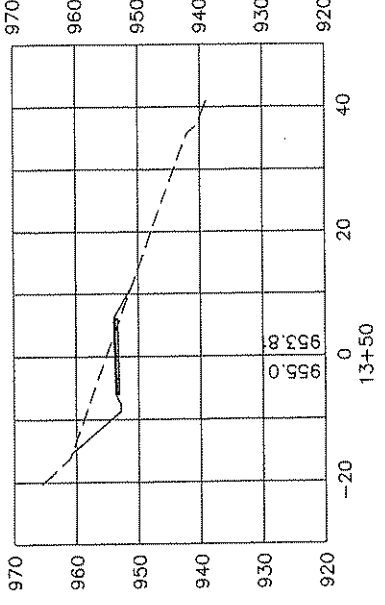
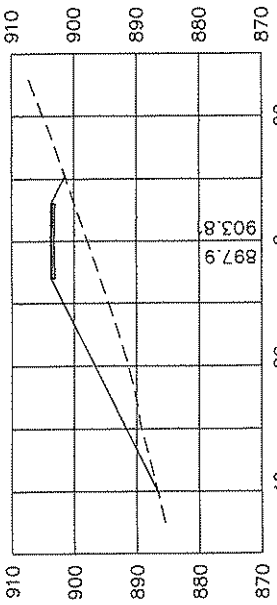
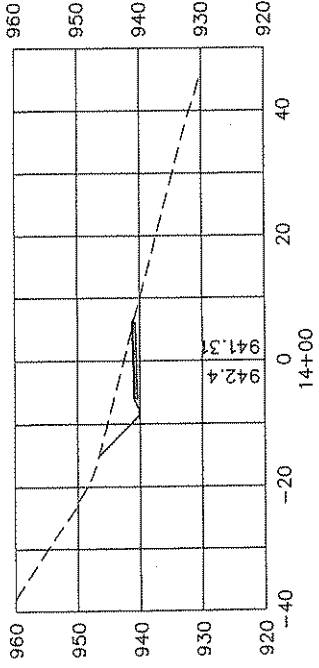
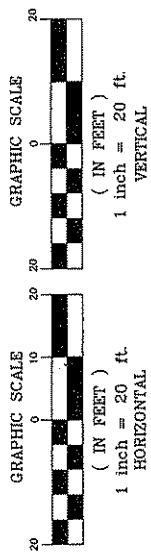

verizon wireless
 2441 HOLLOWAY RD
 LOUISVILLE, KY 40289
 PHONE (502) 552-0330
 FAX (502) 266-7548

BTM
 BTM ENGINEERS, INC.
 3001 TAYLOR SPRINGS DR
 LOUISVILLE, KENTUCKY 40220
 PHONE (502) 459-8402
 FAX (502) 459-8427

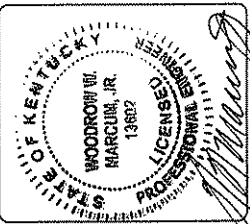

SITE NAME: NYNEX
 SITE ADDRESS: 1650 MCRAVER RD
 MORGANTOWN, KY 40351
 LATITUDE: 38° 09' 19.57" N
 LONGITUDE: 83° 25' 23.88" W
 LEASE AREA: 5,000 SQ. FT.
 TOWER TYPE: SELF-SUPPORT
 TOWER HEIGHT: 280'

NO.	REVISION/ISSUE	DATE
1	ISSUE FOR COMMENT	5/24/07
2	ISSUE FOR CONST	6/22/07

TITLE: ROADWAY PLANS
 SHEET: C6-J

CROSS-SECTIONS
 STA. 16+00 TO 18+50

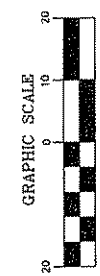
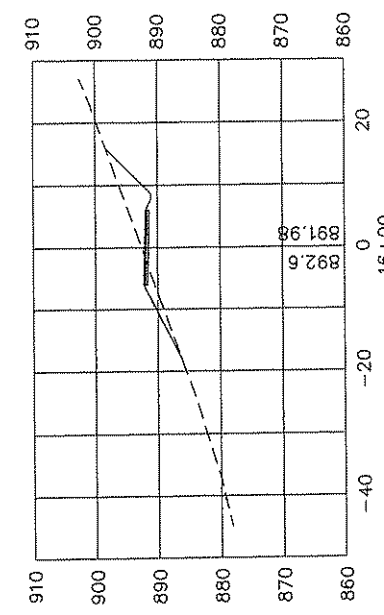
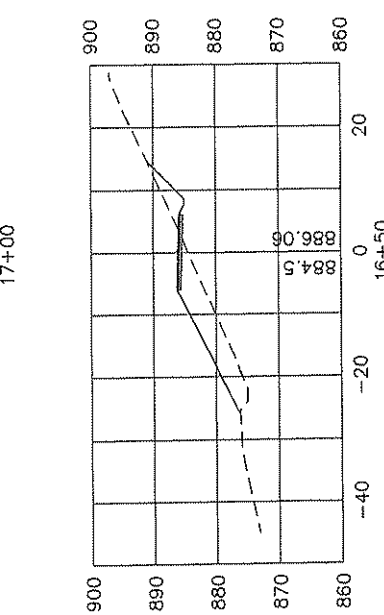
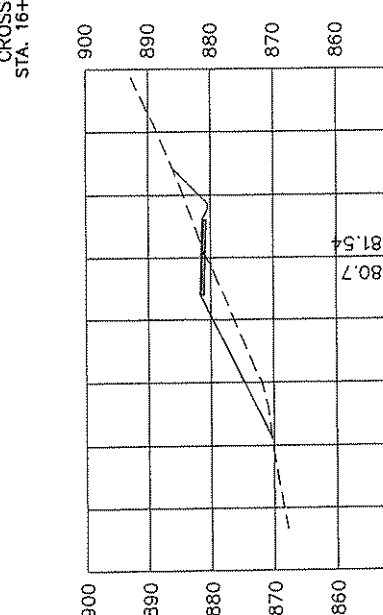
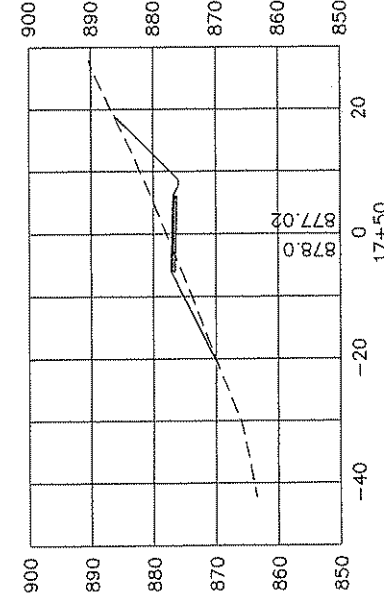
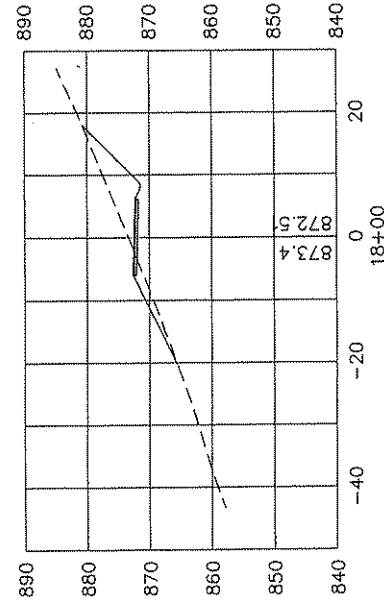
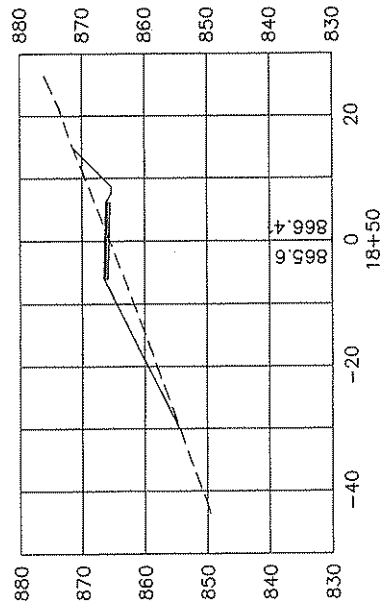

verizon wireless
 2441 HOLLOWAY RD
 LOUISVILLE, KY 40299
 PHONE (502) 552-0330
 FAX (502) 266-7548

BTE
 BTE ENGINEERS INC
 3901 FAYOR SPRINGS DR
 LOUISVILLE, KENTUCKY 40220
 PHONE (502) 459-8493
 FAX (502) 459-8427

STATE OF KENTUCKY
 WOODROW W. MARGUM, JR.
 13802
 LICENSED PROFESSIONAL ENGINEER

SITE NAME: KYNH08

SITE ADDRESS: 1050 MCBRYNER RD
 MOREHEAD, KY 40351

LATITUDE: 38° 09' 19.57" N
 LONGITUDE: 83° 26' 23.58" W

LEASE AREA: 5,000 SQ. FT.

TOWER TYPE: SELF-SUPPORT

TOWER HEIGHT: 290'

NO.	REVISION/ISSUE	DATE
1	ISSUE FOR COMMENT	5/24/07
2	ISSUE FOR CONST	9/22/07

TITLE: ROADWAY PLANS

SHEET: C6-K

CROSS-SECTIONS
 STA. 19+00 TO 22+00

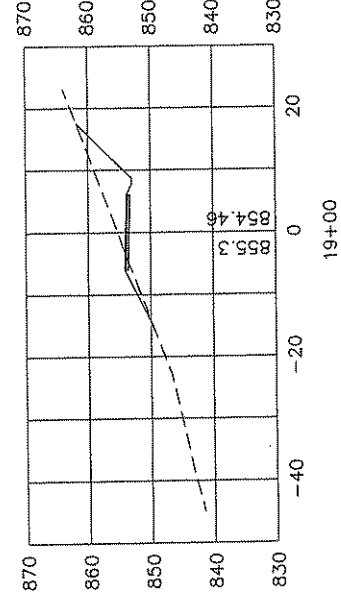
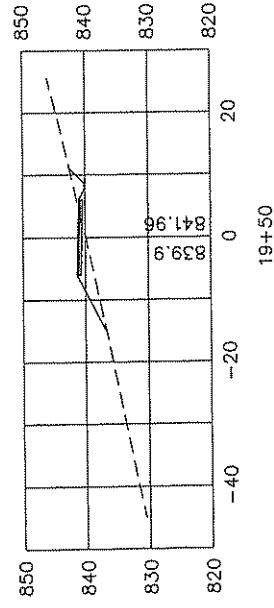
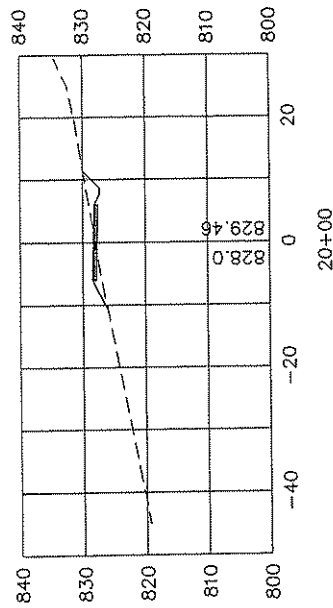
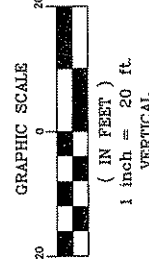
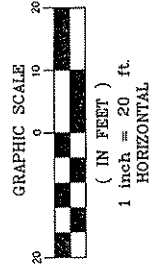
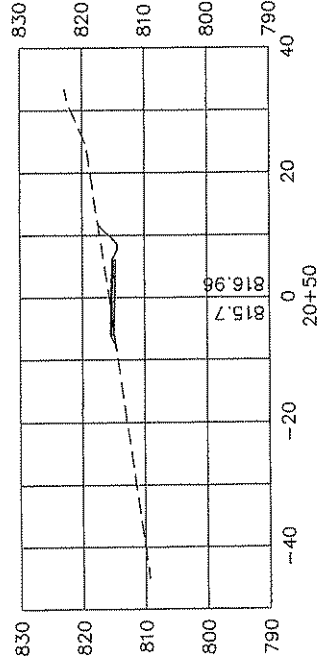
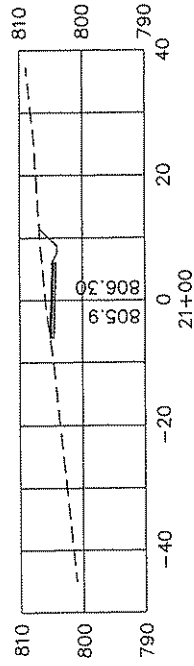
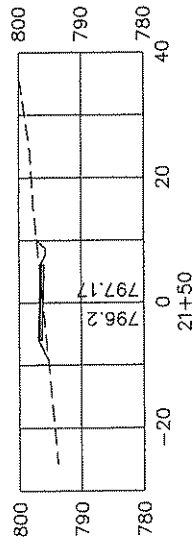
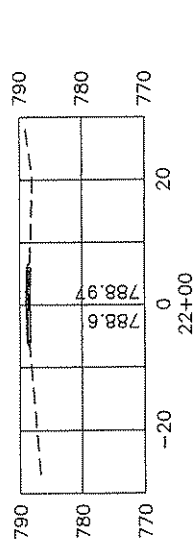

verizon wireless
 2441 HOLLOWAY RD
 LOUISVILLE, KY 40299
 PHONE (502) 552-0330
 FAX (502) 268-7548

BTM
 BTM ENGINEERS, INC.
 3001 HILOR SPRINGS DR
 LOUISVILLE, KENTUCKY 40220
 PHONE (502) 659-8402
 FAX (502) 459-8427

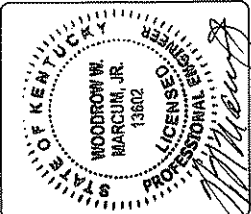

SITE NAME: HYNHIER
 SITE ADDRESS: 1050 MCBRAVER RD
 MOREHEAD, KY 40351
 LATITUDE: 38° 08' 19.57" N
 LONGITUDE: 83° 26' 23.98" W
 LEASE AREA: 5,000 SQ. FT.
 TOWER TYPE: SELF-SUPPORT
 TOWER HEIGHT: 290'

NO.	REVISION/ISSUE	DATE
1	ISSUE FOR COMMENT	5/24/07
2	ISSUE FOR CONST	6/22/07

TITLE: ROADWAY PLANS

SHEET: C6-L

CROSS-SECTIONS
 STA. 22+50 TO END

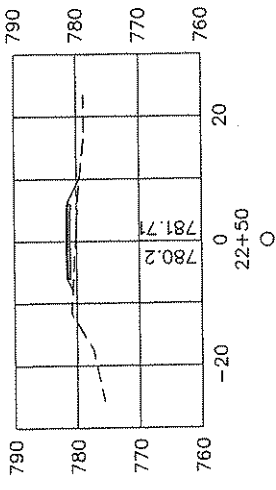
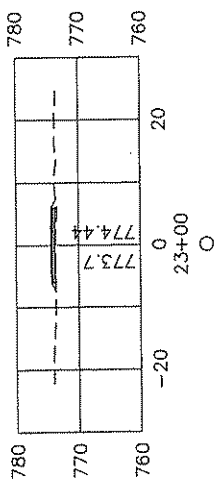
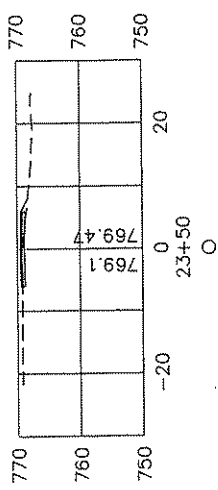
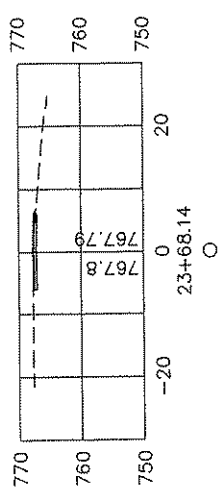



2441 HOLLOWAY RD
LOUISVILLE, KY 40299
PHONE (502) 552-0330
FAX (502) 266-7548

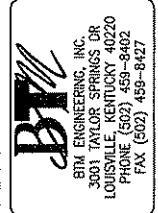

BTM ENGINEERING, INC.
3001 FAYARD SPRINGS DR
LOUISVILLE, KENTUCKY 40220
PHONE (502) 459-8402
FAX (502) 459-8427

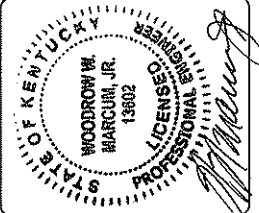

SITE NAME: KYRHEB

SITE ADDRESS: 1030 HICKEY RD
MOREHEAD, KY 40351

LATITUDE: 38° 09' 19.57" N
LONGITUDE: 83° 26' 23.95" W

LEASE AREA: 5,000 SQ. FT.

TOWER TYPE: SELF-SUPPORT

TOWER HEIGHT: 290'

NO.	REVISION/ISSUE	DATE
1	ISSUE FOR COMMENT	5/14/07
2	ISSUE FOR CONST	6/22/07

TITLE: ROADWAY PLANS
SHEET: C6-M

CURVE DATA

Horizontal Alignment Station and Curve Report.

Alignment: P-80-CL Centerline

Desc: Proposed Road

Desc.	Station	Spiral/Curve Data	Northing	Easting
PI	10+40	Length: 0.000 Course: S 90-00-00 E	1907414.8055	
PC	10+40	Length: 22.432 Course: S 07-55-07 E	1907414.8055	
CC	10+40	Delta: 97-55-07		
PT	10+40	Length: 22.432 Course: S 04-26-53 W	1907417.8959	

Desc.	Station	Spiral/Curve Data	Northing	Easting
PI	10+44.69	Length: 12-29-00 Type: 12-29-00	1907414.8055	
PC	10+44.69	Length: 207.036 Type: 207.036	1907414.8055	
CC	10+44.69	Radius: 44.680 Tangent: 27-40-18		
PT	10+44.69	Length: 207.036 Type: 207.036	1907416.1582	

Desc.	Station	Spiral/Curve Data	Northing	Easting
PI	10+44.69	Length: 22.432 Course: S 01-44-07 E	1907416.1582	
PC	10+44.69	Length: 246.009 Course: S 10-12-45 W	1907416.1582	
CC	10+44.69	Delta: 5-45-52		
PT	10+44.69	Length: 182.351 Course: S 43-46-20 W	1907372.5392	

Desc.	Station	Spiral/Curve Data	Northing	Easting
PI	12+90.70	Length: 32-33-35	1907372.5392	
PC	12+90.70	Length: 152.979 Course: S 10-12-45 W	1907372.5392	
CC	12+90.70	Delta: 11-49-57		
PT	12+90.70	Length: 202.275 Course: S 26-29-33 W	1907389.0333	

Desc.	Station	Spiral/Curve Data	Northing	Easting
PI	14+48.02	Length: 115-49-43	1907248.7071	
PC	14+48.02	Length: 242.353 Course: N 21-23-58 W	1907248.7071	
CC	14+48.02	Delta: 115-49-43		
PT	14+48.02	Length: 206.232 Course: N 21-23-58 W	1907248.7071	

Desc.	Station	Spiral/Curve Data	Northing	Easting
PI	13+78.68	Length: 115-49-43	1907248.7071	
PC	13+78.68	Length: 56.000 Course: N 102-18-50	1907248.7071	
CC	13+78.68	Radius: 113.209 Tangent: 89.321		
PT	13+78.68	Length: 26.294 External: 48.424		

Horizontal Alignment Station and Curve Report.

Alignment: P-80-CL Centerline

Desc: Proposed Road

Desc.	Station	Spiral/Curve Data	Northing	Easting
PI	16+44.94	Length: 8-33-48 Course: N 29-57-43 W	1907160.2820	
PC	16+44.94	Length: 257.268 Course: N 29-57-43 W	1907160.2820	
CC	16+44.94	Delta: 8-33-48		
PT	16+44.94	Length: 145.545 Course: N 21-23-56 W	1907163.0135	

Desc.	Station	Spiral/Curve Data	Northing	Easting
PI	16+43.77	Length: 145.545 Course: N 21-23-56 W	1907163.0135	
PC	16+43.77	Length: 2082468.7916	1907163.0135	
CC	16+43.77	Delta: 2082432.3058		
PT	16+43.77	Length: 2082468.7916	1907156.5431	

Desc.	Station	Spiral/Curve Data	Northing	Easting
PI	16+43.77	Length: 145.545 Course: N 21-23-56 W	1907156.5431	
PC	16+43.77	Length: 100.000 Type: 100.000	1907156.5431	
CC	16+43.77	Radius: 14.945 Tangent: 57-17-45		
PT	16+43.77	Length: 100.000 Type: 100.000	1907156.5431	

Desc.	Station	Spiral/Curve Data	Northing	Easting
PI	19+40.18	Length: 220.242 Course: N 48-15-42 W	1907031.7873	
PC	19+40.18	Length: 220.242 Course: N 48-15-42 W	1907031.7873	
CC	19+40.18	Delta: 18-17-59		
PT	19+40.18	Length: 237.720 Course: N 29-57-43 W	1907156.5431	

Desc.	Station	Spiral/Curve Data	Northing	Easting
PI	18+40.11	Length: 237.720 Course: N 29-57-43 W	1907031.7873	
PC	18+40.11	Length: 2082688.1985	1907031.7873	
CC	18+40.11	Delta: 2082650.7418		
PT	18+40.11	Length: 2082688.1985	1907037.8204	

Desc.	Station	Spiral/Curve Data	Northing	Easting
PI	19+14.07	Length: 76-23-40	1907037.8204	
PC	19+14.07	Length: 23.954 Tangent: 76-23-40	1907037.8204	
CC	19+14.07	Radius: 0.954 External: 0.957		
PT	19+14.07	Length: 23.954 Tangent: 76-23-40	1907022.7733	

Desc.	Station	Spiral/Curve Data	Northing	Easting
PI	21+42.23	Length: 115.176 Course: N 48-15-42 W	1906867.4445	
PC	21+42.23	Length: 115.176 Course: N 48-15-42 W	1906867.4445	
CC	21+42.23	Delta: 12-46-08		
PT	21+42.23	Length: 196.302 Course: N 48-15-42 W	1907022.7733	

Desc.	Station	Spiral/Curve Data	Northing	Easting
PI	21+10.37	Length: 196.302 Course: N 48-15-42 W	1906867.4445	
PC	21+10.37	Length: 2062837.3501	1906867.4445	
CC	21+10.37	Delta: 2062816.4866		
PT	21+10.37	Length: 2062837.3501	1906860.5584	

Desc.	Station	Spiral/Curve Data	Northing	Easting
PI	21+35.99	Length: 54-03-09	1906860.5584	
PC	21+35.99	Length: 12.46-06 Type: 12.46-06	1906860.5584	
CC	21+35.99	Radius: 106.000 Tangent: 54-03-09		
PT	21+35.99	Length: 12.46-06 Type: 12.46-06	1906860.5584	

Desc.	Station	Spiral/Curve Data	Northing	Easting
PI	21+43.99	Length: 91.478 Course: N 35-29-36 W	1906800.3722	
PC	21+43.99	Length: 91.478 Course: N 35-29-36 W	1906800.3722	
CC	21+43.99	Delta: 2062929.4215		
PT	21+43.99	Length: 2062929.4215	1906860.5584	

Desc.	Station	Spiral/Curve Data	Northing	Easting
PI	22+49.04	Length: 119.103 Course: N 48-50-47 W	1906701.7551	
PC	22+49.04	Length: 119.103 Course: N 48-50-47 W	1906701.7551	
CC	22+49.04	Delta: 2062946.8275		
PT	22+49.04	Length: 2062946.8275	1906726.0275	

Desc.	Station	Spiral/Curve Data	Northing	Easting
PI	22+49.04	Length: 119.103 Course: N 48-50-47 W	1906726.0275	
PC	22+49.04	Length: 15.30-11 Type: 15.30-11	1906726.0275	
CC	22+49.04	Radius: 100.000 Tangent: 57-17-45		
PT	22+49.04	Length: 15.30-11 Type: 15.30-11	1906791.6381	

Desc.	Station	Spiral/Curve Data	Northing	Easting
PI	23+68.14	Length: 119.103 Course: N 48-50-47 W	1906701.7551	
PC	23+68.14	Length: 119.103 Course: N 48-50-47 W	1906701.7551	
CC	23+68.14	Delta: 2062946.8275		
PT	23+68.14	Length: 2062946.8275	1906726.0275	

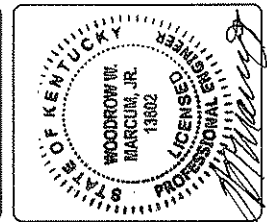
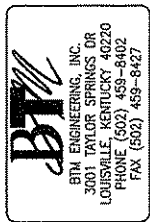

SITE NAME:	MYRHEE
SITE ADDRESS:	1050 MCBRYER RD, MOREHEAD, KY 40351
CARTITUDE:	35° 08' 19.57" N
LONGITUDE:	85° 26' 25.55" W
LEASE AREA:	5,000 SQ. FT.
TOWER TYPE:	SELF-SUPPORT
TOWER HEIGHT:	290'

NO.	REVISION/ISSUE	DATE
1	ISSUE FOR COMMENT	6/24/07
2	ISSUE FOR CONST	6/22/07

TITLE:	ROADWAY PLANS
SHEET:	C6-N

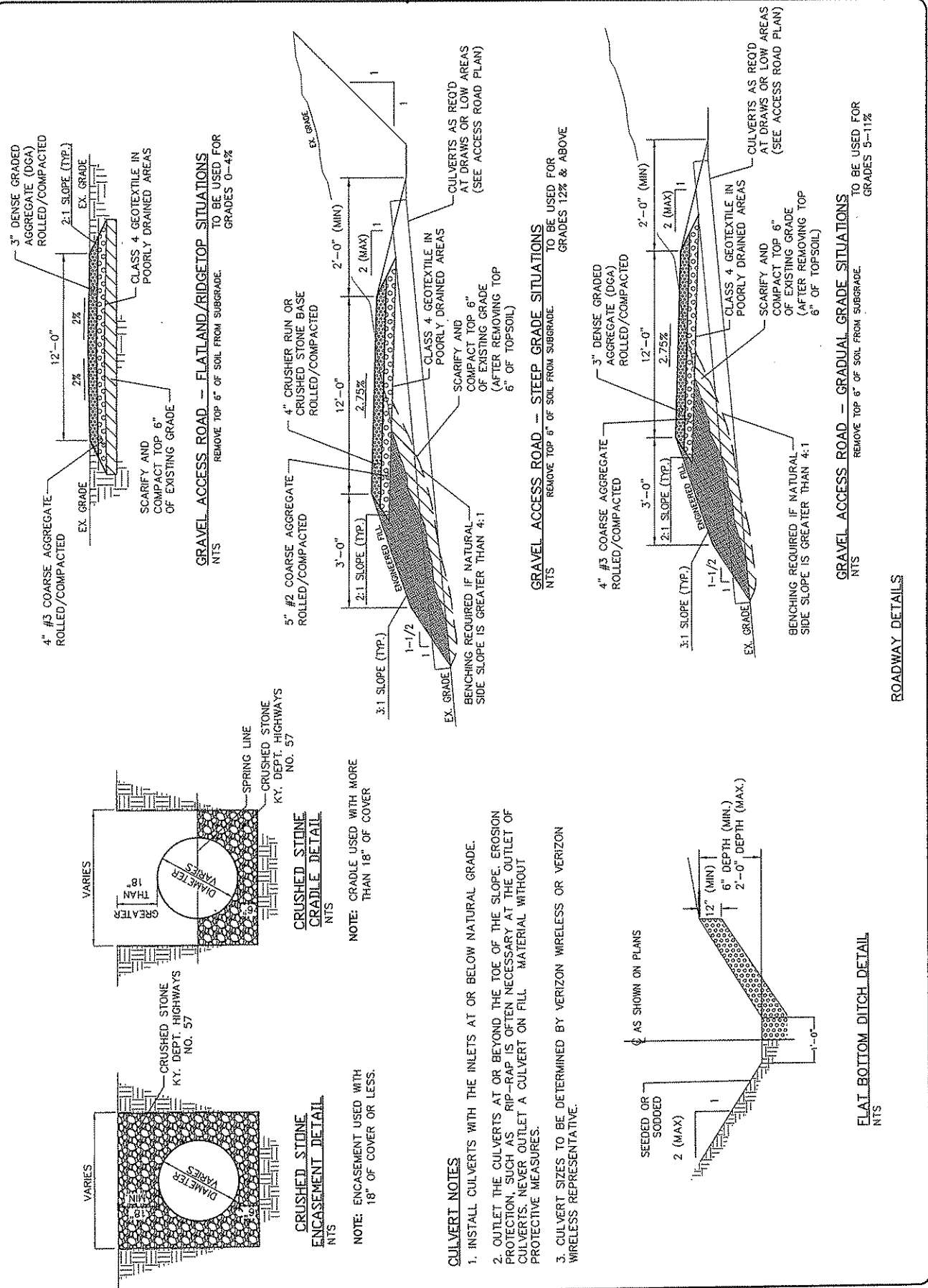

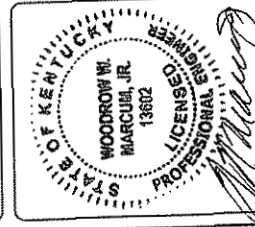
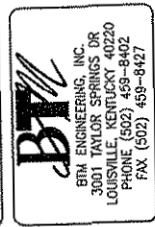
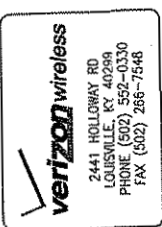

SITE NAME: MYNHER
SITE ADDRESS: 1850 MORRAYER RD MOREHEAD, KY 40351
LATITUDE: 38° 09' 15.57" N
LONGITUDE: 83° 26' 23.98" W
LEASE AREA: 5,000 SQ. FT.
TOWER TYPE: SELF-SUPPORT
TOWER HEIGHT: 290'

NO.	REVISION/ISSUE	DATE
1	ISSUE FOR COMMENT	5/24/07
2	ISSUE FOR CONST	6/22/07

TITLE: ROADWAY PLANS
SHEET: C6--0

SITE AND ACCESS ROAD CONTROL FILL NOTES:

1. STRIPPING: MATERIALS REQUIRED TO BE STRIPPED: - VEGETATION, TOPSOIL, LARGE ROOT ZONES, STUMP MATERIAL, SOFT SOIL, AND EXCESSIVELY WET, DESICCATED, FROZEN, CONTAMINATED OR OTHERWISE UNSUITABLE MATERIALS.
2. MINIMUM EXTENT OF STRIPPING: 1 FOOT BEYOND THE PROPOSED CONSTRUCTION LIMITS.
3. STRIPPED MATERIAL SHOULD BE CONSIDERED FOR REUSE IN LANDSCAPED AREAS ONLY.
4. SUBGRADE REQUIREMENTS: SUBGRADE PROCFROLLED AND ANY REQUIRED IMPROVEMENTS COMPLETED.
5. FILL MATERIAL REQUIREMENTS: NO DELETERIOUS DERRIS
6. NO ROCK PIECES LARGER THAN 3 INCHES
7. LESS THAN 5% ORGANIC MATERIAL
8. MAXIMUM DRY DENSITY OF AT LEAST 100 PCT ACCORDING TO THE STANDARD PROCTOR COMPACTION METHOD (ASTM D-698)
9. EVALUATED AND APPROVED BY GEOTECHNICAL ENGINEER OR VERIZON WIRELESS REPRESENTATIVE PRIOR TO CONSTRUCTION.
10. FILL PLACEMENT GUIDELINES: MINIMUM COMPACTION: - 90 % STANDARD PROCTOR MAXIMUM DRY DENSITY (SPMDD) (ASTM D-698)
11. MOISTURE CONTENT: WITHIN 2 % OF OPTIMUM (ASTM D-698)
12. MAXIMUM LOOSE LIFT THICKNESS: 8 INCHES
13. COMPACT AND TEST AND APPROVE EACH LIFT PRIOR TO PLACING ADDITIONAL LIFTS.
14. SCARIFY SMOOTHED FILL SURFACES PRIOR TO PLACING THE NEXT LIFT.
15. MAINTAIN POSITIVE SURFACE DRAINAGE ON FILL SURFACES DURING PLACEMENT TO PRECLUDE PONDING OF WATER.
16. ROLL FILL SURFACES SMOOTH IF RAIN IS EXPECTED.

NOTES:
THIS TREATMENT FOR EMBANKMENT FOUNDATION BENCHES AS INDICATED ON THIS SHEET, SHALL BE ACCEPTED AS GUIDES FOR HIGHWAY DESIGN. HOWEVER, ALL THE CONDITIONS THAT WILL BE ENCOUNTERED MUST BE SHOWN, SO THE DESIGNER MUST GIVE CONSIDERABLE THOUGHT TO THE LOCATIONS AND DIMENSIONS OF THESE BENCHES. DEFINITE DESIGN INFORMATION MUST BE ESTABLISHED AS TO SIZE OF THESE BENCHES, DUE TO THE IRREGULARITIES AND THE DIFFERENT PERCENTS OF INCLINE OF THE EXISTING HORIZONTAL RUN. THIS RUN IS FAIRLY TYPICAL WITH A HORIZONTAL RUN BEING THE MINIMUM.
WHEN THE INCLINE OF THE CROSS SECTION IS 15 PERCENT OR GREATER THESE EMBANKMENT FOUNDATION BENCHES SHALL BE CONSTRUCTED IN THE ORIGINAL SLOPE AS THE EMBANKMENT IS CONSTRUCTED IN COMPACTED LAYERS OR LIFTS. THE CROSS SECTION, THE VOLUME SHALL BE COMPUTED AS ROADWAY EXCAVATION OR EMBANKMENT IN PLACE AS APPLICABLE AND SHOWING EMBANKMENT FOUNDATION BENCHES. THE TOTAL EARTHWORK WITH THIS NOTE '9' TOTAL INCLUDES 'X' NUMBER OF CUBIC YARDS FROM THESE BENCHES WILL NOT BE SHOWN IN THE DISTRIBUTION OF QUANTITIES BUT THEY WILL DEFINITELY BE A PAY QUANTITY BY VIRTUE OF THE FACT QUANTITIES INCLUDED IN THE TOTAL OF ROADWAY EXCAVATION QUANTITIES.
THE EXCAVATION WILL BE ALLOWED FOR THE REFILLING OF THESE BENCHES, SINCE SUPPOSEDLY, THE MATERIAL THAT WAS EXCAVATED WILL BE PROCESSED AND PLACED BACK IN THESE BENCHES.
IF THE CROSS SECTION IS AN EARTH ONE, THAT IS IF NO ROCK IS SHOWN, THEN THE FOUNDATION BENCHES SHALL BE INDICATED ON THE CROSS SECTION AND CONSTRUCTED AS SHOWN BY THE DRAWING AND THE SECTIONS SHALL BE GIVEN A PAY ITEM AS ROADWAY EXCAVATION OR EMBANKMENT IN PLACE AS APPLICABLE, IN OTHER WORDS, SUPPORT BENCHING OF EARTH CONSTRUCTION, THAT THE ENGINEER FINDS AND SO DIRECTS THAT EMBANKMENT FOUNDATION BENCHING IS NECESSARY AND IT IS SHOULD IT BE EVIDENT ON THE DESIGN CROSS SECTIONS, THE BASIS OF PAYMENT SHALL BE AS HEREIN BEFORE STATED.
ROADWAY EXCAVATION OR EMBANKMENT IN PLACE AS APPLICABLE

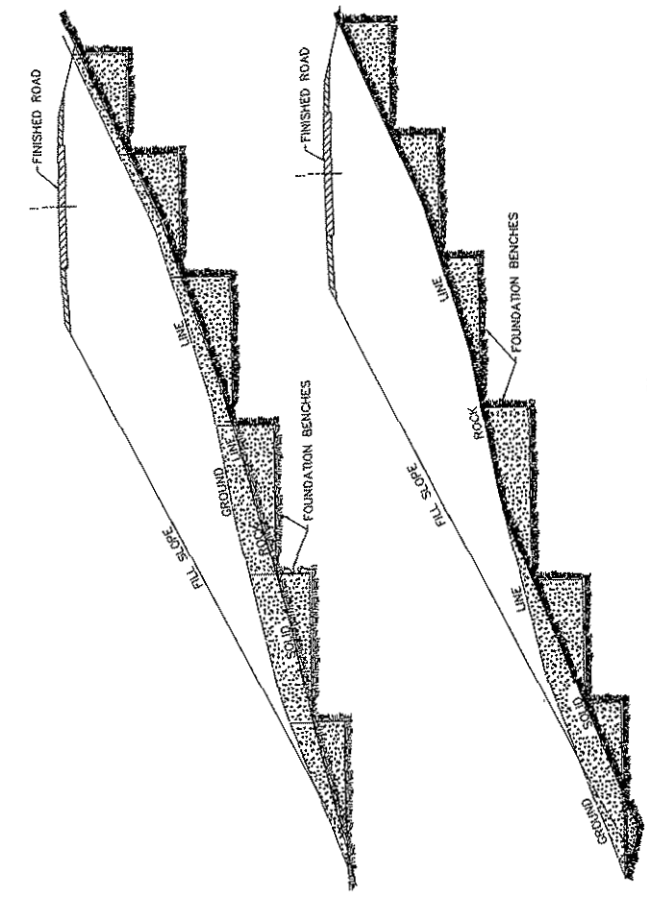

TYPICAL EMBANKMENT FOUNDATION BENCHES
N.T.S.

EMBANKMENT BENCH DETAILS

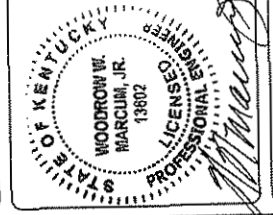

SITE NAME:	LYNNER
SITE ADDRESS:	1650 WILBARGER RD MORGANTOWN, KY 40351
LATITUDE:	36° 09' 19.57" N
LONGITUDE:	83° 26' 23.58" W
LEASE AREA:	5,000 SQ. FT.
POWER TYPE:	SELF-SUPPORT
POWER HEIGHT:	290'

NO.	REVISION/ISSUE	DATE
1	ISSUE FOR COMMENT	5/24/07
2	ISSUE FOR CONST	6/22/07

TITLE:	NOTES & ICE BRIDGE DETAILS
SHEET:	C-7

SITE WORK GENERAL NOTES:

1. THE CONTRACTOR SHALL CONTACT UTILITY LOCATING SERVICES PRIOR TO THE START OF CONSTRUCTION.
2. ALL EXISTING ACTIVE SEWER, WATER, GAS, ELECTRIC, AND OTHER UTILITIES, WHERE ENCOUNTERED IN THE WORK, SHALL BE PROTECTED AT ALL TIMES, AND WHERE REQUIRED FOR THE PROPER EXECUTION OF THE WORK, SHALL BE RE-LOCATED AS DIRECTED BY ENGINEERS. EXTREME CAUTION SHOULD BE USED BY THE CONTRACTOR WHEN EXCAVATING OR DRILLING PIERS AROUND OR NEAR UTILITIES. CONTRACTOR SHALL PROVIDE SAFETY TRAINING FOR THE WORKING CREW. THIS WILL INCLUDE BUT NOT BE LIMITED TO A) FALL PROTECTION B) CONFINED SPACE C) ELECTRICAL SAFETY D) TRENCHING & EXCAVATION.
3. ALL SITE WORK SHALL BE AS INDICATED ON THE DRAWINGS AND PER VERIZON WIRELESS SPECIFICATIONS.
4. IF NECESSARY, RUBBISH, STUMPS, DEBRIS, STICKS, STONES AND OTHER DEBRIS SHALL BE REMOVED FROM THE SITE AND DISPOSED OF LEGALLY.
5. THE SITE SHALL BE GRADED TO CAUSE SURFACE WATER TO FLOW AWAY FROM THE SHELTER OR EQUIPMENT PAD AND TOWER AREAS.
6. NO FILL OR EMBANKMENT MATERIAL SHALL BE PLACED ON FROZEN GROUND. FROZEN MATERIALS, SNOW OR ICE SHALL NOT BE PLACED IN ANY FILL OR EMBANKMENT.
7. THE SUB GRADE SHALL BE COMPACTED AND BROUGHT TO A SMOOTH UNIFORM GRADE PRIOR TO FINISHED SURFACE APPLICATION.
8. ALL EXISTING INACTIVE SEWER, WATER, GAS, ELECTRIC AND OTHER UTILITIES, WHICH INTERFERE WITH THE EXECUTION OF THE WORK, SHALL BE REMOVED AND/OR CAPPED, PLUGGED OR OTHERWISE DISCONTINUED AT POINTS WHICH WILL NOT INTERFERE WITH THE EXECUTION OF THE WORK, SUBJECT TO THE APPROVAL OF ENGINEERING, OWNER AND/OR LOCAL UTILITIES.
9. THE AREAS OF THE OWNERS PROPERTY DISTURBED BY THE WORK AND NOT COVERED BY THE BUILDING OR DRIVEWAY, SHALL BE GRADED TO A UNIFORM SLOPE, FERTILIZED, AND SEEDED. SEE CONSTRUCTION NOTES FOR FURTHER INSTRUCTIONS.
10. CONTRACTOR SHALL MINIMIZE DISTURBANCE TO EXISTING SITE DURING CONSTRUCTION. EROSION CONTROL MEASURES, IF REQUIRED DURING CONSTRUCTION, SHALL BE IN CONFORMANCE WITH THE LOCAL GUIDELINES FOR EROSION AND SEDIMENT CONTROL.

CONCRETE AND REINFORCING STEEL NOTES:

1. ALL CONCRETE WORK SHALL BE IN ACCORDANCE WITH THE ACI 301, ACI 318 AND THE SPECIFICATION 3300 FOR CAST-IN-PLACE CONCRETE.
2. ALL CONCRETE SHALL HAVE A MINIMUM COMPRESSIVE STRENGTH OF 3000 PSI AT 28 DAYS, UNLESS NOTED OTHERWISE.
3. REINFORCING STEEL SHALL CONFORM TO ASTM A 615, GRADE 60, DEFORMED UNLESS NOTED OTHERWISE. WELDED WIRE FABRIC SHALL CONFORM TO ASTM A 185 WELDED STEEL WIRE FABRIC UNLESS NOTED OTHERWISE. SPICES SHALL BE CLASS 'B' AND ALL HOOKS SHALL BE STANDARD, UNO.
4. THE FOLLOWING MINIMUM CONCRETE COVER SHALL BE PROVIDED FOR REINFORCING STEEL UNLESS SHOWN OTHERWISE ON DRAWINGS:
 CONCRETE CAST AGAINST EARTH.....2 IN.
 CONCRETE EXPOSED TO EARTH OR WEATHER:
 #6 AND LARGER2 IN.
 #5 AND SMALLER & W/F1 1/2 IN.
 CONCRETE NOT EXPOSED TO EARTH OR WEATHER OR NOT CAST AGAINST THE GROUND:
 SLAB AND WALL3/4 IN.
 BEAMS AND COLUMNS1 1/2 IN.
5. 3/4" CHAMFER SHALL BE PROVIDED AT ALL EXPOSED EDGES OF CONCRETE, UNO, IN ACCORDANCE WITH ACI 301 SECTION 4.2.4.4.
6. INSTALLATION OF CONCRETE EXPANSION/SHRINK JOINTS SHALL BE PER MANUFACTURER'S WRITTEN RECOMMENDED PROCEDURE. THE ANCHOR BOLT, DOWEL OR ROD SHALL BE PER MANUFACTURER'S RECOMMENDATION FOR EMBEDMENT DEPTH, OR AS SHOWN ON THE DRAWINGS. THE JOINT SHALL BE CUT WITHOUT PRIOR ENGINEERING APPROVAL. WHEN DRILLING HOLES IN CONCRETE, EXPANSION BOLTS SHALL BE PROVIDED BY HANSSET/REDHEAD OR APPROVED EQUAL.

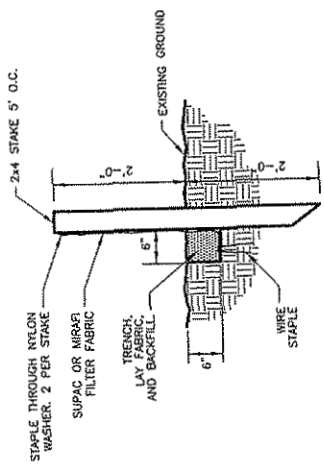

SILT FENCE DETAIL
N.T.S.

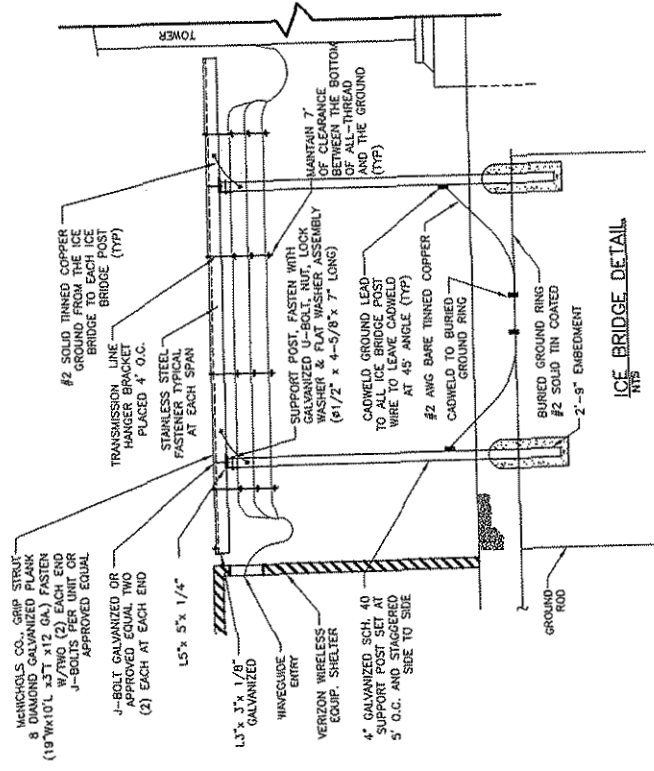

ICE BRIDGE DETAIL
N.T.S.

verizon wireless
 2441 HOLLOWAY RD
 LOUISVILLE, KY 40299
 PHONE (502) 552-0330
 FAX (502) 266-7548

BTM
 BTA ENGINEERING, INC.
 3001 TAYLOR SHELBY DR
 LOUISVILLE, KY 40240
 PHONE (502) 459-8402
 FAX (502) 459-8427

TABOP KENTUCKY
 LICENSED PROFESSIONAL ENGINEER
 WOODROW W. MARCUM, JR.
 13802
Woodrum

SITE NAME: MINNER
 SITE ADDRESS: 090 MCBRAYER RD
 MOREHEAD, KY 40351
 LATITUDE: 37° 05' 19.57" N
 LONGITUDE: 83° 25' 23.59" W
 LEASE AREA: 5,000 SQ. FT.
 TOWER TYPE: SELF-SUPPORT
 TOWER HEIGHT: 290'

NO.	REVISION/ISSUE	DATE
1	ISSUE FOR COMMENT	5/24/07
2	ISSUE FOR CONST	6/22/07

NO.	REVISION/ISSUE	DATE

TITLE: FOUNDATION DETAILS & NOTES
 SHEET: C-8

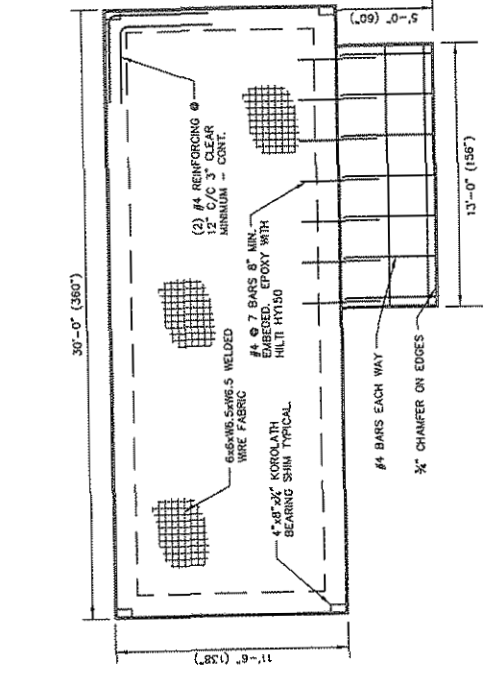

PLAN VIEW NOTES

1. 30" DEPTH IS REQUIRED BETWEEN FINAL GRADE AND BOTTOM OF FOOTING. IF LOCAL FROST DEPTH IS GREATER THAN 30", A DEEPER FOOTING WILL BE REQUIRED.
2. THIS FOUNDATION IS DESIGNED FOR 2000 PSF ALLOWABLE SOIL BEARING CAPACITY.
3. SLAB TOLERANCE IS ±1".
4. EXPANSIVE SOILS (CLAY) MAY REQUIRE SPECIAL CARE AT POINTS WHERE RIGID CONNECTIONS ARE MADE TO THE BUILDING (I.E. UNDERGROUND CONDUIT FEEDS, FLOOR JOISTS, BRICES, ETC) TO ALLOW FOR DIFFERENTIAL MOVEMENT DUE TO SETTLEMENT OR EXPANSION OF SOIL. ADEQUATE DRAINAGE WILL LESSEN THIS EFFECT.
5. ALL REBAR IS GRADE 40 MINIMUM.
6. W6.5 AS SPECIFIED FOR WMF HAS 0.285" DIAMETER.
7. WMF IS 60 KSI MINIMUM.
8. OVERLAP SPICES ARE ALLOWED FOR REINFORCING BAR, USE 18" MINIMUM LAP.
9. ALL REQUIRED TIE DOWN PLATES, SHIMS, BOLTS, AND ANCHORS SHALL BE PLACED INSIDE SHELTER PRIOR TO SHIPMENT FROM MANUFACTURER.

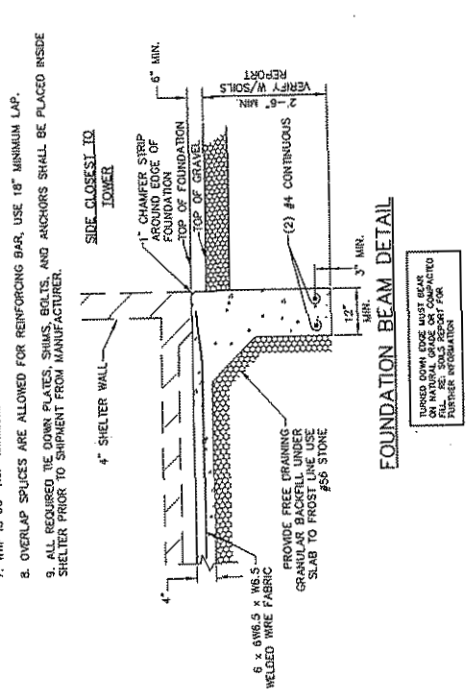

FOUNDATION BEAM DETAIL

CONSTRUCTION NOTES

1. CONFIRM SURVEY STAKES AND SET ELEVATIONS PRIOR TO ANY CONSTRUCTION.
2. THE COMPLETE ROAD AND SITE AREA WILL BE GRADED PRIOR TO FOUNDATION CONSTRUCTION OR PLACEMENT OF BACKFILL OR SUB-BASE MATERIAL.
3. PRIOR TO OTHER EXCAVATION AND CONSTRUCTION EFFORTS CRIB ORGANIC MATERIAL TO A MINIMUM OF 3X (6) INCHES BELOW ORIGINAL GRADE LEVEL.
4. UNLESS OTHERWISE INSTRUCTED BY PROJECT MANAGER, TRANSPORT ALL REMOVED TREES, BRUSH AND DEBRIS FROM THE PROPERTY TO AN APPROVED LANDFILL.
5. CONSTRUCT TEMPORARY CONSTRUCTION ZONE ACCESS DRIVE.
6. THE SITE AREA WILL BE BROUGHT TO SUB-BASE COVER ELEVATION AND THE ACCESS ROAD TO BASE COVER ELEVATION PRIOR TO FLOORING FOUNDATION.
7. APPLY SOIL STABILIZER PRIOR TO PLACING BASE MATERIALS
 AMESON HERMOSIDE - EPA REGISTERED
 1423 MADRID AVENUE
 TOLSON, TX PRODUCT 910 - EPA 10252-7
 PHASAR CORPORATION
 DEARBORN, MI 48129 TEL 313 345-8000
 FAX 313 345-8001
8. SOIL STABILIZER SHALL BE EPA REGISTERED OF LIQUID CONSISTENCY AND OF THE EMERGENCE DESIGN AND APPLIED IN ACCORDANCE WITH MANUFACTURER'S RECOMMENDATIONS.
9. GRADE, SEED, FERTILIZE AND MULCH DISTURBED AREAS IMMEDIATELY AFTER BRUSHING SITE AND ACCESS ROAD TO BASE COVER ELEVATION. WATER TO INSURE GROWTH.
10. REMOVE GRAVEL FROM TEMPORARY CONSTRUCTION ZONE TO AN AUTHORIZED AREA OR AS DIRECTED BY PROJECT MANAGER.
11. AFTER COMPLETION OF CONSTRUCTION BUT PRIOR TO THE FINAL PUNCH LIST INSPECTION, APPLY THREE (3) INCHES OF TOP SOIL TO ALL GRAVEL AREAS.
12. AFTER APPLICATIONS OF FINAL SURFACES, APPLY SOIL STABILIZER TO THE STONE SURFACES.
13. SOIL STABILIZER IS NOT TO BE APPLIED TO GRAVEL AREAS.
14. DISTURBED AREAS WILL REFLECT GROWTH OF NEW GRASS COVER PRIOR TO FINAL INSPECTION.
15. ROAD AND SITE MATERIALS AND CONSTRUCTION METHODS SHALL CONFORM TO KENTUCKY EROSION CONTROL MANUAL, EDITION 2006, WITH STANDARD SPECIFICATIONS FOR ROAD AND EROSION CONTROL CONSTRUCTION, CURRENT EDITION.
16. THE CONTRACTOR SHALL REPAIR ALL AREAS DAMAGED DURING CONSTRUCTION, BACK AS CLOSE TO ORIGINAL AS POSSIBLE.
17. IF UNSTABLE SOIL CONDITIONS ARE ENCOUNTERED THEY SHALL BE BROUGHT TO THE ATTENTION OF THE CONTRACTOR MANAGER AT THE POINT OF INTERSECTION WITH THE ACCESS ROAD OR EQUIVALENT PRIOR TO FILLING OR BACKFILLING OF ANY AREAS.
18. ELEVATIONS FOR SITE AND ACCESS ROAD ARE TO BE CALCULATED FROM FINISHED GRADES OR SURVEY POINTS. ELEVATIONS SHALL BE INDICATED AS TO WHETHER THEY ARE TO BE BASED ON ROUTE OR FINISHED GRADES. FINISHED GRADES SHALL BE INDICATED WITH "FINISHED GRADE" OR "ROUTE".
19. WHEN WORKING ON GRADES, THE CONTRACTOR SHALL MAINTAIN THE GRADES AS INDICATED ON THE DRAWINGS UNTIL THE NEXT WORKING DAY. THE CONTRACTOR SHALL MAINTAIN THE GRADES AS INDICATED ON THE DRAWINGS UNTIL THE NEXT WORKING DAY.
20. AVOID CREATING DEPRESSIONS WHERE WATER MAY POOL.
21. ALL EXCAVATIONS SHALL BE ASSIGNED TO INCLUDE GRADING, BANKING, DITCHING AND UNLESS OTHERWISE INDICATED, COVERING TWO INCHES OF SURFACE COURSE ALL ROADS OR ROUTES UTILIZED FOR ACCESS TO THE SITE COMMENCING AT THE POINT OF INTERSECTION WITH THE EXISTING ROAD AND SMOOTH THE SURFACE BEFORE PLACING FILL OR STONE.
22. WHEN WORKING ON GRADES, THE CONTRACTOR SHALL MAINTAIN THE GRADES AS INDICATED ON THE DRAWINGS UNTIL THE NEXT WORKING DAY. THE CONTRACTOR SHALL MAINTAIN THE GRADES AS INDICATED ON THE DRAWINGS UNTIL THE NEXT WORKING DAY.
23. PLACE FILL OR STONE IN SIX INCH MAXIMUM LIFT AND COMPACT BEFORE PLACING NEXT LIFT.
24. THE FINISH SURFACE SHALL BE GRASS COVER. SHALL EXTEND A MINIMUM OF ONE FOOT BEYOND THE SITE PERMITS AND SHALL COVER THE AREA AS INDICATED.
25. REPAIR SHALL BE APPLIED TO THE SIDES OF DITCHES OR DRAINAGE SPALES.
26. SEED FERTILIZER AND STRAW COVER SHALL BE APPLIED TO ALL OTHER DISTURBED AREAS, DITCHES, AND DRAINAGE SPALES NOT OTHERWISE NOTIFIED.

GENERAL NOTES

1. DRAWINGS ARE NOT TO BE SCALE. THESE PLANS ARE INTENDED TO BE SUPPLEMENTARY ONLY. THE CONTRACTOR SHALL BE RESPONSIBLE FOR OBTAINING ALL NECESSARY PERMITS, EQUIPMENT AND LABOR NECESSARY TO COMPLETE THE WORK. VERIFY ALL EXISTING CONDITIONS AND LOCATIONS WITH CONSTRUCTION MANAGER.
2. PRIOR TO STARTING ANY WORK, THE CONTRACTOR SHALL VISIT THE JOB SITE AND EXAMINE EXISTING CONDITIONS AND MATERIALS AND SHALL OBTAIN ALL NECESSARY PERMITS, EQUIPMENT AND LABOR NECESSARY TO COMPLETE THE WORK. VERIFY ALL EXISTING CONDITIONS AND LOCATIONS WITH CONSTRUCTION MANAGER.
3. CONTRACTOR SHALL VERIFY ALL FIELD CONDITIONS AND DIMENSIONS ON THE JOB SITE AND CONFIRM THAT ALL CONDITIONS ARE AS SHOWN ON DRAWINGS AND PERMITS.
4. NOTIFY PROJECT MANAGER OF ANY MAJOR DISCREPANCIES BEFORE THE CONTRACT DOCUMENTS, PERMITS AND MATERIALS ARE ORDERED. CONTRACTOR SHALL BE RESPONSIBLE FOR OBTAINING ALL NECESSARY PERMITS, EQUIPMENT AND LABOR NECESSARY TO COMPLETE THE WORK. VERIFY ALL EXISTING CONDITIONS AND LOCATIONS WITH CONSTRUCTION MANAGER.
5. CONTRACTOR SHALL VERIFY ALL FIELD CONDITIONS AND DIMENSIONS ON THE JOB SITE AND CONFIRM THAT ALL CONDITIONS ARE AS SHOWN ON DRAWINGS AND PERMITS.
6. CONTRACTOR SHALL VERIFY ALL FIELD CONDITIONS AND DIMENSIONS ON THE JOB SITE AND CONFIRM THAT ALL CONDITIONS ARE AS SHOWN ON DRAWINGS AND PERMITS.
7. ALL TELEPHONE/LINE EQUIPMENT LAYOUTS, PERFORMANCE, INSTALLATION AND TESTING SHALL BE THE RESPONSIBILITY OF THE CONTRACTOR. THE CONTRACTOR SHALL BE RESPONSIBLE FOR COORDINATING HIS WORK WITH THE WORK AND CLEARANCE REQUIRED BY OTHERS RELATED TO SAID EQUIPMENT.
8. ALL WORK PERFORMED AND MATERIALS SHALL MEET THE REQUIREMENTS AS SPECIFIED IN ALL APPLICABLE REGULATIONS, ORDINANCES AND LOCAL AND STATE JURISDICTIONS. AS A MINIMUM STANDARD, CONTRACTOR SHALL OBEY ALL ORDINANCES AND LOCAL AND STATE JURISDICTIONS. CONTRACTOR SHALL OBEY ALL ORDINANCES AND LOCAL AND STATE JURISDICTIONS.
9. ELECTRICAL SYSTEMS SHALL BE INSTALLED PER ALL LOCAL AND STATE JURISDICTIONS, ORDINANCES AND APPLICABLE REGULATIONS.
10. CONTRACTOR SHALL PROVIDE CONTINUOUS SUPERVISION WHILE ANY SUB-CONTRACTOR OR WORKMAN ARE ON THE JOB SITE FOR ALL CONSTRUCTION MEANS, METHODS, TECHNIQUES, SEQUENCES AND PROCEDURES, AND COORDINATING ALL PORTIONS OF THE WORK UNDER THE CONTRACT.
11. CONTRACTOR SHALL PROVIDE A PORTABLE FIRE EXTINGUISHER WITH A RATING OF NOT LESS THAN 10 BULBS (MINIMUM 75 FEET TRAVEL DISTANCE) TO ALL PORTIONS OF THE PROJECT AND DURING CONSTRUCTION.
12. ALL CONSTRUCTION SHALL BE IN ACCORDANCE WITH UNIFORM BUILDING CODE (UBC) LATEST EDITION, AS WELL AS ALL APPLICABLE REGULATIONS, ORDINANCES AND LOCAL AND STATE JURISDICTIONS. CONTRACTOR SHALL OBEY ALL ORDINANCES AND LOCAL AND STATE JURISDICTIONS.
13. ALL CONSTRUCTION THROUGH FIRE RATED AREAS WITH ALL LISTED OR FM APPROVED MATERIALS, DETAILS AND SUBSTITUTES PROPOSED TO SHOW END RESULT OF THE DESIGN.
14. ALL CONSTRUCTION SHALL BE IN ACCORDANCE WITH UNIFORM BUILDING CODE (UBC) LATEST EDITION, AS WELL AS ALL APPLICABLE REGULATIONS, ORDINANCES AND LOCAL AND STATE JURISDICTIONS. CONTRACTOR SHALL OBEY ALL ORDINANCES AND LOCAL AND STATE JURISDICTIONS.
15. VERIFY ALL FINAL EQUIPMENT LOCATIONS WITH OWNERS REPRESENTATIVE.
16. DIMENSIONS ARE TO FINISH SURFACES UNLESS OTHERWISE NOTED.
17. CLEAN UP AND REMOVE ALL DEBRIS, CLEAN, HAZARDOUS, RISK AND DISPOSAL OF ALL OIL, GREASE, AND OTHER CONTAMINANTS FROM THE PROJECT AREA. CONTRACTOR SHALL BE RESPONSIBLE FOR OBTAINING ALL NECESSARY PERMITS, EQUIPMENT AND LABOR NECESSARY TO COMPLETE THE WORK. VERIFY ALL EXISTING CONDITIONS AND LOCATIONS WITH CONSTRUCTION MANAGER.
18. THE GENERAL CONTRACTOR IS RESPONSIBLE FOR OBTAINING ALL NECESSARY PERMITS, EQUIPMENT AND LABOR NECESSARY TO COMPLETE THE WORK. VERIFY ALL EXISTING CONDITIONS AND LOCATIONS WITH CONSTRUCTION MANAGER.
19. GENERAL CONTRACTOR IS RESPONSIBLE FOR CLEANING AND MAINTAINING SHED FLOORS AFTER ALL EQUIPMENT HAS BEEN INSTALLED.
20. CONTRACTOR IS RESPONSIBLE FOR PROVIDING A TRASH RECEPTACLE AND A PORTABLE TOILET AT THE SITE FOR THE DURATION OF CONSTRUCTION.
21. THE VERIZON WIRELESS SHELTER SHALL NOT BE USED FOR STORAGE OF TOOLS, EQUIPMENT, ETC. BY ANY CONNECTIONS OR SUB-CONTRACTORS. CONTRACTOR SHALL BE RESPONSIBLE FOR OBTAINING ALL NECESSARY PERMITS, EQUIPMENT AND LABOR NECESSARY TO COMPLETE THE WORK. VERIFY ALL EXISTING CONDITIONS AND LOCATIONS WITH CONSTRUCTION MANAGER.
22. THE CONTRACTOR SHALL BE RESPONSIBLE FOR OBTAINING ALL NECESSARY PERMITS, EQUIPMENT AND LABOR NECESSARY TO COMPLETE THE WORK. VERIFY ALL EXISTING CONDITIONS AND LOCATIONS WITH CONSTRUCTION MANAGER.
23. CONTRACTOR SHALL PROVIDE 30 DAY WRITTEN NOTICE TO THE OWNER OF ANY WORKING DAYS REQUIRED TO COMPLETE THE WORK. THIS NOTICE SHALL BE PROVIDED TO THE OWNER AT LEAST 30 DAYS PRIOR TO THE START OF CONSTRUCTION. THIS INSTRUCTION APPLIES TO ALL SITES (RAW LAND AND CO-LOCATION). CLOSEST DRAINER DOCUMENTATION IS REQUIRED.

CONNECTION DETAIL - ISOMETRIC

CONNECTION DETAIL - SIDE

CONNECTION DETAIL - FRONT

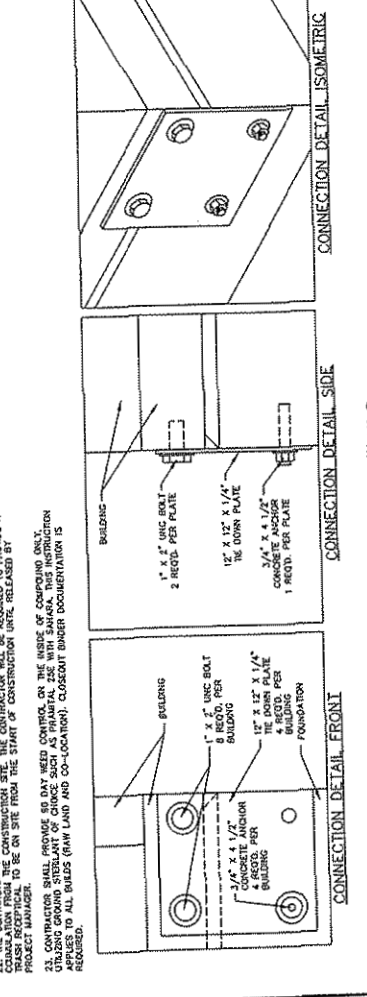

ANCHOR DETAILS

verizon wireless
 2441 HOLLOWAY RD
 LOUISVILLE, KY 40299
 PHONE (502) 552-0330
 FAX (502) 266-7548

BT
 8TH ENGINEERS, INC.
 3401 FAULCON SPRINGS DR
 LOUISVILLE, KENTUCKY 40220
 PHONE (502) 459-8402
 FAX (502) 459-8427

STATE OF KENTUCKY
 WOODROW W. MARQUIN, JR.
 13802
 LICENSED PROFESSIONAL ENGINEER

W. Marquin

SITE NAME: MYNNER

SITE ADDRESS: 1050 MCPHATER RD
 MOREHEAD, KY 40351

LATITUDE: 36° 05' 19.57" N
 LONGITUDE: 83° 26' 23.56" W

LEASE AREA: 5,000 SQ. FT.

TOWER TYPE: SELF-SUPPORT

TOWER HEIGHT: 290'

NO.	REVISION/ISSUE	DATE
1	ISSUE FOR COMMENT	5/24/07
2	ISSUE FOR CONST	6/22/07

TITLE: GROUNDING & CONDUIT ROUTING

SHEET: E-1

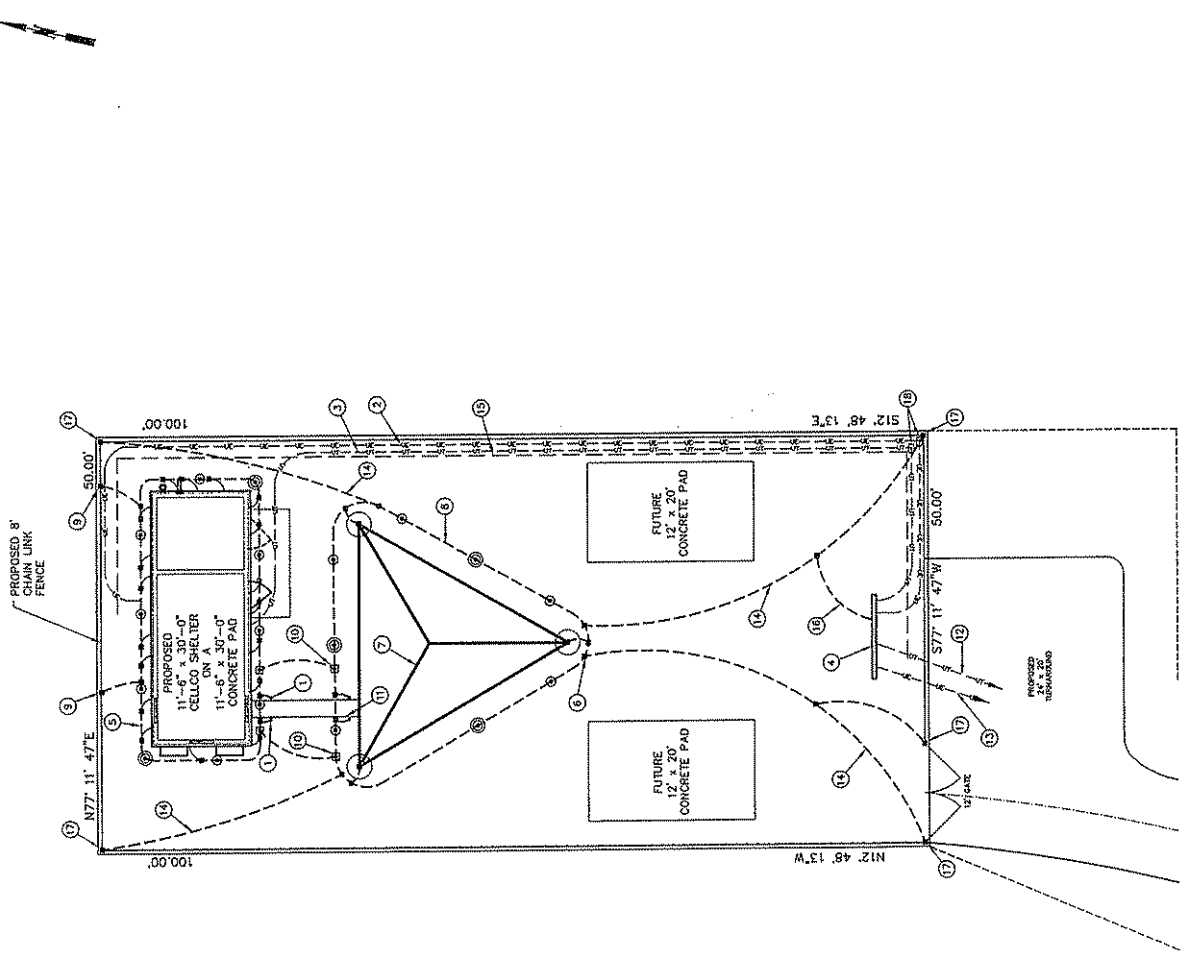

CODED DRAWING NOTES

- 1 BOND EACH ICE BRIDGE POST TO VERIZON WIRELESS SHELTER GROUND RING
- 2 (1) - 4" PVC ELECTRIC CONDUIT ±143'
- 3 (1) - 4" PVC TELCO CONDUIT ±116'
- 4 PROPOSED UTILITY METER BOARD
- 5 PROPOSED VERIZON WIRELESS SHELTER GROUND RING
- 6 CADWELD (TYP)
- 7 PROPOSED TOWER 290'
- 8 PROPOSED SITE GROUND RING
- 9 BOND VERIZON WIRELESS GROUND RING TO HEAREST FENCE POST (TYP 2 PLACES)
- 10 BOND VERIZON WIRELESS GROUND RING TO SITE GROUND RING (TYP 2 PLACES)
- 11 PROPOSED ICE BRIDGE ±13'
- 12 (1) - 4" PVC ELECTRIC CONDUIT FROM SOURCE ±1503'
- 13 (1) - 4" PVC TELCO CONDUIT FROM SOURCE ±1648'
- 14 PROPOSED GROUND FROM SITE GROUND RING TO FENCE POST (TYP 4 PLACES)
- 15 CONDUIT TO BE PLACED WITHIN 2' OF FENCE
- 16 SEE METER BOARD DETAIL (SHEET E-3) FOR MULTIPLE GROUNDING CONNECTIONS
- 17 CADWELD TO CORNER AND DATE POSTS
- 18 PULL BOXES

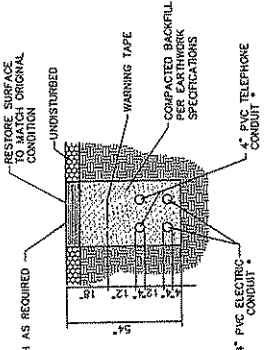

A-CONDUIT BURIED CABLE DETAIL

* SEPARATION DIMENSION TO BE VERIFIED WITH LOCAL UTILITY CO. REQUIREMENT. SEE COMMENTS SIZE APPLICABLE IN THE POWER AND TELCO BEER MANUAL, NUMBER AND QUANTITY COMPANY AND TELCO REQUIREMENTS. MEET ALL REG AND QUANTITY COMPANY REQUIREMENTS.

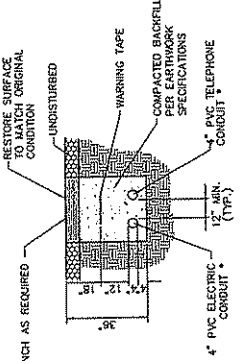

BURIED CABLE DETAIL

* SEPARATION DIMENSION TO BE VERIFIED WITH LOCAL UTILITY CO. REQUIREMENT. SEE COMMENTS SIZE APPLICABLE IN THE POWER AND TELCO BEER MANUAL, NUMBER AND QUANTITY COMPANY AND TELCO REQUIREMENTS. MEET ALL REG AND QUANTITY COMPANY REQUIREMENTS.

LEGEND

- S- PROPOSED UNDERGROUND ELECTRIC
- T- PROPOSED UNDERGROUND TELEPHONE
- G- EXISTING GAS (2" BELOW GRADE)
- ⊙ INSPECTION SLEEVE WITH TEST LOOP
- GROUND ROD WITH CADWELD
- PRIMARY BOND
- CADWELD

NOTE: CONTRACTOR TO HAND EXCAVATE UTILITY TRENCH IN AREAS WHERE EXISTING UTILITIES ARE PRESENT

verizon wireless
 2441 HOLLOWAY RD
 LOUISVILLE, KY 40289
 PHONE (502) 552-0330
 FAX (502) 266-7548

BTM
 BTM ENGINEERING, INC.
 3031 TAYLOR SPRINGS DR
 LOUISVILLE, KENTUCKY 40220
 PHONE (502) 459-8402
 FAX (502) 459-8427

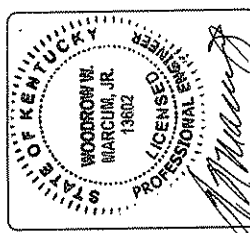

SITE NAME: MYTREER
 SITE ADDRESS: 1050 McGRATER RD
 McCREHEAD, KY 40351
 LATITUDE: 38° 08' 19.57" N
 LONGITUDE: 83° 28' 23.58" W
 LEASE AREA: 5,000 SQ. FT.
 TOWER TYPE: SELF-SUPPORT
 TOWER HEIGHT: 290'

NO.	REVISION/ISSUE	DATE
1	ISSUE FOR COMMENT	5/24/07
2	ISSUE FOR CONST	5/22/07

TITLE: UTILITY CONDUIT ROUTING
 SHEET: E-1A

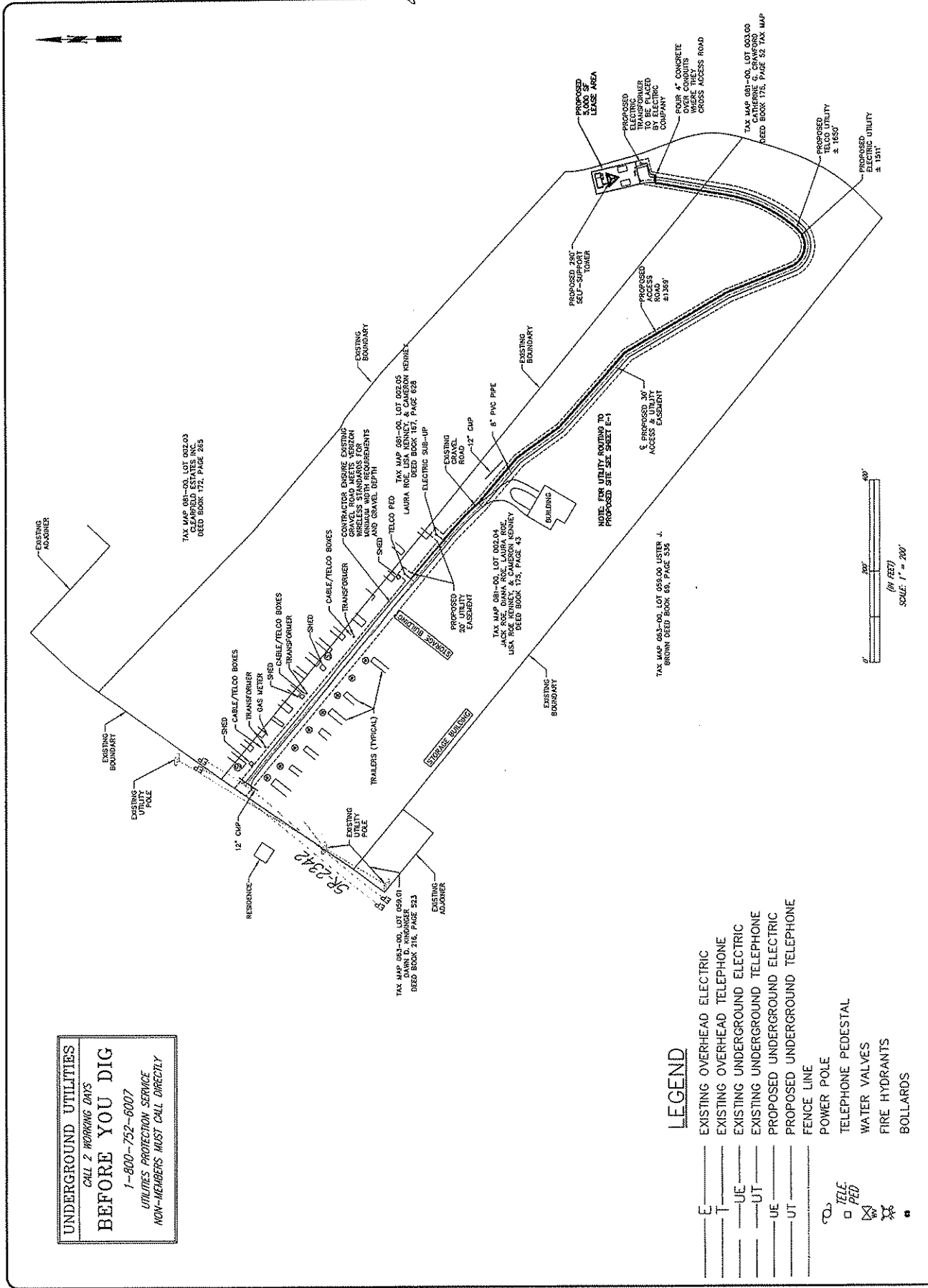

UNDERGROUND UTILITIES
 CALL 2 WORKING DAYS
BEFORE YOU DIG
 1-800-752-6007
 UTILITIES PROTECTION SERVICE
 NON-MEMBERS MUST CALL DIRECTLY

- LEGEND**
- E — EXISTING OVERHEAD ELECTRIC
 - T — EXISTING OVERHEAD TELEPHONE
 - UE — EXISTING UNDERGROUND ELECTRIC
 - UT — EXISTING UNDERGROUND TELEPHONE
 - UE — PROPOSED UNDERGROUND ELECTRIC
 - UT — PROPOSED UNDERGROUND TELEPHONE
 - — FENCE LINE
 - — POWER POLE
 - TELE. TELEPHONE PEDESTAL
 - PED. WATER VALVES
 - ⊗ FIRE HYDRANTS
 - ⊗ BOLLARDS



verizon wireless
 2441 HOLLOWAY RD
 LOUISVILLE, KY 40299
 PHONE (502) 552-0330
 FAX (502) 286-7548

BTM
 BTM ENGINEERING, INC.
 3001 TAYLOR SPRINGS DR
 LOUISVILLE, KENTUCKY 40220
 PHONE (502) 459-8402
 FAX (502) 459-8427

STATE OF KENTUCKY
 WOODROW W. MARCUM, JR.
 13802
 PROFESSIONAL ENGINEER
 LICENSE NO. 11111

SITE NAME:	MYNHER
SITE ADDRESS:	1050 MCBRYER RD MOREHEAD, KY 40351
LATITUDE:	36° 09' 19.57" N
LONGITUDE:	83° 25' 23.96" W
LEASE AREA:	5,000 SQ. FT.
TOWER TYPE:	SELF-SUPPORT
TOWER HEIGHT:	290'

NO.	REVISION/ISSUE	DATE
1	ISSUE FOR COMMENT	5/24/07
2	ISSUE FOR CONST	6/24/07

TITLE: EQUIPMENT SHIELDING PLAN
 SHEET: E-2

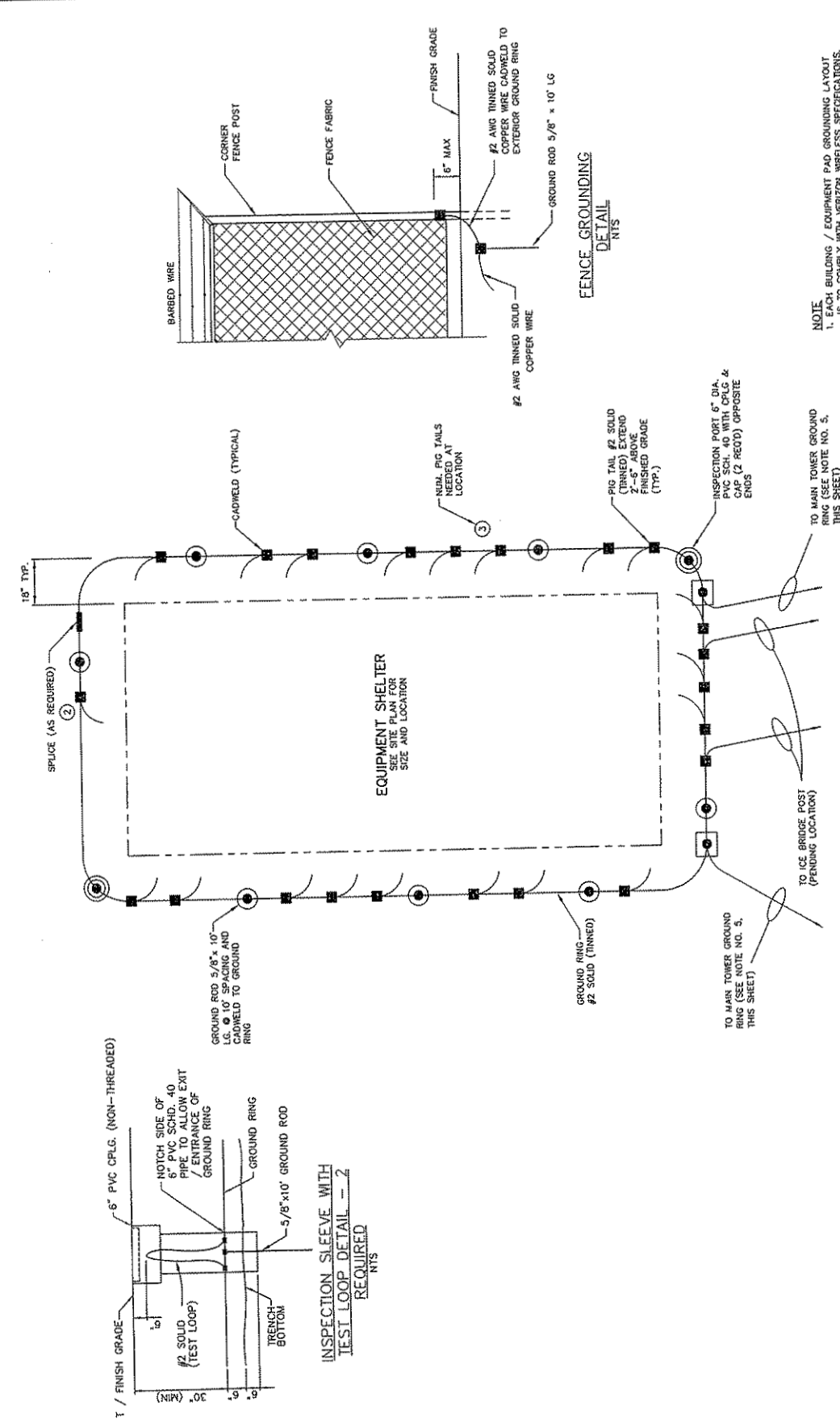

FENCE DETAIL
 NTS

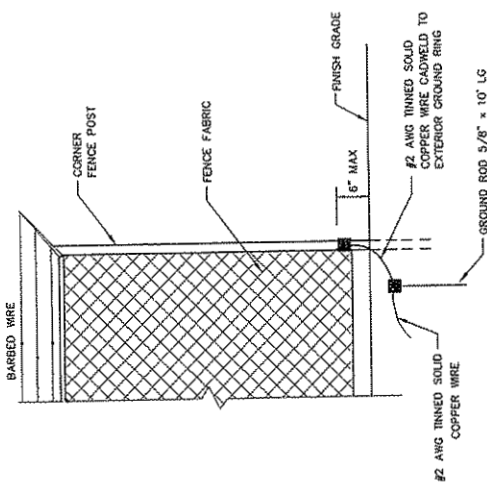

- NOTE**
1. EACH BUILDING / EQUIPMENT PAD GROUNDING LAYOUT IS TO COMPLY WITH VERIZON WIRELESS SPECIFICATIONS.
 2. ALL GROUNDING DETAIL SHALL BE IN ACCORDANCE WITH VERIZON WIRELESS PERSONNEL PRIOR TO BACKFILLING GROUNDING INSTALLATION.
 3. PLACE TEST PORTS AT OPPOSITE ENDS OF SHELTER.
 4. MINIMUM 3 FOOT SPACING BETWEEN THE GROUND CONNECTIONS TO THE MAIN TOWER GROUND RING. (TO BE DETERMINED BY PAD AND TOWER LOCATION)

EQUIPMENT SHELTER GROUNDING RING PLAN
 NTS

NOTE: EQUIPMENT GROUNDING TO COMPLY WITH VERIZON WIRELESS SPECIFICATIONS

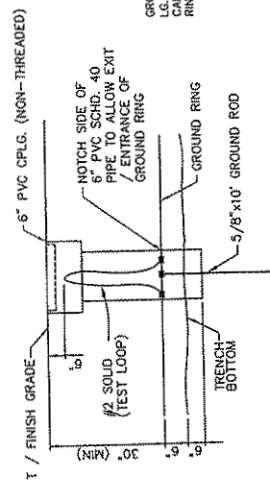

INSPECTION SLEEVE WITH TEST LOOP DETAIL - 2
 NTS

- LEGEND**
- INSPECTION PORT
 - GROUND ROD - 5/8" x 10' WITH CADWELD GROUND CONNECTION
 - CADWELD CONNECTION
 - PRIMARY BOND TO SITE GROUND RING

verizon wireless
 2441 HOLLOWAY RD
 LOUISVILLE, KY 40259
 PHONE (502) 552-0330
 FAX (502) 266-7548

BTM
 BTM ENGINEERING, INC.
 3001 TAYLOR SPRINGS DR
 LOUISVILLE, KENTUCKY 40220
 PHONE (502) 459-8402
 FAX (502) 459-8427

STATE OF KENTUCKY
 WOODROW W.
 MARCIUM, JR.
 13602
 LICENSED PROFESSIONAL ENGINEER

SITE NAME: MYNHER
 SITE ADDRESS: 1050 ACRAVER RD
 MOREHEAD, KY 40351
 LATITUDE: 38° 09' 19.57" N
 LONGITUDE: 83° 25' 22.58" W
 LEASE AREA: 5,000 SQ. FT.
 POWER TYPE: SELF-SUPPORT
 TOWER HEIGHT: 250'

NO.	REVISION/ISSUE	DATE
1	ISSUE FOR COMMENT	5/24/07
2	ISSUE FOR CONST	6/22/07

TITLE:
 10' UTILITY
 H-FRAME

SHEET:
 E-3

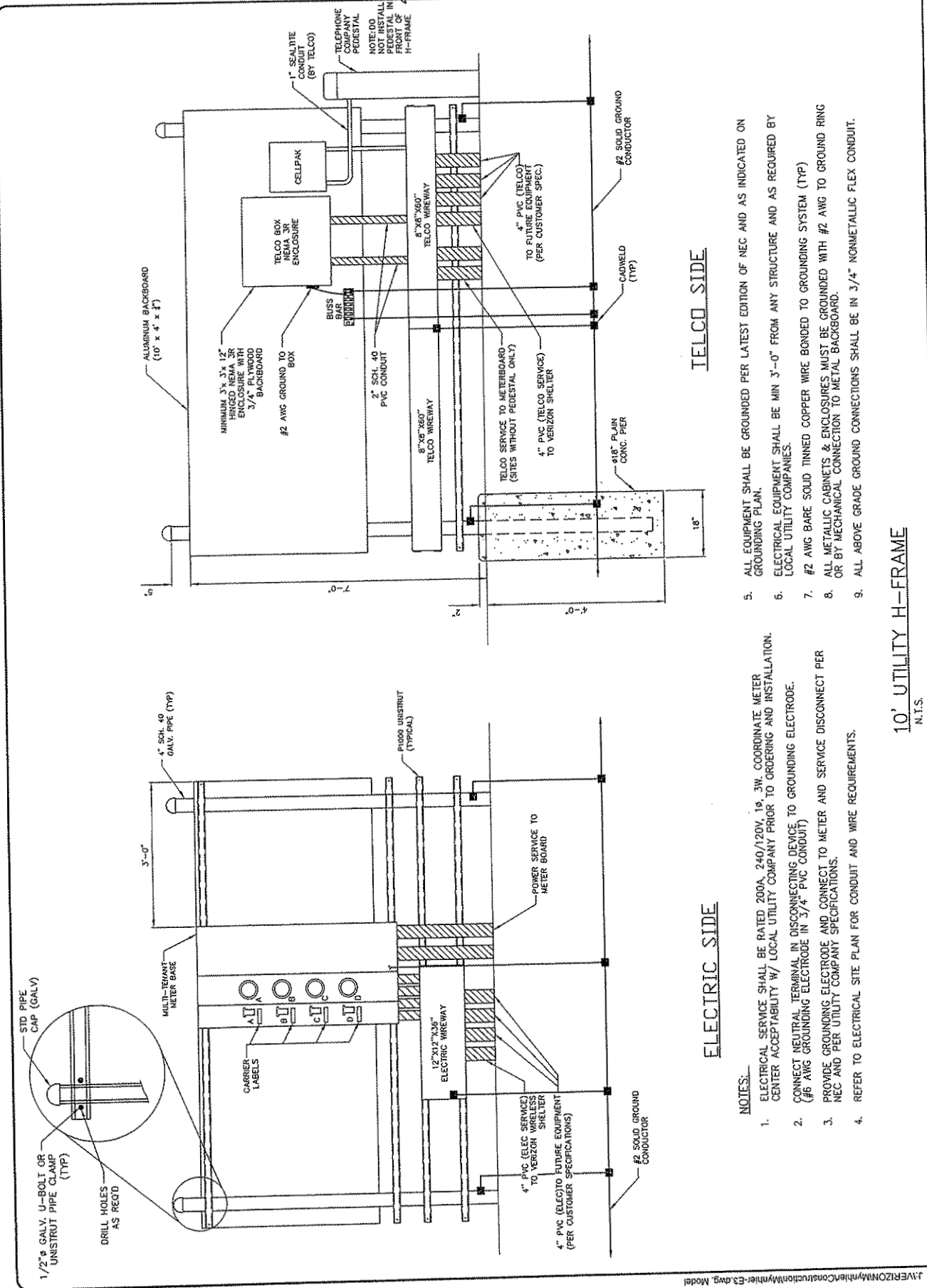

ELECTRIC SIDE

- NOTES:
- ELECTRICAL SERVICE SHALL BE RATED 200A, 240/120V, 1 ϕ , 3W, COORDINATE METER CENTER ACCEPTABILITY W/ LOCAL UTILITY COMPANY PRIOR TO ORDERING AND INSTALLATION.
 - CONNECT NEUTRAL TERMINAL IN DISCONNECTING DEVICE TO GROUNDING ELECTRODE. (#6 AWG GROUNDING ELECTRODE IN 3/4" PVC CONDUIT)
 - PROVIDE GROUNDING ELECTRODE AND CONNECT TO METER AND SERVICE DISCONNECT PER NEC AND PER UTILITY COMPANY SPECIFICATIONS.
 - REFER TO ELECTRICAL SITE PLAN FOR CONDUIT AND WIRE REQUIREMENTS.
- TELCO SIDE
- ALL EQUIPMENT SHALL BE GROUNDED PER LATEST EDITION OF NEC AND AS INDICATED ON GROUNDING PLAN.
 - ELECTRICAL EQUIPMENT SHALL BE MIN 3'-0" FROM ANY STRUCTURE AND AS REQUIRED BY LOCAL UTILITY COMPANIES.
 - #2 AWG BARE SOLID THINNED COPPER WIRE BONDED TO GROUNDING SYSTEM (TYP)
 - ALL METALLIC CABINETS & ENCLOSURES MUST BE GROUNDED WITH #2 AWG TO GROUND RING OR BY MECHANICAL CONNECTION TO METAL BACKBOARD.
 - ALL ABOVE GRADE GROUND CONNECTIONS SHALL BE IN 3/4" NONMETALLIC FLEX CONDUIT.

10' UTILITY H-FRAME
 N.T.S.

verizon wireless
 2441 HOLLOWAY RD
 LOUISVILLE, KY 40299
 PHONE (502) 552-0330
 FAX (502) 266-7548

BTM
 BTM ENGINEERING, INC.
 3001 TAYLOR SPRINGS DR
 LOUISVILLE, KENTUCKY 40220
 PHONE (502) 458-8802
 FAX (502) 458-8827

STATE OF KENTUCKY
 WOODROW W. MARGUM, JR.
 13802
 LICENSED PROFESSIONAL ENGINEER
W. Margum

SITE NAME: MTRHSR

SITE ADDRESS: 1050 MOSRAVER RD
 MOREHEAD, KY 40351

COOR. 38° 08' 10.53" N
 LONGITUDE: 83° 28' 23.98" W

LEASE AREA: 5,000 SQ. FT.

TOWER TYPE: SELF-SUPPORT

TOWER HEIGHT: 280'

NO.	REVISION/ISSUE	DATE
1	ISSUE FOR COMMENT	5/24/07
2	ISSUE FOR CONST	6/22/07

TITLE:
POLYPHASER DETAIL

SHEET: E-4

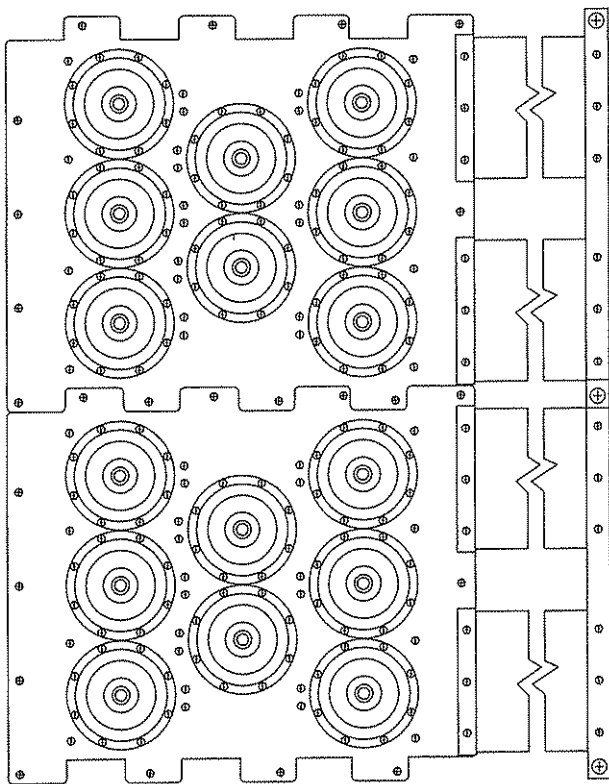

FRONT VIEW

**POLYPHASER
BULKHEAD PORT**

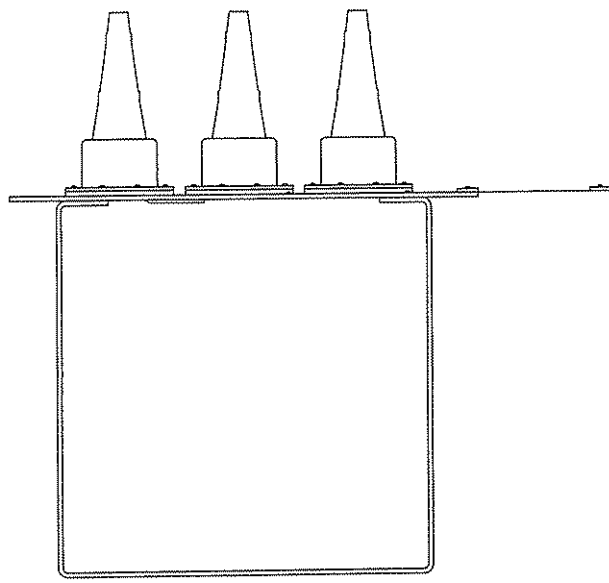

SIDE VIEW

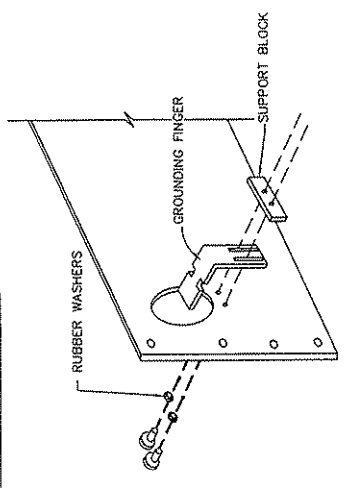

ENTRANCE PANEL
(REAR VIEW)

POLYPHASER EARTHED ENTRANCE PANEL INSTALLATION

- The entrance panel is designed to be installed on the exterior of the shelter. It has 5/16" holes arranged to coincide with standard 18" on center studs. (for hole cut-out dimensions, see below) a weatherproof sealant should be used between panel and siding.
- The adjustable grounding finger provides a means of centering the cable or waveguide in the hole and a ground connection for the shield. The finger is placed on the inside of the panel protruding to the exterior. It is held in place by the support block using the 1/4"-20 hex nuts and rubber washers provided.
- After trimming the weather boot per manufacturer recommendations, slide the retaining ring and then the boot attached over the cable, slightly soapy water may ease the assembly. All future use parts should be booted and end caps attached, as in step 12, to assure weather tightness.
- Install sandwich plates to horizontal grounding bars using the 10-32 x 5/16" slotted screws and lock washers. These will be used on the connection point for grounding strips from impulse suppressors.
- Install 1/4"-20 x 3/4" bolts with 1/4" lock washers to the flat entrance panel. The bolts are held captive on the panel and with 1/4" lock washers and nuts fasten the top and bottom horizontal ground bars, with sandwich plates.
- Preparing the interior opening; determine the approximate location for the panel. Using a suitable level, determine the approximate location for the panel. Measure and mark the opening per the hole cutout guide. Remove any sheet rock and insulation in the opening; do not cut studs.
- Preparing the exterior opening; determine the approximate location for the panel using the opening guide. Mark the opening per the hole cutout guide. Remove the siding in the opening; do not cut studs or remove siding on studs. Apply sealant to siding and install panel system.
- Each of the 6" wide ground strips should be installed in a sandwich between the 1/2" x 1/2" x 1/2" and the sandwich bars provided. Use the "Conductive Joint Compound" in the (CCK) copper cleaning kit to ensure a weatherproof electrical connection. Attach 10-32 x 5/16" screws and lock washers.

- The ground bar is designed to be attached to an existing perimeter ground system. It is attached to the 6" ground strips using brass 10-32 x 1/2" screws and 10-32 nuts. A full 18" of strip is included. The ground bar may be bolted or weatherproof welded to the perimeter ground system. Joint compound should be used on all bolted connections. PolyPhaser's CCK contains all the necessary equipment you will need to clean and protect all of copper joints.
- The master ground bars can be installed using 1/4"-20 round head screws, nuts and washers. These bars can be used as a central grounding location for interior equipment.
- The coax/waveguide must be stripped to expose the shield (approx. 2" long) at the point of entrance. The point of entrance should be determined prior to stripping coax or waveguide; i.e., how much cable should extend internally. Joint compound may be used to seal the joint. The weather boot should be booted and attached to one of the weather gear clamps provided for larger diameters. 2 clamps may be joined.
- Slide the weather boots and retaining rings back to the panel and attached using 8-32 x 1/2" machine screws and #8 lock washers. The weather sealant should be applied to the weather boot. The weather sealant should be applied to the weather boot, if an error in cutting the boot has occurred.
- The nylon cable tie is used to secure the weather boot around the coax/waveguide.

MODULAR ENTRANCE PANEL INSTALLATION

PolyPhaser modular entrance can be customized for multi-port entry by adding panels. The entry panels and combinations are for 16" stub spacing installation. In order to achieve optimum grounding, panels must be electrically bonded together by P/N 540-0219 or 5410-0220 coupler bars included in the product.

Apply silicone caulking around the perimeter and joints of panels to prevent water entry. Mask the contact surface area of the coupler bar to prevent caulking material contamination and reduce electrical bonding. If the panel is stand alone, coupler bars will not be required.

Use weather boot and retaining rings provided for larger diameters. Apply copper joint compound on both panel and coupler bar prior to installation.

To simplify installation, Weather Proofing Kits (WK-1) and Copper Clamping Kits (CKK) with conductive joint compound are available from PolyPhaser.

verizon wireless
 2441 HOLLOWAY RD
 LOUISVILLE, KY 40299
 PHONE (502) 552-0330
 FAX (502) 266-7548

BTM
 BTM ENGINEERING, INC.
 5001 WALTON STRAVAS DR
 LOUISVILLE, KY 40220
 PHONE (502) 459-8402
 FAX (502) 459-8427

STATE OF KENTUCKY
WOODROW W. MARCUM, JR.
 13602
 PROFESSIONAL ENGINEER
 LICENSE NO. 13602

SITE NAME: MYRHER

SITE ADDRESS: 1050 MCBRYER RD
 MOREHEAD, KY 40351

LATITUDE: 38° 08' 16.87" N
 LONGITUDE: 83° 26' 23.98" W

LEASE AREA: 5,000 SQ. FT.

TOWER TYPE: SELF-SUPPORT

TOWER HEIGHT: 290'

NO.	REVISION/ISSUE	DATE
1	ISSUE FOR COMMENT	5/24/07
2	ISSUE FOR CONST	6/22/07

TITLE: GPS ANTENNA DETAILS

SHEET: E-5

- NOTE:**
- 2 - "V" CLAMPS (8-9-5/8" B-6-5/8") PART NUMBER 104223
 - 1 - IN-LINE "V" CLAMP BRACKET PART NUMBER 119669
 - 2 - "V" CLAMPS PART NUMBER 116165
 - 1 - 1/2" MIN. 1-1/4" GALVANIZED PIPE (SUPPLIED BY CONTRACTOR)
 - 2 - 1/2"x6-1/2" GALVANIZED BOLTS PART NUMBER 311089
 - 2 - 1/2"x4" GALVANIZED BOLTS PART NUMBER 311073
 - 4 - 1/2" PLAIN NUTS GALVANIZED PART NUMBER 312500
 - 8 - 1/2" FLAT WASHERS GALVANIZED PART NUMBER 312122
 - 8 - GPS SHALL BE ATTACHED TO THE FIRST ICE-BRIDGE POST FROM THE SHELTER.
 - 10 - GPS SHALL HAVE MAXIMUM VIEW OF THE SOUTHERN SKY.
 - 11 - WHEN THE ABOVE CANNOT BE ACHIEVED CALL THE RESPONSIBLE CONSTRUCTION MGR.

NOTE:
 CONTRACTOR TO PROVIDE
 AND INSTALL ALL ITEMS
 LISTED ON THIS SHEET

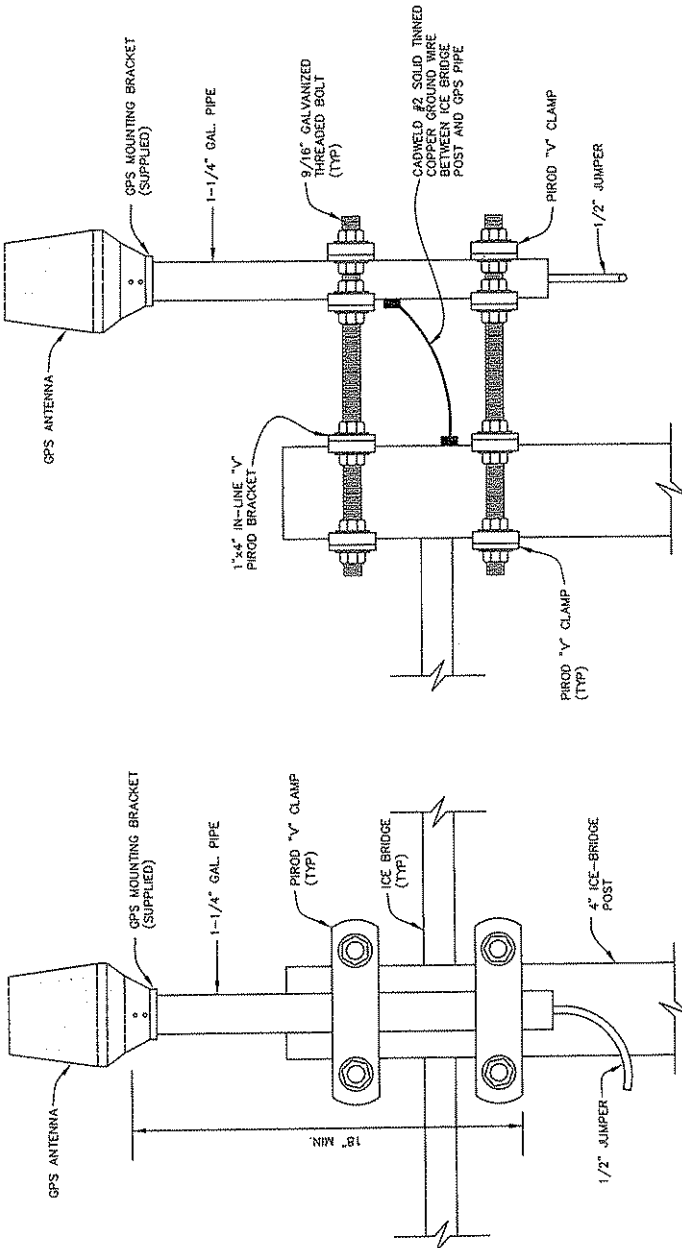

SIDE

FRONT

GPS ANTENNA DETAILS
 N.T.S.

ELECTRICAL GENERAL NOTES:

1. MOUNT METER CENTER ASSEMBLY ON METER CENTER BOARD STAND.
2. PROVIDE 2 - 4" CONDUITS WITH PULL LINES FROM TELCO SERVICE DROP AT POLE TO TELCO BOX ON METER CENTER STAND.
3. PROVIDE EQUIPMENT WITH HIGHER FAULT CURRENT AS NEEDED TO MATCH AVAILABLE FAULT CURRENT.
4. ALL ELECTRICAL WORK SHALL CONFORM TO THE NATIONAL ELECTRICAL CODE (EDITION ACCEPTED BY LOCAL JURISDICTION) AND APPLICABLE LOCAL CODES.
5. ALL ELECTRICAL ITEMS SHALL BE U.L. APPROVED OR LISTED.
6. ALL WIRES SHALL BE COPPER THHN/THWN. GROUND WIRES SHALL BE BARE TIN COATED UNLESS NOTED OTHERWISE.
7. CONDUCTORS SHALL BE INSTALLED IN GALVANIZED RIGID STEEL CONDUIT OR FLEXIBLE LIQUIDTIGHT CONDUIT AS INDICATED ON DRAWING. SECURE AUTHORIZATION WITH BUILDING REP. ON CONDUIT ROUTING.
8. CONTRACTOR SHALL OBTAIN ALL PERMITS AND INSPECTIONS, PAY PERMIT FEES AND SCHEDULE INSPECTIONS.
9. CONTRACTOR SHALL PROVIDE ALL LABOR AND MATERIAL DESCRIBED ON THIS DRAWING, AND ALL ITEMS INCIDENTAL TO COMPLETING AND PRESENTING THIS PROJECT AS FULLY OPERATIONAL.
10. UNDERGROUND GROUNDING CONNECTIONS SHALL BE EXOTHERMIC (CAD WELD) WELDS. CONNECTIONS TO GROUND BARS SHALL BE CAD WELD. BOND TO ALL METAL OBJECTS WITHIN 6' OF GROUNDING CONDUCTOR.
11. ROUTE GROUNDING CONDUCTORS ALONG THE SHORTEST AND STRAIGHTEST PATH POSSIBLE. VERIFY THE CONDUCTIVITY. BEND GROUNDING LEADS WITH A MINIMUM 12" RADIUS. CONTRACTOR TO PROVIDE ALL OFFSETS AND ADDITIONAL SUPPORTS AS REQUIRED AT EQUIPMENT CABINET ENTRY.
12. PROVIDE GROUND WIRES, BARS AND CONNECTIONS AS SHOWN ON THE GROUNDING PLAN AND GROUNDING DIAGRAM. TEST AND VERIFY THAT THE IMPEDANCE DOES NOT EXCEED 5 OHMS TO GROUND WITH THE USE OF A BIDDLE-MEGGER TESTER. GROUNDING AND OTHER OPERATIONAL TESTING SHALL BE WITNESSED BY THE OWNER'S REPRESENTATIVE.
13. NO 5/8" 10'-0" COPPERCLAD GROUND ROD SPACED AT 10' WITH CAD WELD CONNECTION TYPE "GTC-1860" (MOLD#) AND "C-130" (WELD METAL SIZE ONE PER LOCATION).
14. #2 SOLID WIRE BELOW GRADE TO BOND TO EACH TELEPHONE BUS BAR.
15. #2 SOLID WIRE BELOW GRADE TO BOND TO EACH ELECTRICAL SERVICE.
16. #2 SOLID WIRE TO TELEPHONE SERVICE AT METER BOARD.
17. #1/0 COPPER WIRE TO MAIN DISCONNECT SWITCH.
18. CAD WELD #2 SOLID COPPER WIRE TO EACH TOWER LEG.
19. CAD WELD TO FENCE CORNER POST 3" ABOVE GRADE
20. BOND (2) #2 SOLID TINNED WIRES TO GROUND BAR MOUNTED APPROXIMATELY 9'-0" ABOVE FINISHED GRADE ON TOWER LEG.
21. #2 GROUND CONDUCTOR MUST BE A MINIMUM 30" BELOW GRADE AND A MINIMUM OF 18" FROM ALL OBJECTS UNLESS SPECIFIED OTHERWISE.
22. CONTRACTOR SHALL PROVIDE TWO (2) FLEXIBLE STRAPS, ONE BETWEEN EACH GATE POST AND GATE. CADWELD EACH END.

GROUNDING NOTES:

1. APPLY ANTIOXIDANT COMPOUND TO ALL GROUND BARS & GROUND CONNECTIONS. WIPE CLEAN ALL EXCESS.
2. MAKE ALL CONNECTIONS TO GROUND BAR OR METAL EQUIPMENT ENCLOSURES WITH TWO-HOLE COMPRESSION LUGS. (SEE DETAIL)
3. GROUNDING CONNECTORS SHALL BE COPPER. NUTS, BOLTS AND WASHERS SHALL BE STAINLESS STEEL.
4. ALL GROUND WIRE SHALL HAVE A MINIMUM BENDING RADIUS OF 12"

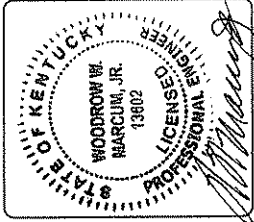
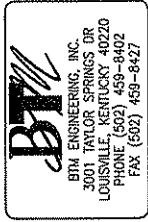

SITE NAME: ATXNH8R

SITE ADDRESS: 1050 HCRMAYER RD HCRSHEAD, KY 40351

LATITUDE: 38° 05' 19.57" N
LONGITUDE: 83° 28' 23.55" W

LEASE AREA: 5,000 SQ. FT.

TOWER TYPE: SELF-SUPPORT

TOWER HEIGHT: 280'

NO.	REVISION/ISSUE	DATE
1	ISSUE FOR COMMENT	5/24/07
2	ISSUE FOR CONST	6/22/07

TITLE: **ELECTRICAL & GROUNDING NOTES**

SHEET: **E-6**