

NORTHERN KENTUCKY  
WATER DISTRICT

RECEIVED

JUN 22 2006

PUBLIC SERVICE  
COMMISSION

*Project – Sub District F*

Campbell County  
184-188

# NORTHERN KENTUCKY WATER DISTRICT

## Sub District F Water Main Extension

<u>EXHIBIT</u>	<u>TITLE</u>
A	Project Description
B	Copy of Approving Board Meeting Minutes and of KIA Grant approval letters
C	ENGINEERING REPORTS Copy of project map, final engineering reports signed, sealed, and dated by a registered professional engineer. Bid Tabulations. Project Specifications and System Hydraulic Model.
D	Certified statement from an authorized utility Official confirming:  (1) That the proposed plans and specifications for the project have been designed to meet the minimum 807 Kar 5:066, Section 5 (3) and (4), section 6(1) through (3), Section 10 (1) and the section 11  (2) That all other state approvals have already been obtained  (3) Dates when construction will begin and end
E	Copy of Rate Schedule, Customer Notice and Proposed Tariff
F	Sources of Construction Funds
G	2005 Northern Kentucky Water District Annual Report for Class-A and Class-B Water Districts
H	Current Schedule of Outstanding Bonds, Notes, and other Indebtedness, Balance Sheet and Income Statement



Case No. 200-\_\_\_\_\_  
Exhibit \_\_\_\_\_ A \_\_\_\_\_

NORTHERN KENTUCKY  
WATER DISTRICT

**Project – Sub District F**

Campbell County  
184-188

Project Description

## Sub District F Water Main Extension

Project 184-188

### Project Description:

The proposed project, involves approximately 34,800 linear feet of new 8" and 12" water main in the following areas of unincorporated Campbell County that has been divided into three bid packages.

#### Bid Package A:

- Approximately 7,400 linear feet of 8" water main along from Grandview Road from Ridgewood Drive to the existing waiting main,
- Approximately 300 linear feet of 8" water main along Amy Lou Drive from Grandview Road to the existing cross-county main from Whitewood Court,
- Approximately 3,600 linear feet of 8" water main along Heck Road from Upper Tug Fork Road to the end of Heck Road,

#### Bid Package B:

- Approximately 3,000 linear feet of 8" water main along West Main Street from Licking Pike to the existing water main,
- Approximately 2,500 linear feet of 8" water main along Steffen Road from the existing main to the end of Steffen Road
- Approximately 13,100 linear feet of 12" water main along Licking Pike from Trapp Road to the end of the existing main near Poplar Thicket,
- Approximately 2,300 linear feet of 8" water main along Licking Pike from Deer Run Road to Cold Stream Road.

#### Bid Package C:

- Approximately 5,300 Linear feet of 8" water main along Flagg Springs Pike from Smith Road to Kennedy Road and along Kennedy Road from Flagg Springs Pike to the AA Highway.

The estimated cost of the total project is \$2,539,803.00

This project will extend 8 inch and 12 inch water mains to make public water available to 136 currently unserved residents. After all phases of this project are completed this will improve water quality and fire protection in the area.

Bidding for the project was advertised on April 22, 2006 and bids opened on May 10, 2006. The bids will expire on August 8, 2006.

<b>Street Name</b>	<b>Unserved Residents</b>	<b>Sign-ups</b>
Grandview Road/Amy Lou Drive	43	22
Heck Road	12	4
Licking Pike (From Deer Run to Cold Stream)	7	2
Licking Pike ( From Tapp Road to Poplar Thicket)	38	11
Steffen Road	11	3
W. Main St.	10	2
Flagg Springs Pike	15	
<b>Total</b>	<b>136</b>	<b>44</b>

NORTHERN KENTUCKY WATER DISTRICT  
 SUBDISTRICT - F  
 CAMPBELL COUNTY SERVICE AREA  
 Bid Prices

	STREET	DISTANCE MILES	TOTAL AVAIL. CUST	BID COST
Pk. A	Grandview Rd. (incl. Amy Lou Dr.)	1.70	43	\$485,426
	Heck Rd.	0.70	12	
	West Main Street	0.5	10	\$936,568
	Steffen Road	0.4	11	
Pk. B	Licking Pike (Existing 8 to Ripple Creek)	0.4	7	\$165,292
	Licking Pike From Trapp Rd to Rifle Range	1.7	31	
	Licking Pike from Rifle Range to Sub-D	0.85	7	
	Licking Pike 12" Upgrade Cost			
Pk. C	Flagg Springs (Route 10)	1	15	\$195,305
		<b>7.25</b>	<b>136</b>	<b>\$1,782,591</b>

Cost Estimate:

1	Construction	\$1,782,591
2	Engineering	\$54,800
3	Geotechnical	\$23,311
4	Geotechnical Inspection (0.06%)	\$10,696
	KIA Administrative Fee (1/2 of 1%)	\$6,440
6	Legal	\$15,000
7	Contingencies	\$646,965
	Total	<u>\$2,539,803</u>

Source of Funds:

1	KIA/State Budget Funding	\$1,288,000
2	Campbell County Fiscal Court	\$25,000
3	Flagg Springs Market	\$55,000
4	Northern Ky Water Dist. Bond Issue	
4a	NKWD Extension Contribution	\$750,000
4b	NKWD Hydraulic Improvement Contr.	\$175,515
4c	NKWD Customer Surcharge	\$246,288
	Total	<u>\$2,539,803</u>





NORTHERN KENTUCKY  
WATER DISTRICT

**Project – Sub District F**

Campbell County

184-188

Approving Board Of Commissioners  
Meeting Minutes and  
KIA Grant Approval Letters

May 18, 2006 Board Meeting Minutes  
to be considered for approval  
on June 23, 3006

**Northern Kentucky Water District  
Board of Commissioners Meeting  
January 19, 2006**

A regular meeting of the Board of Commissioners of the Northern Kentucky Water District was held on January 19, 2006 at the District's Aqua Drive office. All Commissioners were present. Also present were Ron Lovan, Richard Harrison, Bari Joslyn, Mark Lofland, Jack Bragg, Bill Wulfeck, Mary Carol Wagner, Jim Dierig, Bob Buhrlage, Amy Kramer, Don Gibson, Scott Shepherd, Connie Pangburn, Don Fritz, Adam Davey and Charles Pangburn.

Commissioner Koester called the meeting to order.

Commissioner Wagner led those in attendance in the Pledge of Allegiance.

Mr. Lofland and Mr. Harrison of the District staff delivered a presentation to the Board on the District's Rates, Rules and Regulations.

The Board recognized Commissioner Wagner for his two years of leadership and service as Chair of the Board of Commissioners.

The Board reviewed articles published and correspondence received since the last regular Board meeting on December 15, 2005.

Mr. Fritz and Mr. Davey of Von Lehman & Company, Inc. presented the results of their internal control review of the District.

On motion of Commissioner Collins, seconded by Commissioner Sommerkamp, the Board unanimously approved the minutes for the regular Board meeting held on December 15, 2005.

On motion of Commissioner Wagner, seconded by Commissioner Collins, and after discussion, the Board unanimously approved the expenditures of the District for the month of December, 2005.

On motion of Commissioner Jackson, seconded by Commissioner Collins, and after discussion, the Board unanimously agreed to award a contract for lightweight uniform apparel to Van Dyne Crotty, Inc. and to authorize the execution of contract documents.

On motion of Commissioner Wagner, seconded by Commissioner Sommerkamp, and after discussion, the Board unanimously agreed to authorize an increase in the Redstone Road Water Main Extension project budget to \$114,200.00, to award the project to United Plumbing & Sewer Repair, and to authorize the execution of contract documents.

On motion of Commissioner Wagner, seconded by Commissioner Collins, and after discussion, the Board unanimously agreed to award a contract for the construction of bulk water

fill stations on Johns Hill Road, Aqua Drive and Decoursey Pike and at a fourth location near Piner to Krebs Construction and to authorize the execution of contract documents.

On motion of Commissioner Collins, seconded by Commissioner Wagner, and after discussion, the Board unanimously agreed to award a contract, with a possible one-year extension, to Ranger Construction Services, Inc. for new water service installation and to authorize the execution of contract documents

On motion of Commissioner Wagner, seconded by Commissioner Jackson, all Commissioners except Commissioner Collins agreed to authorize the execution of an agreement with DNS Properties, LLC for the extension of water service. Commissioner Collins abstained from the vote.

On motion of Commissioner Sommerkamp, seconded by Commissioner Wagner, and after discussion, the Board unanimously agreed to authorize the execution of engineering contract documents with Thelen Associates for the design of the Subdistrict F Water Main Extension project.

On motion of Commissioner Collins, seconded by Commissioner Macke, and after discussion, the Board unanimously agreed to authorize the execution of engineering contract documents with Viox & Viox, Inc. for the design of the Subdistrict G Water Main Extension project, including the Banklick Road addendum.

On motion of Commissioner Wagner, seconded by Commissioner Jackson, and after discussion, the Board unanimously agreed to authorize the purchase of Steelcase office furniture for the new Central Facility from Loth.

On motion of Commissioner Wagner, seconded by Commissioner Macke, and after discussion, the Board unanimously agreed to authorize the execution of engineering contract documents with EMH&T Inc. for the performance of construction phase services for the new .75 MG Claryville Tank project, including the repainting and rehabilitation of the South County Tank.

On motion of Commissioner Collins, seconded by Commissioner Sommerkamp, and after discussion, the Board unanimously agreed to award the 2006 asphalt restoration contract to Hall's Paving and Sealing and to authorize the execution of contract documents.

The Board reviewed the District's financial reports and department reports.

The Board agreed to move the regular meeting in June 2006 from June 15, 2006 to June 23, 2006.

Other matters of a general nature were discussed.

On motion of Commissioner Wagner, seconded by Commissioner Jackson, the Board unanimously agreed to go into executive session under the provisions of KRS 61.810(1)(f) to discuss a personnel matter.

Mr. Pangburn departed the meeting.

The Board returned to open session.

On motion of Commissioner Wagner, seconded by Commissioner Collins, the Board unanimously agreed to authorize and direct Commissioner Koester to execute an amendment to Mr. Lovan's employment agreement incorporating changes specified by the Board.

There being no further business to come before the Board, the meeting was adjourned.

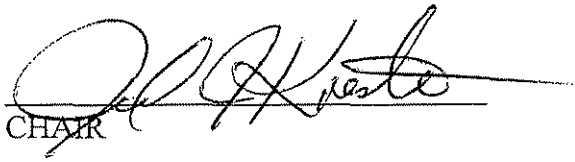
  
CHAIR

  
SECRETARY

**Northern Kentucky Water District  
Board of Commissioners Meeting  
May 18, 2006**

A regular meeting of the Board of Commissioners of the Northern Kentucky Water District was held on May 18, 2006 at the District's Central Facility at 2835 Crescent Springs Road in Erlanger, Kentucky. All Commissioners were present. Also present were Ron Lovan, Richard Harrison, Bari Joslyn, Mark Lofland, Jack Bragg, Bill Wulfeck, Mary Carol Wagner, Amy Kramer, Don Gibson, Bob Buhrlage, Jim Dierig, Kevin Owen and Charles Pangburn.

Commissioner Koester called the meeting to order.

Commissioner Wagner led those in attendance in the Pledge of Allegiance.

Mr. Bragg of the District staff delivered a presentation to the Board on the Order of the Public Service Commission in Case No. 2005-00148, dated April 28, 2006.

The Board reviewed articles published and correspondence received since the last regular Board meeting on April 25, 2006.

On motion of Commissioner Collins, seconded by Commissioner Wagner, the Board unanimously approved the minutes for the regular Board meeting held on April 25, 2006.

On motion of Commissioner Sommerkamp, seconded by Commissioner Wagner, and after discussion, the Board unanimously approved the expenditures of the District for the month of April, 2006.

On motion of Commissioner Macke, seconded by Commissioner Jackson, and after discussion, the Board unanimously agreed to authorize the execution of appropriate contract documents to purchase the following materials from the vendors indicated:

4-36" pipe glands	Water Works Supplies
4-24" pipe glands	Water Works Supplies
Two 36" 250 psi valves	Water Works Supplies
36" x 36" x 24" ductile iron tee	Ferguson Waterworks
30,000 feet of ¾" copper service piping	S.L.C. Meter Service, Inc.
5000 feet of 1" copper service piping	S.L.C. Meter Service, Inc.

On motion of Commissioner Macke, seconded by Commissioner Wagner, and after discussion, the Board unanimously agreed to award the contract for the Fender & Truesdell Road Water Main Replacement Project to G.M. Pipeline and to authorize the execution of contract documents.

On motion of Commissioner Sommerkamp, seconded by Commissioner Collins, and after discussion, the Board unanimously agreed to award Packages A & B of the Subdistrict F Water Main Extension Project to Howell Contractors, Inc. and Package C of the Project to Coomer Contractors and to authorize the execution of appropriate contract documents.

On motion of Commissioner Collins, seconded by Commissioner Sommerkamp, and after discussion, the Board unanimously approved a resolution authorizing the District to file a loan application and appointing its President/CEO as its official project representative with regard to the Drinking Water State Revolving Fund project.

On motion of Commissioner Wagner, seconded by Commissioner Sommerkamp, and after discussion, the Board unanimously agreed to award contracts to the following vendors for the chemicals indicated and to authorize the execution of contract documents:

KA Steel Chemicals, Inc.	50% caustic soda
Bonded Chemicals, Inc.	copper sulfate
LCI Ltd.	23% hydrofluorosilicic acid
Kemiron Companies, Inc.	ferric sulfate
Bonded Chemicals, Inc.	potassium permanganate
NORIT Americas, Inc.	powdered activated carbon
Univar USA, Inc.	12.5% sodium hypochloride
GAC MidAmerica Inc.	corrosion inhibitor (GenPhos 7030)
SAL Chemical Company	alum-polymer blend (Clar + Ion 5055)
SAL Chemical Company	ferric-polymer blend (Fer + Ion 305)
SAL Chemical Company	polyaluminum chloride (Hyper + Ion 1090)
SAL Chemical Company	polyaluminum chloride (Hyper + Ion 1750)

The Board reviewed the District's financial reports and department reports.

Mr. Dierig and Mr. Owen of the District staff provided an update to the Board on the sludge removal project at the Fort Thomas Treatment Plant.

The Board unanimously agreed to move the regular Board meeting in July to July 26 at 12:30 p.m.

On motion of Commission Collins, seconded by Commissioner Wagner the Board unanimously agreed to go into executive session under the provisions of KRS 61.810(1)(c) to discuss proposed or pending litigation.

The Board returned to open session.

There being no further business to come before the Board, the meeting was adjourned.

---

CHAIR

---

SECRETARY



**KENTUCKY INFRASTRUCTURE AUTHORITY**

**Ernie Fletcher**  
Governor

Capital Center Complex  
1024 Capital Center Drive, Suite 340  
Frankfort, Kentucky 40601  
(502) 573-0260  
(502) 573-0157  
kia.ky.gov

**Jody E. Hughes**  
Executive Director

May 18, 2005

Mr. Ron Barrow, Vice President  
Northern Kentucky Water District  
100 Aqua Drive  
Cold Spring, KY 41076

RE: Northern Kentucky Water District - Water Line Extension (WX21037552)  
Grant Award in the amount of \$688,000

Dear Mr. Barrow:

Congratulations on the grant you received from Governor Ernie Fletcher and the General Assembly of the Commonwealth of Kentucky awarded during the 2005 Legislative Session. You are strongly encouraged to view these funds as "seed" money and to match these dollars with other funding sources in order to realize the maximum benefit from your grant award. The Kentucky Infrastructure Authority (KIA) is pleased to have been designated as the agency for administration of these infrastructure project grants. In an effort to ensure that your community receives the level of support it deserves, language was included in the 2005 Budget of the Commonwealth to provide 0.5% of each grant as an administrative fee to KIA.

To make this a successful grant process, KIA wants to update you on some important timing issues with respect to funding and administration.

**First, your grant funds will be available some time after August 1, 2005.** We are working with the State Budget Director's Office to determine the precise date of availability. When the grant funds become available, you must have a fully executed grant assistance agreement and your project must meet all grant requirements and be reviewed by the Capital Projects and Bond Oversight Committee before funds can be released. Primary requirements are discussed in the next paragraph. Detailed requirements will be provided to your Project Administrator. Special consideration will be given to projects needing attention prior to August 1, 2005.

**Second, if your project is ready to go, do not stop progress if you have interim funding available.** Your grant funds will still be available even if you have started your project. However, the expenditure of all project funds must comply with appropriate procurement process and the project must conform to the budget and grant requirements, be approved by the Area Water Management Council and endorsed by the Kentucky e-Clearinghouse. We will work with your designated project administrator to make sure all conditions necessary for reimbursement are satisfied.



**Third, we need your help. KIA needs to know:**

- A. Your designee for Project Administrator to work with KIA and be responsible for completion of all of the grant documentation and requirements.** Your Project Administrator will be responsible for coordinating proper procurement of all necessary contracts and for completing all requirements of the grant. Please be assured that you will be copied on all essential correspondence and consulted on all decisions regarding your grant. **Exhibit 1.**
  
- B. Your project's WX or SX number.** Having this project identifying number will assure that you have coordinated with your Area Water Management Council and your project meets the budget requirements. If your grant award is not yet linked to a project profile with a WX or SX number, it is critical that you contact your Area Water Management Council very soon to get a project designated. If you plan on using your grant funds for more than one project, each project will need a WX or SX number. **Exhibit 2.**

**Please fill out the attached Exhibits and return to KIA by Wednesday, June 1, 2005.** As soon as we receive your designation for Project Administrator, we will be in direct contact with that person regarding the specific requirements and the steps involved in accessing your grant funds. There will a workshop held in the near future to discuss all required grant documentation, so it is important that we receive your response as soon as possible.

Again, we are pleased to be a part of this important effort to improve infrastructure for citizens throughout the Commonwealth. We pledge our full cooperation and look forward to working with you and your Project Administrator in the coming months.

Sincerely,



Jody E. Hughes  
Executive Director

Enclosures

c: Scott Kimmich, Chair, Area Water Management Planning Council  
Chris Sandfoss, Water Service Coordinator



KENTUCKY INFRASTRUCTURE AUTHORITY

56 F  
WJX21037552

Ernie Fletcher  
Governor

Capital Center Complex  
1024 Capital Center Drive, Suite 340  
Frankfort, Kentucky 40601  
(502) 573-0260  
(502) 573-0157  
kia.ky.gov

Jody E. Hughes  
Executive Director

May 18, 2005

Mr. Steven Pendery, County Judge/Executive  
Campbell County Fiscal Court  
Campbell County Fiscal Court  
24 West 4th Street  
Newport, KY 41071-4152

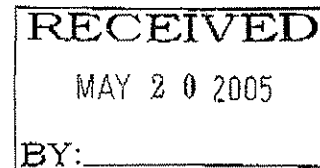

RE: Campbell County Fiscal Court - Various Water and Sewer Projects  
Grant Award in the amount of \$600,000

Dear Judge Pendery:

Congratulations on the grant you received from Governor Ernie Fletcher and the General Assembly of the Commonwealth of Kentucky awarded during the 2005 Legislative Session. You are strongly encouraged to view these funds as "seed" money and to match these dollars with other funding sources in order to realize the maximum benefit from your grant award. The Kentucky Infrastructure Authority (KIA) is pleased to have been designated as the agency for administration of these infrastructure project grants. In an effort to ensure that your community receives the level of support it deserves, language was included in the 2005 Budget of the Commonwealth to provide 0.5% of each grant as an administrative fee to KIA.

To make this a successful grant process, KIA wants to update you on some important timing issues with respect to funding and administration.

**First, your grant funds will be available some time after August 1, 2005.** We are working with the State Budget Director's Office to determine the precise date of availability. When the grant funds become available, you must have a fully executed grant assistance agreement and your project must meet all grant requirements and be reviewed by the Capital Projects and Bond Oversight Committee before funds can be released. Primary requirements are discussed in the next paragraph. Detailed requirements will be provided to your Project Administrator. Special consideration will be given to projects needing attention prior to August 1, 2005.

**Second, if your project is ready to go, do not stop progress if you have interim funding available.** Your grant funds will still be available even if you have started your project. However, the expenditure of all project funds must comply with appropriate procurement process and the project must conform to the budget and grant requirements, be approved by the Area Water Management Council and endorsed by the Kentucky e-Clearinghouse. We will work with your designated project administrator to make sure all conditions necessary for reimbursement are satisfied.



Page 2  
May 18, 2005

Third, we need your help. KIA needs to know:

- A. **Your designee for Project Administrator to work with KIA and be responsible for completion of all of the grant documentation and requirements.** Your Project Administrator will be responsible for coordinating proper procurement of all necessary contracts and for completing all requirements of the grant. Please be assured that you will be copied on all essential correspondence and consulted on all decisions regarding your grant. **Exhibit 1.**
- B. **Your project's WX or SX number.** Having this project identifying number will assure that you have coordinated with your Area Water Management Council and your project meets the budget requirements. If your grant award is not yet linked to a project profile with a WX or SX number, it is critical that you contact your Area Water Management Council very soon to get a project designated. If you plan on using your grant funds for more than one project, each project will need a WX or SX number. **Exhibit 2.**

Please fill out the attached Exhibits and return to KIA by Wednesday, June 1, 2005. As soon as we receive your designation for Project Administrator, we will be in direct contact with that person regarding the specific requirements and the steps involved in accessing your grant funds. There will a workshop held in the near future to discuss all required grant documentation, so it is important that we receive your response as soon as possible.

Again, we are pleased to be a part of this important effort to improve infrastructure for citizens throughout the Commonwealth. We pledge our full cooperation and look forward to working with you and your Project Administrator in the coming months.

Sincerely,

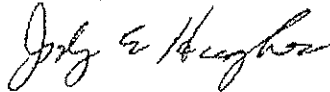

Jody E. Hughes  
Executive Director

Enclosures

- c: Scott Kittrich, Chair, Area Water Management Planning Council  
Chris Sandfoss, Water Service Coordinator



NORTHERN KENTUCKY  
WATER DISTRICT

**Project – Sub District F**

Campbell County  
184-188

Engineering Reports

Engineers Final Estimate

Bid Tabulation and Engineer's Recommendation

System Hydraulic Model

Project Map

Project Specifications  
(See Attached Specifications)

Case No. 200-\_\_\_\_\_  
Exhibit     C    

NORTHERN KENTUCKY  
WATER DISTRICT

**Project – Sub District F**

Campbell County  
184-188

Engineer's Final Estimate

*Subdistrict F Water System Improvements  
Northern Kentucky Water District  
Final Construction Cost Estimate  
April 24, 2006*

**BID PACKAGE A  
Grandview Road/Amy Lou Drive Areas**

<i>Item No.</i>	<i>Item</i>	<i>Qty.</i>	<i>Unit</i>	<i>Unit Price</i>	<i>Total Price</i>
1	- General Conditions/Mobilization/Demobilization	1	LS	\$ 12,500	\$ 12,500
2	- 8-inch PVC C900 Watermain	3,682	LF	\$ 25	\$ 92,050
3	- 8-inch DI Class 50 Watermain	3,689	LF	\$ 35	\$ 129,115
4	- 8-inch Gate Valves	8	EA	\$ 1,800	\$ 14,400
5	- Fire Hydrants and Valve	10	EA	\$ 2,250	\$ 22,500
6	- Air Release Valve	1	EA	\$ 1,500	\$ 1,500
7	- 8-inch DI Class 50 Watermain, Open Cut Thru Road	57	LF	\$ 85	\$ 4,845
8	- 8-inch PVC C900 Watermain, Open Cut Thru Road	188	LF	\$ 65	\$ 12,220
9	- Connection to Existing Mains (incl valve)	3	EA	\$ 7,500	\$ 22,500
10	- Mill and Re-Pave Full Width of Road	451	SY	\$ 50	\$ 22,550
11	- Concrete Driveway Replacement	90	LF	\$ 60	\$ 5,400
12	- Bituminous Pavement Replacement	180	LF	\$ 40	\$ 7,200
13	- Erosion Control Measures	1	LS	\$ 10,000	\$ 10,000
14	- Miscellaneous Construction (15%)	1	LS	\$ 53,517	\$ 53,517
<b>Area Construction Sub-Total</b>					<b>\$ 410,297</b>

**Heck Road Area**

<i>Item No.</i>	<i>Item</i>	<i>Qty.</i>	<i>Unit</i>	<i>Unit Price</i>	<i>Total Price</i>
1	- General Conditions/Mobilization/Demobilization	1	LS	\$ 5,000	\$ 5,000
2	- 8-inch PVC C900 Watermain	1,940	LF	\$ 25	\$ 48,500
3	- 8-inch DI Class 50 Watermain	1,355	LF	\$ 35	\$ 47,425
4	- 8-inch Gate Valve	2	EA	\$ 1,800	\$ 3,600
5	- Fire Hydrants and Valve	4	EA	\$ 2,250	\$ 9,000
6	- 8-inch PVC C900 Watermain, Open Cut Thru Road	120	LF	\$ 65	\$ 7,800
7	- 8-inch DI Class 50 Watermain, Open Cut Thru Road	245	LF	\$ 85	\$ 20,825
8	- Mill and Re-Pave Full Width of Road	245	SY	\$ 50	\$ 12,250
9	- Mill and Re-Pave Single Lane of Road	289	SY	\$ 50	\$ 14,450
10	- Concrete Driveway Replacement	25	LF	\$ 60	\$ 1,500
11	- Bituminous Pavement Replacement	105	LF	\$ 45	\$ 4,725
12	- Connection to Existing Mains (incl valve)	1	LS	\$ 7,500	\$ 7,500
13	- Erosion Control Measures	1	LS	\$ 3,500	\$ 3,500
14	- Miscellaneous Construction (15%)	1	LS	\$ 27,911	\$ 27,911
<b>Area Construction Sub-Total</b>					<b>\$ 213,986</b>

**Bid Package A Estimated Construction Cost**

**\$ 624,283**

**BID PACKAGE B**  
**West Main Street Area (KY 10)**

<i>Item No.</i>	<i>Item</i>	<i>Qty.</i>	<i>Unit</i>	<i>Unit Price</i>	<i>Total Price</i>
1	- General Conditions/Mobilization/Demobilization	1	LS	\$ 7,500	\$ 7,500
2	- 8-inch Class 50 DI Watermain	2,560	LF	\$ 35	\$ 89,600
3	- 8-inch Gate Valve	2	EA	\$ 1,800	\$ 3,600
4	- Fire Hydrants and Valve	1	EA	\$ 2,250	\$ 2,250
5	- Leak Detection Assembly	1	EA	\$ 1,000	\$ 1,000
6	- 8-inch DI Class 50 Watermain, Open Cut Thru Road	230	LF	\$ 65	\$ 14,950
7	- 8-inch DI Class 50 Watermain, Directional Drill	150	LF	\$ 85	\$ 12,750
8	- Mill and Re-Pave Full Width of Road	200	SY	\$ 50	\$ 10,000
9	- Mill and Re-Pave Single Lane of Road	155	SY	\$ 50	\$ 7,750
10	- Connection to Existing Mains (incl valve)	2	EA	\$ 7,500	\$ 15,000
11	- Bituminous Pavement Replacement	50	LF	\$ 45	\$ 2,250
12	- Erosion Control Measures	1	LS	\$ 3,500	\$ 3,500
13	- Miscellaneous Construction (15%)	1	LS	\$ 25,523	\$ 25,523
<b>Area Construction Sub-Total</b>					<b>\$ 195,673</b>

**Steffen Road Area**

<i>Item No.</i>	<i>Item</i>	<i>Qty.</i>	<i>Unit</i>	<i>Unit Price</i>	<i>Total Price</i>
1	- General Conditions/Mobilization/Demobilization	1	LS	\$ 7,500	\$ 7,500
2	- 8-inch DI Class 50 Watermain	1,665	LF	\$ 35	\$ 58,275
3	- 8-inch PVC C900 Watermain	590	LF	\$ 25	\$ 14,750
4	- 8-inch Gate Valve	1	EA	\$ 1,800	\$ 1,800
5	- Fire Hydrants and Valve	3	EA	\$ 2,250	\$ 6,750
6	- 8-inch DI Class 50 Watermain, Open Cut Thru Road	255	LF	\$ 65	\$ 16,575
7	- Mill and Re-Pave Single Lane Width of Road	283	SY	\$ 50	\$ 14,150
8	- Connect to Existing System	1	EA	\$ 7,500	\$ 7,500
9	- Erosion Control Measures	1	LS	\$ 3,500	\$ 3,500
10	- Miscellaneous Construction (15%)	1	LS	\$ 19,620	\$ 19,620
<b>Area Construction Sub-Total</b>					<b>\$ 150,420</b>

**Licking Pike Area (KY 915)**

<i>Item No.</i>	<i>Item</i>	<i>Qty.</i>	<i>Unit</i>	<i>Unit Price</i>	<i>Total Price</i>
1	- General Conditions/Mobilization/Demobilization	1	LS	\$ 3,500	\$ 3,500
2	- 6-inch Gate Valve	1	EA	\$ 1,500	\$ 1,500
3	- 8-inch DI Class 50 Watermain	2,329	LF	\$ 35	\$ 81,515
4	- 8-inch Gate Valve	2	EA	\$ 1,800	\$ 3,600
5	- 12-inch DI Class 50 Watermain	12,471	LF	\$ 50	\$ 623,550
6	- 12-inch Gate Valve	12	EA	\$ 2,200	\$ 26,400
7	- Fire Hydrants	13	EA	\$ 2,250	\$ 29,250
8	- Air Release Valve	1	EA	\$ 1,500	\$ 1,500
9	- Leak Detection Assembly	2	EA	\$ 1,000	\$ 2,000
10	- 8-inch DI Class 50 Watermain, Open Cut Thru Road	61	LF	\$ 65	\$ 3,965
11	- 12-inch DI Class 50 Watermain, Open Cut Thru Road	689	LF	\$ 85	\$ 58,565
12	- 16-inch Steel Encasement Pipe, Open Cut Thru Stream	50	LF	\$ 125	\$ 6,250
13	- 24-inch Steel Encasement Pipe, Open Cut Thru Stream	40	LF	\$ 150	\$ 6,000
14	- Mill and Re-Pave Full Width of Road	111	SY	\$ 50	\$ 5,550
15	- Mill and Re-Pave Single Lane Width of Road	739	SY	\$ 50	\$ 36,950
16	- Connection to Existing Mains (incl valve)	3	EA	\$ 7,500	\$ 22,500
17	- Bituminous Pavement Replacement	125	LF	\$ 45	\$ 5,625
18	- Erosion Control Measures	1	LS	\$ 10,000	\$ 10,000
19	- Miscellaneous Construction (15%)	1	LS	\$ 137,733	\$ 137,733
<b>Area Construction Sub-Total</b>					<b>\$ 1,065,953</b>

**Bid Package B Estimated Construction Cost**

**\$ 1,412,046**



**BID PACKAGE C**  
**Flagg Springs Pike/Kennedy Road/Ivor Road Areas**

<i>Item No.</i>	<i>Item</i>	<i>Qty.</i>	<i>Unit</i>	<i>Unit Price</i>	<i>Total Price</i>
1	- General Conditions/Mobilization/Demobilization	1	LS	\$ 10,000	\$ 10,000
2	- 8-inch DI Class 50 Watermain	5,320	LF	\$ 35	\$ 186,200
3	- 8-inch Gate Valve	5	EA	\$ 1,800	\$ 9,000
4	- Fire Hydrants	5	EA	\$ 2,250	\$ 11,250
5	- 8-inch DI Class 50 Watermain, Open Cut Thru Road	40	EA	\$ 65	\$ 2,600
6	- Mill and Re-Pave Full Width of Road	34	SY	\$ 50	\$ 1,700
7	- Connection to Existing Mains (incl valve)	1	EA	\$ 7,500	\$ 7,500
8	- Miscellaneous Construction (15%)	1	LS	\$ 34,238	\$ 34,238
<b>Area Construction Sub-Total</b>					<b>\$ 262,488</b>

*Bid Package C Estimated Construction Cost* \$ 262,488

<b>Total Preliminary Estimate of Construction Costs - All Areas</b>	<b>\$ 2,298,816</b>
---	---------------------

Case No. 200-\_\_\_\_\_  
Exhibit     C    

NORTHERN KENTUCKY  
WATER DISTRICT

**Project – Sub District F**

Campbell County  
184-188

Bid Tabulation and  
Engineer's Recommendation

Bid Opening for  
 Sub-District F  
 May 10, 2006  
 10:00 am

Company	Package A Bid Amount	Package B Bid Amount	Package C Bid Amount
Howell Contractors, Inc.	\$ 485,426.00	\$ 1,095,860.00	\$ 217,024.00
Coomer Contractors	\$ 548,008.00	\$ 1,418,529.00	\$ 195,305.00
Hartman & Smith Const. Co.	NO BID	NO BID	\$ 278,352.00
Generation 2 Construction	NO BID	NO BID	\$ 248,109.50
Paul Rack Excavating & Paving Co.	\$ 522,531.75	NO BID	\$ 295,150.90
Miami-Western Contractors, Inc.	\$ 592,446.00	\$ 1,286,028.00	NO BID
Fred A. Nemann Company	\$ 642,027.00	NO BID	NO BID
United Plumbing & Sewer Services	NO BID	NO BID	\$ 247,999.00
Jack Gemmer & Sons	NO BID	NO BID	\$ 245,690.00



May 16, 2006

Mr. John Scheben  
Northern Kentucky Water District  
2835 Crescent Springs Road  
Erlanger, KY 41018

Re : Recommendation of Award  
Subdistrict F Waterline Extensions  
Campbell County, KY

Quest Engineers, Inc.

*Lexington:*  
2517 Sir Barton Way  
Lexington, KY 40509  
859-223-3755  
859-223-3150 (Fax)

*Louisville:*  
One Riverfront Plaza  
401 West Main Street  
Suite 500  
Louisville, KY 40202  
502-584-4118  
502-589-3009 (Fax)

*Cincinnati:*  
1251 Kemper Meadow Drive  
Suite 600  
Cincinnati, OH 45240  
513-851-9774  
513-851-9207 (Fax)

Dear John,

As you are aware, bids were received and opened publicly on May 10, 2006 for the above project. Prospective bidders were requested to provide bids for items relating to the installation of approximately 37,570 linear feet of 8-inch and 12-inch waterlines together with all necessary appurtenances. The work was broken into 3 packages in order to encourage bidders of all sizes and to expedite the installation schedule. Bidders were encouraged to bid on single packages as well as the entire project.

We received responsive bids from nine construction firms for the various packages. The number of responsive bids received for each package is identified below:

- Bid Package "A" - 5 bids
- Bid Package "B" - 3 bids
- Bid Package "C" - 7 bids

All of the bids included the appropriate acknowledgment of addendum and a 10% bid bond. The unit price bids were close in each Bid Package which indicates the bidding was very competitive. In addition, each of the Bid Packages came in under Quest's estimate for the work. We believe this indicates that the contractors understood the scope of work and provided their best pricing. Quest has reviewed the math on each of the bids and found two errors. Neither error had an impact on the order of finish although one of the errors was by the low bidder on Bid Package "B" (Howell Contractors). This error will change the amount of the award by \$ 6,000. The other error was a substantial error on a unit price entry that caused a large change on the Bid Package "A" submittal of Paul Rack Excavating.

The bid results are summarized below. A certified bid tabulation is attached to this letter.

**Results of Bid**  
***Subdistrict F Waterline Extensions***

<i>Bidder</i>	<i>Bid Package "A"</i>	<i>Bid Package "B"</i>	<i>Bid Package "C"</i>
Howell Contractors	\$485,426.00	\$1,101,860.00*	\$217,024.00
Coomer Contractors	\$548,008.00	\$1,418,529.00	<b>\$195,305.00</b>
Paul Rack Excavating & Paving	\$1,169,942.25*		\$295,150.90
Miami Western Contractors, Inc.	\$592,446.00	\$1,286,028.00	
Fred A Newman Company	\$642,027.00		
Jack Gemmer & Sons			\$245,690.00
United Plumbing			\$247,999.00
Generation 2 Construction, Inc.			\$248,109.50
Hartman & Smith Construction			\$278,352.00
<i>Engineers Estimate</i>	<i>\$624,283.00</i>	<i>\$1,383,362.00</i>	<i>\$262,488.00</i>

\* Denotes mathematical error on bid form. This is the corrected amount.

Howell Contractors is the low bidder on Bid Packages "A" and "B" while Coomer Contractors is the low bidder on Bid Package "C". We understand from our discussions with Northern Kentucky Water District (NKWD) staff that both construction companies have successfully completed previous projects for the NKWD. Further, we understand that NKWD has been satisfied with the quality of their work on these projects. Based on this information, Quest recommends the Bid Packages be awarded to them at the contract prices identified above.

Once NKWD has reached a decision regarding the award of this project, please let us know and we will assist in preparing the contract documents. If you have any questions about this matter, please feel free to call me at (859) 223-3755.

Kindest regards,



Brent A. Tippey, P.E.  
Project Manager

Attachments

**Bid Tabulation**  
**Subdistrict F Waterline Extension**  
**Campbell County, Kentucky**  
**Northern Kentucky Water District**  
**Bids Received: May 10, 2006**

Item No.	Description	Unit	Approx Qty	Howell Contractors, Inc.		Paul Rack Excavating & Paving Company*		Coomer Contractors	
				Unit Price	Total Item Amount	Unit Price	Total Item Amount	Unit Price	Total Item Amount
1	8" Class 50DI Water Line	LF	3,780	\$35.00	\$132,300.00	\$35.38	\$133,736.40	\$35.00	\$132,300.00
2	8" C-900 PVC Water Line	LF	3,755	32.00	120,160.00	35.38	132,851.90	30.00	112,650.00
3	8' Gate Valve	EA	8	900.00	7,200.00	950.00	7,600.00	2,000.00	16,000.00
4	Fire Hydrant Assembly	EA	9	2,500.00	22,500.00	2,900.00	26,100.00	2,900.00	26,100.00
5	Fire Hydrant Assembly, High Pressure Area	EA	1	2,700.00	2,700.00	3,100.00	3,100.00	3,100.00	3,100.00
6	Air Release Valve	EA	1	300.00	300.00	2,000.00	2,000.00	1,200.00	1,200.00
7	8" DI Class 50 Pipe (Open Cut Thru Road)	LF	57	62.00	3,534.00	100.00	5,700.00	100.00	5,700.00
8	8" PVC C900 Pipe (Open Cut Thru Road)	LF	188	59.00	11,092.00	100.00	18,800.00	100.00	18,800.00
9	Mill and Re-Pave Full Width of Road	Sq Yds	451	15.00	6,765.00	1,450.00	653,950.00	30.00	13,530.00
10	Concrete Driveway Replacement	LF	90	30.00	2,700.00	22.00	1,980.00	100.00	9,000.00
11	Bituminous Pavement Replacement	LF	180	30.00	5,400.00	19.00	3,420.00	55.00	9,900.00
12	Connect to Existing System	EA	3	2,200.00	6,600.00	100.00	300.00	700.00	2,100.00
13	Erosion Control Measures	LS	1	1,000.00	1,000.00	3,000.00	3,000.00	1,500.00	1,500.00
<b>Grandview Road/Amy Lou Drive Subtotal</b>					<b>322,251.00</b>		<b>992,538.30</b>		<b>351,880.00</b>

\*Denotes significant mathematical error in line item #9 and Grandview Road/Amy Lou Drive Subtotal price.

Item No.	Description	Unit	Approx Qty	Howell Contractors, Inc.		Paul Rack Excavating & Paving Company**		Coomer Contractors	
				Unit Price	Total Item Amount	Unit Price	Total Item Amount	Unit Price	Total Item Amount
1	8" Class 50DI Water Line	LF	1,355	\$35.00	\$47,425.00	\$36.03	\$48,820.65	\$35.00	\$47,425.00
2	8" C-900 PVC Water Line	LF	2,010	32.00	64,320.00	36.03	72,420.30	30.00	60,300.00
3	8' Gate Valve	EA	2	900.00	1,800.00	950.00	1,900.00	2,000.00	4,000.00
4	Fire Hydrant Assembly	EA	5	2,500.00	12,500.00	2,900.00	14,500.00	2,900.00	14,500.00
5	8" DI Class 50 Pipe (Open Cut Thru Road)	LF	245	62.00	15,190.00	75.00	18,375.00	100.00	24,500.00
6	8" PVC C900 Pipe (Open Cut Thru Road)	LF	120	59.00	7,080.00	75.00	9,000.00	100.00	12,000.00
7	Mill and Re-Pave Full Width of Road	Sq Yds	245	15.00	3,675.00	14.50	3,552.50	42.00	10,290.00
8	Mill and Re-Pave Single Lane or Road	Sq Yds	289	15.00	4,335.00	14.50	4,190.50	42.00	12,138.00
9	Concrete Driveway Replacement	LF	25	30.00	750.00	22.00	550.00	100.00	2,500.00
10	Bituminous Pavement Replacement	LF	105	30.00	3,150.00	19.00	1,995.00	55.00	5,775.00
11	Connect to Existing System	EA	1	2,200.00	2,200.00	100.00	100.00	700.00	700.00
12	Erosion Control Measures	LS	1	750.00	750.00	2,000.00	2,000.00	2,000.00	2,000.00
<b>Heck Road Subtotal</b>					<b>163,175.00</b>		<b>177,403.95</b>		<b>196,128.00</b>
<b>Grandview Road/Amy Lou Drive Subtotal</b>					<b>322,251.00</b>		<b>992,538.30</b>		<b>351,880.00</b>
<b>3ID PACKAGE "A" TOTAL BID</b>					<b>485,426.00</b>		<b>1,169,942.25</b>		<b>548,008.00</b>

\*\*Denotes significant mathematical error in Grandview Road/Amy Lou Drive Subtotal and Bid Package "A" Total Bid.

**Bid Tabulation**  
**Subdistrict F Waterline Extension**  
**Campbell County, Kentucky**  
**Northern Kentucky Water District**  
**Bids Received: May 10, 2006**

Item No.	Description	Unit	Approx Qty	Miami Western Contractors, Inc.		Fred A Newman Company	
				Unit Price	Total Item Amount	Unit Price	Total Item Amount
1	8" Class 50DI Water Line	LF	3,780	\$42.00	\$158,760.00	\$48.00	\$181,440.00
2	8" C-900 PVC Water Line	LF	3,755	39.00	146,445.00	43.00	161,465.00
3	8' Gate Valve	EA	8	1,250.00	10,000.00	1,200.00	9,600.00
4	Fire Hydrant Assembly	EA	9	2,940.00	26,460.00	3,750.00	33,750.00
5	Fire Hydrant Assembly, High Pressure Area	EA	1	3,240.00	3,240.00	4,100.00	4,100.00
6	Air Release Valve	EA	1	975.00	975.00	1,500.00	1,500.00
7	8" DI Class 50 Pipe (Open Cut Thru Road)	LF	57	66.00	3,762.00	60.00	3,420.00
8	8" PVC C900 Pipe (Open Cut Thru Road)	LF	188	63.00	11,844.00	54.00	10,152.00
9	Mill and Re-Pave Full Width of Road	Sq Yds	451	10.00	4,510.00	20.00	9,020.00
10	Concrete Driveway Replacement	LF	90	70.00	6,300.00	50.00	4,500.00
11	Bituminous Pavement Replacement	LF	180	30.00	5,400.00	21.00	3,780.00
12	Connect to Existing System	EA	3	3,320.00	9,960.00	1,500.00	4,500.00
13	Erosion Control Measures	LS	1	10,000.00	10,000.00	1,000.00	1,000.00
<b>Grandview Road/Amy Lou Drive Subtotal</b>					<b>397,656.00</b>		<b>428,227.00</b>

Item No.	Description	Unit	Approx Qty	Miami Western Contractors, Inc.		Fred A Newman Company	
				Unit Price	Total Item Amount	Unit Price	Total Item Amount
1	8" Class 50DI Water Line	LF	1,355	\$42.00	\$56,910.00	\$49.00	\$66,395.00
2	8" C-900 PVC Water Line	LF	2,010	39.00	78,390.00	44.00	88,440.00
3	8' Gate Valve	EA	2	1,250.00	2,500.00	1,200.00	2,400.00
4	Fire Hydrant Assembly	EA	5	2,940.00	14,700.00	3,750.00	18,750.00
5	8" DI Class 50 Pipe (Open Cut Thru Road)	LF	245	66.00	16,170.00	60.00	14,700.00
6	8" PVC C900 Pipe (Open Cut Thru Road)	LF	120	63.00	7,560.00	54.00	6,480.00
7	Mill and Re-Pave Full Width of Road	Sq Yds	245	10.00	2,450.00	20.00	4,900.00
8	Mill and Re-Pave Single Lane or Road	Sq Yds	289	10.00	2,890.00	20.00	5,780.00
9	Concrete Driveway Replacement	LF	25	70.00	1,750.00	50.00	1,250.00
10	Bituminous Pavement Replacement	LF	105	30.00	3,150.00	21.00	2,205.00
11	Connect to Existing System	EA	1	3,320.00	3,320.00	1,500.00	1,500.00
12	Erosion Control Measures	LS	1	5,000.00	5,000.00	1,000.00	1,000.00
<b>Heck Road Subtotal</b>					<b>194,790.00</b>		<b>213,800.00</b>
<b>Grandview Road/Amy Lou Drive Subtotal</b>					<b>397,656.00</b>		<b>428,227.00</b>
<b>BID PACKAGE "A" TOTAL BID</b>					<b>592,446.00</b>		<b>642,027.00</b>

**Bid Tabulation**  
**Subdistrict F Waterline Extension**  
**Campbell County, Kentucky**  
**Northern Kentucky Water District**  
**Bids Received: May 10, 2006**

Item No.	Description	Unit	Approx Qty	Howell Contractors, Inc.		Miami Western Contractors, Inc.		Coomer Contractors	
				Unit Price	Total Item Amount	Unit Price	Total Item Amount	Unit Price	Total Item Amount
1	12" Class 50 DI Water Line	LF	12,690	\$47.00	\$596,430.00	\$52.00	\$659,880.00	\$57.00	\$723,330.00
2	8" Class 50 DI Water Line	LF	2,325	36.00	83,700.00	48.00	111,600.00	38.00	88,350.00
3	12" Gate	EA	12	1,600.00	19,200.00	2,000.00	24,000.00	3,000.00	36,000.00
4	8" Gate	EA	2	900.00	1,800.00	1,250.00	2,500.00	2,000.00	4,000.00
5	6" Gate Valve	EA	1	650.00	650.00	975.00	975.00	1,500.00	1,500.00
6	Fire Hydrant Assembly, High Pressure Areas	EA	10	3,000.00	30,000.00	3,300.00	33,000.00	3,100.00	31,000.00
7	Air Release Valve	EA	1	1,000.00	1,000.00	975.00	975.00	1,200.00	1,200.00
8	12" DI Class 50 Pipe (Open Cut Thru Rd)	LF	689	55.00	37,895.00	60.00	41,340.00	150.00	103,350.00
9	8" DI Class 50 Pipe (Open Cut Thru Rd)	LF	61	45.00	2,745.00	50.00	3,050.00	120.00	7,320.00
10	24" Steel Encasement Pipe, Open Cut for Stream Crossing	LF	40	150.00	6,000.00	150.00	6,000.00	210.00	8,400.00
11	16" Steel Encasement Pipe, Open Cut for Stream Crossing	LF	50	115.00	5,750.00	120.00	6,000.00	180.00	9,000.00
12	Mill and Re-Pave Full Width of Road Using KDOT SuperPave Mixture	Sq Yds	111	15.00	1,665.00	12.00	1,332.00	42.00	4,662.00
13	Mill and Re-Pave Single Lane of Road Using KDOT SuperPave Mixture	Sq Yds	739	15.00	11,085.00	12.00	8,868.00	42.00	31,038.00
14	Bituminous Pavement Replacement	LF	125	30.00	3,750.00	30.00	3,750.00	55.00	6,875.00
15	Connect to Existing System	EA	4	4,500.00	18,000.00	3,320.00	13,280.00	700.00	2,800.00
16	Erosion and Control Measures	LS	1	2,000.00	2,000.00	20,000.00	20,000.00	4,500.00	4,500.00
<b>KY 915 Subtotal</b>					821,670.00		936,550.00		1,063,325.00

Item No.	Description	Unit	Approx Qty	Howell Contractors, Inc.***		Miami Western Contractors, Inc.		Coomer Contractors	
				Unit Price	Total Item Amount	Unit Price	Total Item Amount	Unit Price	Total Item Amount
1	8" Class 50DI Water Line	LF	2,610	\$36.00	\$93,960.00	\$48.00	\$125,280.00	\$40.00	\$104,400.00
2	8" C-900 PVC Water Line	EA	2	900.00	1,800.00	1,250.00	2,500.00	2,000.00	4,000.00
3	8" Gate Valve	EA	1	9,000.00	9,000.00	3,300.00	3,300.00	3,200.00	3,200.00
4	Fire Hydrant Assembly	LF	230	45.00	10,350.00	50.00	11,500.00	120.00	27,600.00
5	8" DI Class 50 Pipe (Open Cut Thru Road)	LF	150	250.00	37,500.00	300.00	45,000.00	240.00	36,000.00
6	8" PVC C900 Pipe (Open Cut Thru Road)	Sq Yds	340	15.00	5,100.00	12.00	4,080.00	42.00	14,280.00
7	Mill and Re-Pave Full Width of Road	Sq Yds	264	15.00	3,960.00	12.00	3,168.00	42.00	11,088.00
8	Mill and Re-Pave Single Lane or Road	LF	50	30.00	1,500.00	30.00	1,500.00	55.00	2,750.00
9	Concrete Driveway Replacement	EA	2	2,200.00	4,400.00	3,320.00	6,640.00	700.00	1,400.00
10	Erosion Control Measures	LS	1	1,000.00	1,000.00	3,500.00	3,500.00	5,000.00	5,000.00
<b>KY 10 Subtotal</b>					168,570.00		206,468.00		209,718.00

\*\*\*Denotes mathematical error in KY 10 Subtotal



**Bid Tabulation**  
**Subdistrict F Waterline Extension**  
**Campbell County, Kentucky**  
**Northern Kentucky Water District**  
**Bids Received: May 10, 2006**

Item No.	Description	Unit	Approx Qty	Howell Contractors, Inc.****		Miami Western Contractors, Inc.		Coomer Contractors	
				Unit Price	Total Item Amount	Unit Price	Total Item Amount	Unit Price	Total Item Amount
1	8" Class 50 DI Water Line	LF	1,700	\$36.00	\$61,200.00	\$48.00	\$81,600.00	\$38.00	\$64,600.00
2	8" C-900 PVC Water Line	LF	600	33.00	19,800.00	45.00	27,000.00	36.00	21,600.00
3	8" Gate Valve	EA	1	900.00	900.00	1,250.00	1,250.00	2,000.00	2,000.00
4	Fire Hydrant Assembly	EA	4	2,700.00	10,800.00	2,940.00	11,760.00	2,900.00	11,600.00
5	8" DI Class 50 Pipe (Open Cut Thru Rd)	LF	255	45.00	11,475.00	50.00	12,750.00	120.00	30,600.00
6	Mill and Re-Pave Single lane of Road	Sq Yds	283	15.00	4,245.00	10.00	2,830.00	42.00	
7	Connect to Existing System	EA	1	2,200.00	2,200.00	3,320.00	3,320.00	700.00	700.00
8	Erosion Control Measures	LS	1	1,000.00	1,000.00	2,500.00	2,500.00	2,500.00	2,500.00
<b>Steffen Road Subtotal</b>					111,620.00		143,010.00		145,486.00
<b>KY 915 Subtotal</b>					821,670.00		936,550.00		1,063,325.00
<b>KY 10 Subtotal</b>					168,570.00		206,468.00		209,718.00
<b>BID PACKAGE "B" (KY 915/KY10/STEFFEN ROAD) TOTAL BID</b>					1,101,860.00		1,286,028.00		1,418,529.00

\*\*\*\*Denotes mathematical error in BID PACKAGE "B" (KY 915/KY10/STEFFEN ROAD) TOTAL BID

Item No.	Description	Unit	Approx Qty	Coomer Contractors		Howell Contractors, Inc.		Jack Gemmer and Sons	
				Unit Price	Total Item Amount	Unit Price	Total Item Amount	Unit Price	Total Item Amount
1	8" Class 50 DI Water Pipe	LF	5,395	\$29.00	\$156,455.00	\$36.00	\$194,220.00	\$41.00	\$221,195.00
2	8" Gate Valve	EA	5	2,000.00	10,000.00	900.00	4,500.00	750.00	3,750.00
3	Fire Hydrant Assembly, High Pressure Area	EA	5	3,100.00	15,500.00	2,500.00	12,500.00	2,500.00	12,500.00
4	8" DI Class 50 Pipe (Open Cut Thru Rd)	LF	40	200.00	8,000.00	45.00	1,800.00	90.00	3,600.00
5	Mill and Re-Pave Full Width of Road Using KDOT SuperPave Mixture	Sq Yds	67	50.00	3,350.00	12.00	804.00	35.00	2,345.00
6	Connect to Existing System	EA	1	1,000.00	1,000.00	2,200.00	2,200.00	300.00	300.00
7	Erosion Control Measures	LS	1	1,000.00	1,000.00	1,000.00	1,000.00	2,000.00	2,000.00
<b>Flagg Springs Pike Subtotal (TOTAL BID PACKAGE C)</b>					195,305.00		217,024.00		245,690.00

**Bid Tabulation**  
**Subdistrict F Waterline Extension**  
**Campbell County, Kentucky**  
**Northern Kentucky Water District**  
**Bids Received: May 10, 2006**

Item No.	Description	Unit	Approx Qty	United Plumbing		Generation 2 Construction, Inc.	
				Unit Price	Total Item Amount	Unit Price	Total Item Amount
1	8" Class 50 DI Water Pipe	LF	5,395	\$41.00	\$221,195.00	\$40.10	\$216,339.50
2	8" Gate Valve	EA	5	600.00	3,000.00	1,250.00	6,250.00
3	Fire Hydrant Assembly, High Pressure Area	EA	5	2,000.00	10,000.00	3,000.00	15,000.00
4	8" DI Class 50 Pipe (Open Cut Thru Rd)	LF	40	60.00	2,400.00	125.00	5,000.00
5	Mill and Re-Pave Full Width of Road Using KDOT SuperPave Mixture	Sq Yds	67	105.00	7,035.00	60.00	4,020.00
6	Connect to Existing System	EA	1	1,600.00	1,600.00	1,000.00	1,000.00
7	Erosion Control Measures	LS	1	2,769.00	2,769.00	500.00	500.00
<b>Flagg Springs Pike Subtotal (TOTAL BID PACKAGE C)</b>					<b>247,999.00</b>	<b>248,109.50</b>	

Item No.	Description	Unit	Approx Qty	Hartman & Smith Construction Company		Paul Rack Excavating & Paving Company	
				Unit Price	Total Item Amount	Unit Price	Total Item Amount
1	8" Class 50 DI Water Pipe	LF	5,395	\$45.00	\$242,775.00	\$49.42	\$266,620.90
2	8" Gate Valve	EA	5	1,000.00	5,000.00	950.00	4,750.00
3	Fire Hydrant Assembly, High Pressure Area	EA	5	3,600.00	18,000.00	3,100.00	15,500.00
4	8" DI Class 50 Pipe (Open Cut Thru Rd)	LF	40	38.00	1,520.00	100.00	4,000.00
5	Mill and Re-Pave Full Width of Road Using KDOT SuperPave Mixture	Sq Yds	67	71.00	4,757.00	40.00	2,680.00
6	Connect to Existing System	EA	1	3,800.00	3,800.00	100.00	100.00
7	Erosion Control Measures	LS	1	2,500.00	2,500.00	1,500.00	1,500.00
<b>Flagg Springs Pike Subtotal (TOTAL BID PACKAGE C)</b>					<b>278,352.00</b>	<b>295,150.90</b>	

I Hereby certify that this is a true and correct tabulation of bids

\_\_\_\_\_  
 Brent A. Tippey, P.E.  
 Quest Engineers, Inc.

Case No. 200-\_\_\_\_\_  
Exhibit     C    

NORTHERN KENTUCKY  
WATER DISTRICT

**Project – Sub District F**

Campbell County  
184-188

System Hydraulic Model

# FIRE FLOW CERTIFICATION

## Subdistrict F

**Grandview Road, Amy Lou Drive, Heck Road, KY 10, KY 915 North, KY 915  
South, Steffen Road, Flagg Springs Pike  
Campbell County, KY**

I certify that the proposed improvements meet the 807 KAR 5:066, Section 10b regulation for fire flow protection relating to KRS Chapter 278. I am certifying that "the system can provide a minimum fire flow of 250 gallons per minute; and the water system supporting this flow has the capability of providing this flow for a period of not less than two (2) hours plus consumption at the maximum daily rate". This certification is based on the information available and is not a guarantee of any precise results.

This certification is based on hydraulic modeling performed using H2ONET, the program available from MWHSOft. Supporting documentation and operating conditions are attached and are the basis for this certification.

It should be noted that input data used for modeling is based on available data. Results can change and are dependent on the demand conditions, which can vary at any given time. These values will impact the final results when adjusted. The certification is based on estimated conditions and contains many assumptions based on historical data.

With this certification, the Northern Kentucky Water District will permit the construction of fire hydrants within this development.

Fire flow analyses were made using a hydrant within the subdivision that would provide a representative result that should simulate the results at other hydrants within the system. Minor variations at different hydrants would still provide a flow rate that meets the minimum standard.

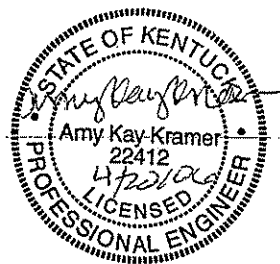

# HYDRAULIC AND FLUSHING VELOCITY CERTIFICATION

## Subdistrict F Grandview Road, Amy Lou Drive, Heck Road, KY 10, KY 915 North, KY 915 South, Steffen Road, Flagg Springs Pike Campbell County, KY

I certify that the proposed improvements will meet the American Water Works Association Standard C651 standard for flushing velocity in the main meeting 2.5 feet per second while maintaining at least 20 psi pressure in accordance with 401 KAR 8:100.

The maximum flow rate that can reliably be supplied to the main and meet 20 psi in the system under maximum hour conditions is as follows:

Grandview Road – 1,300 gpm  
Amy Lou Drive – 1,200 gpm  
Heck Road – 900 gpm  
KY 10 – 2,100 gpm  
KY 915 North – 3,500 gpm  
Steffen Road – 1,300 gpm  
KY 915 South – 3,500 gpm  
Flagg Springs Pike – 500 gpm

At least 30 psi can be maintained under the peak domestic demand for the customers added. The peak domestic demand using the D.R. Taylor formula for the customers is as follows:

Grandview Road, 41 customer – 64.03 gpm  
Amy Lou Drive, 7 customers – 26.46 gpm  
Heck Road, 13 customers – 36.06 gpm  
KY 10, 6 customers – 24.49 gpm  
KY 915 North, 7 customers – 26.46 gpm  
Steffen Road, 10 customers – 31.62 gpm  
KY 915 South, 34 customers – 58.31 gpm  
Flagg Springs Pike, 11 customers – 33.17 gpm

This certification is based on the information available and is not a guarantee of any precise results. Results are based on hydraulic modeling performed using H2ONET, the program available from MWHSoft. Supporting documentation and operating conditions are attached and are the basis for this certification.

It should be noted that input data used for modeling is based on available data. Results can change and are dependent on the demand conditions, which can vary at any given time. These values will impact the final results when adjusted. The certification is based on estimated conditions for maximum hour demand conditions and contains many assumptions based on historical data.

With this certification, the Northern Kentucky Water District will permit the construction of the proposed 8" and 12" water mains.

The assumed Hazen-Williams roughness coefficient for all new pipe was 120, which is suitable for ductile iron or PVC. The water levels in the Main Street and South County Tanks were one-half full.



Subdistrict F Water Mains  
Output from H2ONET model - copied to Excel

Maximum Hour Run, Flagg Springs, 11 customers = 33.16 gpm				
ID	Demand, gpm	Elevation, ft	Grade, ft	Pressure, psi
FLAGG1	33.16	610	772.10	70.27
5137	0	580	772.31	83.37

Maximum Hour Run, KY 915 South, 34 customers = 58.31 gpm				
ID	Demand, gpm	Elevation, ft	Grade, ft	Pressure, psi
9636	5.39	520	1,022.27	217.73
22368	58.31	573	1,011.28	189.99

Maximum Hour Run, Steffen Road, 10 customers = 31.62 gpm				
ID	Demand, gpm	Elevation, ft	Grade, ft	Pressure, psi
STEFFEN1	31.62	765	1,009.10	105.82
22366	0	722	1,009.19	124.5

Maximum Hour Run, KY 10, 6 customers = 24.49 gpm				
ID	Demand, gpm	Elevation, ft	Grade, ft	Pressure, psi
22362	0	645	1,007.43	157.11
9414	24.49	746	1,004.38	112.01

Maximum Hour Run, KY 915 North, 7 customers = 26.46 gpm				
ID	Demand, gpm	Elevation, ft	Grade, ft	Pressure, psi
4785	26.46	586	1,029.58	192.29
706	5.39	569	1,029.58	199.66

Maximum Hour Run, Grandview, 41 customers = 64.03 gpm				
ID	Demand, gpm	Elevation, ft	Grade, ft	Pressure, psi
GRANDV3	21.34	625	972.98	150.85
4986	21.34	801	978.24	76.84
25360	21.34	655	972.99	137.85

Maximum Hour Run, Amy Lou Dr, 7 customers = 26.46 gpm				
ID	Demand, gpm	Elevation, ft	Grade, ft	Pressure, psi
25346A	26.46	690	973.84	123.05
AMYLOU	0	715	973.85	112.21

Maximum Hour Run, Heck Road, 13 customers = 36.06 gpm				
ID	Demand, gpm	Elevation, ft	Grade, ft	Pressure, psi
HECK2	36.06	820	1,005.39	80.37
HECK1	0	670	1,005.60	145.48

Flushing velocity 2.5 fps for Flagg Springs		
ID	Demand, gpm	Pressure, psi
FLAGG1	392	48.75
5137	0	70.43

Flushing velocity 2.5 fps for KY 915 South		
ID	Demand, gpm	Pressure, psi
9636	5.39	214.39
22368	881	178.1

Flushing velocity 2.5 fps for Steffen Road		
ID	Demand, gpm	Pressure, psi
STEFFEN1	392	96.96
22366	0	119.69

Flushing velocity 2.5 fps for KY 10		
ID	Demand, gpm	Pressure, psi
22362	0	154.97
9414	392	106.28

Flushing velocity 2.5 fps for KY 915 North		
ID	Demand, gpm	Pressure, psi
4785	392	185.85
706	5.39	196.99

Flushing velocity 2.5 fps for Grandview		
ID	Demand, gpm	Pressure, psi
GRANDV3	392	127.04
4986	0.81	63.88
25360	6.4	115.19

Flushing velocity 2.5 fps for Amy Lou Dr		
ID	Demand, gpm	Pressure, psi
25346A	392	107.66
AMYLOU	0	97.31

Flushing velocity 2.5 fps for Heck Road		
ID	Demand, gpm	Pressure, psi
HECK2	392	66.78
HECK1	0	139.17

Pipe Information for flushing velocity at 2.5 fps						
Pipe ID	Length, ft	Diam, inch	Flow, gpm	Velocity, fps	Roughness	
915SOUTH	13,100.00	12	-881	2.5	120	KY 915 South
915N	2,300.00	8	-392.25	2.5	120	KY 915 North
HECK	4,500.00	8	392	2.5	120	Heck Road
STEFFEN	2,500.00	8	392	2.5	120	Steffen Road
KY10	3,000.00	8	-392	2.5	120	KY 10
FLAGG	5,300.00	8	392	2.5	120	Flagg Springs
GRANDV3	707	8	392	2.5	120	Grandview
GRANDV2	1,500.00	8	398.4	2.54	120	Grandview
GRANDV1	5,600.00	8	398.4	2.54	120	Grandview
AMYLOU	300	8	392	2.5	120	Amy Lou Dr

Pipe ID	From Node	To Node
915SOUTH	22368	9636
915N	4785	706
HECK	HECK1	HECK2
STEFFEN	22366	STEFFEN1
KY10	9414	22362
FLAGG	5,137.00	FLAGG1
GRANDV3	25360	GRANDV3
GRANDV2	AMYLOU	25360
GRANDV1	4986	AMYLOU
AMYLOU	AMYLOU	25346A

4986

GRANDV1

Grandview 7,400' - 8"

Amy Lou 300' - 8"

GRANDV2

25360

GRANDV3

AMYLOU

AMYLOU

C25346A

GRANDV3

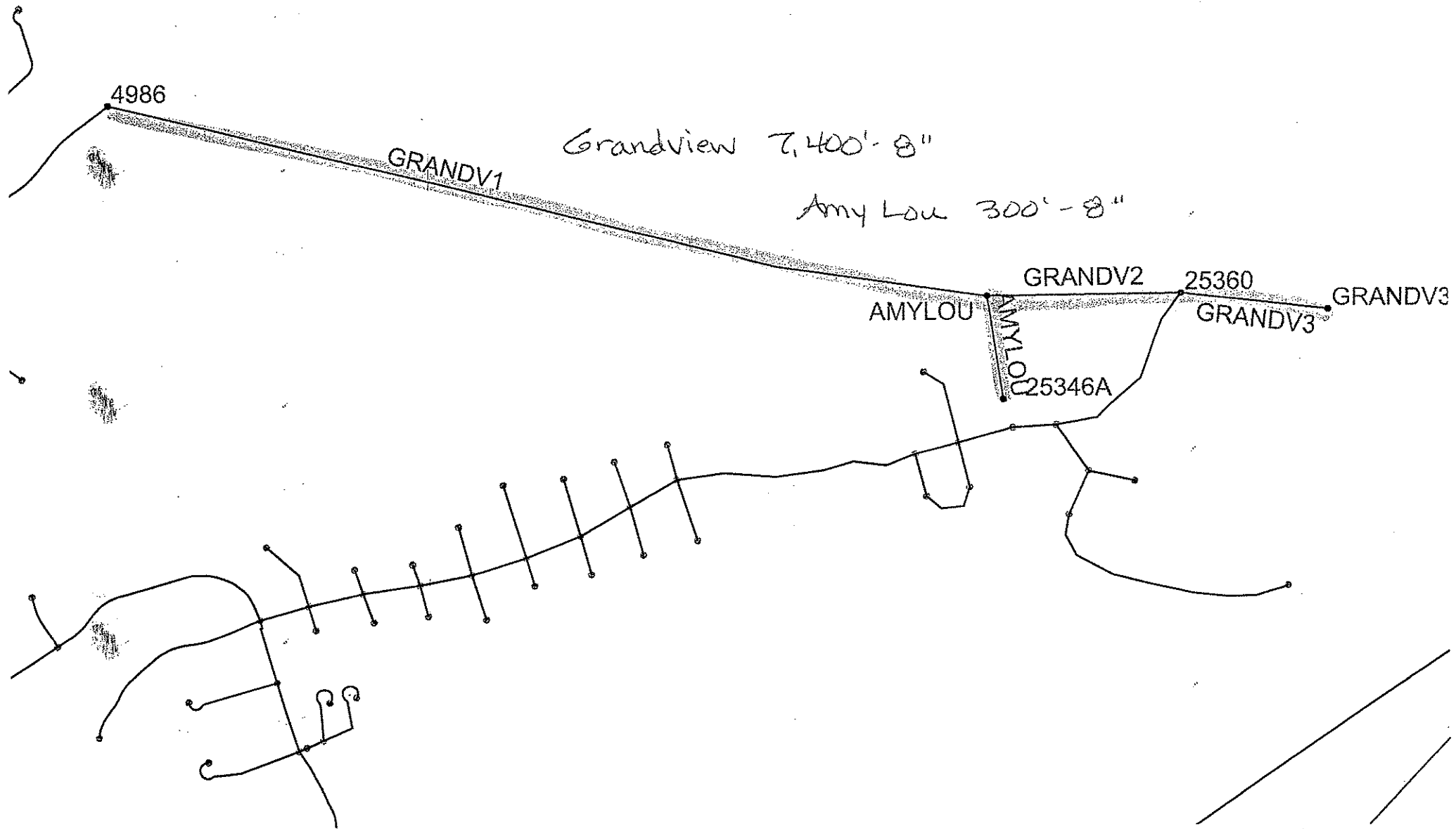

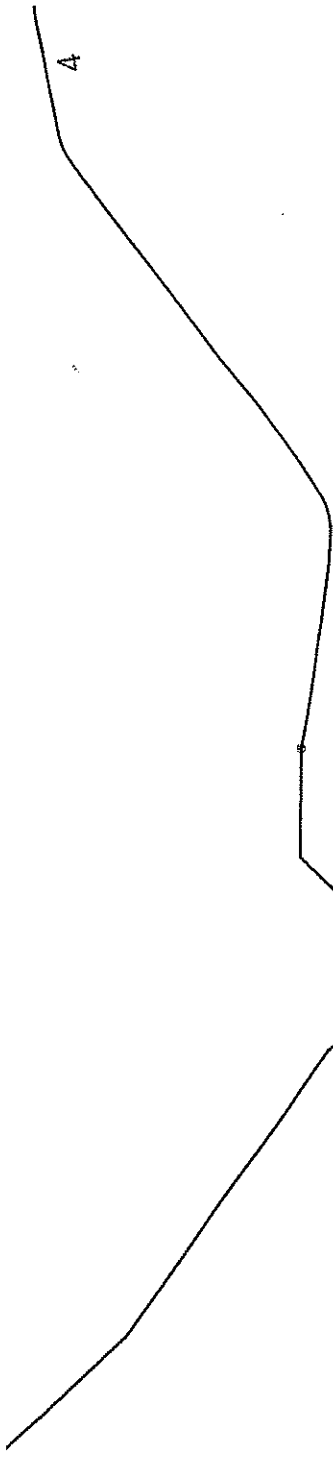

5137

Flagg Springs Pike  
S, 300'-0"

FLAGG

FLAGG1





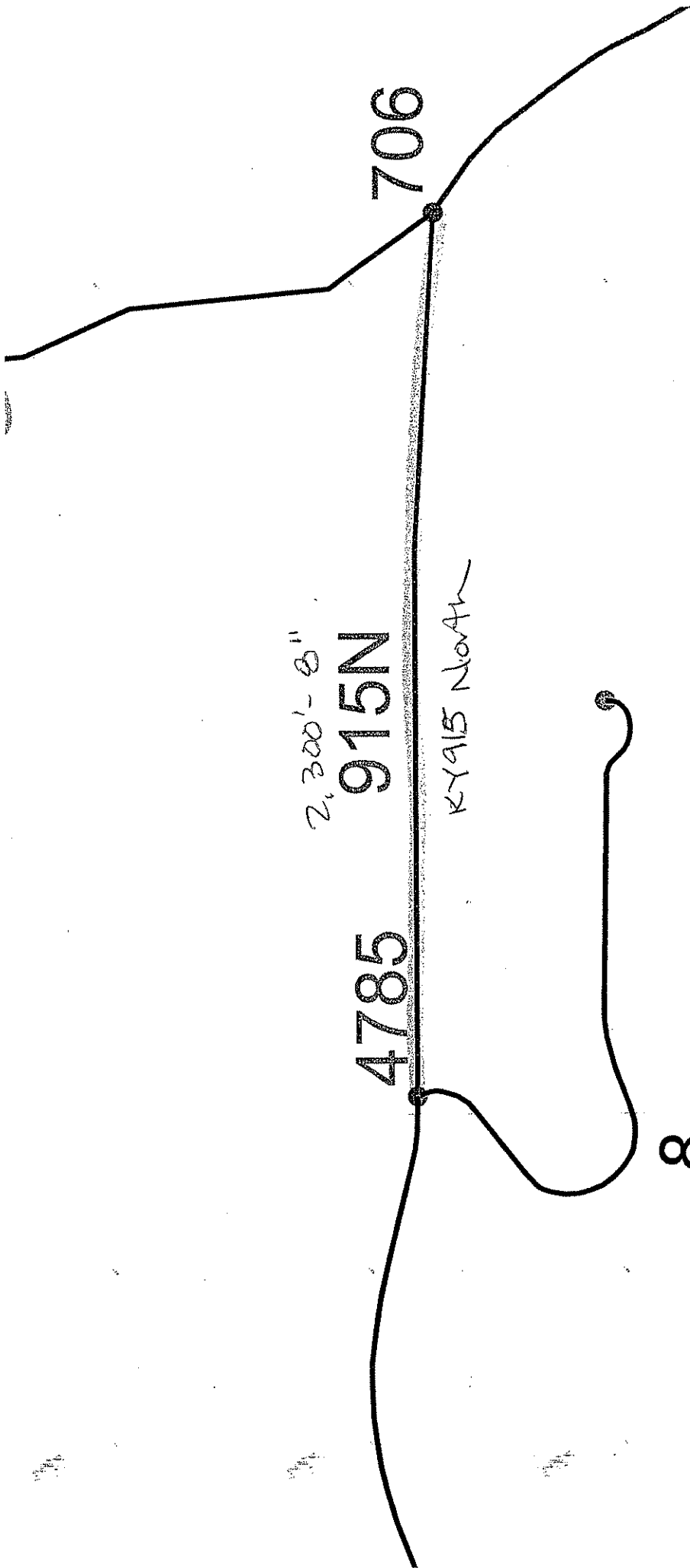

2,300' - 8"

915N

KY915 North

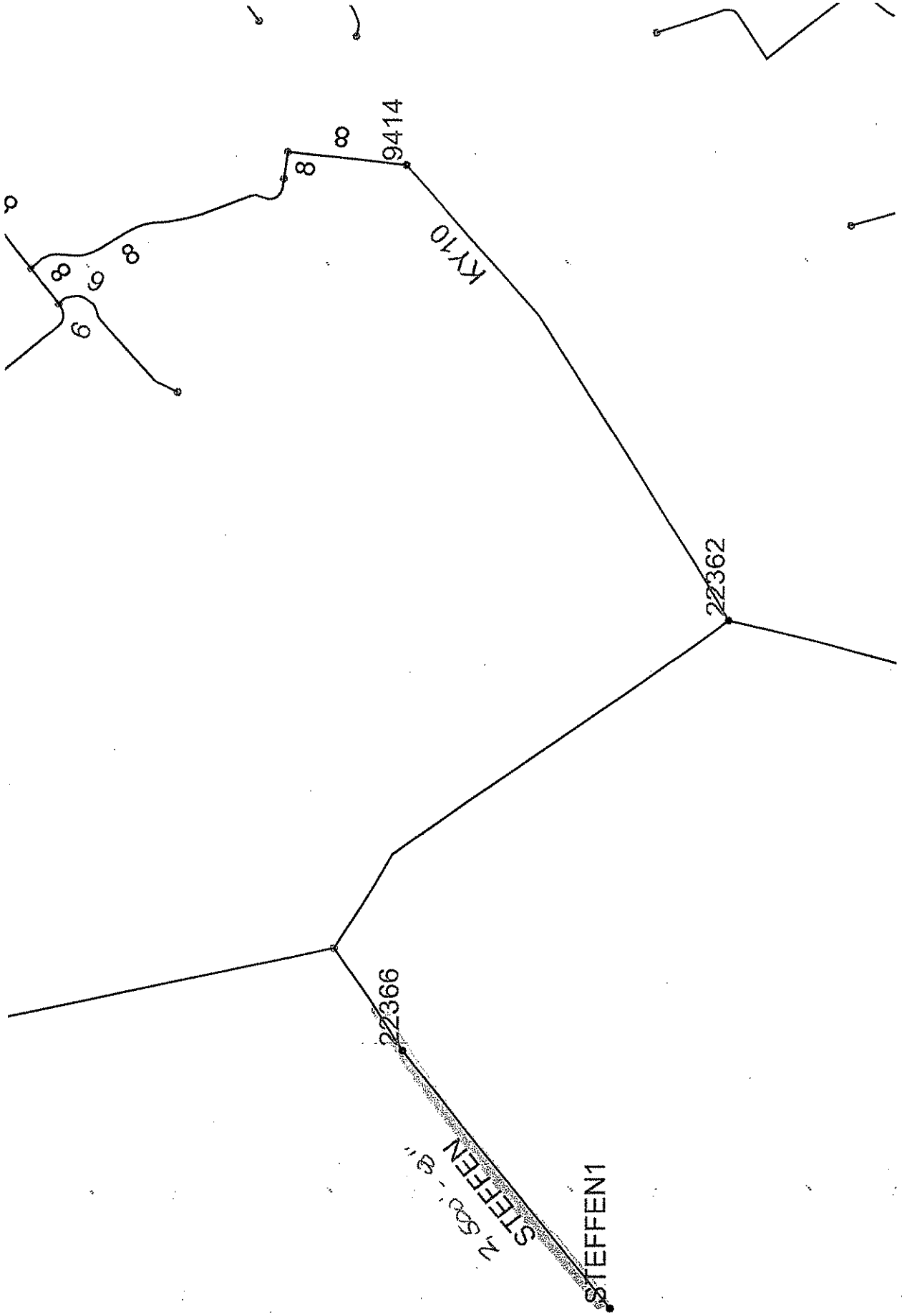

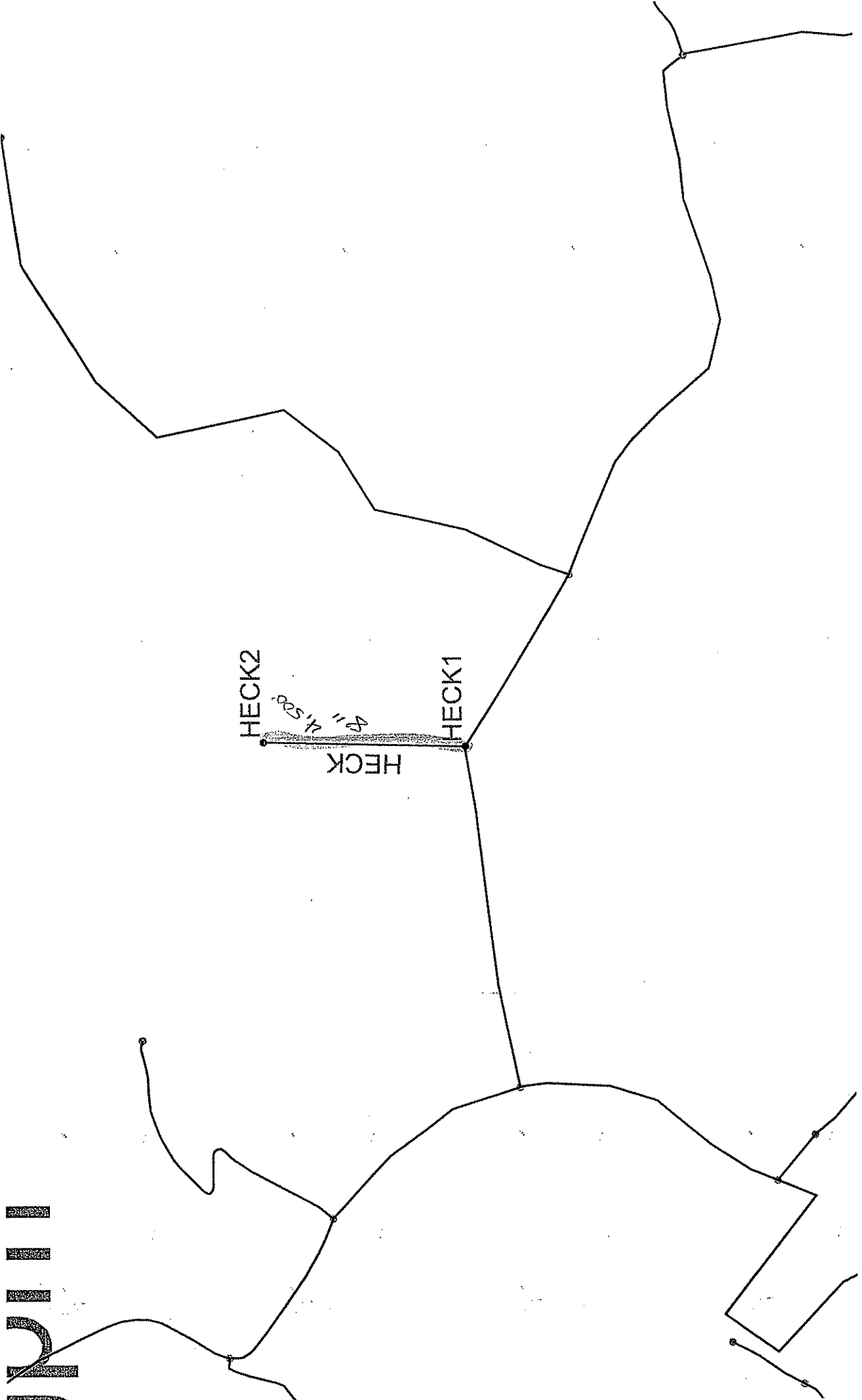

Case No. 200-\_\_\_\_\_  
Exhibit     C    

NORTHERN KENTUCKY  
WATER DISTRICT

**Project – Sub District F**

Campbell County  
184-188

Project Map





Case No. 200-\_\_\_\_\_  
Exhibit     D    

NORTHERN KENTUCKY  
WATER DISTRICT

**Project – Sub District F**

Campbell County  
184-188

Certified Statements  
And  
Roads and Right of Way Permits



# NORTHERN KENTUCKY WATER DISTRICT

## Sub District F Water Main Extension

### Certification Statement

A certified statement from an authorized utility official confirming:

1. That the proposed plans and specifications for the project have been designed to meet the minimum construction and operating requirements established in 807 KAR5:066, Section 4(3) and (4), Section 5(1), Sections 6 and 7, Sections 8(1) through (3), Section 9(1), and Section 10.
2. That all other state approvals or permits have been obtained.
3. Construction is planned to begin as soon as PSC approval is granted and end within 120 days.

R

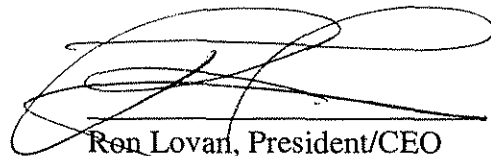

Ron Lovan, President/CEO

5/24/06  
Date

**COMMONWEALTH OF KENTUCKY  
COUNTY OF CAMPBELL**

Affiant, Jack Bragg, being the first duly sworn, deposes and says that he is the Vice President of Finance of the Northern Kentucky Water District, which he is the Applicant in the proceeding styled above; that he has read the foregoing "Sub District F Water Main Extension" Application and knows the contents thereof, and that the same is true of his own knowledge, except as to matters which are therein stated on information or belief, and that as to those matters he believes them to be true.

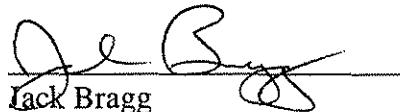
  
\_\_\_\_\_  
Jack Bragg  
Vice President - Finance  
Northern Ky. Water District

Subscribed and sworn to before me in said County to be his act and deed by Jack Bragg, Vice President of Finance of the Northern Kentucky Water District, this 16<sup>th</sup> day of May 2006.

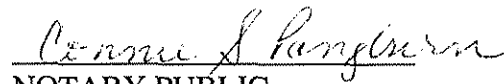
  
\_\_\_\_\_  
NOTARY PUBLIC  
Campbell County, Kentucky  
My commission expires May 26, 2007



ENVIRONMENTAL AND PUBLIC PROTECTION CABINET  
DEPARTMENT FOR ENVIRONMENTAL PROTECTION

**Ernie Fletcher**  
Governor

Division of Water  
14 Reilly Road  
Frankfort, Kentucky 40601-1190  
www.kentucky.gov

**Lajuana S. Wilcher**  
Secretary

May 9, 2006

Mr. Justen T. Dennis, Engineering Technician  
Northern Kentucky Water District  
2835 Crescent Spring Road, P.O. BOX 18640  
Erlanger, Kentucky 41018

Re: Northern Kentucky Water District,  
PWS— 2485  
DW No.0590220-06-017  
Sub district F (Waterline Extension)  
Activity ID: APE20060017  
Kenton County, Kentucky

Dear Mr. Dennis:

We have reviewed the plans and specifications for the above referenced project. The plans include the construction of approximately 25,300 feet of 8-inch PVC and 13,100 feet of 12-inch PVC waterlines. This is to advise that plans and specifications for the above referenced project are APPROVED with respect to sanitary features of design, as of this date with the requirements contained in the enclosed waterline extension construction permit.

If you have any questions regarding this decision, please contact Fred Sarabi, at (502) 564-2225, extension 564.

Sincerely,

*for Donna S. Marlin*  
Donna S. Marlin, Manager  
Drinking Water Branch  
Division of Water

DSM/FFS  
Enclosure

CC: Quest Engineers.  
Kenton County Health Department.

## Distribution-Major Construction

Northern KY Water Service  
Subject Item Inventory

Activity ID No.: APE20060017

### Subject Item Inventory:

ID	Designation	Description
AIOO2485		
PORT130	Waterline Extension	25,300 feet of 8-inch PVC and 13,100 feet of 12-inch PVC waterline

### Subject Item Groups:

ID	Description	Components
GACT130	25,300 feet of 8-inch PVC and 13,100 feet of 12-inch PVC waterline	PORT130 25,300 feet of 8-inch PVC and 13,100 feet of 12-inch PVC waterline

### KEY

ACTV = Activity

AREA = Area

EQPT = Equipment

PERS = Personnel

STOR = Storage

TRMT = Treatment

AIOO = Agency Interest

COMB = Combustion

MNPT = Monitoring Point

PORT = Transport

STRC = Structure

## Distribution-Major Construction

Northern KY Water Service  
Facility Requirements

Activity ID No.: APE20060017

Page 1 of 7

**GACT130 (Subdistrict F (WLE)) 25,300 feet of 8-inch PVC and 13,100 feet of 12-inch PVC waterline :**

### Monitoring Requirements:

---

Condition No.	Parameter	Condition
M-1	Coliform	The presence or absence of total Coliform monitored by sampling and analysis as needed shall be determined for the new or relocated water line(s). Take samples at connection points to existing lines, at 1 mile intervals, and at dead ends without omitting any branch of the new or relocated water line. Sample bottles shall be clearly identified as "special" construction tests. [401 KAR 8:100 Section 1(7), 401 KAR 8:150 Section 4, Recommended Standards for Water Works 8.5.6] This requirement is applicable during the following months: All Year. Statistical basis: Instantaneous determination.

### Submittal/Action Requirements:

#### Coliform:

---

Condition No.	Condition
S-1	Coliform For new construction projects, the distribution system, using the most expedient method, shall submit Coliform test results to the Cabinet: Due immediately following disinfection and flushing. [401 KAR 8:150 Section 4(2)]

---

Condition No.	Condition
S-2	For proposed changes to the approved plan, submit information: Due prior to any modification to the Cabinet for approval. Changes to the approved plan shall not be implemented without the prior written approval of the Cabinet. [401 KAR 8:100 Section 1(8)]
S-3	The person who presented the plans shall submit the professional engineer's certification: Due when construction is complete to the Division of Water. The certification shall be signed by a registered professional engineer and state that the water project has been constructed and tested in accordance with the approved plans, specifications, and requirements. [401 KAR 8:100 Section 1(8)]

**Distribution-Major Construction**

Northern KY Water Service  
Facility Requirements

Activity ID No.: APE20060017

**GACT130 (continued):**

**Narrative Requirements:**

**Additional Limitations:**

---

Condition No.	Condition
T-1	<b>Additional Limitations:</b> Chlorinated water resulting from disinfection of project components shall be disposed in a manner which will not violate 401 KAR 5:031. [401 KAR 8:020 Section 2(20)]

---

Condition No.	Condition
T-2	This project has been permitted under the provisions of KRS Chapter 224 and regulations promulgated pursuant thereto. Issuance of this permit does not relieve the applicant from the responsibility of obtaining any other approvals, permits or licenses required by this Cabinet and other state, federal and local agencies. Further, this permit does not address the authority of the permittee to provide service to the area to be served. [401 KAR 8:100 Section 1(7)]
T-3	Unless construction of this project is begun within 1 year from the issuance date of this permit, the permit shall expire. If requested prior to the permit expiration, an official extension from the Division of Water may be granted. If this permit expires, the original plans and specifications may be resubmitted for a new comprehensive review. If you have any questions concerning this project, please contact the Drinking Water Branch at 502/564-3410. [401 KAR 8:100 Section 1(9)]
T-4	During construction, a set of approved plans and specification shall be available at the job site at all times. All work shall be performed in accordance with the approved plans and specifications. [401 KAR 8:100 Section 1(7)(a)]

## Distribution-Major Construction

Northern KY Water Service  
Facility Requirements

Activity ID No.: APE20060017

Page 3 of 7

### PORT130 (Waterline Extension) 25,300 feet of 8-inch PVC and 13,100 feet of 12-inch PVC waterline:

#### Limitation Requirements:

Condition No.	Parameter	Condition
L-1	Depth	A continuous and uniform bedding shall be provided in the trench for all buried pipe. Backfill material shall be tamped in layers around the pipe and to a sufficient height above the pipe to adequately support and protect the pipe. Stones found in the trench shall be removed for a Depth $\geq$ 6 in below the bottom of the pipe. [Recommended Standards for Water Works 8.5.2] This requirement is applicable during the following months: All Year. Statistical basis: Not applicable.
L-2	Depth	All water lines shall be covered to a Depth $\geq$ 30 in to prevent freezing. [Recommended Standards for Water Works 8.5.3, 401 KAR 8:100 Section 1(7)] This requirement is applicable during the following months: All Year. Statistical basis: Minimum.
L-3	Diameter	All new and existing water lines serving fire hydrants or where fire protection is provided shall have Diameter $\geq$ 6 in. [Recommended Standards for Water Works 8.1.2] This requirement is applicable during the following months: All Year. Statistical basis: Minimum.
L-4	Distance	Water lines shall have a sufficient quantity of valves so that inconvenience and sanitary hazards will be minimized during repairs. A valve spacing Distance $\leq$ 1.0 mi should be utilized. [Recommended Standards for Water Works 8.2] This requirement is applicable during the following months: All Year. Statistical basis: Not applicable.
L-5	Distance	Hydrant drains shall not be connected to sanitary sewers or storm drains and shall be located a Distance $>$ 10 ft from sanitary sewers and storm drains. [Recommended Standards for Water Works 8.3.4] This requirement is applicable during the following months: All Year. Statistical basis: Not applicable.
L-6	Distance	Except when not practical, water lines shall be laid a horizontal Distance $\geq$ 10 ft from any existing or proposed sewer. The distance shall be measured edge to edge. In cases where it is not practical to maintain a 10 foot separation, water lines may be installed closer to a sewer provided that the water lines shall be laid in a separate trench or on an undisturbed shelf located on one side of the sewer at such an elevation that the bottom of the water line is at least 18 inches above the top of the sewer. [Recommended Standards for Water Works 8.6.2] This requirement is applicable during the following months: All Year. Statistical basis: Not applicable.

## Distribution-Major Construction

Northern KY Water Service

Facility Requirements

Activity ID No.: APE20060017

Page 4 of 7

### PORT130 (continued):

#### Limitation Requirements:

Condition No.	Parameter	Condition
L-7	Distance	<p>When water lines and sewers cross,</p> <ol style="list-style-type: none"><li>1) water lines shall be laid such that either<ol style="list-style-type: none"><li>a) the the top of the water line is a vertical Distance <math>\geq 18</math> in below the bottom of the sewer line or</li><li>b) the bottom of the water line is a vertical Distance <math>\geq 18</math> in above the top of the sewer line,</li></ol></li><li>2) 1 full length of the water pipe shall be located so that both joints of the water pipe will be as far from the sewer as possible, and</li><li>3) special structural support for the water and sewer pipes may be required. [Recommended Standards for Water Works 8.6.3] This requirement is applicable during the following months: All Year. Statistical basis: Not applicable.</li></ol>
L-8	Distance	<p>The open end of an air relief pipe from automatic valves shall be extended a Distance <math>\geq 1.0</math> ft above grade and provided with a screened, downward-facing elbow. The pipe from a manually operated valve shall be extended to the top of the pit. Use of manual air relief valves is recommended wherever possible. [Recommended Standards for Water Works 8.4.2] This requirement is applicable during the following months: All Year. Statistical basis: Not applicable.</p>
L-9	Pressure	<p>Pipes shall not be installed unless all points of the distribution system remain designed for ground level Pressure <math>\geq 20</math> psi under all conditions of flow. [Recommended Standards for Water Works 8.1.1] This requirement is applicable during the following months: All Year. Statistical basis: Minimum.</p>
L-10	Pressure	<p>Pressure <math>\geq 30</math> psi must be available on the discharge side of all meters. [401 KAR 8:100 Section 4(2)] This requirement is applicable during the following months: All Year. Statistical basis: Instantaneous determination.</p>
L-11	Residual Disinfection	<p>New or relocated water lines shall be thoroughly disinfected (in accordance with AWWA Standard C651) upon completion of construction and before being placed into service. To disinfect the new or relocated lines use chlorine or chlorine compounds in such amounts as to produce an initial disinfectant concentration of at least 50 ppm and a Residual Disinfection <math>\geq 25</math> ppm at the end of 24 hours. Follow the line disinfection with thorough flushing and place the lines into service if, and only if, Coliform monitoring applicable to the line does not show the presence of Coliform.</p> <p>If Coliform is detected, repeat flushing of the line and Coliform monitoring. If Coliform is still detected, repeat disinfection and flushing as if the line has never been disinfected. Continue the described process until monitoring does not show the presence of Coliform. [401 KAR 8:150 Section 4(1), Recommended Standards for Water Works 8.5.6] This requirement is applicable during the following months: All Year. Statistical basis: Minimum.</p>



## Distribution-Major Construction

Northern KY Water Service  
Facility Requirements

Activity ID No.: APE20060017

Page 5 of 7

### PORT130 (continued):

#### Limitation Requirements:

---

Condition No.	Parameter	Condition
L-12	Velocity	Each blow-off or fire hydrant shall be sized so that Velocity $\geq$ 2.5 ft/sec can be achieved in the water main served by the blow-off or hydrant during flushing. [Recommended Standards for Water Works 8.1.6.b, 401 KAR 8:100 Section 1(7)] This requirement is applicable during the following months: All Year. Statistical basis: Minimum.

#### Monitoring Requirements:

---

Condition No.	Parameter	Condition
M-1	leaks	The presence or absence of leaks monitored by physical testing as needed shall be determined in all types of installed pipe. Pressure testing and leakage testing shall be in accordance with the latest edition of AWWA Standard C600. [Recommended Standards for Water Works 8.5.5] This requirement is applicable during the following months: All Year. Statistical basis: Instantaneous determination.

#### Narrative Requirements:

##### Asbestos (Friable):

---

Condition No.	Condition
T-1	Asbestos (Friable): If the existing water line to be tapped is asbestos concrete, then the contractor shall conform to OSHA regulations governing the handling of hazardous waste during the process of tapping the asbestos concrete line. Pieces of asbestos concrete resulting from the tap shall be double bagged, placed in a rigid container and disposed of in an approved landfill. [401 KAR 8:100 Section 1(7)]

## Distribution-Major Construction

Northern KY Water Service  
Facility Requirements

Activity ID No.: APE20060017

Page 6 of 7

### PORT130 (continued):

#### Narrative Requirements:

##### Additional Limitations:

Condition No.	Condition
T-2	<p>Additional Limitations: Water line installation shall be in accordance with AWWA standards or manufacturer recommendations. [Recommended Standards for Water Works 8.5.1]</p>
T-3	<p>Additional Limitations: Pipes, fittings, valves and fire hydrants shall conform to the latest standards issued by the AWWA or NSF (if such standards exist). PVC and PE piping used must be certified to ANSI/NSF Standard 61. [Recommended Standards for Water Works 8.0.1]</p>
T-4	<p>Additional Limitations: At high points in water lines, where air can accumulate, provisions shall be made to remove the air by means of hydrants or air relief valves. Automatic air relief valves shall not be used in situations where manhole or chamber flooding may occur. [Recommended Standards for Water Works 8.4.1]</p>
T-5	<p>Additional Limitations: All tees, bends, plugs and hydrants shall be provided with reaction blocking, tie rods or joints designed to prevent movement. [Recommended Standards for Water Works 8.5.4]</p>
T-6	<p>Additional Limitations: A fire hydrant or blow-off shall be required at the end of each dead end line. [Recommended Standards for Water Works 8.1.6]</p>
T-7	<p>Additional Limitations: For each fire hydrant, auxiliary valves shall be installed in the hydrant lead pipe. [Recommended Standards for Water Works 8.3.3]</p>
T-8	<p>Additional Limitations: No flushing device, blow-off, or air relief valve shall be directly connected to any sewer. Chambers, pits or manholes containing valves, blow-offs, meters, or other such appurtenances shall not be directly connected to any storm drain or sanitary sewer. Such chambers, pits or manholes shall be drained to absorptions pits underground or to the surface of the ground where they are not subject to flooding by surface water. [Recommended Standards for Water Works 8.1.6, Recommended Standards for Water Works 8.4.3]</p>
T-9	<p>Additional Limitations: If water lines are installed or replaced in areas of organic contamination or in areas within 200 ft of underground or petroleum storage tanks, ductile iron or other nonpermeable materials shall be used in all portions of the water line installation or replacement. [401 KAR 8:100 Section 1(5)(d)6, Recommended Standards for Water Works 8.0.2]</p>

**Distribution-Major Construction**

Northern KY Water Service  
Facility Requirements

Activity ID No.: APE20060017

**PORT130 (continued):**

**Narrative Requirements:**

**Additional Limitations:**

---

Condition

No.      Condition

---

T-10      Additional Limitations:  
No water pipe shall pass through or come in contact with any part of a sewer manhole. [Recommended Standards for Water Works 8.6.6]

T-11      Additional Limitations:  
If a fire sprinkler system is to be installed, a double check detector assembly approved for backflow prevention shall be utilized. The double check detector assembly of the system shall be accessible for testing. [401 KAR 8:100 Section 1(7)]



**TRANSPORTATION CABINET**

Department of Highways District 6 Office  
421 Buttermilk Pike  
P.O. Box 17130  
Covington, KY 41017  
(859) 341-2700

**Ernie Fletcher**  
Governor

**Bill Nighbert**  
Secretary

**Marc Williams**  
Commissioner of Highways

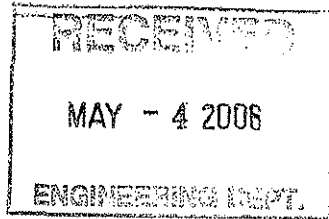

April 26, 2006

SUBJECT: Campbell County, -19-10-11.66  
KY 10 (FLAGG SPRINGS)  
Permit Number 06-0208-06

Dear NORTHERN KENTUCKY WATER SERVICE DISTRICT:

Your application for an encroachment permit has been approved by the Department of Highways. We are returning two copies of the approved permit so one may be kept in your record files. The other copy must be given to the party responsible for completing the project and must be kept at the jobsite at all times.

Please see that the work is done in strict conformity with the permit and any other applicable conditions (See Form TC99-21 and any other attached documents, conditions or specifications). The work should be completed no later than July 1, 2007. When the permitted work and any necessary restoration have been completed please notify this office by using the attached form which will serve as notification for final inspection.

If there are any questions regarding this permit, please do not hesitate to contact Edmond C. Thompson at 859-341-2700 or fax number 859-341-6729.

Sincerely,

  
Tom Schomaker, P.E.  
Chief District Engineer  
Department of Highways  
District 6 -Covington  
P.O. Box 17130  
Covington, KY 41017

KENTUCKY TRANSPORTATION CABINET  
Department of Highways  
Permits Branch

TC 99-1E  
Rev. 10/01

Released Date \_\_\_\_\_

**ENCROACHMENT PERMIT**

PERMIT NO. 06-0208-06

<p><b>APPLICANT IDENTIFICATION:</b>                  NAME: <u>Northern Kentucky Water District</u>                  CONTACT PERSON: <u>Steve Broering</u>                  ADDRESS: <u>2835 Crescent Springs Road</u>                  CITY: <u>Erlanger</u>                  STATE: <u>KY</u> ZIP CODE: <u>41018</u>                  PHONE: area code (<u>859</u>) <u>426-2728</u></p>	<p><b>PROJECT IDENTIFICATION:</b>                  ACCESS CONTROL: <input checked="" type="checkbox"/> By Permit <input type="checkbox"/> Partial <input type="checkbox"/> Full                  COUNTY: <u>Campbell</u> PRIORITY ROUTE NO: <u>KY 10</u>                  MILEPOINT: <u>X</u> <input checked="" type="checkbox"/> Left <input type="checkbox"/> Right <input type="checkbox"/> X-ing                  PROJECT STATUS: <input checked="" type="checkbox"/> Maint. <input type="checkbox"/> Const. <input type="checkbox"/> Design                  PROJECT # STATE: <u>mp-09-0010</u>                  PROJECT # FEDERAL: _____                  ROAD/STREET NAME: <u>Flagg Springs</u></p>
<p><b>TYPE OF ENCROACHMENT:</b>  <input type="checkbox"/> COMMERCIAL ENTRANCE - BUSINESS _____  <input type="checkbox"/> PRIVATE ENTRANCE: <input type="checkbox"/> Single Family <input type="checkbox"/> Farm  <input checked="" type="checkbox"/> UTILITY: <input type="checkbox"/> Overhead <input checked="" type="checkbox"/> Underground  <input type="checkbox"/> GRADE: <input type="checkbox"/> Fill <input type="checkbox"/> Landscape on R/W  <input type="checkbox"/> AIRSPACE: <input type="checkbox"/> Agreement <input type="checkbox"/> Lease  <input type="checkbox"/> OTHER: (Specify) _____</p>	<p><b>ATTACHMENTS:</b>  <input type="checkbox"/> Standard Drawings (List on TC 99-21 under Misc.)  <input checked="" type="checkbox"/> Applicant's Plans  <input type="checkbox"/> Highway Plan and Profile Sheets  <input type="checkbox"/> TC 99-3 (Ponding Encroachment Specs. and Conditions)  <input type="checkbox"/> TC 99-4 (Rest Area Usage Specs. and Conditions)  <input type="checkbox"/> TC 99-5 (Tree Cutting/Trimming Specs. and Conditions)  <input type="checkbox"/> TC 99-6 (Chemical Use of Specs. and Conditions)  <input type="checkbox"/> TC 99-10 (Typical Highway Boring Crossing Detail)  <input type="checkbox"/> TC 99-12 (Overhead Utility Encroachment Diagram)  <input checked="" type="checkbox"/> TC 99-13 (Surface Restoration Methods)  <input checked="" type="checkbox"/> TC 99-21 (Encroachment Permit General Notes and Specs.)  <input type="checkbox"/> TC 99-22 (Agreement for Services to be Performed)  <input type="checkbox"/> TC 99-23 (Mass Transit Shelter Specs. and Conditions)  <input type="checkbox"/> Other Attachments (Specify): _____</p>
<p><b>TYPE OF INDEMNITY:</b> <input type="checkbox"/> Bond <input type="checkbox"/> Cash  <input checked="" type="checkbox"/> SELF-INSURED AMOUNT ENCUMBERED \$ <u>25,000</u>  <input type="checkbox"/> OTHER _____</p>	<p style="text-align: center; font-size: 2em; font-weight: bold; opacity: 0.5;">APPROVED</p> <p style="text-align: center; font-size: 1.5em; font-weight: bold;">APR 26 2006</p>
<p><b>NAME AND ADDRESS OF LOCAL INSURANCE AGENCY OR SELF-INSURED REPRESENTATIVE:</b>                  _____</p>	
<p><b>IDEMNITY:</b> The applicant, in order to secure this obligation, has deposited with the Transportation Cabinet as a guarantee of conformance with the Department's Encroachment Permit requirements, an indemnity in the amount of \$ _____ as determined by the as determined by the Department. It shall be the responsibility of the applicant or permittee, his heirs and assignees to keep all indemnities in full force until construction or reconstruction has been completed and duly accepted by an authorized agent of the Transportation Cabinet, Department of Highways.</p>	
<p><b>BRIEF DESCRIPTION OF WORK TO BE DONE.</b>                  KY 10/Flagg Springs - Subdistrict F installation of 8" ductile iron pipe. Restoration will be 1/2 lane mill and pave in pavement areas and typical restoration in topsoil areas. Drawing # 27, 28, 29 &amp; 30.</p> <p style="font-size: 1.5em; font-weight: bold; margin-top: 20px;"><u>X mp 11.66 - 12.62</u></p>	
<p><b>IMPORTANT (PLEASE READ):</b> Applicant <input type="checkbox"/> does <input checked="" type="checkbox"/> does not intend to apply for excess R/W.</p>	

When the work is completed in accordance with the terms of this encroachment permit, your indemnity will be released. However, the permit is effective until revoked by the Transportation Cabinet and the terms on the permit accompanying permit documents and drawings remain in effect as long as the encroachment exists. **FUTURE MAINTENANCE OF THE ENCROACHMENT IS THE RESPONSIBILITY OF THE PERMITEE.** It is important that you understand the requirements of this encroachment permit application and accompanying documents. If you have not done so, it is suggested that you review these documents and place the permit package in a safe place for future reference.

A copy of this permit and all documents shall be given to your contractor and shall be readily available at the work site for the encroachment permit inspector to review at all times. Failure to meet this requirement may result in cancellation of this permit.

IN THE EVENT THIS APPLICATION IS APPROVED, THIS DOCUMENT SHALL CONSTITUTE A PERMIT FOR THE APPLICANT TO USE THE RIGHT-OF-WAY, BUT ONLY IN THE MANNER AUTHORIZED BY THIS DOCUMENT AND REGULATIONS OF THE DEPARTMENT AND THE DRAWINGS, PLANS, ATTACHMENTS, AND OTHER PERTINENT DATA ATTACHED HERETO AND MADE A PART HEREOF.

Permit No. 06-0208-06

The permittee agrees to the following terms and conditions:

1. The permittee shall comply with and is bound by the requirements of the Department's Permits Manual as revised to and in effect on the date of the issuance of this permit which is made a part hereof by reference.
2. Permittee agrees that if the Department determines that vehicular capacity deficiencies or over capacity conditions develop as a result of the installation and use of this facility, the permittee shall adjust, relocate, or reconstruct the facilities and/or provide and bear the expenses for signs, auxiliary lanes, or other corrective measures reasonably deemed necessary by the Department and as set forth in the Department's Permit Manual within a reasonable length of time after receipt of written notice regarding such adjustments, relocation, additions, modifications, and/or corrective measures, such time to be specified in the notice. In cases where traffic signals are permitted or required, as determined by the Department, the costs for signal equipment and installation(s) shall be borne by the permittee and/or the Department in accordance with Department policy then in force as set forth in the Traffic Manual. Any modifications to the permittee's entrance necessary to accommodate signalization (including necessary easement(s) on private property) shall be the responsibility of the permittee, at no expense to the Department. (This applies only to Entrance Permits.)
3. The said encroachment will not infringe on the frontage rights of an abutting owner without written consent of the said owner as hereto: "I(we) consent to the granting of attached permit." \_\_\_\_\_  
Date \_\_\_\_\_ (This does not apply to utilities which serve the general public.)
4. Any permit granted hereunder shall be with the full understanding that it shall not interfere with any similar rights or permits heretofore granted to any other party except as otherwise provided by law.
5. A plan prepared by Quest Engineers Inc. and dated April 14, 2006 is attached hereto and made a part hereof, which describes the facilities to be constructed by the permittee for which facilities this permit is granted. The permittee agrees as a condition to the issuance of the permit to construct and maintain such facilities in accordance with said plan, and the permittee shall not use the facilities authorized herein in any manner contrary to that prescribed by this permit and plan. Normal usage and routine maintenance only are authorized under this permit.
6. Permittee shall comply with the Manual on Uniform Traffic Control Devices as revised to and in effect on the date of the issuance of this permit which is made a part hereof by reference.
7. Permittee shall at all times from date when work is first commenced and until such time as all facilities are removed from the right-of-way premise, defend, protect, and save harmless the Department from all liability, claims, and demands arising out of work undertaken by the permittee pursuant to this permit, due to any negligent act or omission by the permittee, its servants, agents, employees, or contractors. This provision shall not inure to the benefit of any third party or operate to enlarge any liability of the Department beyond that existing at common law if this right to indemnity did not exist.
8. Upon a violation of any of the provisions of this permit, the Department may revoke the permit by giving notice to the permittee in writing to remove from the right-of-way any facilities placed thereon within a reasonable time as set forth in the notice, and in the event said facilities are not so removed, and the right-of-way restored the Department may cause same to be removed, and the costs thereof shall be charged to the permittee.
9. The permittee, his successors and assigns shall use the encroachment premises in compliance with all Federal requirements imposed pursuant to the provisions of the Title VI of the Civil Rights Act of 1964 (42 U.S.C. 2000-1) and regulations of the U.S. Department of Transportation as set forth in Title 49 C.F.R., Part 21, and as said regulations may be amended.
10. Permittee agrees that in the event it should become necessary, as may be reasonably determined by the Department, for the facilities covered by this permit to be removed or relocated in connection with the reconstruction, relocation, or improvement of the abutting highway, the Department may revoke this permit and require removal or relocation by the permittee at his own expense according and pursuant to the procedures provided in Paragraph 8 above except in those cases where the Department is required by law to pay any or all the same.
11. The permittee understands and agrees that this permit is personal to the permittee and shall not inure to his successors and assigns without the written approval of the Department that he is bound by the provisions of this permit as long as the encroachment exists unless a written release has been obtained from the Department. (Does not apply to utilities serving the general public.)
12. If the work authorized by this permit is on a project in the construction phase, it shall be the responsibility of the permittee to make personal contact with \_\_\_\_\_ Resident Engineer on the project to coordinate the permitted work with the State's prime contractor on the project.
13. This permit does not alleviate any requirements of any other government agency.
14. Permittee agrees to keep the priority route in which this permit was issued clear of dirt, mud, and debris during construction and for the life of this permit.

**ANY ATTEMPT TO ALTER THIS FORM CONSTITUTES A VOID PERMIT.**

THE UNDERSIGNED APPLICANT (being duly authorized representative/owner) DOES AGREE TO ALL TERMS AND CONDITIONS SET FORTH HEREIN.

January 1st, 20  July 1st, 20 07 April 20, 2006 Steve Brien  
Completion Date Date Signature

RECOMMENDED FOR APPROVAL  
Paul S... E.A. W. J. Madson 4/20/06  
Title Signature Chief District Engineer Date

PRIVATE ENTRANCE: TO BE COMPLETED BY PERSONNEL INSTALLING FACILITY.

Installed By: \_\_\_\_\_  
Title Signature Date

**ANY ATTEMPT TO ALTER THIS FORM CONSTITUTES A VOID PERMIT.**

PERMIT NO. 06-0208-06

KENTUCKY TRANSPORTATION CABINET  
Department of Highways  
Louisville Branch

ENCROACHMENT PERMIT GENERAL NOTES & SPECIFICATIONS

I. SAFETY

A. General Requirements

- All signs and control of traffic shall be in accordance with the Manual on Uniform Traffic Control Devices for Streets and Highways, latest edition, Part VI, and safety requirements shall comply with the Permits Manual.
- All work necessary in shoulder or ditchline areas of a state highway is to be scheduled to be promptly completed so that hazards adjacent to the traveled-way are kept to an absolute minimum.
- No more than one (1) traveled-lane is to be blocked or obstructed during normal working hours. All signs and flagmen during lane closure shall conform to the Manual on Uniform Traffic Control Devices.
- When it is necessary to block one (1) traveled-lane of a state highway, the normal working hours shall be as directed by the Department. No lanes are to be blocked or obstructed during adverse weather conditions (i.e., rain, snow, fog, etc.) without specific permission from the Department. Working hours shall be between 8:00 Am and 4:30pm.
- The traveled-way and shoulders shall be kept clear of mud and other construction debris at all times during construction of the permitted facility.
- No nonconstruction equipment or vehicles or office trailers will be allowed on the right-of-way during working hours.
- The right-of-way shall be left free and clear of equipment, material, and vehicles during non-working hours.

B. Explosives

- No explosive devices or explosive material shall be used within state right-of-way without proper license and approval of Kentucky Department of Mines and Minerals, Explosive Division.

C. Other Safety Requirements

- \* APPLICANT MUST REPLACE OR REPAIR, ASAP ANY ROADWAY SIGN REMOVED DUE TO CONSTRUCTION.

II. UTILITIES

- \*All work necessary within the right-of-way shall be behind a temporary fence erected prior to a boring operation.
- \*The temporary woven wire fence shall be removed immediately upon completion of work on the right-of-way and control of access immediately restored to original condition, in accordance with applicable Kentucky Department of Highways Standard Drawings.
- \*All vents, valves, manholes, etc. are to be located outside the right-of-way.
- \*Encasement pipe shall extend from right-of-way line to right-of-way line and shall be one continuous run of pipe. The encasement pipe shall be welded at all joints.
- The boring pit and tail ditch shall extend past the existing toe of slope or bottom of ditch line and shall be a minimum of 30" deep.
- Encasement pipe shall conform to current standards for highway crossings in accordance with the Permits Manual.
- Parallel lines shall be constructed between back slope of ditch line and right-of-way line and shall have a minimum of 36" cover above top of pipe or conduit. (36" preferred)
- All pavement cuts shall be restored per Kentucky Transportation Cabinet Form No. TC 99-13.
- Aerial crossing of this utility line shall have a minimum clearance of \_\_\_\_\_ feet from the high point of the roadway to the low point of the line (calculated at the coefficient for expansion of 120 degrees Fahrenheit).
- The 30' clear zone requirement will be met to the extent possible in accordance with Chapter 99-02.0313 of the Permits Manual.

- Special Requirements:
  - \* FLAWABLE FILL REQUIRED IF UTILITY PIPE IS WITHIN 3' OF EDGE OF ROADWAY.
  - \* MILL & OVERLAY REQUIRED IN DRIVING LANE IF UTILITY IS IN ROADWAY.  
(SEE PAVING DETAILS)

III. GENERAL

A. OSHA

Kentucky Occupational Safety and Health Standards for the construction industry which has the effect of law states in part: (Page 112 1926.651 Specific Excavation Requirements) "Prior to opening an excavation, effort shall be made to determine whether underground installations: i.e., sewer, telephone, water, fuel, electric lines, etc., will be encountered, and if so, where such underground installations are located. When the excavation approaches the estimated location of such an installation, the exact location shall be determined and when it is uncovered, proper supports shall be provided for the existing installation. Utility companies shall be contacted and advised of proposed work prior to the start of actual excavation."

B. Archaeological

Whenever materials of an archaeological nature are discovered during the course of construction work or maintenance operations, contact shall be made immediately with the Division of Environmental Analysis which maintains an archaeologist on its staff, or with the Office of the State Archaeologist located at the University of Kentucky. Following this consultation, further action shall be decided on a case-by-case basis by the State Highway Engineer or the Transportation Planning Engineer or their designated representative.

C. Utilities in the Work Areas

- The permittee is to be responsible for any damage to existing utilities and any utility modifications or relocations within State right-of-way necessary, as determined by the Department or by the owner of the utility, are to be at the expense of the permittee and subject to the approval of the Department.
- All existing manholes and valve boxes are to be adjusted to be flush with finished grade.

IV. RIGHT-OF-WAY RESTORATION

All disturbed portions of the right-of-way are to be restored to grass as per Kentucky Department of Highways Standard Specifications for Road and Bridge Construction (latest edition). A satisfactory turf, as determined by the Department, is to be established by the permittee prior to release of indemnity. Sodding or seeding as follows:

Lawn or High Maintenance Situation	-70% Lawn Fescue (e.g., variety - Falcon)
	-30% Bluegrass or
	70% Lawn Rye (e.g., variety - Derby)
	30% Bluegrass
<u>Right-off-Way Lawn Maintenance Situation</u>	-70% KY 31 Fescue
	-30% Perennial Rye Grass or
	100% KY Fescue

- Two tons clean straw mulch per acre of seeding.
- Prior to seeding, the ground must be prepared in accordance with Kentucky Department of Highways Standard Specifications for Road and Bridge Construction (latest edition).
- Substitutes for sod such as artificial turf or rocked mulch or paved areas may be acceptable if they are aesthetically pleasing.
- All ditch flow lines and all ditch side slopes are to be sodded.
- Existing concrete right-of-way markers are not to be disturbed, but if damaged in any way, they are to be entirely replaced by the permittee with new concrete markers to match the original markers, in accordance with Kentucky Department of Highways Standard Drawings. Markers which are entirely removed are to be re-established in the proper locations by the permittee and to the satisfaction of the Department.
- Other right-of-way restoration requirements are as follows:

V. DRAINAGE

- All pipe is to be laid in a straight alignment, to proper grades, and with all materials and methods of installation including bedding and joint seating in accordance with Department Standard Specifications for Road and Bridge Construction, latest edition. Pipe is not to be covered until inspected by the Department and express permission obtained to make backfill.
- All gutter lines at the base of new curbs are to be on continuous grades, and pockets of water along curbs, or in entrance areas or other paved areas within the right-of-way, are not acceptable.
- All drainage structures and appurtenances (manholes, catch basins, curbing, inlet basins, etc.) shall conform to Department specifications and shall be constructed in accordance with the Department Standard Drawings. Type required:



Permit No. 06-0208-06

VI. PAVING

No bituminous pavement is to be installed within the right-of-way between station numbers 15 and 14.1, nor when the temperature is below 40°F, without the express consent of the Department. No bituminous pavements to be installed when the underlying course is wet.

\* Flammable Fill Required  
\* Flammable Fill Required

Paving within the right-of-way shall be as follows: \* Flammable Fill Required \* \* \* mill? Drilling Required

Base (Type)	* FLAMMABLE FILL	(Thickness)	VARIOUS DEPTH
Surface Base (Type)	BT. BASE CL#	(Thickness)	MATCH EXISTING
Finished Surface (Type)	* * * 26 64-22 0.38"	(Thickness)	1 1/4"

Existing pavement and shoulder material shall be removed to accommodate the above paving specifications.

The finished surface of all new pavement within the right-of-way shall be true to the required slope and grade, uniform in density and texture, free of irregularities, and equivalent in riding qualities to the adjacent highway pavement or as determined by the Department of Highways.

All materials and methods of construction, including base and subgrade preparation, shall be in accordance with Kentucky Department of Highways Specifications for Road and Bridge Construction, latest edition.

24 hours notice to the Department is required prior to beginning paving operations.

Phone: 341-2700  
Name: Mark Brown

To insure proper surface drainage the new pavement is to be flush with the edge of existing highway pavement and is to slope away from the existing edge of the pavement as specified on drawings.

Existing edge of pavement shall be saw cut to provide a straight and uniform joint for new pavement. An approved joint sealer, in accordance with Kentucky Department of Highways Standard Specifications (latest edition) shall be applied between new and existing pavement.

VII. SIDEWALKS SPECIFICATIONS

New Sidewalks

Sidewalks are to be constructed of Class A concrete (3,500 p.s.i. test), are to be " feet in width, are to be 6" in thickness across the bituminous entrance and 4" in thickness across the remaining sections.

Sidewalks are to have tooled joints, not less than 1" in depth at four (4) foot intervals, and 1/2 premoled expansion joints extending entirely through the sidewalk at intervals not to exceed fifty (50) feet.

\* This dimension should be equal to the width of the sidewalk

All materials and methods of construction, including curbing, is to be in accordance with Kentucky Department of Highways Standard Specifications for Road and Bridge Construction, latest edition.

B. Existing Sidewalks

(Applicable if existing sidewalks are being relocated) Use of the sidewalk is not to be blocked or obstructed, and a usable walkway is to be maintained across the construction area at all times.

All damaged sections of the sidewalks are to be entirely replaced to match existing sections.

VIII. DENSE GRADED SHOULDERS

Any existing dense graded aggregate shoulders in the entire frontage within the construction area, which have been disturbed, damaged, or on which dirt has been placed or mud is deposited or tracked, are to be restored to original condition by removal of all contaminated material and replaced to proper grade with new dense graded aggregate.

All new aggregate shoulders as specified on the plan are to consist of 5" compacted dense graded aggregate 2 1/2 pounds per square yard calcium chloride.

All dense graded aggregate shoulders are to slope away from the new edge of pavement at the rate of 1/4" per foot.

IX. CURBING

A. Bituminous Curbs

Bituminous concrete curbs shall be given a paint coat of asphalt emulsion.

The surface under the bituminous concrete curb shall be tacked with asphalt emulsion.

All bituminous concrete curbs shall be constructed of a Class I bituminous concrete mixture as specified by official Department of Highways specifications.

All bituminous curbs shall be of the rolled curb type with a minimum base width of 8" and a minimum height of inches. The top of the curb shall be constructed in such a manner as to guarantee a uniform rolled effect throughout the entire run.

**B. Concrete Curbs**

- All curbs or curb and gutter are to be constructed of Class A concrete (3,500 p.s.i. test) and are to be uniform in height, width, and alignment, true to grade, satisfactory in finish and appearance, as determined by the Department. All materials and methods of construction, including curing, are to be in accordance with Department of Highways Standard Specifications for Road and Bridge Construction, latest edition.
- All concrete curbs are to be 6" in width, extend \_\_\_\_\_ " above finished grade and 12" below finished grade, with all visible edge rounded to 1/2" radii.
- All concrete curbs shall have expansion joints constructed at intervals of not more than 30 feet and 1/2" premolded expansion joint material (cut to conform to the curb or to the curb and gutter section) shall be used in each expansion joint.
- The last \_\_\_\_\_ feet of all concrete curbs are to be tapered down to finish grade.

**X. RIGHT-OF-WAY FENCE REPLACEMENT**

- The replacement fence shall be a height of at least 48" and shall be of sufficient density to contain all animals. (If applicable)
- The replacement fence shall be a minimum of one foot (1') and a maximum of two feet (2') outside the right-of-way line.
- The fence materials and design shall meet accepted industry standards and be treated as paintable.
- The permittee shall be required to maintain the fence in a high state of repair.
- The existing fence shall be removed by permittee and stored at Department's maintenance storage yard for future reuse by the Department.
- The control of access shall not be diminished as a result of replacement of the fence.
- Miscellaneous:

---

---

---

---

NOTICE TO PERMITTEE

THE PERMITTEE AGREES THAT ALL WORK WITHIN THE EXISTING RIGHT-OF-WAY SHALL BE DONE IN ACCORDANCE WITH THE PLANS AS APPROVED AND PERMITTED BY AN ENCROACHMENT PERMIT, ANY CHANGES OR VARIANCES MADE AT THE TIME OF CONSTRUCTION WITHOUT WRITTEN APPROVAL FROM THE DEPARTMENT OF HIGHWAYS SHALL BE REMOVED BY THE PERMITTEE AT NO EXPENSE TO THE DEPARTMENT OF HIGHWAYS AND SHALL BE REDONE TO CONFORM WITH THE APPROVED PLANS.

NOTICE OF COMPLETION OF ENCROACHMENT PERMIT WORK

Please return this form to the District Office when work is completed and ready for final inspection.

---

---

Applicant Identification

Project Identification

Name: NORTHERN KENTUCKY WATER SERVICE Permit Number: 06-0208-06

Contact Person:

County: Campbell

Address: P.O. BOX 17010

Route Number: 10

City: COVINGTON

Road Name: FLAGG SPRINGS

State: KY Zip: 41017

Milepoint: 11.66

Telephone: 606-331-3066

---

---

I wish to notify the Department of Highways that the above mentioned permit work and any necessary right of way restoration have been completed and are ready for final inspection.

---

Applicant

---

---

Please Return To:

Department of Highways  
District 6 Covington  
P.O. Box 17130  
Covington, Ky. 41017

Attention:

Edmond C. Thompson

**SURFACE RESTORATION METHODS**

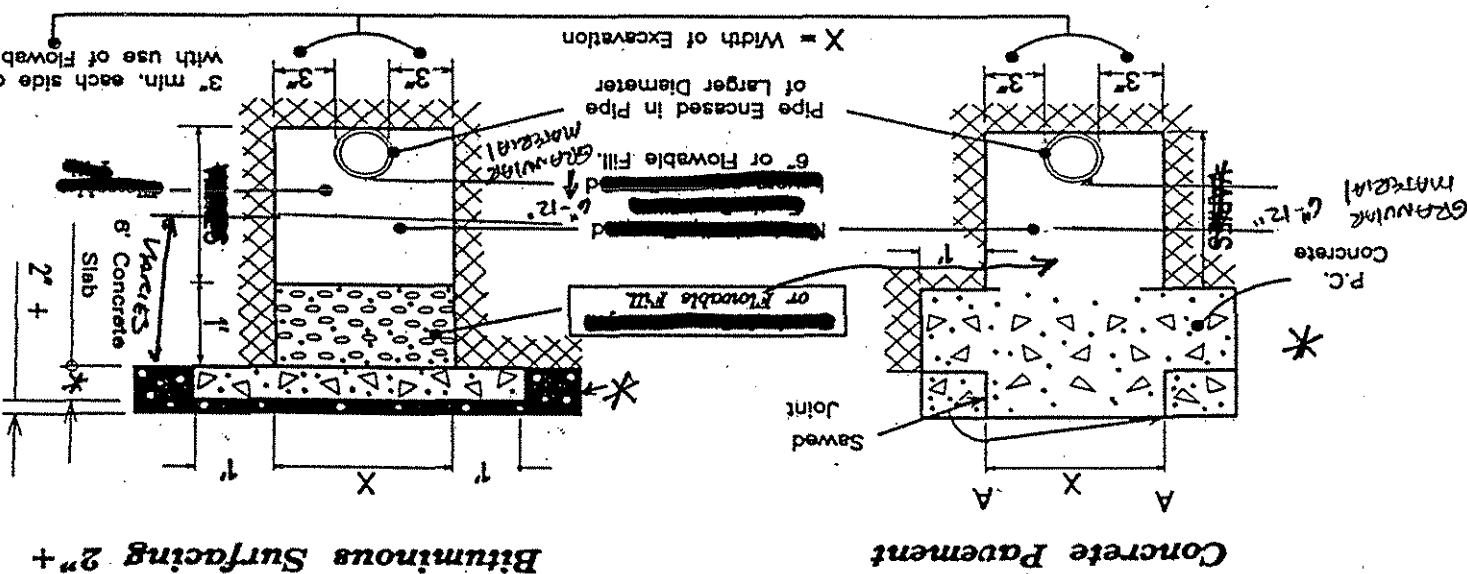

Replace Concrete Pavement with new pavement same thickness of existing pavement.  
 Replace Bituminous Pavement with same type and depth as existing pavement.

**Bituminous Surface Less Than 2" & Traffic Bound Macadam**

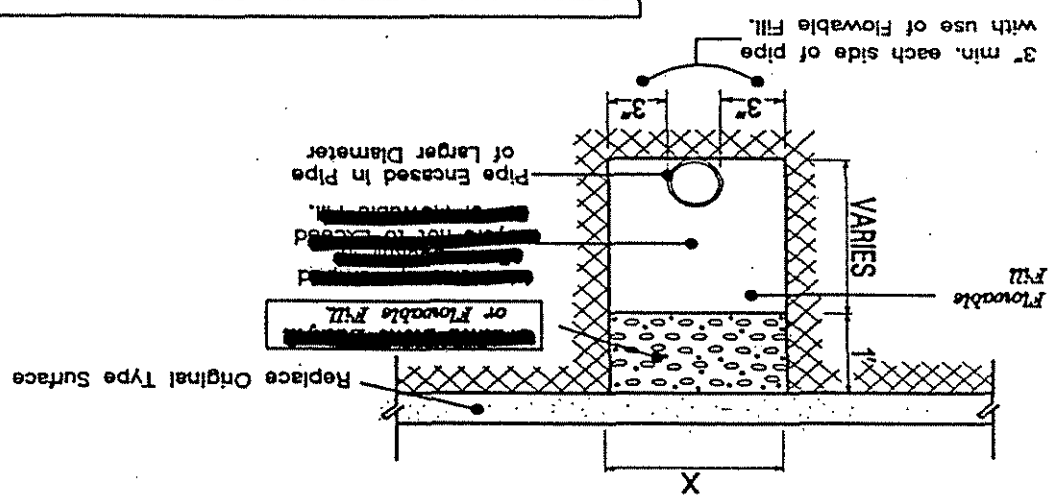

NOTE:

1. Distance From points "A" (Concrete Pavement) to nearest joint or break in pavement must be six (6) feet or more. If less than six (6) feet, remove pavement to joint or break and replace entire slab.  
 Concrete slab under Bituminous Surface to extend twelve (12) inches on each side of trench.
3. An approved joint sealer to be applied between new and existing pavement.

**KENTUCKY TRANSPORTATION CABINET**  
**Department of Highways**

Methods of Surface Restoration Due to Open trench Pipe Installation

\* MATCH DEPTH OF EXISTING PAVEMENT DESIGN

Permit # 06-0208-a



**TRANSPORTATION CABINET**

Department of Highways District 6 Office  
421 Buttermilk Pike  
P.O. Box 17130  
Covington, KY 41017  
(859) 341-2700

**Ernie Fletcher**  
Governor

**Bill Nighbert**  
Secretary

**Marc Williams**  
Commissioner of Highways

April 26, 2006

SUBJECT: Campbell County, -19-10-0  
KY 10 (WEST MAIN STREET)  
Permit Number 06-0207-06

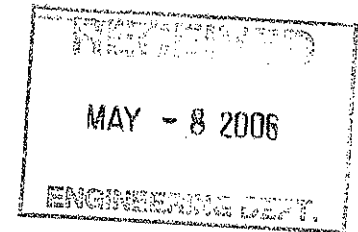

Dear NORTHERN KENTUCKY WATER SERVICE DISTRICT:

Your application for an encroachment permit has been approved by the Department of Highways. We are returning two copies of the approved permit so one may be kept in your record files. The other copy must be given to the party responsible for completing the project and must be kept at the jobsite at all times.

Please see that the work is done in strict conformity with the permit and any other applicable conditions (See Form TC99-21 and any other attached documents, conditions or specifications). The work should be completed no later than July 1, 2007. When the permitted work and any necessary restoration have been completed please notify this office by using the attached form which will serve as notification for final inspection.

If there are any questions regarding this permit, please do not hesitate to contact Edmond C. Thompson at 859-341-2700 or fax number 859-341-6729.

Sincerely,

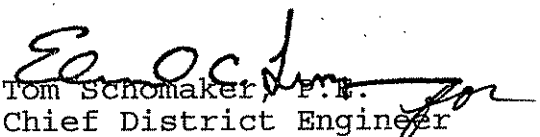
  
Tom Schomaker, P.E.  
Chief District Engineer  
Department of Highways  
District 6 -Covington  
P.O. Box 17130  
Covington, KY 41017

KENTUCKY TRANSPORTATION CABINET  
Department of Highways  
Permits Branch

TC 99-1E  
Rev. 10/01

Released Date \_\_\_\_\_

**ENCROACHMENT PERMIT**

PERMIT NO. 06-0207-06

<p><b>APPLICANT IDENTIFICATION:</b>                  NAME: <u>Northern Kentucky Water District</u>                  CONTACT PERSON: <u>Steve Broering</u>                  ADDRESS: <u>2835 Crescent Springs Road</u>                  CITY: <u>Erlanger</u>                  STATE: <u>KY</u> ZIP CODE: <u>41018</u>                  PHONE: area code (<u>859</u>) <u>426-2728</u></p>	<p><b>PROJECT IDENTIFICATION:</b>                  ACCESS CONTROL: <input checked="" type="checkbox"/> By Permit <input type="checkbox"/> Partial <input type="checkbox"/> Full                  COUNTY: <u>Campbell</u> PRIORITY ROUTE NO: <u>KY 10</u>                  MILEPOINT: <u>X</u> <input type="checkbox"/> Left <input checked="" type="checkbox"/> Right <input type="checkbox"/> X-ing                  PROJECT STATUS: <input checked="" type="checkbox"/> Maint. <input type="checkbox"/> Const. <input type="checkbox"/> Design                  PROJECT # STATE: <u>MP-019-0010</u>                  PROJECT # FEDERAL: _____                  ROAD/STREET NAME: <u>West Main Street</u></p>
<p><b>TYPE OF ENCROACHMENT:</b>  <input type="checkbox"/> COMMERCIAL ENTRANCE - BUSINESS  <input type="checkbox"/> PRIVATE ENTRANCE: <input type="checkbox"/> Single Family <input type="checkbox"/> Farm  <input checked="" type="checkbox"/> UTILITY: <input type="checkbox"/> Overhead <input checked="" type="checkbox"/> Underground  <input type="checkbox"/> GRADE: <input type="checkbox"/> Fill <input type="checkbox"/> Landscape on R/W  <input type="checkbox"/> AIRSPACE: <input type="checkbox"/> Agreement <input type="checkbox"/> Lease  <input type="checkbox"/> OTHER: (Specify) _____</p>	<p><b>ATTACHMENTS:</b>  <input type="checkbox"/> Standard Drawings (List on TC 99-21 under Misc.)  <input checked="" type="checkbox"/> Applicant's Plans  <input type="checkbox"/> Highway Plan and Profile Sheets  <input type="checkbox"/> TC 99-3 (Ponding Encroachment Specs. and Conditions)  <input type="checkbox"/> TC 99-4 (Rest Area Usage Specs. and Conditions)  <input type="checkbox"/> TC 99-5 (Tree Cutting/Trimming Specs. and Conditions)  <input type="checkbox"/> TC 99-6 (Chemical Use of Specs. and Conditions)  <input checked="" type="checkbox"/> TC 99-10 (Typical Highway Boring Crossing Detail)  <input type="checkbox"/> TC 99-12 (Overhead Utility Encroachment Diagram)  <input checked="" type="checkbox"/> TC 99-13 (Surface Restoration Methods)  <input checked="" type="checkbox"/> TC 99-21 (Encroachment Permit General Notes and Specs.)  <input type="checkbox"/> TC 99-22 (Agreement for Services to be Performed)  <input type="checkbox"/> TC 99-23 (Mass Transit Shelter Specs. and Conditions)  <input type="checkbox"/> Other Attachments (Specify): _____</p>
<p><b>TYPE OF INDEMNITY:</b> <input type="checkbox"/> Bond <input type="checkbox"/> Cash  <input checked="" type="checkbox"/> SELF-INSURED AMOUNT ENCUMBERED \$ <u>25,000</u>  <input type="checkbox"/> OTHER _____</p>	<p style="text-align: center; font-size: 24px; font-weight: bold;">APPROVED</p> <p style="text-align: center; font-size: 18px; font-weight: bold;">APR 26 2006</p>
<p><b>NAME AND ADDRESS OF LOCAL INSURANCE AGENCY OR SELF-INSURED REPRESENTATIVE:</b>                  _____</p>	
<p><b>IDEMNITY:</b> The applicant, in order to secure this obligation, has deposited with the Transportation Cabinet as a guarantee of conformance with the Department's Encroachment Permit requirements, an indemnity in the amount of \$ _____ as determined by the as determined by the Department. It shall be the responsibility of the applicant or permittee, his heirs and assignees to keep all indemnities in full force until construction or reconstruction has been completed and duly accepted by an authorized agent of the Transportation Cabinet, Department of Highways.</p>	
<p><b>BRIEF DESCRIPTION OF WORK TO BE DONE.</b>                  KY 10 West Main Street - Subdistrict F installation of 8" ductile iron pipe. Restoration will be 1/2 lane mill and pave in pavement areas and typical restoration in topsoil areas. Drawing # 12 &amp; 13.</p> <p style="font-size: 24px; font-weight: bold; margin-top: 20px;">* MP - 0.00 - 0.740</p>	
<p><b>IMPORTANT (PLEASE READ):</b> Applicant <input type="checkbox"/> does <input checked="" type="checkbox"/> does not intend to apply for excess R/W.</p>	

When the work is completed in accordance with the terms of this encroachment permit, your indemnity will be released. However, the permit is effective until revoked by the Transportation Cabinet and the terms on the permit accompanying permit documents and drawings remain in effect as long as the encroachment exists. **FUTURE MAINTENANCE OF THE ENCROACHMENT IS THE RESPONSIBILITY OF THE PERMITEE.** It is important that you understand the requirements of this encroachment permit application and accompanying documents. If you have not done so, it is suggested that you review these documents and place the permit package in a safe place for future reference.

A copy of this permit and all documents shall be given to your contractor and shall be readily available at the work site for the encroachment permit inspector to review at all times. Failure to meet this requirement may result in cancellation of this permit.

IN THE EVENT THIS APPLICATION IS APPROVED, THIS DOCUMENT SHALL CONSTITUTE A PERMIT FOR THE APPLICANT TO USE THE RIGHT-OF-WAY, BUT ONLY IN THE MANNER AUTHORIZED BY THIS DOCUMENT AND REGULATIONS OF THE DEPARTMENT AND THE DRAWINGS, PLANS, ATTACHMENTS, AND OTHER PERTINENT DATA ATTACHED HERETO AND MADE A PART HEREOF.

Permit No. 06-0207-06

The permittee agrees to the following terms and conditions:

1. The permittee shall comply with and is bound by the requirements of the Department's Permits Manual as revised to and in effect on the date of the issuance of this permit which is made a part hereof by reference.
2. Permittee agrees that if the Department determines that vehicular capacity deficiencies or over capacity conditions develop as a result of the installation and use of this facility, the permittee shall adjust, relocate, or reconstruct the facilities and/or provide and bear the expenses for signs, auxiliary lanes, or other corrective measures reasonably deemed necessary by the Department and as set forth in the Department's Permit Manual within a reasonable length of time after receipt of written notice regarding such adjustments, relocation, additions, modifications, and/or corrective measures, such time to be specified in the notice. In cases where traffic signals are permitted or required, as determined by the Department, the costs for signal equipment and installation(s) shall be borne by the permittee and/or the Department in accordance with Department policy then in force as set forth in the Traffic Manual. Any modifications to the permittee's entrance necessary to accommodate signalization (including necessary easement(s) on private property) shall be the responsibility of the permittee, at no expense to the Department. (This applies only to Entrance Permits.)
3. The said encroachment will not infringe on the frontage rights of an abutting owner without written consent of the said owner as hereto: "I(we) consent to the granting of attached permit." \_\_\_\_\_  
Date \_\_\_\_\_ (This does not apply to utilities which serve the general public.)
4. Any permit granted hereunder shall be with the full understanding that it shall not interfere with any similar rights or permits heretofore granted to any other party except as otherwise provided by law.
5. A plan prepared by Quest Engineers Inc. and dated April 14, 2006 is attached hereto and made a part hereof, which describes the facilities to be constructed by the permittee for which facilities this permit is granted. The permittee agrees as a condition to the issuance of the permit to construct and maintain such facilities in accordance with said plan, and the permittee shall not use the facilities authorized herein in any manner contrary to that prescribed by this permit and plan. Normal usage and routine maintenance only are authorized under this permit.
6. Permittee shall comply with the Manual on Uniform Traffic Control Devices as revised to and in effect on the date of the issuance of this permit which is made a part hereof by reference.
7. Permittee shall at all times from date when work is first commenced and until such time as all facilities are removed from the right-of-way premise, defend, protect, and save harmless the Department from all liability, claims, and demands arising out of work undertaken by the permittee pursuant to this permit, due to any negligent act or omission by the permittee, its servants, agents, employees, or contractors. This provision shall not inure to the benefit of any third party or operate to enlarge any liability of the Department beyond that existing at common law if this right to indemnify did not exist.
8. Upon a violation of any of the provisions of this permit, the Department may revoke the permit by giving notice to the permittee in writing to remove from the right-of-way any facilities placed thereon within a reasonable time as set forth in the notice, and in the event said facilities are not so removed, and the right-of-way restored the Department may cause same to be removed, and the costs thereof shall be charged to the permittee.
9. The permittee, his successors and assigns shall use the encroachment premises in compliance with all Federal requirements imposed pursuant to the provisions of the Title VI of the Civil Rights Act of 1964 (42 U.S.C. 2000-1) and regulations of the U.S. Department of Transportation as set forth in Title 49 C.F.R., Part 21, and as said regulations may be amended.
10. Permittee agrees that in the event it should become necessary, as may be reasonably determined by the Department, for the facilities covered by this permit to be removed or relocated in connection with the reconstruction, relocation, or improvement of the abutting highway, the Department may revoke this permit and require removal or relocation by the permittee at his own expense according and pursuant to the procedures provided in Paragraph 8 above except in those cases where the Department is required by law to pay any or all the same.
11. The permittee understands and agrees that this permit is personal to the permittee and shall not inure to his successors and assigns without the written approval of the Department that he is bound by the provisions of this permit as long as the encroachment exists unless a written release has been obtained from the Department. (Does not apply to utilities serving the general public.)
12. If the work authorized by this permit is on a project in the construction phase, it shall be the responsibility of the permittee to make personal contact with \_\_\_\_\_ Resident Engineer on the project to coordinate the permitted work with the State's prime contractor on the project.
13. This permit does not alleviate any requirements of any other government agency.
14. Permittee agrees to keep the priority route in which this permit was issued clear of dirt, mud, and debris during construction and for the life of this permit.

**ANY ATTEMPT TO ALTER THIS FORM CONSTITUTES A VOID PERMIT.**

THE UNDERSIGNED APPLICANT (being duly authorized representative/owner) DOES AGREE TO ALL TERMS AND CONDITIONS SET FORTH HEREIN.

January 1st, 20\_\_\_\_  July 1st, 2007  April 20, 2006 \_\_\_\_\_  
 Completion Date Date Signature

RECOMMENDED FOR APPROVAL

Pete Sun \_\_\_\_\_ EEOC \_\_\_\_\_ M. J. Madon \_\_\_\_\_ 4/24/06  
 Title Signature Chief District Engineer Date

PRIVATE ENTRANCE: TO BE COMPLETED BY PERSONNEL INSTALLING FACILITY.

Installed By: \_\_\_\_\_  
 Title Signature Date

**ANY ATTEMPT TO ALTER THIS FORM CONSTITUTES A VOID PERMIT.**

**B. Concrete Curbs**

- All curbs or curb and gutter are to be constructed of Class A concrete (3,500 p.s.i. test) and are to be uniform in height, width, and alignment, true to grade and satisfactory in finish and appearance as determined by the Department. All materials and methods of construction, including curing, shall be in accordance with Department of Highways Standard Specifications for Road and Bridge Construction, latest edition.
- All concrete curbs are to be 6" in width, extend \_\_\_\_\_ " above finished grade and 12" below finished grade, with all visible edge rounded to 1/2" radii.
- All concrete curbs shall have expansion joints constructed at intervals of not more than 30 feet and 1/2" premolded expansion joint material (cut to conform to the curb or to the curb and gutter section) shall be used in each expansion joint.
- The last \_\_\_\_\_ feet of all concrete curbs are to be tapered down to finish grade.

**X. RIGHT-OF-WAY FENCE REPLACEMENT**

- The replacement fence shall be a height of at least 48" and shall be of sufficient density to contain all animals. (If applicable)
- The replacement fence shall be a minimum of one foot (1') and a maximum of two feet (2') outside the right-of-way line.
- The fence materials and design shall meet accepted industry standards and be treated as paintable.
- The permittee shall be required to maintain the fence in a high state of repair.
- The existing fence shall be removed by permittee and stored at Department's maintenance storage yard for future reuse by the Department.
- The control of access shall not be diminished as a result of replacement of the fence.
- Miscellaneous:

---

---

---

---

**NOTICE TO PERMITTEE**

THE PERMITTEE AGREES THAT ALL WORK WITHIN THE EXISTING RIGHT-OF-WAY SHALL BE DONE IN ACCORDANCE WITH THE PLANS AS APPROVED AND PERMITTED BY AN ENCROACHMENT PERMIT, ANY CHANGES OR VARIANCES MADE AT THE TIME OF CONSTRUCTION WITHOUT WRITTEN APPROVAL FROM THE DEPARTMENT OF HIGHWAYS SHALL BE REMOVED BY THE PERMITTEE AT NO EXPENSE TO THE DEPARTMENT OF HIGHWAYS AND SHALL BE REDONE TO CONFORM WITH THE APPROVED PLANS.



**VI. PAVING**

- No bituminous pavement is to be installed within the right-of-way between November 15 and April 1, nor when the temperature is below 40°F, without the express consent of the Department. No bituminous pavement is to be installed when the underlying course is wet.
- Paving within the right-of-way shall be as follows: \* FLOWABLE FILL REQUIRED  
\*\* mill & OVERLAY OF DRIVING LANE REQUIRED
- Base (Type) \* FLOWABLE FILL (Thickness) VARIOUS
- Surface Base (Type) BIT. BASE CLIF (Thickness) MATCH EXISTING
- Finished Surface (Type) \*\* PG-64-22 .038 (Thickness) 1 1/4"
- Existing pavement and shoulder material shall be removed to accommodate the above paving specifications.
- The finished surface of all new pavement within the right-of-way shall be true to the required slope and grade, uniform in density and texture, free of irregularities, and equivalent in riding qualities to the adjacent highway pavement or as determined by the Department of Highways.
- All materials and methods of construction, including base and subgrade preparation, shall be in accordance with Kentucky Department of Highways Specifications for Road and Bridge Construction, latest edition.
- 24 hours notice to the Department is required prior to beginning paving operations:  
Phone: 341-2700 Name: MARK BRANNON
- To insure proper surface drainage the new pavement is to be flush with the edge of existing highway pavement and is to slope away from the existing edge of the pavement as specified on drawings.
- Existing edge of pavement shall be saw cut to provide a straight and uniform joint for new pavement. An approved joint sealer, in accordance with Kentucky Department of Highways Standard Specifications (latest edition) shall be applied between new and existing pavement.

**VII. SIDEWALKS SPECIFICATIONS**

- New Sidewalks
    - Sidewalks are to be constructed of Class A concrete (3,500 p.s.i. test), are to be \* \_\_\_\_\_ feet in width, are to be 6" in thickness across the bituminous entrance and 4" in thickness across the remaining sections.
    - Sidewalks are to have tooled joints, not less than 1" in depth at \*four (4) foot intervals, and 1/2 premolded expansion joints extending entirely through the sidewalk at intervals not to exceed fifty (50) feet.
- \* This dimension should be equal to the width of the sidewalk
- All materials and methods of construction, including curing, is to be in accordance with Kentucky Department of Highways Standard Specifications for Road and Bridge Construction, latest edition.
- B. Existing Sidewalks
    - (Applicable if existing sidewalks are being relocated) Use of the sidewalk is not to be blocked or obstructed, and a usable walkway is to be maintained across the construction area at all times.
    - All damaged sections of the sidewalks are to be entirely replaced to match existing sections.

**VIII. DENSE GRADED SHOULDERS**

- Any existing dense graded aggregate shoulders in the entire frontage within the construction area, which have been disturbed, damaged, or on which dirt has been placed or mud is deposited or tracked, are to be restored to original condition by removal of all contaminated material and replaced to proper grade with new dense graded aggregate.
- All new aggregate shoulders as specified on the plan are to consist of 5" compacted dense graded aggregate 2 1/2 pounds per square yard calcium chloride.
- All dense graded aggregate shoulders are to slope away from the new edge of pavement at the rate of 3/4" per foot.

**IX. CURBING**

- A. Bituminous Curbs
  - Bituminous concrete curbs shall be given a paint coat of asphalt emulsion.
  - The surface under the bituminous concrete curb shall be tacked with asphalt emulsion.
  - All bituminous concrete curbs shall be constructed of a Class I bituminous concrete mixture as specified by official Department of Highways specifications.
  - All bituminous curbs shall be of the rolled curb type with a minimum base width of 8" and a minimum height of \_\_\_\_\_ inches. The top of the curb shall be constructed in such a manner as to guarantee a uniform rolled effect throughout the entire run.

III. GENERAL

A. OSHA

Kentucky Occupational Safety and Health Standards for the construction industry which has the effect of law (KRS 327.1926.651 Specific Excavation Requirements) "Prior to opening an excavation, effort shall be made to determine whether underground installations: i.e., sewer, telephone, water, fuel, electric lines, etc., will be encountered, and if so, where such underground installations are located. When the excavation approaches the estimated location of such an installation, the exact location shall be determined and when it is uncovered, proper supports shall be provided for the existing installation. Utility companies shall be contacted and advised of proposed work prior to the start of actual excavation."

B. Archaeological

Whenever materials of an archaeological nature are discovered during the course of construction work or maintenance operations, contact shall be made immediately with the Division of Environmental Analysis which maintains an archaeologist on its staff, or with the Office of the State Archaeologist located at the University of Kentucky. Following this consultation, further action shall be decided on a case-by-case basis by the State Highway Engineer or the Transportation Planning Engineer or their designated representative.

C. Utilities in the Work Areas

The permittee is to be responsible for any damage to existing utilities and any utility modifications or relocations within State right-of-way necessary, as determined by the Department or by the owner of the utility, are to be at the expense of the permittee and subject to the approval of the Department.

All existing manholes and valve boxes are to be adjusted to be flush with finished grade.

IV. RIGHT-OF-WAY RESTORATION

All disturbed portions of the right-of-way are to be restored to grass as per Kentucky Department of Highways Standard Specifications for Road and Bridge Construction (latest edition). A satisfactory turf, as determined by the Department, is to be established by the permittee prior to release of indemnity. Sodding or seeding as follows:

Lawn or High Maintenance Situation

- 70% Lawn Fescue (e.g., variety - Falcon)
- 30% Bluegrass or
- 70% Lawn Rye (e.g., variety - Derby)
- 30% Bluegrass

Right-off-Way Lawn Maintenance Situation

- 70% KY 31 Fescue
- 30% Perennial Rye Grass or
- 100% KY Fescue

Two tons clean straw mulch per acre of seeding.

Prior to seeding, the ground must be prepared in accordance with Kentucky Department of Highways Standard Specifications for Road and Bridge Construction (latest edition).

Substitutes for sod such as artificial turf or rocked mulch or paved areas may be acceptable if they are aesthetically pleasing.

All ditch flow lines and all ditch side slopes are to be sodded.

Existing concrete right-of-way markers are not to be disturbed, but if damaged in any way, they are to be entirely replaced by the permittee with new concrete markers to match the original markers, in accordance with Kentucky Department of Highways Standard Drawings. Markers which are entirely removed are to be re-established in the proper locations by the permittee and to the satisfaction of the Department.

Other right-of-way restoration requirements are as follows:

V. DRAINAGE

All pipe is to be laid in a straight alignment, to proper grades, and with all materials and methods of installation including bedding and joint seating in accordance with Department Standard Specifications for Road and Bridge Construction, latest edition. Pipe is not to be covered until inspected by the Department and express permission obtained to make backfill.

All gutter lines at the base of new curbs are to be on continuous grades, and pockets of water along curbs, or in entrance areas or other paved areas within the right-of-way, are not acceptable.

All drainage structures and appurtenances (manholes, catch basins, curbing, inlet basins, etc.) shall conform to Department specifications and shall be constructed in accordance with the Department Standard Drawings. Type required:

PERMIT NO. 06-0207-06

KENTUCKY TRANSPORTATION CABINET  
Department of Highways  
Permits Branch

ENCROACHMENT PERMIT GENERAL NOTES & SPECIFICATIONS

I. SAFETY

A. General Requirements

- All signs and control of traffic shall be in accordance with the Manual on Uniform Traffic Control Devices for Streets and Highways, latest edition, Part VI, and safety requirements shall comply with the Permits Manual.
- All work necessary in shoulder or ditchline areas of a state highway is to be scheduled to be promptly completed so that hazards adjacent to the traveled-way are kept to an absolute minimum.
- No more than one (1) traveled-lane is to be blocked or obstructed during normal working hours. All signs and flagmen during lane closure shall conform to the Manual on Uniform Traffic Control Devices.
- When it is necessary to block one (1) traveled-lane of a state highway, the normal working hours shall be as directed by the Department. No lanes are to be blocked or obstructed during adverse weather conditions (i.e., rain, snow, fog, etc.) without specific permission from the Department. Working hours shall be between 8:00 Am and 4:30pm.
- The traveled-way and shoulders shall be kept clear of mud and other construction debris at all times during construction of the permitted facility.
- No nonconstruction equipment or vehicles or office trailers will be allowed on the right-of-way during working hours.
- The right-of-way shall be left free and clear of equipment, material, and vehicles during non-working hours.

B. Explosives

- No explosive devices or explosive material shall be used within state right-of-way without proper license and approval of Kentucky Department of Mines and Minerals, Explosive Division.

C. Other Safety Requirements

- 

II. UTILITIES

- \*All work necessary within the right-of-way shall be behind a temporary fence erected prior to a boring operation.
- \*The temporary woven wire fence shall be removed immediately upon completion of work on the right-of-way and control of access immediately restored to original condition, in accordance with applicable Kentucky Department of Highways Standard Drawings.
- \*All vents, valves, manholes, etc. are to be located outside the right-of-way.
- \*Encasement pipe shall extend from right-of-way line to right-of-way line and shall be one continuous run of pipe. The encasement pipe shall be welded at all joints.
- The boring pit and tail ditch shall extend past the existing toe of slope or bottom of ditch line and shall be a minimum of 30" deep.
- Encasement pipe shall conform to current standards for highway crossings in accordance with the Permits Manual.
- Parallel lines shall be constructed between back slope of ditch line and right-of-way line and shall have a minimum of 36" cover above top of pipe or conduit. (~~30"~~ preferred)
- All pavement cuts shall be restored per Kentucky Transportation Cabinet Form No. TC 99-13.
- Aerial crossing of this utility line shall have a minimum clearance of \_\_\_\_\_ feet from the high point of the roadway to the low point of the line (calculated at the coefficient for expansion of 120 degrees Fahrenheit).
- The 30' clear zone requirement will be met to the extent possible in accordance with Chapter 99-02.0313 of the Permits Manual.
- Special Requirements:  
\* FLOWABLE FILL REQUIRED IF PIPE IS WITHIN 3' OF EDGE OF ROADWAY.

NOTICE OF COMPLETION OF ENCROACHMENT PERMIT WORK

Please return this form to the District Office when work is completed and ready for final inspection.

---

---

Applicant Identification

Project Identification

Name: NORTHERN KENTUCKY WATER SERVICE Permit Number: 06-0207-06

Contact Person:

County: Campbell

Address: P.O. BOX 17010

Route Number: 10

City: COVINGTON

Road Name: WEST MAIN STREET

State: KY Zip: 41017

Milepoint: 0

Telephone: 606-331-3066

---

---

I wish to notify the Department of Highways that the above mentioned permit work and any necessary right of way restoration have been completed and are ready for final inspection.

---

Applicant

---

---

Please Return To:

Department of Highways  
District 6 Covington  
P.O. Box 17130  
Covington, Ky. 41017

Attention:

Edmond C. Thompson

**Typical Highway Boring Crossing Detail**

Permit No. 06-0207-04  
Route No. KY 10  
Pavement Width 24'

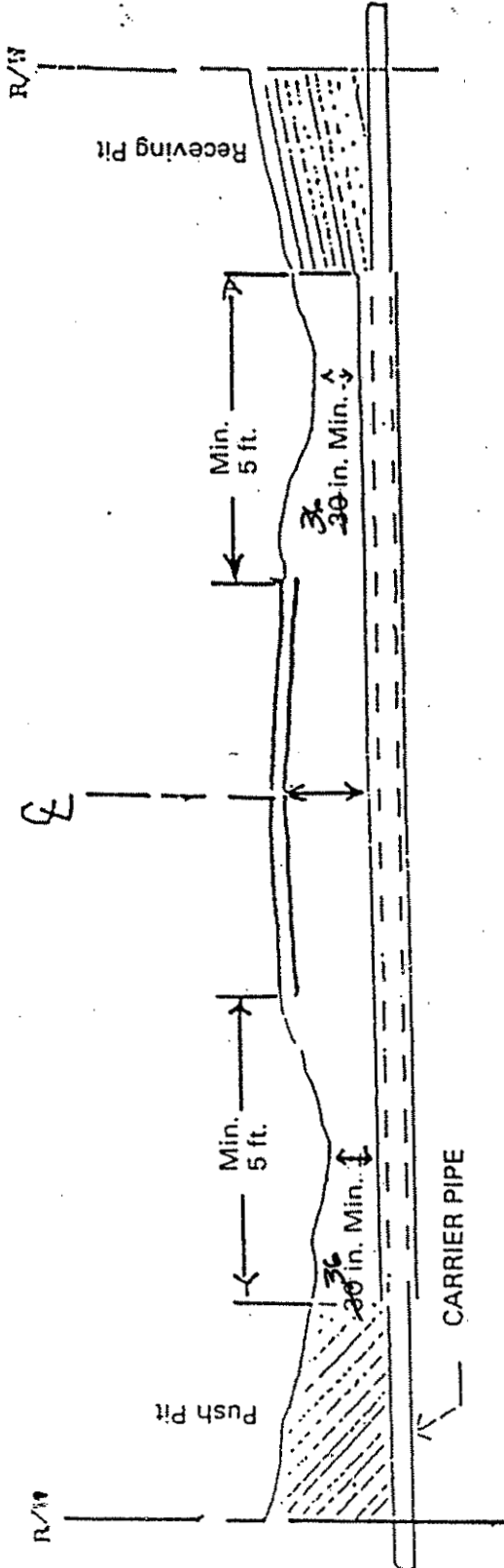

1. Push Pit and Receiving Pit to be backfilled and thoroughly compacted.
2. All Ditch Lines to be left open.
3. Seed and straw all areas disturbed by this work.

Services over 2" to be encased or exempt under Chapter 2 of the Permits Guidance Manual

## SURFACE RESTORATION METHODS

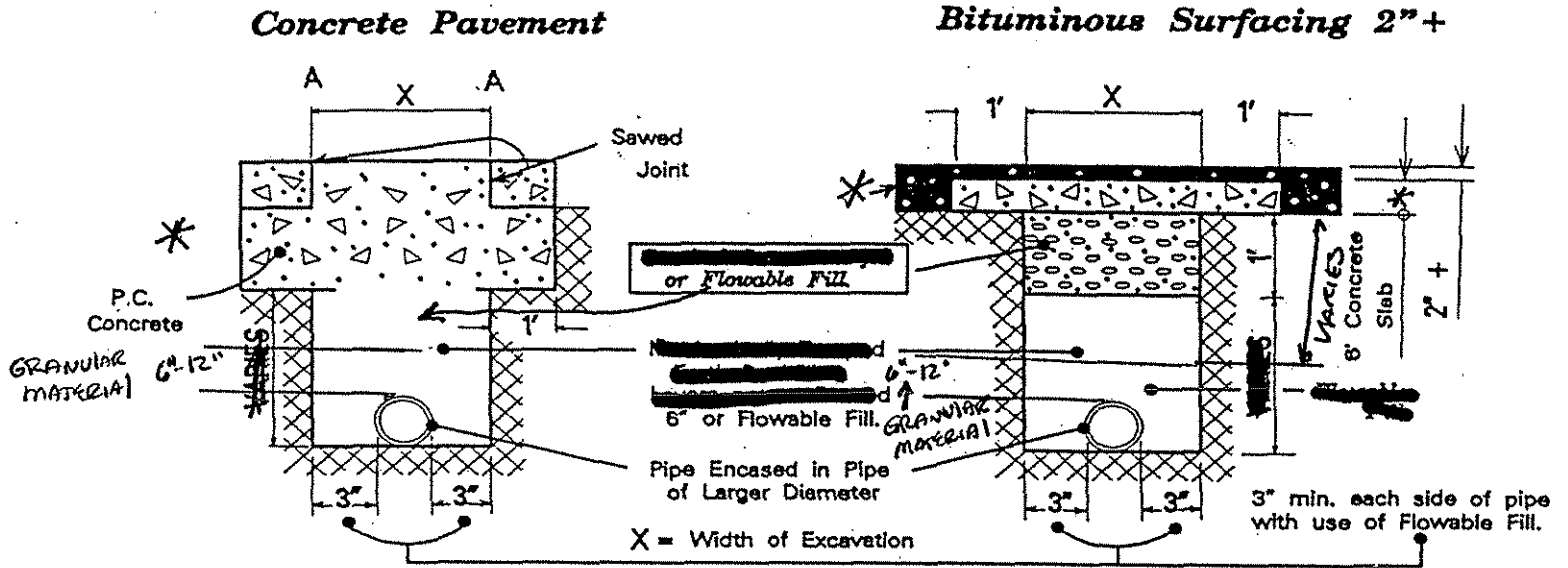

**Replace Concrete Pavement with new pavement same thickness of existing pavement.**

**Replace Bituminous Pavement with same type and depth as existing pavement.**

### Bituminous Surface Less Than 2" & Traffic Bound Macadam

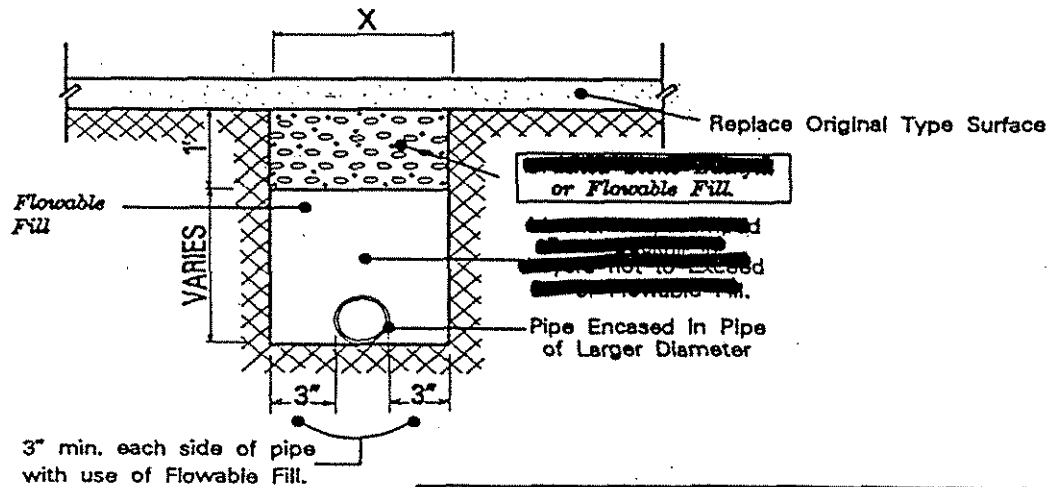

**NOTE:**

- Distance From points "A" (Concrete Pavement) to nearest joint or break in pavement must be six (6) feet or more. If less than six (6) feet, remove pavement to joint or break and replace entire slab.
- Concrete slab under Bituminous Surface to extend twelve (12) inches on each side of trench.
- An approved joint sealer to be applied between new and existing pavement.

**KENTUCKY TRANSPORTATION CABINET**

**Department of Highways**

Methods of Surface Restoration Due to  
 Open trench Pipe Installation

**\* MATCH DEPTH OF EXISTING PAVEMENT DESIGN**

Permit No. 06-0207-06



**TRANSPORTATION CABINET**

Department of Highways District 6 Office  
421 Buttermilk Pike  
P.O. Box 17130  
Covington, KY 41017  
(859) 341-2700

**Ernie Fletcher**  
Governor

**Bill Nighbert**  
Secretary

**Marc Williams**  
Commissioner of Highways

April 26, 2006

SUBJECT: Campbell County, -19-915-3.6  
KY 915 (LI CKING PIKE)  
Permit Number 06-0209-06

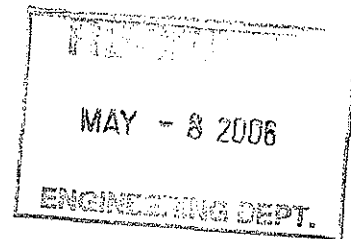

Dear NORTHERN KENTUCKY WATER SERVICE DISTRICT:

Your application for an encroachment permit has been approved by the Department of Highways. We are returning two copies of the approved permit so one may be kept in your record files. The other copy must be given to the party responsible for completing the project and must be kept at the jobsite at all times.

Please see that the work is done in strict conformity with the permit and any other applicable conditions (See Form TC99-21 and any other attached documents, conditions or specifications). The work should be completed no later than July 1, 2006. When the permitted work and any necessary restoration have been completed please notify this office by using the attached form which will serve as notification for final inspection.

If there are any questions regarding this permit, please do not hesitate to contact Edmond C. Thompson at 859-341-2700 or fax number 859-341-6729.

Sincerely,

Tom Schomaker, P.E.  
Chief District Engineer  
Department of Highways  
District 6 -Covington  
P.O. Box 17130  
Covington, KY 41017

KENTUCKY TRANSPORTATION CABINET  
Department of Highways  
Permits Branch

TC 99-1E  
Rev. 10/01

Released Date \_\_\_\_\_

**ENCROACHMENT PERMIT**

PERMIT NO. 06-0209-06

<p><b>APPLICANT IDENTIFICATION:</b>  NAME: <u>Northern Kentucky Water District</u>  CONTACT PERSON: <u>Steve Broering</u>  ADDRESS: <u>2835 Crescent Springs Road</u>  CITY: <u>Erlanger</u>  STATE: <u>KY</u> ZIP CODE: <u>41018</u>  PHONE: area code (<u>859</u>) <u>426-2728</u></p>	<p><b>PROJECT IDENTIFICATION:</b>  ACCESS CONTROL: <input checked="" type="checkbox"/> By Permit <input type="checkbox"/> Partial <input type="checkbox"/> Full  COUNTY: <u>Campbell</u> PRIORITY ROUTE NO: <u>KY 915</u>  MILEPOINT: <u>X</u> <input type="checkbox"/> Left <input checked="" type="checkbox"/> Right <input type="checkbox"/> X-ing  PROJECT STATUS: <input checked="" type="checkbox"/> Maint. <input type="checkbox"/> Const. <input type="checkbox"/> Design  PROJECT # STATE: <u>mp-019-0915</u>  PROJECT # FEDERAL: _____  ROAD/STREET NAME: <u>Licking Pike</u></p>
<p><b>TYPE OF ENCROACHMENT:</b>  <input type="checkbox"/> COMMERCIAL ENTRANCE - BUSINESS  <input type="checkbox"/> PRIVATE ENTRANCE: <input type="checkbox"/> Single Family <input type="checkbox"/> Farm  <input checked="" type="checkbox"/> UTILITY: <input type="checkbox"/> Overhead <input checked="" type="checkbox"/> Underground  <input type="checkbox"/> GRADE: <input type="checkbox"/> Fill <input type="checkbox"/> Landscape on R/W  <input type="checkbox"/> AIRSPACE: <input type="checkbox"/> Agreement <input type="checkbox"/> Lease  <input type="checkbox"/> OTHER: (Specify) _____</p>	<p><b>ATTACHMENTS:</b>  <input type="checkbox"/> Standard Drawings (List on TC 99-21 under Misc.)  <input checked="" type="checkbox"/> Applicant's Plans  <input type="checkbox"/> Highway Plan and Profile Sheets  <input type="checkbox"/> TC 99-3 (Ponding Encroachment Specs. and Conditions)  <input type="checkbox"/> TC 99-4 (Rest Area Usage Specs. and Conditions)  <input type="checkbox"/> TC 99-5 (Tree Cutting/Trimming Specs. and Conditions)  <input type="checkbox"/> TC 99-6 (Chemical Use of Specs. and Conditions)  <input type="checkbox"/> TC 99-10 (Typical Highway Boring Crossing Detail)  <input checked="" type="checkbox"/> TC 99-12 (Overhead Utility Encroachment Diagram)  <input checked="" type="checkbox"/> TC 99-13 (Surface Restoration Methods)  <input checked="" type="checkbox"/> TC 99-21 (Encroachment Permit General Notes and Specs.)  <input type="checkbox"/> TC 99-22 (Agreement for Services to be Performed)  <input type="checkbox"/> TC 99-23 (Mass Transit Shelter Specs. and Conditions)  <input type="checkbox"/> Other Attachments (Specify): <u>APR 26 2006</u></p> <p style="text-align: center; font-size: 2em; font-weight: bold;">APPROVED</p>
<p><b>TYPE OF INDEMNITY:</b> <input type="checkbox"/> Bond <input type="checkbox"/> Cash  <input checked="" type="checkbox"/> SELF-INSURED AMOUNT ENCUMBERED \$ <u>30,000</u>  <input type="checkbox"/> OTHER _____</p> <p><b>NAME AND ADDRESS OF LOCAL INSURANCE AGENCY OR SELF-INSURED REPRESENTATIVE:</b>  _____</p>	
<p><b>IDEMNITY:</b> The applicant, in order to secure this obligation, has deposited with the Transportation Cabinet as a guarantee of conformance with the Department's Encroachment Permit requirements, an indemnity in the amount of \$ _____ as determined by the as determined by the Department. It shall be the responsibility of the applicant or permittee, his heirs and assignees to keep all indemnities in full force until construction or reconstruction has been completed and duly accepted by an authorized agent of the Transportation Cabinet, Department of Highways.</p>	
<p><b>BRIEF DESCRIPTION OF WORK TO BE DONE.</b>  KY 915/Licking Pike - Subdistrict F installation of 8" ductile iron pipe. Restoration will be 1/2 lane mill and pave in pavement areas and typical restoration in topsoil areas. Drawing # 14, 15, 18, 19, 20, 21, 22, 23, 24, 25, &amp; 26.</p> <p style="font-size: 1.5em; font-weight: bold;">X 3.400 - 6.86Z</p>	
<p><b>IMPORTANT (PLEASE READ):</b> Applicant <input type="checkbox"/> does <input checked="" type="checkbox"/> does not intend to apply for excess R/W.</p>	

When the work is completed in accordance with the terms of this encroachment permit, your indemnity will be released. However, the permit is effective until revoked by the Transportation Cabinet and the terms on the permit accompanying permit documents and drawings remain in effect as long as the encroachment exists. **FUTURE MAINTENANCE OF THE ENCROACHMENT IS THE RESPONSIBILITY OF THE PERMITEE.** It is important that you understand the requirements of this encroachment permit application and accompanying documents. If you have not done so, it is suggested that you review these documents and place the permit package in a safe place for future reference.

A copy of this permit and all documents shall be given to your contractor and shall be readily available at the work site for the encroachment permit inspector to review at all times. Failure to meet this requirement may result in cancellation of this permit.

IN THE EVENT THIS APPLICATION IS APPROVED, THIS DOCUMENT SHALL CONSTITUTE A PERMIT FOR THE APPLICANT TO USE THE RIGHT-OF-WAY, BUT ONLY IN THE MANNER AUTHORIZED BY THIS DOCUMENT AND REGULATIONS OF THE DEPARTMENT AND THE DRAWINGS, PLANS, ATTACHMENTS, AND OTHER PERTINENT DATA ATTACHED HERETO AND MADE A PART HEREOF.





PERMIT NO. 06-0209-06

KENTUCKY TRANSPORTATION CABINET  
Department of Highways  
Permits Branch

ENCROACHMENT PERMIT GENERAL NOTES & SPECIFICATIONS

I. SAFETY

A. General Requirements

- All signs and control of traffic shall be in accordance with the Manual on Uniform Traffic Control Devices for Streets and Highways, latest edition, Part VI, and safety requirements shall comply with the Permits Manual.
- All work necessary in shoulder or ditchline areas of a state highway is to be scheduled to be promptly completed so that hazards adjacent to the traveled-way are kept to an absolute minimum.
- No more than one (1) traveled-lane is to be blocked or obstructed during normal working hours. All signs and flagmen during lane closure shall conform to the Manual on Uniform Traffic Control Devices.
- When it is necessary to block one (1) traveled-lane of a state highway, the normal working hours shall be as directed by the Department. No lanes are to be blocked or obstructed during adverse weather conditions (i.e., rain, snow, fog, etc.) without specific permission from the Department. Working hours shall be between 8:00 Am and 4:30 pm.
- The traveled-way and shoulders shall be kept clear of mud and other construction debris at all times during construction of the permitted facility.
- No nonconstruction equipment or vehicles or office trailers will be allowed on the right-of-way during working hours.
- The right-of-way shall be left free and clear of equipment, material, and vehicles during non-working hours.

B. Explosives

- No explosive devices or explosive material shall be used within state right-of-way without proper license and approval of Kentucky Department of Mines and Minerals, Explosive Division.

C. Other Safety Requirements

- \* CONTRACTOR MUST REPLACE OR REPAIR (ASAP) ANY ROADWAY SIGNS THAT IS REMOVED DUE TO UTILITY CONSTRUCTION.

II. UTILITIES

- \*All work necessary within the right-of-way shall be behind a temporary fence erected prior to a boring operation.
- \*The temporary woven wire fence shall be removed immediately upon completion of work on the right-of-way and control of access immediately restored to original condition, in accordance with applicable Kentucky Department of Highways Standard Drawings.
- \*All vents, valves, manholes, etc. are to be located outside the right-of-way.
- \*Encasement pipe shall extend from right-of-way line to right-of-way line and shall be one continuous run of pipe. The encasement pipe shall be welded at all joints.
- The boring pit and tail ditch shall extend past the existing toe of slope or bottom of ditch line and shall be a minimum of 30" deep.
- Encasement pipe shall conform to current standards for highway crossings in accordance with the Permits Manual.
- Parallel lines shall be constructed between back slope of ditch line and right-of-way line and shall have a minimum of 36" cover above top of pipe or conduit. (30" preferred)
- All pavement cuts shall be restored per Kentucky Transportation Cabinet Form No. TC 99-13.
- Aerial crossing of this utility line shall have a minimum clearance of \_\_\_\_\_ feet from the high point of the roadway to the low point of the line (calculated at the coefficient for expansion of 120 degrees Fahrenheit).
- The 30' clear zone requirement will be met to the extent possible in accordance with Chapter 99-02.0313 of the Permits Manual.
- Special Requirements:
  - \* Mill & Overlay REQUIRED FOR DRIVING LANE WHERE UTILITY IS INSTALLED;
  - (SEE PAVING DETAILSHEET)
  - \* FLOWABLE FILL REQUIRED IF UTILITY IS INSTALLED WITHIN 3' OF EDGE OF ROADWAY

III. GENERAL

A. OSHA

- Kentucky Occupational Safety and Health Standards for the construction industry which has the effect of law states in part: (Page 52 1926.651 Specific Excavation Requirements) "Prior to opening an excavation, effort shall be made to determine whether underground installations: i.e., sewer, telephone, water, fuel, electric lines, etc., will be encountered, and if so, where such underground installations are located. When the excavation approaches the estimated location of such an installation, the exact location shall be determined and when it is uncovered, proper supports shall be provided for the existing installation. Utility companies shall be contacted and advised of proposed work prior to the start of actual excavation."

B. Archaeological

- Whenever materials of an archaeological nature are discovered during the course of construction work or maintenance operations, contact shall be made immediately with the Division of Environmental Analysis which maintains an archaeologist on its staff, or with the Office of the State Archaeologist located at the University of Kentucky. Following this consultation, further action shall be decided on a case-by-case basis by the State Highway Engineer or the Transportation Planning Engineer or their designated representative.

C. Utilities in the Work Areas

- The permittee is to be responsible for any damage to existing utilities and any utility modifications or relocations within State right-of-way necessary, as determined by the Department or by the owner of the utility, are to be at the expense of the permittee and subject to the approval of the Department.
- All existing manholes and valve boxes are to be adjusted to be flush with finished grade.

IV. RIGHT-OF-WAY RESTORATION

- All disturbed portions of the right-of-way are to be restored to grass as per Kentucky Department of Highways Standard Specifications for Road and Bridge Construction (latest edition). A satisfactory turf, as determined by the Department, is to be established by the permittee prior to release of indemnity. Sodding or seeding as follows:

Lawn or High Maintenance Situation

- 70% Lawn Fescue (e.g., variety - Falcon)
- 30% Bluegrass or
- 70% Lawn Rye (e.g., variety - Derby)
- 30% Bluegrass

Right-off-Way Lawn Maintenance Situation

- 70% KY 31 Fescue
- 30% Perennial Rye Grass or
- 100% KY Fescue

- Two tons clean straw mulch per acre of seeding.
- Prior to seeding, the ground must be prepared in accordance with Kentucky Department of Highways Standard Specifications for Road and Bridge Construction (latest edition).
- Substitutes for sod such as artificial turf or rocked mulch or paved areas may be acceptable if they are aesthetically pleasing.
- All ditch flow lines and all ditch side slopes are to be sodded.
- Existing concrete right-of-way markers are not to be disturbed, but if damaged in any way, they are to be entirely replaced by the permittee with new concrete markers to match the original markers, in accordance with Kentucky Department of Highways Standard Drawings. Markers which are entirely removed are to be re-established in the proper locations by the permittee and to the satisfaction of the Department.
- Other right-of-way restoration requirements are as follows:

V. DRAINAGE

- All pipe is to be laid in a straight alignment, to proper grades, and with all materials and methods of installation including bedding and joint seating in accordance with Department Standard Specifications for Road and Bridge Construction, latest edition. Pipe is not to be covered until inspected by the Department and express permission obtained to make backfill.
- All gutter lines at the base of new curbs are to be on continuous grades, and pockets of water along curbs, or in entrance areas or other paved areas within the right-of-way, are not acceptable.
- All drainage structures and appurtenances (manholes, catch basins, curbing, inlet basins, etc.) shall conform to Department specifications and shall be constructed in accordance with the Department Standard Drawings. Type required:  
*\* CONTRACTOR MUST REPLACE OR REPAIR ANY DAMAGED ENTRANCE PIPE.*

**VI. PAVING**

- No bituminous pavement is to be installed within the right-of-way between November 15 and April 1, nor when the temperature is below 40°F, without the express consent of the Department. No bituminous pavement is to be installed when the underlying course is wet.
- Paving within the right-of-way shall be as follows: **\* FLOWABLE FILL REQUIRED**
- Base (Type) **\* FLOWABLE FILL** (Thickness) **VARIOUS**
- Surface Base (Type) **BIT BASE CL II** (Thickness) **MATCH EXISTING**
- Finished Surface (Type) **\*\* P664-22 0.38D** (Thickness) **1 1/4"**
- Existing pavement and shoulder material shall be removed to accommodate the above paving specifications.
- The finished surface of all new pavement within the right-of-way shall be true to the required slope and grade, uniform in density and texture, free of irregularities, and equivalent in riding qualities to the adjacent highway pavement or as determined by the Department of Highways.
- All materials and methods of construction, including base and subgrade preparation, shall be in accordance with Kentucky Department of Highways Specifications for Road and Bridge Construction, latest edition.
- 24 hours notice to the Department is required prior to beginning paving operations:  
Phone: **341-2700** Name **MARK BRANNON**
- To insure proper surface drainage the new pavement is to be flush with the edge of existing highway pavement and is to slope away from the existing edge of the pavement as specified on drawings.
- Existing edge of pavement shall be saw cut to provide a straight and uniform joint for new pavement. An approved joint sealer, in accordance with Kentucky Department of Highways Standard Specifications (latest edition) shall be applied between new and existing pavement.

**VII. SIDEWALKS SPECIFICATIONS**

- A. New Sidewalks
  - Sidewalks are to be constructed of Class A concrete (3,500 p.s.i. test), are to be \* \_\_\_\_\_ feet in width, are to be 6" in thickness across the bituminous entrance and 4" in thickness across the remaining sections.
  - Sidewalks are to have tooled joints, not less than 1" in depth at four (4) foot intervals, and 1/2 premolded expansion joints extending entirely through the sidewalk at intervals not to exceed fifty (50) feet.
- \* This dimension should be equal to the width of the sidewalk
- All materials and methods of construction, including curing, is to be in accordance with Kentucky Department of Highways Standard Specifications for Road and Bridge Construction, latest edition.

- B. Existing Sidewalks
- (Applicable if existing sidewalks are being relocated) Use of the sidewalk is not to be blocked or obstructed, and a usable walkway is to be maintained across the construction area at all times.
- All damaged sections of the sidewalks are to be entirely replaced to match existing sections.

**VIII. DENSE GRADED SHOULDERS**

- Any existing dense graded aggregate shoulders in the entire frontage within the construction area, which have been disturbed, damaged, or on which dirt has been placed or mud is deposited or tracked, are to be restored to original condition by removal of all contaminated material and replaced to proper grade with new dense graded aggregate.
- All new aggregate shoulders as specified on the plan are to consist of 5" compacted dense graded aggregate 2 1/2 pounds per square yard calcium chloride.
- All dense graded aggregate shoulders are to slope away from the new edge of pavement at the rate of 3/4" per foot.

**IX. CURBING**

- A. Bituminous Curbs
- Bituminous concrete curbs shall be given a paint coat of asphalt emulsion.
- The surface under the bituminous concrete curb shall be tacked with asphalt emulsion.
- All bituminous concrete curbs shall be constructed of a Class I bituminous concrete mixture as specified by official Department of Highways specifications.
- All bituminous curbs shall be of the rolled curb type with a minimum base width of 8" and a minimum height of \_\_\_\_\_ inches. The top of the curb shall be constructed in such a manner as to guarantee a uniform rolled effect throughout the entire run.

B. Concrete Curbs

- All curbs or curb and gutter are to be constructed of Class A concrete (3,500 p.s.i. test) and are to be uniform in height, width, and alignment, true to grade, and satisfactory in finish and appearance as determined by the Department. All materials and methods of construction, including curing, is to be in accordance with Department of Highways Standard Specifications for Road and Bridge Construction, latest edition.
- All concrete curbs are to be 6" in width, extend \_\_\_\_\_ " above finished grade and 12" below finished grade, with all visible edge rounded to 1/2" radii.
- All concrete curbs shall have expansion joints constructed at intervals of not more than 30 feet and 1/2" premolded expansion joint material (cut to conform to the curb or to the curb and gutter section) shall be used in each expansion joint.
- The last \_\_\_\_\_ feet of all concrete curbs are to be tapered down to finish grade.

**X. RIGHT-OF-WAY FENCE REPLACEMENT**

- The replacement fence shall be a height of at least 48" and shall be of sufficient density to contain all animals. (If applicable)
- The replacement fence shall be a minimum of one foot (1') and a maximum of two feet (2') outside the right-of-way line.
- The fence materials and design shall meet accepted industry standards and be treated as paintable.
- The permittee shall be required to maintain the fence in a high state of repair.
- The existing fence shall be removed by permittee and stored at Department's maintenance storage yard for future reuse by the Department.
- The control of access shall not be diminished as a result of replacement of the fence.
- Miscellaneous:

---

---

---

---

NOTICE TO PERMITTEE

THE PERMITTEE AGREES THAT ALL WORK WITHIN THE EXISTING RIGHT-OF-WAY SHALL BE DONE IN ACCORDANCE WITH THE PLANS AS APPROVED AND PERMITTED BY AN ENCROACHMENT PERMIT, ANY CHANGES OR VARIANCES MADE AT THE TIME OF CONSTRUCTION WITHOUT WRITTEN APPROVAL FROM THE DEPARTMENT OF HIGHWAYS SHALL BE REMOVED BY THE PERMITTEE AT NO EXPENSE TO THE DEPARTMENT OF HIGHWAYS AND SHALL BE REDONE TO CONFORM WITH THE APPROVED PLANS.

NOTICE OF COMPLETION OF ENCROACHMENT PERMIT WORK

Please return this form to the District Office when work is completed and ready for final inspection.

---

---

Applicant Identification

Project Identification

Name: NORTHERN KENTUCKY WATER SERVICE Permit Number: 06-0209-06

Contact Person:

County: Campbell

Address: P.O. BOX 17010

Route Number: 915

City: COVINGTON

Road Name: LI CKING PIKE

State: KY Zip: 41017

Milepoint: 3.6

Telephone: 606-331-3066

---

---

I wish to notify the Department of Highways that the above mentioned permit work and any necessary right of way restoration have been completed and are ready for final inspection.

---

Applicant

---

---

Please Return To:

Department of Highways  
District 6 Covington  
P.O. Box 17130  
Covington, Ky. 41017

Attention:

Edmond C. Thompson

**SURFACE RESTORATION METHODS**

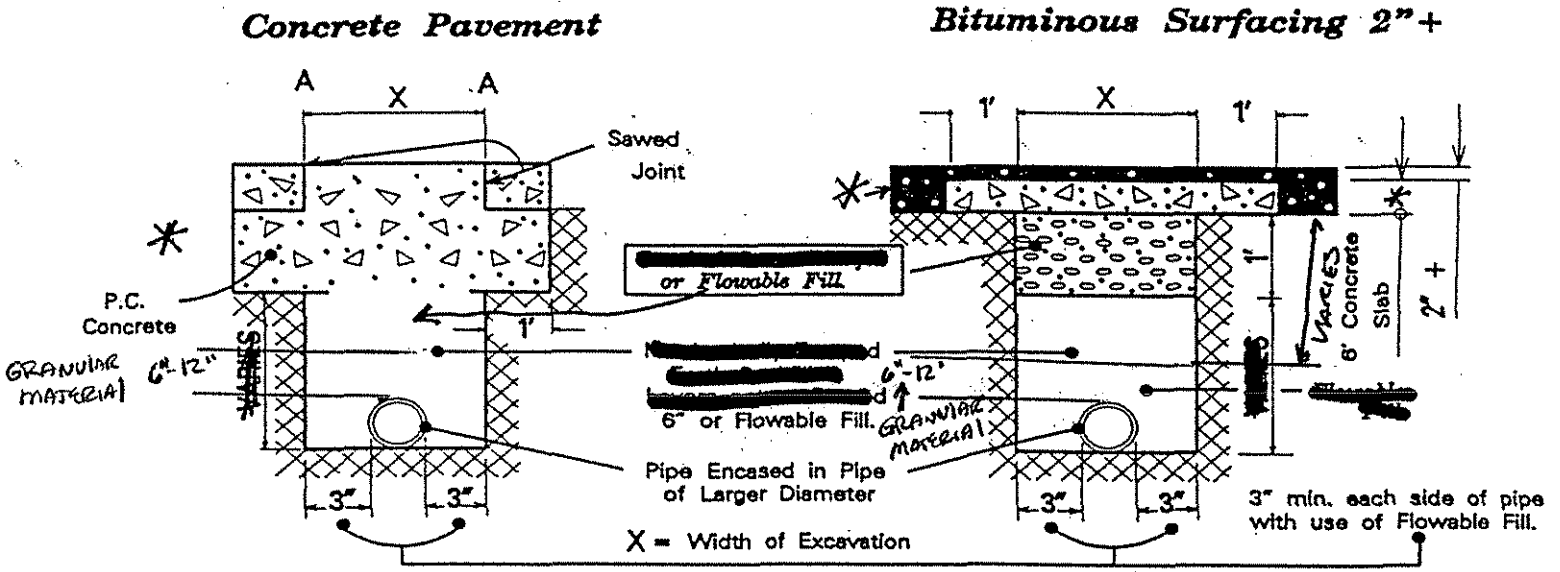

**Replace Concrete Pavement with new pavement same thickness of existing pavement.**

**Replace Bituminous Pavement with same type and depth as existing pavement.**

**Bituminous Surface Less Than 2" & Traffic Bound Macadam**

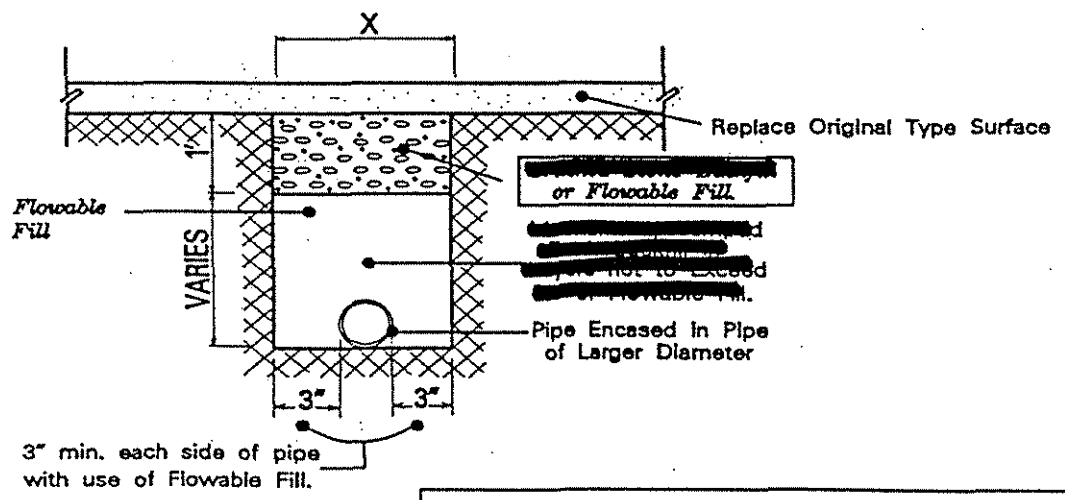

NOTE:

1. Distance From points "A" (Concrete Pavement) to nearest joint or break in pavement must be six (6) feet or more. If less than six (6) feet, remove pavement to joint or break and replace entire slab.
2. Concrete slab under Bituminous Surface to extend twelve (12) inches on each side of trench.
3. An approved joint sealer to be applied between new and existing pavement.

**KENTUCKY TRANSPORTATION CABINET**

**Department of Highways**

---

Methods of Surface Restoration Due to  
 Open trench Pipe Installation

**\* MATCH DEPTH OF EXISTING PAVEMENT DESIGN**

Permit No. 06-0209-06

COUNTY ORDINANCE NO. 0-17-92  
CAMPBELL COUNTY, KENTUCKY

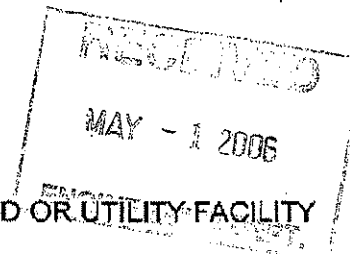

APPLICATION AND PERMIT TO OPEN OR CUT COUNTY ROAD OR UTILITY FACILITY

PERMIT NO.: 03-06

NAME: Northern Kentucky Water District

ADDRESS: 2835 Crescent Springs Road, P.O. Box 18640  
Erlanger, Kentucky 41018

LOCATION OF PROJECT: Steffen Road (Drawing #16 & 17), Heck Road (Drawing #9, 10 & 11), Grandview Drive (Drawing #2, 3, 4, 5, 6 & 7) and Amy Lou Drive (Drawing #8)

PAVEMENT CLASSIFICATION NO.: Asphalt *PER PLAN*

BACKFILL METHOD A: *Flowable Fill All Disturbed Areas To be Restored To Original*

DESCRIPTION OF WORK TO BE DONE: Installation of 8" ductile iron pipe in asphalt and topsoil areas. Pavement areas to be milled and paved, typical trench restoration in topsoil areas.

DATE OF OPENING TO BE MADE: August 2006

ATTACHEMENTS: \_\_\_\_\_ DRAWING OF PROPOSED WORK (PER COUNTY SAMPLE).

APPROVAL SHALL CONSTITUTE A PERMIT FOR THE APPLICANT TO OPEN OR CUT STREET OR UTILITY FACILITY, PER THE TERMS OF CAMPBELL COUNTY ORDINANCE 0-17-92, BUT ONLY IN THE MANNER AUTHORIZED BY THIS DOCUMENT. APPLICANT'S SIGNATURE HEREON CONSTITUTES ACCEPTANCE OF THE TERMS OF ORDINANCE 0-17-92, AND APPLICANT HEREBY AGREES TO COMPLY THEREWITH.

Steve Brown 7/20/06  
APPLICANTS SIGNATURE DATE

PERMIT FEE: \$17.00  
CASH INDEMNITY NO LESS THAN \$500.00

DIRECTOR OF TRANSPORTATION: Lon Schultz  
COUNTY JUDGE/EXECUTIVE: Steve Coulter

THE APPLICANT SHALL HOLD THE COUNTY HARMLESS FROM ALL CLAIMS, DEMANDS, SUITS, DAMAGES AND CAUSES OF ACTIONS ARISING FROM OR RELATING TO THE ACTIVITIES PROVIDED FROM IN THIS APPLICANT, OTHER THAN THE ACTUAL NEGLIGENCE OR INTENTIONAL WRONGDOING OF THE COUNTY, OR ITS AGENTS OR EMPLOYEES.





NORTHERN KENTUCKY  
WATER DISTRICT

**Project – Sub District F**

Campbell County  
184-188

Copy of Rate Schedule,  
Customer Notice and  
Proposed Tariff

**APPENDIX TO AN ORDER OF THE KENTUCKY PUBLIC SERVICE  
COMMISSION IN CASE NO. 2005-00148 DATED April 28, 2006**

The following rates and charges are prescribed for the customers in the area served by Northern Kentucky Water District. All other rates and charges not specifically mentioned herein shall remain the same as those in effect under authority of this Commission prior to the effective date of this order.

Effective Date: June 1, 2006

**1. Service Charges**

<u>Meter Size</u>	<u>Monthly</u>	<u>Quarterly</u>
5/8"	\$ 10.63	\$ 16.09
3/4"	\$ 10.99	\$ 16.95
1"	\$ 12.00	\$ 19.49
1 1/2"	\$ 13.51	\$ 22.96
2"	\$ 17.07	\$ 32.28
3"	\$ 41.22	\$100.44
4"	\$ 51.63	\$126.09
6"	\$ 76.45	\$186.08
8"	\$103.24	\$254.22
10" and larger	\$137.30	\$331.96

**2. Commodity Charges**

	<u>Monthly Block</u>	<u>Quarterly Block</u>	<u>Rate</u>
First	1,500 cubic feet	4,500 cubic feet	\$2.81 per 100 cubic feet
Next	163,500 cubic feet	490,500 cubic feet	\$2.43 per 100 cubic feet
Over	165,000 cubic feet	495,000 cubic feet	\$2.16 per 100 cubic feet

**3. Sub-district Charges (effective 1/13/06)**

- Sub-district A shall be assessed a monthly surcharge in the amount of \$ 9.84
- Sub-district B shall be assessed a monthly surcharge in the amount of \$19.46
- Sub-district C shall be assessed a monthly surcharge in the amount of \$20.33
- Sub-district D shall be assessed a monthly surcharge in the amount of \$30.00
- Sub-district E shall be assessed a monthly surcharge in the amount of \$30.00
- Sub-district F shall be assessed a monthly surcharge in the amount of \$30.00
- Sub-district K shall be assessed a monthly surcharge in the amount of \$30.00
- Sub-district R shall be assessed a monthly surcharge in the amount of \$18.89
- Sub-district RF shall be assessed a monthly surcharge in the amount of \$25.47
- Sub-district RL shall be assessed a monthly surcharge in the amount of \$37.50

**Wholesale Water Rates**

Bullock Pen Water District	\$1.89 per 100 cubic feet or \$2.52 per 1000 gallons
City of Walton	\$1.89 per 100 cubic feet or \$2.52 per 1000 gallons
Pendleton County	\$1.89 per 100 cubic feet or \$2.52 per 1000 gallons

**Miscellaneous Service Fees**

Returned Check Charge	\$20.00
Water Hauling Station	\$ 3.50 per 1000 gallons
Service Charge	\$25.00
Overtime Charge	\$40.00

**NOTICE OF FUTURE WATER SERVICE AND SURCHARGE**

In a section of Rural Campbell County, funded in part by a Kentucky Infrastructure Authority Grant, Northern Kentucky Water District will seek approval of the Public Service Commission of Kentucky to furnish potable water service to Sub-District F Water Main Extension Project. This project is located in the rural area in Campbell County which includes the following streets or portions thereof:

Sub-District F – Licking Pike, West Main Street, Steffen Road, Grandview Road, Amy Lou Drive, Heck Road, and Flagg Springs Pike.

Total construction costs for this project will be in excess of \$1.2 million. The proposed consumer rates will be:

**PRELIMINARY NORTHERN KENTUCKY WATER DISTRICT  
MONTHLY WATER RATES FOR PROPOSED  
SUB-DISTRICT F  
WATER MAIN EXTENSION PROJECT**

**ESTIMATED MONTHLY SURCHARGE OF \$30.00  
SHALL BE ADDED TO THE MINIMUM MONTHLY BILL**

**SECTION II – RETAIL WATER RATES**

1. Rates

First 11,220 gallons used per month	\$2.81 per 748 gallons
Next 1,223,064 gallons used per month	\$2.43 per 748 gallons
Over 1,234,285 gallons used per month	\$2.16 per 748 gallons

Minimum Monthly charges by meter sizes shall apply for each size meter.

Meter Size	Minimum Monthly Amount	Meter Size	Minimum Monthly Amount
5/8"	\$ 10.63	3"	\$ 41.22
3/4"	\$ 10.99	4"	\$ 51.63
1"	\$ 12.00	6"	\$ 76.45
1 1/2"	\$ 13.51	8"	\$ 103.24
2"	\$ 17.07	10"& Larger	\$ 137.30

2. Delayed Payment Charge: 10% penalty

Sample Monthly Bill Amount for a 5/8" meter is as Follows:

Estimated Monthly Usage of 1,000 Gallons	--	Estimated Monthly Bill = \$44.38
Estimated Monthly Usage of 2,000 Gallons	--	Estimated Monthly Bill = \$48.13
Estimated Monthly Usage of 3,000 Gallons	--	Estimated Monthly Bill = \$51.88
Estimated Monthly Usage of 4,000 Gallons	--	Estimated Monthly Bill = \$55.63
Estimated Monthly Usage of 5,000 Gallons	--	Estimated Monthly Bill = \$59.38
Estimated Monthly Usage of 6,000 Gallons	--	Estimated Monthly Bill = \$63.13

Note: Actual bill will vary according to actual measured usage

Note: The estimated monthly bill includes the \$30.00 surcharge amount.

The proposed surcharge may be changed by the Ky. Public Service Commission and may be higher or lower than proposed.

Any corporation, association, body politic or person may by timely motion, within 30 days of this notice, request intervention in the case. The motion must be submitted in writing to the Public Service Commission, 211 Sower Blvd., Box 615 Frankfort, KY 40602 and should state the grounds for the request, including the interest and status of the party. Customers may obtain without cost a copy of the Application and any testimony filed by contacting Northern Kentucky Water District at the address below. Interveners may obtain a copy of the Application and supporting documents. A copy of the Application and testimony is available for public review at the district's office.

For further information contact the PSC of Kentucky at PO Box 615 Frankfort, KY 40602 (Tel: 502 564 3940). Or contact the undersigned.

Northern Kentucky Water District  
2835 Crescent Springs Road  
PO Box 18640  
Erlanger, KY 41018  
(859) 578-9898

**SECTION II – RETAIL WATER RATES**

**Northern Kentucky Water District Service Area**

1. Monthly Service Rate

First	1,500 cubic feet	\$2.81 per 100 cubic feet
Next	163,500 cubic feet	\$2.43 per 100 cubic feet
Over	165,000 cubic feet	\$2.16 per 100 cubic feet

**Customers in Subdistrict A** \*shall be assessed a monthly surcharge in the amount of \$9.84

**Customers in Subdistrict B** \*shall be assessed a monthly surcharge in the amount of \$19.46

**Customers in Subdistrict C** \*shall be assessed a monthly surcharge in the amount of \$20.33

**Customer in Subdistrict D** \*shall be assessed a monthly surcharge in the amount of \$30.00

**Customers in Subdistrict E** \*shall be assessed a monthly surcharge in the amount of \$30.00

**Customers in Subdistrict F** \*shall be assessed a monthly surcharge in the amount of \$30.00

**Customers in Subdistrict R** \*shall be assessed a monthly surcharge in the amount of \$18.89

**Customers in Subdistrict RF** \*shall be assessed a monthly surcharge in the amount of \$25.47

**Customers in Subdistrict RL** \*shall be assessed a monthly surcharge in the amount of \$37.50

\*Subdistrict charges are reviewed annually.

\*Detailed street listing within each Subdistrict can be found under Appendix A.

\*Service connections on extensions or laterals from a Subdistrict street will be assessed the appropriate Subdistrict charge.

2. Quarterly Rates

First	4,500 cubic feet	\$2.81 per 100 cubic feet
Next	490,500 cubic feet	\$2.43 per 100 cubic feet
Next	495,000 cubic feet	\$2.16 per 100 cubic feet

3. Fixed Service Charge

<u>Meter Size</u>	<u>Monthly Service Charge</u>	<u>Quarterly Charge</u>
5/8"	\$10.63	\$16.09
3/4"	\$10.99	\$16.95
1"	\$12.00	\$19.49
1 1/2"	\$13.51	\$22.96
2"	\$17.07	\$32.28
3"	\$41.22	\$100.44
4"	\$51.63	\$126.09
6"	\$76.45	\$186.08
8"	\$103.24	\$254.22
10" and Larger	\$137.30	\$331.96

Date of Issue: June 22, 2006

Date Effective: August 1, 2006

Issued by: \_\_\_\_\_  
 Officer & Title Jack Bragg, Jr. CPA, CMA  
 Vice President - Finance

2835 Crescent Springs Road, Erlanger, Ky 41018

---

**APPENDIX A – Subdistrict Street Names**

**Customers in Subdistrict A**

- Ashford Village Subdivision - Donegal Ct., Ashford Rd., Celtic Ct., Galloway Ct., Kildare Ct., Limerick Circlecourt, Waterford Ct. (Off of Mills Rd.)
- Bowman Rd. (KY 16 to end of road)
- Dorman Dr. (Hickory Grove to end of road)
- Gretchen Dr. (Ryland Estates Subdivision) – Stewart to end of road
- Hickory Grove Drive – KY 16 to end of road
- KY 177 – Porter Rd. to Pruett Rd.
- Manor Hill Subdivision - Briarcrest Lane, Burbridge Trail, Chipping Camden, Cotswold Way, Foxbourne Lane, Manor Hill Dr., Sussex Ct., Tanglewood Trace, Teenisian Pl., Willowhurst Trace & Windmere Hill (Off Marshall Rd.)
- Manor Lake Dr. – KY 16 to end of road
- Marshall Rd. – KY 16 to Stewart Rd.
- Miller Lane – Tapped off KY 177
- Mills Rd. – Marshall to Taylor Mill Water Service Area (5,700’)
- Petty Rd. – Tapped off Marshall Rd.
- Pruett Rd. – KY 177 to 300’
- Riggs Rd. – KY 16 to end of road
- Ryland Trace Dr. – Subdivision off KY 177
- Staffordsburg Rd. – Marshall Rd. to Maverick
- Stewart Rd. – Marshall to KY 177
- Teegarden Lane – Bowman to end of road

**Customers in Subdistrict B**

- Armstrong Rd. – 1 service tapped off Moffett
- Bird Rd. – KY 17 to Wynewood
- Farmview Dr. – Moffett Rd. to end of pavement
- Gleason – 1 service tapped off Madison
- KY 17 (Madison Pike) – 12363 to 14158 – 1,200’ North of Callant Rd. to Gleason
- Martin Rd. – Moffett Rd. to 3,650’
- Moffett Rd. – KY 17 to Armstrong Rd.
- Rector Rd. – Moffett Rd. to 8,100’
- Rosehawk Lane (Forrest Ridge Subdivision Off of Moffett)
- Wynewood Trail – Bird Rd. to end of road

**Customers in Subdistrict C**

- Banklick Rd. – From Bristow to Maher
- Callant – From KY 17 for the first 0.6 miles
- Dixon Dr. – 2 services tapped on KY 17, 1 service tapped on Rich Rd.
- Gardnersville Rd. – From KY 17 for the first 0.8 miles
- Glenhurst Subdivision – Chinkapin Circle, Berlander Dr., Glenhurst Dr., Lyonia Dr., Colton Ct., Hornbean Dr. Off of Maher Rd.)  
Glenhurst Subdivision – Glenhurst Drive (Subdistrict stops at Intersection of Glenhurst Dr. & Berlander Dr. Off of Maher Road)

---

Date of Issue: June 22, 2006

Date Effective: August 1, 2006

Issued by: \_\_\_\_\_  
Officer & Title Jack Bragg, Jr. CPA, CMA  
Vice President - Finance

2835 Crescent Springs Road, Erlanger, Ky 41018

**APPENDIX A – Subdistrict Street Names – Cont’d**

- Glenhurst Subdivision – Glenhurst Drive (Sub district stops at Intersection of Glenhurst Drive & Berlander Drive, Off of Maher Road
- Graven Rd. – From Maher, 4,400’ towards Wright Road
- Green Rd. – KY 16 to US 25
- Hempfling Rd. – First 2.1 miles
- Independence – From Shaw to Maher Rd., Maher 2700’ towards Banklick
- KY 17 (Madison Pike) – 14192 – 15960 – Gleason to Pendleton County Line
- Maher – From Banklick Rd. to Kenton/Boone County Line
- Maher – From Independence Road to Banklick
- Martin Road – From Subdistrict B to Staffordsburg Road
- Mulberry Lane – (Rolling Greene Subdivision off of Green Road)
- Paxton Road – From KY 17 for the first 0.65 miles
- Percival Road
- Rector Road – From Subdistrict B to Kenton Station Road
- Rich Road – From KY 17 for the first 2.1 miles
- South Fork Estates Subdivision (South Fork Drive)
- South Fork Estates Subdivision (Thoroughbred Lane)
- South Fork Estates Subdivision – Stablegate
- Spillman Road – KY 17 to end of road
- Staffordsburg Road – From KY 16 to Martin Road
- Stephenson Road – From Green Road to the first 0.5 miles
- Symbo – From Green Road for the first 0.6 miles
- Tupelo Drive – Glenhurst Subdivision, Off of Maher Road
- US 25 – Walton City Limits to KY 14
- Visalia Road – From Klein Road to the school (waiting on PSC approval)
- Visalia Road – From Staffordsburg Road for 2 miles
- York Road – From US 25 to the first 0.4 miles

**Customer in Subdistrict D**

- 4 Mile Pike from Uhl Road to Geenville
- California Cross Roads from Saint Peter and Paul to Washington Trace Road
- Ky Route 8 to McDonald Lane off Blangey Road
- Persimmon Grove Pike from Burns Road to California Cross Road
- Persimmon Grove Pike from Stevens Branch to Shaw Hess
- Wagner Road – first .6 miles
- Winters Lane – County
- Providence Trace off of 4 Mile
- Licking Pike & Steffen Road from Route 10 to KY 936 – ky 936 before Poplar Thicket

**Customers in Subdistrict E**

- Bethel Grove
- Brandy Lane
- Bromley Crescent Springs Road
- Fiskburg Road (KY 17 to Goshorn Road)

Date of Issue: June 22, 2006

Date Effective: August 1, 2006

Issued by: \_\_\_\_\_

2835 Crescent Springs Road, Erlanger, Ky 41018

Officer & Title Jack Bragg, Jr. CPA, CMA  
 Vice President - Finance



**APPENDIX A – Subdistrict Street Names – Cont’d**

- Ishmael Road (KY 177 to 1200')
- Kenton Station (Rector Road to KY 177)
- KY 177 (North of Kenton Station 7100')
- KY 177 (North of Vises Trail 4250')
- KY 177 (South of Kenton Station 5400')
- KY 177 (South of Vises Trail 2850')
- Licking Station
- McDonald Avenue
- Oliver Road
- St. Johns Road
- Vises Trail from KY 177 to 1150' south of Visalia Road
- Whitaker

**Customer is Subdistrict F**

- Grandview Road
- Amy Lou Drive
- Heck Road
- Steffen Road
- Licking Pike (Existing 8 to Ripple Creek)
- Licking Pike (from Trapp Road to Rifle Range Road)
- Licking Pike (from Rifle Range Road to Sub District D)
- Flagg Springs Pike

**Customers in Subdistrict R**

- Coleman Road – KY 177 to end of street
- Feiser Road – Porter Road to Locust Pike
- KY 177 – 500' North of Wards to 2900' South of Wards
- KY 177 – Porter Road to 800' North
- KY 177 – Pruett Road to Ryland Lakes Drive
- Locust Pike – 650' West of Whites end of road
- Locust Pike – Feiser Road to Wards Lane
- Porter Road – KY 177 to 7,500'
- Redrow – Locust Pike to end of street
- Spanton Road – Locust Pike to 1,300'
- Wards Lane – Locust Pike to KY 177
- Whites Road – KY 177 to Locust Pike

**Customers in Subdistrict RF**

- KY 177 (From Subdistrict R to short Marshall)
- Porter Road (From Tecuseh approximately 500')
- Short Marshall (KY 177 East 500')
- Tecumseh

**Customers in Subdistrict RL**

- Crystal Court

---

Date of Issue: June 22, 2006

Date Effective: August 1, 2006

Issued by: \_\_\_\_\_

2835 Crescent Springs Road, Erlanger, Ky 41018

Officer & Title Jack Bragg, Jr. CPA, CMA  
Vice President - Finance

**APPENDIX A – Subdistrict Street Names – Cont'd**

- Crystal Drive
- Crystal Lane
- Ernst Bridge Road
- Hillside Drive
- Maplewood Drive
- Meadow Lane
- Mirror Court
- Northall Court
- Orchard Lane
- Redbud Lane
- Ryland Lakes Drive
- Sylvan Lake Drive
- Wild Lake Drive

---

Date of Issue: June 22, 2006

Date Effective: August 1, 2006

Issued by: \_\_\_\_\_  
Officer & Title Jack Bragg, Jr. CPA, CMA  
Vice President - Finance

2835 Crescent Springs Road, Erlanger, Ky 41018



Case No. 200-\_\_\_\_\_  
Exhibit     F    

NORTHERN KENTUCKY  
WATER DISTRICT

**Project – Sub District F**

Campbell County

184-188

Sources of Construction Funds

NORTHERN KENTUCKY WATER DISTRICT  
 SUBDISTRICT - F  
 CAMPBELL COUNTY SERVICE AREA  
 Bid Prices

	STREET	DISTANCE MILES	TOTAL AVAIL. CUST	BID COST
Pk. A	Grandview Rd. (incl. Amy Lou Dr.)	1.70	43	\$485,426
	Heck Rd.	0.70	12	
	West Main Street	0.5	10	\$936,568
	Steffen Road	0.4	11	
Pk. B	Licking Pike (Existing 8 to Ripple Creek)	0.4	7	
	Licking Pike From Trapp Rd to Rifle Range	1.7	31	
	Licking Pike from Rifle Range to Sub-D	0.85	7	
	Licking Pike 12" Upgrade Cost			\$165,292
Pk. C	Flagg Springs (Route 10)	1	15	\$195,305
		7.25	136	\$1,782,591

Cost Estimate:

1	Construction	\$1,782,591
2	Engineering	\$54,800
3	Geotechnical	\$23,311
4	Geotechnical Inspection (0.06%)	\$10,696
	KIA Administrative Fee (1/2 of 1%)	\$6,440
6	Legal	\$15,000
7	Contingencies	\$646,965
	Total	\$2,539,803

Source of Funds:

1	KIA/State Budget Funding	\$1,288,000
2	Campbell County Fiscal Court	\$25,000
3	Flagg Springs Market	\$55,000
4	Northern Ky Water Dist. Bond Issue	
4a	NKWD Extension Contribution	\$750,000
4b	NKWD Hydraulic Improvement Contr.	\$175,515
4c	NKWD Customer Surcharge	\$246,288
	Total	\$2,539,803