

RECEIVED
001 06405
PUBLIC SERVICE COMMISSION

COMMONWEALTH OF KENTUCKY
BEFORE THE PUBLIC SERVICE COMMISSION

In the Matter of:

**APPLICATION OF BLUEGRASS WIRELESS LLC
FOR ISSUANCE OF A CERTIFICATE OF PUBLIC
CONVENIENCE AND NECESSITY TO CONSTRUCT
A CELL SITE (BURNSIDE) IN RURAL SERVICE
AREA #6 (PULASKI) OF THE COMMONWEALTH OF
KENTUCKY**

CASE NO. 2005-00282

**APPLICATION FOR A CERTIFICATE
OF PUBLIC CONVENIENCE AND NECESSITY (BURNSIDE)**

Bluegrass Wireless LLC ("Bluegrass Wireless"), through counsel, pursuant to KRS 278.020 and 278.040, hereby submits this application for a certificate of public convenience and necessity to construct a cell site to be known as the Burnside cell site in and for rural service area ("RSA") #6 of the Commonwealth of Kentucky, namely the counties of Boyle, Casey, Garrard, Laurel, Lincoln, Madison, Pulaski, and Rockcastle, Kentucky.

1. As required by 807 KAR 5:001 Sections 8(1) and (3), and 807 KAR 5:063, Bluegrass Wireless states that it is a Kentucky limited liability company whose full name and post office address are: Bluegrass Wireless LLC, 2902 Ring Road, Elizabethtown, Kentucky, 42701.
2. Pursuant to 807 KAR § 1 (1)(b), a copy of the applicant's applications to the Federal Aviation Administration and Kentucky Airport Zoning Commission are Exhibit "A". Written authorizations from these agencies will be supplied to the Commission upon their approval.
3. Pursuant to 807 KRS 5:063 §1(1)(d), applicant is submitting as Exhibit "B" a "preliminary" geotechnical investigation report, signed and sealed by a professional engineer registered in Kentucky, that includes boring logs, foundation design recommendations, and a finding as to the susceptibility of the area surrounding the proposed site to flood hazard. The geotechnical report is "preliminary" because, pursuant to a letter dated September 27, 2005 (also attached as Exhibit "B") from the United States Department of the Interior, Fish and Wildlife Service, applicant is being delayed from completing its geotechnical survey until on or about November 15, 2005 due to the possible existence of a "summer roost habitat" for the Indiana bat at the proposed site. After the

November 15th deadline has expired and the applicant is permitted to complete its geotechnical survey, a copy of the complete geotechnical report will be submitted to the Commission.

4. Pursuant to 807 KRS 5:063 §1(1)(e), clear directions from the county seat to the proposed site, including highway numbers and street names, if applicable, with the telephone number of the person who prepared the directions are Exhibit "C".

5. Pursuant to 807 KRS 5:063 §1(1)(f), a copy of the lease (or sale agreement) for the property on which the tower is proposed to be located, is Exhibit "D".

6. Pursuant to 807 KAR §1(1)(g), experienced personnel will manage and operate the Burnside cell site. The President of Bluegrass Cellular Inc., Mr. Ron Smith, is ultimately responsible for all construction and operations of the cellular system of Bluegrass Wireless, of which system the Burnside cell site will be a part. Bluegrass Cellular Inc. provides management services to Bluegrass Wireless under a management contract, just as it does with three (3) other wireless carriers in the Commonwealth. And, Bluegrass Cellular Inc. has been providing these management services to these other wireless carriers for well over a decade. This extensive management experience with Bluegrass Cellular demonstrates that Bluegrass Cellular Inc.'s management and technical ability to supervise the operations of a wireless carrier.

7. Pursuant to 807 KAR §1(1)(g), East Pointe Manufacturing is responsible for the design specifications of the proposed tower (identified in Exhibit "B").

8. Pursuant to 807 KRS 5:063 §1(1)(h), a site development plan or survey, signed and sealed by a professional engineer registered in Kentucky, that shows the proposed location of the tower and all easements and existing structures within 500 feet of the proposed site on the property on which the tower will be located, and all easements and existing structures within 200 feet of the access drive, including the intersection with the public street system, is Exhibit "B".

9. Pursuant to 807 KRS 5:063 §1(1)(i), a vertical profile sketch of the tower, signed and sealed by a professional engineer registered in Kentucky, indicating the height of the tower and the placement of all antennas; is Exhibit "B".

10. Pursuant to 807 KRS 5:063 §1(1)(j), the tower and foundation design plans and a description of the standard according to which the tower was designed, signed and sealed by a professional engineer registered in Kentucky, is Exhibit "B".

11. Pursuant to 807 KRS 5:063 § 1 (1)(k), a map, drawn to a scale no less than one (1) inch equals 200 feet, that identifies every structure and every owner of real estate within 500 feet of the proposed tower, is Exhibit “E”.

12. Pursuant to 807 KRS 5:063 § 1 (1)(l), applicant’s legal counsel hereby affirms that every person who owns property within 500 feet of the proposed tower has been: (i) notified by certified mail, return receipt requested, of the proposed construction; (ii) given the commission docket number under which the application will be processed; and (iii) informed of his right to request intervention.

13. Pursuant to KRS 278.665(2), applicant’s legal counsel hereby affirms that every person who, according to the records of the property valuation administrator, owns property contiguous to the property where the proposed cellular antenna tower will be located has been: (i) notified by certified mail, return receipt requested, of the proposed construction; (ii) given the commission docket number under which the application will be processed; and (iii) informed of his right to request intervention.

14. Pursuant to 807 KRS 5:063 §1(1)(m), a list of the property owners who received the notice together with copies of the certified letters sent to listed property owners, is Exhibit “F”.

15. Pursuant to 807 KRS 5:063 § 1 (1)(n), applicant’s legal counsel hereby affirms that the Pulaski County Judge Executive has been: (i) notified by certified mail, return receipt requested, of the proposed construction; (ii) given the commission docket number under which the application will be processed; and (iii) informed of its right to request intervention.

16. Pursuant to 807 KRS 5:063 §1(1)(o), a copy of the notice sent to the Pulaski County Judge Executive is Exhibit “G”.

17. Pursuant to 807 KRS 5:063 § 1 (1)(p), applicant’s legal counsel hereby affirms that (i) two written notices meeting subsection two (2) of this section have been posted, one in a visible location on the proposed site and one on the nearest public road; and (ii) the notices shall remain posted for at least two weeks after the application has been filed.

18. Pursuant to 807 KAR 5:063 § 1 (2)(a), applicant’s legal counsel affirms that:

(a) A written notice, of durable material at least two (2) feet by four (4) feet in size, stating that “*Bluegrass Wireless, LLC proposes to construct a telecommunications tower on this site*”, including the addresses and telephone numbers of the applicant and the Kentucky Public Service Commission, has been posted and shall remain in a visible location on the proposed site until final disposition of the application; and

(b) A written notice, of durable material at least two (2) feet by four (4) feet in size, stating that "*Bluegrass Wireless, LLC proposes to construct a telecommunications tower near this site*", including the addresses and telephone numbers of the applicant and the Kentucky Public Service Commission, has been posted on the public road nearest the site.

A copy of each sign is attached as Exhibit "H"

19. Pursuant to 807 KRS 5:063 § 1 (1)(q), a statement that notice of the location of the proposed construction has been published in a newspaper of general circulation in the county in which the construction is proposed, is Exhibit "I".

20. Pursuant to 807 KRS 5:063 § 1(1)(r), the cell site which has been selected is in a relatively undeveloped area in Burnside, Kentucky.

21. Pursuant to 807 KRS 5:063 §1(1)(s), Bluegrass Wireless has considered the likely effects of the installation on nearby land uses and values and has concluded that there is no more suitable location reasonably available from which adequate service to the area can be provided, and that there is no reasonably available opportunity to co-locate. Bluegrass Wireless has attempted to co-locate on towers designed to host multiple wireless service providers' facilities or existing structures, such as a telecommunications tower, or another suitable structure capable of supporting the utility's facilities.

22. Pursuant to 807 KRS 5:063 § 1(1)(t), a map of the area in which the tower is proposed to be located, that is drawn to scale and that clearly depicts the search area in which a site should, pursuant to radio frequency requirements, be located is Exhibit "J".

23. Pursuant to KRS 100.987(2)(a), a grid map, that is drawn to scale, that shows the location of all existing cellular antenna towers and that indicates the general position of proposed construction sites for new cellular antenna towers is Exhibit "K".

24. No reasonably available telecommunications tower, or other suitable structure capable of supporting the cellular facilities of Bluegrass Wireless and which would provide adequate service to the area exists.

25. Correspondence and communication with regard to this application should be addressed to:

John E. Selent
1400 PNC Plaza
500 West Jefferson Street
Louisville, KY 40202
(502) 540-2300
selent@dinslaw.com

WHEREFORE, Bluegrass Wireless Partnership requests the Commission to enter an order:

1. Granting a certificate of public convenience and necessity to construct the Burnside cell site; and
2. Granting all other relief as appropriate.

Respectfully submitted,



John E. Selent
DINSMORE & SHOHL, LLP
1400 PNC Plaza
500 West Jefferson Street
Louisville, KY 40202
(502) 540-2300
(502) 540-2207
john.selent@dinslaw.com

Burnside

**LUKAS, NACE
GUTIERREZ & SACHS**

CHARTERED

1850 TYBONS BOULEVARD, SUITE 1500

MCLEAN, VIRGINIA 22102

703 584 8678 • 703 584 8688 FAX

WWW.FCCLAW.COM

RUBELL D. LUKAS*
DAVID L. NACE*
THOMAS GUTIERREZ*
ELIZABETH R. SACHS*
GEORGE L. LYON, JR.
PAMELA L. GIST*
DAVID A. LAFURIA
B. LYNN F. RATNAVALE*
TODD BLAMOWITZ*
STEVEN M. CHERNOFF*

CONSULTING ENGINEERS
ALI KUZEHKANANI
LEROY A. ADAM
LEILA REZANAVAZ
SUMEET K. BHALOTIA
OF COUNSEL
JOHN J. MCAVOY*
J.K. HAGE III*
LEONARD S. KOLSKY*
HON. GERALD S. MCGOWAN*
*NOT ADMITTED IN VA

October 4, 2005

Via Federal Express

(703)584-8668

FACSIMILE

(703)584-8692

Mr. John Houlihan
Kentucky Airport Zoning Commission
200 Mero Street
Frankfort, Kentucky 40622

Dear Mr. Houlihan:

Enclosed please find two completed TC 56-50 forms, Application for Permit to Construct or Alter a Structure, for a new tower (Burnside) near Burnside, Kentucky. The Structure, including top-mounted PCS antennas will have an overall height of 255 feet Above Ground Level. This site was originally, filed and evaluated by your office at 199'. Bluegrass has decided to construct the tower at the increased height of 255' AGL.

Enclosed Form TC 56-50 and the attached exhibit include all the pertinent information for this existing tower structure. Also enclosed are copies of the completed FAA Form 7460-1 for the proposed site and a non-reduced 7-1/2' U.S. Geological Survey map indicating the exact location of the site.

Please do not hesitate to contact the undersigned if there are questions regarding this matter.

Sincerely,
Leila Rezanavaz
Leila Rezanavaz
Consulting Engineer

Enclosures

CC: Scott McCloud

INSTRUCTIONS ON REVERSE SIDE OF FORM

Kentucky Transportation Cabinet, Kentucky Airport Zoning Commission, 125 Holmes Street, Frankfort KY 40622

Kentucky Aeronautical Study Number

APPLICATION FOR PERMIT TO CONSTRUCT OR ALTER A STRUCTURE

1. APPLICANT - Name, Address, Telephone, Fax, etc.

Scott McCloud
Bluegrass Wireless
2902 Ring Road
Elizabethtown, KY 42702

T: 270-769-0339 F: 270-737-0580

2. Representative of Applicant - Name, Address, Telephone, Fax

Leila Rezanavaz
Lukas, Nace, Gutierrez & Sachs, Chartered
1650 Tysons Blvd., Suite 1500
McLean, VA 22102

T: 703-584-8668

3. Application for: New Construction Alteration Existing

4. Duration: Permanent Temporary (Months _____ Days _____)

5. Work Schedule: Start 10/20/05 End 10/25/05

6. Type: Antenna Tower Crane Building Power Line
 Landfill Water Tank Other _____

7. Marking/Painting and/or Lighting Preferred:

Red Lights and Paint Dual - Red & Medium Intensity White
 White - Medium Intensity Dual - Red & High Intensity White
 White - High Intensity Other _____

8. FAA Aeronautical Study Number 2005-ASO-4642-0E

9. Latitude: 36 ° 58 ' 40 "

10. Longitude: 84 ° 35 ' 27 "

11. Datum: NAD 83 NAD 27 Other _____

12. Nearest Kentucky City Burnside County Pulaski

13. Nearest Kentucky public use or Military airport:
Somerset-Pulaski County Airport

14. Distance from #13 to Structure: 5.4 Miles

15. Direction from #13 to Structure: South

16. Site Elevation (AMSL): 1011 Feet

17. Total Structure Height (AGL): 255 Feet

18. Overall Height (#16 + #17) (AMSL): 1266 Feet

19. Previous FAA and/or Kentucky Aeronautical Study Number(s):
N/A

20. Description of Location: (Attach a USGS 7.5 minute Quadrangle Map or an Airport Layout Drawing with the precise site marked and any certified survey)

Site is located 1 mile south of Burnside, KY.

21. Description of Proposal:

Structure: Antenna structure including top-mounted PCS antennas has an overall height of 255' AGL.

Frequencies: 1975-1982.5 MHz

Max. ERP: 200 Watts

22. Has a "NOTICE OF CONSTRUCTION OR ALTERATION" (FAA Form 7460-1) been filed with the Federal Aviation Administration? No Yes, When 10/04/2005

CERTIFICATION: I hereby certify that all the above statements made by me are true, complete and correct to the best of my knowledge and belief.

Leila Rezanavaz/Consulting Engineer Leila Rezanavaz 10/04/2005
Printed Name Signature Date

PENALTIES: Persons failing to comply with Kentucky Revised Statutes (KRS 183.861 through 183.990) and Kentucky Administrative Regulations (602 KAR 050: Series) are liable for fines and/or imprisonment as set forth in KRS 183.990(3). Non-compliance with Federal Aviation Administration Regulations may result in further penalties.

Commission Action:

Chairman, KAZC

Administrator, KAZC

Approved

Date _____

Kentucky Transportation Cabinet, Kentucky Airport Zoning Commission, 125 Holmes Street, Frankfort KY 40622
APPLICATION FOR PERMIT TO CONSTRUCT OR ALTER A STRUCTURE

Kentucky Aeronautical Study Number

1. APPLICANT - Name, Address, Telephone, Fax, etc.

Scott McCloud
Bluegrass Wireless
2902 Ring Road
Elizabethtown, KY 42702

T: 270-769-0339 F: 270-737-0580

2. Representative of Applicant - Name, Address, Telephone, Fax

Laila Rezanavaz
Lukas, Nace, Gutierrez & Sachs, Chartered
1650 Tysons Blvd., Suite 1500
McLean, VA 22102

T: 703-584-8668

3. Application for: New Construction Alteration Existing

4. Duration: Permanent Temporary (Months _____ Days _____)

5. Work Schedule: Start 10/20/05 End 10/25/05

6. Type: Antenna Tower Crane Building Power Line
 Landfill Water Tank Other _____

7. Marking/Painting and/or Lighting Preferred:

Red Lights and Paint Dual - Red & Medium Intensity White
 White - Medium Intensity Dual - Red & High Intensity White
 White - High Intensity Other _____

8. FAA Aeronautical Study Number 2005-ASO-4642-OR

9. Latitude: 36 ° 58 ' 40 " 38 "

10. Longitude: 84 ° 35 ' 27 " 46 "

11. Datum: NAD 83 NAD 27 Other _____

12. Nearest Kentucky City Burnside County: Pulaski

13. Nearest Kentucky public use or Military airport:
Somerset-Pulaski County Airport

14. Distance from #13 to Structure: 5.4 Miles

15. Direction from #13 to Structure: South

16. Site Elevation (AMSL): 1011 Feet

17. Total Structure Height (AGL): 255 Feet

18. Overall Height (#16 + #17) (AMSL): 1266 Feet

19. Previous FAA and/or Kentucky Aeronautical Study Number(s):
N/A

20. Description of Location: (Attach a USGS 7.5 minute Quadrangle Map or an Airport Layout Drawing with the precise site marked and any certified survey)

Site is located 1 mile south of Burnside, KY.

21. Description of Proposal:

Structure: Antenna structure including top-mounted PCS antennas has an overall height of 255' AGL.

Frequencies: 1975-1982.5 MHz

Max. ERP: 200 Watts

22. Has a "NOTICE OF CONSTRUCTION OR ALTERATION" (FAA Form 7460-1) been filed with the Federal Aviation Administration?

No
 Yes, When 10/04/2005

CERTIFICATION: I hereby certify that all the above statements made by me are true, complete and correct to the best of my knowledge and belief.

Laila Rezanavaz/Consulting Engineer Laila Rezanavaz 10/04/2005
Printed Name Signature Date

PENALTIES: Persons failing to comply with Kentucky Revised Statutes (KRS 183.861 through 183.990) and Kentucky Administrative Regulations (602 KAR 050: Series) are liable for fines and/or imprisonment as set forth in KRS 183.990(3). Non-compliance with Federal Aviation Administration Regulations may result in further penalties.

Commission Action:

Chairman, KAZC

Administrator, KAZC

Approved

Disapproved

Date

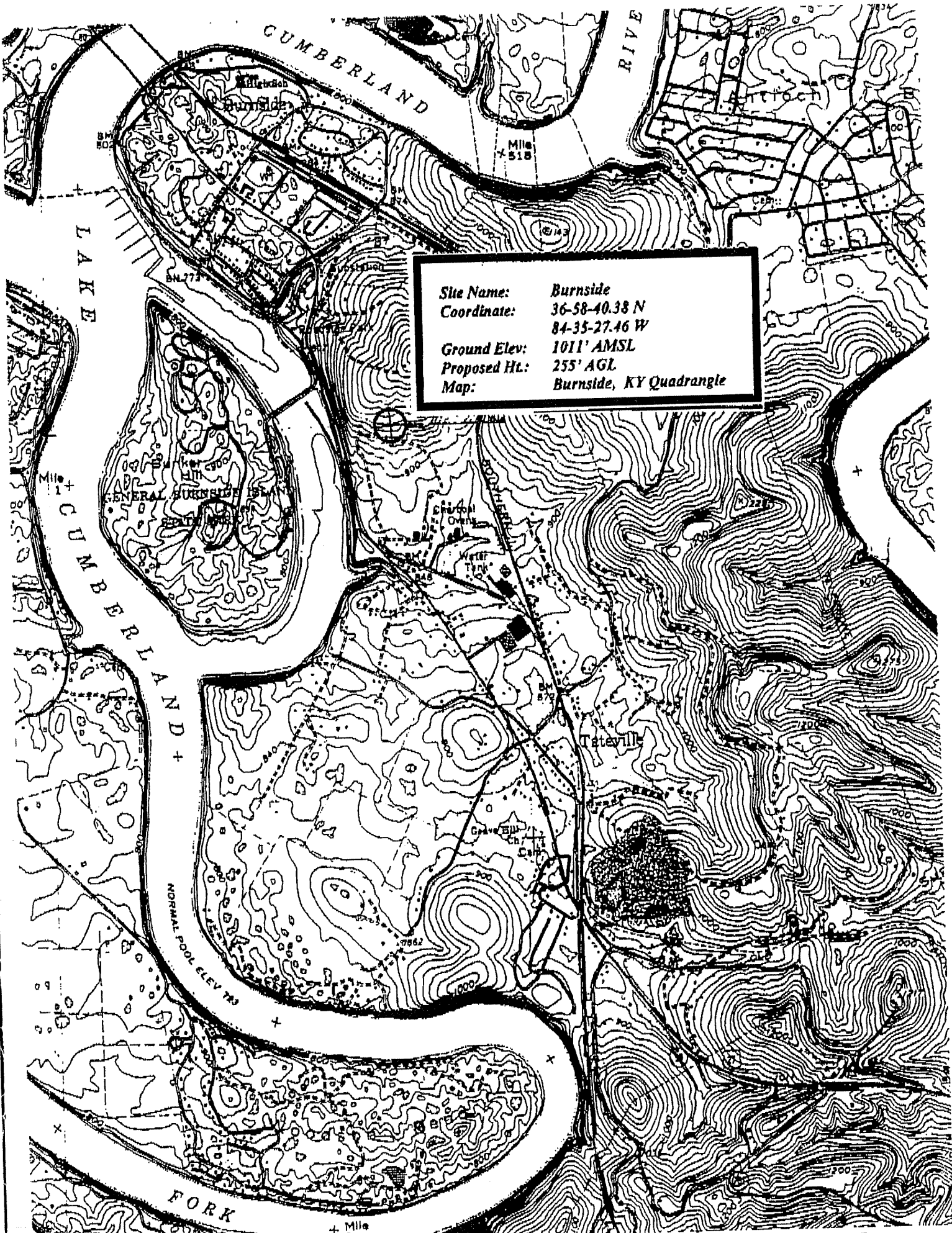

Site Name:	Burnside
Coordinate:	36-58-40.38 N 84-35-27.46 W
Ground Elev:	1011' AMSL
Proposed Ht.:	255' AGL
Map:	Burnside, KY Quadrangle

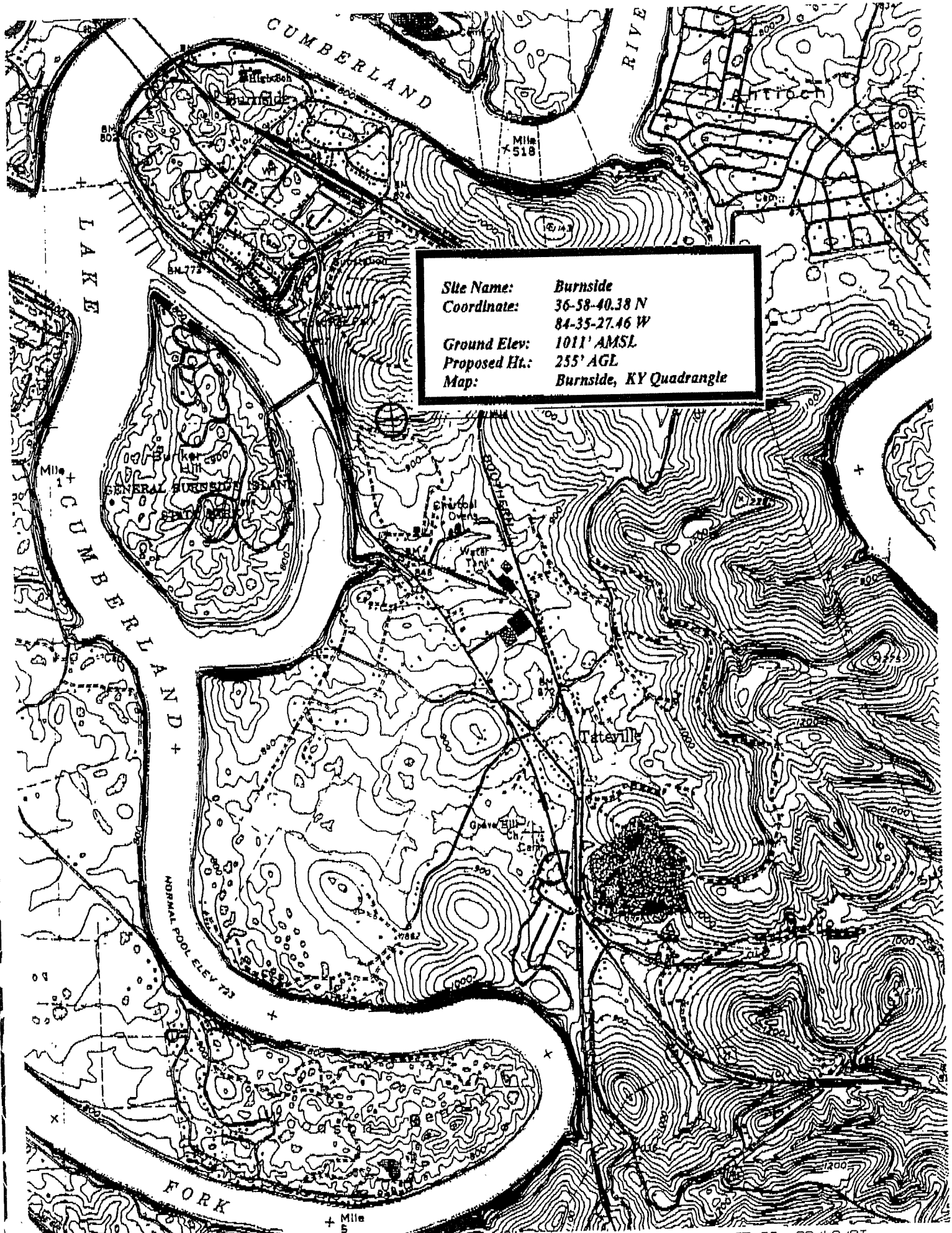

BLUEGRASS CELLULAR
2902 Ring Road
Elizabethtown, KY 42702

LA Letter

Date: August 12, 2005
FBTAN Project No: 03-3437

Site Name:

BURNSIDE

For Aeronautical Study No.

Location City County

Burnside, KY
Pulaski

U.S.G.S. Quadrangle:

Burnside, KY

(NAD 27) LATITUDE
LONGITUDE

36° 58' 40.10"
84° 35' 27.67"

(NAD 83) LATITUDE
LONGITUDE

36° 58' 40.38"
84° 35' 27.46"

SITE ELEVATION (NAVD 83)
PROPOSED TOWER HEIGHT
TOWER HEIGHT WITH ANTENNA
OVERALL HEIGHT ELEVATION

1011' ± AMSL
240' ± FAA AGL
265' ± FAA AGL
1276' ± AMSL

I Certify, to the best of my knowledge and belief, that the horizontal and vertical datum as established from the referenced U.S.G.S. Quadrangle, is accurate to 1A Reporting requirements of ± 20 feet horizontally and ± 3 vertically.

The horizontal datum (coordinates) are in terms of the North American Datum of 1927 (NAD 27) and 1983 (NAD 83) and expressed as degrees, minutes and seconds.

The vertical datum (heights) are in terms of the National Geodetic Vertical Datum of 1988 and are determined to the nearest foot.

Kentucky State Plane Coordinates (South Zone) were established with Trimble Global Positioning Systems (GPS) receivers. This site has ties to the National Geodetic Reference System established by the National Geodetic Survey, formerly the U.S. Coast & Geodetic Survey by measurements to PID Station "022627", designated as "SOMERPORT".

CONSULTANT

Frank L. Sellsinger II, P.L.S. No. 3242
FBTAN Land Surveyors and Consulting Engineers
2313/2315 Chestnut Drive, Louisville, Ky. 40217
Phone: 502-635-5866 Fax: 502-635-3263



**BLUEGRASS CELLULAR
2902 King Road
Elizabethtown, KY 42702**

1A Letter

Date: August 12, 2005
FSTAN Project No: 05-3437

Site Name:

BURNSIDE

For Aeronautical Study No.

Location:

City
County

**Burnside, KY
Palmer**

U.S.G.S. Quadrangle:

Burnside, KY

(NAD 27)

LATITUDE
LONGITUDE

**36° 58' 40.10"
84° 35' 27.67"**

(NAD 83)

LATITUDE
LONGITUDE

**36° 58' 40.38"
84° 35' 27.46"**

**SITE ELEVATION (NAVD 83)
PROPOSED TOWER HEIGHT
TOWER HEIGHT WITH ANTENNA
OVERALL HEIGHT ELEVATION**

**1011' ± AMSL
240' ± FAA AGL
265' ± FAA AGL
1276' ± AMSL**

I Certify, to the best of my knowledge and belief, that the horizontal and vertical datum as established from the referenced U.S.G.S. Quadrangle, is accurate to 1A Reporting requirements of ± 20 feet horizontally and ± 3 vertically.

The horizontal datum (coordinates) are in terms of the North American Datum of 1927 (NAD 27) and 1983 (NAD 83) and expressed as degrees, minutes and seconds.

The vertical datum (heights) are in terms of the National Geodetic Vertical Datum of 1988 and are determined to the nearest foot.

Kentucky State Plane Coordinates (South Zone) were established with Trimble Global Positioning Systems (GPS) receivers. This site has ties to the National Geodetic Reference System established by the National Geodetic Survey, formerly the U.S. Coast & Geodetic Survey by measurements to FID Station "GZ2627", designated as "SCORERPORT".

CONSULTANT



Frank L. Sellinger II, P.L.S. No. 3282
FSTAN Land Surveyors and Consulting Engineers
2315/2315 Crittenden Drive, Louisville, Ky. 40217
Phone: 502-635-5866 Fax: 502-636-5263



**LUKAS, NACE
GUTIERREZ & SACHS**

CHARTERED

1850 TYSONS BOULEVARD, SUITE 1500
MCLEAN, VIRGINIA 22102
703 864 8678 • 703 864 8696 FAX

WWW.FCCLAW.COM

RUSSELL D. LUKAS*
DAVID L. NACE*
THOMAS GUTIERREZ*
ELIZABETH R. SACHS*
GEORGE L. LYON, JR.
PAMELA L. GIST*
DAVID A. LAFUNIA
B. LYNN F. RATNAVALE*
TODD SLAMOWITZ*
STEVEN M. CHERNOFF*

CONSULTING ENGINEERS
ALI KUZEHKANANI
LEROY A. ADAM
LEILA REZANAVAZ
SUMEET K. BHALOTIA
OF COUNSEL
JOHN J. MCAVOY*
J.K. HAGE III*
LEONARD S. KOLSKY*
HON. GERALD S. MCGOWAN*
*NOT ADMITTED IN VA

Burnside

October 4, 2005

(703) 584-8668

TELECOPIER
(703) 584-8692

Via Federal Express
EXPRESS PROCESSING CENTER
Federal Aviation Administration
Southwest Regional Office
Air Traffic Airspace Branch, ASW-520
2601 Meacham Blvd.
Fort Worth, TX 76137-4298

RE: Aeronautical Study No.: 2005-ASO-4642-OE

Dear FAA Evaluator:

Enclosed please find a completed FAA Form 7460-1, Notice of Proposed Construction/Alteration, for a new tower structure (Burnside) near Burnside, Kentucky. The height of the structure, including top-mounted PCS antennas, will be 255 feet Above Ground Level ("AGL").

This site has an FAA determination for 199' AGL. On behalf of Bluegrass Wireless, this application is proposing to increase the structure height from 199' to 255'. Enclosed FAA Form 7460-1 and the attached Exhibit include all the pertinent information for the new structure at this site. Geographic coordinates are based on 1A Certification. Also enclosed is a non-reduced copy of a portion of the 7-1/2' US Geological Survey map illustrating the location of the proposed cell site. Additionally, the copy of the 1A Certification is enclosed. Please do not hesitate to contact the undersigned if there are questions regarding this matter.

Sincerely,
Leila Rezanavaz
Leila Rezanavaz
Consulting Engineer

Enclosures

cc: Scott McCloud

U.S. Department of Transportation
Federal Aviation Administration

Failure To Provide All Requested Information May Delay Processing of Your Notice

FOR FAA USE ONLY
Aeronautical Study Number
06 - ASO - 4642 -

Notice of Proposed Construction or Alteration

1. Sponsor (person, company, etc. proposing this action):
 Attn. of: **Scott McCloud**
 Name: **Bluegrass Wireless**
 Address: **2902 Ring Road**
 City: **Elizabethtown** State: **KY** Zip: **42702**
 Telephone: **(270) 789-0339** Fax: **(270) 737-0580**

2. Sponsor's Representative (if other than #1):
 Attn. of: **Lella Rezanavaz**
 Name: **Lukas, Nace, Gutierrez & Sachs, Chartered**
 Address: **1650 Tysons BLVD**
 Suite **1500**
 City: **McLean** State: **VA** Zip: **22102**
 Telephone: **(703) 854-8668** Fax: **(703) 854-8692**

3. Notice of: New Construction Alteration Existing

4. Duration: Permanent Temporary (months, days)

5. Work Schedule: Beginning **10/20/2005** End **10/25/2005**

6. Type: Antenna Tower Crane Building Power Line
 Landfill Water Tank Other

7. Marking/Painting and/or Lighting Preferred:
 Red Lights and Paint Dual - Red and Medium Intensity White
 White - Medium Intensity Dual - Red and High Intensity White
 White - High Intensity Other

8. FCC Antenna Structure Registration Number (if applicable):
 N/A

9. Latitude: 36° 58' 40. 38''

10. Longitude: 84° 36' 27. 48''

11. Datum: NAD 83 NAD 27 Other

12. Nearest City: **Burnside** State: **KY**

13. Nearest Public-use (not private-use) or Military Airport or Heliport:
Somerset-Pulaski County Airport

14. Distance from #13. to Structure: **5.4 miles**

15. Direction from #13. to Structure: **South**

16. Site Elevation (AMSL): **1011** ft.

17. Total Structure Height (AGL): **255** ft.

18. Overall height (#16. + #17.) (AMSL): **1266** ft.

19. Previous FAA Aeronautical Study Number (if applicable):
2005-ASO-4642 - OE

20. Description of Location: (Attach a USGS 7.5 minute
 Quadrangle Map with the precise site marked and any certified survey)
 Site is located 1.0 mile south of Burnside, KY

21. Complete Description of Proposal:

Bluegrass Wireless is proposing to construct this structure with an overall height of 255' AGL. This site was originally filed and has been determined for 199' AGL.

	Frequency/Power (kW)	
	1975-1983 MHz	0.2

Notice is required by 14 Code of Federal Regulations, part 77 pursuant to 49 U.S.C., Section 44718. Persons who knowingly and willingly violate the notice requirements of part 77 are subject to a civil penalty of \$1,000 per day until the notice is received, pursuant to 49 U.S.C., section 46301 (a).

I hereby certify that all of the above statements made by me are true, complete, and correct to the best of my knowledge. In addition, I agree to mark and/or light the structure in accordance with established marking and lighting standards as necessary.

Date 10/04/2005	Typed or Printed name and Title of Person Filing Notice Lella Rezanavaz / Consulting Engineer	Signature <i>Lella Rezanavaz</i>
--------------------	---	-------------------------------------

BLUEGRASS CELLULAR
2903 Ring Road
Elizabethtown, KY 42702

LA Letter

Date: August 12, 2005
FSTAN Project No: 03-3437

Site Name:

BURNSIDE

For Aeronautical Study No.

Location: City
County

Burnside, KY
Pulaski

U.S.G.S. Quadrangle:

Burnside, KY

(NAD 27) LATITUDE
LONGITUDE

36° 58' 40.10"
84° 35' 27.67"

(NAD 83) LATITUDE
LONGITUDE

36° 58' 40.38"
84° 35' 27.46"

SITE ELEVATION (NAVD 83)
PROPOSED TOWER HEIGHT
TOWER HEIGHT WITH ANTENNA
OVERALL HEIGHT ELEVATION

1011' ± AMSL
240' ± FAA AGL
265' ± FAA AGL
1276' ± AMSL

I Certify, to the best of my knowledge and belief, that the horizontal and vertical datum as established from the referenced U.S.G.S. Quadrangle, is accurate to 1A Reporting requirements of ± 20 feet horizontally and ± 3 vertically.

The horizontal datum (coordinates) are in terms of the North American Datum of 1927 (NAD 27) and 1983 (NAD 83) and expressed as degrees, minutes and seconds.

The vertical datum (heights) are in terms of the National Geodetic Vertical Datum of 1988 and are determined to the nearest foot.

Kentucky State Plane Coordinates (South Zone) were established with Trimble Global Positioning Systems (GPS) receivers. This site has ties to the National Geodetic Reference System established by the National Geodetic Survey, formerly the U.S. Coast & Geodetic Survey by measurements to PID Station "G22627", designated as "SCENERPORT".

CONSULTANT

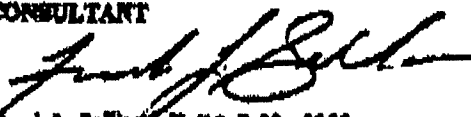

Frank L. Sellinger II, P.L.S. No. 3282
FSTAN Land Surveyors and Consulting Engineers
2313/2315 Critchenden Drive, Louisville, Ky. 40217
Phone: 502-635-5866 Fax: 502-636-5263





United States Department of the Interior

FISH AND WILDLIFE SERVICE

3761 Georgetown Road
Frankfort, Kentucky 40601

September 27, 2005

Mr. Jason Thomson
Terracon
4545 Bishop Lane, Suite 101
Louisville, Kentucky 40218

Subject: FWS #06-0091; Burnside 2, Bluegrass Cellular Proposed 240-foot Self Support Communications Tower, Pulaski County, Kentucky

Dear Mr. Thompson:

Thank you for your correspondence of August 31, 2005, regarding the proposed 240-foot self support communications tower in Pulaski County, Kentucky. The tower site is situated on a wooded hillside near Burnside. Fish and Wildlife Service (Service) personnel have reviewed the information submitted, and we offer the following comments.

According to our records, summer roost habitat for the endangered Indiana bat (*Myotis sodalis*) may exist within the proposed project site. Based on this information, we believe that: (1) forested areas in the vicinity of and on the project area may provide potentially suitable summer roosting and foraging habitat for the Indiana bat and (2) caves, rockshelters, and abandoned underground mines in the vicinity of and on the project area may provide potentially suitable winter hibernacula habitat for the Indiana bat. Our belief that potentially suitable habitat may be present, and possibly occupied by this species, is based on information provided in your correspondence, that fact that the project site and surrounding area may contain forested habitats that are within the natural ranges of these species, and our knowledge of the life history characteristics of this species.

The Indiana bat uses a wide array of forested habitats, including riparian forests, bottomlands, and uplands for both summer foraging and roosting habitat. Indiana bats typically roost under exfoliating bark, in cavities of dead and live trees, and in snags (i.e., dead trees or dead portions of live trees). Trees in excess of 16 inches diameter at breast height (DBH) are considered optimal for maternity colony roosts, but trees in excess of 9 inches DBH appear to provide suitable maternity roosting habitat. Male Indiana bats have been observed roosting in trees as small as 3 inches DBH.

Prior to hibernation, Indiana bats utilize the forest habitat around the hibernacula, where they feed and roost until temperatures drop to a point that forces them into hibernation. This "swarming" period lasts, depending on weather conditions in a particular year, from about September 15 to about November 15. This is a critical time for Indiana bats, since they are acquiring additional fat reserves and mating prior to hibernation. Research has shown that bats

TAKE PRIDE
IN AMERICA 

exhibiting this "swarming" behavior will range up to five miles from chosen hibernacula during this time. For hibernation, the Indiana bat prefers limestone caves, sandstone rockshelters, and abandoned underground mines with stable temperatures of 39 to 46 degrees F and humidity above 74 percent but below saturation.

Because we have concerns relating to the Indiana bat on this project and due to the lack of occurrence information available on these species relative to the proposed project area, we have the following recommendations relative to Indiana bats.

1. Based on the presence of numerous caves, rockshelters, and underground mines in Kentucky, we believe that it is reasonable to assume that other caves, rockshelters, and/or abandoned underground mines may occur within the project area, and, if they occur, they could provide winter habitat for Indiana bats. Therefore, we recommend that you survey the project area for caves, rockshelters, and underground mines, identify any such habitats that may exist on-site, and avoid impacts to those sites pending an analysis of their suitability as Indiana bat habitat by this office.
2. Since a known Indiana bat hibernaculum exists less than 10 miles from the project areas, we recommend you only remove trees between November 15 and March 31 in order to avoid impacting Indiana bat "swarming" behavior.

We request your written acceptance of these recommendations for this project. However, if these recommendations cannot be accomplished, then you should survey the project area to determine the presence or absence of the species within the project area in an effort to determine if potential impacts to these species are likely. A qualified biologist who holds the appropriate collection permits for these species must undertake such surveys, and we would appreciate the opportunity to approve the biologist's survey plan prior to the survey being undertaken and to review all survey results, both positive and negative. If any Indiana bats are identified, we request written notification of such occurrence(s) and further coordination and consultation with you.

Surveys would not be necessary if sufficient site-specific information was available that showed: (1) that there is no potentially suitable habitat within the project area or its vicinity or (2) that the species would not be present within the project area or its vicinity due to site-specific factors. Please provide us with written notification if either or both of these are applicable to the proposed project area.

If you have any questions regarding the information that we provided, please contact Mindi Brady at (502) 695-0468.

Sincerely,

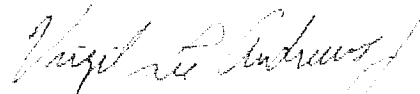

Virgil Lee Andrews, Jr.
Field Supervisor

DRILLED PIER FOUNDATION DESIGN

Vertical Bars	(12) #8 bars, 14' long
Ties	#5 bars @ 6" c/c for the first 6.5' then 16" c/c thereafter

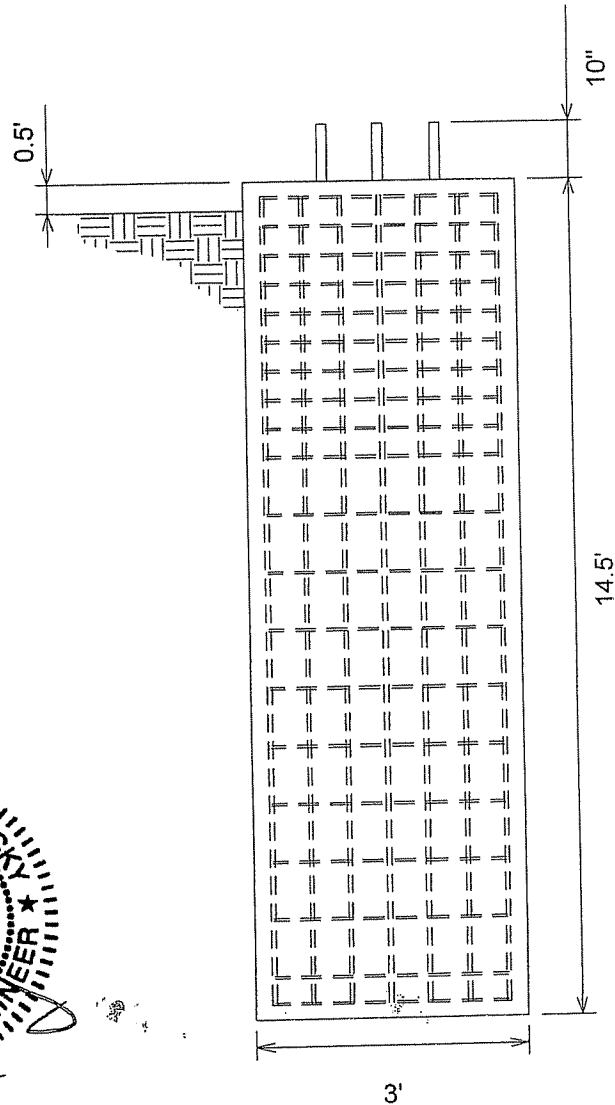

General Notes

1. Concrete shall be placed in accordance with ACI318-02, latest revision.
2. Concrete shall have a minimum 28 day compressive strength of 3000 PSI.
3. Rebar to conform to ASTM A615 grade 60.
4. Rebar used for ties may be A615 grade 40.
5. All rebar to have a minimum of 3" clear cover.
6. All exposed concrete corners to have 3/4" chamfer.
7. Bottom and side surfaces to rest on undisturbed soil.
8. Contractor shall be responsible to review and follow all recommendations of the geotechnical report.

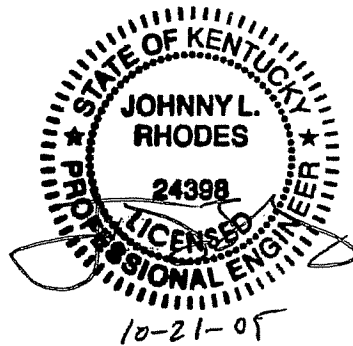

Supplemental Notes

Soil values obtained from Terracon soils report #57057351G Dated 10/21/05

EASTPOINTE ENGINEERING GROUP, LLC 4020 Tull Ave. Muskogee, OK 74403--Phone 918.683.2169--Fax:918.682.7618	Client: Bluegrass Cellular	
	Site: Burnside	
	Job: 2077	Drawn by: JLR
	Scale: NTS	Date: 10/21/05

T1	SR 1 3/4	L1 3/4x1 3/4x3/16	4	0.9
T2	SR 2 1/4	L1 3/4x1 3/4x3/16	1.2	1.2
T3	SR 2 1/2	L1 3/4x1 3/4x3/16	1.4	1.4
T4	SR 2 3/4	L2 2x3/16	5.5	1.7
T5	SR 3	L2 2x3/16	7	1.8
T6	SR 3 1/4	L2 2x3/16	8.5	2.2
T7	SR 3 1/2	L2 1/2x2 1/2x3/16	10	2.6
T8	SR 3 3/4	L3 3x3/16	11.5	2.7
T9	SR 3 3/4	L3 3x3/16	13	2.8
T10	SR 3 3/4	L3 3x3/16	14.5	3.4
T11	SR 3 3/4	L3 3x3/16	16	3.6
T12	SR 3 3/4	L3 3x3/16	17.5	4.5
Legs				28.7
Leg Grade				
Diagonals				
Diagonal Grade				
Top Girts				
Face Width (ft)	19			
# Panels @ (ft)				
Weight (K)				

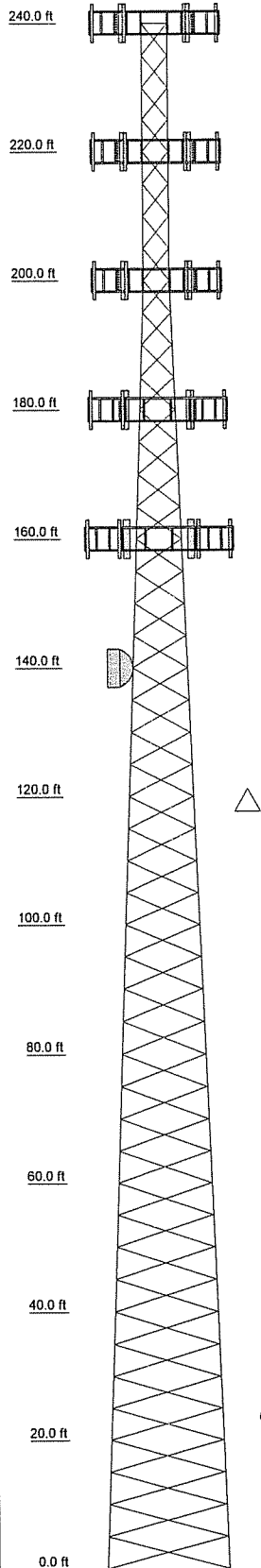

APPURTENANCES

TYPE	ELEVATION	TYPE	ELEVATION
(6) D100-0042-0041	240	(6) RWB 80014/120 (Future)	180
Lightning Rod 1"x10' (Initial)	240	(3) T frame sector Mount (Future Carrier 3)	180
Flash Beacon Lighting (Initial)	240	(6) RWB 80014/120 (Future)	160
(3) T frame sector Mount (Initial)	240	(3) T frame sector Mount (Future Carrier 4)	160
(6) RWB 80014/120 (Future)	220	HP6-122	140
(3) T frame sector Mount (Future Carrier 1)	220		
(6) RWB 80014/120 (Future)	200		
(3) T frame sector Mount (Future Carrier 2)	200		

MATERIAL STRENGTH

GRADE	Fy	Fu	GRADE	Fy	Fu
A572-50	50 ksi	65 ksi	A36	36 ksi	58 ksi

TOWER DESIGN NOTES

1. Tower is located in Pulaski County, Kentucky.
2. Tower designed for a 70 mph basic wind in accordance with the TIA/EIA-222-F Standard.
3. Tower is also designed for a 61 mph basic wind with 0.50 in ice.
4. Deflections are based upon a 50 mph wind.
5. Final Design 9/30/05 JLR
6. Please see feedline distribution plan for proper feedline placement. Any deviation from plan may invalidate tower design.
7. In no case shall more than (6) 1 5/8" lines be exposed to wind on any face.
8. Feedlines may be stacked up to two rows on the inside and outside face of the tower.

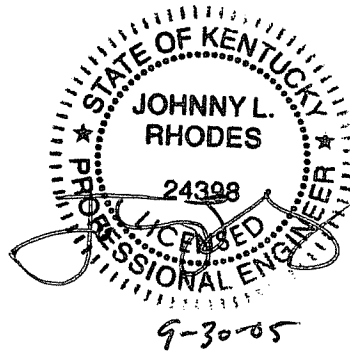

MAX PIER FORCES:
DOWN: 280 K
UPLIFT: -244 K
SHEAR: 19 K

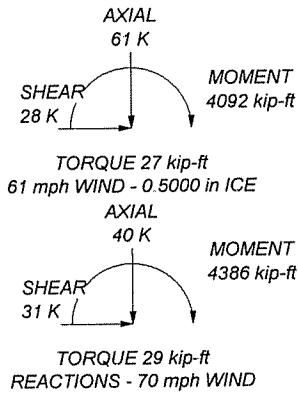

Eastpointe Engineering Group, LLC
4020 Tull Ave.
Muskogee, OK
Phone: 918.683.2169
FAX: 918.682.7618

Job: ELL Job # 2077--Burnside			
Project: 240' SST/Pulaski County, KY			
Client: Bluegrass Cellular	Drawn by: JLR	App'd:	
Code: TIA/EIA-222-F	Date: 09/30/05	Scale: NTS	
Path: Z:\Drafting\Drawings\Jobs\2000-2099\2077\Final Tower Design\240s1.dwg	Dwg No E-1		

Feedline Plan

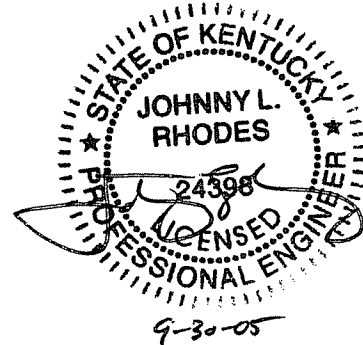
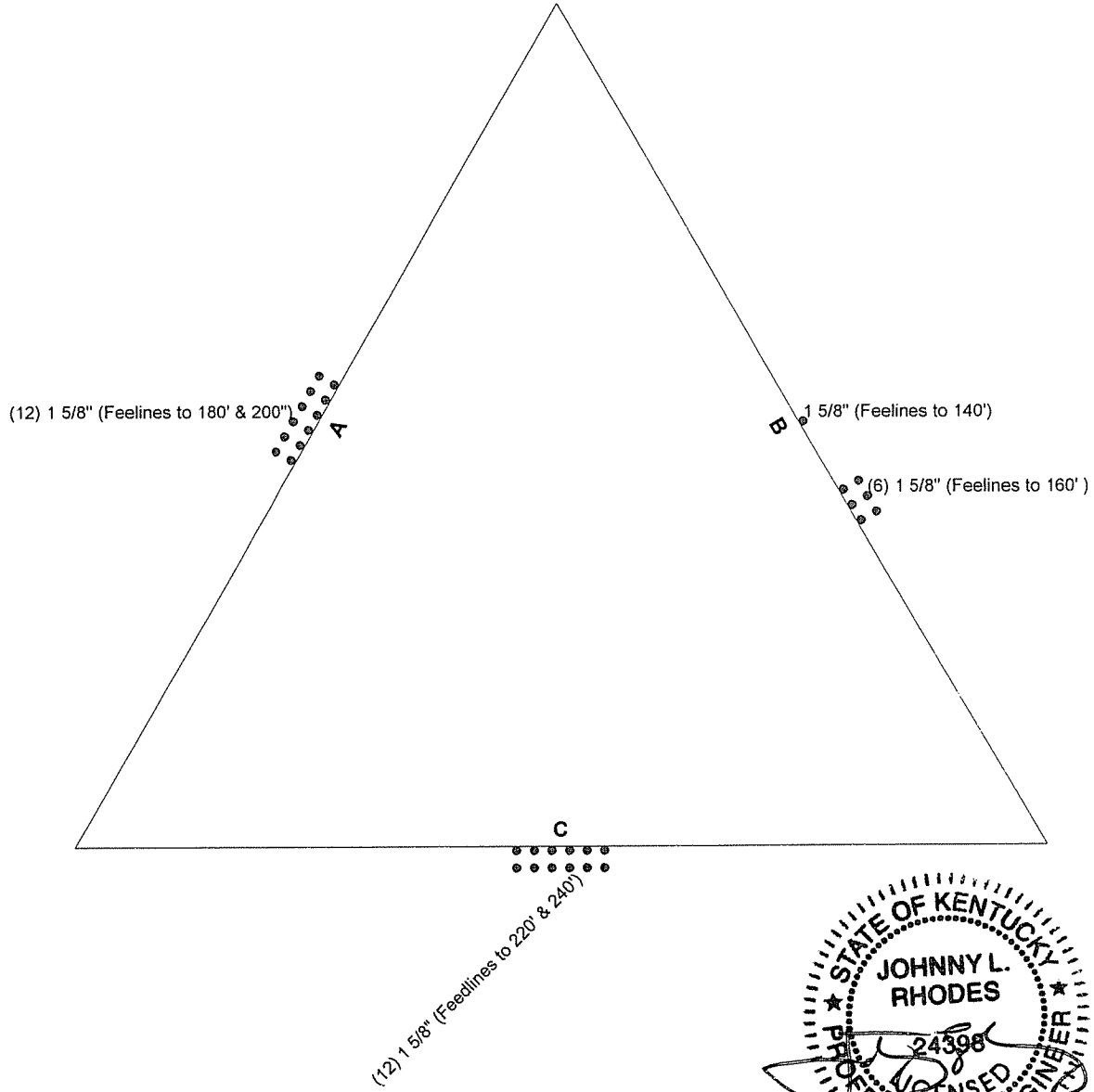

Eastpointe Engineering Group, LLC 4020 Tull Ave. Muskogee, OK Phone: 918.683.2169 FAX: 918.682.7618	Job: EII Job # 2077--Burnside		
	Project: 240' SST/Pulaski County, KY		
	Client: Bluegrass Cellular	Drawn by: JLR	App'd:
	Code: TIA/EIA-222-F	Date: 09/30/05	Scale: NTS
	Path:	Dwg No E-7	

Z:\Drafting\Drawings\Jobs\2005-2099\2077\Final Tower Design\240sst.dwg

GEOTECHNICAL ENGINEERING REPORT
PROPOSED BURNSIDE II COMMUNICATION TOWER
LAKE CUMBERLAND MOTOR SPEEDWAY
BURNSIDE, KENTUCKY

TERRACON PROJECT NO. 57057351G
October 21, 2005

Prepared For:

RSB DESIGN
Louisville, Kentucky

Prepared by:

Terracon
Louisville, Kentucky

Terracon

October 21, 2005

Terracon
Consulting Engineers & Scientists

RSB Design
6403 Mercury Drive
Louisville, Kentucky 40291

Terracon Consultants, Inc.
4545 Bishop Lane, Suite 101
Louisville, Kentucky 40218
Phone 502.456.1256
Fax 502.456.1278
www.terracon.com

Attention: Mr. Robin Becker

**Re: Geotechnical Engineering Report
Proposed Burnside II Communication Tower
Lake Cumberland Motor Speedway
Burnside, Kentucky
Terracon Project No. 57057351G**

Dear Mr. Becker:

We are submitting, herewith, the results of our subsurface exploration for the referenced project. The purpose of this exploration was to obtain information on subsurface conditions at the proposed project site and, based on this information, to provide recommendations regarding the design and construction of the foundations for the proposed tower.

We appreciate the opportunity to be of service to you on this project. If you have any questions concerning this report, or if we may be of further service to you in any way, please feel free to contact us.

Sincerely,
Terracon

Erich J. Hoehler
Project Engineer

n:\projects\2005\towers\570577351BurnsideII\geo570577351G.doc

Attachments: Geotechnical Engineering Report

Copies: (4) RSB Design



Timothy G. LaGrow
Kentucky No. 

TABLE OF CONTENTS

Cover Letter	i
1.0 INTRODUCTION	1
2.0 PROJECT DESCRIPTION	1
3.0 EXPLORATION PROCEDURES.....	1
3.1 Field Exploration.....	1
3.2 Laboratory Testing.....	3
4.0 EXPLORATORY FINDINGS	3
4.1 Subsurface Conditions	3
4.2 Site Geology	3
4.3 Groundwater Conditions.....	4
5.0 ENGINEERING RECOMMENDATIONS	4
5.1 Geotechnical Considerations.....	4
5.2 Tower Foundation.....	5
5.3 Equipment Building Foundations.....	6
5.4 Parking and Drive Areas.....	6
5.5 Site Preparation.....	7
6.0 GENERAL COMMENTS	7
APPENDIX	
Boring Location Plan	
Boring Log	
General Notes	
General Notes – Description of Rock Properties	
Unified Soil Classification System	

GEOTECHNICAL ENGINEERING REPORT
PROPOSED BURNSIDE II COMMUNICATION TOWER
LAKE CUMBERLAND MOTOR SPEEDWAY
BURNSIDE, KENTUCKY
TERRACON PROJECT NO. 57057351G
October 21, 2005

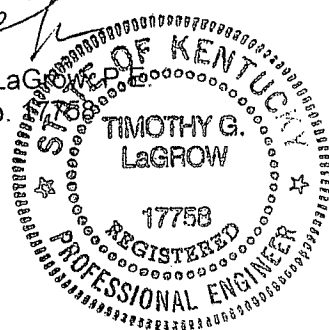
1.0 INTRODUCTION

The purpose of this report is to describe the subsurface conditions encountered in the boring, analyze and evaluate the test data, and provide recommendations regarding the design and construction of the foundations and earthwork for the proposed tower. One boring extending to a depth of about 19 feet below the existing ground surface was drilled at the site. An individual boring log and a boring location plan are included with this report.

2.0 PROJECT DESCRIPTION

Terracon understands the proposed project will consist of the construction of a 240-foot self supporting tower. Exact tower loads are not available, but based on our past experience are anticipated to be as follows:

Vertical Load:	600 kips
Horizontal Shear:	80 kips
Uplift:	500 kips

A small, lightly loaded equipment building will also be constructed. Wall and floor loads for this building are not anticipated to exceed 1 kip per linear foot and 100 pounds per square foot, respectively. At the time of our exploration the site consisted of a wooded, boulder covered, gently sloping hillside. The tower is located near an existing residence behind the Lake Cumberland Motor Speedway. Based on the proposed tower construction and the gently sloping site, cuts and/or fills of 2 to 3 feet may be required to reach the planned site grades.

3.0 EXPLORATION PROCEDURES

3.1 Field Exploration

The subsurface exploration consisted of drilling and sampling one boring at the site to a depth of about 19 feet below existing grade. As requested, due to the trees and boulders in the vicinity of the tower, the boring was advanced approximately 250 feet south of the staked tower location. Ground surface elevations were not available at the time of this report and have been omitted from the boring log.

The boring was drilled with an ATV-mounted rotary drill rig using hollow stem augers to advance the borehole. Representative soil samples were obtained by the split-barrel

sampling procedure in general accordance with the appropriate ASTM standard. In the split-barrel sampling procedure, the number of blows required to advance a standard 2-inch O.D. split-barrel sampler the last 12 inches of the typical total 18-inch penetration by means of a 140-pound hammer with a free fall of 30 inches, is the standard penetration resistance (SPT) value (N-Value). This value is used to estimate the in-situ relative density of cohesionless soils and the consistency of cohesive soils. The sampling depths, penetration distance, and standard penetration resistance values are shown on the boring log. The samples were sealed and delivered to the laboratory for testing and classification.

Auger refusal was encountered at a depth of about 9 feet below the existing ground surface. The boring was extended into the refusal materials using a diamond bit attached to the outer barrel of a double core barrel. The inner barrel collected the cored material as the outer barrel was rotated at high speeds to cut the rock. The barrel was retrieved to the surface upon completion of each drill run. Once the core samples were retrieved, they were placed in a box and logged. The rock was later classified by an engineer and the "percent recovery" and rock quality designation (RQD) were determined. Classification and descriptions of rock core samples are in accordance with the enclosed General Notes, and are based on visual and tactile observations. Petrographic analysis of thin sections may indicate other rock types. Percent recovery and rock quality designation (RQD) values are noted at their depths of occurrence on the boring log.

The "percent recovery" is the ratio of the sample length retrieved to the drilled length, expressed as a percent. An indication of the actual in-situ rock quality is provided by calculating the sample's RQD. The RQD is the percentage of the length of broken cores retrieved which have core segments at least 4 inches in length compared to each drilled length. The RQD is related to rock soundness and quality as illustrated below:

Table 1 – Rock Quality Designation (RQD)

Relation of RQD and In-situ Rock Quality	
RQD (%)	Rock Quality
90 - 100	Excellent
75 - 90	Good
50 - 75	Fair
25 - 50	Poor
0 -25	Very Poor

A field log of the boring was prepared by a subcontract driller. This log included visual classifications of the materials encountered during drilling as well as the driller's interpretation of the subsurface conditions between samples. The final boring log included

with this report represents an interpretation of the driller's field log and a visual classification of the soil samples made by the Geotechnical Engineer.

3.2 Laboratory Testing

The samples were classified in the laboratory based on visual observation, texture and plasticity. The descriptions of the soils indicated on the boring log are in accordance with the enclosed General Notes and the Unified Soil Classification System. Estimated group symbols according to the Unified Soil Classification System are given on the boring log. A brief description of this classification system is attached to this report.

The laboratory testing program consisted of performing water content tests on representative soil samples. Information from these tests was used in conjunction with field penetration test data to evaluate soil strength in-situ, volume change potential, and soil classification. Results of these tests are provided on the boring log.

4.0 EXPLORATORY FINDINGS

4.1 Subsurface Conditions

Conditions encountered at the boring location are indicated on the boring log. Stratification boundaries on the boring log represent the approximate location of changes in soil types and the transition between materials may be gradual. Water levels shown on the boring log represent the conditions only at the time of our exploration. Based on the results of the boring, subsurface conditions on the project site can be generalized as follows.

Underlying minimal gravel surface cover, fat clay (CH) was encountered to an auger refusal depth of about 9 feet below existing grade. The fat clay exhibited a stiff to very stiff consistency based on SPT N-Values of 11 to 16 blows per foot.

Below a depth of about 9 feet, rock coring techniques were used to advance the borehole. The cores samples recovered consisted of close to moderately closely jointed, moderately weathered to fresh, hard limestone. The bedrock at the boring location appears to be relatively continuous based on a core recovery of 90 percent. The quality of the rock is rated at fair based on an RQD value of 74 percent. Considering the height of the tower and the quality of the bedrock, coring operations were terminated at a depth of 19 feet below grade.

4.2 Site Geology

A review of the Geologic Map of the Burnside Quadrangle published by the United States Geological Survey (USGS), indicates that the site is located near the contact of the Kidder and the Saint Genevieve limestone of the Mississippian age.

The Kidder formation consists of limestone, minor siltstone and shale. The limestone is medium to light gray, bluish gray and yellowish gray, thin to thick bedded, massive, partly crossbedded and contains some interbedded siltstone and thin shale. The Saint Genevieve formation consists of limestone and chert. The limestone is medium to light gray and bluish gray, sandy and silty, thin to thick bedded, commonly crossbedded and contains a few 2 to 4 inch thick clay shale beds.

4.3 Groundwater Conditions

No groundwater was encountered during the auger drilling portion of the borehole. Water was used to advance the borehole during rock coring operations. The introduction of water into the borehole precluded obtaining accurate groundwater level readings at the time of drilling operations. Long term observation of the groundwater level in monitoring wells, sealed from the influence of surface water, would be required to obtain accurate groundwater levels on the site.

It should be recognized that fluctuations of the groundwater table may occur due to seasonal variations in the amount of rainfall, runoff and other factors not evident at the time the boring was performed. Therefore, groundwater levels during construction or at other times in the life of the structure may be higher or lower than the levels indicated on the boring log. The possibility of groundwater level fluctuations should be considered when developing the design and construction plans for the project.

5.0 ENGINEERING RECOMMENDATIONS

5.1 Geotechnical Considerations

As previously mentioned, due to the existing site conditions our boring was not drilled at the staked center of the tower. Based on our visual observations of the site, auger refusal depths will likely be shallower at the actual tower location. An additional boring should be performed at the tower center after the site has been cleared to obtain subsurface information at that location and to provide any additional recommendations required.

Based on the encountered subsurface conditions, the tower can be constructed on drilled piers. Mat foundation recommendations may be provided after an additional boring is advanced at the center of the tower. The lightly loaded equipment building can be supported on shallow spread footings. Shallow foundation and drilled pier recommendations are presented in the following paragraphs.

5.2 Tower Foundation

Based on the results of the boring, the following drilled pier foundation design parameters have been developed:

Table 2 - Drilled Pier Foundation Design Parameters

Depth * (feet)	Description **	Allowable Skin Friction (psf)	Allowable End Bearing Pressure (psf)	Allowable Passive Pressure (psf)	Internal Angle of Friction (Degree)	Cohesion (psf)	Lateral Subgrade Modulus (pci)	Strain, &sub50 (in/in)
0 - 3	Topsoil and Fat Clay	Ignore	Ignore	Ignore	-	-	Ignore	Ignore
3 - 9	Fat Clay	425	Ignore	1,500	0	1,500	120	0.007
9 - 19	Limestone	5,000***	50,000	10,000***	0	100,000***	3,000	0.00001

* Pier inspection is recommended to adjust pier length if variable soil/rock conditions are encountered.

** A total unit weight of 115 and 150 pcf can be estimated for the fat clay and limestone, respectively.

*** The parameters have been reduced to take into account the shallow overburden. The pier should be embedded a minimum of 3 feet into competent limestone to mobilize these higher rock strength parameters. Furthermore, it is assumed the rock socket will be extended using coring techniques rather than blasting/shooting.

The above indicated cohesion, friction angle, lateral subgrade modulus and strain values have no factors of safety, and the allowable skin friction and the passive resistances have factors of safety of 2. The cohesion, internal friction angle, lateral subgrade modulus and strain values given in the above table are based on the boring, published correlation values and Terracon's past experience with similar soil/rock types. These values should, therefore, be considered approximate. The allowable end bearing pressure provided in the table has an approximate factor of safety of at least 3. Total settlement of drilled piers designed using the above parameters is not anticipated to exceed ½ inch.

The upper 3 feet of topsoil and fat clay should be ignored due to the potential affects of frost action and construction disturbance. To avoid a reduction in uplift and lateral resistance caused by variable bedrock depths and bedrock quality, it is recommended that a minimum pier length and minimum rock socket length be stated on the design drawings. Bedrock was encountered in our boring below a depth of about 9 feet, however the depth to rock could be significantly different at the exact tower location. To facilitate pier length adjustments that may be necessary because of variable rock conditions, it is recommended that a Terracon representative observe the drilled pier excavations.

A drilled pier foundation should be designed with a minimum shaft diameter of 30 inches to facilitate clean out and possible dewatering of the pier excavation. Temporary casing may be required during the pier excavation in order to control possible groundwater seepage and support the sides of the excavation in weak soil zones. Care should be taken so that the sides and bottom of the excavations are not disturbed during construction. The bottom of the shaft should be free of loose soil or debris prior to reinforcing steel and concrete placement.

A concrete slump of at least 6 inches is recommended to facilitate temporary casing removal. It should be possible to remove the casing from a pier excavation during concrete placement provided that the concrete inside the casing is maintained at a sufficient level to resist any earth and hydrostatic pressures outside the casing during the entire casing removal procedure.

5.3 Equipment Building Foundations

The proposed equipment shed may be supported on shallow footings bearing on stiff natural soils. The equipment building foundations should be dimensioned using a net allowable soil bearing pressure of 2,000 pounds per square foot (psf). In using net allowable soil pressures for footing dimensioning, the weight of the footings and backfill over the footings need not be considered. Furthermore, the footings should be at least 12 inches wide and a minimum of 2.0 feet square.

The geotechnical engineer or a qualified representative should observe the foundation excavations to verify that the bearing materials are suitable for support of the proposed loads. If, at the time of such observation, any soft soils are encountered at the design foundation elevation, the excavations should be extended downward so that the footings rest on stiff soils. If it is inconvenient to lower the footings, the proposed footing elevations may be re-established by backfilling after the undesirable material has been removed.

The recommended soil bearing value should be considered an upper limit, and any value less than that listed above would be acceptable for the foundation system. Using the value given, total settlement would be about 1 inch or less with differential settlements being less than 75 percent of total settlement. Footings should be placed at a depth of 2.0 feet, or greater, below finished exterior grade for protection against frost damage.

5.4 Parking and Drive Areas

The drive that accesses the site will be surfaced with crushed stone. Parking and drive areas that are surfaced with crushed stone should have a minimum thickness of 6 inches and be properly placed and compacted as outlined herein. The crushed stone should meet Kentucky Transportation Cabinet specifications and applicable local codes.

A paved section consisting only of crushed graded aggregate base course should be considered a high maintenance section. Regular care and maintenance is considered essential to the longevity and use of the section. Site grades should be maintained in such a manner as to allow for adequate surface runoff. Any potholes, depressions or excessive rutting that may develop should be repaired as soon as possible to reduce the possibility of degrading the soil subgrade.

5.5 Site Preparation

Site preparation should begin with the removal of any topsoil, loose (including boulders), soft or otherwise unsuitable materials from the construction area. The geotechnical engineer should evaluate the actual stripping depth, along with any soft soils that require undercutting at the time of construction.

Any fill and backfill placed on the site should consist of approved materials that are free of organic matter and debris. Suitable fill material should consist of either well graded granular material or low-plasticity cohesive soil. Structural fill placed below the tower foundation should be limited to the well graded granular material. Low-plasticity cohesive soil should have a liquid limit of less than 45 percent and a plasticity index of less than 25 percent. Based on our visual classification, the on site soils are not considered suitable for reuse as structural fill. It is recommended that during construction these soils should be further tested and evaluated prior to use as fill. Fill should not contain frozen material and it should not be placed on a frozen subgrade.

The fill should be placed and compacted in lifts of 9 inches or less in loose thickness. Fill placed below structures or used to provide lateral resistance should be compacted to at least 98 percent of the material's maximum standard Proctor dry density (ASTM D-698). Fill should be placed, compacted, and maintained at moisture contents within minus 1 to plus 3 percent of the optimum value determined by the standard Proctor test.

The geotechnical engineer should be retained to monitor fill placement on the project and to perform field density tests as each lift of fill is placed in order to evaluate compliance with the design requirements. Standard Proctor and Atterberg limits tests should be performed on the representative samples of fill materials before their use on the site.

6.0 GENERAL COMMENTS

Terracon should be retained to review the final design plans and specifications so comments can be made regarding interpretation and implementation of our geotechnical recommendations in the design and specifications. Terracon also should be retained to provide testing and observation during excavation, grading, foundation and construction phases of the project.

The analysis and recommendations presented in this report are based upon the data obtained from the boring performed at the indicated location and from other information discussed in this report. This report does not reflect variations that may occur across the site, or due to the modifying effects of weather. The nature and extent of such variations may not become evident until during or after construction. If variations appear, we should be immediately notified so that further evaluation and supplemental recommendations can be provided.

**Burnside II Communication Tower
Burnside, Kentucky
Terracon Project No.: 57057351G
October 21, 2005**

Terracon

The scope of services for this project does not include either specifically or by implication any environmental or biological (e.g., mold, fungi, bacteria) assessment of the site or identification or prevention of pollutants, hazardous materials or conditions. If the owner is concerned about the potential for such contamination or pollution, other studies should be undertaken.

This report has been prepared for the exclusive use of our client for specific application to the project discussed and has been prepared in accordance with generally accepted geotechnical engineering practices. No warranties, either express or implied, are intended or made. Site safety, excavation support, and dewatering requirements are the responsibility of others. In the event that changes in the nature, design, or location of the project as outlined in this report are planned, the conclusions and recommendations contained in this report shall not be considered valid unless Terracon reviews the changes and either verifies or modifies the conclusions of this report in writing.

APPENDIX

U.S. 27

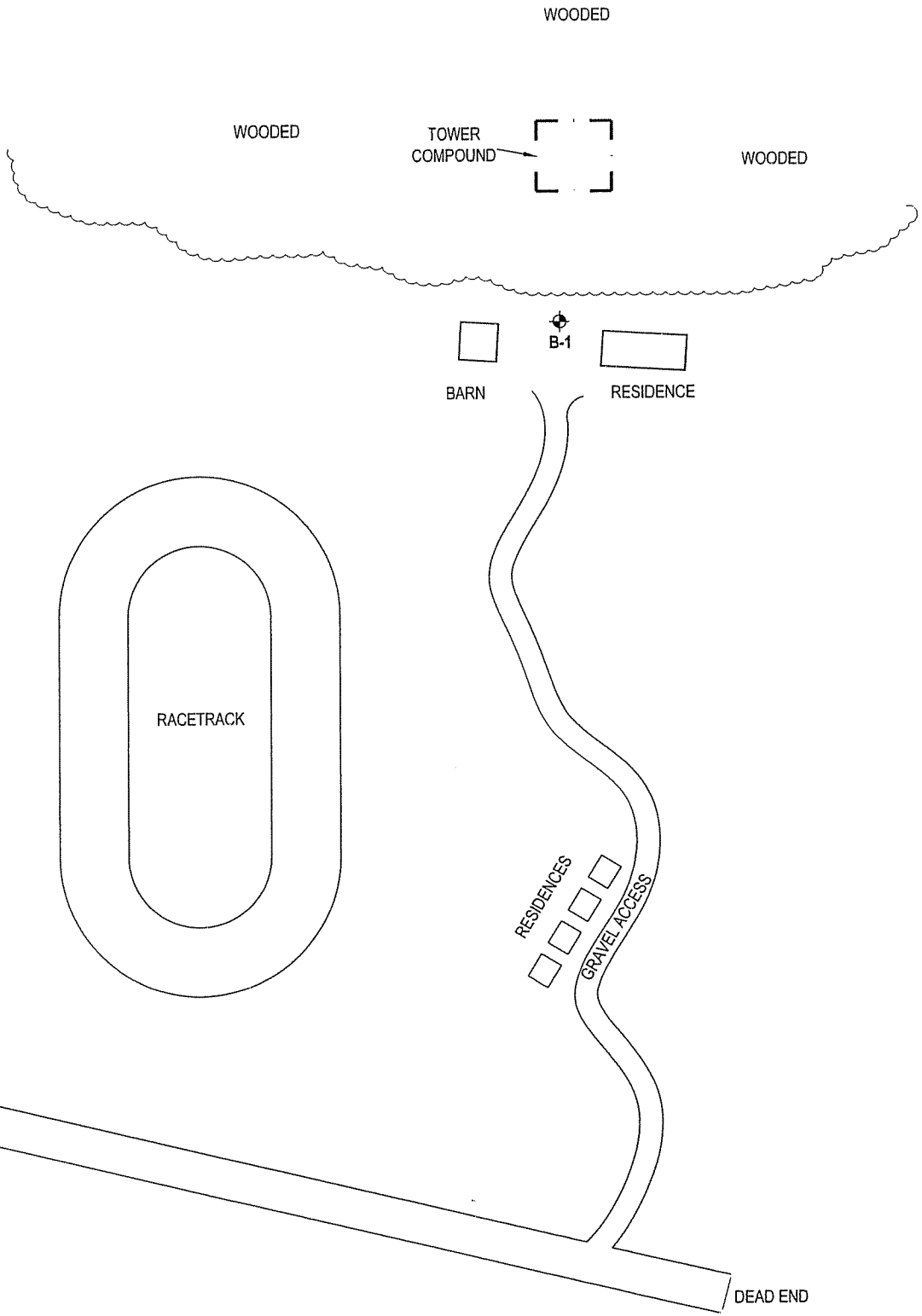

LEGEND

- · — SUBJECT SITE
- ⊕ BORING LOCATION

NOT TO SCALE

THIS DIAGRAM IS FOR GENERAL LOCATION ONLY, AND IS NOT INTENDED FOR CONSTRUCTION PURPOSES

BORING LOCATION PLAN				
BURNSIDE 2				
U.S. 27				
Project Mngr:	EJH	 2855 Premiere Parkway, Suite C Duluth, Georgia 30097	Project No:	57057351
Designed By:			Scale:	NOT TO SCALE
Drawn By:	MRF		File No:	57057351-1
Checked By:	EJH		Date:	OCTOBER 2005
Approved By:	EJH		Figure No.	1

LOG OF BORING NO. B-1

CLIENT RSB Design										
SITE Burnside, Kentucky		PROJECT Burnside II Communication Tower								
GRAPHIC LOG	DESCRIPTION	DEPTH, ft.	USCS SYMBOL	SAMPLES				TESTS		
				NUMBER	TYPE	RECOVERY, in.	SPT - N * BLOWS / ft.	WATER CONTENT, %	DRY UNIT WT pcf	UNCONFINED STRENGTH, psf
9	FAT CLAY , orangish brown, brown and tan, stiff to very stiff	1	CH	SS	18	11	31			
		2	CH	SS	14	12	23			
		3	CH	SS	16	16	29			
9	Auger Refusal at 9 feet, Began Coring	4	CH	SS	3	50/3	28			
	LIMESTONE , close to moderately closely jointed, moderately weathered to fresh, brownish gray to gray, hard	5		DB	90%	RQD 74%				
19	Boring Terminated at 19 feet									

The stratification lines represent the approximate boundary lines between soil and rock types: in-situ, the transition may be gradual.

*Manual Hammer

WATER LEVEL OBSERVATIONS, ft	
WL ∇ DRY	∇
WL ∇	∇
WL	



BORING STARTED		10-18-05	
BORING COMPLETED		10-18-05	
RIG	Acker	FOREMAN	GT
APPROVED	EJH	JOB #	57057351

BOREHOLE 99 LOGS.GPJ TERRACON.GDT 10/21/05

GENERAL NOTES

DRILLING & SAMPLING SYMBOLS:

SS:	Split Spoon - 1- ³ / ₈ " I.D., 2" O.D., unless otherwise noted	HS:	Hollow Stem Auger
ST:	Thin-Walled Tube - 2" O.D., unless otherwise noted	PA:	Power Auger
RS:	Ring Sampler - 2.42" I.D., 3" O.D., unless otherwise noted	HA:	Hand Auger
DB:	Diamond Bit Coring - 4", N, B	RB:	Rock Bit
BS:	Bulk Sample or Auger Sample	WB:	Wash Boring or Mud Rotary

The number of blows required to advance a standard 2-inch O.D. split-spoon sampler (SS) the last 12 inches of the total 18-inch penetration with a 140-pound hammer falling 30 inches is considered the "Standard Penetration" or "N-value".

WATER LEVEL MEASUREMENT SYMBOLS:

WL:	Water Level	WS:	While Sampling	N/E:	Not Encountered
WCI:	Wet Cave in	WD:	While Drilling		
DCI:	Dry Cave in	BCR:	Before Casing Removal		
AB:	After Boring	ACR:	After Casing Removal		

Water levels indicated on the boring logs are the levels measured in the borings at the times indicated. Groundwater levels at other times and other locations across the site could vary. In pervious soils, the indicated levels may reflect the location of groundwater. In low permeability soils, the accurate determination of groundwater levels may not be possible with only short-term observations.

DESCRIPTIVE SOIL CLASSIFICATION: Soil classification is based on the Unified Classification System. Coarse Grained Soils have more than 50% of their dry weight retained on a #200 sieve; their principal descriptors are: boulders, cobbles, gravel or sand. Fine Grained Soils have less than 50% of their dry weight retained on a #200 sieve; they are principally described as clays if they are plastic, and silts if they are slightly plastic or non-plastic. Major constituents may be added as modifiers and minor constituents may be added according to the relative proportions based on grain size. In addition to gradation, coarse-grained soils are defined on the basis of their in-place relative density and fine-grained soils on the basis of their consistency.

CONSISTENCY OF FINE-GRAINED SOILS

<u>Unconfined Compressive Strength, Qu, psf</u>	<u>Standard Penetration or N-value (SS) Blows/Ft.</u>	<u>Consistency</u>
< 500	<2	Very Soft
500 – 1,000	2-3	Soft
1,001 – 2,000	4-7	Medium Stiff
2,001 – 4,000	8-15	Stiff
4,001 – 8,000	16-30	Very Stiff
8,000+	30+	Hard

RELATIVE DENSITY OF COARSE-GRAINED SOILS

<u>Standard Penetration or N-value (SS) Blows/Ft.</u>	<u>Relative Density</u>
0 – 3	Very Loose
4 – 9	Loose
10 – 29	Medium Dense
30 – 49	Dense
50+	Very Dense

RELATIVE PROPORTIONS OF SAND AND GRAVEL

<u>Descriptive Term(s) of other constituents</u>	<u>Percent of Dry Weight</u>
Trace	< 15
With	15 – 29
Modifier	> 30

GRAIN SIZE TERMINOLOGY

<u>Major Component of Sample</u>	<u>Particle Size</u>
Boulders	Over 12 in. (300mm)
Cobbles	12 in. to 3 in. (300mm to 75 mm)
Gravel	3 in. to #4 sieve (75mm to 4.75 mm)
Sand	#4 to #200 sieve (4.75mm to 0.075mm)
Silt or Clay	Passing #200 Sieve (0.075mm)

RELATIVE PROPORTIONS OF FINES

<u>Descriptive Term(s) of other constituents</u>	<u>Percent of Dry Weight</u>
Trace	< 5
With	5 – 12
Modifiers	> 12

PLASTICITY DESCRIPTION

<u>Term</u>	<u>Plasticity Index</u>
Non-plastic	0
Low	1-10
Medium	11-30
High	30+

GENERAL NOTES

Description of Rock Properties

WEATHERING

Fresh	Rock fresh, crystals bright, few joints may show slight staining. Rock rings under hammer if crystalline.
Very slight	Rock generally fresh, joints stained, some joints may show thin clay coatings, crystals in broken face show bright. Rock rings under hammer if crystalline.
Slight	Rock generally fresh, joints stained, and discoloration extends into rock up to 1 in. Joints may contain clay. In granitoid rocks some occasional feldspar crystals are dull and discolored. Crystalline rocks ring under hammer.
Moderate	Significant portions of rock show discoloration and weathering effects. In granitoid rocks, most feldspars are dull and discolored; some show clayey. Rock has dull sound under hammer and shows significant loss of strength as compared with fresh rock.
Moderately severe	All rock except quartz discolored or stained. In granitoid rocks, all feldspars dull and discolored and majority show kaolinization. Rock shows severe loss of strength and can be excavated with geologist's pick.
Severe	All rock except quartz discolored or stained. Rock "fabric" clear and evident, but reduced in strength to strong soil. In granitoid rocks, all feldspars kaolinized to some extent. Some fragments of strong rock usually left.
Very severe	All rock except quartz discolored or stained. Rock "fabric" discernible, but mass effectively reduced to "soil" with only fragments of strong rock remaining.
Complete	Rock reduced to "soil". Rock "fabric" not discernible or discernible only in small, scattered locations. Quartz may be present as dikes or stringers.

HARDNESS (for engineering description of rock – not to be confused with Moh's scale for minerals)

Very hard	Cannot be scratched with knife or sharp pick. Breaking of hand specimens requires several hard blows of geologist's pick.
Hard	Can be scratched with knife or pick only with difficulty. Hard blow of hammer required to detach hand specimen.
Moderately hard	Can be scratched with knife or pick. Gouges or grooves to ¼ in. deep can be excavated by hard blow of point of a geologist's pick. Hand specimens can be detached by moderate blow.
Medium	Can be grooved or gouged 1/16 in. deep by firm pressure on knife or pick point. Can be excavated in small chips to pieces about 1-in. maximum size by hard blows of the point of a geologist's pick.
Soft	Can be gouged or grooved readily with knife or pick point. Can be excavated in chips to pieces several inches in size by moderate blows of a pick point. Small thin pieces can be broken by finger pressure.
Very soft	Can be carved with knife. Can be excavated readily with point of pick. Pieces 1-in. or more in thickness can be broken with finger pressure. Can be scratched readily by fingernail.

Joint, Bedding and Foliation Spacing in Rock^a

Spacing	Joints	Bedding/Foliation
Less than 2 in.	Very close	Very thin
2 in. – 1 ft.	Close	Thin
1 ft. – 3 ft.	Moderately close	Medium
3 ft. – 10 ft.	Wide	Thick
More than 10 ft.	Very wide	Very thick

Rock Quality Designator (RQD) ^b		Joint Openness Descriptors	
RQD, as a percentage	Diagnostic description	Openness	Descriptor
Exceeding 90	Excellent	No Visible Separation	Tight
90 – 75	Good	Less than 1/32 in.	Slightly Open
75 – 50	Fair	1/32 to 1/8 in.	Moderately Open
50 – 25	Poor	1/8 to 3/8 in.	Open
Less than 25	Very poor	3/8 in. to 0.1 ft.	Moderately Wide
		Greater than 0.1 ft.	Wide

- a. Spacing refers to the distance normal to the planes, of the described feature, which are parallel to each other or nearly so.
b. RQD (given as a percentage) = length of core in pieces 4 in. and longer/length of run.

References: American Society of Civil Engineers. Manuals and Reports on Engineering Practice - No. 56. Subsurface Investigation for Design and Construction of Foundations of Buildings. New York: American Society of Civil Engineers, 1976.
U.S. Department of the Interior, Bureau of Reclamation, Engineering Geology Field Manual.

UNIFIED SOIL CLASSIFICATION SYSTEM

Criteria for Assigning Group Symbols and Group Names Using Laboratory Tests^A

				Soil Classification		
				Group Symbol	Group Name ^B	
Coarse Grained Soils More than 50% retained on No. 200 sieve	Gravels More than 50% of coarse fraction retained on No. 4 sieve	Clean Gravels Less than 5% fines ^C	$Cu \geq 4$ and $1 \leq Cc \leq 3^E$	GW	Well-graded gravel ^F	
			$Cu < 4$ and/or $1 > Cc > 3^E$	GP	Poorly graded gravel ^F	
		Gravels with Fines More than 12% fines ^C	Fines classify as ML or MH Fines classify as CL or CH	GM GC	Silty gravel ^{F,G,H} Clayey gravel ^{F,G,H}	
	Sands 50% or more of coarse fraction passes No. 4 sieve	Clean Sands Less than 5% fines ^D	$Cu \geq 6$ and $1 \leq Cc \leq 3^E$ $Cu < 6$ and/or $1 > Cc > 3^E$	SW SP	Well-graded sand ^I Poorly graded sand ^I	
		Sands with Fines More than 12% fines ^D	Fines classify as ML or MH Fines Classify as CL or CH	SM SC	Silty sand ^{G,H,I} Clayey sand ^{G,H,I}	
Fine-Grained Soils 50% or more passes the No. 200 sieve	Silts and Clays Liquid limit less than 50	inorganic	$PI > 7$ and plots on or above "A" line ^J $PI < 4$ or plots below "A" line ^J	CL ML	Lean clay ^{K,L,M} Silt ^{K,L,M}	
		organic	Liquid limit - oven dried < 0.75 Liquid limit - not dried	OL	Organic clay ^{K,L,M,N} Organic silt ^{K,L,M,O}	
		Silts and Clays Liquid limit 50 or more	inorganic	PI plots on or above "A" line PI plots below "A" line	CH MH	Fat clay ^{K,L,M} Elastic Silt ^{K,L,M}
			organic	Liquid limit - oven dried < 0.75 Liquid limit - not dried	OH	Organic clay ^{K,L,M,P} Organic silt ^{K,L,M,Q}
	Highly organic soils	Primarily organic matter, dark in color, and organic odor		PT	Peat	

^ABased on the material passing the 3-in. (75-mm) sieve

^BIf field sample contained cobbles or boulders, or both, add "with cobbles or boulders, or both" to group name.

^CGravels with 5 to 12% fines require dual symbols: GW-GM well-graded gravel with silt, GW-GC well-graded gravel with clay, GP-GM poorly graded gravel with silt, GP-GC poorly graded gravel with clay.

^DSands with 5 to 12% fines require dual symbols: SW-SM well-graded sand with silt, SW-SC well-graded sand with clay, SP-SM poorly graded sand with silt, SP-SC poorly graded sand with clay

$$^E Cu = D_{60}/D_{10} \quad Cc = \frac{(D_{30})^2}{D_{10} \times D_{60}}$$

^FIf soil contains $\geq 15\%$ sand, add "with sand" to group name.

^GIf fines classify as CL-ML, use dual symbol GC-GM, or SC-SM.

^HIf fines are organic, add "with organic fines" to group name.

^IIf soil contains $\geq 15\%$ gravel, add "with gravel" to group name.

^JIf Atterberg limits plot in shaded area, soil is a CL-ML, silty clay.

^KIf soil contains 15 to 29% plus No. 200, add "with sand" or "with gravel," whichever is predominant.

^LIf soil contains $\geq 30\%$ plus No. 200 predominantly sand, add "sandy" to group name.

^MIf soil contains $\geq 30\%$ plus No. 200, predominantly gravel, add "gravelly" to group name.

^N $PI \geq 4$ and plots on or above "A" line.

^O $PI < 4$ or plots below "A" line.

^P PI plots on or above "A" line.

^Q PI plots below "A" line.

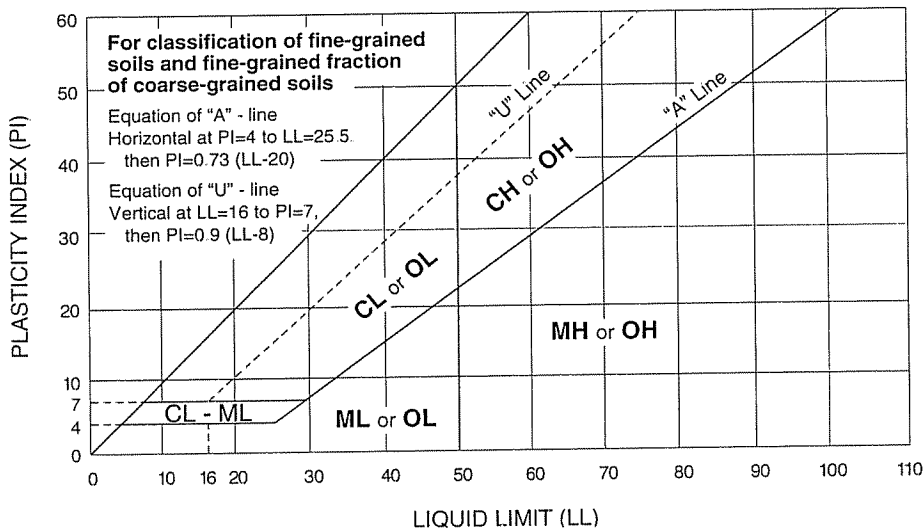



Land Surveyors and Consulting Engineers

Site Name: BURNSIDE

DRIVE TO DIRECTIONS

FROM ELIZABETHTOWN, KY PROCEED SOUTH ON I-65 43 MILES TO THE CUMBERLAND PARKWAY (EXIT 43). PROCEED EAST ON THE CUMBERLAND PARKWAY 87 MILES TO TO SR 1225 (TIGERS WAY). PROCEED SOUTH ON SR 1225 0.3 MILES TO SR 80 (W. HIGHWAY 80). TURN LEFT ONTO SR 80 AND PROCEED 1 MILE TO WEST COLUMBIA STREET. TURN RIGHT ONTO WEST COLUMBIA STREET AND PROCEED 0.4 MILES TO U.S. HWY. 27. TURN RIGHT ONTO U.S. HWY. 27 AND PROCEED SOUTH 9.3 MILES TO KINGSFORD ROAD. TURN LEFT ONTO KINGSFORD ROAD AND PROCEED 0.6 MILES TO RACE TRACK ROAD. PROCEED 0.2 MILES TO AN EXISTING GATE AT THE END OF THE ROAD. PROCEED THROUGH THE GATE AND FOLLOW THE EXISTING GRAVEL ROAD APPROXIMATELY 1400'± TO THE PROPOSED SITE.

OPTION TO LEASE AND LEASE AGREEMENT

I.

OPTION TO LEASE REAL PROPERTY

THIS OPTION TO LEASE REAL PROPERTY (the "Option Agreement") is made and entered into this 27 day of July, 2005, by and between **Harold Hardgrove** whose address is **1 Race Track Road, Burnside, KY 42519** (the "Optionor (s)") and **Bluegrass Wireless LLC, a Kentucky limited liability company** with principal office and place of business at **2902 Ring Road, Elizabethtown, KY 42701** (the "Optionee").

WITNESSETH:

WHEREAS, the Optionor(s) is the owner of certain real property located in **Pulaski** County, **Kentucky** as more particularly described on Exhibit A attached hereto and incorporated herein by reference (the "Property"); and

WHEREAS, the Optionor(s) wishes to grant to the Optionee, and the Optionee wishes to obtain from the Optionor(s), an option to lease the Property upon the terms and conditions set forth herein;

NOW, THEREFORE, in consideration of the foregoing premises and for other good and valuable consideration, the mutuality, receipt and sufficiency of which are hereby acknowledged, the parties hereto do agree as follows.

1. In consideration of **One Thousand Two Hundred Dollars and Zero Cents (\$1,200.00)** paid by the Optionee to the Optionor(s) (the "Option Consideration"), the receipt of which is hereby acknowledged by the Optionor(s), the Optionor(s)

Site Name: Burnside

hereby grants to the Optionee an exclusive and irrevocable option to lease the Property (the "Option"), upon the terms and conditions hereinafter set forth, upon the exercise of the Option at any time before 4:00 p.m. prevailing time on July 27, 2006, as set forth in Paragraph 5 thereof.

2. The parties hereto anticipate that the Property comprises approximately a **One Hundred Foot by One Hundred Foot** area, and that a right of way will be given by the Optionor(s) for the purposes of ingress and egress throughout the term of the lease. The Optionee shall obtain an accurate survey of the Property by a registered land surveyor licensed in the Commonwealth of Kentucky at the sole expense of the Optionee. A copy of the survey shall be provided to the Optionor(s). The description of the Property shall include the number of acres determined by the surveyor. The Optionee shall obtain said survey within a reasonable time following the date of the Option Agreement.
3. During the term of the Option, the Optionee may enter onto the Property at its own risk to obtain soil samples and to bore soil for the purposes of determining the suitability of the Property for a communications tower.
4. Upon the Optionee's proper exercise of the Option in accordance with Paragraph **5** hereof, the Optionor(s) shall be deemed to have immediately executed, acknowledged and delivered to the Optionee the Lease Agreement contained in Section II hereof. The description of the Property shall be that determined by the registered land surveyor in accordance with Paragraph 2 hereof.
5. If the Optionee elects to exercise the Option in accordance with the terms hereof, notice of such election shall be deemed sufficient if personally delivered or sent by

Site Name: Burnside

registered or certified mail, return receipt requested, to the address of the Optionor(s) set forth in Paragraph 14 hereof.

6. The Optionor(s) agrees not to sell, lease or offer for sale or lease the Property during the term of this Option or any renewal or extension of the Option.
7. In the event the Optionee fails to exercise the Option as set forth herein (unless such failure is due to the discovery of a defect in the Property or other matter unsatisfactory to the Optionee), the Optionor(s) shall have the right to retain the Option Consideration.
8. The Optionee may assign this Option with written consent of the Optionor(s), which consent shall not be unreasonably withheld, and upon any assignment such assignee shall have all the rights, remedies and obligations as if it were the original Optionee hereunder. From and after any such assignment, the term "Optionee" shall refer to such assignee.
9. Each party hereto shall bear any and all of its own expenses in connection with the negotiation, execution or settlement of this Option.
10. Risk of loss with respect to the Property during the term of this Option and during the term of the lease shall be upon the Optionor(s). If, during the term of the Option, any portion of the Property shall be acquired by public authority under the right or threat of eminent domain, the Optionee may, at its sole option, either (i) exercise the Option, and in such event, all sums received from the public authority by the Optionor(s) by reason of the taking of a portion of the Property shall reduce the rent due under the lease, or (ii) terminate this Option and thereupon the Optionor(s) shall be obligated to

Site Name: Burnside

return to the Optionee the full amount of the Option Consideration previously paid to the Optionor(s) in "good and collected funds."

11. The parties hereto represent to each other that neither has engaged any broker to represent their interests in connection with the transactions contemplated hereby, and each agrees to indemnify the other against any and all claims made by any brokers engaged or purported to be engaged by the other for brokerage commissions or fees in connection with the transactions contemplated hereby.
12. The Optionor(s) represents, warrants and covenants to the Optionee that the Optionor(s) has not caused or permitted, and shall not cause or permit, and to the best of Optionor(s)' knowledge no other person has caused or permitted any hazardous material (as defined by any applicable federal, state or local law, rule or regulation) to be brought upon, placed, held, located or disposed of at the Property. In the event any such contamination occurs for which the Optionee becomes legally liable, the Optionor(s) shall indemnify the Optionee against all claims, damages, judgments, penalties and costs and expenses, including reasonable attorneys' fees, which Optionee may incur.
13. This Option Agreement and the rights and obligations of the parties hereto shall be construed in accordance with the laws of the Commonwealth of Kentucky.
14. For the purposes of giving notice as permitted or required herein, the address of the Optionor(s) shall be: **P.O. Box 1089, Burnside, KY 42519**; the Optionee's address shall be: **2902 Ring Road, Elizabethtown, KY 42701**.

Site Name: Burnside

15. The Optionee shall have the right, in its sole discretion, to record this Option in the Office of the Clerk of the County Court of Pulaski County, Kentucky.

II.

LEASE AGREEMENT

16. In the event the Optionee elects to exercise the Option to lease the Property, the terms of the lease shall become immediately effective upon such exercise and shall be as follows.
1. The term of the lease shall commence on the date that the Optionor(s) receives proper notice that the Optionee has exercised the Option, pursuant to Paragraph 5 therein. The initial term shall expire five (5) year(s) from the commencement date of the lease agreement and shall include three (3) additional five (5)-year terms per the lease agreement. Optionee may, by providing written notice at least sixty (60) days prior to the expiration of the original or any renewal lease term, elect to unilaterally terminate this lease at the end of any original or renewal lease term. Such notice must be personally delivered or sent via registered or certified mail, return receipt requested, to the address of the Optioner(s) set forth in Paragraph 14 hereof. The lease amount shall be adjusted at the end of each term by an increase of 12%.
 2. The Optionee shall pay to the Optionor(s) rent for the Property in the sum of Six Thousand Dollars and Zero Cents (\$6,000.00) yearly, to be paid in advance. All rent payments shall be personally delivered

or mailed to the Optionor(s) at the address set forth in Paragraph 14 hereof. Any check payment of the rent due under the lease shall be payable to the order of Optionor(s).

3. The Optionee shall be entitled to use and occupy the Property for the purpose of erecting and maintaining a communications tower thereon and for such other uses as Optionee may deem necessary in connection therewith.
4. The Optionor(s) shall be responsible for the payment of all real estate taxes which shall be assessed against the Property during the term of the lease. The Optionee shall pay all charges for heat, water, gas, electricity, sewer use charges and any other utility used or consumed on the Property. The Optionee shall, at its own cost and expense, maintain and keep in full force and effect during the term of the lease public liability insurance with coverage in the amount of at least one million dollars (\$1,000,000.00) per person for bodily injury, disease, or death and shall maintain property insurance on any property the Optionee located on the Property.
5. The Optionee may assign the lease. The Optionee may sublet all or part of the space on the tower or ground space.
6. The Optionor(s) covenants that upon the Optionee's payment of the rent agreed upon herein, as well as Optionee's observing and performing all of the covenants and conditions contained in the lease, the Optionee may peacefully and quietly enjoy the Property subject to the terms and conditions set forth in the lease.

Site Name: Burnside

7. The Optionee agrees to maintain an access road in a passable manner for the term of the lease.

17. This Option and Lease Agreement contains the entire agreement between the parties hereto and no modification or amendment shall be binding upon any party unless made in writing and signed by each of the parties hereto.

18. Upon the termination or other end of this lease agreement, Optionee shall have the right to remove any and all of its property (real or personal) from the Property regardless of whether or not such property may be considered a fixture thereto.

19. Upon abandonment of the property, Optionee shall have thirty (30) days to dismantle and remove the cellular antenna tower and any/all equipment located on Optionor's property.

[Remainder of Page Intentionally Left Blank]

Site Name: Burnside

EXECUTION OF AGREEMENT(S)

IN TESTIMONY WHEREOF, witness the signatures of the Optionor(s) and the Optionee as of the date first above written, as proof that the parties enter into the **Option to Lease Real Property and the Lease Agreement** set out in **Sections I and II** hereof .

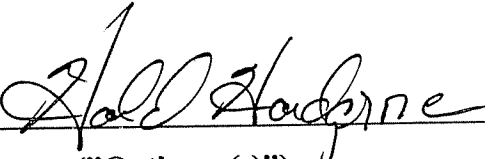

("Optionor(s)")

By: Harold Hardgrove
Property Owner



("Optionee")

By: Ron Smith
Authorized Representative
Bluegrass Wireless LLC, a Kentucky
limited liability company

Date: 7-27-05

Date: 7-27-05

Site Name: Burnside

STATE OF Kentucky
COUNTY OF Hardin

The foregoing instrument was acknowledged before me this 20 day of July, 2005,
by Harold Hand Grove to be his/her free act and deed.

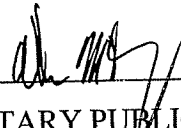

NOTARY PUBLIC STATE AT LARGE
My commission expires: 1-27-06

STATE OF Kentucky
COUNTY OF Hardin

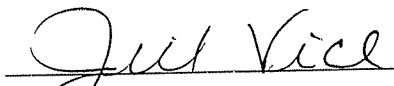
The foregoing instrument was acknowledged before me this 1 day of August,
2005, by Ron Smith, to be his free act and deed.

NOTARY PUBLIC STATE OF LARGE
My commission expires: 1-21-09

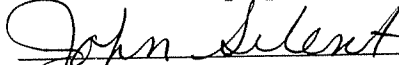
This instrument prepared by:

John E. Selent

DINSMORE & SHOHL LLP

2000 Meidinger Tower

Louisville, KY 40202

(502) 585-2450



Land Surveyors and Consulting Engineers

Map 79-3-2, Lot 28
Phillips, Tommy & Emma Whaley
153 Barreb River Blvd.
Georgetown, KY 40324
Deed Book 23, Page 243
No Zoning

Map 79-3-2, Lot 30
Phillips, Brian Keith & Donna
P.O. Box 1149
Burnside, KY 42519
Deed Book 21, Page 555
No Zoning

Map 79-3-2, Lot 27
Moon, Kent A.
209 East Market Street
New Albany, IN 47130
Deed Book 726, Page 397
No Zoning

Map 79-3-2, Lot 31.1
Pennington, Ferne
318 Auburn Avenue
Somerset, KY 42501
Deed Book 558, Page 368
No Zoning

Map 79-3-2, Lot 31
Lowery, Willard E. & Wanda
P.O. Box 684
Burnside, KY 42519
Deed Book 486, Page 406
No Zoning

Map 79-3-2, Lot 39
Hogue, William J., Karen & Gerald
P.O. Box 537
Burnside, KY 42519
Deed Book 373, Page 475
No Zoning

Map 79-3-2, Lot 42
Casada, Jason Ray
P.O. Box 382
Burnside, KY 42519
Deed Book 611, Page 642
No Zoning

Map 79-3-2, Lot 43
Hogue, Gerald W. & Louise
103 Beachview Drive
Burnside, KY 42519
Deed Book 373, Page 475
No Zoning



Land Surveyors and Consulting Engineers

Map 79-3-2, Lot 44
Hogue, Gerald W. & Louise
103 Beachview Drive
Burnside, KY 42519
Deed Book 373, Page 475
No Zoning

Map 79-3-2, Lot 45
Hogue, Gerald W. & Louise
103 Beachview Drive
Burnside, KY 42519
Deed Book 373, Page 475
No Zoning

Map 79-3-2, Lot 46
Southerland, Lisha
P.O. Box 1388
Burnside, KY 42519
Deed Book 707, Page 704
No Zoning

Map 79-3-2, Lot 47
Southerland, Lisha
P.O. Box 1388
Burnside, KY 42519
Deed Book 707, Page 704
No Zoning



Land Surveyors and Consulting Engineers

Site Name: BURNSIDE

500' RADIUS & ADJOINING LANDOWNER LIST

Map 79-2, Lot 25.3
Hardgrove, Harold Lee
P.O. Box 1089
Burnside, KY 42519
Deed Book 668, Page 300
No Zoning

Map 79-2, Lot 24
Kingsford Manufacturing Co.
P.O. Box 24305
Oakland, CA 94623
Deed Book 632, Page 637
No Zoning

Map 79-2, Lot 27
Grissom, Rakestraw & Burgess
948 Leawood Square
Frankfort, KY 40601
Deed Book 601, Page 304
No Zoning

Map 79-2, Lot 25
Lowe, Edward & Lucy
340 Beachview Drive
Burnside, KY 42519
Deed Book 543, Page 630
No Zoning

Map 79-2, Lot 25.1
Eaton, Judy R.
P.O. Box 3516
Somerset, KY 42502
Deed Book 757, Page 38
No Zoning

Map 79-2, Lot 25.2
Goad, Shawn & Chelea
270 Beachview Drive
Burnside, KY 42519
Deed Book 655, Page 674
No Zoning

Map 79-3-2, Lot 29
Hardgrove, Harold Lee
P.O. Box 1089
Burnside, KY 42519
Deed Book 607, Page 217
No Zoning

LICOMMONWEALTH OF KENTUCKY
BEFORE THE PUBLIC SERVICE COMMISSION

In the Matter of:

**APPLICATION OF BLUEGRASS WIRELESS LLC
FOR ISSUANCE OF A CERTIFICATE OF PUBLIC
CONVENIENCE AND NECESSITY TO CONSTRUCT
A CELL SITE (BURNSIDE) IN RURAL SERVICE
AREA #6 (PULASKI) OF THE COMMONWEALTH OF
KENTUCKY**

CASE NO. 2005-00282

AFFIDAVIT OF JOHN E. SELENT

I, John E. Selent, being duly sworn, depose and state as follows:

1. My name is John E. Selent and I am a member of the Kentucky Bar Association.

I am legal counsel to Bluegrass Wireless LLC and am submitting this affidavit in conjunction with the above referenced matter.

2. Pursuant to 807 KAR 5:063 §1(1)(l), the attached list containing the names of the residents/tenants and property owners within 500 feet of the proposed tower have been: (i) notified by written notice of the proposed construction, sufficient postage prepaid, by United States certified mail, return receipt requested; (ii) given the Commission docket number under which the application will be processed; and (iii) informed of the right to request intervention:

3. The addresses for Lisha Southerland, Harold Lee Hardgrove, Kingsford Manufacturing Co., Jason Ray Casada, William J., Karen & Gerald Hogue, Willard E. & Wanda Lowery, Brian Keith & Donna Phillips, and Judy R. Eaton are P.O. Boxes and therefore cannot be served by U.S. Certified Mail, pursuant to 807 KAR 5:063 § 1(l) and (m).

4. For the reason set forth in paragraph 3, the written notices of the proposed construction for Lisha Southerland, Harold Lee Hardgrove, Kingsford Manufacturing Co., Jason Ray Casada, William J., Karen & Gerald Hogue, Willard E. & Wanda Lowery, Brian Keith &

Donna Phillips, and Judy R. Eaton were sent via U.S. Express Mail. The proof of service for each is attached hereto.

Further Affiant saith not.

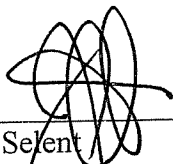

John E. Seibert

COMMONWEALTH OF KENTUCKY)
)SS:
COUNTY OF JEFFERSON)

SUBSCRIBED AND SWORN to before me this 25th day of October, 2005.

My commission expires: 10-25-05

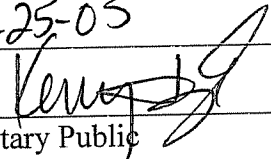

Notary Public

PUBLIC NOTICE

TO: Kent A. Moon
 209 East Market Street
 New Albany, Indiana 47130

Bluegrass Wireless LLC, is applying to the Public Service Commission of Kentucky for a Certificate of Public Convenience and Necessity for construction and operation as a new cell facility to provide cellular radio service. The facility would include a 240 foot tower to be located at 362 Race Track Road, Burnside, Kentucky, 42519. A map showing the location is attached. This notice is being sent to you because you either own property and/or reside on property that is located within a 500 ft. radius of the proposed tower or you own property contiguous to the property where the proposed tower will be located.

The Commission invites your comments regarding the utilities' proposed construction. Also, the Commission wants you to be aware of your right to intervene in this matter. Your comments and request for intervention should be addressed to:

**Executive Director's Office
 Public Service Commission of Kentucky
 P.O. Box 615
 Frankfort, Kentucky 40602**

Please refer to case number 2005-00282 in your correspondence.

SENDER: COMPLETE THIS SECTION	COMPLETE THIS SECTION ON DELIVERY
<ul style="list-style-type: none"> ■ Complete items 1, 2, and 3. Also complete item 4 if Restricted Delivery is desired. ■ Print your name and address on the reverse so that we can return the card to you. ■ Attach this card to the back of the mailpiece, or on the front if space permits. <p>1. Article Addressed to:</p> <p style="font-size: 1.2em; margin-left: 20px;">Kent A. Moon 209 E. Market Street 209 E. Market Street New Albany, Indiana 47130</p> <p>2. Article Number (Transfer from service label) 7005 1160 0005 4137 5164</p>	<p>A. Signature <input type="checkbox"/> Agent <input type="checkbox"/> Addressee</p> <p><input checked="" type="checkbox"/> <i>Kent A. Moon</i></p> <p>B. Received by (Printed Name) C. Date of Delivery</p> <p><i>Kent A. Moon</i> 9/19/05</p> <p>D. Is delivery address different from item 1? <input type="checkbox"/> Yes If YES, enter delivery address below: <input type="checkbox"/> No</p> <p>3. Service Type</p> <p><input checked="" type="checkbox"/> Certified Mail <input type="checkbox"/> Express Mail <input type="checkbox"/> Registered <input type="checkbox"/> Return Receipt for Merchandise <input type="checkbox"/> Insured Mail <input type="checkbox"/> C.O.D.</p> <p>4. Restricted Delivery? (Extra Fee) <input checked="" type="checkbox"/> Yes</p>

PUBLIC NOTICE

TO: Shawn & Chelea Goad
270 Beachview Drive
Burnside, Kentucky 42519

Bluegrass Wireless LLC, is applying to the Public Service Commission of Kentucky for a Certificate of Public Convenience and Necessity for construction and operation as a new cell facility to provide cellular radio service. The facility would include a 240 foot tower to be located at 362 Race Track Road, Burnside, Kentucky, 42519. A map showing the location is attached. This notice is being sent to you because you either own property and/or reside on property that is located within a 500 ft. radius of the proposed tower or you own property contiguous to the property where the proposed tower will be located.

The Commission invites your comments regarding the utilities' proposed construction. Also, the Commission wants you to be aware of your right to intervene in this matter. Your comments and request for intervention should be addressed to:

**Executive Director's Office
Public Service Commission of Kentucky
P.O. Box 615
Frankfort, Kentucky 40602**

Please refer to case number 2005-00282 in your correspondence.

SENDER: COMPLETE THIS SECTION	COMPLETE THIS SECTION ON DELIVERY	
<ul style="list-style-type: none">■ Complete items 1, 2, and 3. Also complete item 4 if Restricted Delivery is desired.■ Print your name and address on the reverse so that we can return the card to you.■ Attach this card to the back of the mailpiece, or on the front if space permits.	A. Signature <i>[Signature]</i> <input type="checkbox"/> Agent <input type="checkbox"/> Addressee	
1. Article Addressed to: Shawn & Chelea Goad 270 Beachview Drive Burnside, Kentucky 42519	B. Received by (Printed Name)	C. Date of Delivery 9-16-05
2. Article Number (Transfer from service label)	D. Is delivery address different from item 1? <input type="checkbox"/> Yes If YES, enter delivery address below: <input type="checkbox"/> No	
PS Form 3811, February 2004	3. Service Type <input checked="" type="checkbox"/> Certified Mail <input type="checkbox"/> Express Mail <input type="checkbox"/> Registered <input type="checkbox"/> Return Receipt for Merchandise <input type="checkbox"/> Insured Mail <input type="checkbox"/> C.O.D.	
Domestic Return Receipt	4. Restricted Delivery? (Extra Fee) <input checked="" type="checkbox"/> Yes	
102595-02-M-1540	7005 1160 0005 4137 5140	

PUBLIC NOTICE

TO: Edward & Lucy Lowe
340 Beachview Drive
Burnside, Kentucky 42519

Bluegrass Wireless LLC, is applying to the Public Service Commission of Kentucky for a Certificate of Public Convenience and Necessity for construction and operation as a new cell facility to provide cellular radio service. The facility would include a 240 foot tower to be located at 362 Race Track Road, Burnside, Kentucky, 42519. A map showing the location is attached. This notice is being sent to you because you either own property and/or reside on property that is located within a 500 ft. radius of the proposed tower or you own property contiguous to the property where the proposed tower will be located.

The Commission invites your comments regarding the utilities' proposed construction. Also, the Commission wants you to be aware of your right to intervene in this matter. Your comments and request for intervention should be addressed to:

**Executive Director's Office
Public Service Commission of Kentucky
P.O. Box 615
Frankfort, Kentucky 40602**

Please refer to case number 2005-00282 in your correspondence.

SENDER: COMPLETE THIS SECTION	COMPLETE THIS SECTION ON DELIVERY
<ul style="list-style-type: none">■ Complete items 1, 2, and 3. Also complete item 4 if Restricted Delivery is desired.■ Print your name and address on the reverse so that we can return the card to you.■ Attach this card to the back of the mailpiece, or on the front if space permits.	<p>A. Signature <input type="checkbox"/> Agent <input checked="" type="checkbox"/> <i>Edward Lowe</i> <input type="checkbox"/> Addressee</p> <p>B. Received by (Printed Name) C. Date of Delivery <i>9-16-05</i></p> <p>D. Is delivery address different from item 1? <input type="checkbox"/> Yes If YES, enter delivery address below: <input type="checkbox"/> No</p>
<p>1. Article Addressed to: <i>Edward & Lucy Lowe 340 Beachview Drive Burnside, KY 42519</i></p>	<p>3. Service Type <input checked="" type="checkbox"/> Certified Mail <input type="checkbox"/> Express Mail <input type="checkbox"/> Registered <input type="checkbox"/> Return Receipt for Merchandise <input type="checkbox"/> Insured Mail <input type="checkbox"/> C.O.D.</p> <p>4. Restricted Delivery? (Extra Fee) <input checked="" type="checkbox"/> Yes</p>
<p>2. Article Number (Transfer from service label)</p>	<p>7005 1160 0005 4137 5133</p> <p>Domestic Return Receipt</p> <p>102595-02-M-1540</p>

PUBLIC NOTICE

TO: Grissom, Rakestraw & Burgess
948 Leawood Square
Frankfort, Kentucky 40601

Bluegrass Wireless LLC, is applying to the Public Service Commission of Kentucky for a Certificate of Public Convenience and Necessity for construction and operation as a new cell facility to provide cellular radio service. The facility would include a 240 foot tower to be located at 362 Race Track Road, Burnside, Kentucky, 42519. A map showing the location is attached. This notice is being sent to you because you either own property and/or reside on property that is located within a 500 ft. radius of the proposed tower or you own property contiguous to the property where the proposed tower will be located.

The Commission invites your comments regarding the utilities' proposed construction. Also, the Commission wants you to be aware of your right to intervene in this matter. Your comments and request for intervention should be addressed to:

**Executive Director's Office
Public Service Commission of Kentucky
P.O. Box 615
Frankfort, Kentucky 40602**

Please refer to case number 2005-00282 in your correspondence.

SENDER: COMPLETE THIS SECTION	COMPLETE THIS SECTION ON DELIVERY
<ul style="list-style-type: none">Complete items 1, 2, and 3. Also complete item 4 if Restricted Delivery is desired.Print your name and address on the reverse so that we can return the card to you.Attach this card to the back of the mailpiece, or on the front if space permits.	A. Signature <input type="checkbox"/> Agent <input checked="" type="checkbox"/> Addressee B. Received by (Printed Name) <u>SEP 14 2005</u> Date of Delivery
1. Article Addressed to: <u>Grissom, Rakestraw & Burgess 948 Leawood Square Frankfort, KY 40601</u>	D. Is delivery address different from item 1? <input type="checkbox"/> Yes If YES, enter delivery address below: <input type="checkbox"/> No 3. Service Type <input checked="" type="checkbox"/> Certified Mail <input type="checkbox"/> Express Mail <input type="checkbox"/> Registered <input type="checkbox"/> Return Receipt for Merchandise <input type="checkbox"/> Insured Mail <input type="checkbox"/> C.O.D. 4. Restricted Delivery? (Extra Fee) <input checked="" type="checkbox"/> Yes
2. Article Number (Transfer from service label)	<u>7005 1160 0005 4137 5126</u> PS Form 3811, February 2004 Domestic Return Receipt 102595-02-M-1540

PUBLIC NOTICE

TO: Ferne Pennington
318 Auburn Avenue
Somerset, Kentucky 42501

Bluegrass Wireless LLC, is applying to the Public Service Commission of Kentucky for a Certificate of Public Convenience and Necessity for construction and operation as a new cell facility to provide cellular radio service. The facility would include a 240 foot tower to be located at 362 Race Track Road, Burnside, Kentucky, 42519. A map showing the location is attached. This notice is being sent to you because you either own property and/or reside on property that is located within a 500 ft. radius of the proposed tower or you own property contiguous to the property where the proposed tower will be located.

The Commission invites your comments regarding the utilities' proposed construction. Also, the Commission wants you to be aware of your right to intervene in this matter. Your comments and request for intervention should be addressed to:

**Executive Director's Office
Public Service Commission of Kentucky
P.O. Box 615
Frankfort, Kentucky 40602**

Please refer to case number 2005-00282 in your correspondence.

SENDER: COMPLETE THIS SECTION	COMPLETE THIS SECTION ON DELIVERY
<ul style="list-style-type: none">Complete items 1, 2, and 3. Also complete item 4 if Restricted Delivery is desired.Print your name and address on the reverse so that we can return the card to you.Attach this card to the back of the mailpiece, or on the front if space permits.	<p>A. Signature <input type="checkbox"/> Agent <i>Joan Garner</i> <input type="checkbox"/> Addressee</p> <p>B. Received by (Printed Name) <i>Joan Garner</i></p> <p>C. Date of Delivery <i>SEP 26 2005</i></p> <p>D. Is delivery address different from item 1? <input type="checkbox"/> Yes If YES, enter delivery address below: <input checked="" type="checkbox"/> No</p>
1. Article Addressed to: <i>Ferne Pennington 318 Auburn Ave. Somerset, KY 42501</i>	3. Service Type <input checked="" type="checkbox"/> Certified Mail <input type="checkbox"/> Express Mail <input type="checkbox"/> Registered <input type="checkbox"/> Return Receipt for Merchandise <input type="checkbox"/> Insured Mail <input checked="" type="checkbox"/> C.O.D. <p>4. Restricted Delivery? (Extra Fee) <input checked="" type="checkbox"/> Yes</p>
2. Article Number (Transfer from service label)	7005 1160 0005 4137 5171 Domestic Return Receipt

PUBLIC NOTICE

TO: Tommy & Emma Whaley Phillips
 153 Barreb River Blvd.
 Georgetown, Kentucky 40324

Bluegrass Wireless LLC, is applying to the Public Service Commission of Kentucky for a Certificate of Public Convenience and Necessity for construction and operation as a new cell facility to provide cellular radio service. The facility would include a 240 foot tower to be located at 362 Race Track Road, Burnside, Kentucky, 42519. A map showing the location is attached. This notice is being sent to you because you either own property and/or reside on property that is located within a 500 ft. radius of the proposed tower or you own property contiguous to the property where the proposed tower will be located.

The Commission invites your comments regarding the utilities' proposed construction. Also, the Commission wants you to be aware of your right to intervene in this matter. Your comments and request for intervention should be addressed to:

**Executive Director's Office
 Public Service Commission of Kentucky
 P.O. Box 615
 Frankfort, Kentucky 40602**

Please refer to case number 2005-00282 in your correspondence.

SENDER: COMPLETE THIS SECTION	COMPLETE THIS SECTION ON DELIVERY
<ul style="list-style-type: none"> ■ Complete items 1, 2, and 3. Also complete item 4 if Restricted Delivery is desired. ■ Print your name and address on the reverse so that we can return the card to you. ■ Attach this card to the back of the mailpiece, or on the front if space permits. <p>1. Article Addressed to:</p> <p style="font-size: 1.2em; margin-left: 20px;">Tommy & Emma Whaley Phillips 153 Barreb River Blvd. Georgetown, KY 40324</p>	<p>A. Signature <input checked="" type="checkbox"/> Agent <input type="checkbox"/> Addressee</p> <p>X <i>Tom Phillips</i></p> <p>B. Received by (Printed Name) C. Date of Delivery</p> <p>Josh Phillips</p> <p>D. Is delivery address different from item 1? <input type="checkbox"/> Yes If YES, enter delivery address below: <input type="checkbox"/> No</p> <div style="text-align: center; border: 1px solid black; border-radius: 50%; width: 80px; margin: 10px auto; padding: 5px;"> 2005 40324 USPS </div> <p>3. Service Type</p> <p><input checked="" type="checkbox"/> Certified Mail <input type="checkbox"/> Express Mail <input type="checkbox"/> Registered <input type="checkbox"/> Return Receipt for Merchandise <input type="checkbox"/> Insured Mail <input type="checkbox"/> C.O.D.</p> <p>4. Restricted Delivery? (Extra Fee) <input checked="" type="checkbox"/> Yes</p>
<p>2. Article Number 7005 1160 0005 4137 5157 (Transfer from service label)</p>	
<p>PS Form 3811, February 2004 Domestic Return Receipt 102595-02-M-1540</p>	

PUBLIC NOTICE

TO: Gerald W. & Louise Hogue
 103 Beachview Drive
 Burnside, Kentucky 42519

Bluegrass Wireless LLC, is applying to the Public Service Commission of Kentucky for a Certificate of Public Convenience and Necessity for construction and operation as a new cell facility to provide cellular radio service. The facility would include a 240 foot tower to be located at 362 Race Track Road, Burnside, Kentucky, 42519. A map showing the location is attached. This notice is being sent to you because you either own property and/or reside on property that is located within a 500 ft. radius of the proposed tower or you own property contiguous to the property where the proposed tower will be located.

The Commission invites your comments regarding the utilities' proposed construction. Also, the Commission wants you to be aware of your right to intervene in this matter. Your comments and request for intervention should be addressed to:

**Executive Director's Office
 Public Service Commission of Kentucky
 P.O. Box 615
 Frankfort, Kentucky 40602**

Please refer to case number 2005-00282 in your correspondence.

SENDER: COMPLETE THIS SECTION	COMPLETE THIS SECTION ON DELIVERY
<ul style="list-style-type: none"> ■ Complete items 1, 2, and 3. Also complete item 4 if Restricted Delivery is desired. ■ Print your name and address on the reverse so that we can return the card to you. ■ Attach this card to the back of the mailpiece, or on the front if space permits. <p>1. Article Addressed to:</p> <p style="font-size: 1.2em; margin-left: 20px;">Gerald W. & Louise Hogue 103 Beachview Drive Burnside, KY 42519</p>	<p>A. Signature X <i>Gerald W. Hogue</i> <input checked="" type="checkbox"/> Agent <input type="checkbox"/> Addressee</p> <p>B. Received by (Printed Name) GERALD W. HOGUE</p> <p>C. Date of Delivery 9-21-05</p> <p>D. Is delivery address different from item 1? <input type="checkbox"/> Yes If YES, enter delivery address below: <input checked="" type="checkbox"/> No</p>
	<p>3. Service Type</p> <p><input checked="" type="checkbox"/> Certified Mail <input type="checkbox"/> Express Mail <input type="checkbox"/> Registered <input type="checkbox"/> Return Receipt for Merchandise <input type="checkbox"/> Insured Mail <input type="checkbox"/> C.O.D.</p>
	<p>4. Restricted Delivery? (Extra Fee) <input checked="" type="checkbox"/> Yes</p>
<p>2. Article Number (Transfer from service label)</p>	<p>7005 1160 0005 4137 5188</p>
<p>PS Form 3811, February 2004</p>	<p>Domestic Return Receipt 102595-02-M-1540</p>

PUBLIC NOTICE

TO: Lisha Southerland
P.O. Box 1388
Burnside, Kentucky 42519

Bluegrass Wireless LLC, is applying to the Public Service Commission of Kentucky for a Certificate of Public Convenience and Necessity for construction and operation as a new cell facility to provide cellular radio service. The facility would include a 240 foot tower to be located at 362 Race Track Road, Burnside, Kentucky, 42519. A map showing the location is attached. This notice is being sent to you because you either own property and/or reside on property that is located within a 500 ft. radius of the proposed tower or you own property contiguous to the property where the proposed tower will be located.

The Commission invites your comments regarding the utilities' proposed construction. Also, the Commission wants you to be aware of your right to intervene in this matter. Your comments and request for intervention should be addressed to:

**Executive Director's Office
Public Service Commission of Kentucky
P.O. Box 615
Frankfort, Kentucky 40602**

Please refer to case number 2005-00282 in your correspondence.



[Track & Confirm](#)

[FAQs](#)

Track & Confirm

Search Results

Label/Receipt Number: **ER28 9497 301U S**
Status: **Delivered**

Your item was delivered at 12:25 pm on September 19, 2005 in BURNSIDE, KY 42519. The item was signed for by R NEW.

[Additional Details >](#)

[Return to USPS.com Home >](#)

Track & Confirm

Enter Label/Receipt Number.

[Go >](#)

Notification Options

Track & Confirm by email

Get current event information or updates for your item sent to you or others by email. [Go >](#)

Proof of Delivery

Verify who signed for your item by email, fax, or mail. [Go >](#)



POSTAL INSPECTORS
Preserving the Trust

[site map](#)

[contact us](#) [government services](#) [jobs](#) [National & Premier Accounts](#)
Copyright © 1999-2004 USPS. All Rights Reserved. [Terms of Use](#) [Privacy Policy](#)





Track & Confirm

Search Results

Label/Receipt Number: ER28 9497 301U S
Detailed Results:

- Delivered, September 19, 2005, 12:25 pm, BURNSIDE, KY 42519
- Notice Left, September 19, 2005, 10:23 am, BURNSIDE, KY 42519
- Notice Left, September 17, 2005, 6:53 am, BURNSIDE, KY 42519
- Arrival at Pick-Up-Point, September 17, 2005, 6:52 am, BURNSIDE, KY 42519
- Arrival at Unit, September 17, 2005, 6:52 am, BURNSIDE, KY 42519
- Enroute, September 17, 2005, 4:34 am, SOMERSET, KY 42501
- Enroute, September 16, 2005, 6:54 pm, LOUISVILLE, KY 40231
- Acceptance, September 16, 2005, 3:44 pm, LOUISVILLE, KY 40270

[< Back](#)

[Return to USPS.com Home >](#)

Track & Confirm

Enter Label/Receipt Number.

[Go >](#)

Notification Options

Track & Confirm by email

Get current event information or updates for your item sent to you or others by email. [Go >](#)

Proof of Delivery

Verify who signed for your item by email, fax, or mail. [Go >](#)



POSTAL INSPECTORS
Preserving the Trust

[site map](#)

[contact us](#) [government services](#) [jobs](#) [National & Premier Accounts](#)
Copyright © 1999-2004 USPS. All Rights Reserved. [Terms of Use](#) [Privacy Policy](#)



PUBLIC NOTICE

TO: Harold Lee Hardgrove
P.O. Box 1089
Burnside, Kentucky 42519

Bluegrass Wireless LLC, is applying to the Public Service Commission of Kentucky for a Certificate of Public Convenience and Necessity for construction and operation as a new cell facility to provide cellular radio service. The facility would include a 240 foot tower to be located at 362 Race Track Road, Burnside, Kentucky, 42519. A map showing the location is attached. This notice is being sent to you because you either own property and/or reside on property that is located within a 500 ft. radius of the proposed tower or you own property contiguous to the property where the proposed tower will be located.

The Commission invites your comments regarding the utilities' proposed construction. Also, the Commission wants you to be aware of your right to intervene in this matter. Your comments and request for intervention should be addressed to:

**Executive Director's Office
Public Service Commission of Kentucky
P.O. Box 615
Frankfort, Kentucky 40602**

Please refer to case number 2005-00282 in your correspondence.



[Track & Confirm](#)

[FAQs](#)

Track & Confirm

Search Results

Label/Receipt Number: **ER28 3587 984U S**
Status: **Delivered**

Your item was delivered at 12:05 pm on September 20, 2005 in BURNSIDE, KY 42519. The item was signed for by H HARDGROVE.

Track & Confirm

Enter Label/Receipt Number.

[Go >](#)

[Additional Details >](#)

[Return to USPS.com Home >](#)

Notification Options

Track & Confirm by email

Get current event information or updates for your item sent to you or others by email. [Go >](#)

Proof of Delivery

Verify who signed for your item by email, fax, or mail. [Go >](#)



POSTAL INSPECTORS
Preserving the Trust

[site map](#)

[contact us](#) [government services](#) [jobs](#) [National & Premier Accounts](#)
Copyright © 1999-2004 USPS. All Rights Reserved. [Terms of Use](#) [Privacy Policy](#)





[Track & Confirm](#)

[FAQs](#)

Track & Confirm

Search Results

Label/Receipt Number: ER28 3587 984U S
Detailed Results:

- Delivered, September 20, 2005, 12:05 pm, BURNSIDE, KY 42519
- Notice Left, September 19, 2005, 10:23 am, BURNSIDE, KY 42519
- Notice Left, September 17, 2005, 6:53 am, BURNSIDE, KY 42519
- Arrival at Pick-Up-Point, September 17, 2005, 6:52 am, BURNSIDE, KY 42519
- Arrival at Unit, September 17, 2005, 6:52 am, BURNSIDE, KY 42519
- Enroute, September 17, 2005, 4:34 am, SOMERSET, KY 42501
- Enroute, September 16, 2005, 6:54 pm, LOUISVILLE, KY 40231
- Acceptance, September 16, 2005, 3:46 pm, LOUISVILLE, KY 40270

[< Back](#)

[Return to USPS.com Home >](#)

Track & Confirm

Enter Label/Receipt Number.

[Go >](#)

Notification Options

Track & Confirm by email

Get current event information or updates for your item sent to you or others by email. [Go >](#)

Proof of Delivery

Verify who signed for your item by email, fax, or mail. [Go >](#)



POSTAL INSPECTORS
Preserving the Trust

[site map](#)

[contact us](#) [government services](#) [jobs](#) [National & Premier Accounts](#)
Copyright © 1999-2004 USPS. All Rights Reserved. [Terms of Use](#) [Privacy Policy](#)



PUBLIC NOTICE

TO: Kingsford Manufacturing Co.
P.O. Box 24305
Oakland, California 94623

Bluegrass Wireless LLC, is applying to the Public Service Commission of Kentucky for a Certificate of Public Convenience and Necessity for construction and operation as a new cell facility to provide cellular radio service. The facility would include a 240 foot tower to be located at 362 Race Track Road, Burnside, Kentucky, 42519. A map showing the location is attached. This notice is being sent to you because you either own property and/or reside on property that is located within a 500 ft. radius of the proposed tower or you own property contiguous to the property where the proposed tower will be located.

The Commission invites your comments regarding the utilities' proposed construction. Also, the Commission wants you to be aware of your right to intervene in this matter. Your comments and request for intervention should be addressed to:

**Executive Director's Office
Public Service Commission of Kentucky
P.O. Box 615
Frankfort, Kentucky 40602**

Please refer to case number 2005-00282 in your correspondence.



[Track & Confirm](#)

[FAQs](#)

Track & Confirm

Search Results

Label/Receipt Number: **ER28 9497 329U S**
Status: **Delivered**

Your item was delivered at 9:14 am on September 19, 2005 in OAKLAND, CA 94623. The item was signed for by M L.

Track & Confirm

Enter Label/Receipt Number.

[Go >](#)

[Additional Details >](#)

[Return to USPS.com Home >](#)

Notification Options

Track & Confirm by email

Get current event information or updates for your item sent to you or others by email. [Go >](#)

Proof of Delivery

Verify who signed for your item by email, fax, or mail. [Go >](#)



POSTAL INSPECTORS
Preserving the Trust

[site map](#)

[contact us](#) [government services](#) [jobs](#) [National & Premier Accounts](#)
Copyright © 1999-2004 USPS. All Rights Reserved. [Terms of Use](#) [Privacy Policy](#)





Track & Confirm

Search Results

Label/Receipt Number: ER28 9497 329U S
Detailed Results:

- Delivered, September 19, 2005, 9:14 am, OAKLAND, CA 94623
- Arrival at Pick-Up-Point, September 17, 2005, 8:10 am, OAKLAND, CA 94623
- Arrival at Unit, September 17, 2005, 8:09 am, OAKLAND, CA 94615
- Enroute, September 17, 2005, 7:01 am, OAKLAND, CA 94615
- Enroute, September 16, 2005, 6:54 pm, LOUISVILLE, KY 40231
- Acceptance, September 16, 2005, 3:45 pm, LOUISVILLE, KY 40270

[< Back](#)

[Return to USPS.com Home >](#)

Track & Confirm

Enter Label/Receipt Number.

[Go >](#)

Notification Options

Track & Confirm by email

Get current event information or updates for your item sent to you or others by email. [Go >](#)

Proof of Delivery

Verify who signed for your item by email, fax, or mail. [Go >](#)



POSTAL INSPECTORS
Preserving the Trust

[site map](#)

[contact us](#)

[government services](#)

[jobs](#)

[National & Premier Accounts](#)

Copyright © 1999-2004 USPS. All Rights Reserved. [Terms of Use](#) [Privacy Policy](#)



PUBLIC NOTICE

TO: Jason Ray Casada
P.O. Box 382
Burnside, Kentucky 42519

Bluegrass Wireless LLC, is applying to the Public Service Commission of Kentucky for a Certificate of Public Convenience and Necessity for construction and operation as a new cell facility to provide cellular radio service. The facility would include a 240 foot tower to be located at 362 Race Track Road, Burnside, Kentucky, 42519. A map showing the location is attached. This notice is being sent to you because you either own property and/or reside on property that is located within a 500 ft. radius of the proposed tower or you own property contiguous to the property where the proposed tower will be located.

The Commission invites your comments regarding the utilities' proposed construction. Also, the Commission wants you to be aware of your right to intervene in this matter. Your comments and request for intervention should be addressed to:

**Executive Director's Office
Public Service Commission of Kentucky
P.O. Box 615
Frankfort, Kentucky 40602**

Please refer to case number 2005-00282 in your correspondence.



[Track & Confirm](#)

[FAQs](#)

Track & Confirm

Search Results

Label/Receipt Number: **ER28 9497 292U S**
Status: **Delivered**

Your item was delivered at 2:13 pm on September 19, 2005 in BURNSIDE, KY 42519. The item was signed for by C SELLERS.

Track & Confirm

Enter Label/Receipt Number.

[Go >](#)

[Additional Details >](#)

[Return to USPS.com Home >](#)

Notification Options

Track & Confirm by email

Get current event information or updates for your item sent to you or others by email. [Go >](#)

Proof of Delivery

Verify who signed for your item by email, fax, or mail. [Go >](#)



POSTAL INSPECTORS
Preserving the Trust

[site map](#)

[contact us](#)

[government services](#)

[jobs](#)

[National & Premier Accounts](#)

Copyright © 1999-2004 USPS. All Rights Reserved. [Terms of Use](#) [Privacy Policy](#)





Track & Confirm

Search Results

Label/Receipt Number: ER28 9497 292U S
Detailed Results:

- Delivered, September 19, 2005, 2:13 pm, BURNSIDE, KY 42519
- Notice Left, September 19, 2005, 10:23 am, BURNSIDE, KY 42519
- Notice Left, September 17, 2005, 6:53 am, BURNSIDE, KY 42519
- Arrival at Pick-Up-Point, September 17, 2005, 6:52 am, BURNSIDE, KY 42519
- Arrival at Unit, September 17, 2005, 6:52 am, BURNSIDE, KY 42519
- Enroute, September 17, 2005, 4:34 am, SOMERSET, KY 42501
- Enroute, September 16, 2005, 6:54 pm, LOUISVILLE, KY 40231
- Acceptance, September 16, 2005, 3:42 pm, LOUISVILLE, KY 40270

[< Back](#)

[Return to USPS.com Home >](#)

Track & Confirm

Enter Label/Receipt Number

[Go >](#)

Notification Options

Track & Confirm by email

Get current event information or updates for your item sent to you or others by email. [Go >](#)

Proof of Delivery

Verify who signed for your item by email, fax, or mail. [Go >](#)



POSTAL INSPECTORS
Preserving the Trust

[site map](#)

[contact us](#) [government services](#) [jobs](#) [National & Premier Accounts](#)
Copyright © 1999-2004 USPS. All Rights Reserved. [Terms of Use](#) [Privacy Policy](#)



PUBLIC NOTICE

TO: William J., Karen & Gerald Hogue
P.O. Box 537
Burnside, Kentucky 42519

Bluegrass Wireless LLC, is applying to the Public Service Commission of Kentucky for a Certificate of Public Convenience and Necessity for construction and operation as a new cell facility to provide cellular radio service. The facility would include a 240 foot tower to be located at 362 Race Track Road, Burnside, Kentucky, 42519. A map showing the location is attached. This notice is being sent to you because you either own property and/or reside on property that is located within a 500 ft. radius of the proposed tower or you own property contiguous to the property where the proposed tower will be located.

The Commission invites your comments regarding the utilities' proposed construction. Also, the Commission wants you to be aware of your right to intervene in this matter. Your comments and request for intervention should be addressed to:

**Executive Director's Office
Public Service Commission of Kentucky
P.O. Box 615
Frankfort, Kentucky 40602**

Please refer to case number 2005-00282 in your correspondence.



Track & Confirm

Search Results

Label/Receipt Number: **ER28 9497 289U S**
Status: **Delivered**

Your item was delivered at 12:54 pm on September 20, 2005 in BURNSIDE, KY 42519. The item was signed for by L HOGUE.

Track & Confirm

Enter Label/Receipt Number.

[Go >](#)

[Additional Details >](#)

[Return to USPS.com Home >](#)

Notification Options

Track & Confirm by email

Get current event information or updates for your item sent to you or others by email. [Go >](#)

Proof of Delivery

Verify who signed for your item by email, fax, or mail. [Go >](#)



POSTAL INSPECTORS
Preserving the Trust

[site map](#)

[contact us](#) [government services](#) [jobs](#) [National & Premier Accounts](#)
Copyright © 1999-2004 USPS. All Rights Reserved. [Terms of Use](#) [Privacy Policy](#)





Track & Confirm

Search Results

Label/Receipt Number: ER28 9497 289U S
Detailed Results:

- Delivered, September 20, 2005, 12:54 pm, BURNSIDE, KY 42519
- Notice Left, September 19, 2005, 10:23 am, BURNSIDE, KY 42519
- Notice Left, September 17, 2005, 6:53 am, BURNSIDE, KY 42519
- Arrival at Pick-Up-Point, September 17, 2005, 6:52 am, BURNSIDE, KY 42519
- Arrival at Unit, September 17, 2005, 6:52 am, BURNSIDE, KY 42519
- Enroute, September 17, 2005, 4:34 am, SOMERSET, KY 42501
- Enroute, September 16, 2005, 6:54 pm, LOUISVILLE, KY 40231
- Acceptance, September 16, 2005, 3:40 pm, LOUISVILLE, KY 40270

[< Back](#)

[Return to USPS.com Home >](#)

Track & Confirm

Enter Label/Receipt Number.

[Go >](#)

Notification Options

Track & Confirm by email

Get current event information or updates for your item sent to you or others by email. [Go >](#)

Proof of Delivery

Verify who signed for your item by email, fax, or mail. [Go >](#)



POSTAL INSPECTORS
Preserving the Trust

[site map](#)

[contact us](#)

[government services](#)

[jobs](#)

[National & Premier Accounts](#)

Copyright © 1999-2004 USPS. All Rights Reserved. [Terms of Use](#) [Privacy Policy](#)



PUBLIC NOTICE

TO: Willard E. & Wanda Lowery
P.O. Box 684
Burnside, Kentucky 42519

Bluegrass Wireless LLC, is applying to the Public Service Commission of Kentucky for a Certificate of Public Convenience and Necessity for construction and operation as a new cell facility to provide cellular radio service. The facility would include a 240 foot tower to be located at 362 Race Track Road, Burnside, Kentucky, 42519. A map showing the location is attached. This notice is being sent to you because you either own property and/or reside on property that is located within a 500 ft. radius of the proposed tower or you own property contiguous to the property where the proposed tower will be located.

The Commission invites your comments regarding the utilities' proposed construction. Also, the Commission wants you to be aware of your right to intervene in this matter. Your comments and request for intervention should be addressed to:

**Executive Director's Office
Public Service Commission of Kentucky
P.O. Box 615
Frankfort, Kentucky 40602**

Please refer to case number 2005-00282 in your correspondence.



Track & Confirm

Search Results

Label/Receipt Number: **ER28 9497 275U S**
Status: **Delivered**

Your item was delivered at 10:25 am on September 19, 2005 in BURNSIDE, KY 42519. The item was signed for by W LOWERY.

[Additional Details >](#)

[Return to USPS.com Home >](#)

Track & Confirm

Enter Label/Receipt Number

[Go >](#)

Notification Options

Track & Confirm by email

Get current event information or updates for your item sent to you or others by email. [Go >](#)

Proof of Delivery

Verify who signed for your item by email, fax, or mail. [Go >](#)



POSTAL INSPECTORS
Preserving the Trust

[site map](#)

[contact us](#)

[government services](#)

[jobs](#)

[National & Premier Accounts](#)

Copyright © 1999-2004 USPS. All Rights Reserved. [Terms of Use](#) [Privacy Policy](#)



Track & Confirm

Search Results

Label/Receipt Number: ER28 9497 275U S
Detailed Results:

- Delivered, September 19, 2005, 10:25 am, BURNSIDE, KY 42519
- Notice Left, September 19, 2005, 10:23 am, BURNSIDE, KY 42519
- Notice Left, September 17, 2005, 6:53 am, BURNSIDE, KY 42519
- Arrival at Pick-Up-Point, September 17, 2005, 6:52 am, BURNSIDE, KY 42519
- Arrival at Unit, September 17, 2005, 6:52 am, BURNSIDE, KY 42519
- Enroute, September 17, 2005, 4:34 am, SOMERSET, KY 42501
- Enroute, September 16, 2005, 6:54 pm, LOUISVILLE, KY 40231
- Acceptance, September 16, 2005, 3:39 pm, LOUISVILLE, KY 40270

[< Back](#)

[Return to USPS.com Home >](#)

Track & Confirm

Enter Label/Receipt Number

[Go >](#)

Notification Options

Track & Confirm by email

Get current event information or updates for your item sent to you or others by email. [Go >](#)

Proof of Delivery

Verify who signed for your item by email, fax, or mail. [Go >](#)



POSTAL INSPECTORS
Preserving the Trust

[site map](#)

[contact us](#)

[government services](#)

[jobs](#)

[National & Premier Accounts](#)

Copyright © 1999-2004 USPS. All Rights Reserved. [Terms of Use](#) [Privacy Policy](#)

PUBLIC NOTICE

TO: Brian Keith & Donna Phillips
P.O. Box 1149
Burnside, Kentucky 42519

Bluegrass Wireless LLC, is applying to the Public Service Commission of Kentucky for a Certificate of Public Convenience and Necessity for construction and operation as a new cell facility to provide cellular radio service. The facility would include a 240 foot tower to be located at 362 Race Track Road, Burnside, Kentucky, 42519. A map showing the location is attached. This notice is being sent to you because you either own property and/or reside on property that is located within a 500 ft. radius of the proposed tower or you own property contiguous to the property where the proposed tower will be located.

The Commission invites your comments regarding the utilities' proposed construction. Also, the Commission wants you to be aware of your right to intervene in this matter. Your comments and request for intervention should be addressed to:

**Executive Director's Office
Public Service Commission of Kentucky
P.O. Box 615
Frankfort, Kentucky 40602**

Please refer to case number 2005-00282 in your correspondence.



[Track & Confirm](#)

[FAQs](#)

Track & Confirm

Search Results

Label/Receipt Number: **ER28 9497 350U S**
Status: **Delivered**

Your item was delivered at 11:12 am on September 17, 2005 in BURNSIDE, KY 42519. The item was signed for by D PHILLIPS.

Track & Confirm

Enter Label/Receipt Number.

[Go >](#)

[Additional Details >](#)

[Return to USPS.com Home >](#)

Notification Options

Track & Confirm by email

Get current event information or updates for your item sent to you or others by email. [Go >](#)

Proof of Delivery

Verify who signed for your item by email, fax, or mail. [Go >](#)



POSTAL INSPECTORS
Preserving the Trust

[site map](#)

[contact us](#) [government services](#) [jobs](#) [National & Premier Accounts](#)
Copyright © 1999-2004 USPS. All Rights Reserved. [Terms of Use](#) [Privacy Policy](#)



Track & Confirm

Search Results

Label/Receipt Number: ER28 9497 350U S

Detailed Results:

- Delivered, September 17, 2005, 11:12 am, BURNSIDE, KY 42519
- Notice Left, September 17, 2005, 6:53 am, BURNSIDE, KY 42519
- Arrival at Pick-Up-Point, September 17, 2005, 6:52 am, BURNSIDE, KY 42519
- Arrival at Unit, September 17, 2005, 6:52 am, BURNSIDE, KY 42519
- Enroute, September 17, 2005, 4:34 am, SOMERSET, KY 42501
- Enroute, September 16, 2005, 6:54 pm, LOUISVILLE, KY 40231
- Acceptance, September 16, 2005, 3:38 pm, LOUISVILLE, KY 40270

[< Back](#)

[Return to USPS.com Home >](#)

Track & Confirm

Enter Label/Receipt Number.

[Go >](#)

Notification Options

Track & Confirm by email

Get current event information or updates for your item sent to you or others by email. [Go >](#)

Proof of Delivery

Verify who signed for your item by email, fax, or mail. [Go >](#)



POSTAL INSPECTORS
Preserving the Trust

[site map](#)

[contact us](#)

[government services](#)

[jobs](#)

[National & Premier Accounts](#)

Copyright © 1999-2004 USPS. All Rights Reserved. [Terms of Use](#) [Privacy Policy](#)



PUBLIC NOTICE

TO: Judy R. Eaton
P.O. Box 3516
Somerset, Kentucky 42502

Bluegrass Wireless LLC, is applying to the Public Service Commission of Kentucky for a Certificate of Public Convenience and Necessity for construction and operation as a new cell facility to provide cellular radio service. The facility would include a 240 foot tower to be located at 362 Race Track Road, Burnside, Kentucky, 42519. A map showing the location is attached. This notice is being sent to you because you either own property and/or reside on property that is located within a 500 ft. radius of the proposed tower or you own property contiguous to the property where the proposed tower will be located.

The Commission invites your comments regarding the utilities' proposed construction. Also, the Commission wants you to be aware of your right to intervene in this matter. Your comments and request for intervention should be addressed to:

**Executive Director's Office
Public Service Commission of Kentucky
P.O. Box 615
Frankfort, Kentucky 40602**

Please refer to case number 2005-00282 in your correspondence.



[Track & Confirm](#)

[FAQs](#)

Track & Confirm

Search Results

Label/Receipt Number: **ER28 9497 332U S**
Status: **Delivered**

Your item was delivered at 12:52 pm on September 19, 2005 in SOMERSET, KY 42501. The item was signed for by B CARENDER.

Track & Confirm

Enter Label/Receipt Number.

[Go >](#)

[Additional Details >](#)

[Return to USPS.com Home >](#)

Notification Options

Track & Confirm by email

Get current event information or updates for your item sent to you or others by email. [Go >](#)

Proof of Delivery

Verify who signed for your item by email, fax, or mail. [Go >](#)



POSTAL INSPECTORS
Preserving the Trust

[site map](#)

[contact us](#)

[government services](#)

[jobs](#)

[National & Premier Accounts](#)

Copyright © 1999-2004 USPS. All Rights Reserved. [Terms of Use](#) [Privacy Policy](#)



[Track & Confirm](#)

[FAQs](#)

Track & Confirm

Search Results

Label/Receipt Number: ER28 9497 332U S

Detailed Results:

- Delivered, September 19, 2005, 12:52 pm, SOMERSET, KY 42501
- Notice Left, September 19, 2005, 10:10 am, WEST SOMERSET, KY 42564
- Notice Left, September 17, 2005, 5:19 am, WEST SOMERSET, KY 42564
- Arrival at Unit, September 17, 2005, 5:18 am, SOMERSET, KY 42503
- Enroute, September 17, 2005, 4:34 am, SOMERSET, KY 42501
- Enroute, September 16, 2005, 6:54 pm, LOUISVILLE, KY 40231
- Acceptance, September 16, 2005, 3:37 pm, LOUISVILLE, KY 40270

[< Back](#)

[Return to USPS.com Home >](#)

Track & Confirm

Enter Label/Receipt Number.

[Go >](#)

Notification Options

Track & Confirm by email

Get current event information or updates for your item sent to you or others by email. [Go >](#)

Proof of Delivery

Verify who signed for your item by email, fax, or mail. [Go >](#)



POSTAL INSPECTORS
Preserving the Trust

[site map](#)

[contact us](#) [government services](#) [jobs](#) [National & Premier Accounts](#)
Copyright © 1999-2004 USPS. All Rights Reserved. [Terms of Use](#) [Privacy Policy](#)



Dinsmore & Shohl LLP
ATTORNEYS

Kerry W. Ingle
(502) 540-2354 (Direct Dial)
kerry.ingle@dinslaw.com

August 1, 2005

Via Certified Mail

Honorable Darrell BeShears
Pulaski County Judge Executive
Courthouse
100 North Main Street
Somerset, Kentucky 42501

RE: Public Notice - Public Service Commission of Kentucky
Case No. 2005-00282

Bluegrass Wireless LLC is applying to the Public Service Commission of Kentucky (the Commission") for a Certificate of Public Convenience and Necessity to propose construction and operation for a new facility to provide cellular radio telecommunications service in rural service area (RSA) #6 in Pulaski County. The facility will include a 240 ft. tower and an equipment shelter to be located at 362 Race Track road, Burnside, Kentucky, 42519. A map showing the location of the proposed new facility is enclosed.

The Commission invites your comments regarding the proposed construction. You also have the right to intervene in this matter.

Your comments and request for intervention should be addressed to: Executive Director's Office, Public Service Commission, P.O. Box 615, Frankfort, Kentucky 40602. Please refer to case number 2005-00281 in your correspondence.

Very truly yours,

DINSMORE & SHOHL LLP

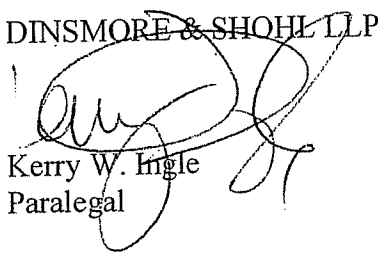
Kerry W. Ingle
Paralegal

enclosure

KWI

SENDER: COMPLETE THIS SECTION

- Complete items 1, 2, and 3. Also complete item 4 if Restricted Delivery is desired.
- Print your name and address on the reverse so that we can return the card to you.
- Attach this card to the back of the mailpiece, or on the front if space permits.

1. Article Addressed to:

Honorable Darrell BeShears
Pulaski County Judge Executive
100 N. Main St.
Somerset, KY 42501

COMPLETE THIS SECTION ON DELIVERY

A. Signature Agent
 USA Childcare Addressee

B. Received by (Printed Name) C. Date of Delivery
USA Childcare *8/26/05*

D. Is delivery address different from item 1? Yes
If YES, enter delivery address below: No

3. Service Type

- Certified Mail Express Mail
- Registered Return Receipt for Merchandise
- Insured Mail C.O.D.

4. Restricted Delivery? (Extra Fee) Yes

2. Article Number

(Transfer from service label)

7004 2510 0002 1019 5214

AFFIDAVIT OF PUBLICATION

I, Jessica Mullins
of the Commonwealth Journal, a legal
newspaper holding a second-class mailing
permit, published daily except Saturdays in
Somerset, county of Pulaski, Commonwealth of
Kentucky, do swear and subscribe that the
attached proof of publication of a

legal notice, as required and prescribed by
KRS

paid advertisement

was published in said newspaper in the issue
of Sept 21 & 25

for which the sum of \$ 120.00
is due and payable.

Signed: Jessica Mullins

Title: Classified Ad Manager

Subscribed and sworn to before me, a notary
public for the County of Pulaski,
Commonwealth of Kentucky, this 3
day of October, 19 2005.

Brenda Hackney

My commission expires August 19, 2002

(SEAL)

NOTICE

Bluegrass Wireless LLC is applying to the Public Service Commission of Kentucky for a Certificate of Public Convenience and Necessity to construct and operate a new facility to provide cellular radio telecommunications service in rural service area #6 of the Commonwealth of Kentucky (Burnside Cell Site). The facility is a 240-foot tower and an equipment shelter to be located at 362 Race Track Road, Burnside, Kentucky 42519. Your comments and requests for intervention should be addressed to: Executive Director's Office, Public Service Commission, Post Office Box 615, 211 Sower Boulevard, Frankfort, Kentucky 40602. Please refer to Case No. 2005-00282 in your correspondence.

PUBLIC MEETING NOTICE

The Pulaski County Fiscal Court shall hereby give public notice that the Pulaski County Project Development Board (PDB) has been authorized and scheduled to begin Public meetings for the purpose of constructing a new Pulaski County Judicial Center. The meetings shall be scheduled as follows:

The inaugural meeting of the PDB shall be held October 3, 2005, at 4:00 p.m. at the Pulaski County Courthouse, in the Fiscal Courtroom.

A regular scheduled meeting date will be established at this inaugural meeting and publicly advertised.

These meetings shall be for the general purpose of conducting that general and specific business associated with the construction of the new Pulaski County Judicial Facility.

Special called meeting and/or hearings may be held by the Pulaski County Project Development Board as needed for project progress. Special called meeting and/or hearing dates shall require additional legal public notice prior to the event giving topic(s)/date/time/location of the meeting.

The General Public and/or those interested individuals are encouraged to attend and provide public input to the PDB.

Darrell BeShears
Pulaski County Judge/Executive

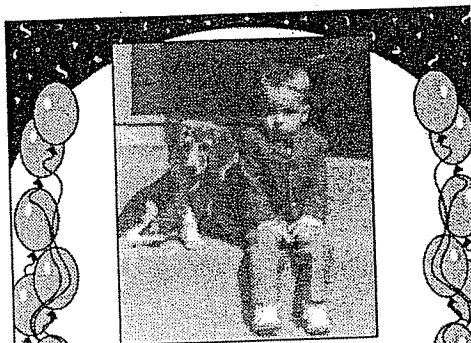

Lordy,

www.timnallelectronic.com

REES FLOORING

www.reesfloorcovering.com
www.mrwisebuys.com

COMMONWEALTH JOURNAL
www.somerset-kentucky.com

MCCREARY COUNTY RECORD
www.mccrearyrecord.com

K&T SAW SHOP & POWER EQUIPMENT
www.ktoutdoor.com

RENT A CENTER
www.rentacenter.com

HOBBY

KY EASELS
www.kyeasels.com

GOLF SHOP WAREHOUSE
www.golfshopwarehouse.com

NOT-FOR-PROFIT ORGANIZATIONS

AMERICAN CANCER SOCIETY
www.cancer.org

AMERICAN HEART ASSOCIATION
www.americanheart.org

AMERICAN RED CROSS
www.redcross.org

GOD'S FOOD PANTRY
www.godsfoodpantrysomerset.org

MARCH OF DIMES
www.modimes.org

SOMERSET-PULASKI HUMANE SOCIETY
www.bhumane.org

UNITED WAY
www.unitedway.org

PROFESSIONAL SERVICES

FIRST & FARMERS BANK
www.firstandfarmers.com

LIFE ABUNDANT MINISTRY
& HEALING ROOMS
www.lifeabundantministry.org

THE MEDICINE SHOPPE
www.medicineshoppe.com

REAL ESTATE

CENTURY 21 DE'JON PROPERTIES
www.2clakecumberland.com

RON JONES REALTY
www.ronjonesrealty.com

FORD BROTHERS
www.fordbrothersinc.com

ACTION REALTY
www.actionhouses.com

HOMECOURT REALTY
www.homecourtrealty.net

"THE E-Z WAY TO FIND YOUR NEW HOME"
www.HomeFinderZ.net

CORETRANS
www.coretrans.com

PULASKI COUNTY SCHOOLS
www.pulaski.net

To add your
business
or service
to this directory.

• At
40
Call Before
875

GL

DEEL
CLI
Larry
67

• Carpets • I
• Pick
• Orienta

COM
CLEAN

• Resi
&
FREE EST
45

CO

COM
CONC

• Detect Univ
• Monitor
Children
• Protect
• On-site I
Call I

606-

COM
RI

COI
Lea
606-

M
C
Ce
6'

High c
comput
spy ware
W

Conver

CON

SA
CONC

Re
Add
Ga

68

AD
REPAIR

'97 Yamaha Warrior 350
4-wheeler, good shape.
\$1400 firm. 561-5415 or
271-6519

2004 Pontoon
Starcraft 20' Fish, 40HP
Mercury 4 stroke w/ 2yr
warranty. Aluminum trailer.
Like new, less than 12 hrs.
\$12,900. Call 636-4141

'92 30ft 5thwheel camper
With slide, very good con-
dition. \$7000 423-2757

Boat For Sale
22 ft. Bayliner Cuddy Cab-
in sleeps 5. 165 HP V-8
engine w/ mercruiser O.D.
Convertible top side cur-
tains aft cover 2 mooring
covers excellent shape on
tandem axle trailer w/
brakes \$16,000. Please
call 1-606-679-4776

(606)305-7289

**2002 Honda Shadow
ACE.**
Cobra pipes, saddle bags,
sissy bar, hwy. bars, wind-
shield. \$5000. 676-9422

1985 Honda Rebel
250CC, low miles, \$1500.
Call 305-6025 or 305-2902

2003 RM 250
Dirt bike. Lots of new
parts, excellent condition.
\$3000 OBO. Call 875-
1337.

2005 Honda VTX.
1300 C, black, custom
seat, detachable sissy bar.
1700 miles, paid \$10,700,
must sell \$7700. (270)343-
2434

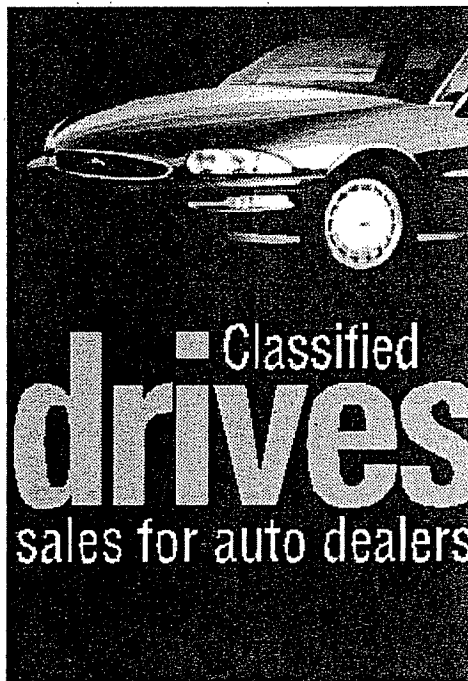

**Classified
drives
sales for auto dealers**

NOTICE

Bluegrass Wireless LLC is applying to the Public Service Commission of Kentucky for a Certificate of Public Convenience and Necessity to construct and operate a new facility to provide cellular radio telecommunications service in rural service area #6 of the Commonwealth of Kentucky (Burnside Cell Site). The facility is a 240-foot tower and an equipment shelter to be located at 362 Race Track Road, Burnside, Kentucky 42519. Your comments and requests for intervention should be addressed to: Executive Director's Office, Public Service Commission, Post Office Box 615, 211 Sower Boulevard, Frankfort, Kentucky 40602. Please refer to Case No. 2005-00282 in your correspondence.

HOBBY

KY EASELS
www.kyeasels.com
GOLF SHOP WAREHOUSE
www.golfshopwarehouse.com

NOT-FOR-PROFIT ORGANIZATIONS

AMERICAN CANCER SOCIETY
www.cancer.org
AMERICAN HEART ASSOCIATION
www.americanheart.org
AMERICAN RED CROSS
www.redcross.org
GOD'S FOOD PANTRY
www.godsfoodpantrysomerset.org
MARCH OF DIMES
www.modimes.org
SOMERSET-PULASKI HUMANE SOCIETY
www.bhumane.org
UNITED WAY
www.unitedway.org

PROFESSIONAL SERVICES

FIRST & FARMERS BANK
www.firstandfarmers.com
**LIFE ABUNDANT MINISTRY
& HEALING ROOMS**
www.lifeabundantministry.org
THE MEDICINE SHOPPE
www.medicineshoppe.com

REAL ESTATE

CENTURY 21 DE'JON PROPERTIES
www.2clakecumberland.com
RON JONES REALTY
www.ronjonesrealty.com
FORD BROTHERS
www.fordbrothersinc.com
ACTION REALTY
www.actionhouses.com
HEMOCOURT REALTY
www.homecourtrealty.net
"THE E-Z WAY TO FIND YOUR NEW HOME"
www.HomeFinderZ.net
CORETRANS
www.coretrans.com
PULASKI COUNTY SCHOOLS
www.pulaski.net

**To add your
business
or service
to this directory,
call
678-8191.**

• Carpet
• Pi
• Orier

**GOLF
GOLF**

Re

FREE ES
4

CO

**COM
CON**

• Detect Un
• Monitor
Children
• Protect
• On-site I
Call I

606-

**COM
RI**

USA

COM

Leas
606-(

**M
Co
Co
67**

High qu
computer
spy ware re
We c

Convenie

CONS

**SAV
CONSTR**

Ren
Additi
Gara
687

**ADV
Build/thing**

• Ac
• Decl
Remod
Free f
Office 3
Cell: 2

PUBLIC NOTICE

Bluegrass Wireless LLC
proposes to
construct a cellular
communications

TOWER

on this site. If you have any
questions please contact:

Bluegrass Wireless LLC
P.O. Box 5012
2502 Ring Road
Elizabethtown, KY 40120

Executive Director
Public Service Commission
211 South Boulevard
P.O. Box 615
Frankfort, KY 40602

Please refer to P.S.C.
Case #2005-00282
in your correspondence.

PUBLIC NOTICE

Bluegrass Wireless LLC
proposes to
construct a cellular
communications

TOWER

near this site. If you have any
questions please contact:

Bluegrass Wireless LLC
P.O. Box 5012
2502 Ring Road
Elizabethtown, KY 40120

Executive Director
Public Service Commission
211 South Boulevard
P.O. Box 615
Frankfort, KY 40602

Please refer to P.S.C.
Case #2005-00282
in your correspondence.

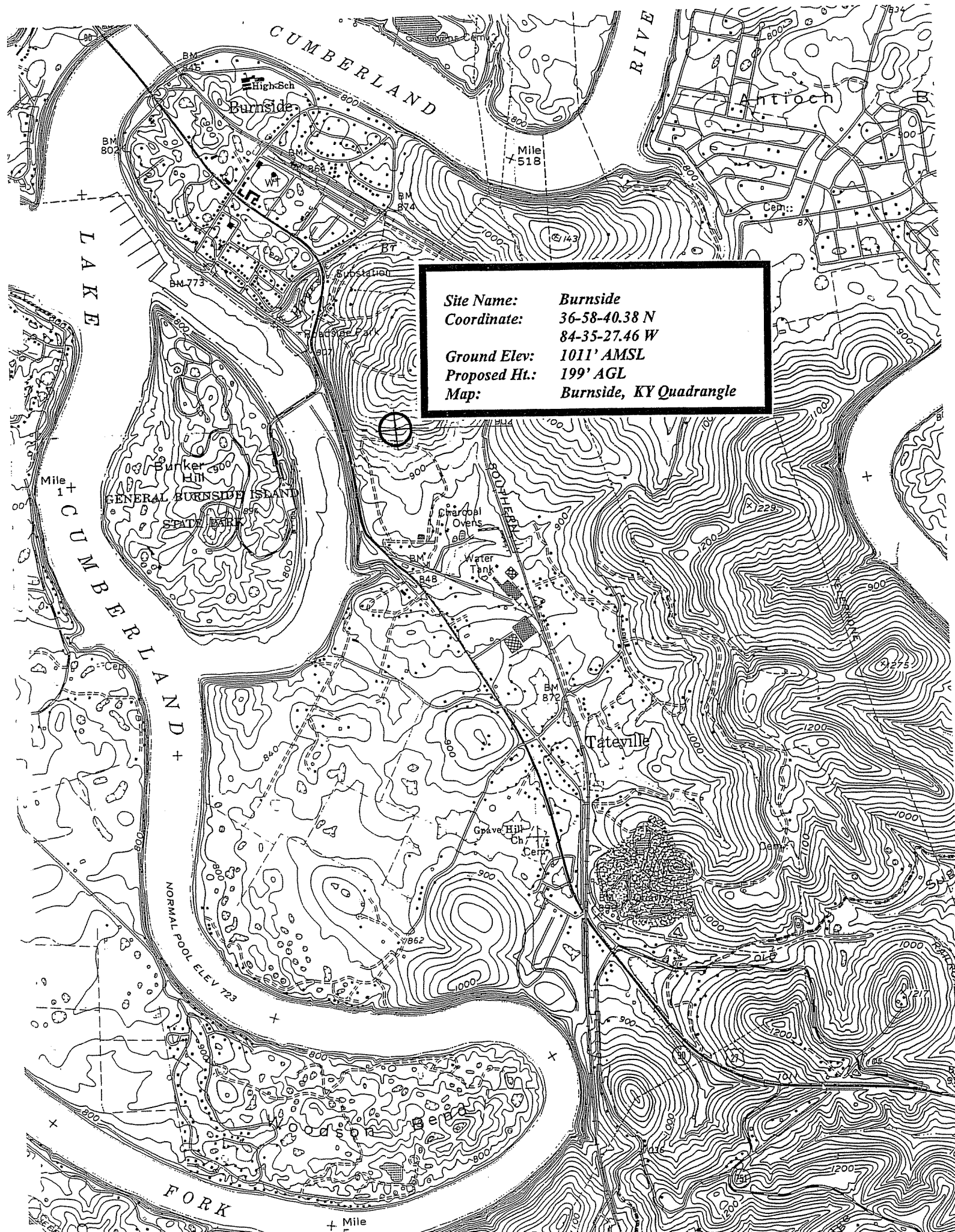

Site Name: Burnside
Coordinate: 36-58-40.38 N
84-35-27.46 W
Ground Elev: 1011' AMSL
Proposed Ht.: 199' AGL
Map: Burnside, KY Quadrangle

84°24'00"
37°21'00"

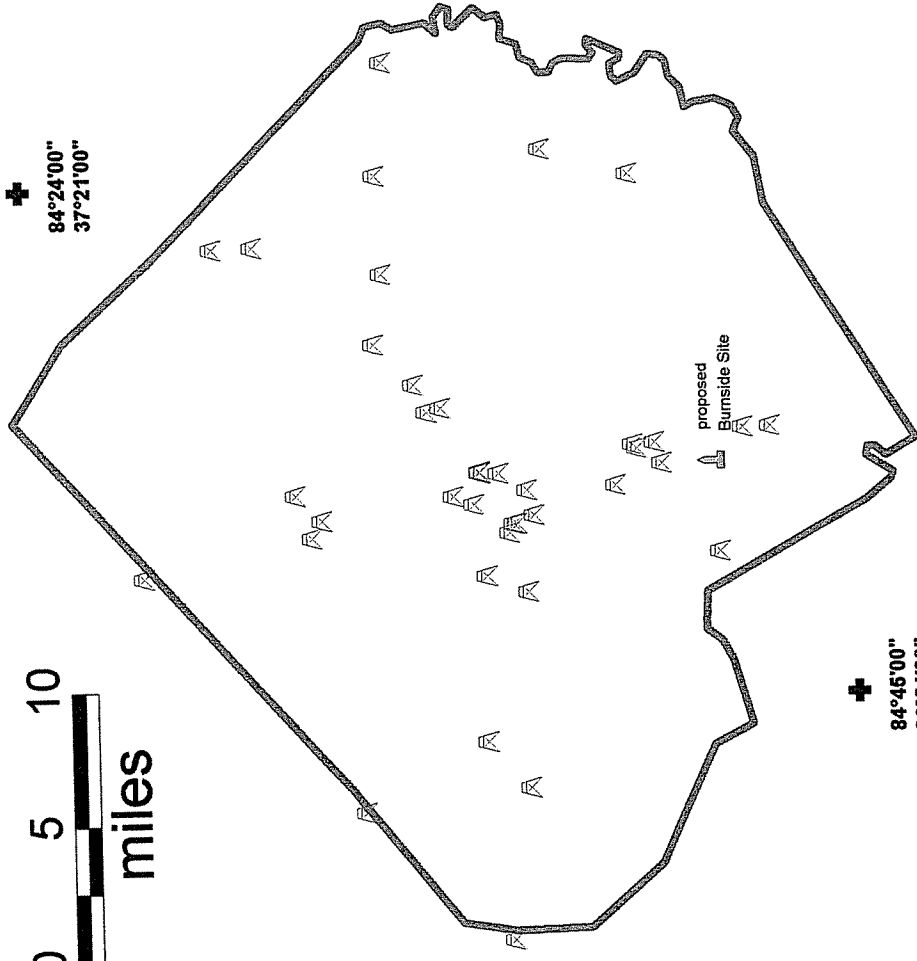
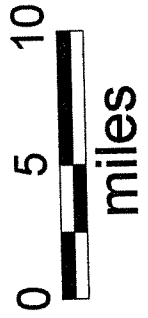

84°45'00"
36°54'00"

	Pulaski County Boundary
	Wireless Tower Locations Registered with the FCC
	Proposed BW Site
	Tick Marks

Prepared By: LINGS Engineering September 8, 2005

**Information on Towers Registered with the FCC
in Pulaski County and 1/2 Mile Area Outside of the County Boundary**

FCC Tower Reg. No.	North Latitude	West Longitude	City, State	Tower Owner
1044043	37-10-03 N	84-49-30 W	MINTONVILLE, KY	KENTUCKY AUTHORITY FOR EDUCATIONAL TELEVISION DBA = WKSO TV
1018905	37-14-47.9 N	84-26-28.5 W	SOMERSET, KY	Global Tower, LLC
1035924	37-05-00 N	84-37-52 W	SOMERSET, KY	NORFOLK SOUTHERN CORPORATION
1042206	37-08-17 N	84-32-08 W	SOMERSET, KY	Global Tower, LLC
1042811	37-05-06 N	84-37-52 W	SOMERSET, KY	Sprintcom, Inc.
1043118	37-04-41 N	84-40-39 W	SOMERSET, KY	First Radio Inc
1043456	37-04-03 N	84-22-37 W	MT VICTORY, KY	Fridley , John D
1043625	37-06-10 N	84-35-45 W	SOMERSET, KY	CELLULAR PHONE OF KENTUCKY DBA = RAMCELL
1043628	36-58-25 N	84-39-09 W	BURNSIDE, KY	CELLULAR PHONE OF KENTUCKY, INC. DBA = RAMCELL
1043674	37-07-03 N	84-36-42 W	SOMERSET, KY	Capstar Radio Operating Company
1043675	37-09-16 N	84-27-35 W	SHOPVILLE/STAB, KY	Capstar Radio Operating Company
1043676	37-01-46.6 N	84-36-22.9 W	BURNSIDE, KY	Capstar Radio Operating Company
1043677	36-57-38 N	84-34-07 W	TATEVILLE, KY	Capstar Radio Operating Company
1043977	37-01-05 N	84-34-54 W	BURNSIDE, KY	C&C TOWER RENTAL,LLC
1043979	37-06-12 N	84-35-43 W	SOMERSET, KY	Falcon Community Cable, LP, a Delaware Limited Partnership
1044514	37-00-30 N	84-34-40 W	BURNSIDE, KY	EAST KENTUCKY POWER COOPERATIVE, INC
1044771	37-05-15 N	84-38-14 W	SOMERSET, KY	CUMBERLAND COMMUNICATIONS INC DBA = WTLO RADIO
1044797	37-01-13 N	84-23-41 W	MOUNT VICTORY, KY	KENTUCKY, COMMONWEALTH OF DBA = KY EMERGENCY WARNING SYSTEM
1047763	37-17-09.6 N	84-39-48.6 W	EUBANKS, KY	Global Tower, LLC
1047989	37-06-10 N	84-35-45 W	SOMERSET, KY	DEAL, DOUG
1051877	37-07-52 N	84-33-15 W	SOMERSET, KY	Somerset Educational Broadcasting Foundation
1203424	37-04-42.3 N	84-48-36.8 W	Nancy, KY	Global Tower, LLC
1204492	37-06-22.2 N	84-37-02.7 W	Somerset, KY	Epperson Air Conditioning & Heating
1208691	37-04-40.4 N	84-36-30.8 W	SOMERSET, KY	Norfolk Southern Railway Company
1219832	37-05-35.3 N	84-35-47.8 W	Somerset, KY	Commonwealth of Kentucky
1229865	37-09-08.3 N	84-18-58.5 W	Somerset, KY	Global Tower LLC
1229869	37-11-39.7 N	84-38-18.2 W	Science Hill, KY	Global Tower LLC
1230075	37-12-11.1 N	84-36-34.1 W	Science Hill, KY	American Tower through UNIsite, Inc.
1230266	37-09-26.4 N	84-23-34.2 W	Somerset, KY	Global Tower LLC
1230432	37-09-33.8 N	84-30-27.8 W	SOMERSET, KY	C&C TOWER RENTAL LLC
1230577	37-04-26.3 N	84-37-31.2 W	Somerset, KY	SBA Properties, Inc.
1231891	37-05-59.8 N	84-39-58.6 W	SOMERSET, KY	HEMPHILL CORPORATION
1231893	37-07-24.5 N	84-33-06.1 W	SOMERSET, KY	HEMPHILL CORPORATION
1232264	37-05-19.7 N	84-54-47.3 W	RUSSELL SPRINGS, KY	HEMPHILL CORPORATION
1232544	37-06-03.7 N	84-46-43.5 W	NANCY, KY	HEMPHILL CORPORATION
1232562	37-13-27.2 N	84-26-25.3 W	SOMERSET, KY	HEMPHILL CORPORATION
1232715	36-56-43.9 N	84-34-04.5 W	BURNSIDE, KY	HEMPHILL CORPORATION

**Information on Towers Registered with the FCC
in Pulaski County and 1/2 Mile Area Outside of the County Boundary**

FCC Tower Reg. No.	North Latitude	West Longitude	City, State	Tower Owner
1234158	37-00-16.3 N	84-35-30.8 W	Burnside, KY	East Kentucky Power Cooperative, Inc.
1234225	37-01-12.7 N	84-34-43.7 W	SOMERSET, KY	C&C TOWER RENTAL, LLC
1235212	37-06-12 N	84-35-46 W	Somerset, KY	Global Tower, LLC
1237226	37-11-19.3 N	84-37-36.3 W	Science Hill, KY	East Kentucky Power Cooperative, Inc.
1247464	37-06-03.7 N	84-46-43.5 W	Nancy, KY	Hemphill Corporation
1247918	37-07-24.6 N	84-33-06.1 W	Somerset, KY	Hemphill Corporation