

COMMONWEALTH OF KENTUCKY  
BEFORE THE PUBLIC SERVICE COMMISSION

In the Matter of:

MR. AND MRS. CLINT A. STEELE )  
 )  
COMPLAINANTS )  
 )  
v. ) CASE NO. 96-422  
 )  
BELLSOUTH TELECOMMUNICATIONS, )  
INC. )  
 )  
DEFENDANT )

ORDER TO SATISFY OR ANSWER

BellSouth Telecommunications, Inc. ("BellSouth") is hereby notified that it has been named as defendant in a formal complaint filed on August 21, 1996, a copy of which is attached hereto.

Pursuant to 807 KAR 5:001, Section 12, BellSouth is HEREBY ORDERED to satisfy the matters complained of or file a written answer to the complaint within 10 days from the date of service of this Order.

Should documents of any kind be filed with the Commission in the course of this proceeding, the documents shall also be served on all parties of record.

Done at Frankfort, Kentucky, this 5th day of September, 1996.

PUBLIC SERVICE COMMISSION

  
Chairman

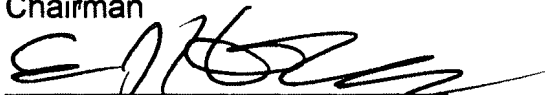
  
Vice Chairman

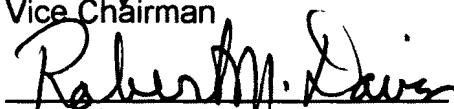
  
Commissioner

ATTEST:

  
Executive Director

AUG 21 1996  
PUBLIC SERVICE  
COMMISSION

Sirs,

96-422

I have enclosed a sketch of our property and the matter in-question. I have made numerous attempts with Bell South to have a mercer co. phone line installed. The person that I have talked to is Jim Gipe. He has stated that the only service that we can have is from Anderson Co.

I have also talked to Carl Mitchell who is an engineer from Anderson Co. he states that it can be run from this side for a fee of \$3,000.00 (not including my cost of clearing the right of way obtaining easements etc..).

The engineer from mercer co., (Judy Stanley) states that although the phone service is ~~across~~ already across Cheese-Lick creek, that my driveway must enter from mercer co. before I can be connected. Since Cheese-Lick creek is the Mercer/Anderson county line, Bell South says they cannot cross it. As I have already stated, it is already across the County line to service Billy Sparks. (Please note this on sketch).

As I have noted on the sketch approximately 700-800 ft. would need to be installed from the service at Billy Spark to reach our house. -

My question is why can't this line be run to the house from the Mercer Co. side instead of paying the unreasonable amount from the Anderson Co. side. I believe this ~~amount~~ is unreasonable and I am not willing to pay that amount when there is a service line so close.

It makes no sense when both ~~so~~ Counties are Bell South served.

I have also requested that if they will not install a line to the primary residence, then I want a Call Box on ~~to~~ our Mercer Co. property and I will install ~~it~~ service my own line.

I would like for both engineers, myself and some-one from Bell South to meet me at my house & discuss this problem.

Please contact me by mail at the address below:

Clint & Myra Stede  
1625 ALFORD Rd.  
SALVISA, Ky 40372



Formal Complaint

MR. & MRS Clint Steele  
(Your Name)

vs

Bell South  
(Utility Name)

Page 2

\_\_\_\_\_  
\_\_\_\_\_  
\_\_\_\_\_  
\_\_\_\_\_  
\_\_\_\_\_

Wherefore, complainant asks Note attached Letter  
(Specifically state the

relief desired.)  
\_\_\_\_\_  
\_\_\_\_\_  
\_\_\_\_\_

Dated at Salvisa, Kentucky, this ~~20th~~ <sup>20th</sup> day

of ~~20th~~ August, 19 96.  
(Month)

Clint A. Steele  
(Your Signature)

(Name and address of attorney, if any)

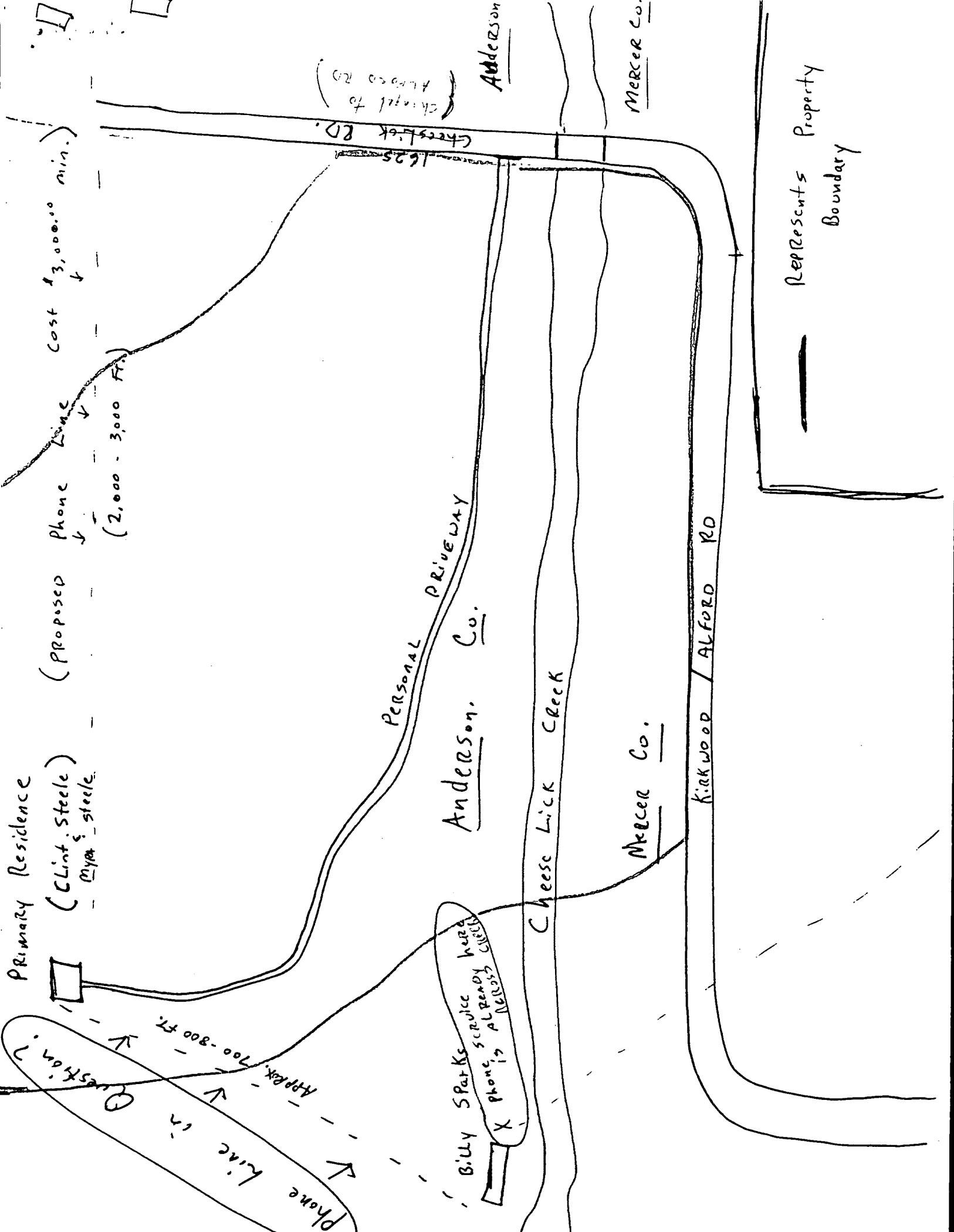

Primary Residence  
(Clint Steele)  
Myra Steele

(Proposed Phone Line)  
Cost \$3,000.00 min.

(2,000 - 3,000 Ft.)

PERSONAL PRIVIEWAY

Anderson, Co.

Cheese Lick Creek

Mercer Co.

Kirkwood / ALFORD RD

Cheese Lick RD.  
1625  
(changed to Alford RD)

Billy Sparks  
Service area  
X phone is already used

Phone line in question?

Approx. 700-800 ft.

Represents Property Boundary

Anderson.

Mercer Co.